

## A POCKET TAP SELF-PRIMING

click valve tap  
PTMCV-NB-EN

## B HANDY TAP SELF-PRIMING

self-closing tap  
HTMSC-GN-EN

### USER MANUAL

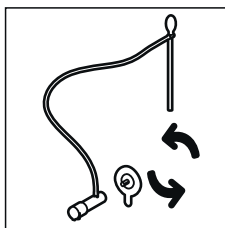

**1** Screw the suction cup onto the tap.

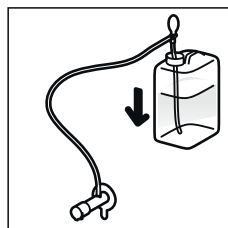

**2** Insert the tube into the water tank. Place the water tank above the tap.

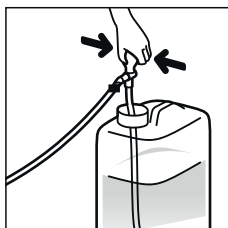

**3** Squeeze the bulb several times until the water completely fills the tube.

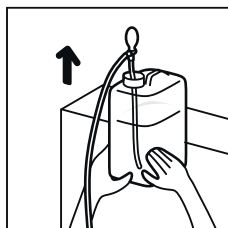

**4** Place the container so that the water level is above the tap.

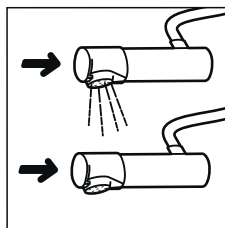

**5 A**  
**For the Pocket Tap Self-Priming (click valve tap).**  
To activate the water flow, press the faucet from the front and hold. Release to stop the water flow.

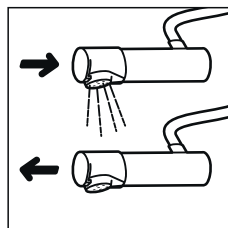

**5 B**  
**For the Handy Tap Self-Priming (self-closing tap).**  
To activate the water flow, press the faucet from the front and hold. Release to stop the water flow.

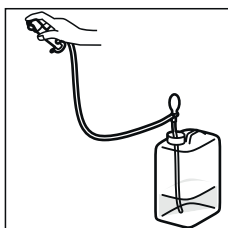

**6** To empty the device, lift the tap above the water tank and press on the tap to let the water back into the water tank.

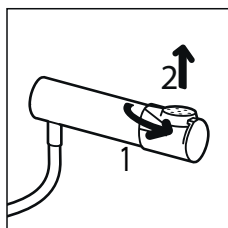

**7** Depending on your needs, you can change the nozzle by turning it 90 degrees and pulling it upwards.

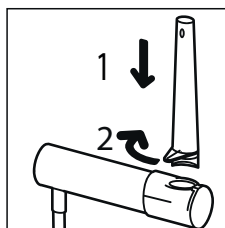

**8** Insert another nozzle into the hole and rotate 90 degrees.

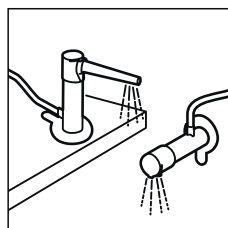

**9** Application examples.