

Quick Start Guide

Wireless Subwoofer Connection Kit

1. Contents List

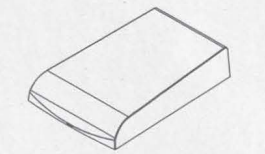

Wireless Transmitter

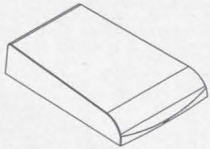

Wireless Receiver

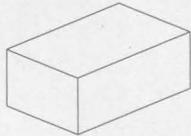

Accessory Carton

- RCA Cables
- USB Cables
- USB AC Adapters
- International USB Plugs (240V version **only**)

2. Connection

LFE (or for devices with built-in bass management)

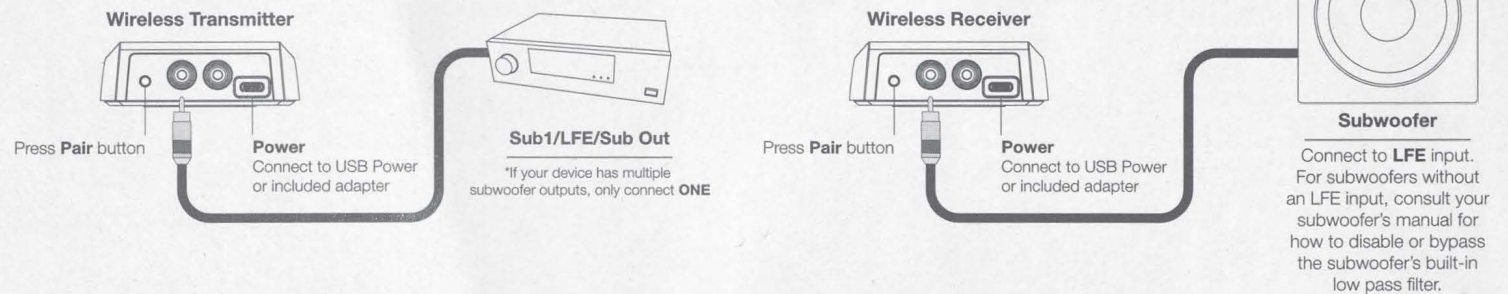

Single Wire Connection (or for devices without built-in bass management)

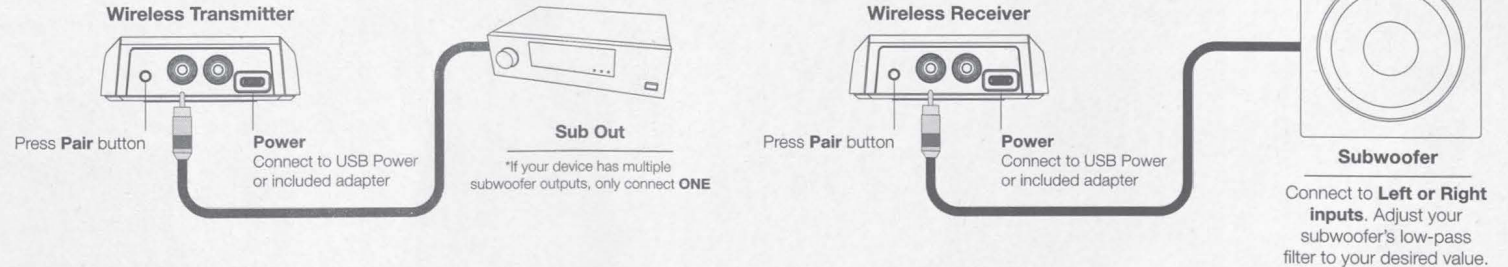

*LFE/Single Wire Connections can use either Left or Right connections on the wireless transmitter or receiver

Quick Start Guide Wireless Subwoofer Connection Kit

2. Connection (Continued)

Stereo Connection

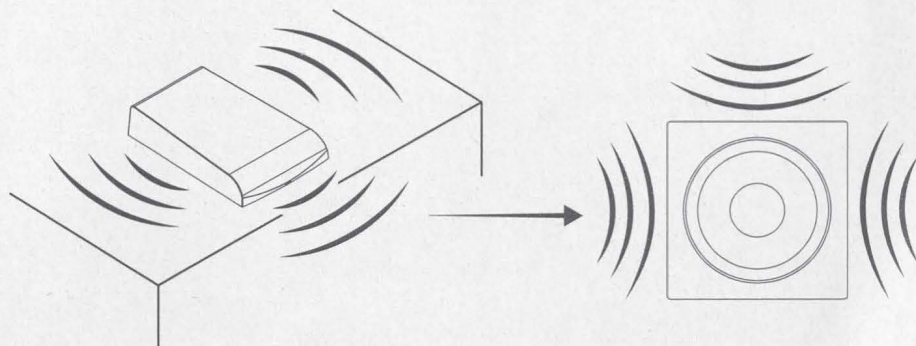
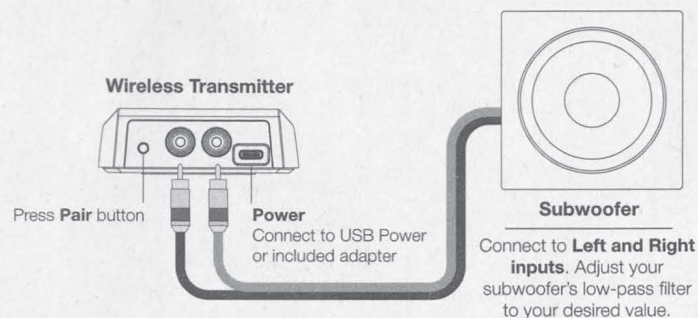

Recommendations for best performance:

- Give the wireless transmitter as clear of a path as possible to the wireless receiver. This may mean placing the transmitter on top of the furniture or away from other components like wireless routers etc.
- It is possible to use multiple wireless subwoofer connection kits in a single system. Due to the nature of wireless signals, it may be necessary to experiment with placement of the transmitter(s). Results may vary.