

User's manual	Manual del usuario	Manuel de l'utilisateur
Customer Service US: 1-800-645-2986	Servicio de atención al Cliente US: 1-800-645-2986	Service à la clientèle Canada: 888-645-2986

# Electronic Lock Surface Mounted Vertical Keypad

Models: 493722

## Features:

- 4 Different Operator's Codes:
  - 8 Digit Master Code
  - 6 Digit Sub-Master Code
  - 6 Digit Technician Code
  - 4 Digit User Code
- Two Modes: Public and Private
- Two-Color LED for Lock Status
- Mechanical Keyway for Emergency Override w/ Master Key
- Requires (2) AA Batteries (Not included)



## Functions:

### Public Mode (Default)

This function is used for short term, multi user applications. While the lock is unlocked, input a 4 digit code to lock the lock. When the lock is unlocked using the same code, the code is erased and a new code can be input by the next user.

### Private Mode

User code is set once and can be reused to lock and unlock the unit.

### Default Settings: Public Mode

Master Code : 99551133  
Technician Code: 147258

### Switching Modes:

To set to Private Mode: C -- 11 -- OK -- Master code -- OK

Example: C -- 11 -- OK -- 99551133 -- OK

The lock will revert to the default user code of 1111 when switched to Private Mode. Don't forget to set a new user code!

To set back to Public Mode: C -- 22 -- OK -- Master code -- OK

The lock will now remain open until next user enters their own code into the lock

Step 1: enter new user code -- OK Close the locker and lock the lock.

Step 2: enter user code -- Unlocks the lock and erases the previous code.

# Electronic Lock

## Installation

1. Open the locker door that the Electronic Lock will be installed on. Remove the nuts holding the plate that covers the hole in the door.

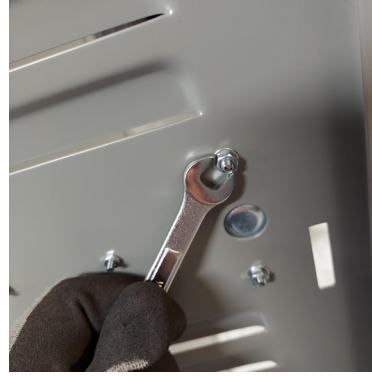

2. Using the included template, align the large hole on the locker and the hole indicated in the template. Align the edge of the template so that it is parallel with the edge of the locker door. Drill a second hole for the securing screw included in the Electronic Lock. Clean off any metal dust.



Drilled Hole

3. Remove the locking bar from the lock and the securing nut from the threaded core. Place batteries inside the unit.

Vent Plate

Rubber Backing

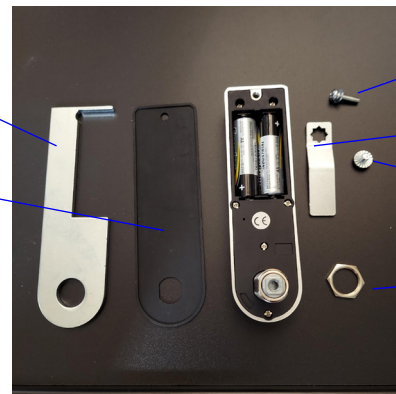

Securing Screw

Lock Bar

Locking Screw

Securing Nut

4. Insert the rubber cover over the batteries, putting the threaded core through the rubber. Depending on the size of the door on the locker, the Vent Plate may be necessary. If Plate is necessary, slide the Plate over the rubber mount so that the gap is on the left Side

No Plate:  
Single Tier  
Double Tier



Plate Required:  
Triple Tier  
4 Tier  
6 Tier



5. Insert the threaded core through the door of the locker. Reattach the Securing Nut, Lock Bar, and Locking Screw onto the threaded core. Insert the Securing Screw through the drilled hole and secure the unit through the hole on the top.



The lock should rest flatly against the locker door with the plate

# Electronic Lock

## Setup:

Before programming, choose which mode would be most appropriate for the application: Public Mode or Private Mode

New locks operate with the default user and master codes. A new user and master code must be programmed to prevent the default codes from operating the lock and reducing lock security.

**Be sure to change the master code after installation.**

## Operating Instructions:

The lock has a 10 button keypad, a C button and an OK button.

The lock has three codes that allow you to perform the following actions:

1) Master code:

- Open the lock
- Change the master code
- Set/Change/Delete the sub-master and user code
- Select between Private and Public functions
- Activate/deactivate technician code

2) Sub-master code:

- Open the lock
- Change the sub-master code
- Set/Change/Delete the user code

3) User code:

- Open the lock
- Change the user code (Public Mode)

4) Technician code: open the lock



# Electronic Lock

## Master Code Functions:

- 1) Open:  
Enter master code  
(The user code will be deleted when using master code when the lock is in public mode)
- 2) Programming Master Code  
Press C -- 01 -- OK -- current master code -- OK -- new master code -- OK  
Example: C -- 01 -- OK -- 99551133 -- OK -- 12345678 -- OK  
Result: Master code has been changed to 12345678
- 3) Set or change the sub-master Code  
Press C -- 02 -- OK -- master code -- OK -- new sub-master code -- OK
- 4) Delete sub-master code  
Press C -- 03 -- OK -- Master code -- OK
- 5) Set or change the User Code (Private Mode)  
Press C -- 00 -- OK -- master code -- OK -- new user code -- OK  
the blue light flash 2 times and one beep will be heard  
Example: C -- 00 -- OK -- 99551133 -- OK -- 1234 -- OK  
Result: The user code has been set to 1234
- 6) Delete User code  
C -- 04 -- OK -- Master code -- OK
- 7) Activate/deactivate technician code  
Activate: C -- 77 -- OK -- Master code -- OK  
Deactivate: C -- 88 -- OK -- Master code -- OK

## Sub-Master Code Functions:

- 1) Open:  
Enter sub-master code  
(The user code will be deleted with the sub master code when the lock is in public mode)
- 2) Change the sub-master Code  
C -- 02 -- OK -- current sub-master code -- OK -- new sub-master code -- OK
- 3) Set/Change the User Code (Private Use mode)  
C -- 00 -- OK -- sub-master code -- OK -- new user code -- OK
- 4) Delete User code (Private Use mode)  
C -- 04 -- OK -- sub-master code -- OK

## User Code Functions:

### Private Mode

- 1) Open:  
Enter user code
- 2) Change the User Code  
C -- current user code -- OK -- new user code -- OK

### Public Mode

- 1) Set code:  
Enter user code -- OK
- 2) Open:  
Enter user code -- OK

## Technician Code Functions:

- 1) Open:  
Enter technician code -- OK  
In private mode using the Technician code will not delete or change the user codes.  
In public mode it will delete the user code.
- 2) Initialize:  
C -- 99 -- OK  
Lock resets to default settings

# Electronic Lock

## Additional Functions

### Occupied Status Indicator (Public Mode) – deactivated by default

When activated, the blue light will flash every 2 seconds to indicate the locker is in use Activate:

C -- 33 -- OK -- Master code -- OK

Deactivate: C -- 44 -- OK -- Master code -- OK

### Password protection – deactivated by default

Entering incorrect codes 5 times will cause the lock to shutdown for 5 minutes

### Automatically locked in Private Mode

The PCB will be lock 3 seconds after being opened

### Emergency Opening

Master key for emergency opening ,the lock code still keep the previous setting

### Sound signals

Press button: beep

Successful unlocking: beep

Low power alarm: 5 beeps

### Colour signals

Blue light flashes when: 1) unlocked successfully 2) programming successful

Red light flashes when: 1) wrong code entered 2) low power alarm

### Low power alarm Function

Alarm will sound if the battery power is low (5 beeps, red light flashes 3 times before blue light flashes once) informing users to replace the batteries.

### Changing the Battery

1. Remove fixing screw
2. Rotate the lock down over the edge of door
3. Take out the batteries
4. Put in the new batteries and screw lock back into place

## Schematics and Specifications

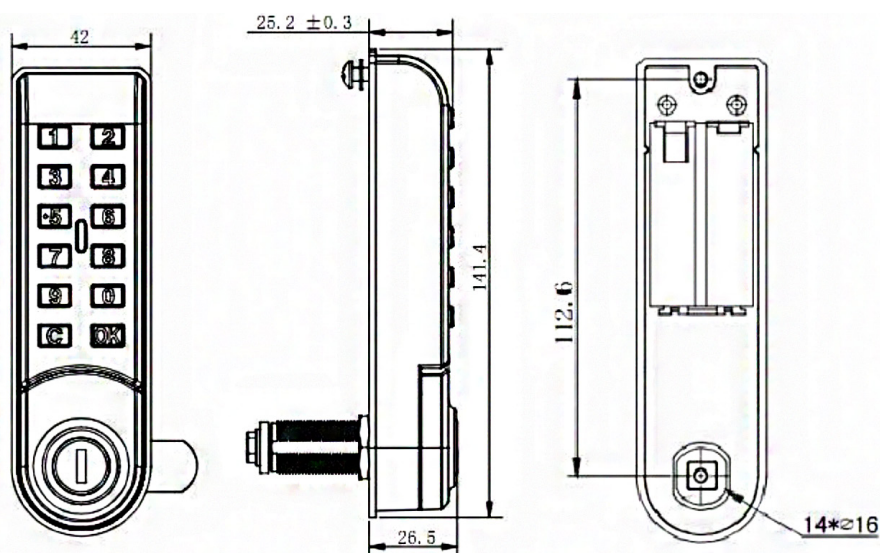

Material	Zinc alloy housing and handle with black/satin chrome coated Mechanical, override lock key Fixing screws and cam
Input Voltage	3VDC
Battery	2x AA Alkaline Batteries (Not Included) Service Life: 60,000 Locking Cycles
Static Power	≤15μA
Dynamic Power	≤170mA
Required Conditions	Temperature Range: 5°F – 140°F Humidity: 15%-90%