

Water Dispenser

USER MANUAL

YL2036S

Warning notices: Before using this product, please read this manual carefully and keep it for future reference. The design and specifications are subject to change without prior notice for product improvement. Consult with your dealer or manufacturer for details. The diagram above is just for reference. Please take the appearance of the actual product as the standard.

THANK YOU LETTER

Thank you for choosing Midea! Before using your new Midea product, please read this manual thoroughly to ensure that you know how to operate the features and functions that your new appliance offers in a safe way.

CONTENTS

THANK YOU LETTER	01
SAFETY INSTRUCTIONS	02
SPECIFICATIONS	05
PRODUCT OVERVIEW	06
PRODUCT INSTALLATION	08
OPERATION INSTRUCTIONS	10
CLEANING AND MAINTENANCE	12
TROUBLESHOOTING	13
TRADEMARKS, COPYRIGHTS AND LEGAL STATEMENT	14
DISPOSAL AND RECYCLING	15
DATA PROTECTION NOTICE	16

SAFETY INSTRUCTIONS

Intended Use

The following safety guidelines are intended to prevent unforeseen risks or damage from unsafe or incorrect operation of the appliance. Please check the packaging and appliance on arrival to make sure everything is intact to ensure safe operation. If you find any damage, please contact the retailer or dealer. Please note modifications or alterations to the appliance are not allowed for your safety concern. Unintended use may cause hazards and loss of warranty claims.

Explanation of Symbols



Danger

This symbol indicates that there are dangers to the life and health of persons due to extremely flammable gas.



Warning of electrical voltage

This symbol indicates that there is a danger to life and health of persons due to voltage.



Warning

The signal word indicates a hazard with a medium level of risk which, if not avoided, may result in death or serious injury.



Caution

The signal word indicates a hazard with a low degree of risk which, if not avoided, may result in minor or moderate injury.



Attention

The signal word indicates important information (e.g. damage to property), but not danger.



Observe instructions

This symbol indicates that a service technician should only operate and maintain this appliance in accordance with the operating instructions.

Read these operating instructions carefully and attentively before using/commissioning the unit and keep them in the immediate vicinity of the installation site or unit for later use!

SAFETY INSTRUCTIONS

DANGER: Risk of Fire/Flammable materials

- Do not use an extension cord with your water dispenser.
Do NOT operate dispenser in the presence of explosive fumes.
- Use only properly grounded outlets.
Always grasp plug and pull straight out from outlet. Never unplug by pulling on power cord.
- Do NOT use dispenser if cord becomes frayed or otherwise damaged.
To protect against electric shock, do NOT immerse cord, plug, or any other part of dispenser in water or other liquids.
Ensure dispenser is unplugged prior to cleaning.
If the supply cord is damaged, it must be replaced by the manufacturer, its service agent or similarly qualified persons in order to avoid a hazard.
It is recommended to use bottled pure water. If you use hard water, may lead to hot pot furring or detonation tank or pipeline risk. If you need cleaning tube, remove scale, need to find a professional institutions and professional operation.
WARNING: When positioning the appliance, ensure the supply cord is not trapped or damaged.
WARNING: Do not locate multiple portable socket-outlets or portable power supplies at the rear of the appliance.

CAUTION: Risk of injury!

Failure to comply with the safety information and instructions may result in injury. Safety of children and persons with reduced abilities.

- This appliance is not intended for use by persons (including children) with reduced physical, sensory or mental capabilities, or lack of experience and knowledge, unless they have been given supervision or instruction concerning use of the appliance by a person responsible for their safety.
- Children should be supervised to ensure that they do not play with the appliance.
- Never allow children to dispense hot water without proper and direct supervision.
Unplug unit to prevent unsupervised use by children.

WARNING

- This appliance is intended to be used in household and similar applications such as: staff kitchen areas in shops, offices and other working environments; farm houses and by clients in hotels, motels and other residential type environments; bed and breakfast type environments; catering and similar non-retail applications.
- WARNING: Keep ventilation openings, in the appliance enclosure or in the built-in structure, clear of obstruction.
- WARNING: Do not use mechanical devices or other means to accelerate the defrosting process, other than those recommended by the manufacturer.
- This appliance is not suitable for installation in an area where a water jet could be used.

SAFETY INSTRUCTIONS

- Do not store explosive substances such as aerosol cans with a flammable propellant in this appliance.
- The appliance must not be immersed.
- The appliance must not be cleaned by a water jet.
- The appliance is suitable for indoor use only.
- This appliance should work under environment of temp from 10°C~43°C.
- Never turn the machine upside down or lean it more than 45°.
- Thermostat has be adjusted. No need to adjust it by yourself. When the machine is under the ice point and blocked by ice, the cooling switch must be closed for 4 hours before turning it on again to continue its operation.
- This machine should not be turned on until 3 minutes later after turning off the power switch.
- Prior to use, this dispenser must be properly assembled and installed in accordance with this manual.
- This dispenser is intended for water dispensing only. Do NOT use other liquids. Do NOT use for other purposes. Never use any other liquid in the dispenser other than known and microbiologically safe bottled water.
- For indoor use only. Keep water dispenser in a dry place away from direct sunlight. Do NOT use outdoors.
- Install and use only on a hard, flat and level surface.
- Do NOT place dispenser into an enclosed space or cabinet.
- Position back of dispenser no closer than 20cm from wall and permit free airflow between wall and dispenser. There must be at least 20cm clearance on the sides of the dispenser to permit airflow.
- Warning: Do not damage the refrigerant circuit.
- Service should be performed only by a certified technician.
- This product is not recommended at an altitude of 1500 meters above the region to use.
- In order to make sure the machine can be used normally, please keep it stand still for 24 hours before powering up.

SPECIFICATIONS

Product Model	YL2036S
Rated Voltage	220-240V~
Rated Frequency	50/60Hz
Rated power	520W
Heating power	420W
Cooling current	1.0A
Hot water capacity	4L/h(≥85°C)
Cold water capacity	4L/h(≤10°C)
REFRIGERANT	R134a(32g)

PRODUCT OVERVIEW

Product

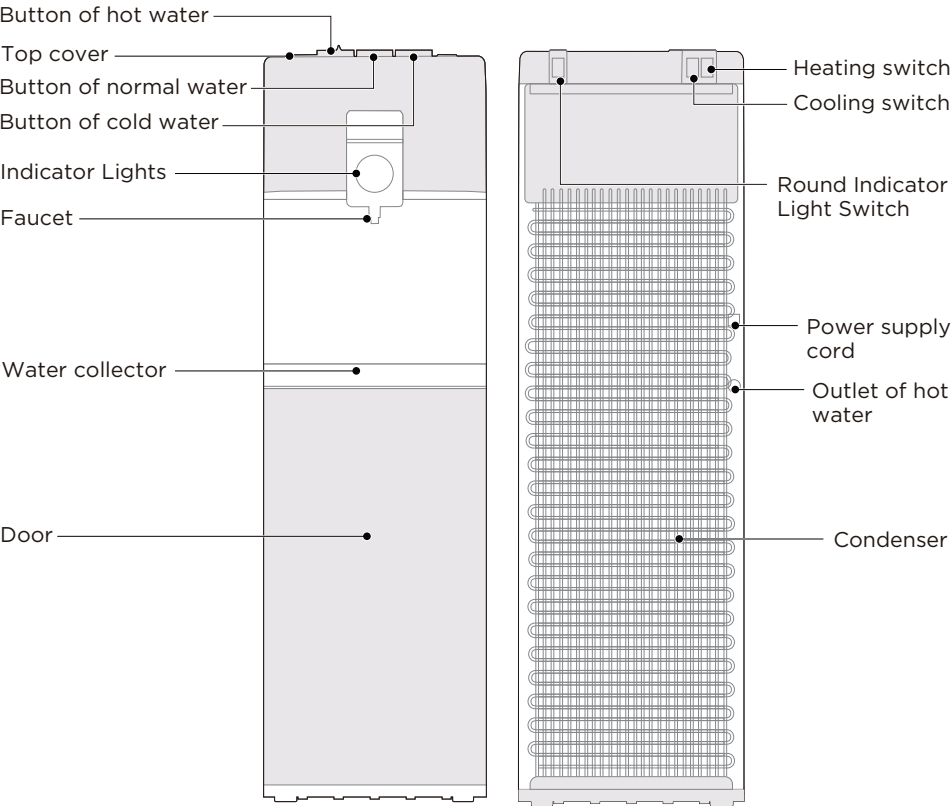

PRODUCT OVERVIEW

Accessories

Instruction Manual x1

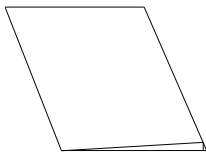

Warranty Card x1



Anchor bolt x1

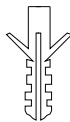

Fixed block x1

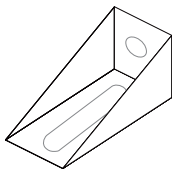

Screw x2

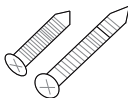

PRODUCT INSTALLATION

Getting Started

Locate Dispenser

1. Place dispenser upright.
2. Locate dispenser on a hard and level surface in a cool shaded location near a grounded wall outlet.

Note: Do not plug in power cord yet.

3. Position dispenser with at least 20cm from wall and at least 20cm on both sides.

Assemble

1. Remove drip tray from door and place the grid on top.
2. Snap drip tray and grid assembly into door.

Install Water Bottle

1. Open dispenser door.
2. Place probe assembly on probe hanger.
3. Place fresh bottle outside of cabinet.
4. Remove entire plastic cap from top of bottle.
5. Clean outside of new bottle with a cloth.
6. Place probe into bottle.
7. Slide collar down until it clicks in place.
8. Push head down until tubes hit bottom of bottle.
9. Slide bottle into cabinet and close door.

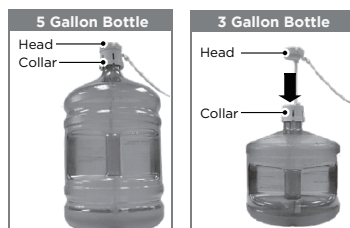

Provide Electricity

Plug cord into a properly grounded wall outlet. At this time the pump will begin to move water from the bottle to the hot and cold tanks. It will take up to 5 minutes to fill the tanks for the first time. During this period the pump will run continuously. This is normal.

Activate Heating & Cooling

Notice: This unit will not dispense hot or cold water until the switches are activated.

To activate, push top side of power switches in to start heating and cooling water.

If you do not want to heat water, push bottom side of red switch in.

If you do not want to cool water, push bottom side of green switch in.

Activate Nightlight

Push top side of blue power switch in to turn light on. Push bottom side in to turn light off.

PRODUCT INSTALLATION

Machine Installation

To prevent the machine from swaying to fall, please install the bracket accordingly.

- 1-2. Loosen the screw of the left or right bottom angle just as the picture shown.
3. Use the screw to fix the bracket on the left or right bottom angle of the water dispenser.
4. Make a hole on the floor's or the desk's surface where the water dispenser will be installed.
5. Fix the bracket on the floor by screw tightly.
6. Tighten the screw.

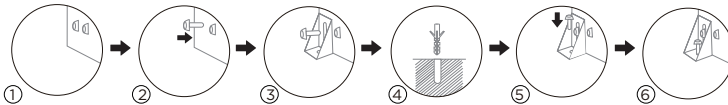
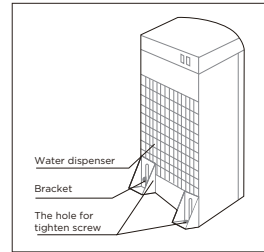



WARNING! To avoid a hazard due to instability of the appliance, it must be fixed in accordance with the instructions.

OPERATION INSTRUCTIONS

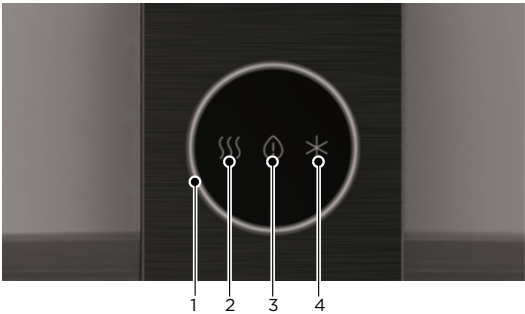
Operation Panel

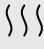

Description		
No.1	 Round Indicator Light	<ul style="list-style-type: none">• Plug the power supply cord into a wall outlet, the power pilot lamp will light up and will go off when the unit is unplugged.• If the machine is powered on, you don't need the round indicator light, you can turn off the round indicator light switch on the back of the machine.
No.2	 Heating Indicator Light	<ul style="list-style-type: none">• When heating function is on, the icon lights on. When heating function is off, the icon lights off
No.3	 Lacking Water Indicator Light	<ul style="list-style-type: none">• When lack of water, the icon flashes. When no lack of water, the icon lights off
No.4	 Cooling Indicator Light	<ul style="list-style-type: none">• When cooling function is on, the icon lights on. When cooling function is off, the icon lights off

Dispensing Water

This unit has been tested and sanitized prior to packing and shipping. During transit dust and odors can accumulate in the tank and lines. Dispense and dispose at least one quart of water prior to drinking any water.

Dispensing Cold Water

After setup, it will take up to 3 hour to get water to maximum cold temperature. During this time the compressor could run continuously. This is normal.

1. Position bottle, glass, pitcher or cooking pot below spout.
2. Depress cold water control downward to start cold water flow.
3. Release control once desired fill level is achieved.

OPERATION INSTRUCTIONS

Dispensing Normal Water

1. Position bottle, glass, pitcher or cooking pot below spout.
2. Depress normal water control downward to start normal water flow.
3. Release control once desired fill level is achieved.

Dispensing Hot Water

After setup, hot water will be available in 15-20 minutes.

1. Position bottle, glass, pitcher or cooking pot below spout.
2. Slide red button away from you and depress hot water control downward to start hot water flow.
3. Release control once desired fill level is achieved.

Changing Bottles

A flashing red light on your function lights alerts you when your bottle is empty.

Replace the bottle as soon as possible.

Notice: Do not dispense hot, cool or cold water if the red light is flashing as you could empty the tanks and cause the dispenser to overheat.

1. Open dispenser door.
2. Slide empty bottle out of cabinet.
3. Remove probe assembly from empty bottle. Place probe assembly on probe hanger.
4. Set empty bottle aside.
5. Place fresh bottle outside of cabinet. Remove entire plastic cap from top of bottle. Clean outside of new bottle with a cloth.
6. Place probe into bottle. Slide collar down until it clicks in place. Push head down until tubes hit bottom of bottle.
7. Slide bottle into cabinet and close door.

CLEANING AND MAINTENANCE

To avoid accident cut off the power supply before operation according to the following instruction.

1. The machine had been disinfected before departed from factory. Cleaning the dispenser prior to installing a full bottle of water for the first time.

2. Cleaning and draining instruction:

- 1) Making sure the power switch in the O(off) position and unplug the water dispenser before cleaning.
- 2) Twist out the two screws ①, then take down top cover, cold tank cover and separator ②.
- 3) Fill 0.6 gallons pure water into cold tank to clean it.
- 4) Turn on all the taps in turn for 3 minutes after the water outflow, which completes the internal pipeline flushing.
- 5) Place a large water bucket beneath the drain outlet which on the back of water dispenser, then, remove the drain cover and drain the water ③.
- 6) Reposition the drain cover, separator, cold tank cover and top cover after draining. Ensure the pipe and wires are connected properly, then, you can use the machine normally.

Attention: 1) The cleaning must be under the guidance of professional staff.

2) The dispenser heats water to a temperature of approximately 85 °C. It can cause severe burns. Please operate it carefully.

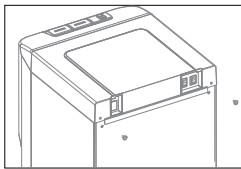

①

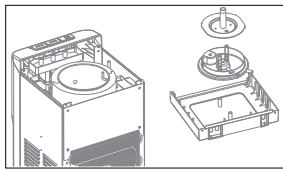

②

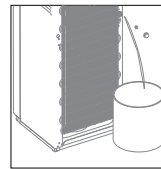

③

3. Sanitizing

The machine should be disinfected with the disinfectant separately bought from drugstore or marketplace according to the instruction manual of the disinfectant and then clean it with water (see **cleaning and draining instruction**). Generally this should be done every three months.

4. To Remove Mineral Deposits:

Mix 4 liters water with 200g citric acid crystals, inject into the machine and make sure the water can flow out of the hot water tap. Switch on the power and heat it about 10 minutes, 30 minutes later, drain off the liquor and clean it with water for two or three times. Generally this should be done every six months. Never disassemble this machine by yourself to avoid danger from damaging machine.

TROUBLESHOOTING

Operation of your appliance can lead to errors and malfunctions. The following tables contain possible causes and notes for resolving an error message or malfunction. It is recommended to read the tables carefully below in order to save your time and money that may cost for calling to the service center.

Problem	Possible reason	Solution
Does not work	• Electric plug out of the socket.	• Plug in.
	• Bonded in different voltage.	• Connect in correct voltage.
	• Lack of electric power or fuse blown.	• Wait for electric power ON or change fuse.
	• Make sure water switches in the rear side of dispenser is ON.	• Push the switches to the ON position.
	• Voltage drop.	• Use a voltage stabilizer.
No Water is coming from the tap	• Make sure the bottle is not empty.	• The lacking water pilot lamp is turn on to alert you when your bottle is empty, if empty, replace it.
Water not cold from cold tank	• Electric plug out of the socket.	• Plug in.
	• After setup, it will take up to 3 hour to chill the water until minimal set temperature.	• Wait 3 hour for the cold water supply.
	• Make sure cold water switch in the rear side of dispenser is ON.	• Push the cold water switch (green) to the ON position.
Water not hot from hot tank	• Electric plug out of the socket.	• Plug in.
	• After setup, it will take up to 15 min to heat the water until maximal set temperature.	• Wait 15 -20 min. for the heat water supply.
	• Make sure hot water switch in the rear side of dispenser is ON	• Push the hot water switch (red) to the ON position.
Water leakage	• A hole or a crack in the bottle.	• Replace the water bottle.
	• Overflow in the water collector.	• Empty the water collector.
	• Drainage cap not well tightened.	• Tighten the cap.
Noisy operation	• Product leaning on the wall.	• The appliance must be at least 20 cm from the wall.
	• Uneven placement.	• Place the machine on placid & solid surface.

TRADEMARKS, COPYRIGHTS AND LEGAL STATEMENT

 Midea logo, word marks, trade name, trade dress and all versions thereof are valuable assets of Midea Group and/or its affiliates (“Midea”), to which Midea owns trademarks, copyrights and other intellectual property rights, and all goodwill derived from using any part of an Midea trademark. Use of Midea trademark for commercial purposes without the prior written consent of Midea may constitute trademark infringement or unfair competition in violation of relevant laws.

This manual is created by Midea and Midea reserves all copyrights thereof. No entity or individual may use, duplicate, modify, distribute in whole or in part this manual, or bundle or sell with other products without the prior written consent of Midea.

All the described functions and instructions were up to date at the time of printing this manual. However, the actual product may vary due to improved functions and designs.

DISPOSAL AND RECYCLING

Important instructions for environment

Compliance with the WEEE Directive and Disposing of the Waster Product:
This product complies with EU WEEE Directive (2012/19/EU). This product bears a classification symbol for waster electrical and electronic equipment (WEEE).

This symbol indicates that this product shall not be disposed with other household wastes at the end of its service life. Used device must be returned to official collection point for recycling of electrical electronic devices. To find these collection systems please contact to your local authorities or retailer where the product was purchased. Each household performs important role in recovering and recycling of old appliance. Appropriate disposal of used appliance helps prevent potential negative consequences for the environment and human health.



Compliance with RoHS Directive

The product you have purchased complies with EU RoHS Directive (2011/65/EU). It does not contain harmful and prohibited materials specified in the Directive.

Package information

Packaging materials of the product are manufactured from recyclable materials in accordance with our National Environment Regulations. Do not dispose of the packaging materials together with the domestic or other wastes. Take them to the packaging material collection points designated by the local authorities.



DATA PROTECTION NOTICE

For the provision of the services agreed with the customer, we agree to comply without restriction with all stipulations of applicable data protection law, in line with agreed countries within which services to the customer will be delivered, as well as, where applicable, the EU General Data Protection Regulation (GDPR).

Generally, our data processing is to fulfil our obligation under contract with you and for product safety reasons, to safeguard your rights in connection with warranty and product registration questions. In some cases, but only if appropriate data protection is ensured, personal data might be transferred to recipients located outside of the European Economic Area.

Further information are provided on request. You can contact our Data Protection Officer via **MideaDPO@midea.com**. To exercise your rights such as right to object your personal data being processed for direct marketing purposes, please contact us via **MideaDPO@midea.com**. To find further information, please follow the QR Code.

