

140mm

100mm

Solar Charger for Nest Doorbell (battery)

USER MANUAL



WASSERSTEIN
made for
Google Nest

In the Box

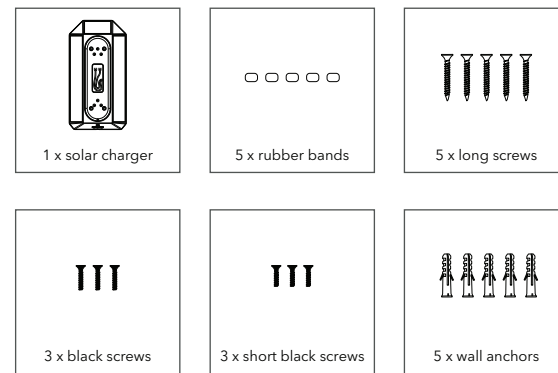

Important note: Fully charge the Nest Doorbell (battery) before connecting to the solar charger. Mount the solar charger where it can receive maximum sunlight.

Page 1

Installation with Google Nest Doorbell

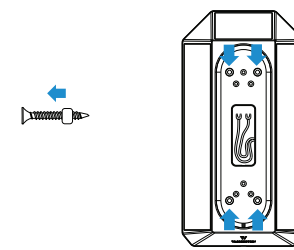

1. Insert the rubber bands onto the long screws provided. Using the long screws and wall anchors, install the solar charger onto the wall using a 3/32" drill bit (0.9 inch).

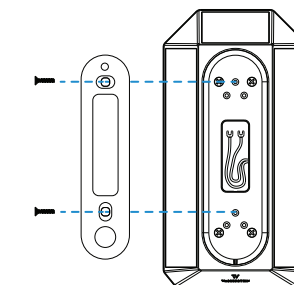

2. With 2 of the short black screws provided, install the backplate (included with the doorbell) onto the solar charger, inserting them into the middle screw holes.

Page 2

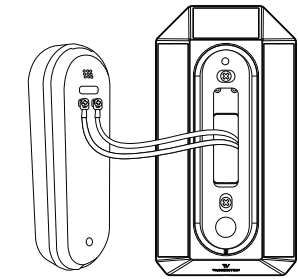

3. Pull out the fork connector cables and screw them to the back of the doorbell. Once connected, push the cables back in and click the doorbell onto the solar charger.

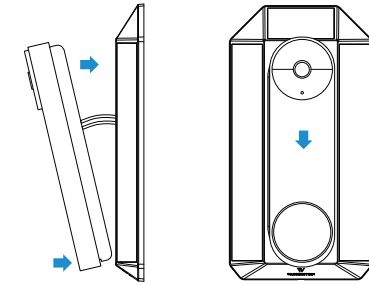

4. Once the doorbell has been placed, push the doorbell down to lock it onto the solar charger.

Page 3

Installation with Google Nest Doorbell Wedge

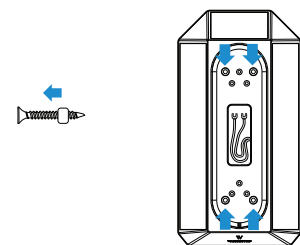

1. Insert the rubber bands onto the long screws provided. Using the long screws and wall anchors, install the solar charger onto the wall using a 3/32" drill bit (0.09 inch).

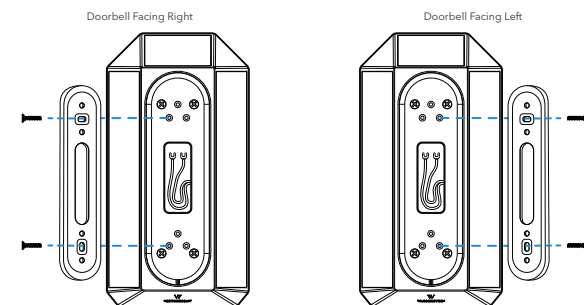

2. With 2 of the black screws provided, install the wedge plate (included with the doorbell) onto the solar charger. When the doorbell is faced on the right, install the wedge plate with the two screw holes on the left. When the doorbell is faced to the left, install the wedge plate with the two screw holes on the right.

Page 4

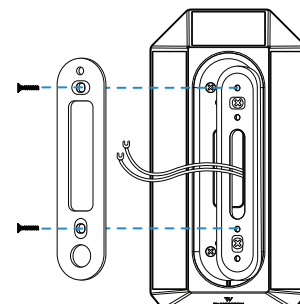

3. Insert 2 of the short black screws into the upper screw holes on both the top and bottom part of the backplate.

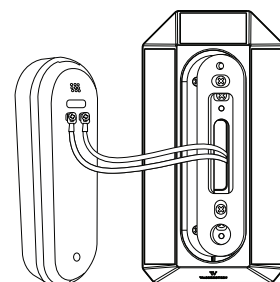

4. Pull out the fork connector cables and screw them to the back of the doorbell. Once connected, push the cables back in and click the doorbell onto the solar charger.

Page 5

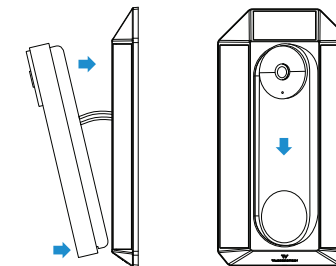

5. Once the doorbell has been placed, push the doorbell down to lock it onto the solar charger.

FAQ

The Solar charger is connected to Nest Doorbell - Why does the battery level drop?

The solar charger has to be exposed to direct sunlight. the "Plug-in" and "Infinity" signs in the Nest App mean the Nest Doorbell is correctly connected and being charged by the solar charger. Depending on the sunlight exposure, it may take a while to see an increase in your battery percentage.

Note :
In most situations, the solar charger can extend the battery life. However, it depends on the number of triggering events from the doorbell. The more triggering events there are, the more current gets consumed by the doorbell battery, which may exceed the charging input provided by the solar charger.

You can extend the battery life by adjusting the doorbell settings. Settings include wake-up sensitivity, maximum event length, video quality, activity zone, and event history.

Page 6

Get More Support

Scan the QR code below or email us at contact@wasserstein-home.com.

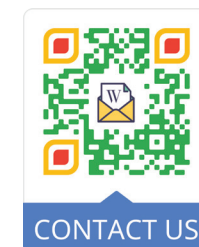

This product has been certified by Wasserstein to meet Google's compatibility standards. Google is not responsible for the operation of this product or its compliance with any applicable safety or other requirements.

Learn more at [g.co/madeforgoogle](https://www.google.com/madeforgoogle/).

Google's "made for" badge, Google Nest Doorbell (battery), and related marks are trademarks of Google LLC.

Google Nest Doorbell (battery) is not included. Wasserstein is not affiliated with Google LLC. Wasserstein is a trademark of Dropcases Ltd. Google Nest Doorbell (battery) is a trademark of Google LLC.

WASSERSTEIN
www.wasserstein-home.com
Made in China