

Belmont sash window furniture

INSTRUCTIONS

Sash pulley	1
Sash stop	4

Sash pulley

INCLUDED

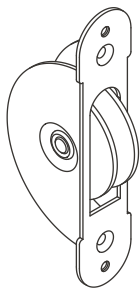

Pulley body x1

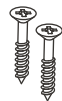

Crosshead wood
screw x2



Face plate x1



Flathead face
plate screw x2

TOOLS YOU'LL NEED

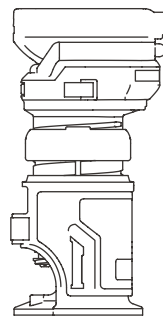

Router or chisel

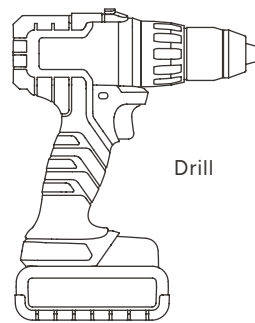

Drill



2mm drill bit

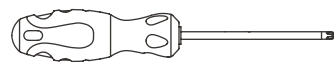

Crosshead
screwdriver
(PZ2)

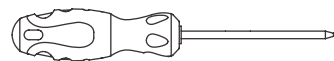

Flathead
screwdriver
(6.5mm)

Sash pulley

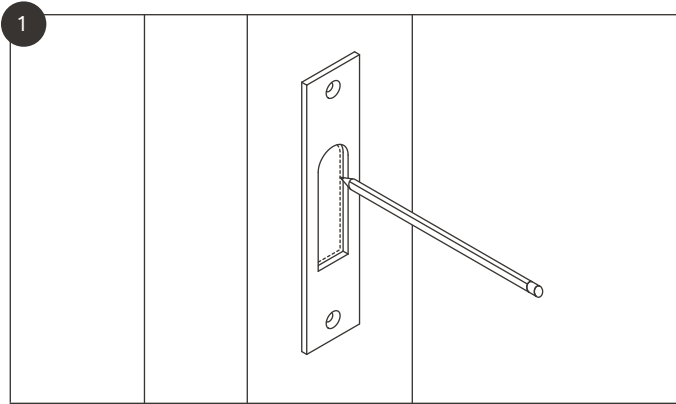

Use the face plate to mark the pulley position on the window frame with a pencil.

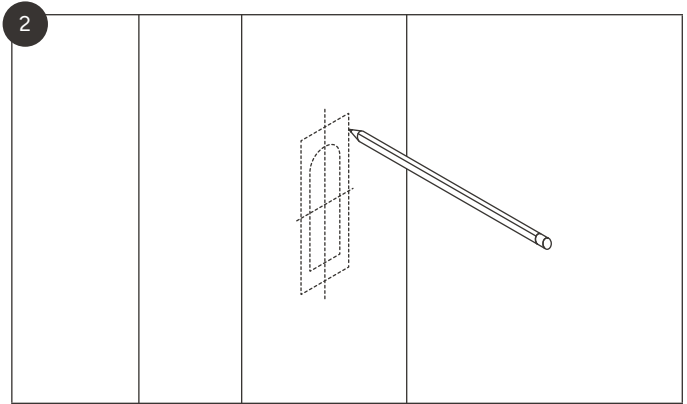

Find the centre point and mark out a H67mm x W22mm rectangle.

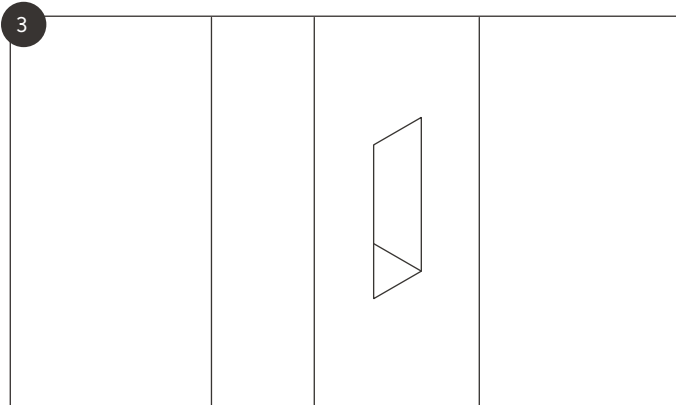

Use these markings to make a 40mm deep cavity in the frame. This will house the pulley body.

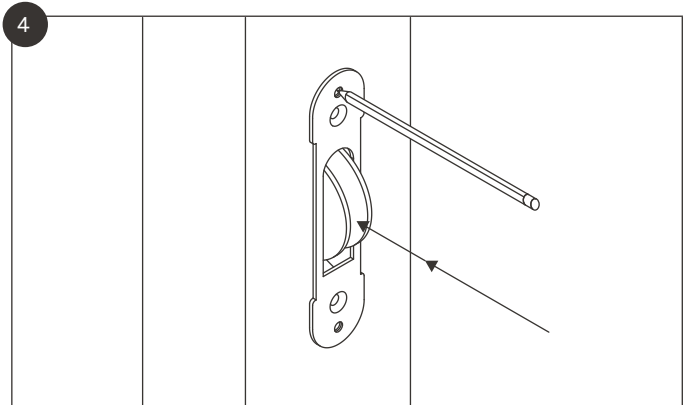

Push the pulley body into the cavity and mark all four holes with a pencil.

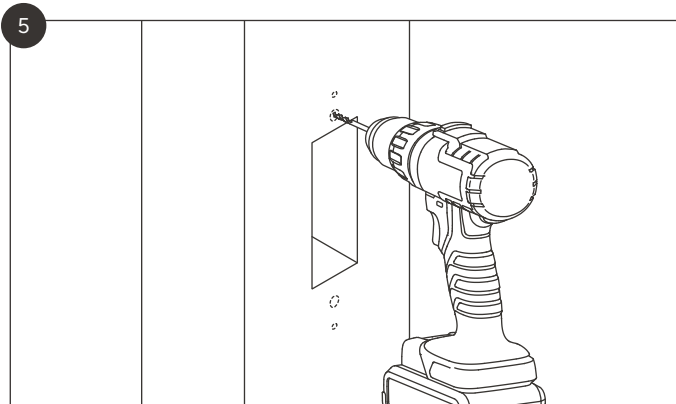

Drill pilot holes on the two inner markings, closest to the cavity.

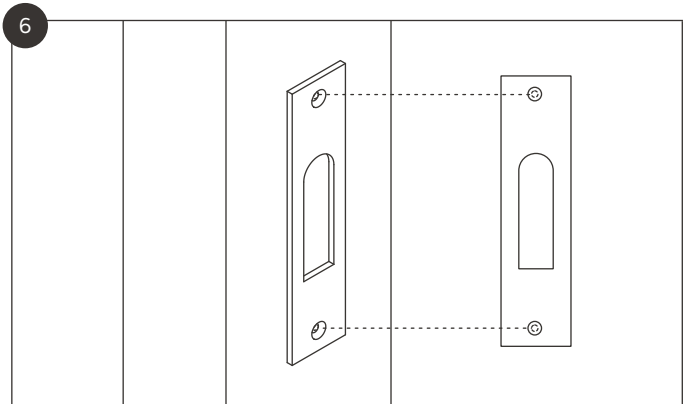

Line the face plate up so the outermost markings are visible through the holes in the face plate.

Sash pulley

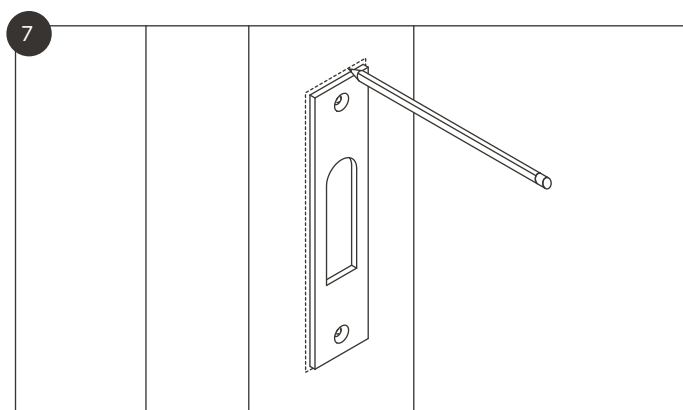

Draw a line around the edge of the face plate.

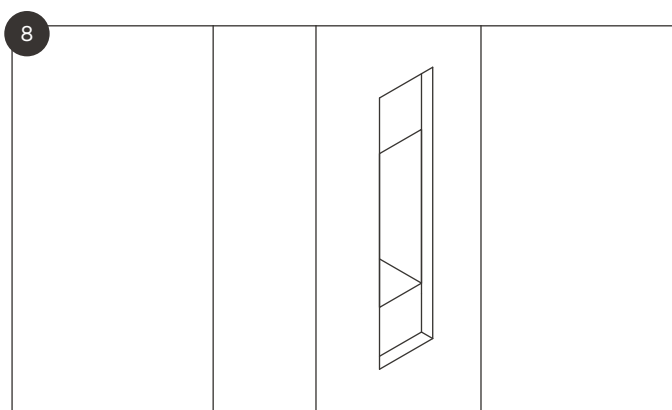

Using this as a template, create a 4mm recess in the frame.

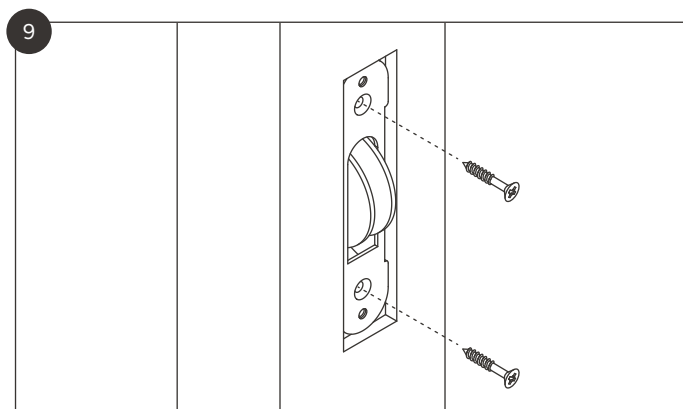

Use the wood screws provided to install the pulley.

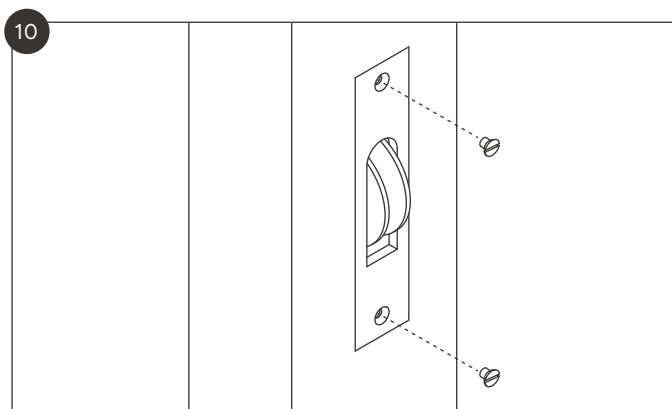

Use the front plate screws to install the face plate.

Sash stop

INCLUDED

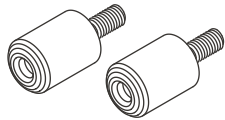

Belmont sash
stop x2

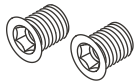

Threaded
insert x2



Hex key x1

TOOLS YOU'LL NEED

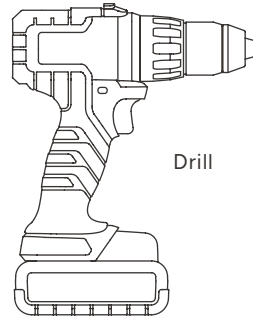

Drill



2mm drill bit



10mm drill bit

Sash stop

1

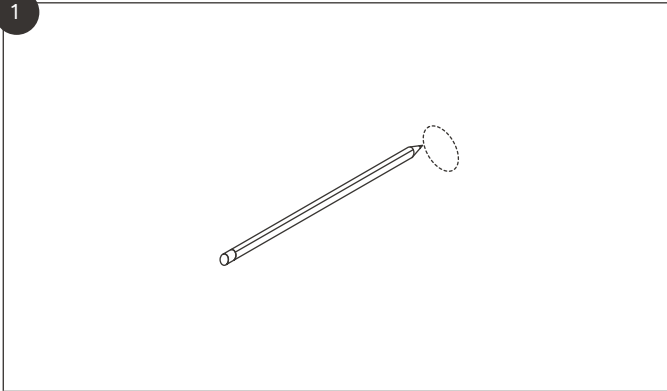

Mark the position of the stop on the window.

2

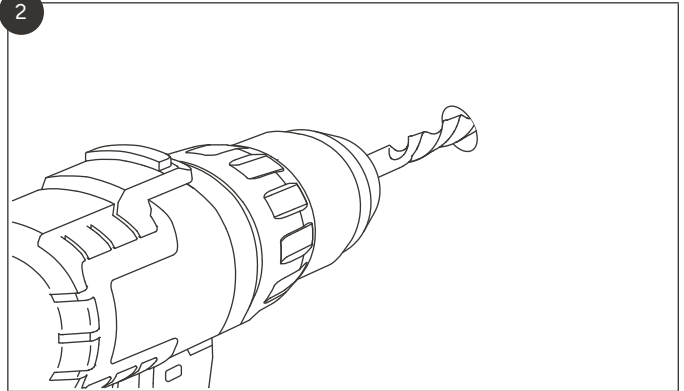

Where marked, drill a pilot hole. Use this to drill a 10mm hole, 13mm deep. This will be for the threaded insert.

3

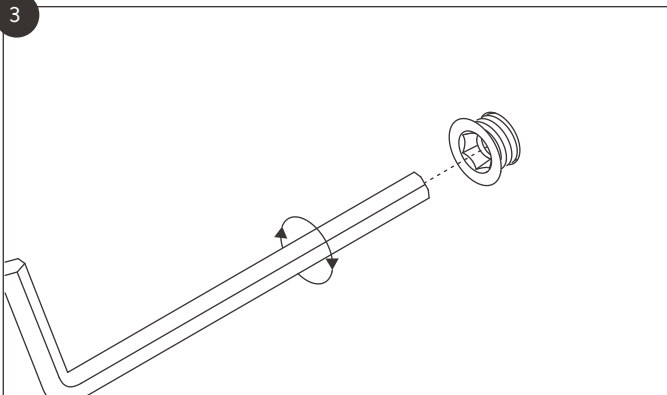

Install the threaded insert using the 6mm hex key provided.

4

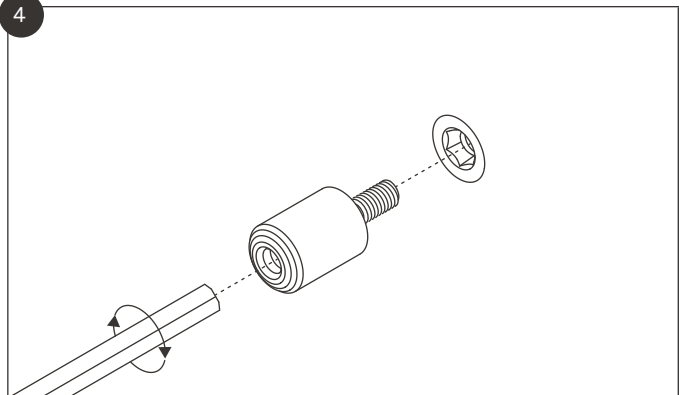

Use the hex key provided to install the stop to the window.