

MECHANICAL KEYLESS DOOR LOCK

USER MANUAL

MODEL: OL-209D2-BY-B-01
OL-209S2-BY-C-01

We continue to be committed to provide you tools with competitive price.
"Save Half", "Half Price" or any other similar expressions used by us only represents an estimate of savings you might benefit from buying certain tools with us compared to the major top brands and does not necessarily mean to cover all categories of tools offered by us. You are kindly reminded to verify carefully when you are placing an order with us if you are actually saving half in comparison with the top major brands.

Safety instruction and precautions

WARNING:

Read this material before using this product. Failure to do so can result in serious injury.

Assembly precautions:

- 1) Assemble only according to these instructions. Improper assembly can create hazards.
- 2) Wear ANSI-approved safety goggles and heavy-duty work gloves during assembly.
- 3) Keep assembly area clean and well lit.
- 4) Keep bystanders out of the area during assembly.

1. Front Panel x 1
2. Back Panel x 1
3. Instruction x 1
4. Door Striker Plate* 1 set
5. Widen protective rubber mat (160x65mm) x 2 pieces
6. Screws M4x40mm x 2pcs
7. Screws M4x50mm x 2pcs
8. Mounting spindle (square root) 55mm x 1pc
9. Mounting spindle (square root) 63mm x 1pc
10. Mounting spindle (square root) 71mm x 1pc
11. Mounting spindle (square root) 79mm x 1pc
12. Hollow stud (M5xM4x40mm) x 2
13. Spring x 1
14. Cross slotted flat head self-tapping screws (wood tooth screws) x 4
15. Auxiliary installation drilling sticker x 1

- 2 -

MODEL: OL-209D2-BY-B-01/OL-209S2-BY-C-01



NEED HELP? CONTACT US!

Have product questions? Need technical support? Please feel free to contact us:

Technical Support and E-Warranty Certificate
www.vevor.com/support

This is the original instruction, please read all manual instructions carefully before operating. VEVOR reserves a clear interpretation of our user manual. The appearance of the product shall be subject to the product you received. Please forgive us that we won't inform you again if there are any technology or software updates on our product.

- 1 -

MODEL: OL-209D2-BY-B-01

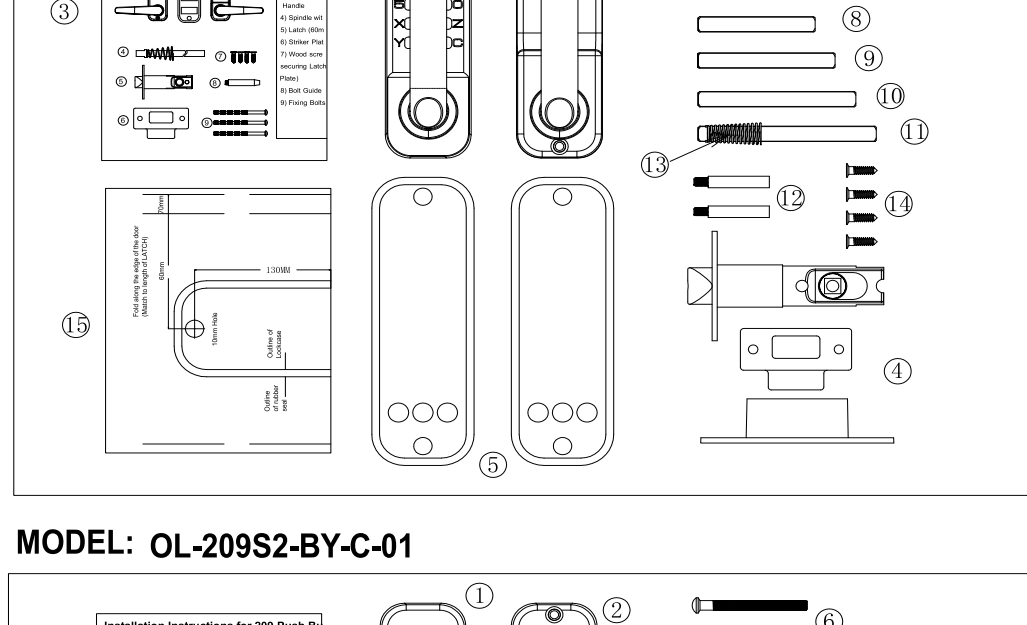

MODEL: OL-209S2-BY-C-01

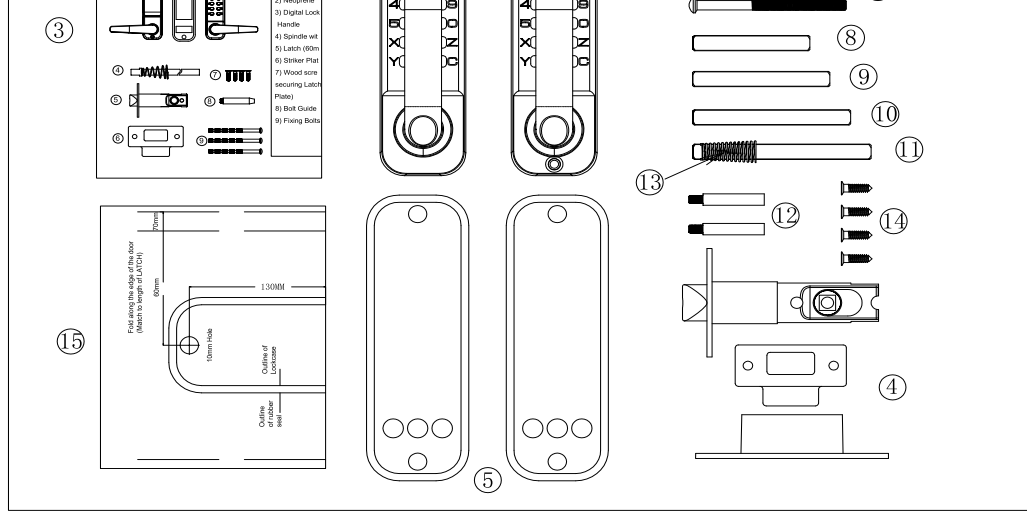

- 3 -

Before installation, please:

- 1) Ensure all parts work properly.
- 2) Set or Change the password. The passwords are set in different order and cannot be repeated. A four-digit password is the most secure.
- 3) Ensure that the door lock can be used normally after setting the password. Also check whether the lock cylinder can be switched freely. You can insert the lanyards into the square hole of the feed cylinder, turn the lanyards, and the lock tongue can expand normally.

Set/change the password

- 1) On the back of the lock body with the number key, you will see the button with the slot, the point of the direction towards the middle. This position is password free. FIG 1A
- 2) If you want to set a button as a password, please gently push down the button with a one-word screw batch and rotate it 180 degrees so that the point position is opposite to the number. This button is the password. Point outward to "G" FIG 1B
- 3) To cancel a password, please gently hold the button with the one-word screw batch and rotate 180 degrees so that the dot is facing the middle of the lock body (inward "F").

Before installing the door, please remember the password set.

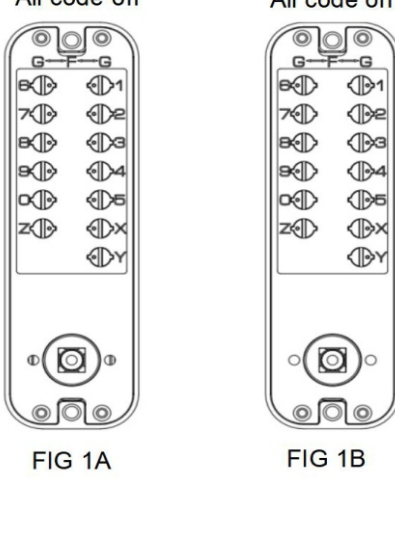

- 4 -

Installation

- 1) Correctly position and paste the templates (page 8) to the surface of the inner section at the required height off the ground. Ensure that relevant, marked, door-to-door templates are properly aligned with the actual door-to-door. (FIG 2)
- 2) The holes marked with a diameter of 10mm are the main shaft holes of the lanyards, and the two holes with a diameter of 7mm are the bolts for digital locking the spindle through the fastener. 3) Doors with 6mm diameter holes marked correctly for reinforcement pins according to installation.
- 4) Drill all marked holes.

Door edge

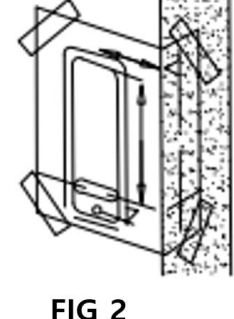

FIG 2

Install the lock cylinder

- 1) A door marked with a center point on the "latch center line".
- 2) Drill a hole 25 mm in diameter and 80 mm in depth at the marked location. (FIG 3A)
- 3) Put the lock cylinder into the open hole and then insert the lanyards into the square hole of the lock cylinder and tighten the lock cylinder.
- 4) Drill a small hole 3MM in the mounting hole of the lock cylinder.
- 5) Secure the door with wood national screws to ensure proper positioning.
- 6) Please adjust the size according to the value above the lock cylinder in FIG 3B, when push forward, the size is 60MM, when pull back, the size is 70MM.

- 5 -

FIG 3A

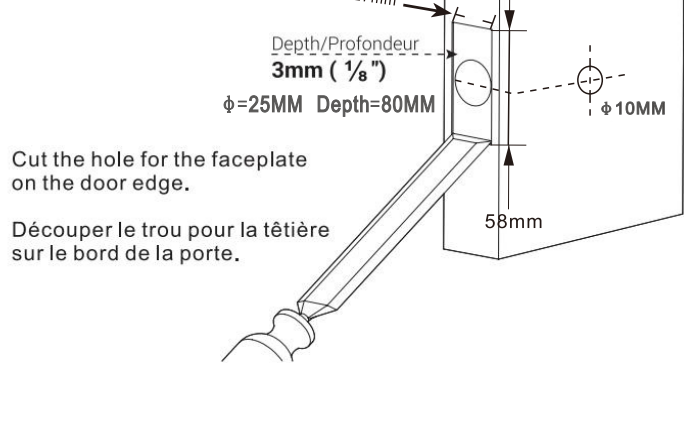
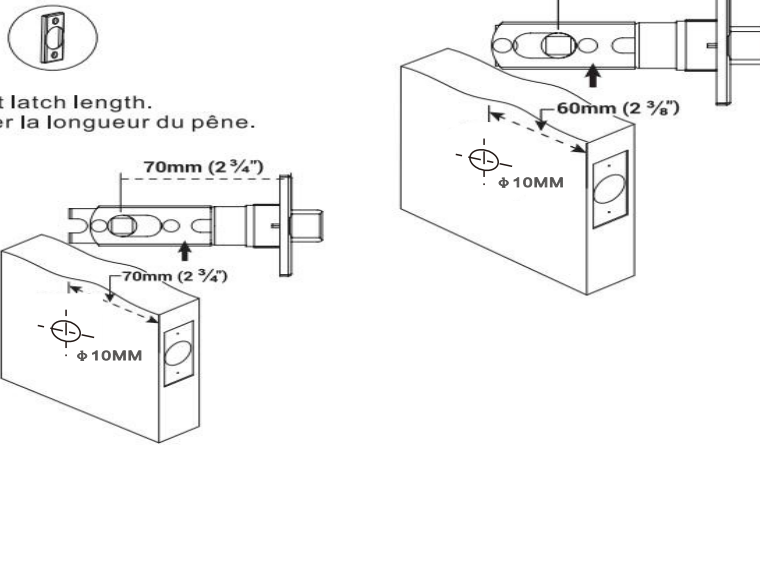
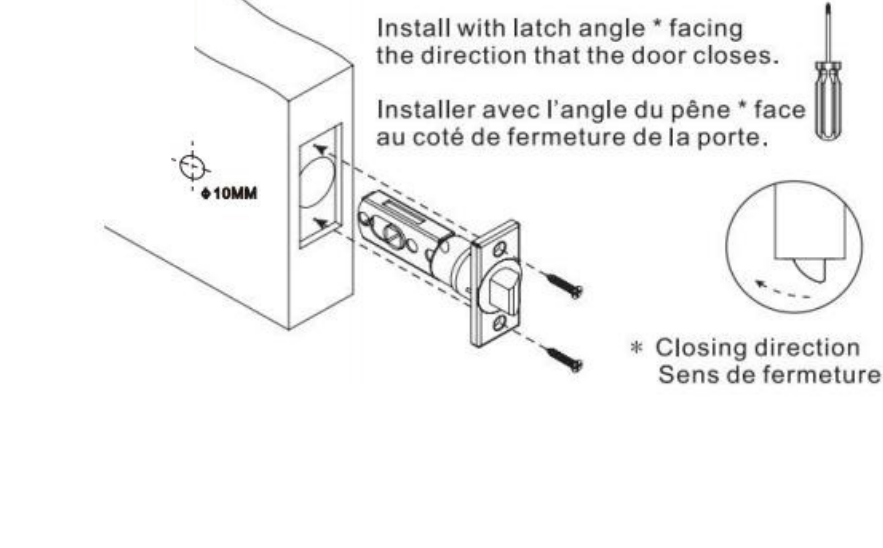

FIG 3B



- 6 -

FIG 3C



* Closing direction
Sens de fermeture

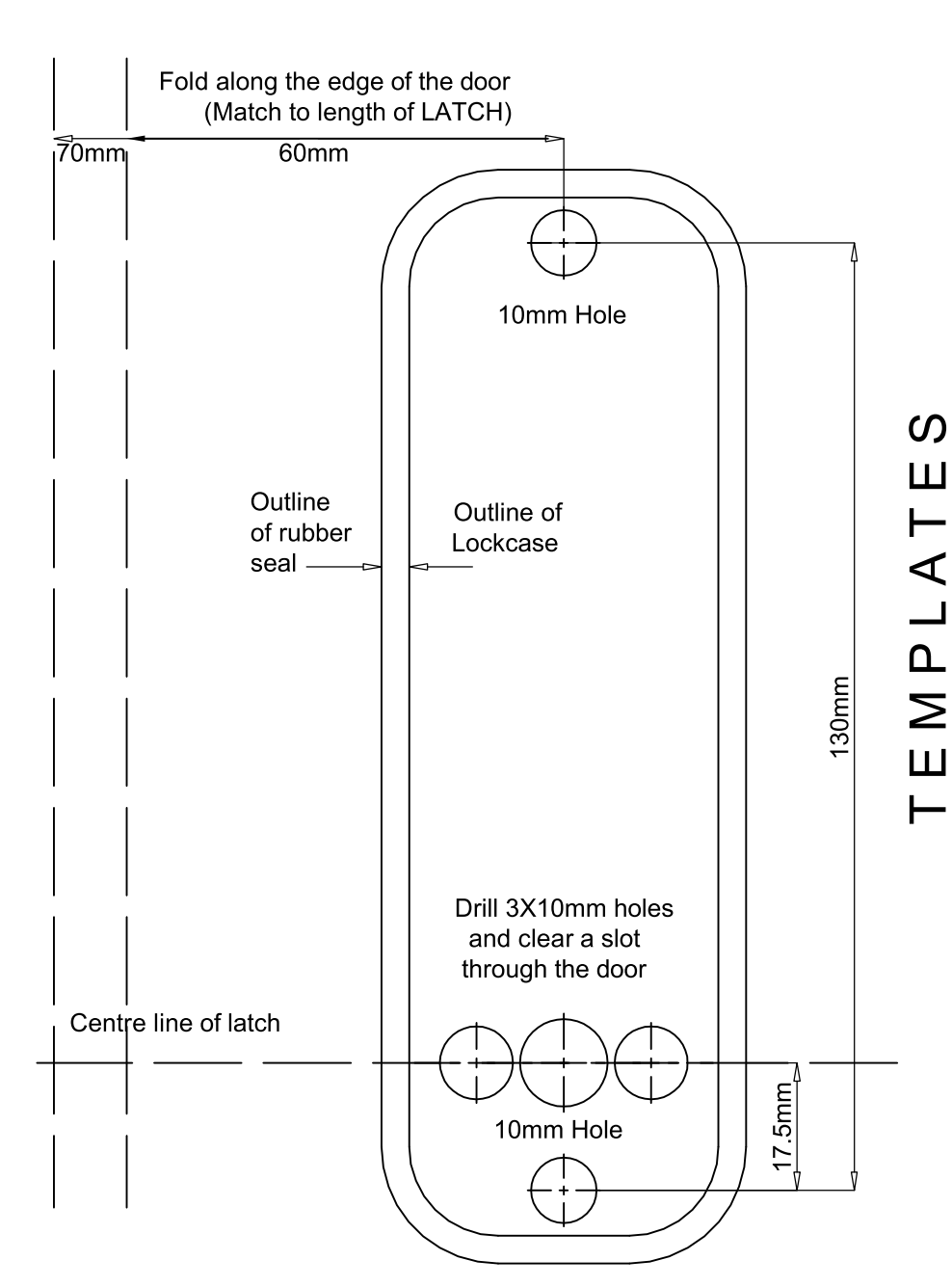

- 8 -

Adjustment handle

- 1) After opening the package, the handle is above the lock body. When adjusting the direction of the handle, it is necessary to confirm the direction of the handle first (left/right open).
- 2) Loosen the bolt of the lock body with a Phillips screwdriver (FIG. 4A) and leave the handle from the lock body.
- 3) Adjust the handle to the desired direction of the door (left/right open) (FIG. 4B/C) and then lock the bolts.
- 4) Insert the lanyards into the lanyards hole and turn the stem so that the triangular arrow on the lanyards sleeve faces the handle.

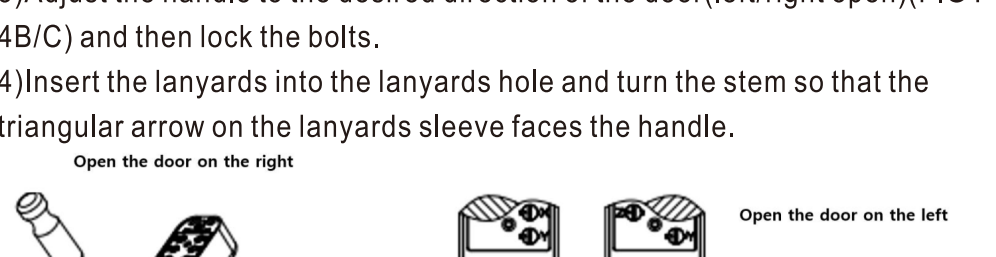

FIG 4A

FIG 4B

FIG 4C

Square bar positioning

- 1) Please screw the hollow stud into the screw holes of the front panel of the door lock. (FIG 5A)
- 2) According to the thickness of the door, please choose the corresponding size of the drive shaft and mounting screws.
- 3) Bar size default (8X8MM) design, suitable for door thickness of 35 to 65 mm. Therefore, if necessary, cut the square bar to fit the thickness of the door.
- 4) Insert one end of the bar with spring into the square hole of the lock body and insert the other end into the square hole corresponding to the handle of the rear door body. Fixed to see FIG 5B

Important note: Do not close the door until you have confirmed that the password and lock are working properly.

- 9 -

- 5) If necessary, shorten the bolts according to the thickness of the door.
- 6) When shortening the bolts, allow at least 4/5 threads to screw into the lock box.
- 7) Locate the rubber seal behind the mechanical combination lock, and secure the lock at the neck and bottom with fixing bolts.
- 8) Before final pressing, make sure the door is vertical and test the lockpick function to make sure it is free to move.
- 9) Do not overtighten the locks and seals to avoid damaging the operation of the mechanism.

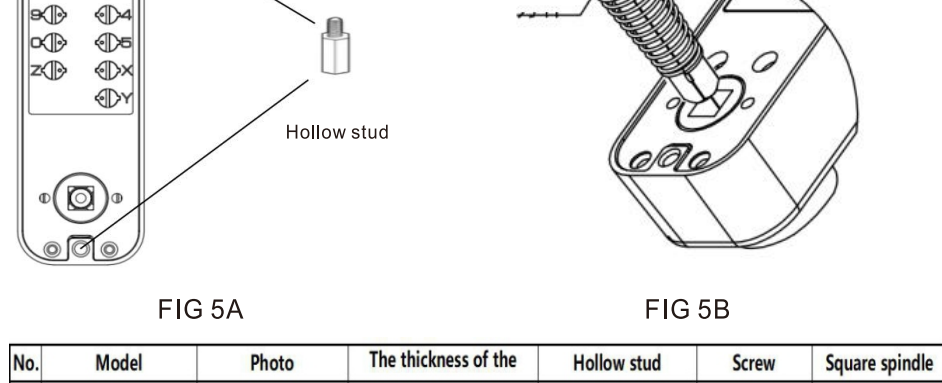

FIG 5A

FIG 5B

No.	Model	Photo	The thickness of the	Hollow stud	Screw	Square spindle
1	OL-209D2-BY-B-01		35mm-42mm	(M5xM4x40mm) x 2	M4x40 x 2	55mm x 1
			43mm-50mm			63mm x 1
			51mm-58mm		M4x50 x 2	71mm x 1
			59mm-66mm			79mm x 1
2	OL-209S2-BY-C-01		35mm-42mm	(M5xM4x40mm) x 2	M4x40 x 2	55mm x 1
			43mm-50mm			63mm x 1
			51mm-58mm		M4x50 x 2	71mm x 1
			59mm-66mm			79mm x 1

- 10 -

Doorframe striker plate, box fixed

- 1) Important note: The striker plate must be positioned so that the lock lanyards can enter the hole. The safety bolt of the lock lanyards should not enter the striker plate hole.
- 2) In consideration of the above factors, properly place the door frame striker plate.
- 3) Once the correct location has been determined, mark around the striker plate and the two holes.
- 4) Remove the hole. The striker plate align the second hole of the box with the marked two holes, mark around the box and remove the box.
- 5) Along the open and box size square hole, about 24.6MM deep (FIG 6B). can easily put down the box. The front striker plate is flush in the door frame with a 3MM deep square hole (FIG 6C).

FIG 6A

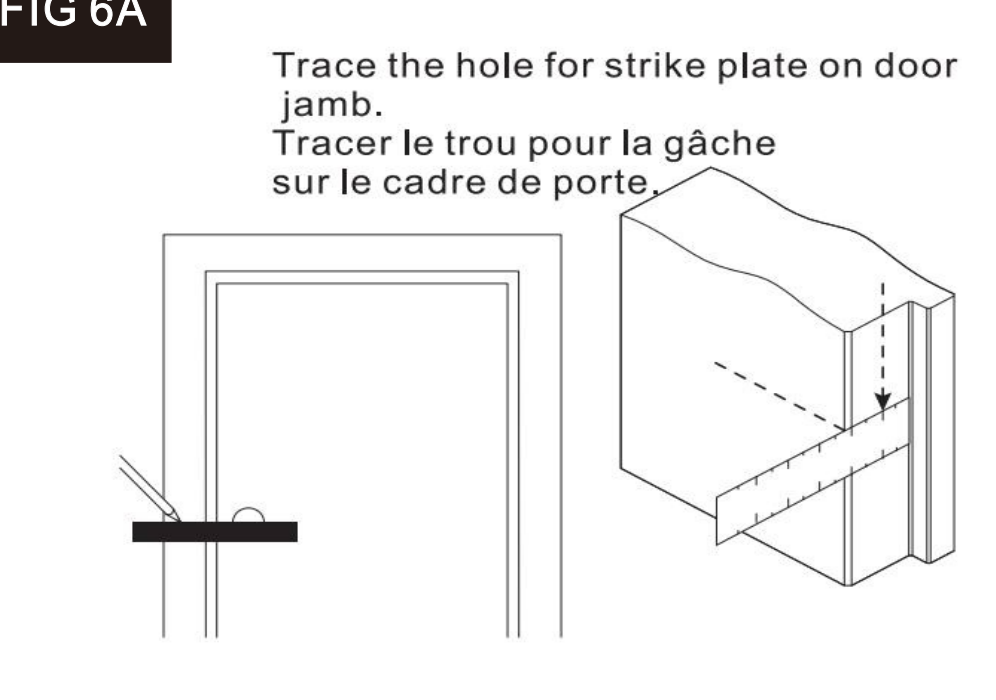

- 11 -

FIG 6B

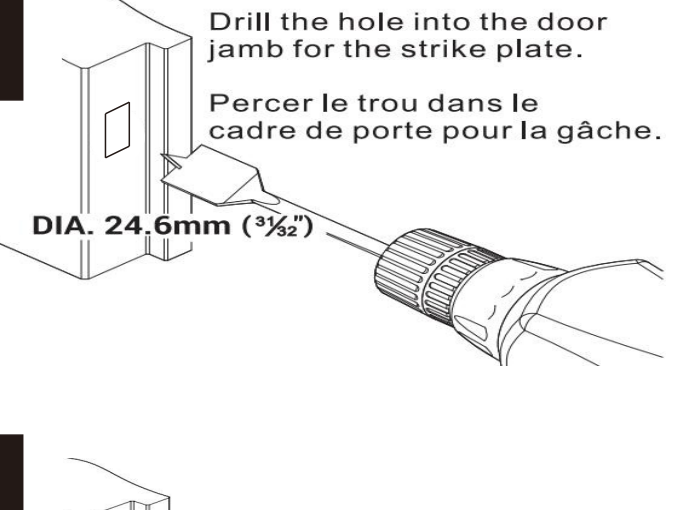

FIG 6C

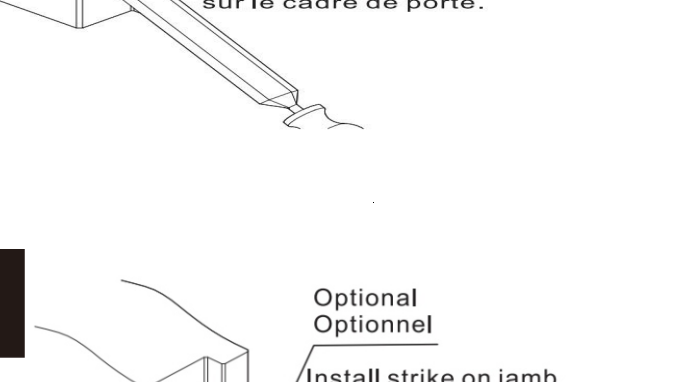
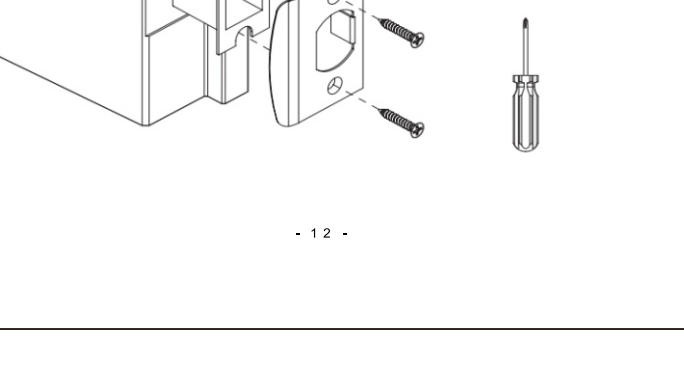

FIG 6D



- 12 -

- Normally open mode setting and cancellation

Firstly, please hold down the handle and Y key, then enter the correct password. When finished entering, please release the handle first and release the Y key, then the normally open mode setting is completed.

When need to cancel the normally open mode, hold down the C key and press the handle, then cancellation of normally open mode is completed.

MADE IN CHINA