



TOTALLY wicked®



TORNADO GTL

USER MANUAL



YOUR TORNADO GTL KIT

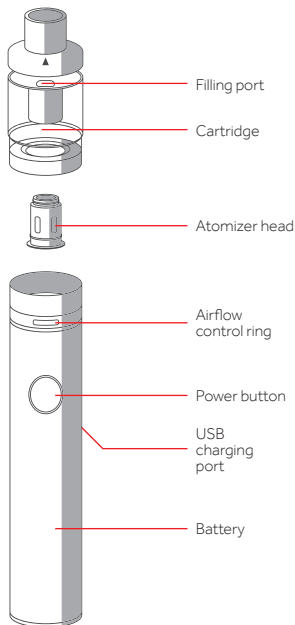

PRIME THE ATOMIZER HEAD

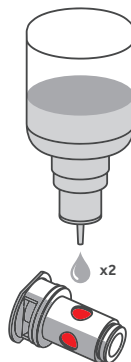

Wait 5 minutes before vaping a new atomizer head.





**INSERT THE
ATOMIZER HEAD**

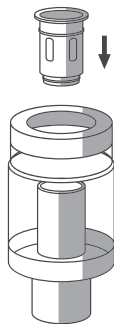

**FILL THE
CARTRIDGE**

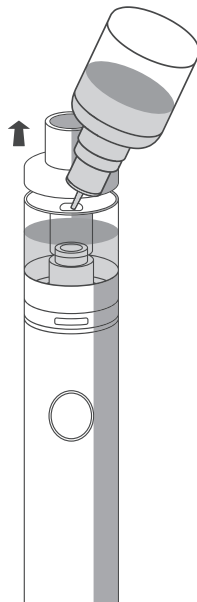

4



TORNADO GTL

5



TURN POWER ON

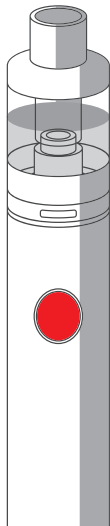

x5

On/Off

VAPE

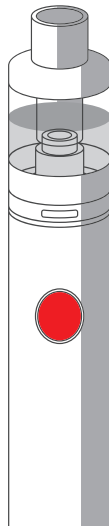

Press and hold to vape.
Or simply inhale on the
mouthpiece to activate.





ADJUST AIRFLOW

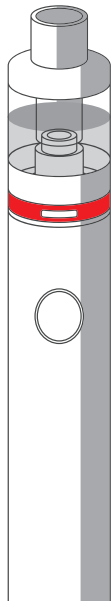

SET POWER LEVEL

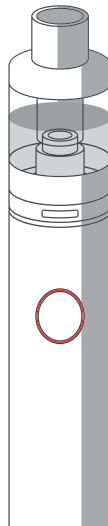

- high
- medium
- low



x3



To set power level



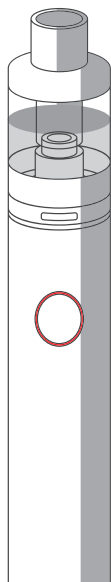

BATTERY LIFE



-  100% - 60%
-  59% - 20%
-  19% - 0%

CHARGE THE BATTERY

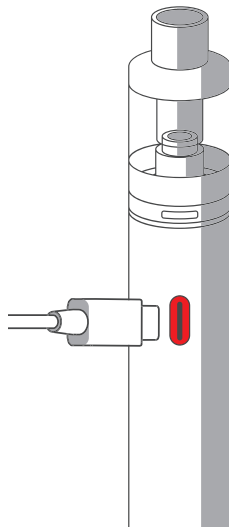



USING YOUR TORNADO GTL

PRIMING THE ATOMIZER HEAD

It is important to "prime" a new atomizer head before first use. Failure to do so can damage the atomizer head.

Remove the cartridge from the battery by pulling upwards. Prime one of the atomizer heads for the kit by dripping a few drops of e-liquid onto the cotton inlets on the side of the atomizer head. Insert the atomizer head into the cartridge by pushing and reattach the cartridge to the battery.

ATOMIZER HEAD LIFESPAN

Atomizer heads do not last forever and need to be replaced periodically. Lifespan is generally from a few days to several weeks, depending on power used, vaping style, flavour and type of e-liquid. A slight burnt taste, general loss of vapour production, or a reduction in flavour intensity can all be indicators that the atomizer head requires replacement.

FILLING THE CARTRIDGE

Slide the top of the cartridge in the direction indicated by the arrow on the top-cap. Fill the cartridge, ensuring an air gap of approximately 2mm is left over the e-liquid, to avoid air-locks. Slide back over the cartridge to close. On first filling with a new atomizer head, wait 5

minutes for the atomizer head to fully prime before using.

SWITCHING ON AND OFF

To switch the Tornado GTL on or off, quickly press the power button five times. The indicator light will flash three times when switched on or off.

VAPING

Press and hold the power button as you gently inhale the vapour, release the power button when you have finished inhaling. The indicator light will illuminate while the power button is held down. The Tornado GTL also has a vacuum activated switch. Simply switch the device on and inhale on the mouthpiece for automatic operation.

Please note: Due to the sensitivity of the automatic switch, the vacuum activated mode will only work with certain airflow settings. If this mode is not working, try adjusting the airflow to a less "open" setting.

ADJUSTING AIRFLOW

If you find airflow too airy or too tight, rotate the airflow adjuster to expose fewer or more holes of different sizes. Experiment to find your preference.





USING YOUR TORNADO GTL

CHANGING OUTPUT MODES

The Tornado GTL has 3 power settings – Red = Low, Blue = Medium, Green = High. The LED surrounding the button indicates these settings. It only shows power setting while adjusting the power, and not in normal operation, when the LED colour indicates battery charge. To step through these settings, with the device switched on, press the power button three times in quick succession. The LED will stay illuminated for a couple of seconds, indicating the current power setting.

E-LIQUID LEVEL

To prevent the atomizer head from becoming dry and burning prematurely, ensure remaining e-liquid never drops below the 4 fluid feed holes around the bottom of the atomizer head.

BATTERY LIFE INDICATION

The battery indication for the Tornado GTL kit is measured in three phases, 100-60% (Green LED), 59-20% (Blue LED), <20% (Red LED). The LED colour will indicate the current battery level when the power button is pressed for normal operation, and in automatic operation.

CHARGING THE BATTERY

Insert the supplied USB-C cable into the Tornado GTL charge port, connect the other end of the charge cable to a USB port or suitable wall adaptor. The indicator light will flash the LED at the current battery level, when fully charged, the indicator light will switch off. The Tornado GTL can be used whilst charging.

REPLACING THE ATOMIZER HEAD

To replace the atomizer head in the Tornado GTL, remove the cartridge from the device by pulling straight up, invert the cartridge 180 degrees and remove the atomizer head by pulling. If the cartridge is full, or nearly full of e-liquid, there will be some leakage from the mouthpiece, so it is best to do this over a piece of tissue paper. Prime a new atomizer head and insert into the cartridge by pushing.

Note: Leave a new atomizer head to sit in a cartridge full of e-liquid for five minutes before vaping. This ensures the atomizer head is fully saturated with e-liquid before use.





PROTECTIONS

ATOMIZER HEAD PROTECTION

If the power button is held down for longer than 10 seconds while vaping, the indicator light will flash 5 times and the Tornado GTL will refuse to power or produce any vapour. Releasing the power button allows normal operation to resume.

LOW VOLTAGE PROTECTION

If battery voltage drops to 3.3 volts, the indicator light will flash 20 times and the Tornado GTL will switch off. Charge the Tornado GTL using the procedure outlined in *Charging the Battery* to allow normal operation to resume.

SHORT CIRCUIT PROTECTION

If an atomizer short circuit occurs, the indicator light will flash 5 times and the Tornado GTL will switch off. Replace the atomizer head by following the steps outlined in *Replacing the Atomizer Head*.

CLEANING AND MAINTENANCE

The Tornado GTL battery and cartridge connection can be cleaned by wiping down with tissue or a dry cloth. The cartridge can be cleaned by removing it from the battery and removing the atomizer head from the cartridge; the entire cartridge and cartridge base can be cleaned under warm running water. Allow the cartridge to dry fully before refitting the atomizer head. Reassemble the cartridge. Wipe the connector and area under the cartridge dry regularly to ensure reliable operation.

Note: To prevent damaging the atomizer head, do not allow it to come into contact with water. Do not submerge the Tornado GTL battery unit in water or allow it to get wet.





KIT CONTENTS

1 x Tornado GTL battery
1 x Tornado GTL cartridge
2 x GTL 1.2 ohm atomizer heads
1 x USB-C cable
1 x User manual
1 x Spare parts

SPECIFICATIONS

Dimensions: 20mm (diameter)
131mm (length)
Battery: 1500mAh Integrated Battery
Max Charging Current: 2.0A
Cartridge Capacity: 2.0 ml
Atomizer Head Type: GTL
Resistance Range: 0.4 - 3.0ohm
Maximum Filling Nozzle Diameter: 3.0mm

ADDITIONAL PRODUCT INFORMATION

There are no reported medical side effects with this product. If you believe you experience a side effect, please contact the manufacturer.

PRODUCT STORAGE AND BATTERY PRECAUTIONS

- Store the Tornado GTL kit and its accessories away from children when not in use.
- Ensure the Tornado GTL kit is powered off when not in use.
- Avoid accidentally pressing the Tornado GTL power button when not in use.
- Please only use the charging cable provided.
- Please dispose of dead batteries in accordance with your country's appropriate legislation.
- Do not charge the batteries in a damp environment.
- Do not use the device when temperatures are outside the range of -10°C - 60°C.
- Do not charge the battery when temperatures are outside the range of 0°C - 45°C.
- Do not attempt to repair a faulty Tornado GTL as these are sealed units with no serviceable parts. Attempted repairs will void the warranty.





WARRANTY

The Tornado GTL kit components have a 6 months parts warranty, with the exception of atomizer heads, which are consumable items and covered by "dead on arrival" warranty only. The USB cable supplied has a 12-month warranty. If any parts are found to be faulty within this time please contact our customer service team, whose details are on the back page of this booklet and we will arrange for a replacement. We may require the goods to be returned for further investigation.

WARNING

This product contains magnets. If you have an ICD or pacemaker, avoid close or prolonged contact with pods that are not fitted into the battery, and keep the assembled device at least 15cm from where your device is implanted.





TO^TaLLY wicked[®]

Manufactured in China under the authority of
Pillbox38 (UK) Ltd, Stancliffe Street,
Blackburn, Lancashire, BB2 2QR.
Tel: 01254 692244
www.totallywicked.co.uk



**UK
CA**

