

ORION-W

MANUAL



Read this manual carefully before using and keep for future reference. Visit www.moon-sport.com for manual updates.

CONTENTS

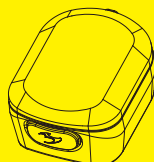

ORION-W



RB-29-W
(MAGNETIC MOUNT)

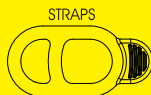

STRAPS
RS-G
20-35 mm



RS-H
35-52 mm

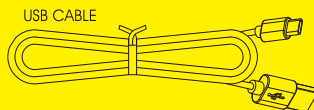

USB CABLE

OPERATION

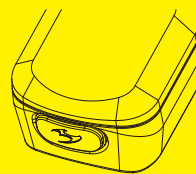

ON / OFF : Press 1s

MODE SELECT : Click

* Mode memory: The light resumes previous mode upon next usage.

RUNTIME

ANSI FL1	MODE1	MODE2	FLASH 1	FLASH 2	DAY FLASH
LUMEN	20	40	20	40	100
H:MIN	6:30	3:00	64:00	31:30	36:30

MOUNTING

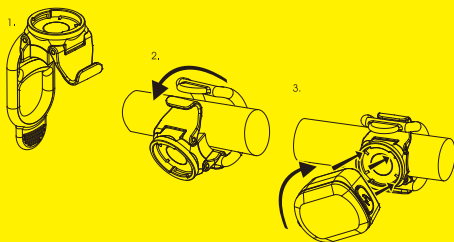

AUTO SAFE MODE



To preserve battery when power is low, the light will enter safe mode with less light output for extra **3 hours**.

Safe mode cannot be override.

Recharge battery for maximum performance.

CHARGING

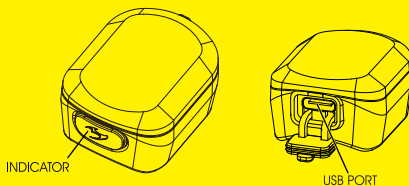

CHARGING

1. Power off
2. Plug USB cable to USB port
3. Unplug after fully charged

* Do not charge over 5V.

* Keep away from flammable objects while charging.

INDICATOR

Low battery

Auto safe

Charging

Fully Charged

WARNING

Understand country lighting laws and regulations before use.
Do not shine light directly into eyes.
Do not mount near wireless computer.
Do not blind the oncoming vehicles. Always adjust the angle downward.
Do not submerge the light into water.
Keep light in cool and dry place when storing.
Fully recharge the light at least every 3 months during storage.

WARRANTY

MOON Lights are covered by a **2-year LIMITED WARRANTY**, while MOON batteries are covered by a **180-day warranty**, both starting from the date of purchase.

This warranty covers defects or malfunctions arising from manufacturing or design flaws in the product. It does not cover normal wear and tear, non-rechargeable batteries, and damage caused by improper installation, misuse, mishandling, accidental loss, abuse, accidents, or negligence.

MOON may require the return of any product submitted for warranty consideration. Customers should contact their authorized local dealer or authorized regional distributor for warranty service.

For more information, please contact cs@moon-sport.com.

ONLINE WARRANTY REGISTRATION

Please visit www.moon-sport.com for online warranty registration.