

INSTRUCTION MANUAL

Door/Window Sensor E3

You will need Nous Smart Home App. Scan the QR code or download it from [direct link](#)



Know about the Contact Sensor

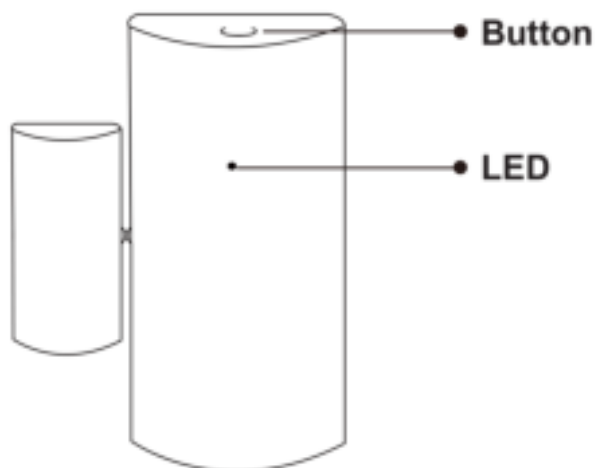

Button

Reset or enter configuration mode: Press and hold the button for 5 seconds until the blue LED blinks, the device will enter configuration mode

LED

Blinking: The device enters Zigbee network configuration mode(preparing to connect the gateway)

OFF: The device is under standby status

Quick Installation Guide

Note: Please make sure the gateway is added and on-line before the next step

- (If you have installed the NOUS Smart Home on your mobile phone,please go to step 2) Scan QR code or search NOUS Smart Home in APP Store or Google Play to install APP(new user must register account first).
- Open NOUS Smart Home app, on smart gateway homepage, Click: Zigbee Smart Gateway

1

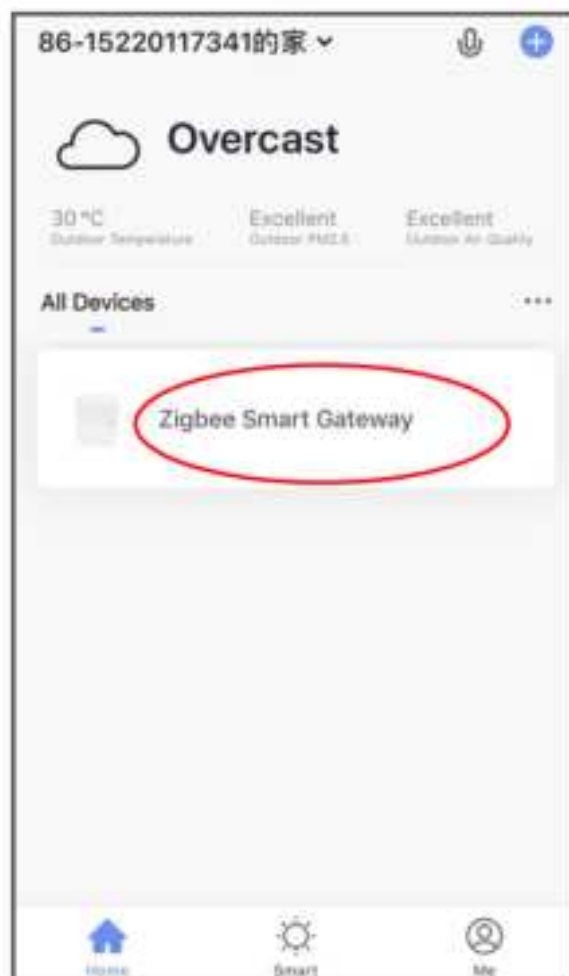

2 Click "+Add subdevice"

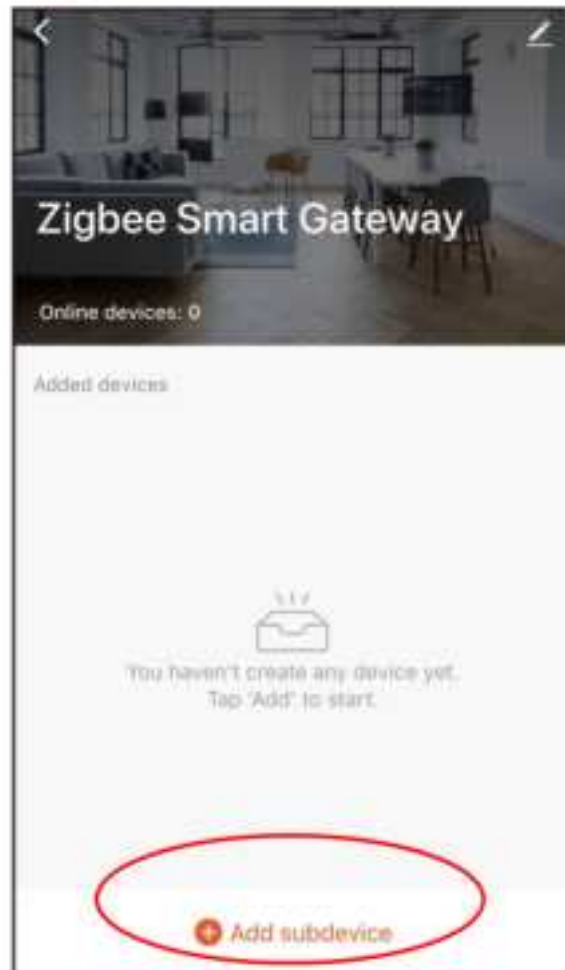

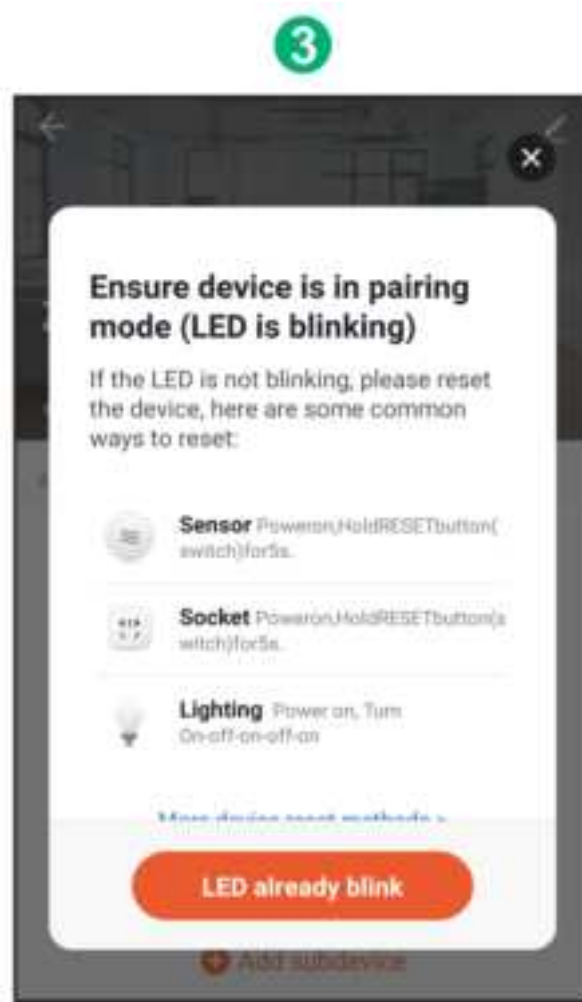

- Remove the insulation sheet and press the reset button for 5 seconds, till the blue LED blink, then click "LED already blink" on the app.

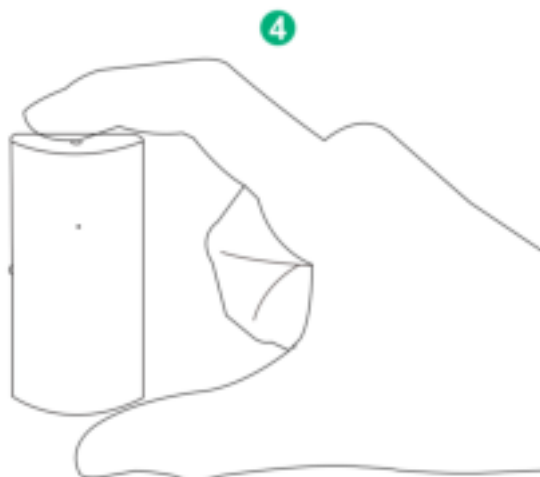

- Waiting for a few seconds, you can see the this device is shown and you may rename it.

5



- Put it where you need it.
The alignment marks must be close together as possible.
Must be $\leq 15\text{mm}$

