

User Guide

kogan
.com

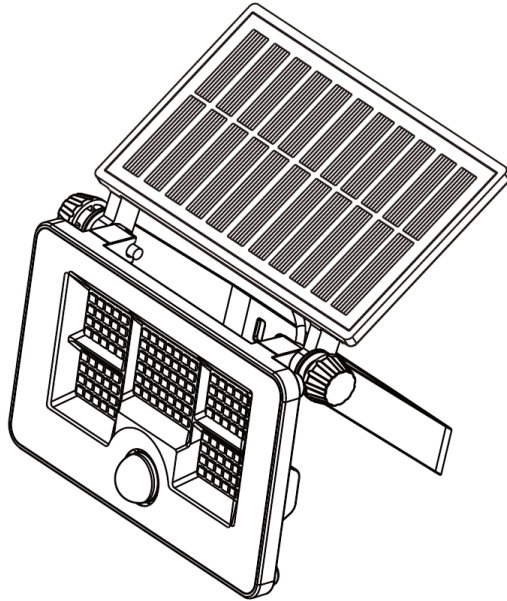

Solar Motion Security Light

(2 Pack)

NBSLMSECLTA

Safety & Warnings

- Install the light at a height of 1.8m to 3m (6ft to 10ft) to ensure optimal motion detection within its 120° sensor range.
- Do not install the solar panel in shaded areas such as under trees, eaves, or other obstructions that may block sunlight.
- Avoid placing the light where artificial light sources may shine directly on the solar panel, as this can cause flickering or prevent the light from turning on.
- Fully charge the product before first use by placing the solar panel in direct sunlight for at least 8 hours. Charging time may be longer on cloudy or winter days.
- Alternatively, the light can be charged via the USB-C port during days without sufficient sunlight.
- Keep the product away from fire and heat sources to prevent damage or hazards.

Components

When you open the package, it should contain the following items listed below. Confirm everything is present before proceeding with installation. If there is anything missing, contact help.Kogan.com for support.

Part	Single Pack (qty)	2 Pack (qty)	4 pack (qty)
Light	1	x2	x4
Fastener Bag	1	x2	x4
Cable Tie	1	x2	x4
User Guide	1	1	1

Overview

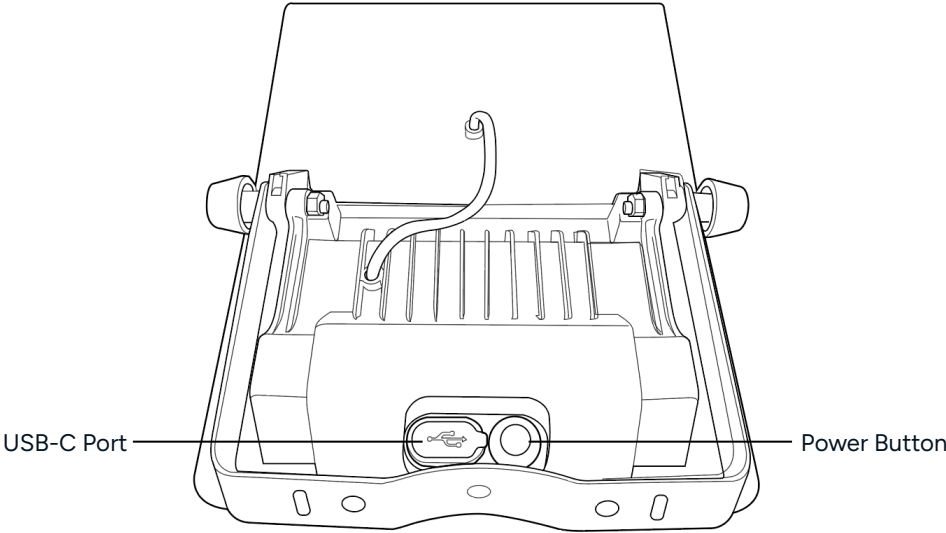

Installation

The solar panel, lamp body and bracket can all rotate 180° making it suitable for several different installation locations (walls, fences light poles, columns, etc.)

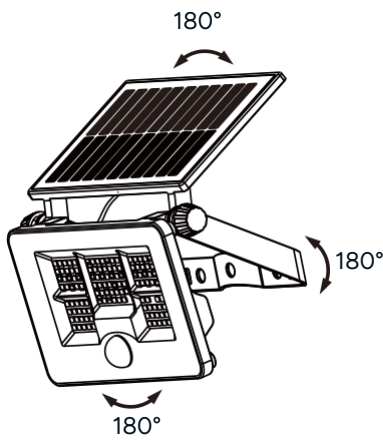

Wall Mounting

1. Select a suitable mounting location for the solar light.
2. Using the bracket as a template, mark the position for the holes. Use a drill to drill the marked locations for the mounting hardware.
3. For concrete and masonry, insert the supplied wall anchors into the holes.

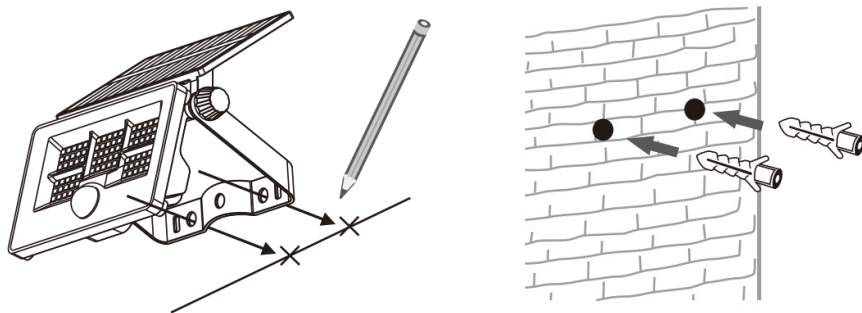

Note:

If you are unsure as to what hardware is required for your chosen surface, consult a licensed trade professional.

4. Attach the bracket to the wall using the supplied screws.
5. Press the power button once to turn the solar light on.

Note:

Ensure that the product is fully charged for at least 8 hours before use.

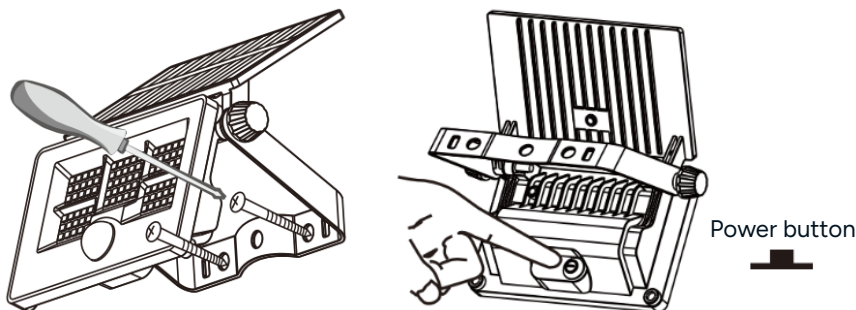

Post Mounting

1. Feed the supplied cable tie through the holes in the mounting bracket.
2. Adjust the solar light to the desired installation height.

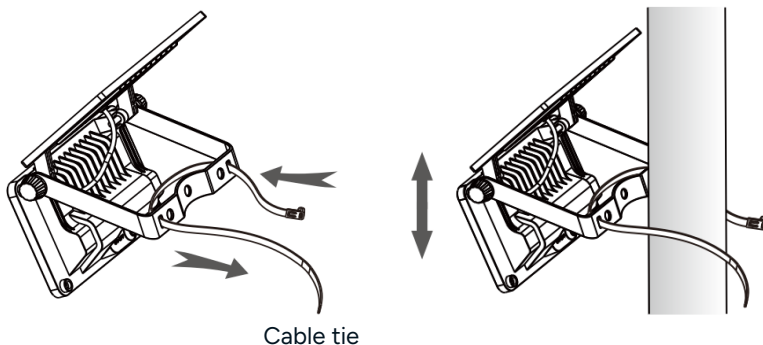

3. Use the cable tie to secure the solar light to the post. Ensure the solar light is firmly in place, tighten the cable tie if required.
4. Press the power button once to turn the solar light on.

Note:

Ensure that the product is fully charged for at least 8 hours before use.

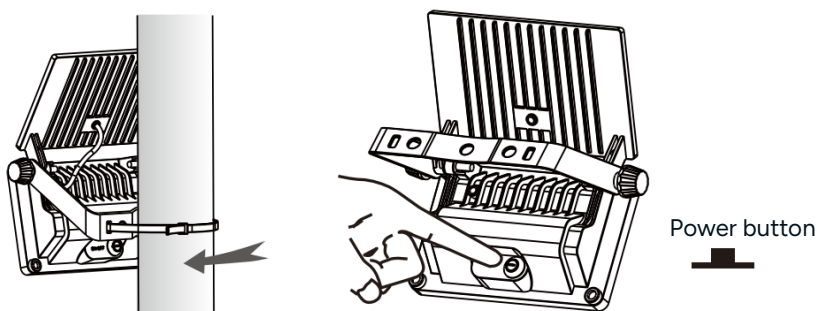

Tips:

- Install the light in a location where the solar panel receives maximum direct sunlight throughout the day.
- Press the silicone power button to turn the light on. Once activated, it will automatically charge during the day and operate at night based on the selected lighting mode.

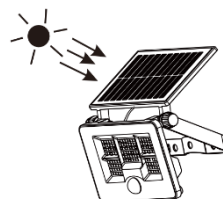

Lighting Modes

Press the power button on the rear of the lamp to cycle between the available lighting modes (mode 1, mode 2, mode 3, mode 4 & off):

- **Mode 1 – Dim Light Mode (default):**
 - Press the power button once to activate this mode.
 - The light remains on at 30% brightness continuously.
- **Mode 2 – High Brightness Mode:**
 - Press the power button twice to activate this mode.
 - The light remains on at 100% brightness continuously.
- **Mode 3 – Motion Sensor Mode:**
 - Press the power button three times to activate this mode.
 - The light stays off and turns on at 100% brightness when motion is detected.
 - The light automatically turns off after 20 seconds of no movement.
- **Mode 4 – SOS Mode:**
 - Press the power button four times to activate this mode.
 - The light will flash in an SOS pattern for emergency signalling.
- **Off:** Press the power button a fifth time to turn the solar light off.

Motion Sensor Placement

- For optimal motion detection, install the light at a height between 1.8m and 3m (6ft to 10ft).
- The motion sensor has a 120° detection range and will activate the light when movement is detected within this area.

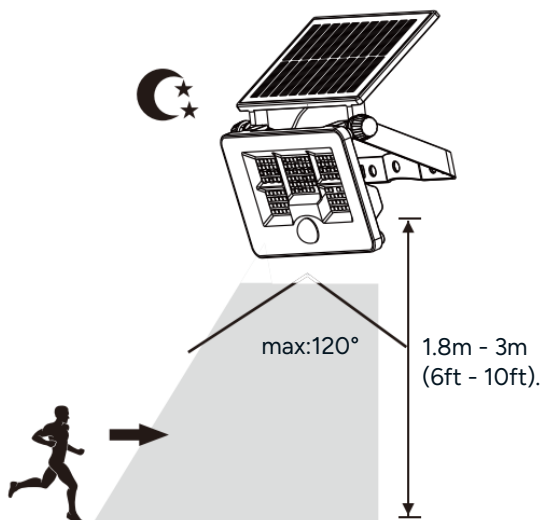

Specifications

Number of LEDs	122
Colour Temperature	6500 Kelvin
Battery Capacity	2200mAH
Working Temperature Range	-20°C~65°C
Material	ABS+PC

Need more information?

We hope that this user guide has given you the assistance needed for a simple set-up.

For the most up-to-date guide for your product, as well as any additional assistance you may require, head online to **help.Kogan.com**.

