



Hookswitch Tab Installation Guide for SIP-T29_T27_T4X IP Phones

The IP phone is packaged with the hookswitch tab in desk mount position. Before mounting the IP phone to a wall, you must set the hookswitch tab to wall mount position.

To adjust the hookswitch tab:

1. Pull the hookswitch tab in the handset cradle.
2. Rotate the hookswitch tab 180 degrees.
3. Reinsert the hookswitch tab.

Adjust the hookswitch tab as shown below (Take a SIP-T46G IP phone as an example):

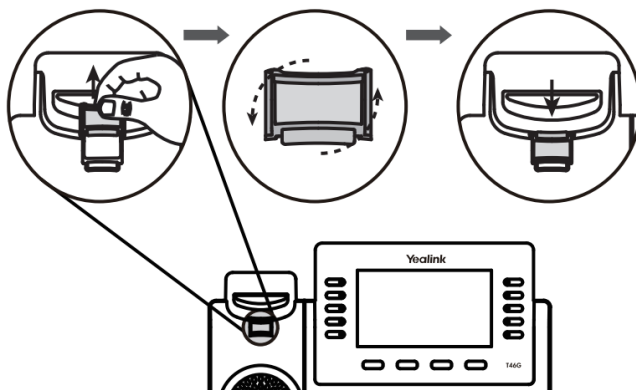

The hookswitch tab has a lip which allows the handset to stay on-hook when the IP phone is mounted vertically.