

Fanttik

CB APEX Dash Cam

User Manual

Read this manual carefully before use
and keep it for future reference.



Contents

1. SPECIFICATIONS ----- 01

2. PACKAGE CONTENTS ----- 01

3. PRODUCT OVERVIEW ----- 02

4. LED INDICATOR INSTRUCTION ----- 02

5. SPECIFICATION ----- 03

6. INSTALLATION ----- 04

7. APP PROGRAM INSTRUCTIONS ----- 08

8. FUNCTION INTRODUCTION ----- 12

1 SPECIFICATIONS

Product Name: Dash Cam

Product Model: C8 APEX (64G) / C8 APEX GT (128G)

Size: 106*37*26mm

Storage: Built-in eMMC high speed flash, loop recording

Operating Temperature: -20°C-70°C (-4°F-158°F)

2 PACKAGE CONTENTS

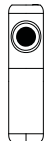

Dash Cam*1



Bracket*1



Power Cable 3.5m *1



Installation Tool*1



3M Adhesive*2



Electrostatic Sticker *2



User Guide



USB Charger
(5V2.4A) *1

3 PRODUCT OVERVIEW

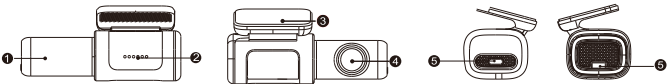

- 1.Working Indicator
2.MIC (Second on the left)
3.Bracket
4.Lens
5.Type-C Interface
6.Button

4 LED INDICATOR INSTRUCTION

Name	Description	Name	Description
Work Indicator	Normal recording: Blue light is always on.	Button	It does not support power on or off.
	Parking monitoring: Red light is always on		Turn on/off recording: Click the button to turn on/off recording.
	Upgrading: Red light flashes quickly		Reset: Long press 6s to reset
	Collision/Taking pictures by voice: Purple light flashes quickly.		
	USB data transmission mode: Green light is always on.		
	Storage error: Green light flashes quickly.		

5 SPECIFICATION

CPU	RV1126 Quad A7
Sensor	SONY IMX415
Resolution	4K 3840*2160 @30fps / 2K 2880*1600 @30fps / 1920*1080 @90fps
Video Compression	H.265
Wide View	140°
Aperture	F1.8
WiFi	5G
GPS	Support
Recording	Support
Voice command	Support

ADAS	Support
SR	Support
G-sensor	Six axis
Memory	eMMC 64G/128G
Working Voltage	5V
Working Current	2A
Capacitor	2.5F, 5V
Operating Temperature	(-20°C~70°C)(-4°F~158°F)
Storage Temperature	(-40°C~85°C)(-40°F~185°F)
Size	106*37*26MM

6 INSTALLATION

There are two ways to connect and install the recorder:

1. Charge via cigarette lighter:

Insert the car charger into the cigarette lighter and connect the car charger and recorder through the power cord (3.5 meters). Most of the power cord will be embedded in the automobile plastic shield, a small part of it will be exposed in the car, the wiring operation could be simple and easy.

2. Connecting the Hardwire kit cable to the fuse box to get electricity through the step-down wire: using the dark wire can ensure the neatness and appearance of the car. This wiring and electricity installation method can realize the function of parking monitoring. The wiring operation is relatively complicated. In order to avoid vehicle damage caused by misoperation, please complete the installation at a professional car service point.

Note: The Hardwire kit needs to be purchased separately or a package that includes the hard wire kit cable.

The following describes the installation operation of the cigarette lighter.

1. Wipe the front windshield clean

Wipe the front windshield with a clean, soft cloth to ensure the brackets are securely attached.

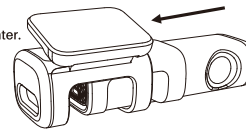

2. Insert the recorder into the bracket and fix it

Take out the recorder and bracket, insert the recorder into the bracket sleeve, there is a magnet inside the bottom of the bracket, which can attract the recorder to fix it.

3. Turn on the power

①. After inserting the standard single-port car charger into the cigarette lighter, use the standard Type-C power cable to connect the single-port car charger and the recorder.

②. After the car is started, the recorder is powered on and automatically starts up, and a start-up prompt sound (Hello, Fanttik) is issued, and the recorder starts recording at this time.

4. Determine the installation position of the recorder and adjust the lens angle

①. Refer to the mobile phone FanttikCam App to connect the recorder . After connecting the FanttikCam App with the recorder , enter the FanttikCam App, select "Device > Enter the Recorder", enter the "Now/Back" interface, and the level will be displayed on the screen. midline and vertical midline .

②. Place the recorder in the middle of the front windshield, so that the bottom of the bracket is attached to the front windshield, the lens is facing outward, and the power interface is facing right . The centerline of the front of the car is at the vertical centerline position, then move the recorder up and down and move the bracket up and down to ensure that the disappearing line of the ground plane is at the horizontal centerline position of the screen.

Notice:

Please refer to the horizontal center line and vertical center line to determine the position of the recorder, otherwise some functions of the recorder will be affected.



5. Fixed recorder

- ①. After determining the installation position of the recorder, stick the electrostatic sticker on the installation position.
- ②. Tear off the 3M adhesive film on the bracket, and stick the bracket to the center of the electrostatic sticker through 3M adhesive.

Note: Please pay attention to the direction and position when pasting. 3M adhesive is a one-time item, please make sure that the recorder is installed at the correct shooting angle.

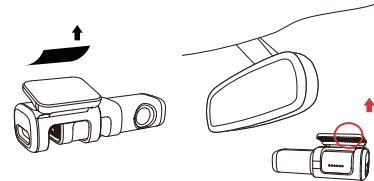

6. Wiring

Route the power cord from the cigarette lighter to the fixed position of the recorder as shown in the wiring diagram below. Use the included spudger to snap the power cord into the plastic car cover.

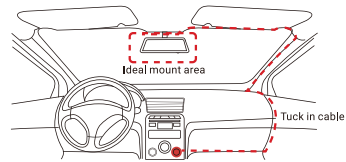

7 APP PROGRAM INSTRUCTIONS

Install FanttikCam APP

Scan the QR code below or download the "FanttikCam" app through the iOS/Android APP market .



iOS



Android

Pair Smart Phone to Dash Cam

Scan the QR code below or download the "FanttikCam" app through the iOS/Android APP market .

1. Keep the Dash Cam and mobile phone within 2.5 meters.
2. Launch FanttikCam App, tap on "Device > Connect new devices".
3. Choose your Fanttik Dash Cam from the network list (For Android system, App will start to search Dash Cam network automatically. For iOS phone: turn on WLAN from "Settings -> WLAN"). The Dash Cam's default SSID (or Wi-Fi name) is "WIFI_Fanttik_C8_Apex_XXXX" / "WIFI_Fanttik_C8_Apex_GT_XXXX".

4. Enter the password (the default password is '1234567890').
5. Enter FanttikCam, wait a few seconds until the preview screen show.
6. The WIFI name and password can be changed.If you forget the password after modifying the Wi-Fi password of the recorder , press and hold the button on the side of the host for about 6 seconds to restore the factory settings. The factory password is 1234567890.

Preview

1. Open the FanttikCam App, and add your Dash Cam.
2. Select "Device > Entering" tab, this will bring you to the preview page.
3. Rotate your smart phone or press expand  icon, turn the preview screen to landscape mode.
4. Click and drag the time line left and right at the bottom of the screen to create a preview of your desired recording starting point, then click on the thumbnail selection, or wait 5 seconds for buffering. you can watch the history.

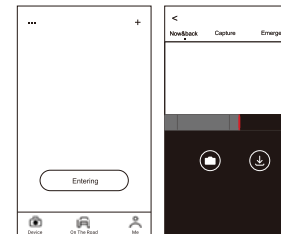

Download VideoFiles

1. Tap and left/right drag time line bar at the screen bottom to create the starting point of the recording you wish to download, then tap on thumbnail when you have made your selection, or wait for 5 sec for buffering, to enter the download start screen.
2. Tap on from preview screen to enter the download interface.
3. After the video has finished downloading, click "Complete".
4. You can choose to open SR to download videos, which are more informative.
5. The recorder supports downloading video clips with a minimum of 5 seconds and a maximum of 3 minutes.
6. The downloaded video will be saved in the local album of the Fanttik App, and will be synchronously saved in the local photo album of the mobile phone. You can enter the "Video" interface of "Me > Local Album" of the Fanttik App or enter the mobile phone View or delete from the local album .

Edit and Share Photos

1. Enter the FanttikCam App, click "Me > Local Albums", enter the "Local Albums" page, select the photos you want to edit and share, and click "Share" at the bottom of the interface.
2. Enter the editing interface, "Filter", "Cut", "Subtitle" are displayed at the bottom of the interface, you can add filters, subtitles, and crop the screen.
3. After completing the above editing, click "Done" in the upper right corner of the interface to enter the sharing interface.

You can choose any social media platform to share the edited photo to Facebook, Twitter, Tiktok and other platforms.

Edit and Share Videos

1. Enter the FanttikCam App, click 'Me > Local Albums', enter the 'Local Albums' page, select the photos you want to edit and share, and click 'Share' at the bottom of the interface.
2. Enter the editing interface, the bottom of the interface displays 'Crop', 'SR Style', 'Soundtrack', you can cut, soundtrack, and overlay SR effects on the video.

① After clicking 'Crop', you can cut the desired video clip by dragging the white borders on both sides left and right. The video can be intercepted with a maximum of 30 seconds and a minimum of 5 seconds.

② After clicking 'SR Style', there are two SR styles at the bottom of the interface to choose from, you can choose according to your preference; if you choose 'None', there will be no SR effect in the video.

Note: If you select any SR style and check 'Set as default SR' at the bottom of the interface, all subsequent videos will default to the current SR style.

③ After clicking 'Soundtrack', a variety of soundtracks will be displayed at the bottom of the interface, and you can choose according to your own preferences.

3. After completing the above editing, check 'Original Quality' at the bottom of the screen, and then click 'Confirm' in the upper right corner of the interface.

Note: If 'Original Quality' is not checked, the video will be compressed and the quality of the video will be poor.

4. After waiting for the video to be synthesized, enter the sharing interface, you can choose any social media platform to share the edited video to the Facebook Twitter, Tliktok and other platforms.

8. FUNCTION INTRODUCTION

Parking monitoring

The recorder is connected to the fuse box through the hardwire kit cable to obtain power, which can realize the function of parking monitoring.

Parking monitoring, that is, when the vehicle is parked and turned off, the recorder is still in working state. Through the recorded video, you can check whether the vehicle has collided during the parking and turning off.

Note: The Hardwire kit cable needs to be purchased separately or a package including the hardwire kit cable; the operation of connecting the fuse box to get electricity is complicated. To avoid vehicle damage caused by misoperation, please complete the installation at a professional car service point.

The default parking monitoring recording mode of the recorder is "time-lapse recording", and supports three parking monitoring recording modes of "time-lapse recording", "normal recording" and "sleep".

Declare:

① Select time-lapse video / normal video for parking monitoring video mode. After 15 minutes of parking, the Wi-Fi of the

recorder will be turned off.

- ② You can check how to set the collision sensitivity of the recorder in Setting Collision Sensitivity .
- ③ In normal recording, within the set recording duration, if a collision occurs, the recorder will not exit the parking monitoring, and the recorder will generate associated photos and associated videos.
- ④ In the time-lapse video recording, if there is a collision within the set recording time, the recorder will not exit the parking monitoring, and the recorder will generate an associated photo.
- ⑤ You can check how to set the recording duration in Setting the recording duration of parking surveillance .
The default parking monitoring video duration of the recorder is " 24 hours ", and supports five parking monitoring video duration options of " 15 minutes ", " 1 hour ", " 6 hours ", " 24 hours " and " Not shut down " .
When the vehicle battery voltage is lower than the set vehicle battery protection value, the recorder will automatically shut down to protect the vehicle battery.
The default vehicle battery protection value of the recorder is " 12V ", and it supports the selection of vehicle battery protection value in three gears: " 12.4V ", " 12V " and " 11.8V " .
The lower the selected vehicle battery protection value, the longer the parking monitoring video time that the recorder can record; the higher the selected vehicle battery protection value, the shorter the parking monitoring video time that the recorder can record.

Collision Latch

When the recorder is in working state, it detects a collision (such as emergency braking of vehicles or emergency situations such as collision) , which will trigger a photo to generate an emergency photo and an emergency related video , which will be stored separately and will not be covered by the normal recording cycle.

The higher the collision sensitivity of the recorder is, the easier it is to trigger the photo; the lower the sensitivity of the recorder, the less likely it is to trigger the photo.

The default collision sensitivity of the recorder is "Medium", which supports the choice of four gears of collision sensitivity : " High ", " Medium ", " Low " and "Off".

The default emergency associated video duration of the recorder is " 10s ", and supports three emergency associated video duration options of " 10s ", " 20s " and " 30s ". You can switch the duration of the emergency link video by any of the following methods.

ADAS intelligent driving assistance

The ADAS intelligent auxiliary system only includes the function of the vehicle in front to start. It is recommended that the dashcam be installed in the center as far as possible, otherwise the deviation of the function will be affected. If you don't need this feature, you can turn it off.

Declare:

If you need to change or have changed the installation position or lens angle of the recorder in order to obtain a more

accurate ADAS intelligent driving assistance experience, you need to re-calibrate the ADAS intelligent driving assistance. The calibration reset method is: after the mobile phone App is connected to the recorder, enter the App preview interface, click the settings icon in the upper right corner, enter the "Recorder Settings" interface, select "ADAS intelligent auxiliary reminder > ADAS effect reset", and complete the recording according to the on-screen prompts position adjustment and ADAS intelligent driving assistance calibration reset.

Voice command

On by default, it can be turned off. Only English is supported. The recorder supports three kinds of voice commands, which are: Take photo; Turn on audio; Turn off audio.

Recording

Recording is closed by default and can be opened by voice or APP.

If the microphone recording is turned on, the sound will be recorded when the video is recorded; if the microphone recording is turned off, the sound will not be recorded during the video recording, and there is no sound in the video.

Switch video resolution

The higher the resolution setting, the higher the video recording clarity and the shorter the recording time; the lower the resolution setting, the lower the video recording clarity and the longer the recording time.

The default video resolution of the recorder is 4K (2160P) , and it supports three resolution options: 4K (2160P), 2K (1600P), and full HD (1080P). You can switch the video resolution by any of the following methods.

SR

Note:

1. The real-time effect of SR is viewed in the preview interface , not the final effect of SR .
2. The SR data is for reference only, and the accuracy of the data has a great relationship with the installation position of the recorder.

Format memory

For your better use of the recorder, it is recommended that you format the memory every one to three months. After the recorder is formatted in the memory, all the video and photo files in the recorder will be cleared . Please back up the data before formatting.

1. After connecting the recorder to the mobile phone Fanttik APP , enter the Fanttik, select "Device > Enter Recorder", and enter the "Now/Back" interface;

2. Click "More Settings" in the quick setting menu of the recorder , enter the "Recorder Settings" interface, open "Recorder Storage Management", click "Format" , and clear all the video and photo files in the recorder .

Upgrade Firmware

Upgrade via App

If there is a new version of firmware released, after the mobile phone FanttikApp is connected to the recorder, and after entering the Fanttik App, an upgrade prompt will pop up, and the firmware upgrade can be completed according to the prompt.

Note: If the upgrade prompt is popped up and the upgrade is not performed, the app will pop up the upgrade prompt again the next time the phone is reconnected to the recorder ; enter the main interface of the FanttikCam App , and select "Me > About Fanttik > New firmware available " , and firmware upgrade is also available.

Upgrade via eMMC memory.

1. When the recorder is turned off, use the Type-C data cable to connect the recorder to the computer;
2. Download the compressed file of the firmware upgrade package, decompress the upgrade package, and copy the decompressed update folder to the root directory of the built-in memory card of the recorder;

Note: When unzipping, please select "Extract to the current folder". After completion, please put the entire update folder into the root directory of the memory card, and do not copy the files in the folder separately .

3. When the recorder is powered on, the recorder will be automatically upgraded, and the upgrade will be completed after restarting.

Note: Do not plug or unplug the power supply during the upgrade process.

Other

1. Turn on "Time Watermark", the time and recorder model will be displayed on the recording screen; if "Time Watermark" is turned off , the time and recorder model will not be displayed on the recording screen.
2. Turn on the GPS speed display , and the GPS real-time speed will be displayed on the recording screen ; if the GPS speed display is turned off , the GPS real-time speed will not be displayed on the recording screen.
3. The recorder turns off image flipping by default. Advised not to open it except in special circumstances.
4. Switch to H.265 video encoding mode, the video will be recorded in higher definition, but it has certain requirements on the configuration of the mobile phone.
5. If the power-on prompt sound is turned on, the recorder will have a prompt sound when it is turned on and off; if the power-on prompt sound is off, the recorder will have no prompt sound when it is turned on and off. The startup beep is turned on by default.

Warranty Info

Your Warranty Includes

- **12-Month Coverage**

Within 12 months of purchase, we will provide timely and effective online after-sales service. We will repair or replace any defective product (due to manufacturing fault) within the warranty period.

How to Return Your Fanttik Product

- Contact support@fanttik.com with your order number.

-  If your purchase was fulfilled by Amazon, please use Amazon's 30-day return service.

www.fanttik.com
support@fanttik.com
METASEE LLC
5205 Broadway #634 Pearland Texas 77581

Made in China



Federal Communications Commission (FCC) Statement

This device complies with part 15 of the FCC Rules. Operation is subject to the following two conditions: (1) This device may not cause harmful interference, and (2) this device must accept any interference received, including interference that may cause undesired operation.

Note: This equipment has been tested and found to comply with the limits for a Class B digital device, pursuant to part 15 of the FCC Rules. These limits are designed to provide reasonable protection against harmful interference in a residential installation. This equipment generates, uses and can radiate radio frequency energy and, if not installed and used in accordance with the instructions, may cause harmful interference to radio communications. However, there is no guarantee that interference will not occur in a particular installation. If this equipment does cause harmful interference to radio or television reception, which can be determined by turning the equipment off and on, the user is encouraged to try to correct the interference by one or more of the following measures:

- Reorient or relocate the receiving antenna.
- Increase the separation between the equipment and receiver.
- Connect the equipment into an outlet on a circuit different from that to which the receiver is connected.

● Consult the dealer or an experienced radio/TV technician for help.

Warning: Changes or modifications made to this device not expressly approved by **METASSEE LLC** may void the FCC authorization to operate this device.

Note: The manufacturer is not responsible for any radio or TV interference caused by unauthorized modifications to this equipment. Such modifications could void the user's authority to operate the equipment.

RF exposure statement:

The transmitter must not be colocated or operated in conjunction with any other antenna or transmitter. This equipment complies with the FCC RF radiation exposure limits set forth for an uncontrolled environment. This equipment should be installed and operated with a Minimum distance of 20cm between the radiator and any part of your body.