

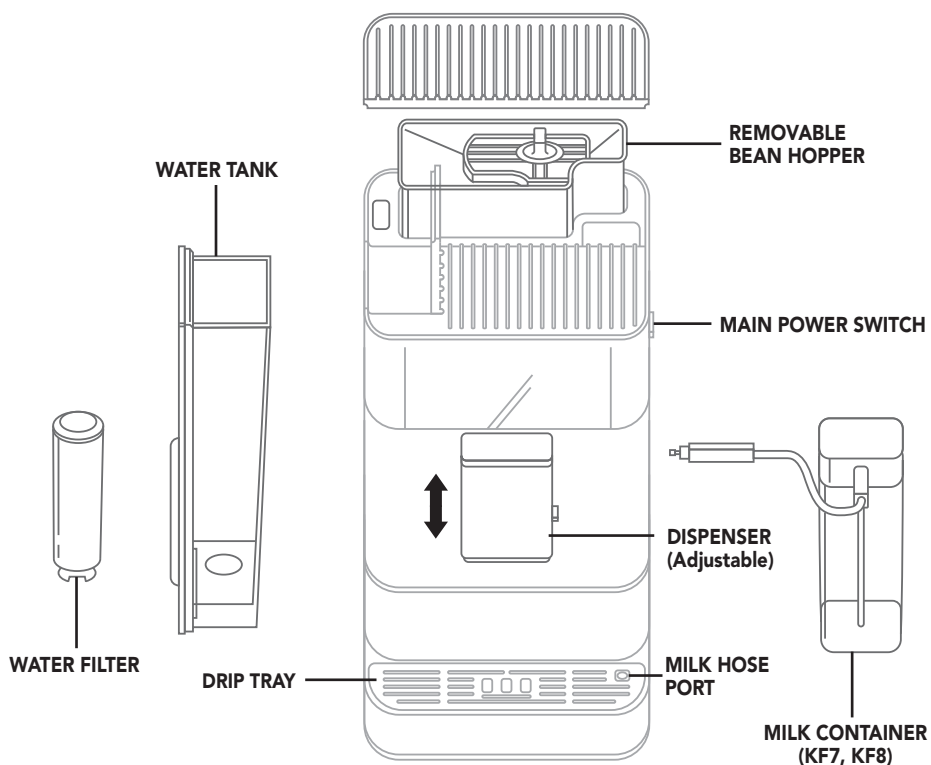

KitchenAid

WELCOME!

QUICK START GUIDE



BEFORE FIRST USE

01. Remove and wash Water Tank and Milk Container.

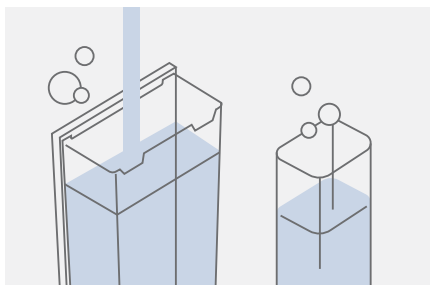

02. Turn on machine by pressing the Main Power Switch located on the side panel of the machine.

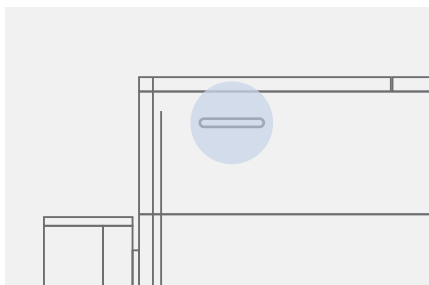

QUICK START GUIDE

GETTING STARTED

01. Follow on screen instruction for first time use.



02. Prime the machine by making and purging 4x shots of Espresso (ready!).

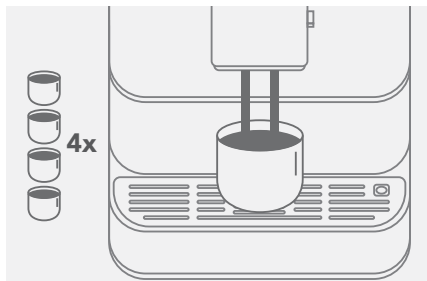

MILK OR PLANT-BASED MILK

01. Add milk or Plant-based milk to Milk Container.

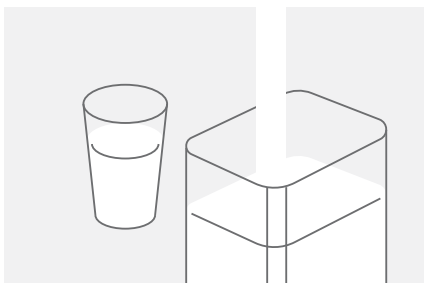

02. Insert one end of the milk hose into dispenser port.

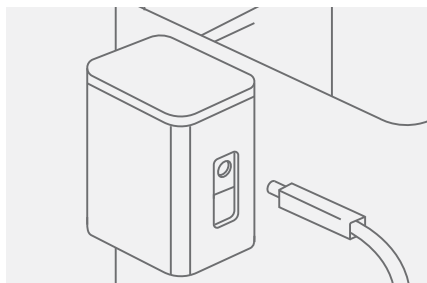

03. Insert other end into Milk Container (KF7, KF8) or your own reservoir (KF6).

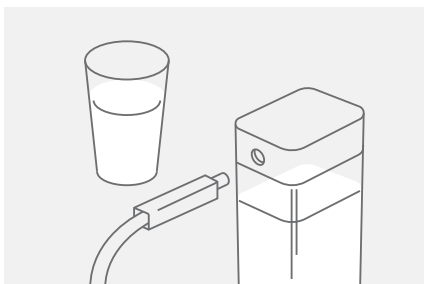

04. Select desired milk or Plant-based milk and Enjoy!

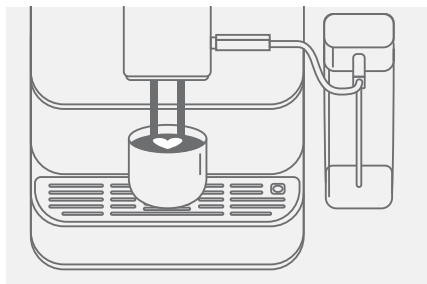

KitchenAid

QUICK START GUIDE

CUSTOMISATION

01. In your drink settings, you can customise the Strength, Temperature, Body type, and Volume of your drink.

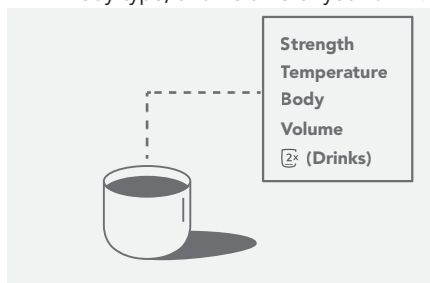

02. Choose between Plant-based milk or Dairy milk cycles (on KF8 models).



BEAN HOPPER FUNCTIONS

01. The Purge Function: **Select the Purge Beans** in Cleaning Menu (⌂) and follow the instructions on the screen.



02. Remove Bean Hopper: **Unlock hopper knob and press down** on the side removal button.

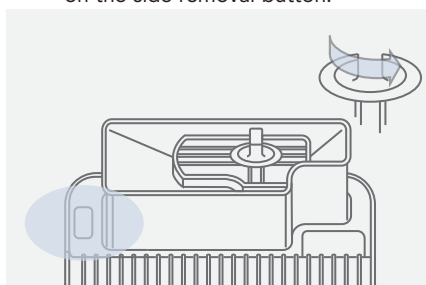

NOTE: See the Owner's Manual and/or the online Product Guide for detailed information.

CARE AND CLEANING

All cleaning and maintenance programs can be selected and started in the Cleaning Menu (⌂). Your machine will notify and guide you through maintenance when cleaning activity is suggested.

- **Easy Milk Rinsing:** After you make milk based drinks, the display instructs you to rinse the frother. This should be done as soon as possible, but at the latest before switching off the machine.
- **Deep Milk Cleaning:** From time to time you may want a more thorough milk system clean (monthly).
- **Descaling:** When prompted, remove your Water Filter and add descaling solution to Water Tank.
- **Brew Unit Cleaning:** Unit is removable and can be cleaned monthly to maintain best performance.
- **Water Filter:** Suggested after 50 L of water has flowed through machine (4x per year).

KitchenAid

KitchenAid

©2024 All rights reserved.