

HAND MIXER

2007067 (black) 2013077 (Red)

2013242 (Cream)

- Instruction Manual



VonShef

VonShef

VonShef

VonShef

VonShef

VonShef

VonShef

VonShef

CONTENTS

Safety Instructions

1

Specification

2

Before First Use, Speed Settings

3

Operation

4

Cleaning & Maintenance, Warranty

5

VonShef

VonShef

VonShef

VonShef

VonShef

VonShef

VonShef

VonShef

SAFETY INSTRUCTIONS



WARNING



PLEASE READ THESE INSTRUCTIONS CAREFULLY AND KEEP FOR FUTURE REFERENCE.

INTENDED USE.

Only operate the VonShef Hand Mixer and Stand for its intended purpose and within the parameters specified in this manual.

This Hand Mixer is for domestic use only. Do not use outdoors, on wet surfaces, or for commercial purposes.

This appliance is not intended for use by persons with reduced physical, sensory or mental capabilities, or lack of experience and knowledge, unless supervised or given appropriate instruction concerning the product's use by a person responsible for their safety.

This appliance is not intended for use by children.

GENERAL PRECAUTIONS.

When using an electrical appliance, basic precautions should always be followed, including the following:

Do not allow to be used as a toy. Children should be supervised to ensure they do not play with the Hand Mixer.

If the Hand Mixer is not functioning properly, has been dropped, damaged, left outdoors, or immersed in liquid, do not use, contact DOMU Brands Customer Services.

Do not use the Hand Mixer if any parts appear to be faulty, missing or damaged.

Ensure all parts are securely attached before use.

CABLE AND PLUGS.

Check to ensure your electricity supply matches that shown on the rating plate. This product should only be used as rated. Preferably, the socket outlet should be protected by a Residual Current Device (RCD).

Do not use with a damaged cable or plug. If the supply cable is damaged, it must be replaced by a qualified engineer or authorised service agent in order to avoid a hazard.

The use of an extension cable is not recommended.

Do not handle the plug or appliance with wet hands.

Do not let the cable hang over the edge of the table or countertop where it could be pulled on inadvertently by children or pets.

Keep the cable away from heated surfaces.

Do not coil the cable around sharp edges or corners.

Do not leave unattended when plugged in. Unplug from outlet when not in use.

Turn off all controls before unplugging.

Do not unplug by pulling on the cable. To unplug, grasp the plug, not the cable.

Always unplug before performing user maintenance, connecting or disconnecting attachments, or changing accessories.

Ensure the cable is stored safely to prevent hazards.

RISK OF PERSONAL INJURY.

Always locate your appliance away from the edge of the worktop, on a firm, flat, heat-resistant surface with sufficient space around all sides.

The Hand Mixer is not intended to be operated by means of an external timer or separate remote-control system.

Do not insert any objects into openings or cover the appliance.

Keep hair, loose clothing, fingers and all parts of the body away from openings and moving parts.

Never mix accessories that are intended for different functions (e.g. Dough Hook and Beater).

Do not touch the Dough Hooks, Balloon Whisk or Beaters whilst the appliance is in operation.

Do not leave the Hand Mixer unattended when in use.

Do not operate continuously for periods longer than those marked on the product or indicated in the instructions.

Ensure the appliance is switched off and unplugged before changing accessories or cleaning.

Do not lubricate any parts or carry out any maintenance or repair work other than that shown in this manual, as advised by the DOMU Brands Customer Care helpline.

Use only as described in this manual and do not overfill. Use only DOMU Brands recommended attachments.

TECHNICAL SPECIFICATION

VOLTAGE	RATED POWER	RATED FREQUENCY
V	W	Hz
220-240	300	50/60

PRODUCT SPECIFICATION



1. EJECT BUTTON.
2. CONTROL SWITCH.
3. TURBO BUTTON.

4. DOUGH HOOKS.
5. BALLOON WHISK.
6. BEATERS.

7. MAIN UNIT.
8. HANDLE.
9. VENT.

BEFORE FIRST USE

Before using this appliance for the first time, please ensure you complete the following steps:

- Carefully unpack the Hand Whisk and all parts and remove all packaging materials including any stickers or labels.
- Clean the **MAIN UNIT** and all accessories with a damp cloth or sponge. Wipe dry with a soft dry cloth.
- Inspect the item and check that all parts are included.



WARNING! Never immerse the Hand Mixer in water or any other liquid to clean.

SPEED SETTINGS



EJECT BUTTON: Releases the accessories from the appliance with a single push.



WARNING! Do not press when the Hand Mixer is in use.

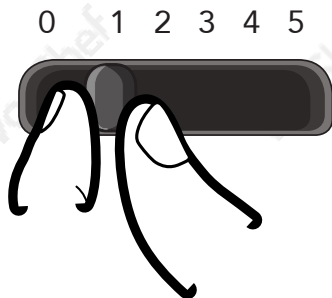

Use **SPEED 1 - 2** for:

- Mixing dry ingredients with liquids
- Folding whipped egg whites and cream into mixtures
- Stirring gravies and sauces

Use **SPEED 3 - 4** for:

- Mixing cake mixes, puddings or batters
- Using the **DOUGH HOOKS** when mixing dough or heavier cake mixes
- Creaming together butter and sugar

Use **SPEED 5** for:

- Whipping cream, evaporated or powdered milk, egg whites or whole eggs
- Mixing minced meat
- Kneading heavy dough



TURBO BUTTON: Instantly switches to maximum speed when pressed and held.

OPERATION

- Align and insert the **DOUGH HOOKS, BALLOON WHISK** and **BEATERS** until they are locked in place.

IMPORTANT: Only insert one accessory at a time and do not combine accessories of different types. The **BALLOON WHISK** must be used on its own.

- Plug the Hand Mixer into a suitable mains socket.
- Depending on the quantity being prepared, add the ingredients to an appropriate container.
- Carefully plunge the **DOUGH HOOKS, BALLOON WHISK** and **BEATERS** into the container and slowly slide the **CONTROL SWITCH** from speed 1 up to the maximum speed of 5 as desired.

CAUTION: To avoid unnecessary strain on the motor, do not use the Hand Mixer for any mixtures which prevent the mixing attachments from revolving freely.

NOTE: To prevent splattering, always submerge the **DOUGH HOOKS, BALLOON WHISK** and **BEATERS** into your mixture **before** turning on the appliance.

- Slowly rotate the appliance around the container to evenly mix your ingredients.
- If necessary, increase the speed gradually until the desired consistency is achieved.

CAUTION: After **2 minutes** of continuous use, allow a 5 minutes for the Hand Mixer to cool before using again. Do not operate for more than **2 minutes** at a time.

- This Hand Whisk is equipped with a **TURBO BUTTON** which, when pressed and held, will speed up the Hand Mixer to its maximum setting.

CAUTION: Do not use the **TURBO BUTTON** for more than **2 minutes** at a time as this may cause the motor to overheat.

IMPORTANT: To prevent splattering, always keep the **BEATERS, DOUGH HOOKS** or **BALLOON WHISK** in the mixture and switch the appliance off **before** removing from the container.

- Once you have finished mixing your ingredients, reset the **CONTROL SWITCH** to the '0' position and unplug.
- Eject the **BEATERS, DOUGH HOOKS** or **BALLOON WHISK** by pressing the **EJECT BUTTON**.

CAUTION: Do not press the **EJECT BUTTON** whilst attachments are rotating.

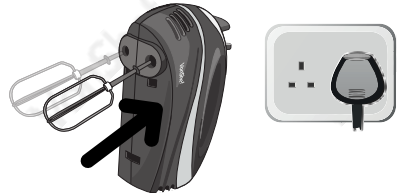

CLEANING & MAINTENANCE

CAUTION: Before carrying out cleaning or maintenance, disconnect the appliance from the mains.

Clean the **MAIN UNIT** of the appliance after every use using a damp cloth and warm water.

WARNING! Do not submerge the Hand Mixer in water or any other liquid to clean. To prevent electric shock, take care not to allow water to get inside the air outlet.

- Clean the **DOUGH HOOKS**, **BALLOON WHISK** and **BEATERS** under warm running water with a sponge and mild detergent.

NOTE: All mixing attachments are dishwasher-safe.

- Dry all attachments thoroughly before storing in a dry area out of reach of children.

CUSTOMER SERVICES

If you are having difficulty using your product and require support, please contact hello@domu.co.uk.

DISPOSAL INFORMATION

Please recycle where facilities exist. Check with your local authority for recycling advice.

WARRANTY

To register your product and find out if you qualify for a free extended warranty, go to:

www.VonShef.com/warranty

Please retain a proof of purchase receipt or statement as proof of the purchase date.

The warranty only applies if the product is used solely in the manner indicated in this manual and all instructions have been followed accurately. Any abuse of the product or the manner in which it is used will invalidate the warranty.

Returned goods will not be accepted unless re-packaged in its original packaging and accompanied by a relevant and completed returns form. This does not affect your statutory rights.

No rights are given under this warranty to a person acquiring this appliance second-hand or for commercial or communal use.

COPYRIGHT

All material in this instruction manual are copyrighted by DOMU Brands Ltd.

Unauthorised use may violate worldwide copyright, trademark and other laws.

Thank you for purchasing the Hand Mixer.

VonShef® is a registered trademark of DOMU Brands Ltd
Made in China for DOMU Brands Ltd M24 2RW
