

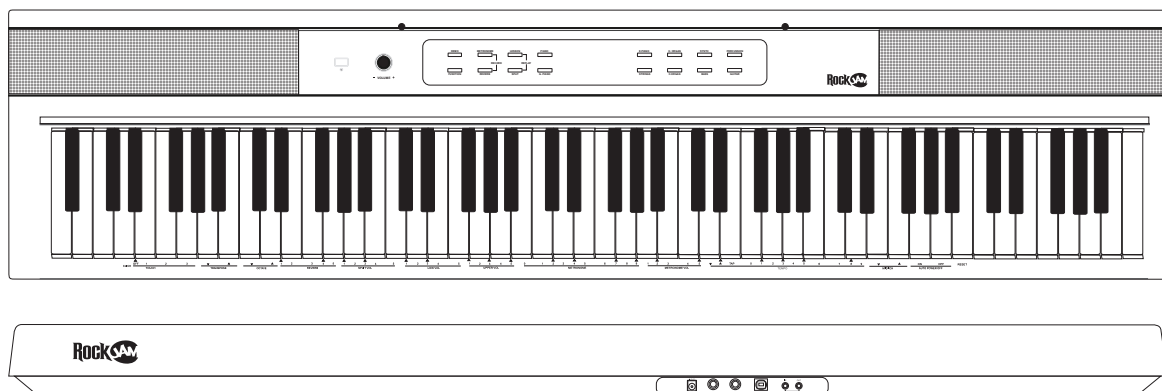

# 88 Key Digital Piano

## User Guide





## PRECAUTIONS

Please be sure to read the following information carefully and keep this in a safe place for your further reference.

### WARNING

In order to avoid serious casualties caused by electric shock, short circuit, fires or other dangers, please be sure to obey the following information at all times. The precautions are as follows:

- Do not open the digital piano or try to disassemble any part of it. If it should appear to be malfunctioning, discontinue using immediately and have it inspected by qualified service personnel.
- To avoid damaging the piano, please do not place it in a wet environment. Do not place any vessel holding water onto the piano as spillage may occur and damage the internal parts of the piano.
- If the power cord or plug becomes damaged, the piano suddenly cuts off during use or an unusual smell/smoke is detected, please turn off the power and unplug the power adaptor as soon as possible. Then find the qualified service personal to inspect the piano.
- Please use the specified adaptor only. Using the wrong adaptor can result in damage to the instrument.

### NOTICE

- Please remove the power adaptor from the outlet if the piano is not used for a long period of time.
- Do not expose the instrument to excessive dust, vibrations or extreme hot/cold environments (such as direct sunlight or heaters).
- Please unplug the power adaptor or other external devices before moving the keyboard.
- When cleaning the instrument, use a soft, dry cloth. Do not use paint thinner, solvents, cleaning fluids, or chemical-impregnated wiping cloths which may cause discolouration.
- Before connecting the instrument to other electronic components, turn off the power and set all volume levels to minimum. You can then adjust the minimum volume gradually to an appropriate level once the music is playing.
- Do not place the piano on an uneven surface.
- Do not place heavy objects on the piano or hit the keys with excessive force.
- The electric piano has been designed with enough volume redundancy which is suitable for classroom and such places. When using the Piano, please adjust the volume to an appropriate level. Excessive loud volume levels for long periods of time may damage your hearing.

## CONTENTS:

Technical Specification.....	1
Box Contents.....	2
Setup.....	2
Rear Panel Connection Diagram.....	2
Top Panel.....	3
Rear Panel.....	3
Battery Compartment.....	3
<b>Quick Start.....</b>	<b>4</b>
Playing Demo.....	4
Tones Selection.....	5
Layer Mode.....	5
Split Mode.....	5
<b>Advanced Functions.....</b>	<b>6</b>
Setting the Click Tone.....	6
Touch Sensitivity.....	6
Transpose.....	6
Lesson Mode.....	6
Reverb.....	7
Adjust Volume.....	7
Metronome.....	7
<b>Setting The MIDI Channel.....</b>	<b>8</b>
Auto Power Off.....	8
Adjust All Parameters.....	8
<b>Restore Factory Default Settings.....</b>	<b>9</b>
Troubleshooting.....	9
FCC Compliance Statement.....	10
Product Disposal (UK and EU).....	10

## Technical Specification

<b>Keyboard</b>	88 Piano Keys
<b>Polyphony</b>	32 Notes
<b>Tones</b>	10 Tones
<b>Demos</b>	10 Songs
<b>Keyboard Control</b>	Split, Lesson function
<b>Effect Control</b>	Dual Voice, Reverb
<b>Metronome</b>	10
<b>Setting</b>	Power off reservation
<b>Accessories included</b>	User guide, Power adapter, Music stand

<b>Input</b>	Headphones Aux Input/ Output
<b>Pedals</b>	Sustain
<b>USB-MIDI</b>	Supported
<b>Power Adapter</b>	DC 12V - 2A
<b>Outpower Power</b>	2 x 12W
<b>Size</b>	125 x 29 x 9cm
<b>Weight</b>	6.5kg

## Box Contents

- RockJam Digital Piano
- Music Stand
- Power Adapter
- User Guide
- Tablet Clip x2

## Setup

### Music Stand

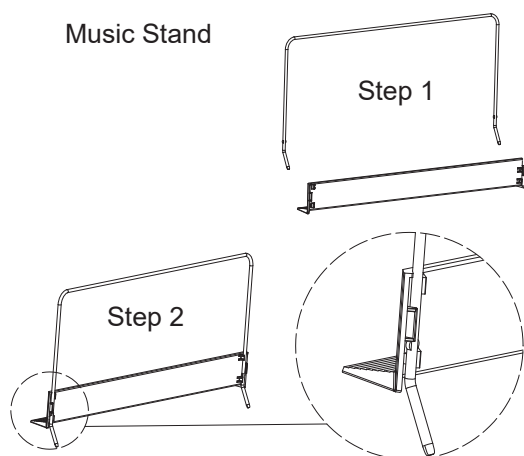

### Tablet Clips

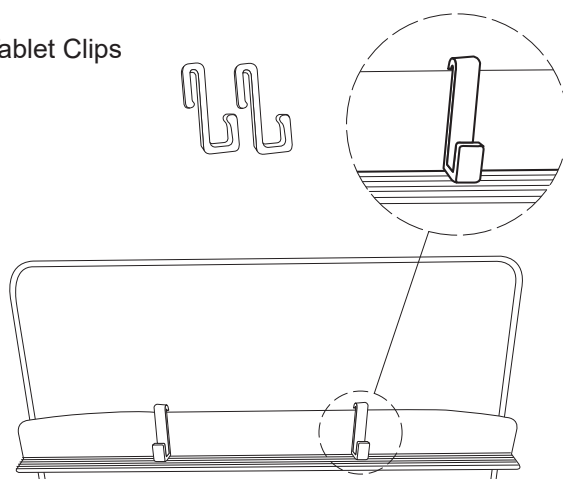

## Rear Panel Connection Diagram

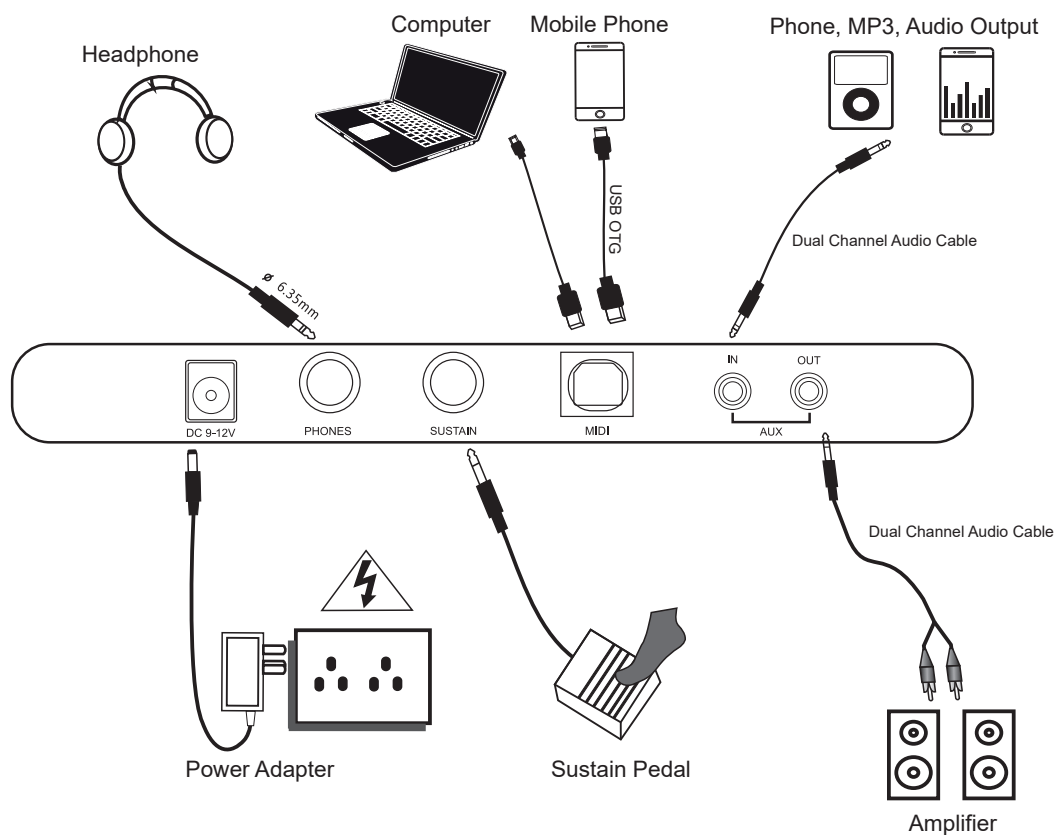

## Top Panel

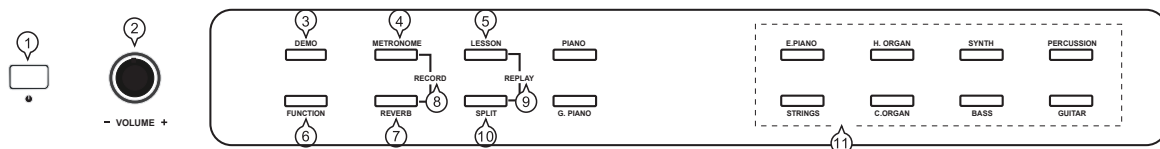

- 1. Power Switch:** Turn the piano's power on or off. In order to save energy, the piano will automatically shut down after 30 minutes if it is not used.
- 2. Master Volume Knob:** Adjust the master volume for Line Output and Headphone Output.  
**Note:** If the internal speakers do not produce any sound, check that the Master Volume knob is not set too low or if headphones plugged into the Headphone Output.
- 3. Demo Button:** Press this button to turn the Demo on or off.
- 4. Metronome Button:** Press this button to turn the metronome on or off. The LED light will turn on or off accordingly.
- 5. Lesson Button:** Press this button to turn the Lesson Mode on or off, the LED light will turn on or off accordingly.
- 6. Function Button:** Press this button to enter or exit Advanced Function Mode, LED light will turn on or off.
- 7. Reverb Button:** Press this button to turn the reverb effect on or off, the indicator light will turn on or off accordingly.
- 8. Record Button:** Press the Metronome button and Reverb Button at the same time to enter the recording mode. The maximum recording capacity is around 1000 notes. When the recording capacity is full the keyboard will stop recording. Press the Metronome button and Reverb button again to quit this mode.
- 9. Replay Button:** Press the Lesson Button button and Split Button at the same time to play back what you recorded.
- 10. Split Button:** Press split and desired tone button at the same time to enter Split Mode. Press split button again to exit Split Mode, the LED light will turn on or off accordingly.
- 11. Tone Select Buttons:** Press one of these buttons to select a preset tone. The selected tone LED light will turn on or off accordingly.

## Rear Panel

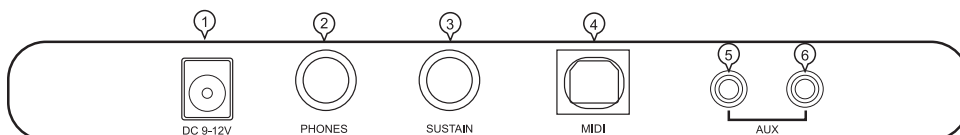

- 1. Power Connector:** Use only dedicated AC-DC power adapter for this piano.
- 2. Back Headphone Output:** Connect stereo headphones with a 1/4"(6.35mm) stereo connector. When headphones are connected, the internal speakers will automatically turn off and sound will only be heard from the headphones.
- 3. Sustain Pedal Input:** Connect a standard 1/4"(6.35mm) sustain pedal here.
- 4. USB-MIDI Port:** Allows for transfer of MIDI data to a computer.
- 5. AUX IN Port:** Allows Input audio signals from other audio devices, such as mp3, mobile phone and other media devices to the keyboard.
- 6. AUX OUT Port:** Allows connection to external audio equipment such as an amplifier, mixer, or recorder.

## Battery Compartment

Battery Compartment: Install 6“D” batteries here to power the digital piano if you are not using the power adapter. Being careful to follow the polarity marking on the inside of the compartment, replace the compartment cover, make sure that it locks firmly in place.

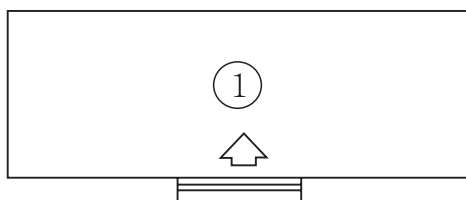

Caution: Do not use different kinds of batteries at the same time, or mix old and new batteries. When the batteries run down, the low voltage will lead to the weaker volume and distortion of tone, replace them with new batteries. If the instrument is not to be in use for a long time, remove the batteries from it, in order to prevent possible fluid leakage from the battery.

## Quick Start

### Playing Demo

The Digital Piano has 10 demo songs built-in.

Tone Demo List:

TONE	DEMO	TONE	DEMO
Piano	Marriage Of Love	Church Organ	The New Era
Grand Piano	Nocturne in E Flat, Op. 9 No. 2	SYNTH	The Sun Sank
Electric Piano	Traveler	Bass	90's Rock
Strings	Sour Seasons Spring	Percussion	Charming Jazz
Hammond Organ	Butterfly Love	Guitar	Romance De Amor

To play the demo songs:

1. Press “Demo” button, the piano will enter the Demo Mode and play 10 demo songs in a continuous loop. The indicator light will flash during demo playback. Press “DEMO” button again to exit this mode.
2. Each Tone on the panel is preset with a voice demo. Firstly press and hold “DEMO” button, then press one of the tone buttons and then release both buttons at the same time. To exit Demo Mode, press “DEMO” button again and the LED will turn off .

## Tones Selection

1. Press one of Tone buttons, the corresponding LED will be lit for that tone.
2. Play the keys to hear the tone accordingly.

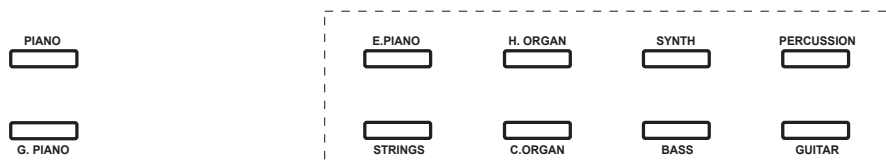

## Layer Mode

Layer Mode allows for two different tones to be layered together for a more full and rich sound.

### To Enable Layer Modes:

1. Firstly, Press and hold one tone button, then press a second tone button to layer together. Release these two buttons at the same time. The piano will then enter Layer Mode and the two corresponding tone button LEDs will be lit.
2. Play the keys to hear the two different tones layered together.
3. To disable Layer Mode, touch one of the tone buttons.

**Note:** The first tone selected will be set as the "lower" tone and the second will be set as the "upper" tone.

See the **Advanced Functions** section of this manual to learn how to adjust the level of the "Upper" and "Lower" tones.

## Split Mode

Split Mode allows you to split the 88 keys into two zones so that you can have two different tones for each of your hands. For example, you may want the Piano tone for your right hand and the Brass tone for your left hand.

When split Mode is enabled, the left hand tone is referred to as the Split tone.

### To Enable Split Mode:

1. Select the tone you would like to be in the right-hand zone.
2. Press and hold the Split button, then press one of the tone buttons to select the Split tone for the left-hand zone and then release those two buttons at the same time to enter Split Mode. The corresponding LEDs will be lit when Split Mode is enabled.
3. Play the keys and you will hear that the right-hand and left-hand zones will have different tones.

To disable Split Mode, press the Split button again. The split button LED will turn off when Split Mode is disabled.

### To Set Split Point:

To set the key for where the split point between the right-hand tone and left-hand tone occurs, use the following procedure:

1. Press and hold the Split button, and then press the key where you would like the split to occur.
2. Release the Split button to confirm the new split point.

**Note:** When you are using Split Mode and Layer Mode at the same time, the right-hand zone of the split will play both of the layered tones and the left-hand zone of the split will play the Split tone only.

See the **Advanced Functions** section of this manual to learn how to adjust the level of the Split tone.

## Advanced Function Mode

### How to Enter and Exit Advanced Function Mode:

There are more advanced settings available by using the Function button.

Press the Function button, the LED will be lit. **1**

Then use the keys that correspond to the graphics below to change to your desired setting.

Press the Function button again to exit advance function mode. **2**

## Setting the Click Tone

When the click tone is on, you will hear a click sound whenever you change a setting or parameter. You can turn the click tone on or off in Advanced Function Mode.

To turn the click tone on or off:

1. Enter Advanced Function Mode, the function LED will be lit on.
2. Press the key marked "Click" to turn the tone on or off.
3. Exit Advanced Function Mode.

## Touch Sensitivity

The keyboard is equipped with touch response to control level of the voice with your playing strength. That means the harder you play the keys, the greater volume comes from the speakers.

Turning this function off results in a fixed touch response no matter how hard or how soft you play the keys. There are 3 types of touch settings (off, 1, 2, 3)

Parameters	Description
OFF	Fixed
1	Soft
2	Medium
3	Hard

### To Set The Sensitivity:

1. Enter Advanced Function Mode. The function LED will be lit.
2. Use the "Touch" keys to select an appropriate touch level.
3. Exit Advanced Function Mode.

## Transpose

This function allows the overall pitch of the piano to be transposed up or down.

### To change the transposition:

1. Enter Advanced Function Mode. The function LED will be lit.
2. Use the keys marked Transpose+ or Transpose – to set the transpose value from (-6 to 6). Press both keys together to reset the transposition back to default value of 0.
3. Exit Advanced Function Mode.

## Lesson Mode

The Lesson Mode feature divides the 88 keys into two zones with the same pitch and tone. This enables both the student and teacher to easily watch and or play together during instruction, without having to reach over each other to play the same pitch.

**Note:** In Lesson Mode, the layer and Split Modes will be automatically disabled.

Set Other Functions In Lesson Mode:

1. To select a tone for both zones in Lesson Mode, press one of the Tone buttons.
2. The default split point is C4.

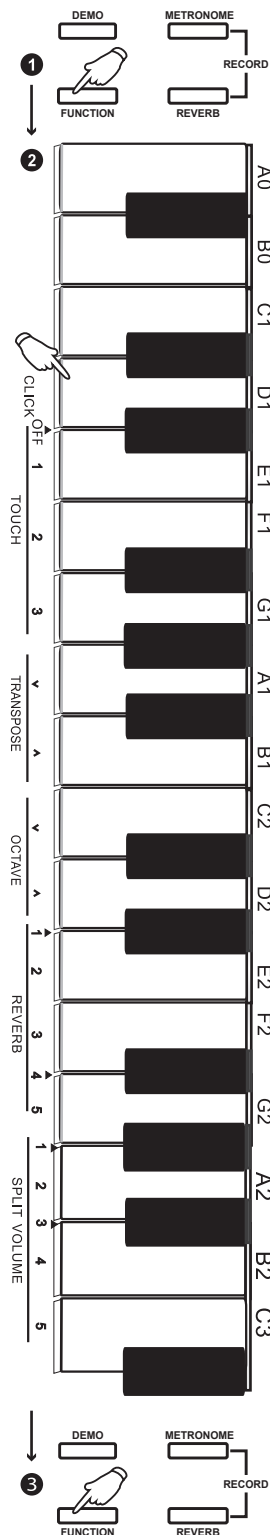



### To Change the Octave of both Zones in Lesson Mode:

1. Enter Advanced Function Mode. The function LED will be lit on.
2. Use the keys marked "Octave+" or "Octave-" to adjust the octave value from (-3 to 3). Press both keys at the same time to restore the default octave value to 0. (octave value can only be adjusted in Lesson Mode, and has no effect in other functions)
3. Exit Advanced Function Mode.

## Reverb

You can also add an adjustable effect to your sound, this piano has five types of reverb. "Reverb" effect will be default enabled when piano is turned on.

### To Turn on / off The Reverb Effect:

1. Press the "Reverb" button to turn off the Reverb effect. The button LED will be turn off.
2. Press the button again to turn on the Reverb effect.

### To Adjust The Reverb Type:

1. Enter Advanced Function Mode. The function LED will be lit.
2. Use the keys marked "Reverb" 1-5 to select the desired reverb type.
3. Exit Advanced Function Mode.

Parameters	Reverb Type
1	Plate
2	Hall 1
3	Room 1
4	Hall 2
5	Room 2

## Adjust Volume

You can set the volume of each tone in Layer and Split Mode by using Advanced Function Mode.

1. Enter Advanced Function Mode. The function LED will be lit on.
2. Use the keys marked Upper Volume 1-5 to change the volume of the upper tone in Layer Mode. 1 is the lowest volume, and 5 is the highest volume.
3. Exit Advanced Function Mode.

You can follow the above steps to set the volumes for the lower tone in the Layer Mode and the split tone in the Split Mode, using the Lower Volume 1-5 and Split volume 1-5 keys respectively.

## Metronome

Turn the metronome on, and the speaker has a tick sound which provides a steady beat to aid in practicing at a consistent tempo. Press the "Metronome" button to turn the metronome on or off. When the metronome is in use, the Metronome button LED will flash along with the current tempo which can be freely adjusted from 30 to 250 beats per minute.

### To Set The Metronome Time Signature:

1. Enter Advanced Function Mode. The function LED will be lit on.
2. Use the keys marked "Metronome" (0-9) to set the time signature.
3. Exit Advanced Function Mode.
4. You can set keys marked Metronome 0-9 as 1/4, 2/4, 3/4, 4/4, 6/4, 3/8, 6/8, 7/8, 9/8, 12/8.

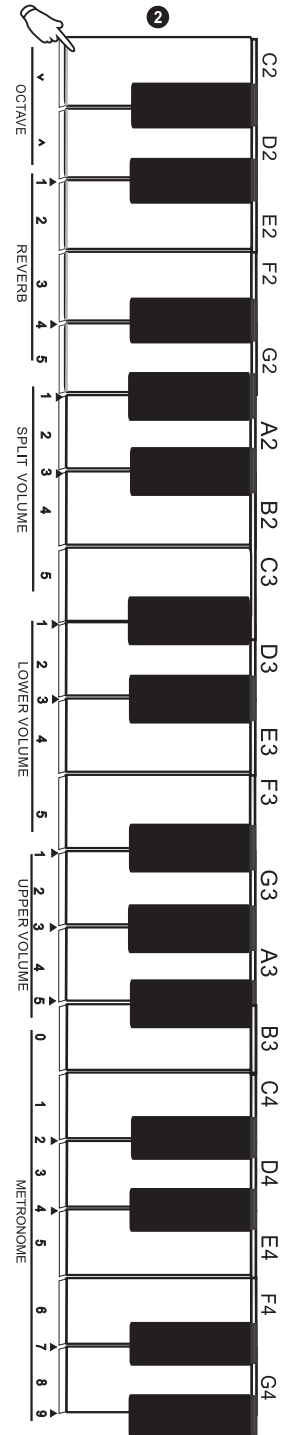

### To set the metronome volume level:

1. Enter Advanced Function Mode. The function LED will be lit on.
2. Use the keys marked "Metronome Volume" (1-5) to set the metronome volume. 1 is lowest volume, and 5 is the highest volume.
3. Exit Advanced Function Mode.

### To Set The Metronome Tempo:

1. Enter Advanced Function Mode. The function LED will be lit on.
2. Use the keys marked "TEMPO+" or "TEMPO-" to adjust the tempo value. If you press both keys at the same time, the metronome will be restored to the default tempo of 120.
3. You can also use the keys marked "Metronome" (0-9) to set the tempo value. You will need to press 3 keys total to enter the tempo value. For example, press 1,2,0 in sequence to enter a tempo value of 120, or touch 0,6,4 in sequence to enter a tempo value of 64.

Alternatively, you may tap the marked TAP to get the desired tempo. The piano will start the Metronome sound at the speed of the last two presses.

4. Exit Advanced Function Mode.

## Setting the MIDI channel

You can also set the MIDI channel for USB-MIDI output by using Advanced Function Mode.

1. Enter Advanced Function Mode. The function LED will be lit.
2. Use the keys marked "MIDI Ch+" or "MIDI Ch-" to set the MIDI Out channel from Channels 1-16. Press both keys at the same time to restore the default channel setting to 1.

**Note:** The keyboard uses only one MIDI channel at a time, even if you are using Split Mode or Layer Mode.

3. Exit Advanced Function Mode.

## Auto Power Off

In order to save energy, the piano will automatically shut down after 30 minutes if it is not used.

### To enable or disable the Auto Power Off function:

1. Enter Advanced Function Mode. The function LED will be lit on.
2. Use the keys marked Auto Power Off to enable or disable the Auto Power Off function.
3. Exit Advanced Function Mode.

## Adjust All Parameters

To set all the desired Parameters in one go, follow the sequence below:

1. Enter Advanced Function Mode. The function LED will be lit on.
2. Set all parameters: Reverb, Metronome Tempo, Metronome Time Signature, Metronome Volume, Upper Volume, Lower Volume, Split Volume, MIDI Channel, Touch Sensitivity and Auto Power Off.
3. Exit Advanced Function Mode.

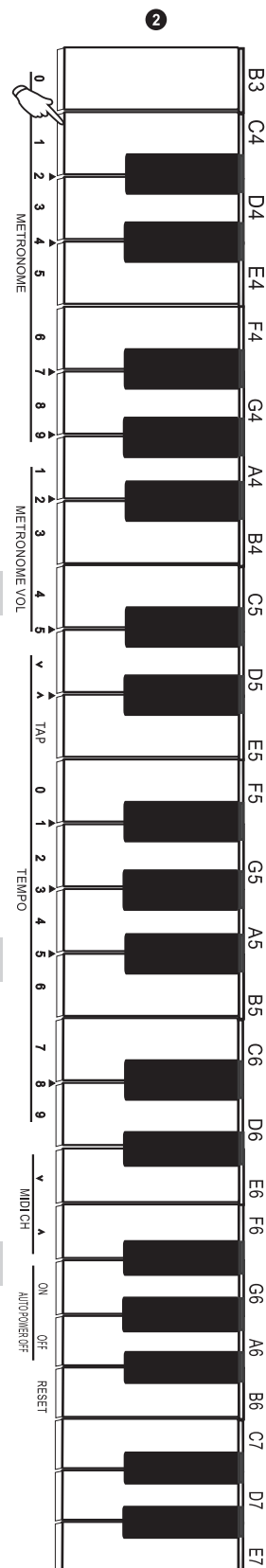

## Restore Factory Default Settings

1. Enter Advanced Function Mode. The function LED will be lit on.
2. Pressing the reset key means the following parameters will be reset to their default values:  
Reverb  
Metronome  
Tempo  
Metronome Time signature  
Metronome Volume  
Upper Volume  
Lower Volume  
Split Volume  
MIDI Channel  
Touch Sensitivity  
Auto Power off
3. Exit Advanced Function Mode.

## Troubleshooting

Problem	Possible Cause and Solution
The speakers produce a pop sound whenever the power is turned on/off.	This is normal and is no cause for alarm
The speakers do not produce sound when the keys are played	Check if the master volume is set too low or if headphones are plugged into the Headphone Output. The speakers will be muted if there are headphones plugged into the Headphone Output.
The speakers are producing a noise or interference	Using a mobile phone in close proximity to the piano may produce interference. To prevent this, turn off the mobile phone or keep it away from the piano.
Certain notes produce the wrong pitch	Make sure that the transpose value is set to 0. If that does not work, then restore the factory default settings according to Advanced Functions.
The notes sound weak or distorted	If the piano is being powered by batteries, make sure new batteries are installed.

## FCC Compliance Statement



### FCC Class B Part 15

This device complies with Part 15 of the Federal Communications Commission (FCC) Rules. Operation is subject to the following two conditions:

This device may not cause harmful interference.

This device must accept any interference received, including interference that may cause undesired operation.

#### CAUTION:

Changes or modifications to this unit not expressly approved by the party responsible for compliance could void the user's authority to operate this equipment.

This equipment has been tested and found to comply with the limits for a Class B digital device, pursuant to Part 15 of the FCC Rules. These limits are designed to provide reasonable protection against harmful interference in a residential installation. This equipment generates, uses, and can radiate radio frequency energy and, if not installed and used in accordance with the manufacturer's instructions, may cause interference harmful to radio communications.

There is no guarantee, however, that interference will not occur in a particular installation. If this equipment does cause harmful interference to radio or television reception, which can be determined by turning the equipment off and on, the user is encouraged to try to correct the interference by one or more of the following measures:

Reorient or relocate the receiving antenna.

Increase the separation between the equipment and receiver.

Connect the equipment to an outlet on a circuit different from that to which the receiver is connected.

Consult the dealer or an experienced radio or TV technician for help.

## Product disposal instructions



The symbol shown here and on the product means that the product is classed as Electrical or Electronic Equipment and should not be disposed with other household or commercial waste at the end of its working life.

The Waste Electrical and Electronic Equipment (WEEE) Directive (2012/19/EU) has been put in place to encourage the recycling of products using best available recovery and recycling techniques to minimise the impact on the environment, treat any hazardous substances and avoid the increase of landfill.

When you have no further use for this product, please dispose of it using your local authority's recycling processes. For more information please contact your local authority or the retailer where the product was purchased.

This user guide is for keyboard models RJ88DP RJ88DPV2 and DP88-V

---

RockJam is a registered trademark of:

PDT Ltd

Unit 4B, Greengate Industrial Estate, White Moss View

Middleton, Manchester M24 1UN, UK

Email: [info@pdtuk.com](mailto:info@pdtuk.com)

---