

**TECHNICAL SERVICE BULLETIN****Equipped With Parking Aid Sensors - Parking Aid Sensors Not Staying Deactivated After Vehicle Is Off Longer Than 5 Minutes****22-2094**15 March
2022

This bulletin supersedes 22-2038.

Model:

Ford 2021-2022 Bronco

Summary

This article supersedes TSB 22-2038 to update the Service Procedure.

Issue: Some 2021-2022 Bronco vehicles equipped with parking aid sensors may exhibit a park aid system that does not remain deactivated after the vehicle has been off for more than 5 minutes. The vehicle may exhibit false alerts from the parking aid warning system which may cause it to activate while driving or towing or due to the presence of a winch. This may be due to the software within the instrument panel cluster (IPC). To correct the condition, follow the Service Procedure and update the IPC software.

Action: Follow the Service Procedure steps to correct the condition on vehicles that meet all of the following criteria:

- 2021-2022 Bronco
- Equipped with parking aid sensors
- Parking aid sensors do not stay deactivated if vehicle remains in the off position for longer than 5 minutes

Warranty Status: Eligible under provisions of New Vehicle Limited Warranty (NVLW)/Service Part Warranty (SPW)/Special Service Part (SSP)/Extended Service Plan (ESP) coverage. Limits/policies/prior approvals are not altered by a TSB. NVLW/SPW/SSP/ESP coverage limits are determined by the identified causal part and verified using the OASIS part coverage tool.

Labor Times

Description	Operation No.	Time
2021-2022 Bronco: Reprogram The IPC, Refresh The Parking Aid System And Road Test (Do Not Use With Any Other Labor Operations)	222094A	3.0 Hrs.
2021-2022 Bronco: Reprogram The IPC, Refresh The Parking Aid System And Road Test Includes Time To Disconnect/Reconnect Battery And A Second Road Test (Do Not Use With Any Other Labor Operations)	222094B	3.3 Hrs.

Repair/Claim Coding

Causal Part:	10849
Condition Code:	04

Service Procedure

NOTE: If a MyKey has been programmed to the vehicle, use the admin key to operate the vehicle throughout this procedure.

1. Reprogram the IPC using the latest level of the Ford Diagnosis and Repair System (FDRS) scan tool.

NOTE: IPC programming could take up to 3 hours if using a VCM 3 or VCMM and up to 6 hours if using a VCM 2, however, no technician interaction is needed during programming.

2. Refresh the park aid system by cycling all parking aid sensors from on to off, several times, ending in off. Use the touchscreen to access Features > Driver Assistance > Parking Aid Sensors.
3. Turn the vehicle off and let sit undisturbed for at least 5 minutes.
4. Test drive the vehicle to be sure that all parking aid sensor warning chimes remain deactivated when obstructions are in close proximity to the rear and front bumpers (if equipped).

NOTE: Vehicle must be in drive (D) or reverse (R) to activate the appropriate parking aid sensor chime.

5. If the park aid system fails to remain disabled, disconnect the vehicle's 12v battery for at least 5 minutes, reconnect the battery and repeat Step 4.

© 2022 Ford Motor Company

All rights reserved.

NOTE: The information in Technical Service Bulletins is intended for use by trained, professional technicians with the knowledge, tools, and equipment to do the job properly and safely. It informs these technicians of conditions that may occur on some vehicles, or provides information that could assist in proper vehicle service. The procedures should not be performed by "do-it-yourselfers". Do not assume that a condition described affects your car or truck. Contact a Ford or Lincoln dealership to determine whether the Bulletin applies to your vehicle. Warranty Policy and Extended Service Plan documentation determine Warranty and/or Extended Service Plan coverage unless stated otherwise in the TSB article. The information in this Technical Service Bulletin (TSB) was current at the time of printing. Ford Motor Company reserves the right to supersede this information with updates. The most recent information is available through Ford Motor Company's on-line technical resources.

NO PART OF THIS DOCUMENT MAY BE REPRODUCED WITHOUT PRIOR AGREEMENT AND WRITTEN PERMISSION OF
FORD PERFORMANCE PARTS

PRIOR TO INSTALLATION READ THESE INSTRUCTION COMPLETELY
For questions, Call the FORD PERFORMANCE Techline 1-800-367-3788

Please visit <https://www.performanceparts.ford.com> for warranty information

Warn Winch Kit

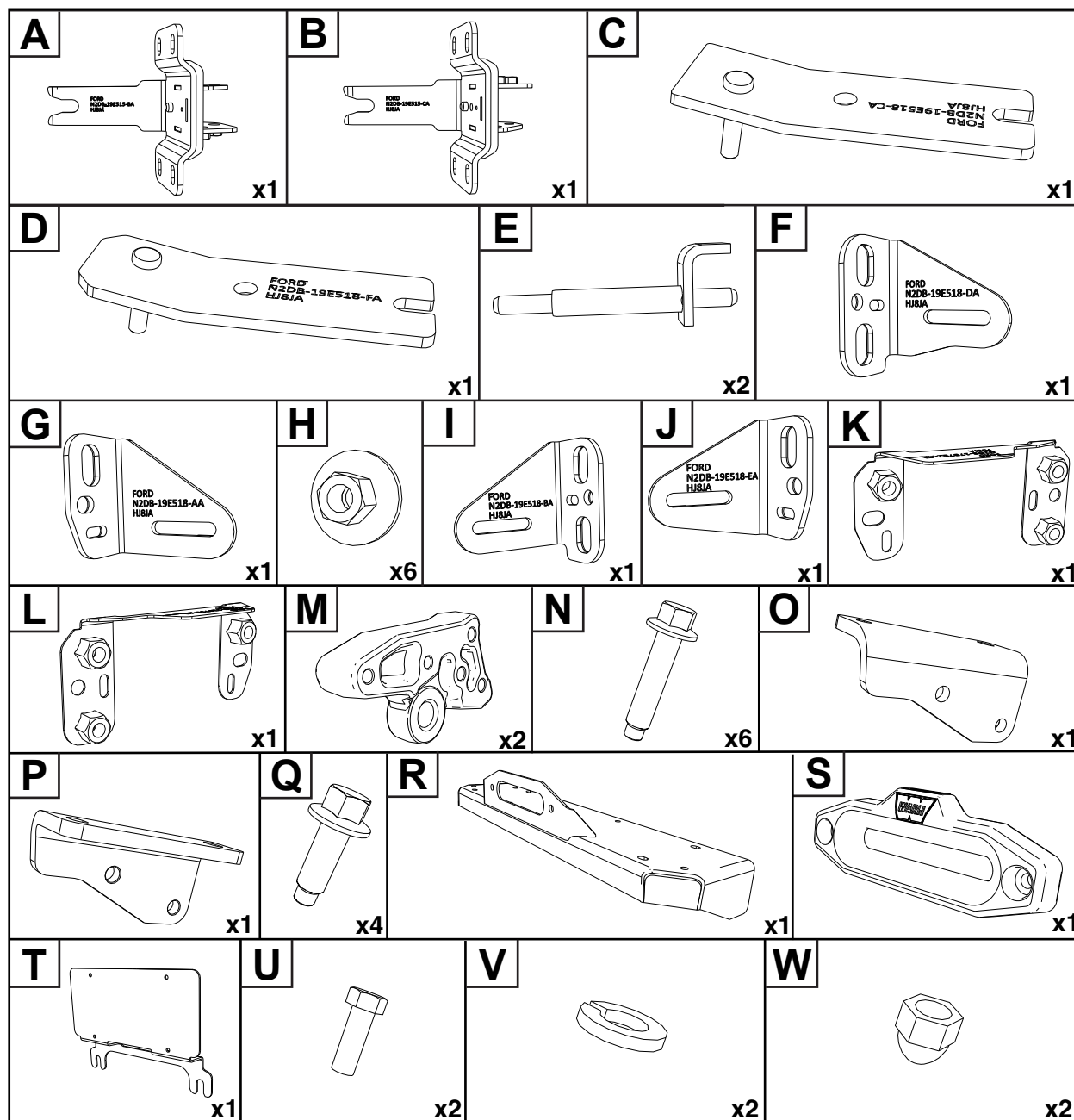

Ford Factory Shop Manual purchase options www.motorcraftservice.com

NO PART OF THIS DOCUMENT MAY BE REPRODUCED WITHOUT PRIOR AGREEMENT AND WRITTEN PERMISSION OF FORD PERFORMANCE PARTS

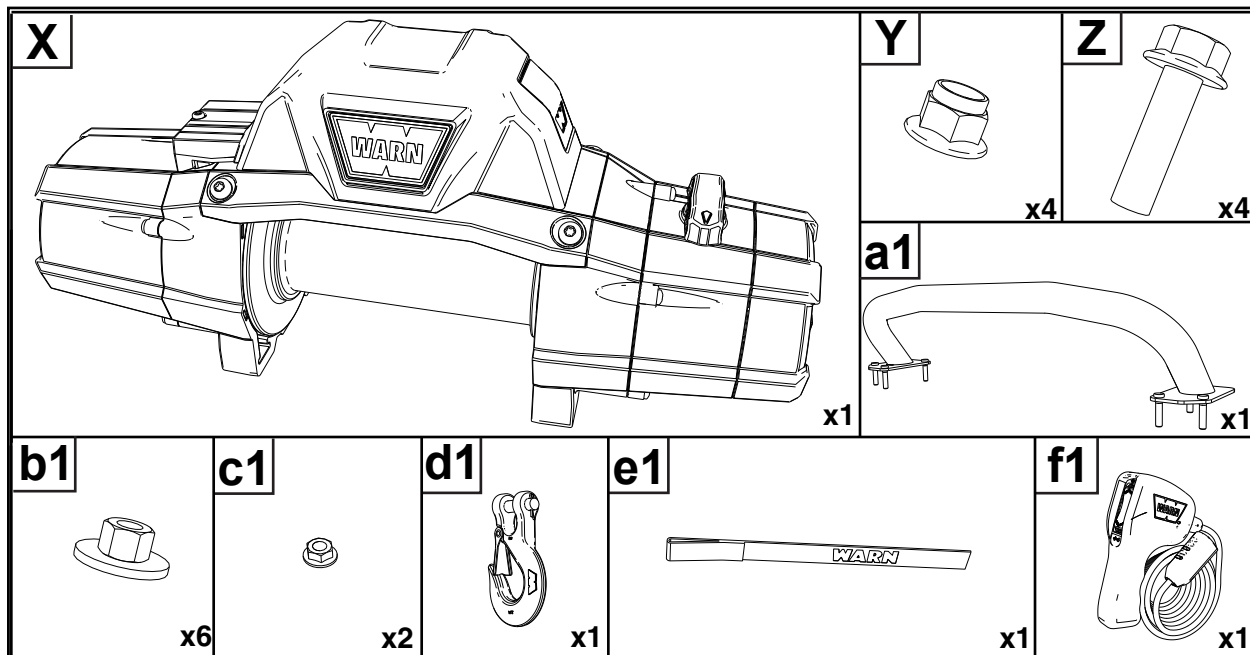

Tools Required

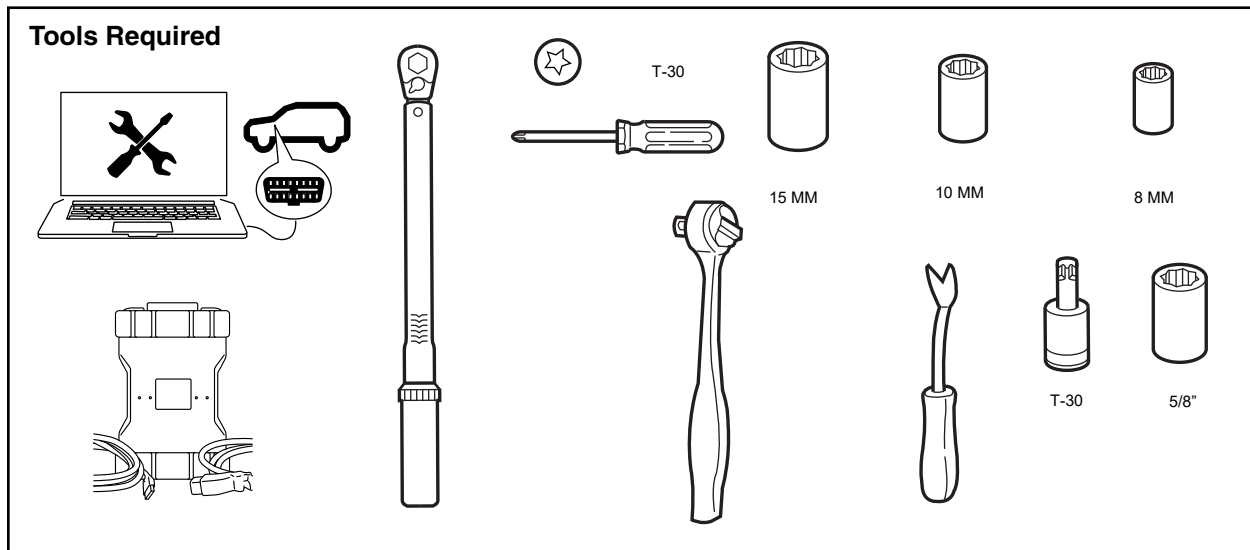



M-1821-B
2021 →
Bronco Off-Road Winch

NO PART OF THIS DOCUMENT MAY BE REPRODUCED WITHOUT PRIOR AGREEMENT AND WRITTEN PERMISSION OF
FORD PERFORMANCE PARTS

Kit Contents	Description	Part Number
A	Clevis Bracket (Left Hand)	N2DB-19E515-BA
B	Clevis Bracket (Right Hand)	N2DB-19E515-CA
C	CAC Bracket (Left Hand)	N2DB-19E518-CA
D	CAC Bracket (Right Hand)	N2DB-19E518-FA
E	Inner Frame Bolt	N2DB-19H381-AA
F	Inner Frame Bracket (Right Hand)	N2DB-19E518-DA
G	Outer Frame Bracket (Left Hand)	N2DB-19E518-AA
H	Frame Bracket Nut - M10 HX PTM FL 10	W716805-S442
I	Inner Frame Bracket (Left Hand)	N2DB-19E518-BA
J	Outer Frame Bracket (Right Hand)	N2DB-19E518-EA
K	Frame Nut Plate (Left Hand)	N2DB-17B757-AA
L	Frame Nut Plate (Right Hand)	N2DB-17B756-AA
M	Recovery Forging	N2DB-19E515-AA
N	Outer Frame Bolt - M12x1.75x80.0 HEX FLNG PIL	W500747-S450B
O	Recovery Forging Bracket (Left Hand)	N2DB-19H292-BA
P	Recovery Forging Bracket (Right Hand)	N2DB-19H292-CA
Q	Recovery Forging Bracket Bolt - M12X30 HF PIL 10	W500642-S405B
R	Winch Plate	N2DB-19H292-AA
S	Fair Lead	N2DB-19E514-AA
T	License Plate Kit (Optional)	KN2DB-17N397-AA
U	Fairlead Bolt - 7/16-14 HX	WARN-1824
V	Fairlead Washer - 7/16 HELIX SPLIT	WARN-2146
W	Fairlead Nut - 7/16 ACORN	WARN-73849
X	Winch	N2DB-19E513-AA
Y	Winch Housing Nut - M10	WARN-87166
Z	Winch Housing Bolt - M10 X 35	WARN-69954
a1	Brush Bar	
b1	Brush Bar Nut - M10 HX PTM FL 10	W716805-S450B
c1	Nut - M6 HF 8	W520412-S437
d1	Hook	N2DB-19H382-AA
e1	Hook Strap	
f1	Winch Remote	LC3C-19H380-AA

Ford Factory Shop Manual purchase options www.motorcraftservice.com

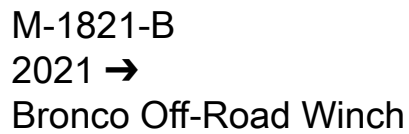

INSTALLATION PROCEDURE - Winch Kit

[illegible]

-
- Diagram illustrating the removal of the front fender. Four screws are indicated for removal with dashed lines and arrows. A legend shows a screwdriver and a 15 mm hex key.

IS M-1821-B 112221

NO PART OF THIS DOCUMENT MAY BE REPRODUCED WITHOUT PRIOR AGREEMENT AND WRITTEN PERMISSION OF
FORD PERFORMANCE PARTS

2. Remove the push pin retainers.

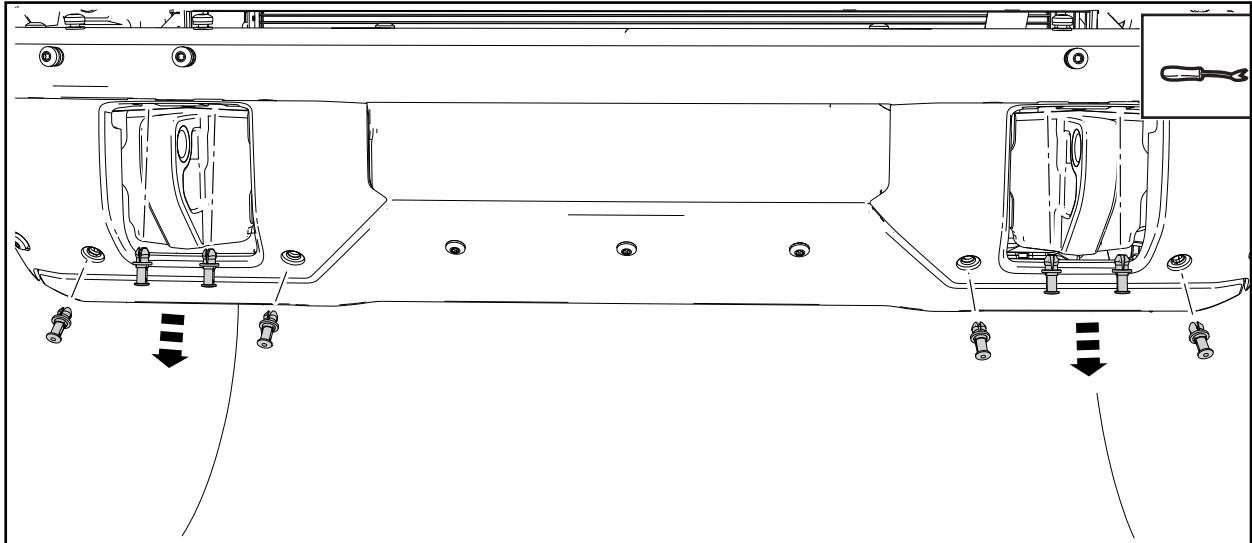

3. Remove the front bumper trim panel.

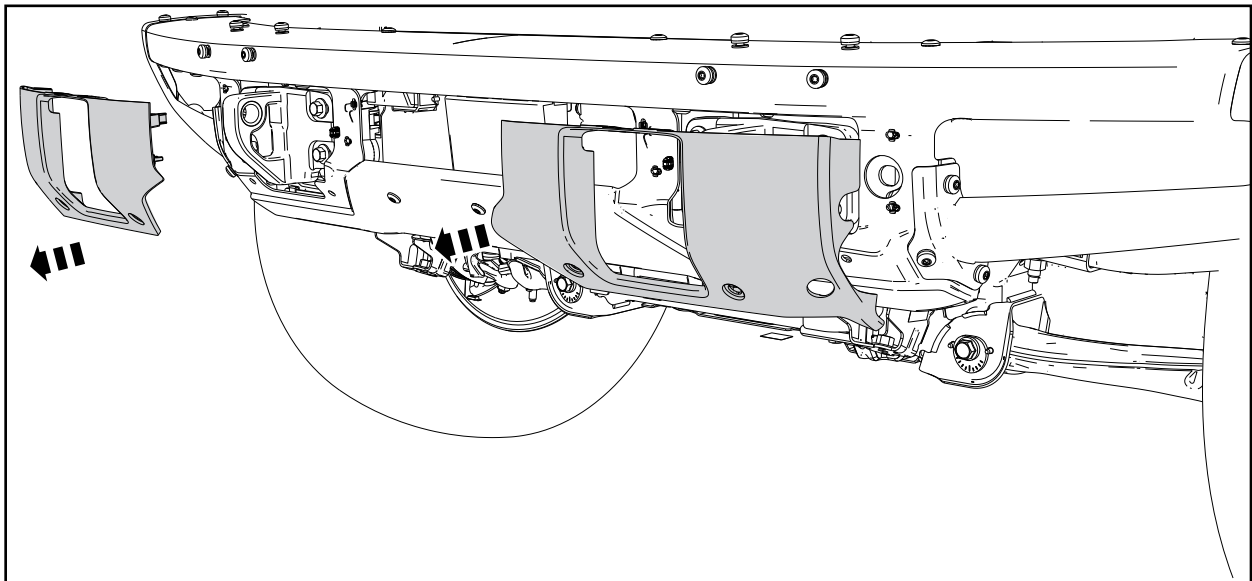

NO PART OF THIS DOCUMENT MAY BE REPRODUCED WITHOUT PRIOR AGREEMENT AND WRITTEN PERMISSION OF
FORD PERFORMANCE PARTS

4. If Equipped, remove the bolts and the safari bar.

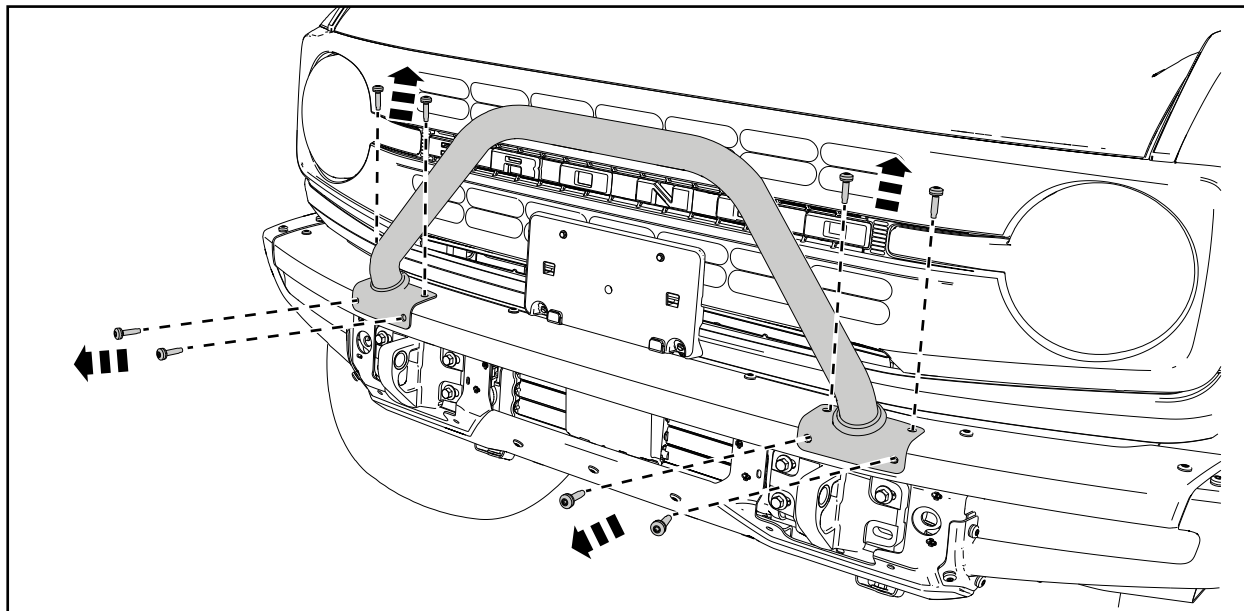

5. Install the safari bar retainers into the front bumper.

• Torque: 25 Nm (18 ft-lb)

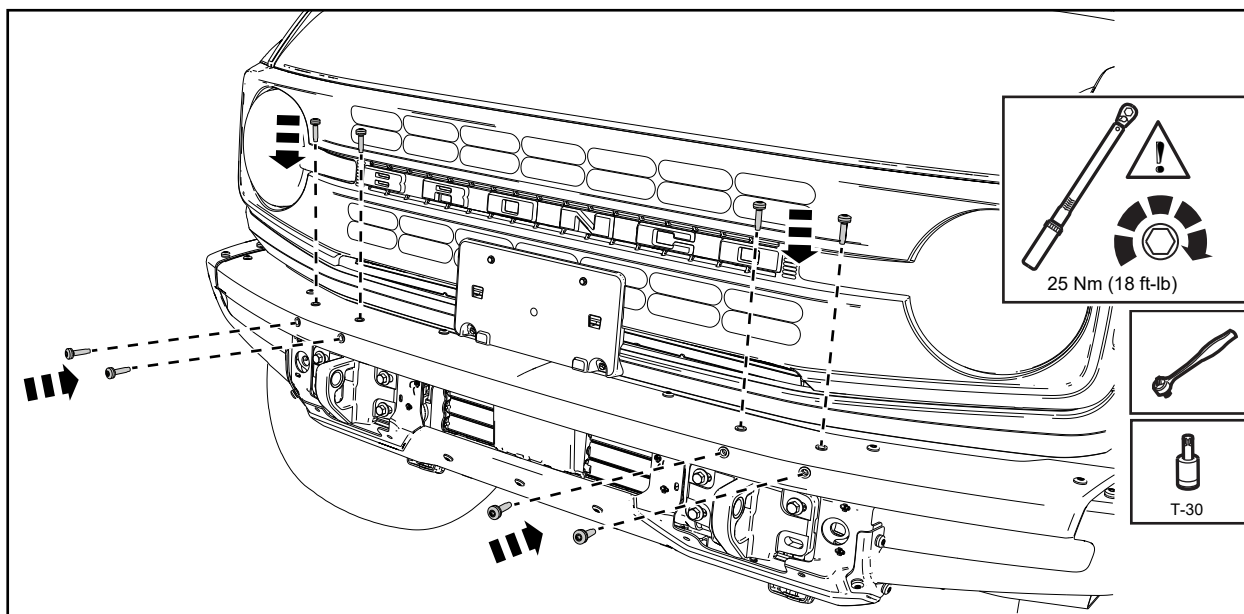

NO PART OF THIS DOCUMENT MAY BE REPRODUCED WITHOUT PRIOR AGREEMENT AND WRITTEN PERMISSION OF
FORD PERFORMANCE PARTS

NOTE: Save front bumper bolts for installation.

6. Remove the front bumper bolts.

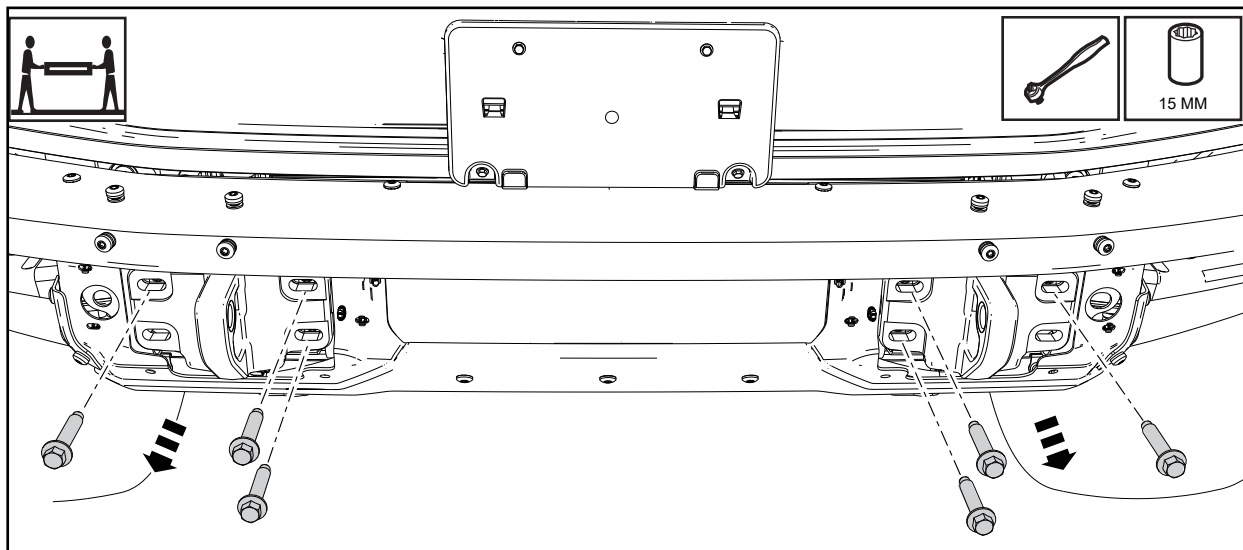

NOTE: If the bumper is equipped with a safari bar it must be removed before proceeding. The mounting bolts should be reinstalled and torqued to 18 lb.ft (25 Nm).

7. Remove the front bumper.

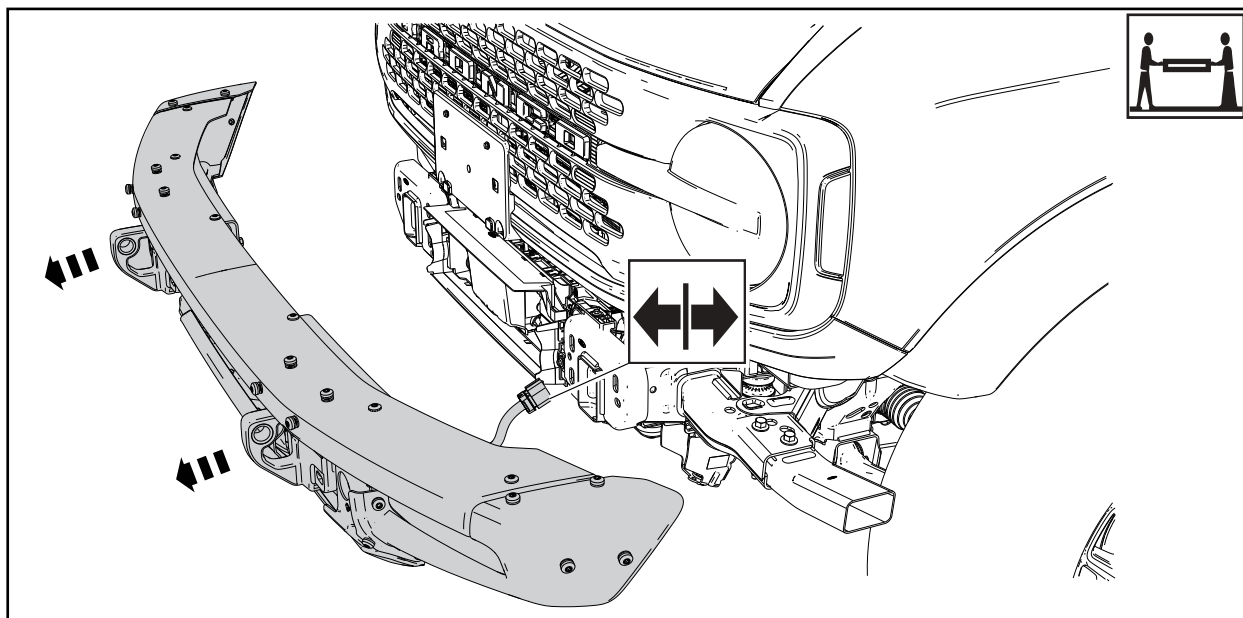

NO PART OF THIS DOCUMENT MAY BE REPRODUCED WITHOUT PRIOR AGREEMENT AND WRITTEN PERMISSION OF
FORD PERFORMANCE PARTS

8. Remove the retainers and the front license plate mounting bracket.

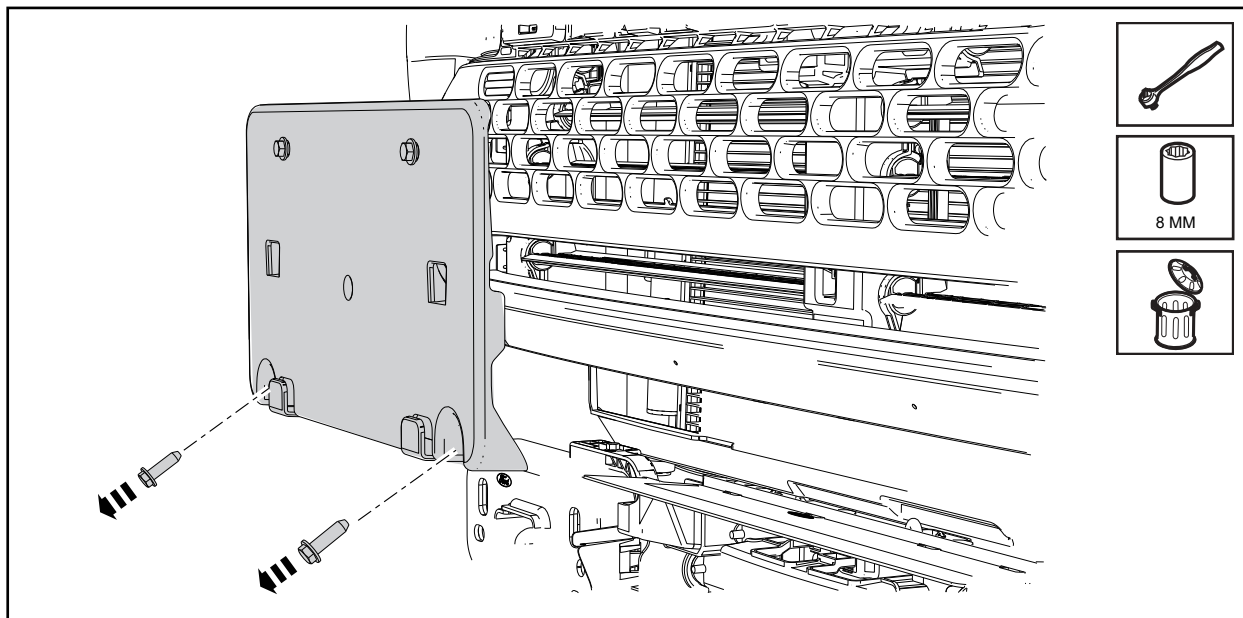

9. Remove the recovery hook holding bolts.

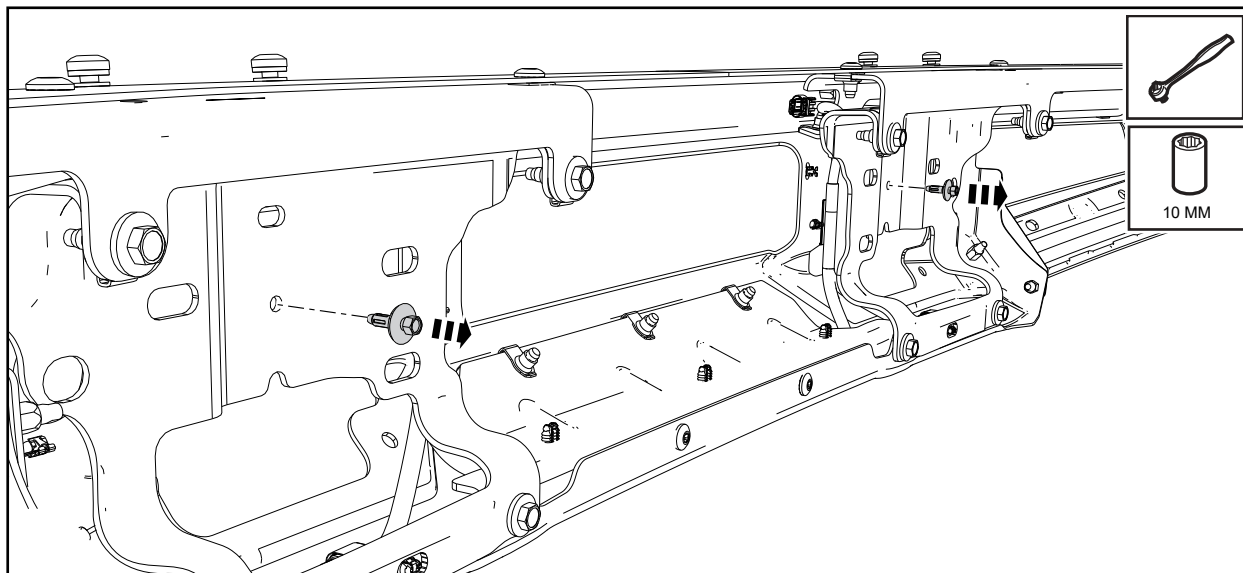

NO PART OF THIS DOCUMENT MAY BE REPRODUCED WITHOUT PRIOR AGREEMENT AND WRITTEN PERMISSION OF
FORD PERFORMANCE PARTS

10. Remove and discard the recovery hooks.

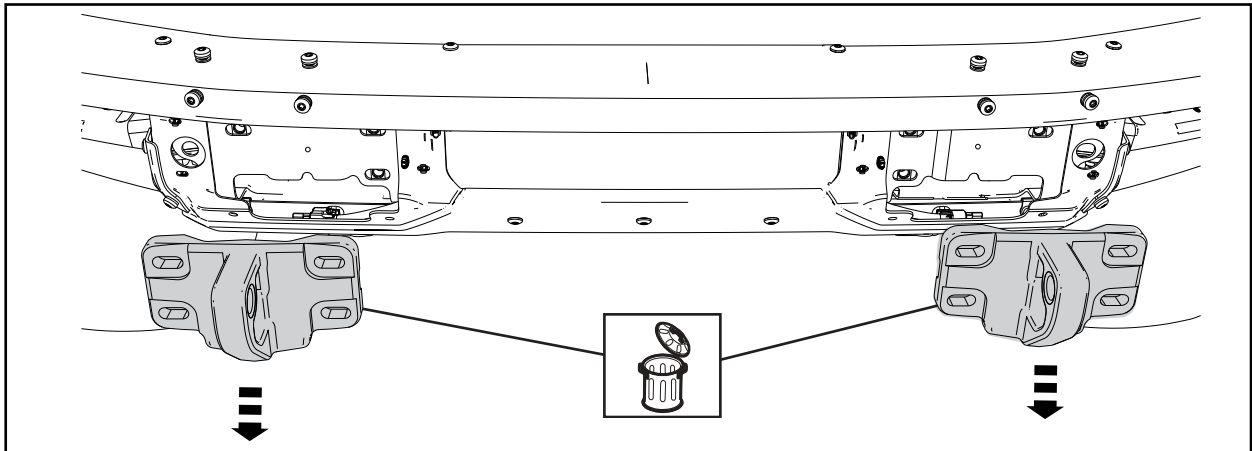

11. Remove the plastic holding nuts on both sides of the vehicle.

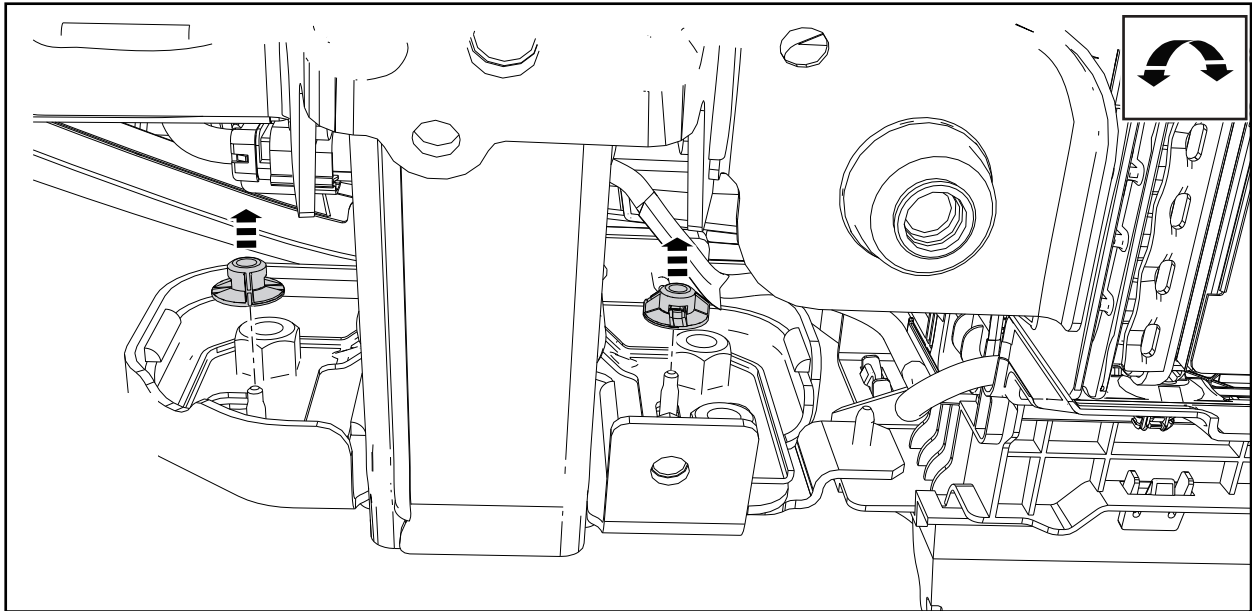

NO PART OF THIS DOCUMENT MAY BE REPRODUCED WITHOUT PRIOR AGREEMENT AND WRITTEN PERMISSION OF
FORD PERFORMANCE PARTS

12. Remove and discard the frame nut plate on both sides of the vehicle.

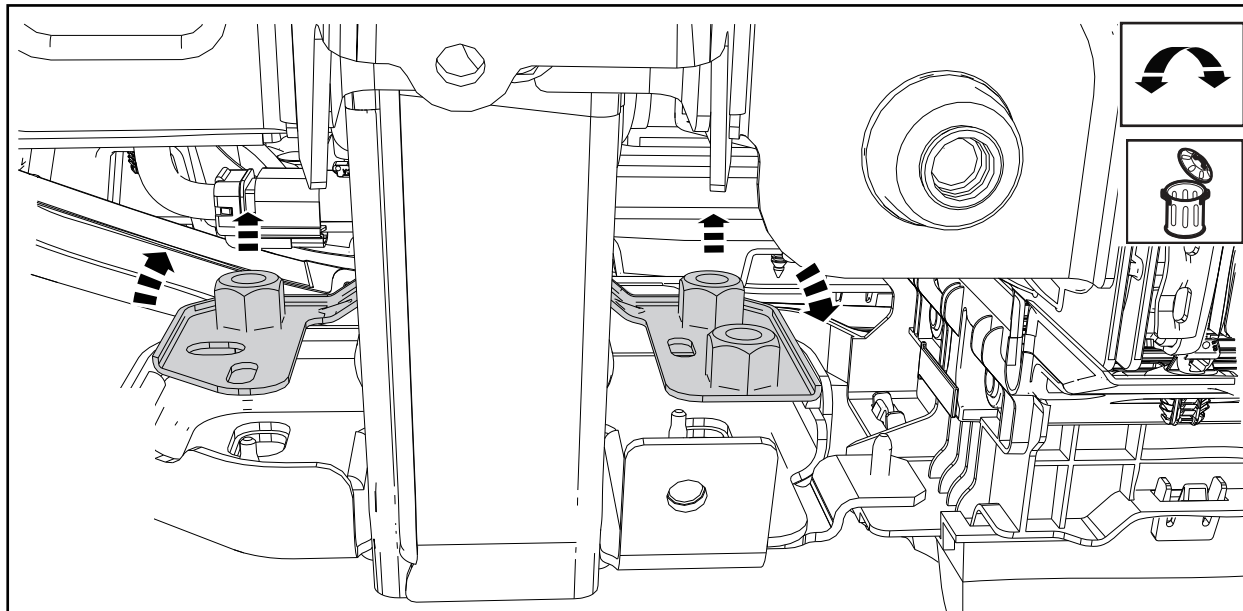

13. Install the two clevis brackets to the bumper.

• Torque: 10.5 Nm (7.5 ft-lb)

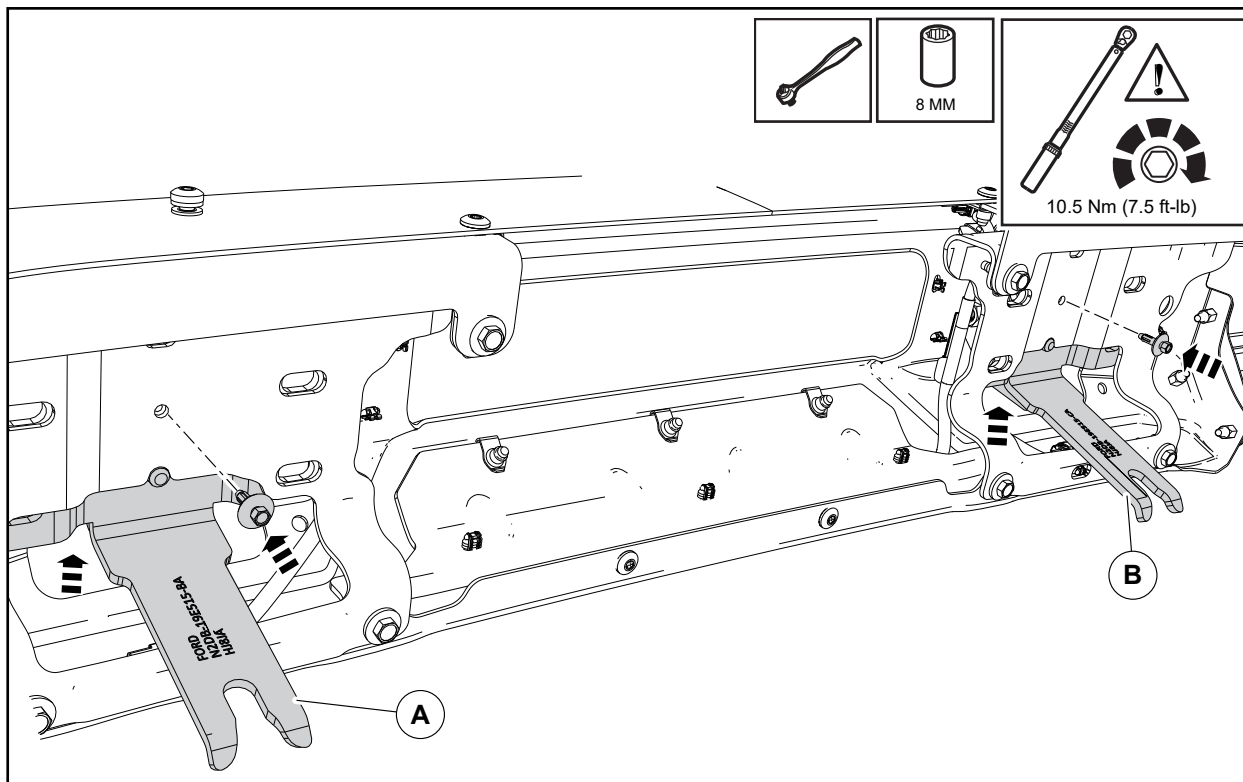

Ford Factory Shop Manual purchase options www.motorcraftservice.com

NO PART OF THIS DOCUMENT MAY BE REPRODUCED WITHOUT PRIOR AGREEMENT AND WRITTEN PERMISSION OF
FORD PERFORMANCE PARTS

NOTE: Save frame bolts for installation (*).

14. Remove the two frame bolts. Perform this step on both sides.

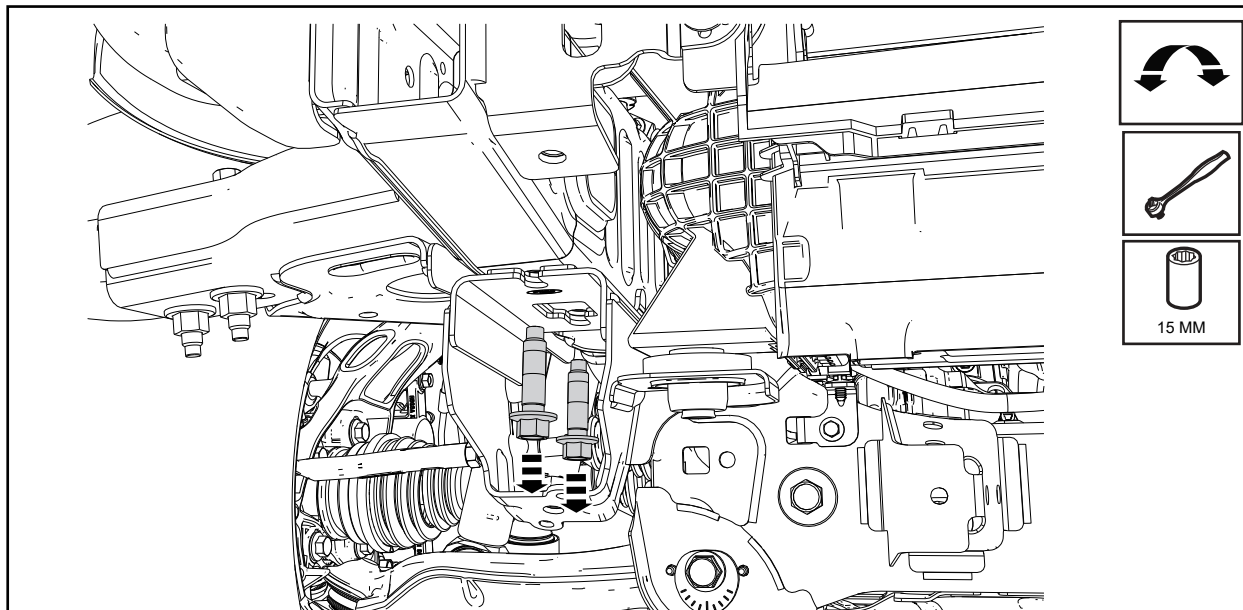

15. Install the winch CAC bracket and the bolts saved from step 14 to the frame.

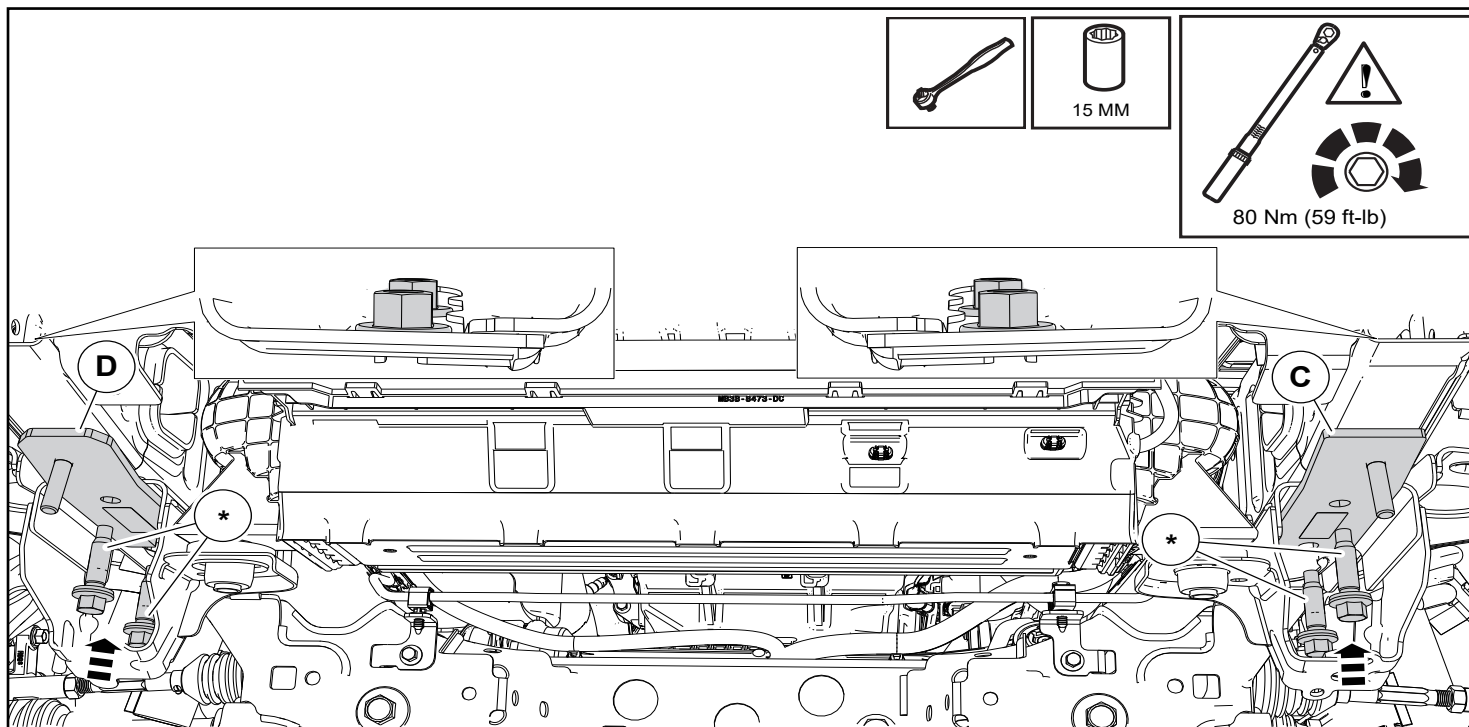

NO PART OF THIS DOCUMENT MAY BE REPRODUCED WITHOUT PRIOR AGREEMENT AND WRITTEN PERMISSION OF
FORD PERFORMANCE PARTS

16. Install the shoulder bolt into the frame rail. Perform this step on both sides of the vehicle.

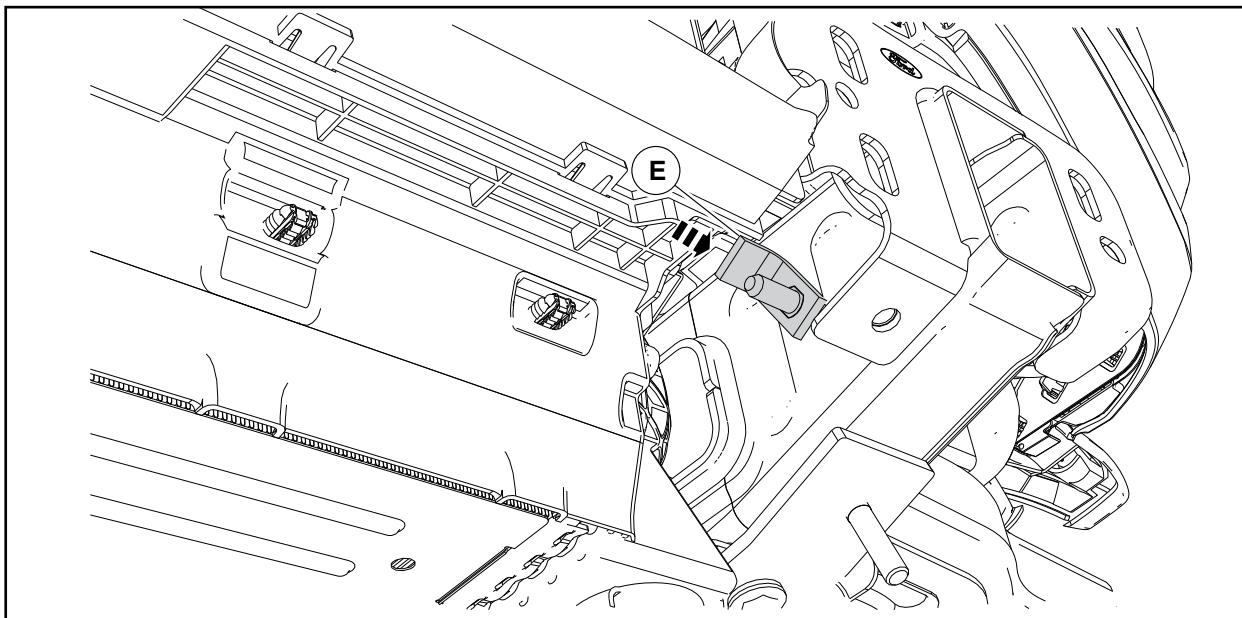

17. Install the left hand inner and outer bracket to the frame rail. Hand tighten the nuts at this time.

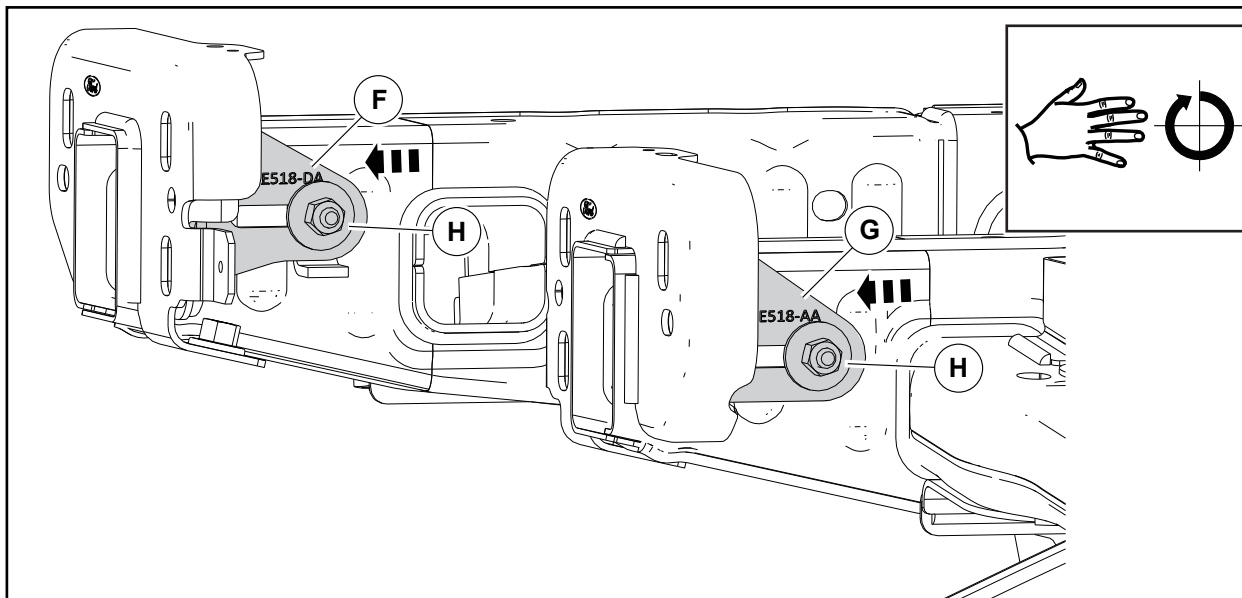

NO PART OF THIS DOCUMENT MAY BE REPRODUCED WITHOUT PRIOR AGREEMENT AND WRITTEN PERMISSION OF FORD PERFORMANCE PARTS

18. Install the right hand inner and outer bracket to the frame rail. Hand tighten the nuts at this time.

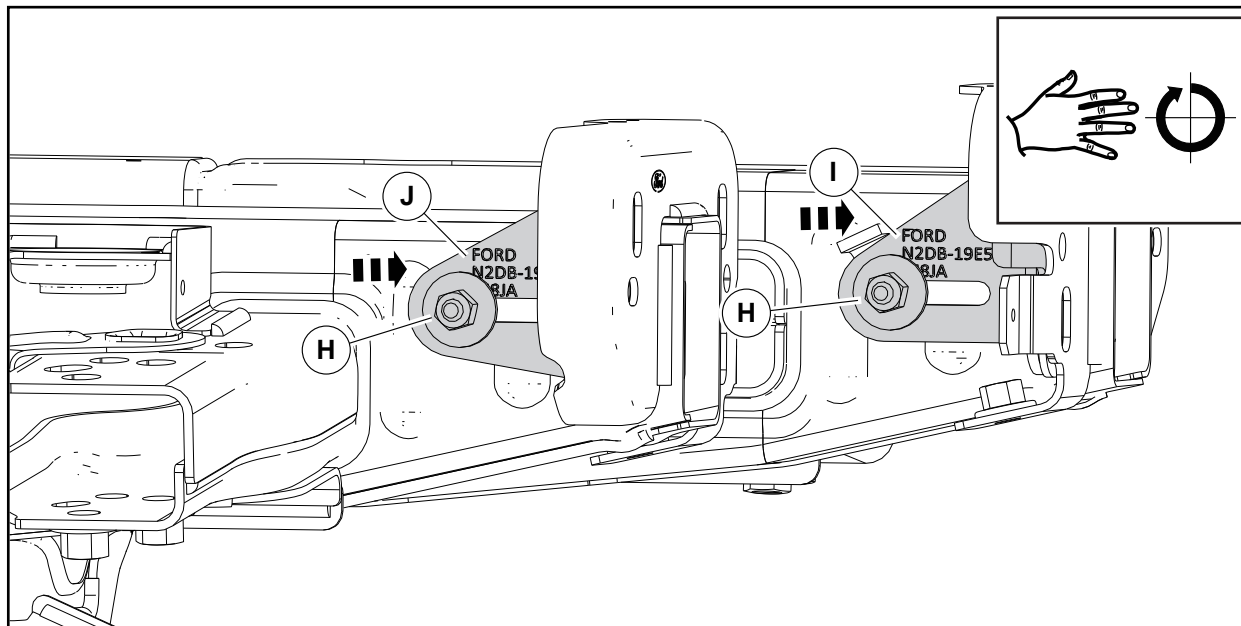

19. Install the frame rail bracket.

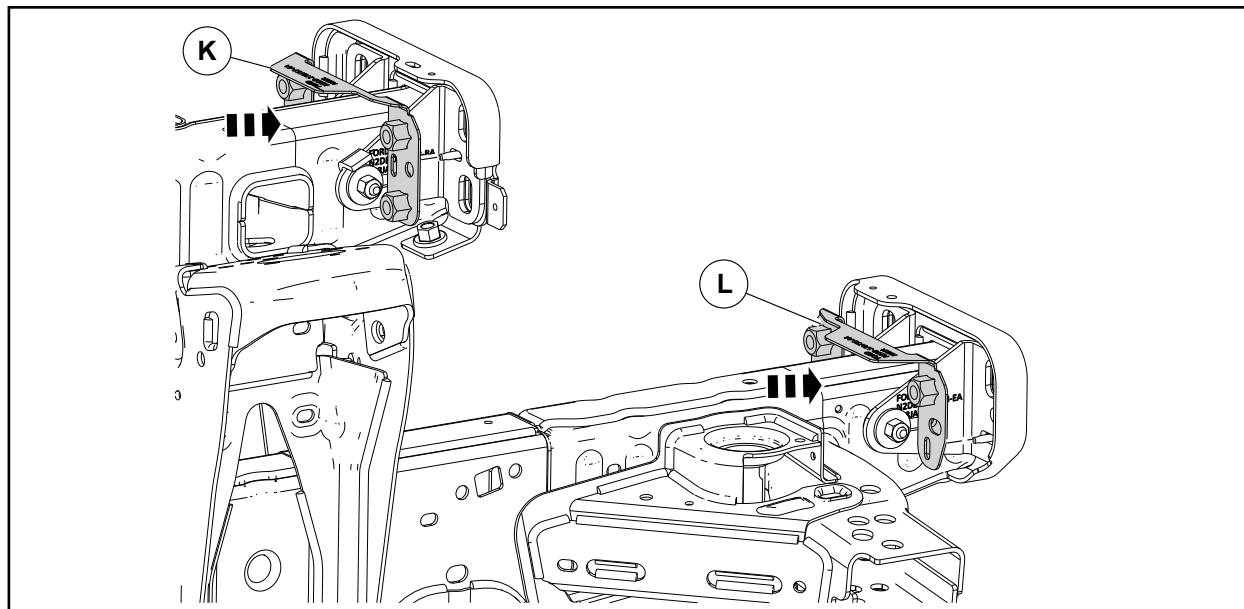

NO PART OF THIS DOCUMENT MAY BE REPRODUCED WITHOUT PRIOR AGREEMENT AND WRITTEN PERMISSION OF
FORD PERFORMANCE PARTS

20. Starting by hand, install the plastic holding nuts. Perform this step on both sides.

- Torque: 10 Nm (7 ft-lb)

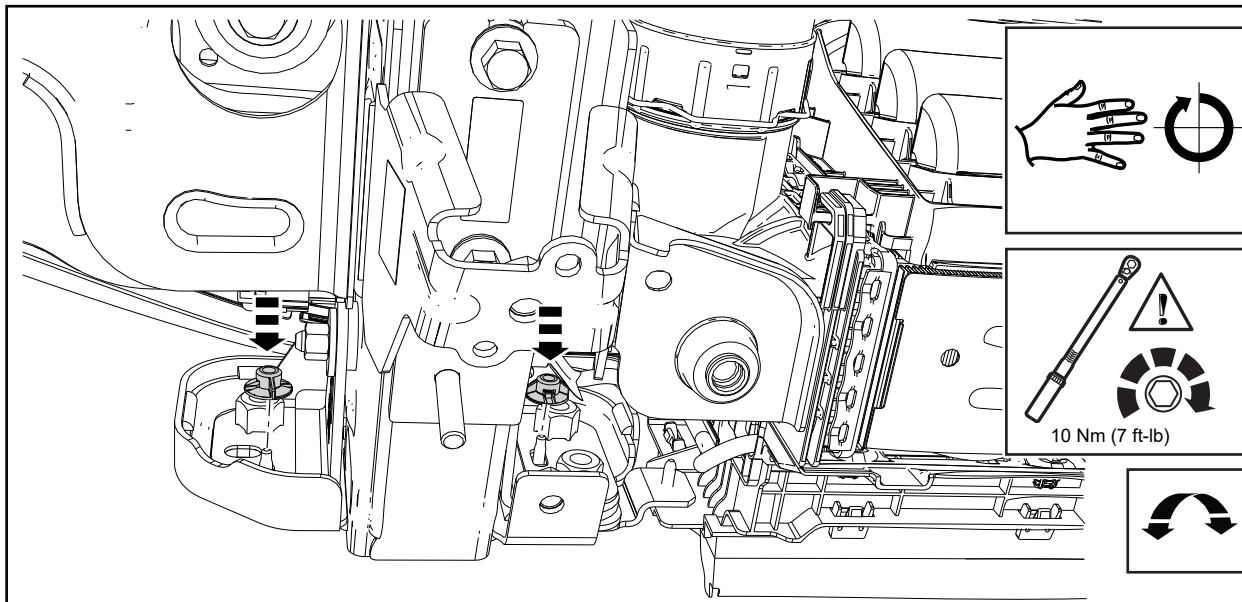

21. Tighten all 4 inner and outer brackets nuts.

- Torque: 48 Nm (35.5 ft-lb)

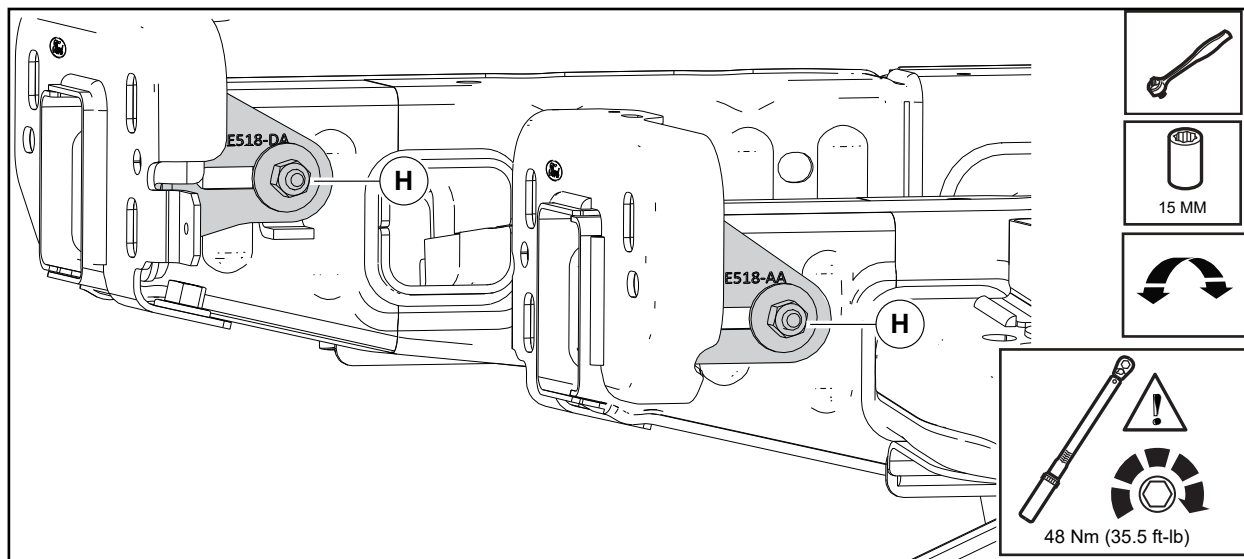

NO PART OF THIS DOCUMENT MAY BE REPRODUCED WITHOUT PRIOR AGREEMENT AND WRITTEN PERMISSION OF
FORD PERFORMANCE PARTS

22. Install the front bumper and connect the electrical connector.

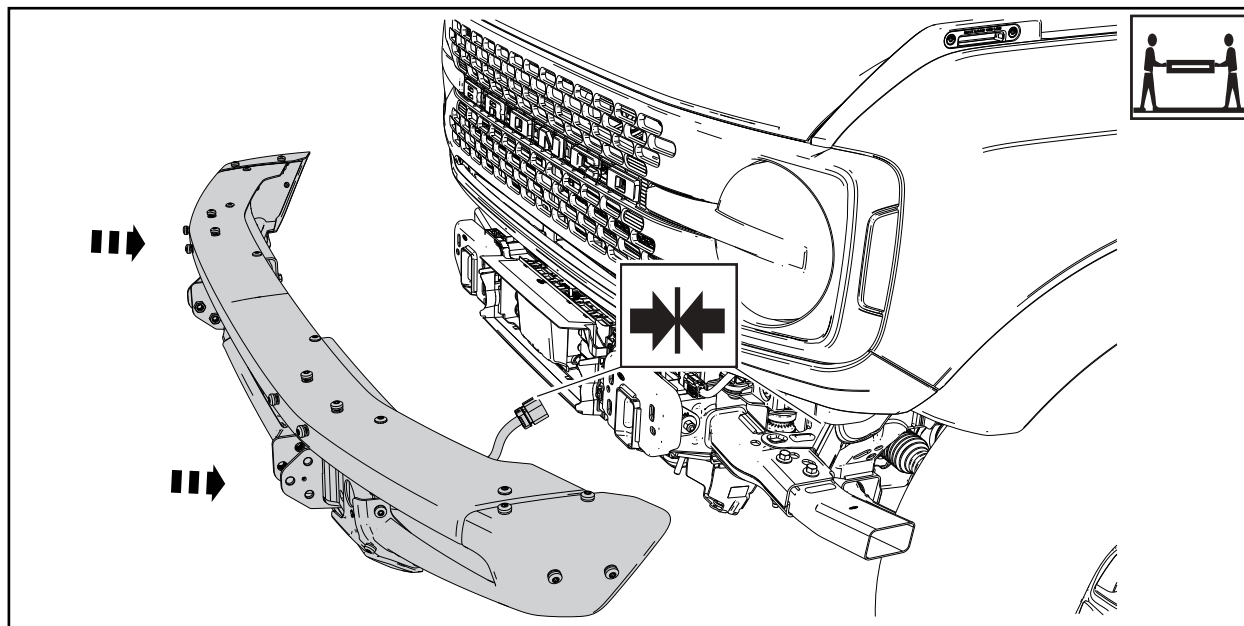

NOTE: Bolts saved from step 6.

23. Install the front bumper retainers.

- Torque: 80 Nm (59 ft-lb)

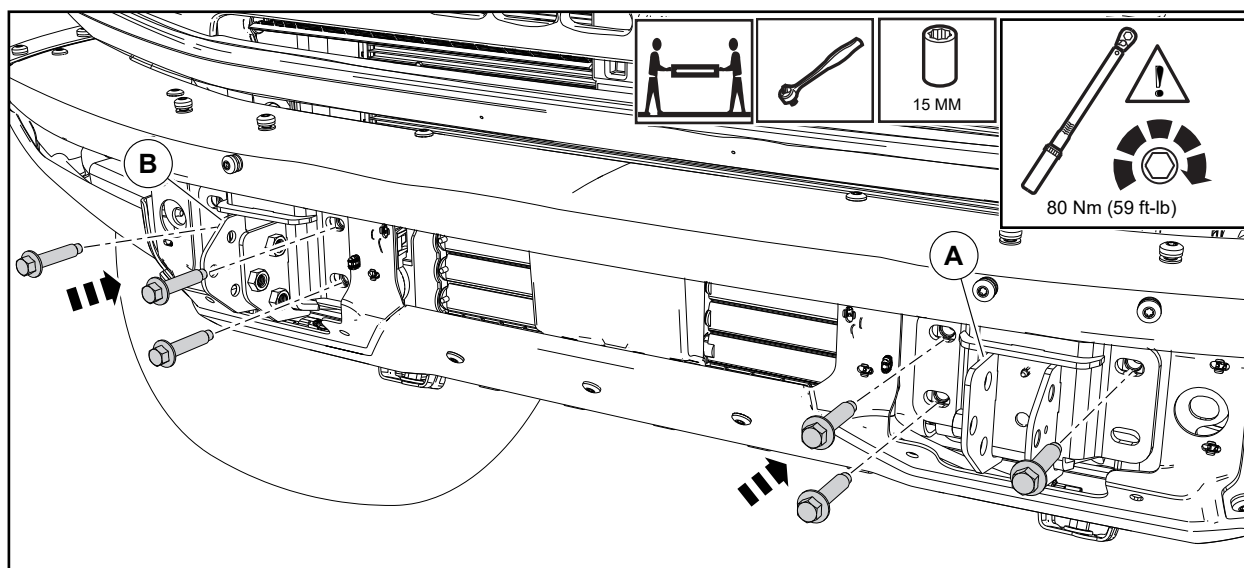

NO PART OF THIS DOCUMENT MAY BE REPRODUCED WITHOUT PRIOR AGREEMENT AND WRITTEN PERMISSION OF
FORD PERFORMANCE PARTS

24. Install the clevis bracket nuts.

- Torque: 35 Nm (25.8 ft-lb)

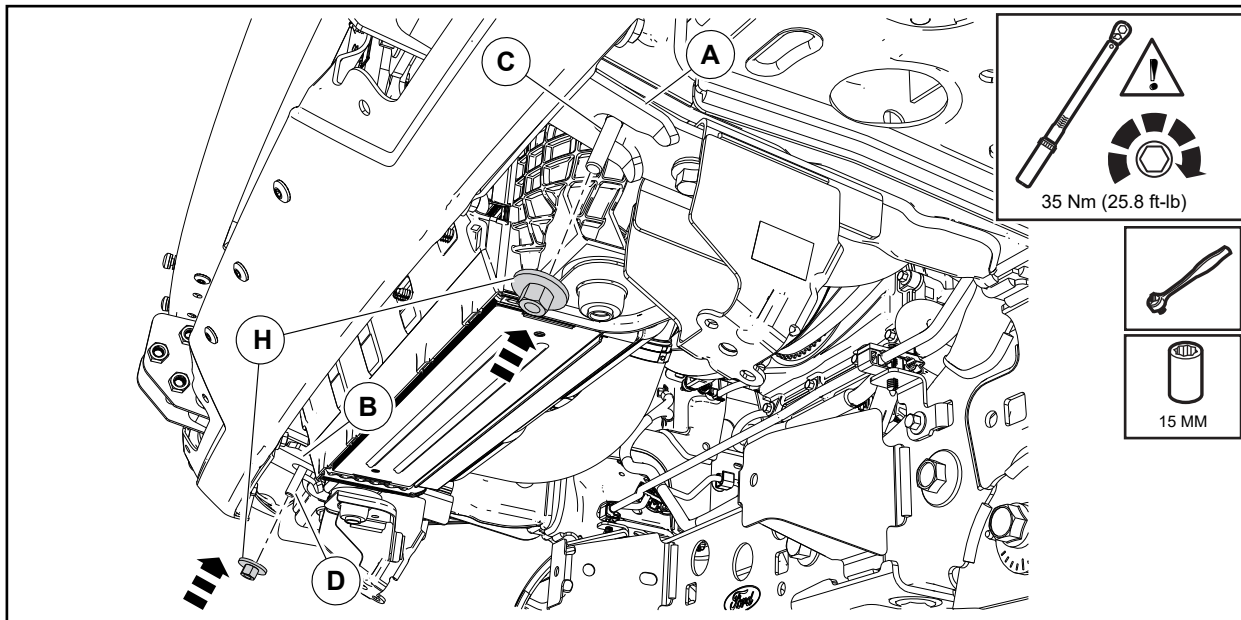

25. Install the recover forging into the clevis bracket.

- Torque: 110 Nm (81 ft-lb)

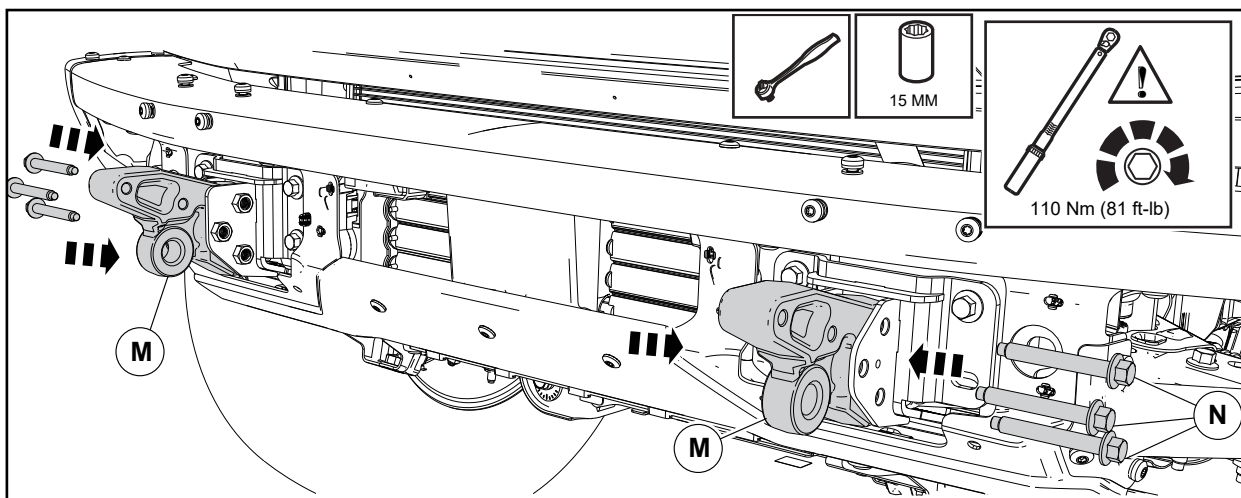

NO PART OF THIS DOCUMENT MAY BE REPRODUCED WITHOUT PRIOR AGREEMENT AND WRITTEN PERMISSION OF
FORD PERFORMANCE PARTS

26. Install the front bumper trim panels.

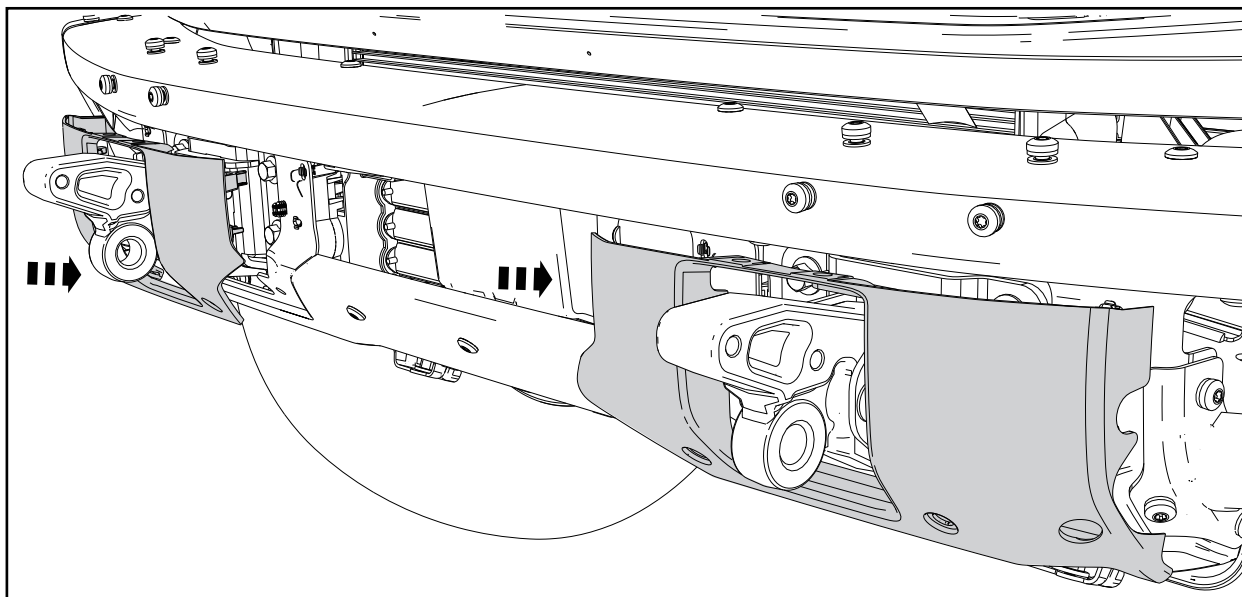

27. Install the front bumper trim panel push pins.

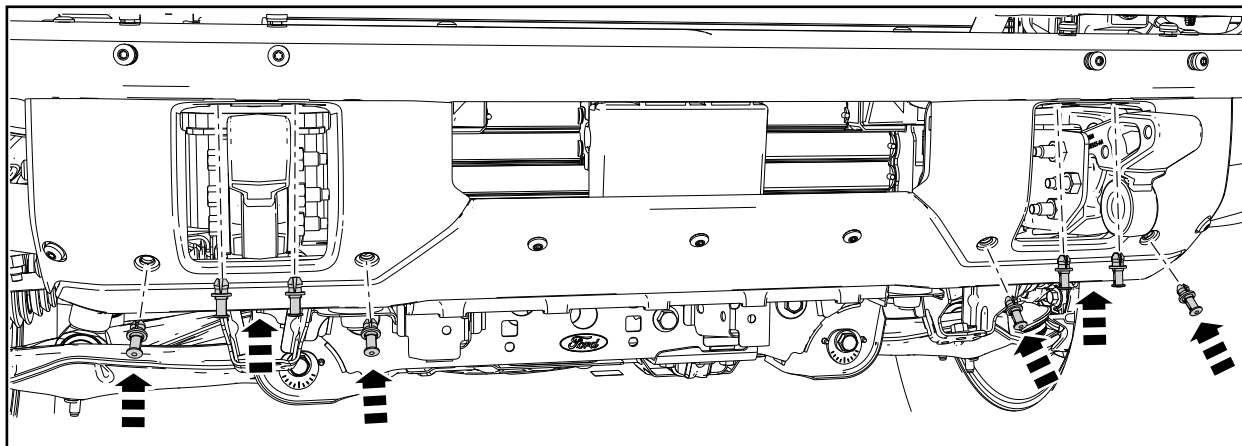

NO PART OF THIS DOCUMENT MAY BE REPRODUCED WITHOUT PRIOR AGREEMENT AND WRITTEN PERMISSION OF
FORD PERFORMANCE PARTS

28. Install the recovery forging mounting bracket.

- Torque: 80 Nm (59 ft-lb)

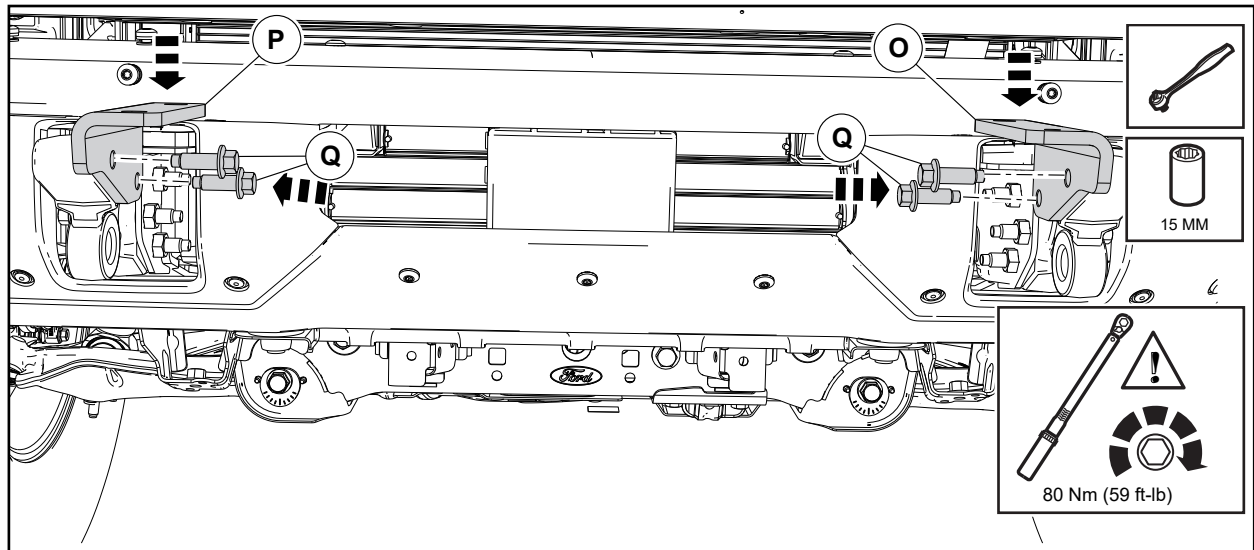

NOTE: Installation of license plate bracket is optional depending on local regulations.

29. Install the fairlead to the winch plate.

- Torque: 47.5 Nm (35 ft-lb)

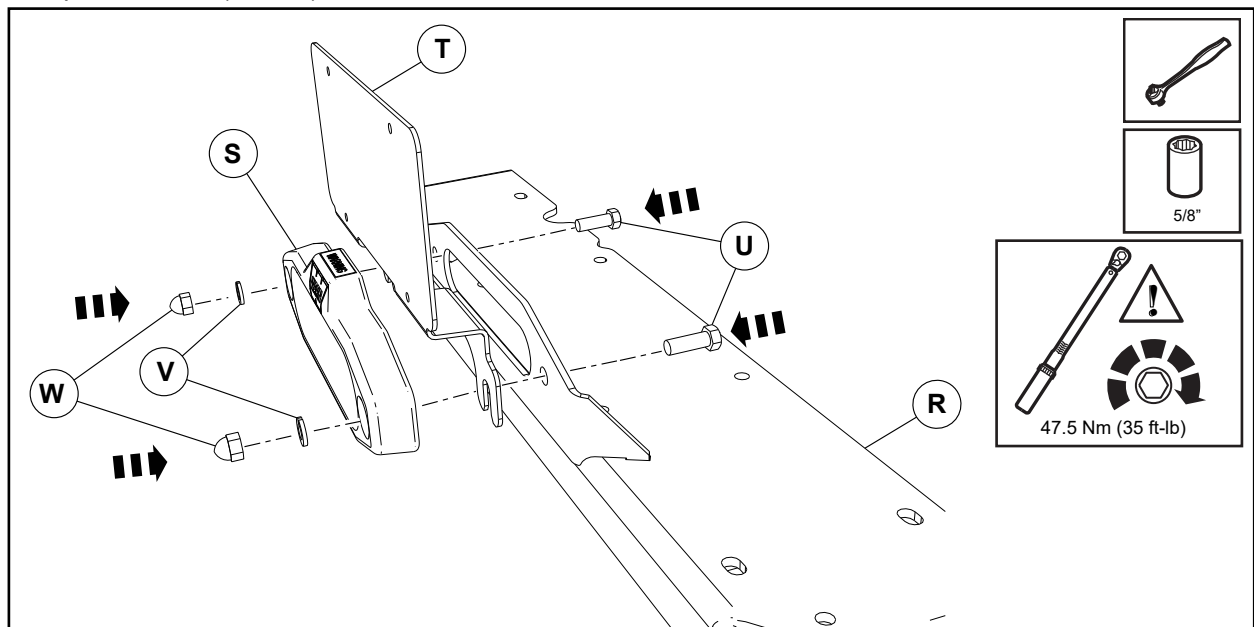

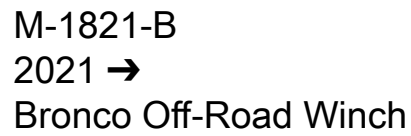

30. If equipped, install the license plate to license plate mounting bracket retainers.

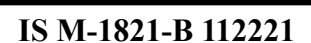
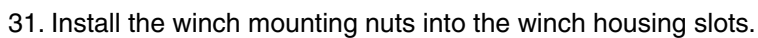

NO PART OF THIS DOCUMENT MAY BE REPRODUCED WITHOUT PRIOR AGREEMENT AND WRITTEN PERMISSION OF
FORD PERFORMANCE PARTS

32. Route the winch rope through the fairlead and install the winch to the winch plate.

• Torque: 47.5 Nm (35 ft-lb)

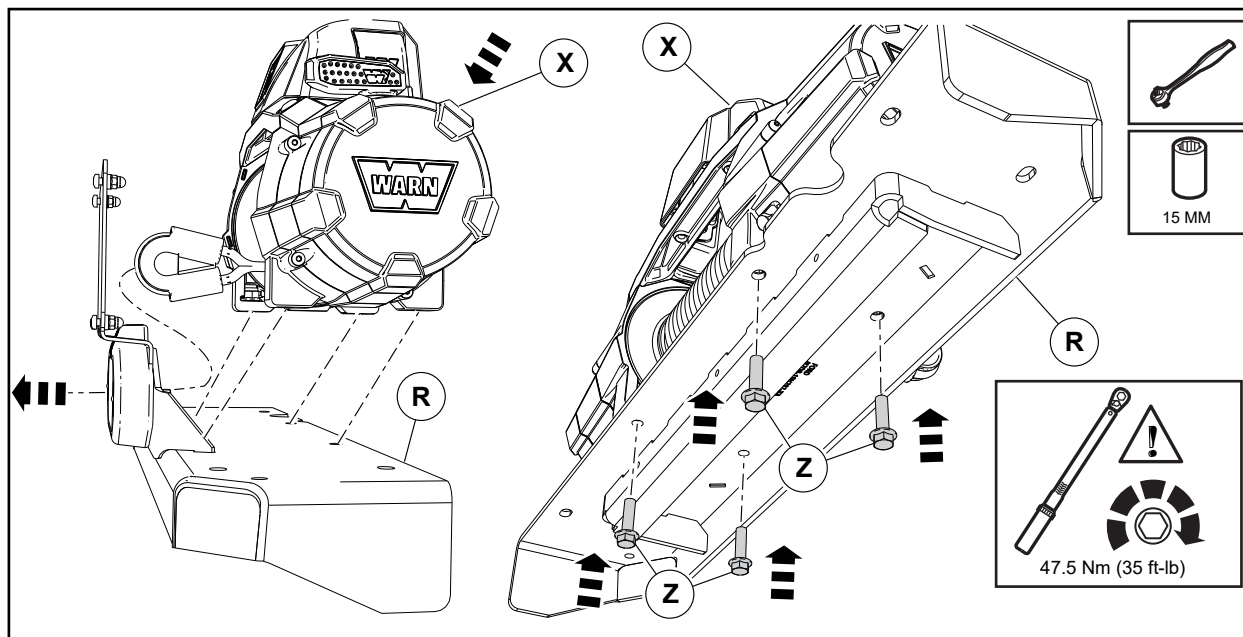

33. Engage the winch wire harness push pin retainers into the winch plate.

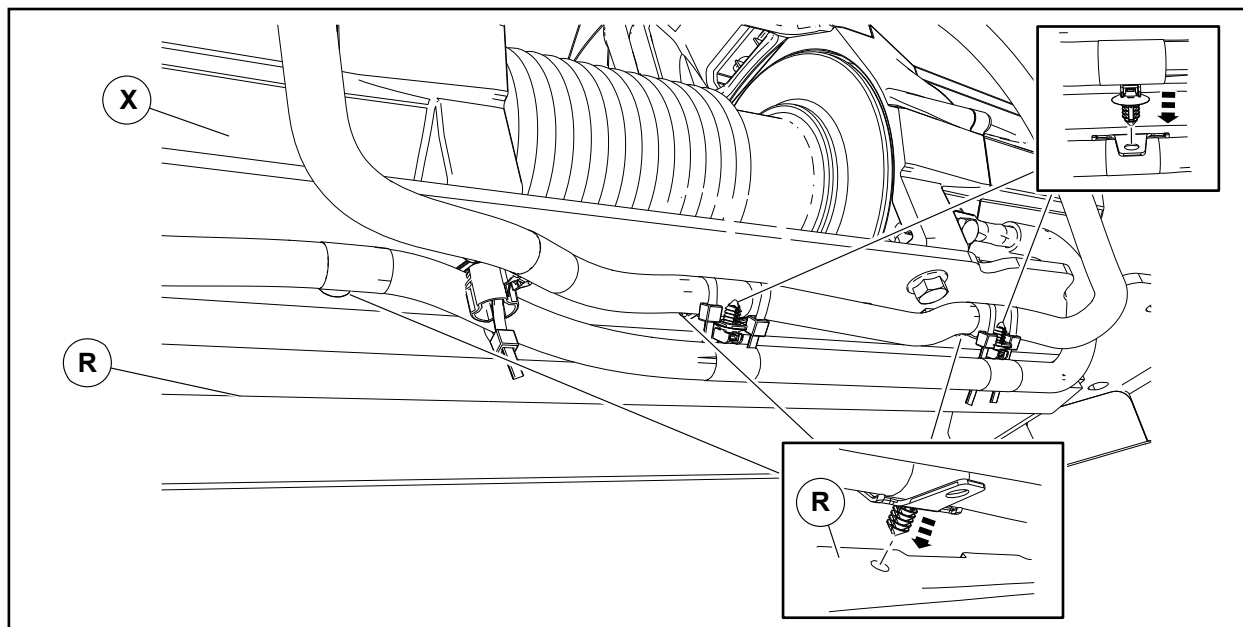

NO PART OF THIS DOCUMENT MAY BE REPRODUCED WITHOUT PRIOR AGREEMENT AND WRITTEN PERMISSION OF
FORD PERFORMANCE PARTS

34. Install the brush bar to the winch plate.

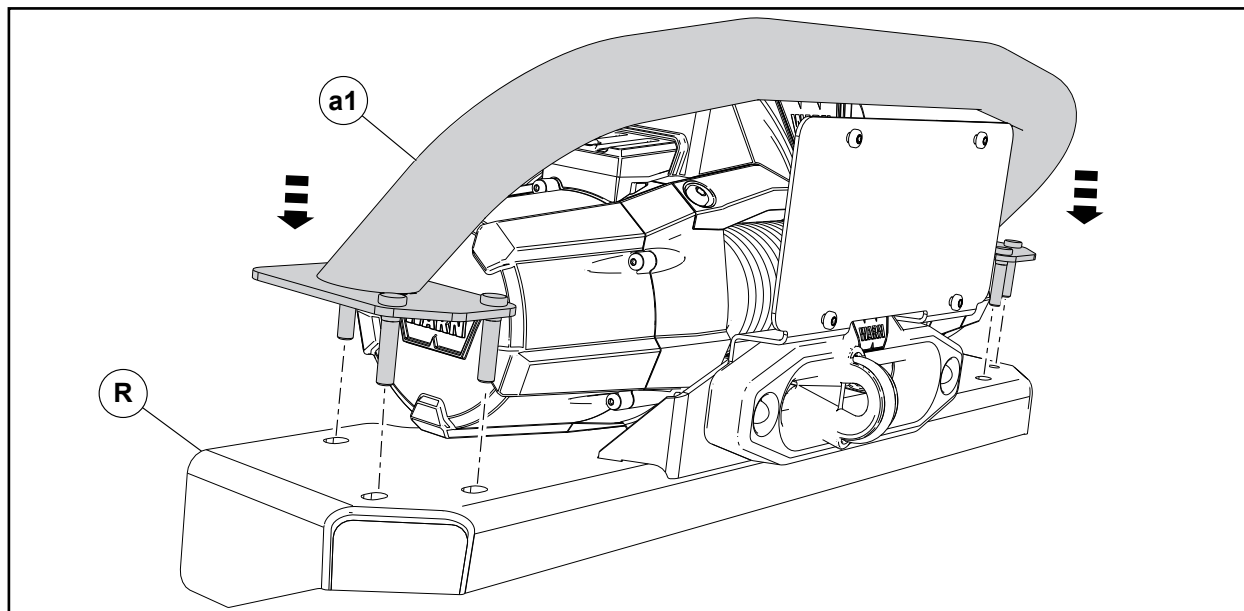

35. Install the brush bar outboard nut.

• Torque: 47.5 Nm (35 ft-lb)

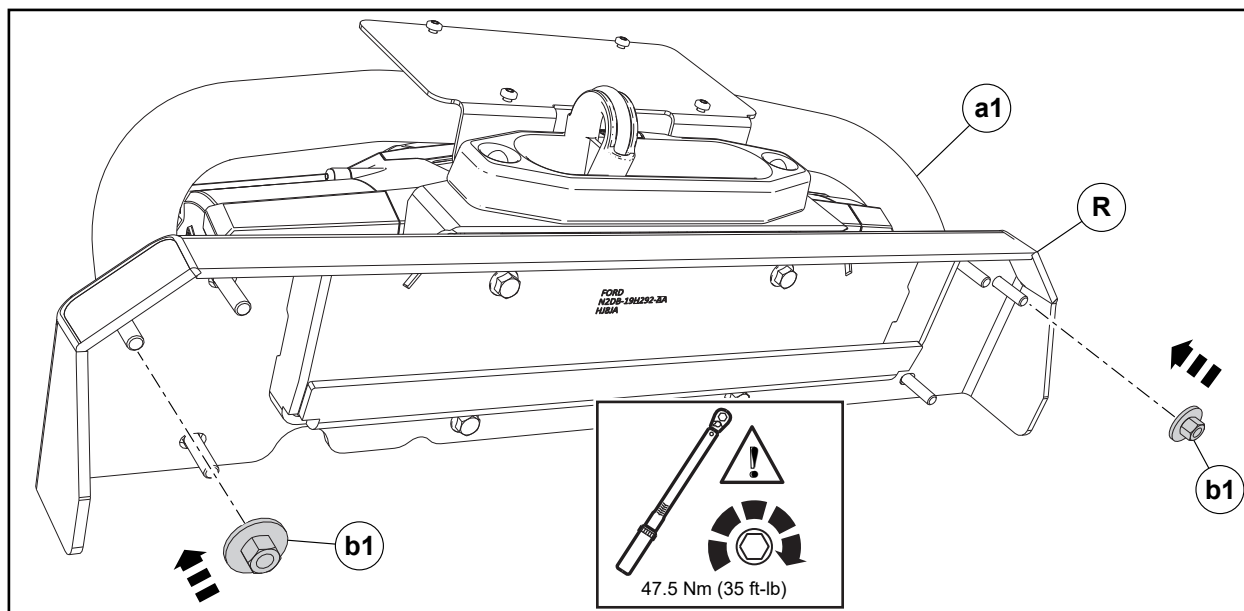

NO PART OF THIS DOCUMENT MAY BE REPRODUCED WITHOUT PRIOR AGREEMENT AND WRITTEN PERMISSION OF
FORD PERFORMANCE PARTS

36. Install the winch assembly to the recovery forging mounting brackets.

- Torque: 47.5 Nm (35 ft-lb)

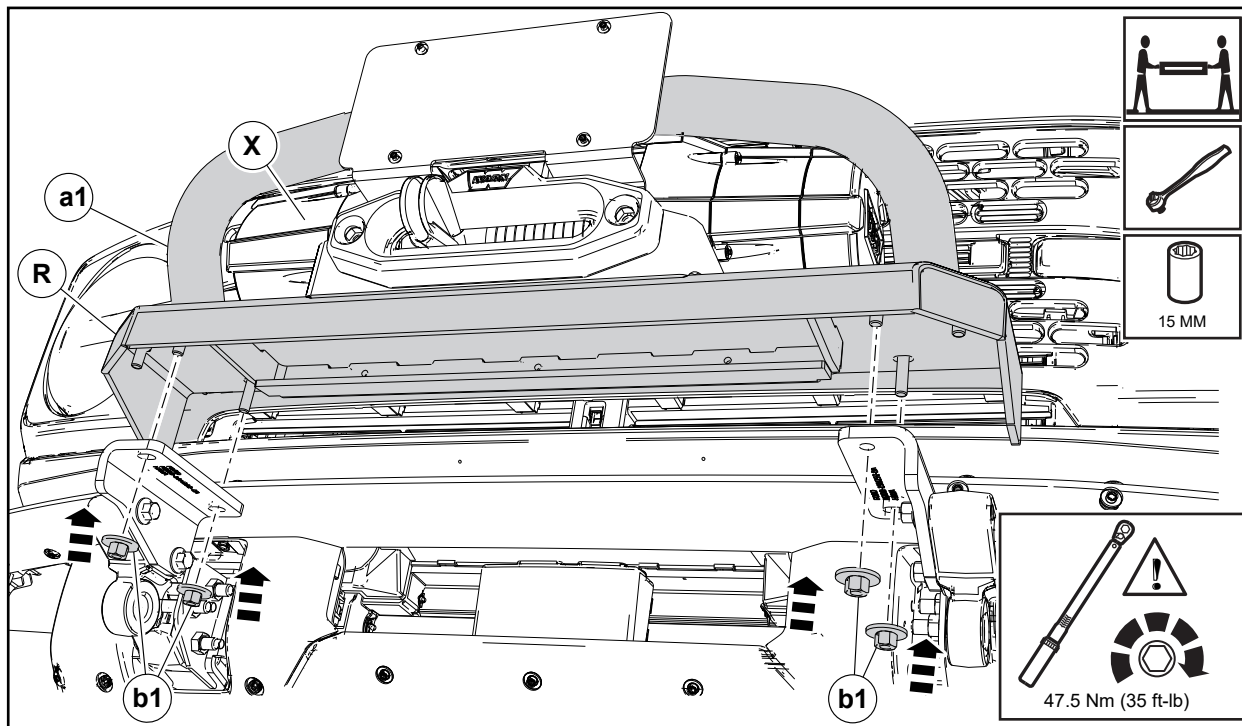

37. Remove the lug nuts and the left hand tire.

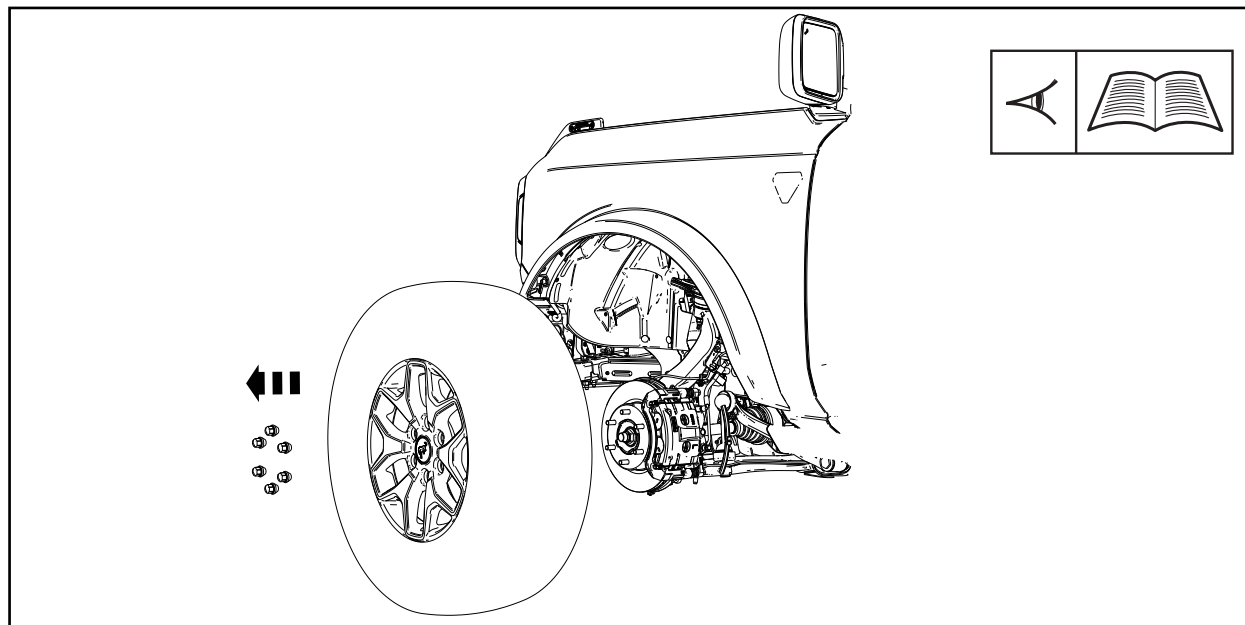

NO PART OF THIS DOCUMENT MAY BE REPRODUCED WITHOUT PRIOR AGREEMENT AND WRITTEN PERMISSION OF
FORD PERFORMANCE PARTS

38. Remove the retainers and the left hand wheel well splash shield.

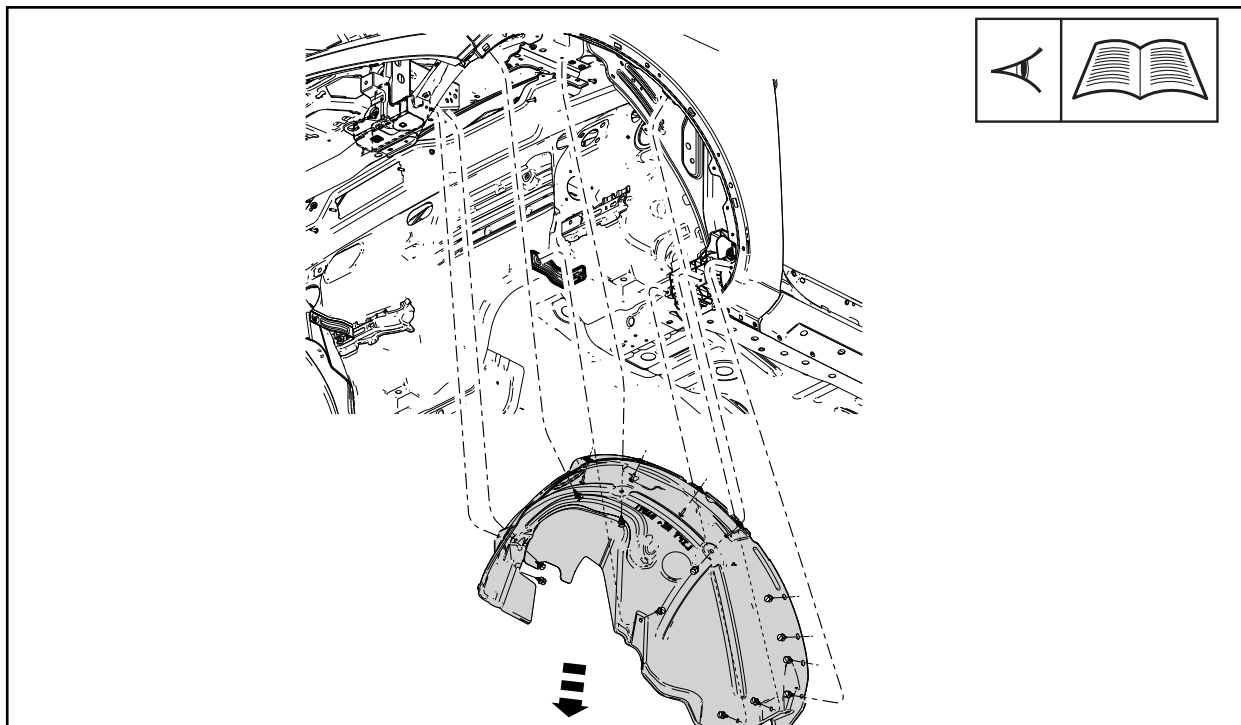

39. Route the positive battery cable under the winch plate and through the left hand side of the center bumper opening. Route the negative cable over top of the left hand recovery forging.

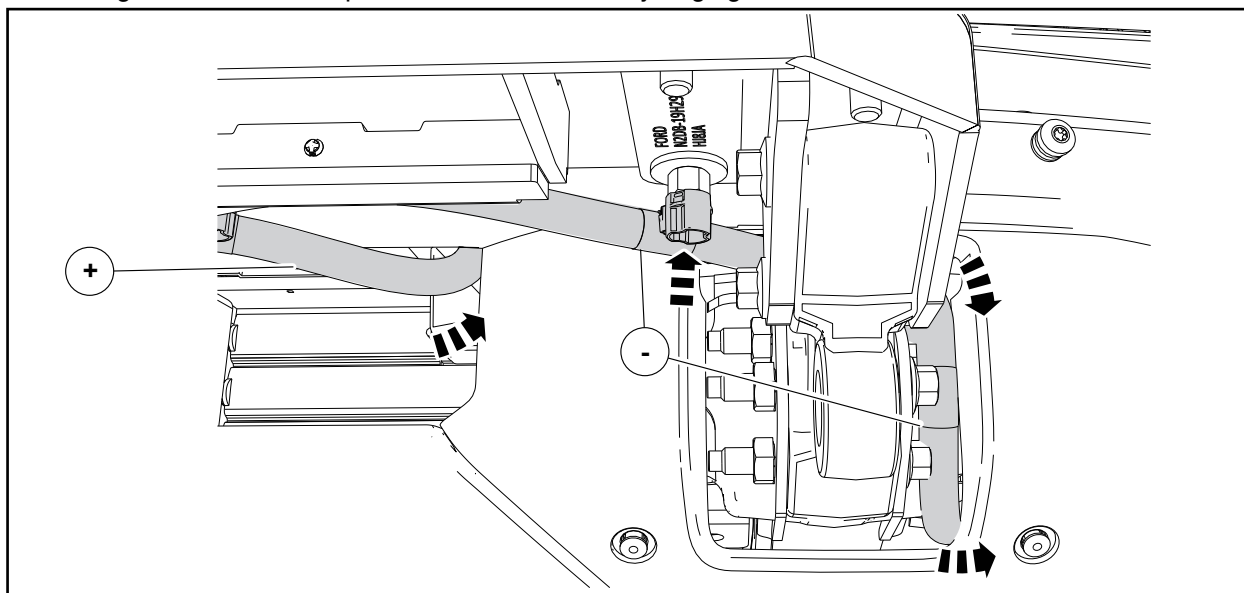

NO PART OF THIS DOCUMENT MAY BE REPRODUCED WITHOUT PRIOR AGREEMENT AND WRITTEN PERMISSION OF
FORD PERFORMANCE PARTS

40. Route the positive cable through the frame towards the left hand side of the vehicle.

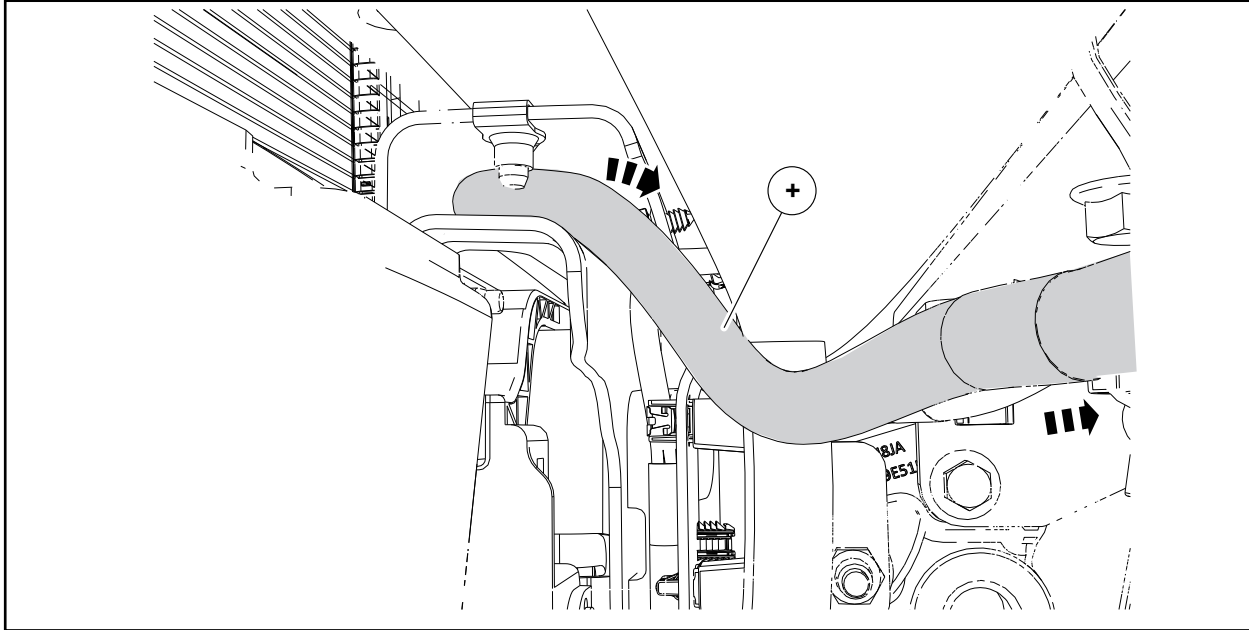

NO PART OF THIS DOCUMENT MAY BE REPRODUCED WITHOUT PRIOR AGREEMENT AND WRITTEN PERMISSION OF
FORD PERFORMANCE PARTS

41. Route the positive and negative cables upwards towards the battery. Secure the cables to the existing wiring harness using tie straps.

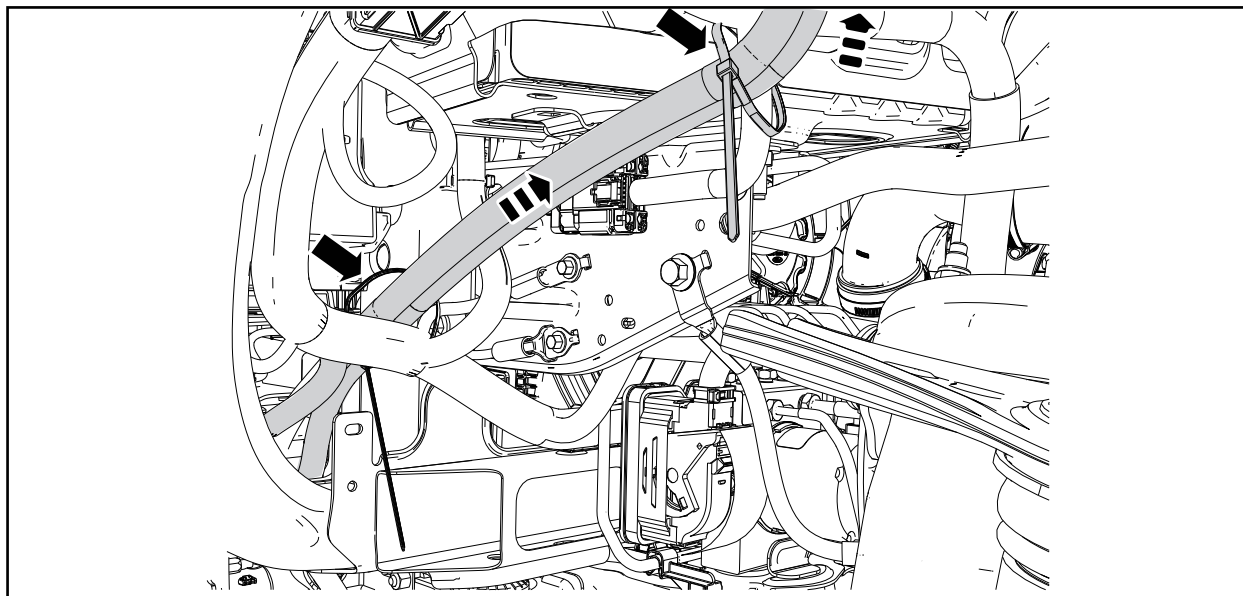
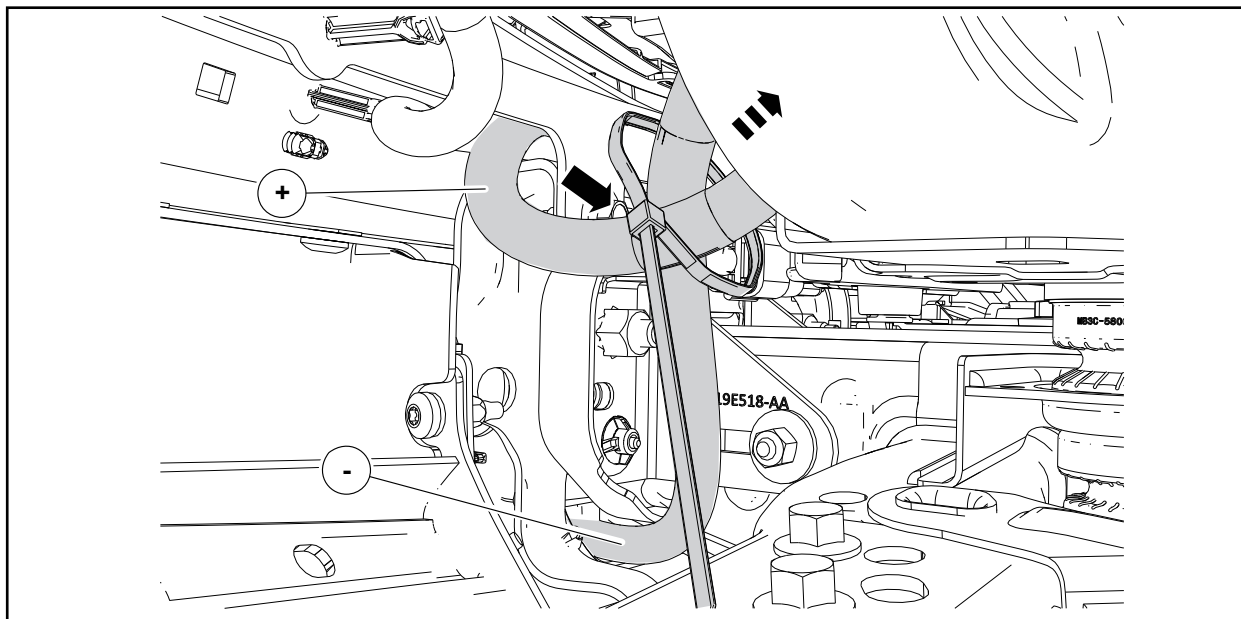

NO PART OF THIS DOCUMENT MAY BE REPRODUCED WITHOUT PRIOR AGREEMENT AND WRITTEN PERMISSION OF
FORD PERFORMANCE PARTS

42. Open the hood of the vehicle.

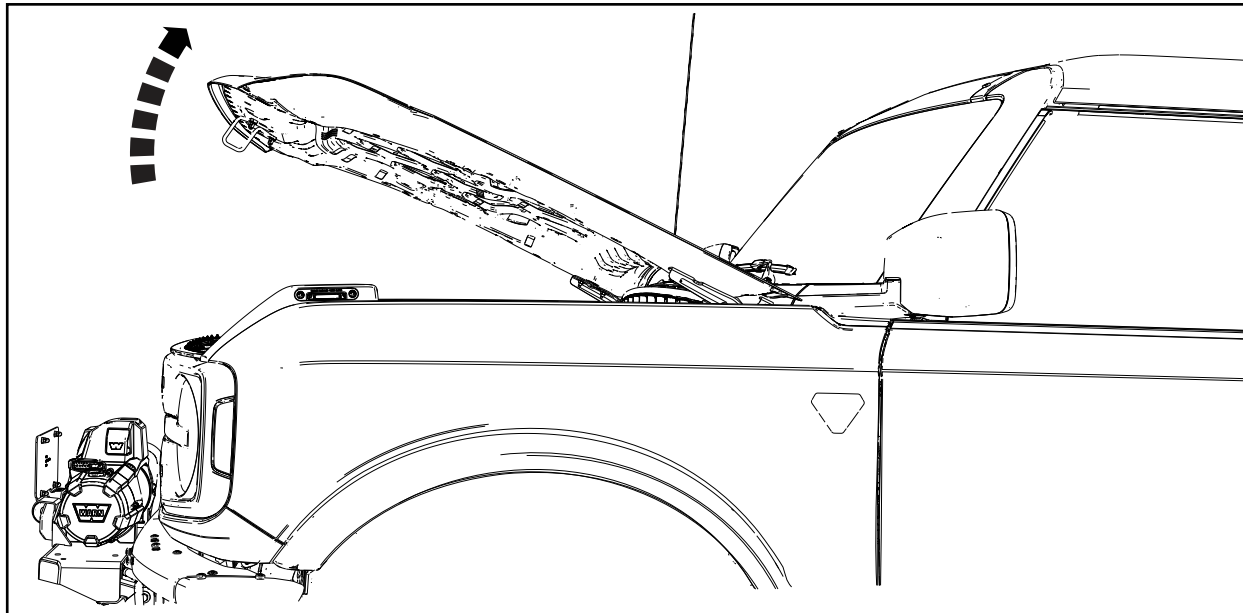

43. Connect the positive winch cable to the positive bus bar on the vehicles battery.

• Torque: 13.5 Nm (10 ft-lb)

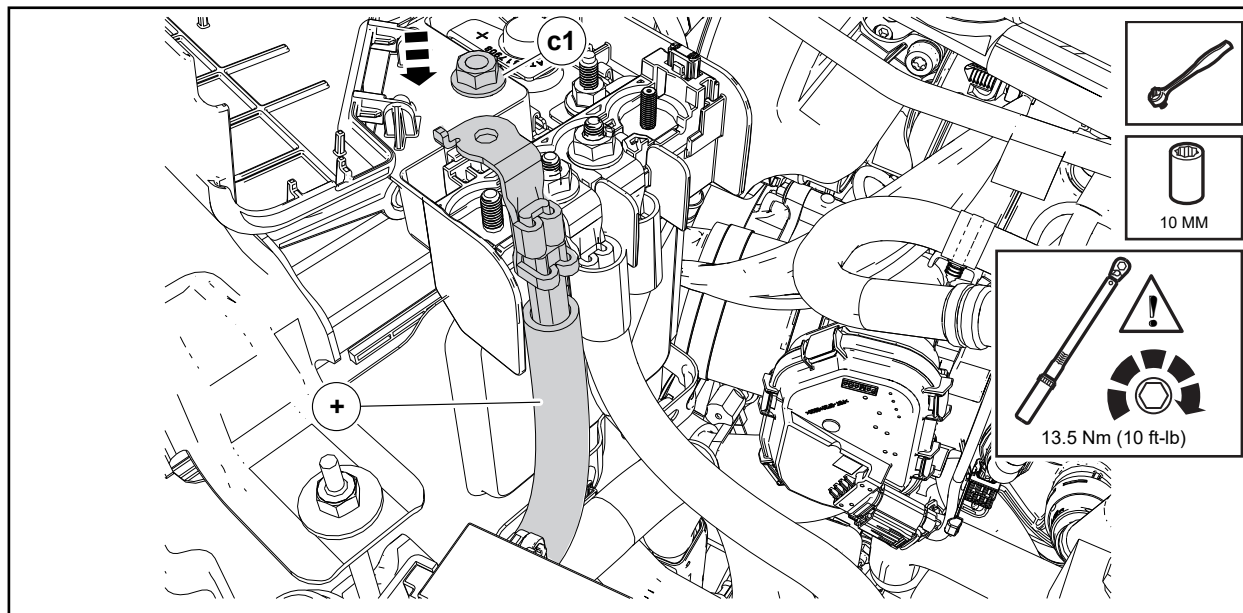

NO PART OF THIS DOCUMENT MAY BE REPRODUCED WITHOUT PRIOR AGREEMENT AND WRITTEN PERMISSION OF
FORD PERFORMANCE PARTS

44. Connect the negative winch cable to the negative terminal on the vehicles battery.

- Torque: 13.5 Nm (10 ft-lb)

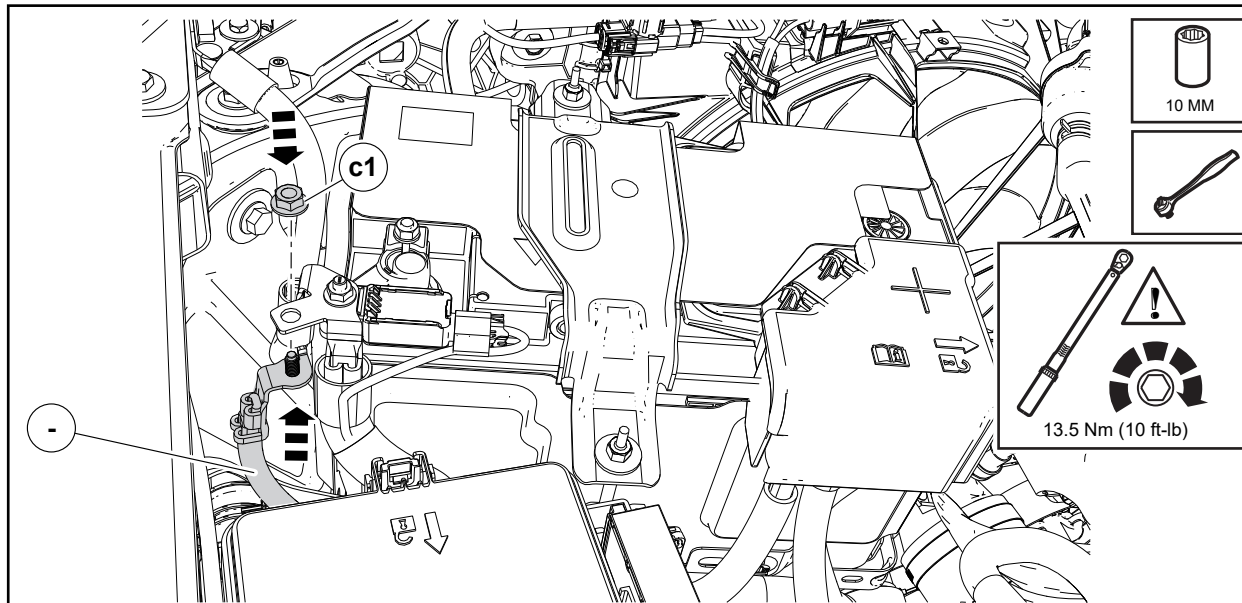

45. Install the tow hook and tow hook strap to the winch cable eyelet.

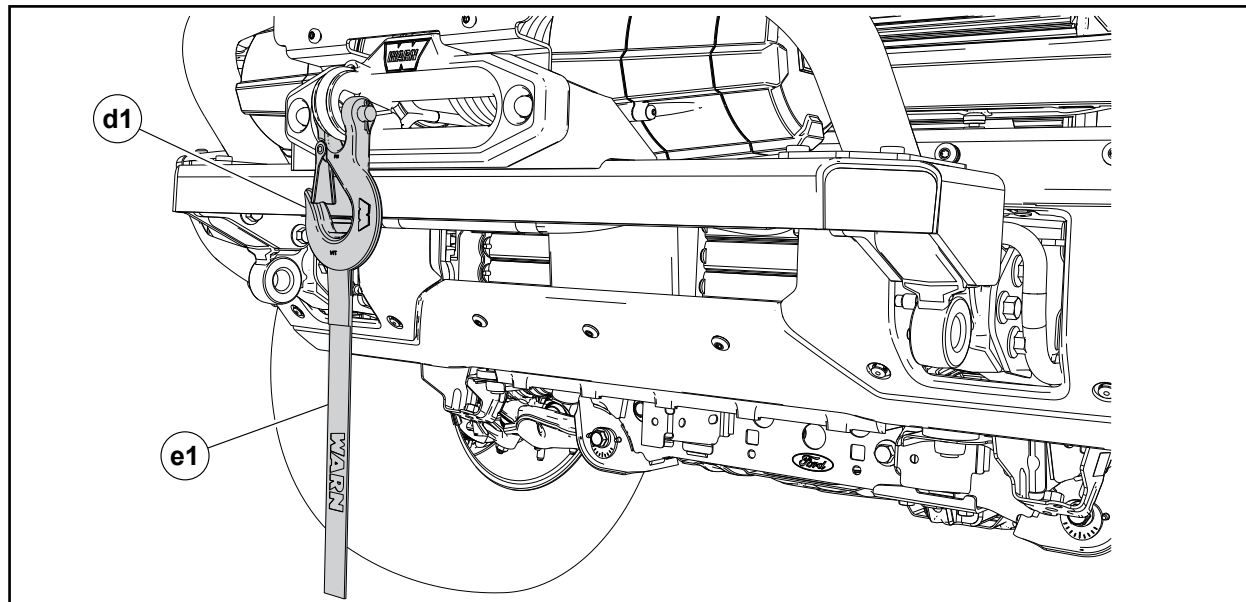

NO PART OF THIS DOCUMENT MAY BE REPRODUCED WITHOUT PRIOR AGREEMENT AND WRITTEN PERMISSION OF
FORD PERFORMANCE PARTS

46. Connect the remote to the winch and test the operation. Store the winch remote in the center console.

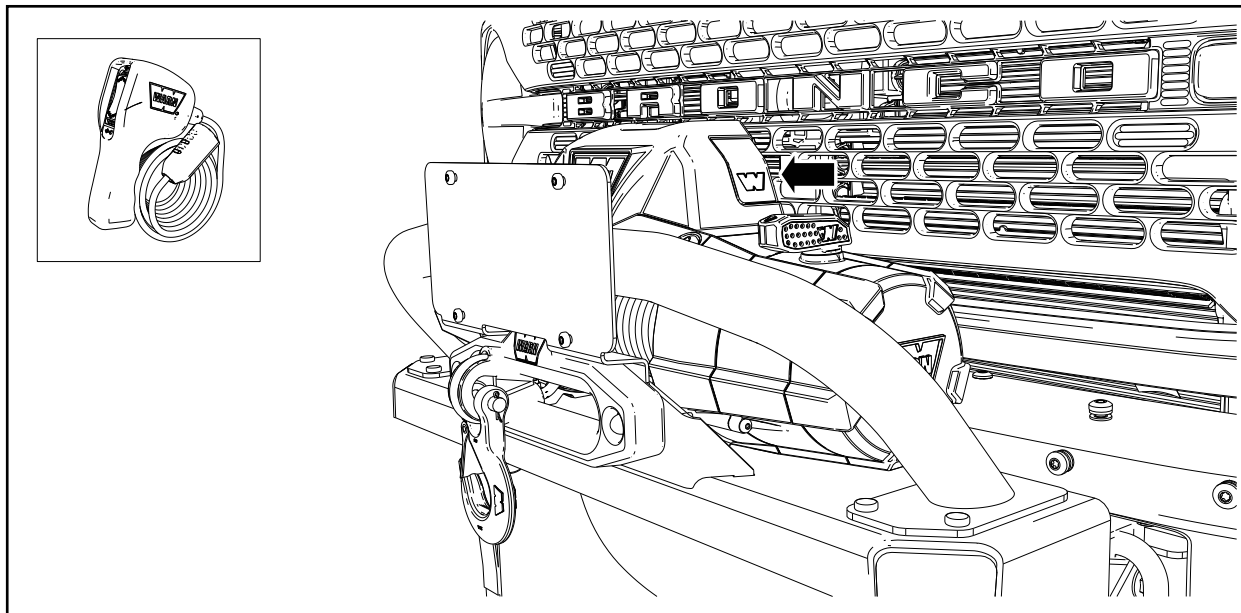

47. Close the hood of the vehicle.

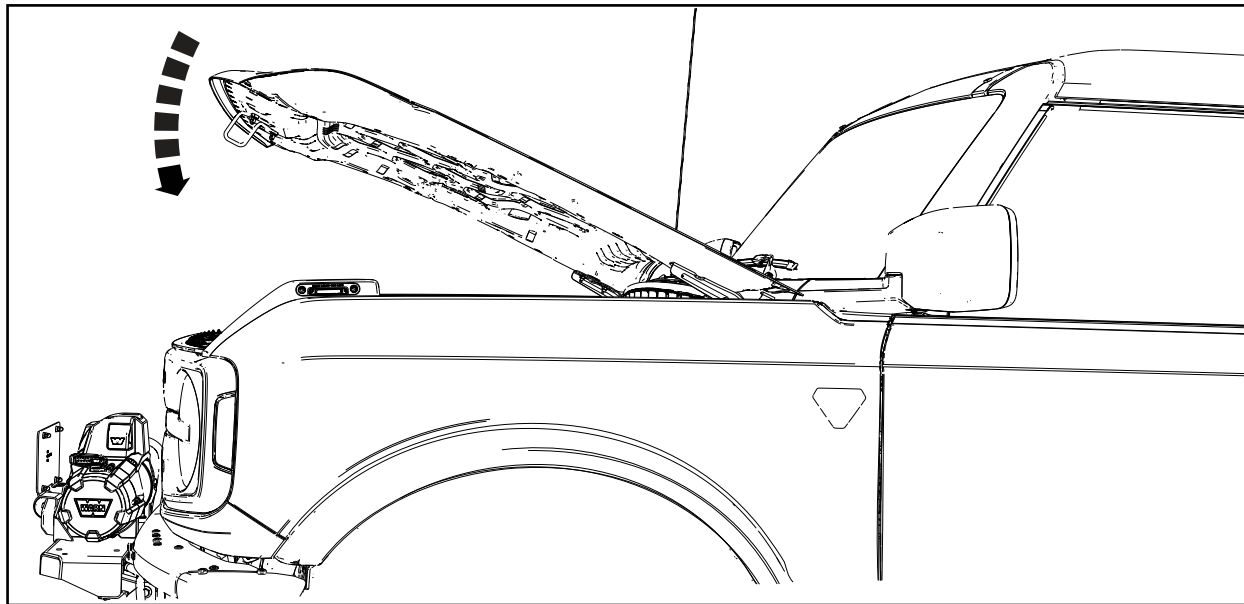

NO PART OF THIS DOCUMENT MAY BE REPRODUCED WITHOUT PRIOR AGREEMENT AND WRITTEN PERMISSION OF
FORD PERFORMANCE PARTS

48. Install the left hand wheel well splash shield and retainers.

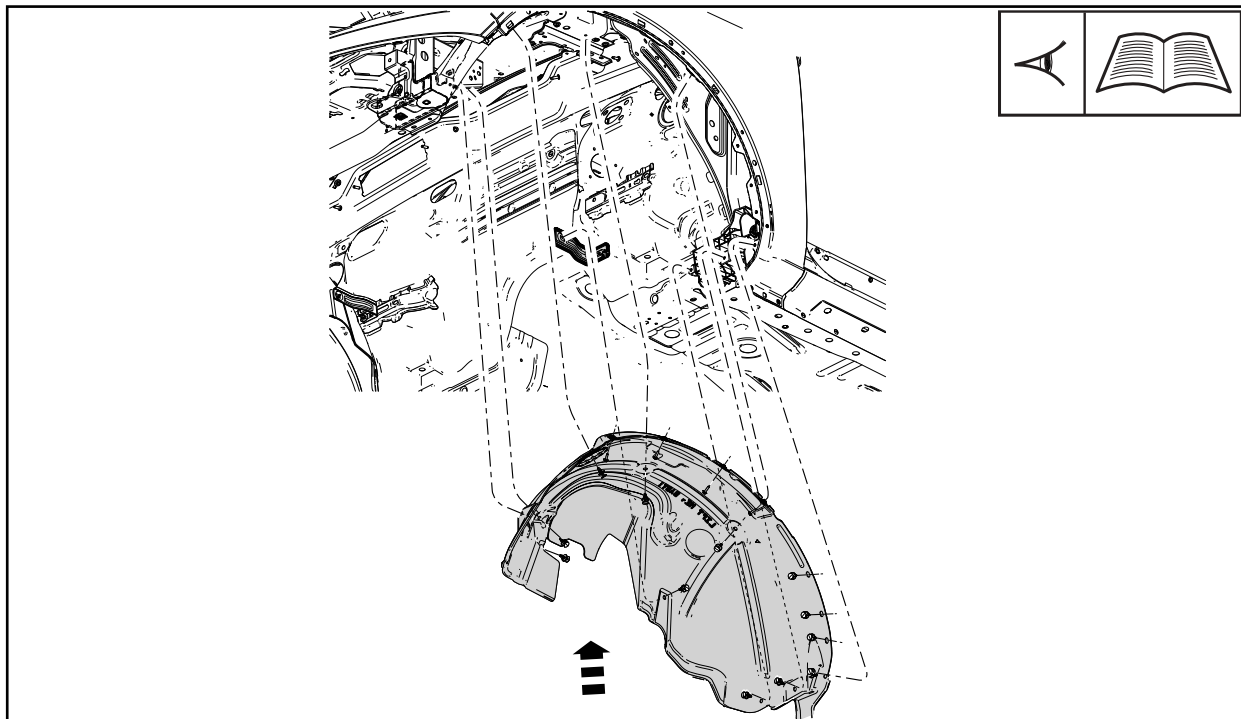

49. Install the left hand tire and lug nuts.

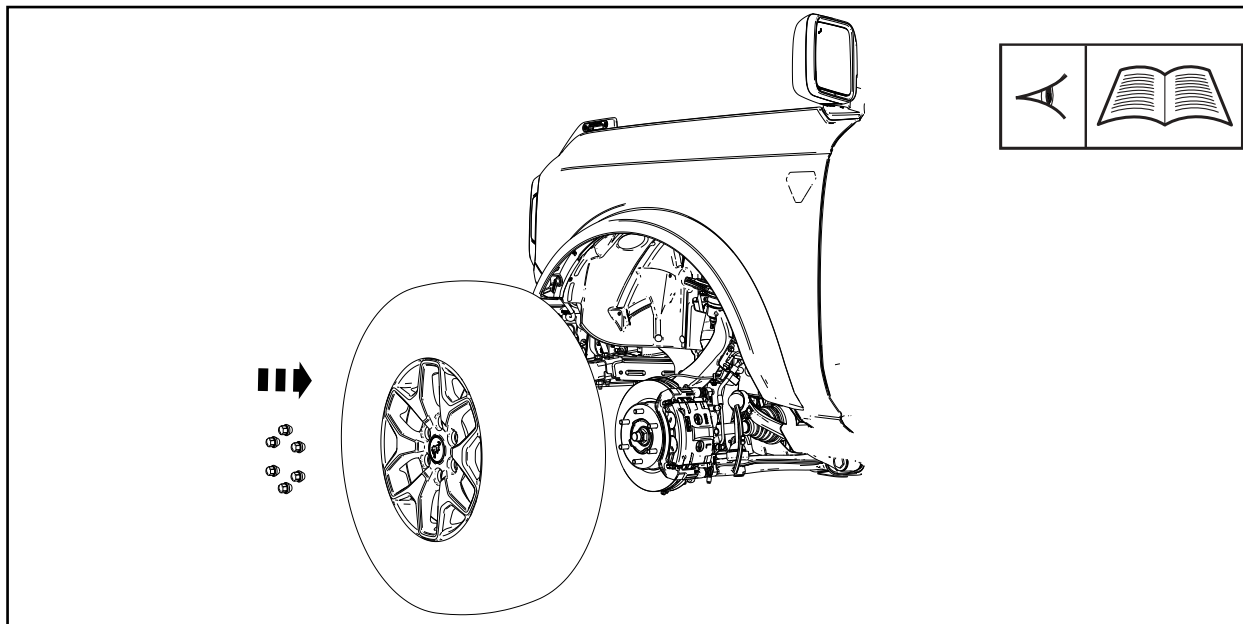

NO PART OF THIS DOCUMENT MAY BE REPRODUCED WITHOUT PRIOR AGREEMENT AND WRITTEN PERMISSION OF FORD PERFORMANCE PARTS

50. Install the left hand wheel well splash shield and retainers.

• Torque: 30 Nm (22 ft-lb)

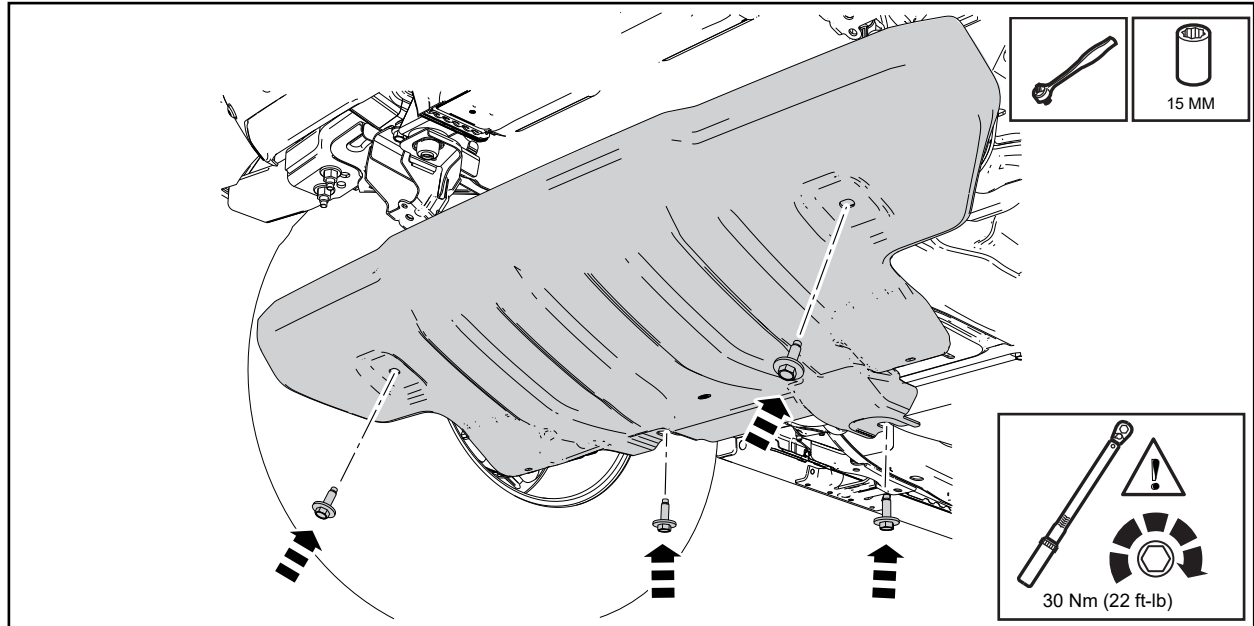

Programming procedure:

51. Connect Ford Diagnostic & Repair System (FDRS) and start a new vehicle session.

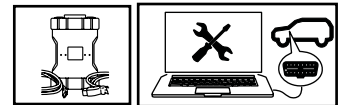

52. Select "Toolbox", then scroll down to "RCM - Restraint Control Module". On the left hand side of the screen download the "RCM - Winch Configuration"

53. Select "Run" after the download has completed. Follow the on-screen instructions to complete the RCM - Winch Configuration.

NOTE: When prompted for part number entry, enter "M-1821". The part numbers are case sensitive. Do Not enter spaces or a part suffix or quotes.

54. If equipped with Front Bumper Park Aid Sensors, disable Park Aid Front Sensors. Press 'Features' on the SYNC touchscreen, press 'Driver Assistance', then select 'Park Aid Front Sensors' to OFF.



M-1821-B
2021 →
Bronco Off-Road Winch

NO PART OF THIS DOCUMENT MAY BE REPRODUCED WITHOUT PRIOR AGREEMENT AND WRITTEN PERMISSION OF
FORD PERFORMANCE PARTS

Returning Vehicle to Factory Condition:

When completely removing the Winch from the vehicle, perform these steps to return the vehicle to factory conditions. Programming is required to reset the airbag safety system sensitive for proper deployment during a collision event.

55. Connect Ford Diagnostic & Repair System (FDRS) and start a new vehicle session.

56. Select "Toolbox", then scroll down to "RCM - Restraint Control Module". On the left hand side of the screen download the "RCM - Winch Configuration"

57. Select "Run" after the download has completed. Then select "Remove Winch from Vehicle" and follow the on-screen instructions to complete the RCM – Winch Configuration.

NOTE: During the programming procedure you will be prompted to enter the part number "**RESTORE**". The part numbers are case sensitive and do not include any spaces.

58. If equipped with Front Bumper Park Aid Sensors, Enable Park Aid Front Sensors. Press 'Features' on the SYNC touchscreen, press 'Driver Assistance', then select 'Park Aid Front Sensors' to ON.