



JLAB®
JBUDS AIR
|
EARBUDS

We love that you are rocking JLab!
We take pride in our products and fully stand behind them.



YOUR WARRANTY

All warranty claims are subject to JLab authorization and at our sole discretion. Retain your proof of purchase to ensure warranty coverage.



CONTACT US

Reach out to us at support@jlab.com or visit jlab.com/contact

REGISTER TODAY

jlab.com/register

Product updates | How-to tips
FAQs & more

FIRST TIME SETUP

1 AUTO-CONNECTING EARBUDS

Press and hold **both buttons 3+ seconds** to power ON.

The Left earbud turns **solid white** and Right earbud **blinks blue/white** indicating ready to pair to your device.

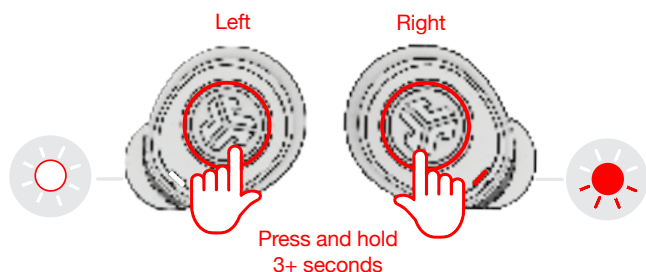

2 CONNECTING TO BLUETOOTH

Select "JLab JBuds Air" in your device settings.

Voice prompt "Bluetooth connected" followed by **solid white lights** will indicate you are connected.

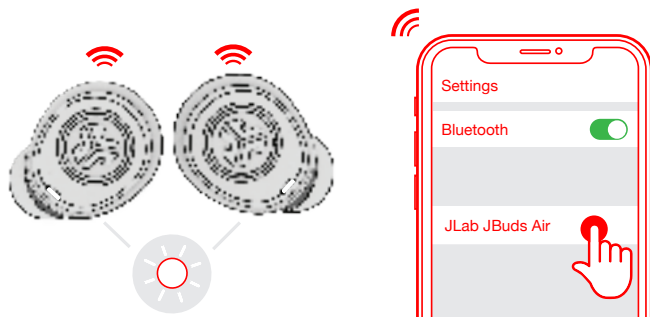

ADDING NEW / ADDITIONAL BLUETOOTH DEVICES:

Turn OFF Bluetooth from any previously connected device. **Turn ON Bluetooth** from new device. Take earbuds out of the case. Earbuds will automatically enter Bluetooth Pairing. Select "JLab JBuds Air" in new device settings to connect.

BUTTON FUNCTIONS

LEFT
EARBUD

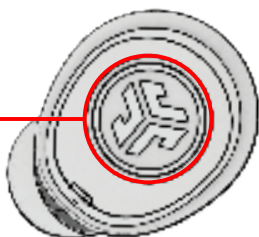

RIGHT
EARBUD

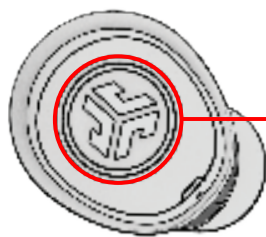

VOLUME DOWN: Single tap
SIRI (iOS) or "OK GOOGLE" (ANDROID): Double tap
TRACK BACK: Press & hold 1+ sec
TURN ON: Press & hold 2+ sec
TURN OFF: Press & hold 5+ sec
CHANGE EQ: Triple tap

VOLUME UP: Single tap
ANSWER: Single tap
HANGUP: Double tap
REJECT INCOMING CALLS: Press & hold 1+ sec
PLAY / PAUSE: Double tap
TRACK FORWARD: Press & hold 1+ sec
TURN ON: Press & hold 2+ sec
TURN OFF: Press & hold 5+ sec
CHANGE EQ: Triple tap

VOICE PROMPTS

"Hello": Power ON
"Earbuds joined": Earbuds paired to each other
"Ready to Pair": JBuds Air are ready to pair to Bluetooth device
"Bluetooth Connected": Earbud is connected to device
"Battery Full": 100-80%
"Battery Medium": 80-20%
"Low Battery": Less than 20%
When power decreases to 10%, "Low Battery" will play
"Goodbye": Power OFF

CUSTOM EQ³ SOUND MODES

Tap either the right or left earbud 3 times for different EQ settings (JBuds Air will cycle 3 EQ settings).

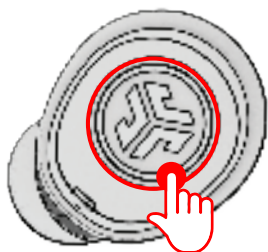

JLab SIGNATURE
JLab C3™ signature sound with amplified bass and vocals



BALANCED
Even sound with no additional enhancements



BASS BOOST
Amplified bass and sub-bass

CHARGING EARBUDS

1

Match the corresponding L and R letters on the charging case for proper charging. The earbuds will auto power OFF and start charging.

Blue lights will indicate earbuds are charging and will turn OFF when fully charged.

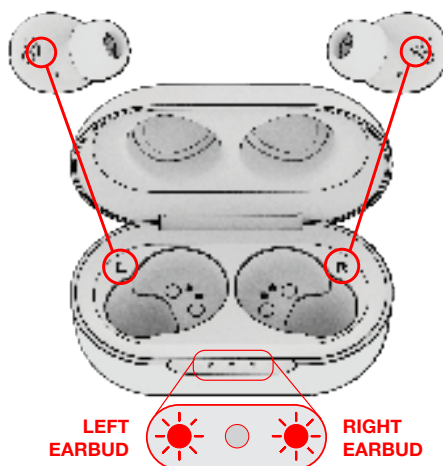

2

Earbuds will auto power ON and reconnect to your device when taken out of the case.

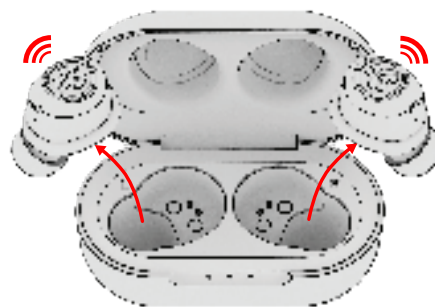

CHARGING CASE

Connect the JBuds Air to computer or USB 5V 1A (or less) output device.

LEDs **pulse white** when charging and **turn solid white** when fully charged.

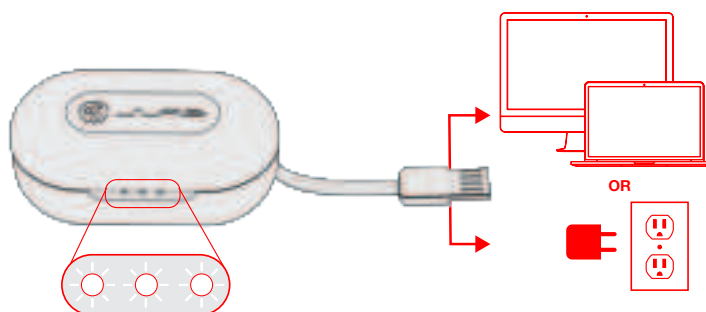

FITTING

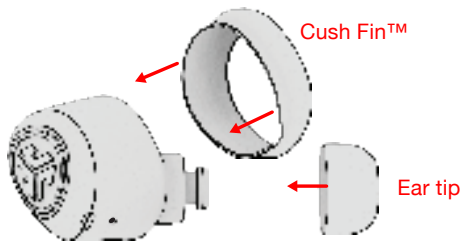

Try all the optional Cush Fins and ear tips for best fit and proper seal.

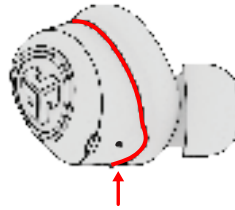

The Cush Fin should be aligned by positioning the contour around the microphone hole.

TROUBLESHOOTING

NO AUDIO IN LEFT EARBUD OR EARBUDS ARE DISCONNECTED FROM EACH OTHER (MANUAL RESET)

- 1 Enter your Bluetooth device settings and forget the JBuds Air.

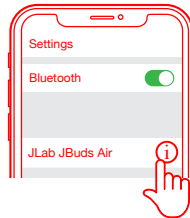

- 2 Open the charging case door and leave both earbuds inside. Starting with ONE earbud, **quickly tap the button 4x times**. Light will **blink blue 4x times** then turn **solid blue**. Leave the earbuds in the charging case.



- 3 Repeat with the other earbud. **Quickly tap the button 4x times**. Light will **blink blue 4x times** then turn **solid blue**.



- 4 Take both earbuds out of the charging case and keep them within 2 inches from each other. Wait for Left earbud to turn **solid white** and Right to **blink blue/white**. You are now ready to pair to your Bluetooth device.

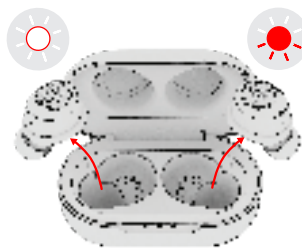

TROUBLESHOOTING

BLUETOOTH DEVICE DOES NOT CONNECT / RECONNECT

- 1 Enter your Bluetooth device settings and forget the JBuds Air.

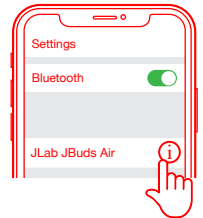

- 2 On your device, turn OFF then ON Bluetooth.

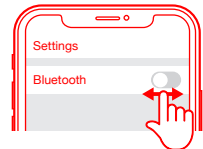

- 3 Take the earbuds out of the case. Wait for Left to turn **solid white** and Right **blinking blue/white**.

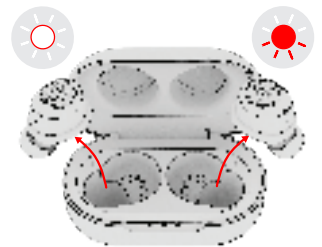

- 4 Select "JLab JBuds Air" in device settings to reconnect.

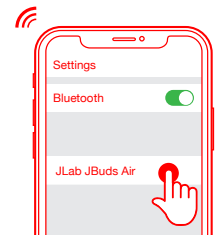

Instructional videos at: [JLAB.COM/MANUALS](https://www.jlab.com/manuals)

ECHOES ON CALLS

If you experience microphone echo/call quality with the JBuds Air, make sure the Cush Fin is not blocking the microphone port.

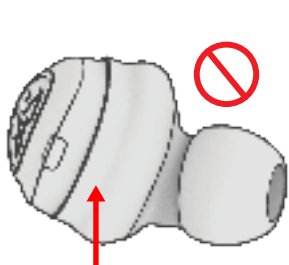

Microphone covered

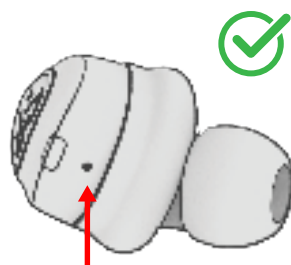

Microphone open

QUICK TIPS

- The Bluetooth connection is established from the right earbud. For the most stable connection, keep the device near right hand side or in right pocket.
- If you prefer to wear only one earbud, you must wear the **right earbud** as this is the main earbud connected to Bluetooth.
- Choosing the correct ear tip makes a significant improvement in audio quality due to proper seal for the driver. Try all ear tips for best results.
- Only ONE Bluetooth device can be connected at a time. Turn off Bluetooth from unwanted devices and turn on Bluetooth from chosen device to connect.

WARNING

Fully dry off the earbuds before putting in the charging case to avoid any damage to the case.

The earbuds are sweat/water resistant but the case is not.

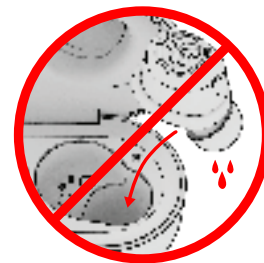

CAUTIONS

- Avoid extreme heat, cold, and humidity.
- Avoid dropping or crushing the earbuds.
- Wax may build up in the earbud tips, lowering the sound quality. Carefully remove the wax with a cotton swab or other small tool to improve the sound quality.
- If you experience discomfort or pain, try lowering the volume or discontinuing use temporarily.
- If you experience regular discomfort while using this product, discontinue use and consult your physician.
- We recommend you treat your earbuds as you would a nice pair of sunglasses and keep them in safe location when not in use.



Shop products | Product alerts | Burn-in your headphones

JLab Store + Burn-in Tool

