

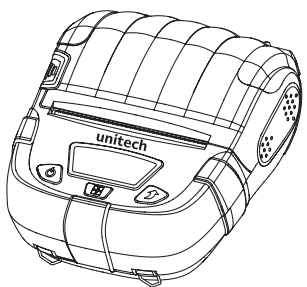

SP320

Bluetooth Mobile Printer



Quick Start Guide

V1.0

Package Content

■ Standard Accessories

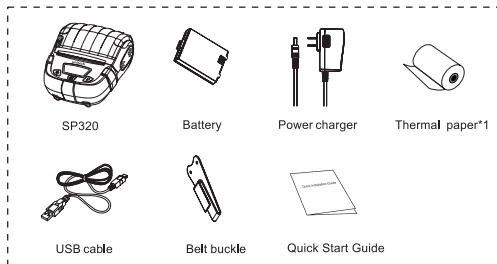

ⓘ The pictures are for reference only. If any item is damaged or missing, please contact the supplier.
ⓘ For Belt buckle installation, please visit <http://www.ute.com/> to view SP320 User's Manual.

Appearance and Components

■ Front View

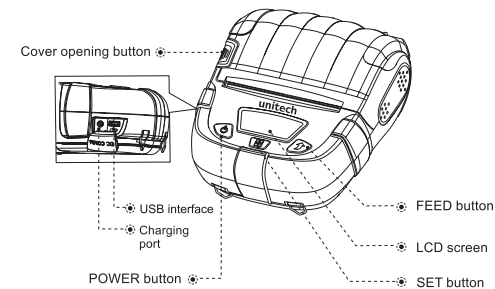

Preparation before Using

■ Battery Installation

The battery is not installed in the printer before the product leaves factory.

1. Remove the protective film of battery contacts.
2. Install the battery as shown in the figure above.
3. Fasten the battery.



■ Printing Paper Roll Installation

1. Press the cover opening button to open the paper bin cover.
2. Load paper roll into the paper bin according to the direction as shown in the figure.
3. Pull out a part of paper roll and close the paper bin cover.
4. Tear off the excessive paper according to the direction as shown in the figure.

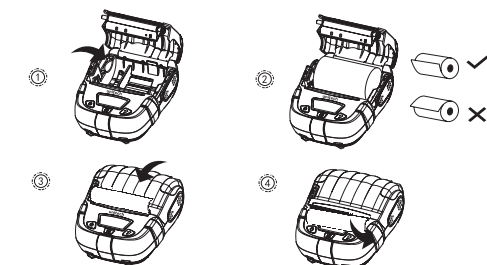

- ⓘ note:
1. Paper specification used by the printer: Paper width: 80mm (One side can be adjusted), paper roll diameter: 50mm.
 2. Pay attention to the direction of paper roll. If it is placed in the wrong direction, it will lead to blank printing.
 3. Be sure to pull a part of paper out of the paper bin.

■ Battery Charging

Plug the charger plug into the power socket, and the charger DC plug into the printer charging port.(AC:100V~240V(50/60Hz))

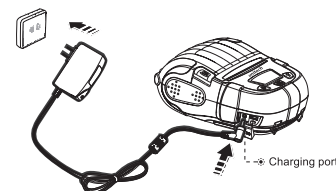

- WARNING** If you use a power adapter not provided or approved by us, the printer may be damaged.
- ATTENTION** Do not remove the battery while charging.
- NOTE** You can print while charging.

Basic Functions

■ Basic Functions

Power On: press and hold the POWER button for 3 seconds.
Power Off: When the printer is on, press and hold the POWER button.
FEED: Press the FEED button (under continuous feeding mode, press FEED button to feed paper of about 5mm; under label/black label mode, press FEED button to feed paper to seam label or black label.)
Auto sleep/wake:
When the printer is turned on and has no button operation or data transmission within 10 seconds, it will automatically enter sleep mode. Press POWER button to wake up the printer (the printer will automatically wake up when data is received).

■ Setting

Enter setting screen : During power-on state (non-sleep mode), press and hold SET button to enter the option screen.

Press **SET** button : Go to the next option.
Press **FEED** button : Change option parameters.
Press **POWER** button: Confirm settings and exit.

	Print self-test page	Press Power button to start printing self-test page
	0-4	Set wide range definition (coarse tuning)
	0-4	Set small range definition (fine tuning)
	0-4	Set print speed
	English	Set language
	Open	Set whether to turn on the buzzer
	Label	Set according to the paper type used
	TSC/ESC	Set command mode
	80/58 mm	Set according to the paper width
	1-5hrs	Set auto shutdown
	10/15/30/40S	Set screensaver time

Printer Parameters

Printing Parameters	
Printing method	Thermal line printing
Printing paper width	3 1/2 inch
Paper Warehouse Capacity	≤50mm
Printing speed	90mm per second
Resolution	203dpi (8dots/mm)
Fonts	GB 18030 ASCII font (8x16, 12x24, 16x32), GBK (16x16, 24x24, 32x32), BIG5 (16x16, 32x32) Unicode (UTF8)
Printer core life	50km for thermal label 150km for thermal paper/ receipt (25% print density or the following) / Each point: 1.5 million pulses
Command set	ESC/POS CPCL (compatibility)
Print length	> 300m
Battery specification	7.4V 2700mAh rechargeable Li-ion battery
Charging time	< 6 hours
Wire communication	Standard USB 2.0
Wireless communication	Dual-mode Bluetooth 5.0 (SPP+BLE)
Dimensions	140mmx117mmx60mm
Weight	450g
Working environment	Temperature: 0°C~45°C humidity: 20%~85%
Storage environment	Temperature: -10°C~60°C, humidity: 10%~90%
Print content	1D barcode: UPC-A, UPC-E, EAN-13, EAN-8, Code39 ITF, Codebar Code93, Code128, I2/5 2D barcode: QR code, PDF417, DataMatrix

Repair and Maintenance

■ Daily Maintenance of Printer

1. Cleaning of outside and paper bin: Wipe the surface of the printer and the inside of the paper bin gently with a wrung-out wet cloth. Make sure that the wet cloth is completely wrung out.
2. Cleaning of printer mechanism: The printer mechanism must be cleaned regularly, especially when the print quality declines. The cleaning method is as follows: Use absorbent cotton moistened with anhydrous alcohol to gently wipe the area marked with a gray box until it is clean.
3. If water is found inside the printer, turn it off immediately, remove the battery, and dry the printer by airing.
4. If the printer will not be used for a long time, remove the battery and store it separately.

■ Use and Storage of Printing Paper

1. Please keep newly purchased printing paper in intact package and prevent it from direct sunlight and high temperature.
2. Please keep printed documents in a dark place at room temperature (about 20°C), so as to effectively extend the storage life of the documents.
3. If the documents need to be kept for a long time, please use long-lasting thermal printing paper.

Troubleshooting

Fault Phenomenon	Cause	Solution
Paper is fed but no data is printed.	Printing paper is loaded in the wrong direction.	Please load the printing paper in the other direction.
Blurry printing	The printer is not cleaned for a long time and the printer mechanism is contaminated by dirt.	Clean the printer mechanism.
	Poor color rendering of printing paper	Please set higher blackness or use paper with better color rendering.
Printed documents are blurred in months or even weeks	Poor quality of printing paper	Please use long-lasting thermal printing paper.
	Documents are kept at high ambient temperature	Please keep the documents at room temperature. (about 20°C)

Battery Recycling

This product uses a rechargeable lithium battery. To protect the environment, please do not dispose of used batteries at will. Need to send used batteries to the designated recycling box.



FCC WARNING :

Any changes expressly or modifications not approved by the party responsible for compliance could void the user's authority to operate the equipment. This device complies with Part 15 of the FCC Rules. Operation is subject to the following two conditions:
(1) This device may not cause harmful interference, and (2) This device must accept any interference received, including interference that may cause undesired operation.

Note: This equipment has been tested and found to comply with the limits for a Class B digital device, pursuant to Part 15 of the FCC Rules. These limits are designed to provide reasonable protection against harmful interference in a residential installation.

This equipment generates, uses, and can radiate radio frequency energy and, if not installed and used in accordance with the instructions, may cause harmful interference to radio communications. However, there is no guarantee that interference will not occur in a particular installation. If the printer will not be used for a long time, remove the battery and store it separately.

If this equipment does cause harmful interference to radio or television reception, which can be determined by turning the equipment off and on, the user is encouraged to try to correct the interference by one or more of the following measures:

- Reorient or relocate the receiving antenna.
- Increase the separation between the equipment and receiver.
- Connect the equipment into an outlet on a circuit different from that to which the receiver is connected.
- Consult the dealer or an experienced radio/TV technician for help.

FCC Radiation Exposure Statement:

This equipment complies with FCC radiation exposure limits set forth for an uncontrolled environment. This transmitter must not be co-located or operating in conjunction with any other antenna or transmitter.



<http://www.ute.com/>