



www.nuxaudio.com

Made in China

Owner's Manual

NOISE GATE

HAMINATOR

Reissue Series

NUX

Thank you for choosing the NUX Reissue Series NRN-1 Huminator Noise Gate Pedal. This pedal features dynamic LED indicators that visually track real-time noise suppression levels, paired with two selectable modes: MUTE Mode for instant silence during playing pauses and REDUCTION Mode for smooth signal decay that retains natural sustain. Its dedicated SEND/RETURN loop isolates noisy pedals to protect your core guitar tone while achieving transparent noise reduction, and with an upgraded 18V internal power circuit, the Huminator ensures enhanced headroom even when driving high-output pickups.

Overview

- Terminate unwanted noise, perfect the sound.
- The internal circuit converts the power supply to 18V, for greater headroom and wider usability.
- Dual Modes: Reduction mode and Mute mode.
- Dynamical LED indicator.
- Built-in effects loop.
- 100% Analog circuit.

Specifications

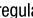
- Input impedance: 1M Ohms
- Output impedance: 1k Ohms
- Power: 9V battery or external AC adaptor delivering 9V DC regulated minimum 100mA ()
- Dimensions: 121(L) x 77(W) x 48(D) mm
- Weight: 253g

1. Do not place near heat sources, such as radiators, heat registers, or appliances which produce heat.
2. Guard against objects or liquids entering the enclosure.
3. Refer all servicing to qualified service personnel.
4. Prolonged listening at high volume levels may cause irreparable hearing loss and/or damage. Always be sure to practice "safe listening".

Follow all instructions and heed all warnings

KEEP THESE INSTRUCTIONS!

Product Interface

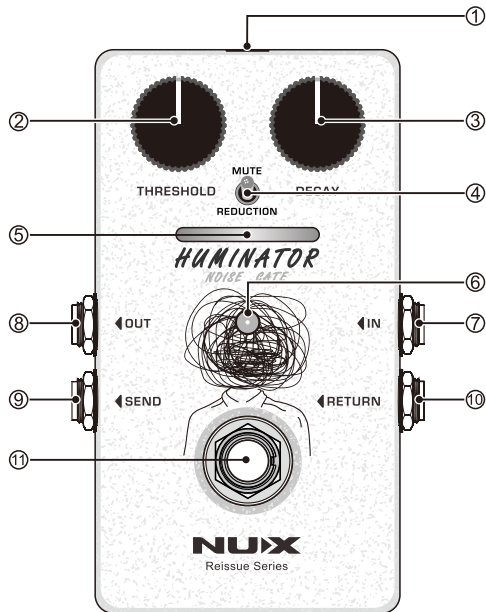

1.DC IN Jack

Use a regular 9V DC adaptor with Negative Tip to power this pedal. It's highly recommended using the optional NUX ACD-006A adaptor. Using an incompatible adaptor may cause noise or malfunction.

2.Threshold Knob

Adjust at which signal level that will start the reduction.

3.Decay Knob

Adjust how fast the output signal will be attenuated when the input signal falls below the Threshold. Turn this knob clockwise for more natural attenuation.

4.REDUCTION/MUTE Switch

Choose the modes of the Huminator.

- Downward Position: REDUCTION mode, the noise reduction effect is turned on.
- Upward Position: MUTE mode, the output signal will be muted when bypassed.

5.LED INDICATOR

Displays real-time noise reduction intensity. More indicators light up as the attenuation increases.

When the signal is near mute, the orange light turns on; when the signal is muted the red light turns on.

6.ON/OFF Indicator

Indicate the ON/OFF of the Huminator.

7.INPUT Jack

Connect the guitar to this jack. Plugging in this jack switch on the power whether the effect is engaged or disengaged.

When not using this pedal, disconnect the cable from this jack to save battery life.

8.OUTPUT Jack

Connect an amplifier into this jack.

9.SEND Jack

Connect to the beginning of your effects loop.

10.RETURN Jack

Connect to the end of your effects loop.

11.Footswitch

Tap the footswitch to turn the effect ON/OFF.

In the MUTE mode, it will switch between Reduction and Mute.

In the REDUCTION mode, it will switch between Normal and Reduction.

How to Connect

Normal Method

Simply connect the NRN-1 into your signal chain as the last pedal AFTER the noisy pedals.

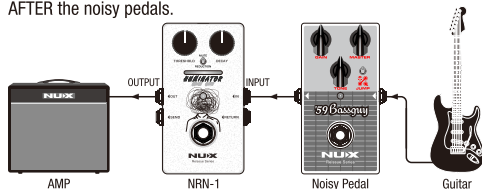

Advanced Method

Connect the noisy pedals in the SEND/RETURN loop, the NRN-1 will sense your guitar signal and allow the suppression circuit to activate only as your guitar signal dies out, making the sound more natural.

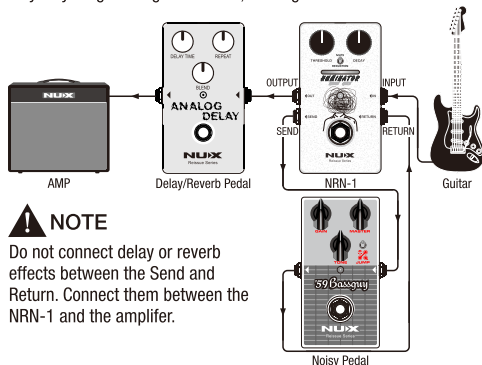

! NOTE

Do not connect delay or reverb effects between the Send and Return. Connect them between the NRN-1 and the amplifier.

Installing The Battery

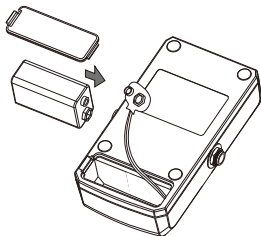

A 9V battery is included in the product packaging. Please replace the battery if any of the following occurs:

- 1.The indicator light dims or fails to light up.
- 2.The effect sound becomes weak or heavily distorted.

Please connect the snap cord to the battery and insert the battery as shown in the drawing below.

! NOTE

- 1.When replacing the battery, ensure correct polarity.
- 2.To extend battery life, when not using this pedal, disconnect the cable from INPUT jack.
- 3.If the product will be unused and stored for a long time, remove the battery to prevent leakage and potential damage.
- 4.Only use a compatible power adapter for operation.(DC 9V $\ominus \rightarrow \oplus$)

Accessories

- 9V battery ●Owner's manual ●NUX sticker

*Specifications and features are subject to change without notice.

WARNING!-IMPORTANT SAFETY INSTRUCTIONS BEFORE CONNECTING, READ INSTRUCTIONS

WARNING: To reduce the risk of fire or electric shock, do not expose this appliance to rain or moisture.

CAUTION: To reduce the risk of fire or electric shock, do not remove screws. No user-serviceable parts inside. Refer servicing to qualified service personnel.



The lightning symbol within a triangle means "electrical caution!" It indicates the presence of information about operating voltage and potential risks of electrical shock.



The exclamation point within a triangle means "caution!" Please read the information next to all caution signs.