

尺寸：85\*120mm

HD Industrial Endoscope

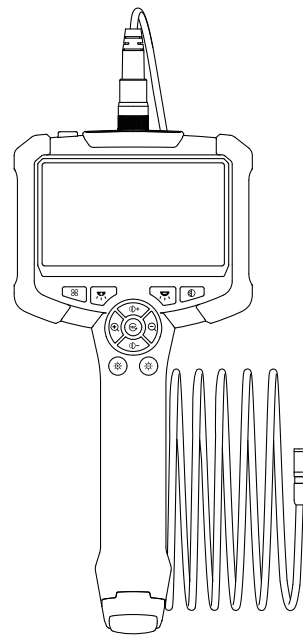

Model: G30-M

PRODUCT DESCRIPTION

G30-M is a high-precision industrial endoscopy camera with 4.3 inch HD color display. It adopts ergonomic design, Easy to operate, real-time viewing of high-definition real images. This product is equipped with a small diameter HD camera with LED auxiliary lighting. The camera adopts a high-sensitivity chip, which can be used normally even in a dark working environment.

SAFETY AND MAINTENANCE

- The product is an industrial endoscopy camera and is not intended for medical use or human examination.
- Do not hit the camera violently and do not pull the cable.
- When used in an environment with sharp bumps, please use it carefully to prevent the waterproof protective layer of the probe from being scratched.
- The camera probe is not made of heat-resistant and high-temperature materials. When checking the automobile engine, please ensure that the temperature in the engine drops to the normal temperature.
- When not in use, please ensure that the lens and the main unit are clean and dry, and avoid contact with oil, etc. or other corrosive and dangerous substances.
- This product is not suitable for people with limited physical, sensory or mental abilities.
- Do not allow children to touch and operate this equipment.

BATTERY INSTRUCTIONS

- Please use a (5V=1A) household charger that meets the safety regulations to charge the equipment. Fast charging is not supported.
- This device supports charging while using.
- If the device is not used for a long time, please ensure that it is charged at least once every 3 months to prevent irreparable damage caused by excessive discharge of the battery.

FUNCTION INTRODUCTION

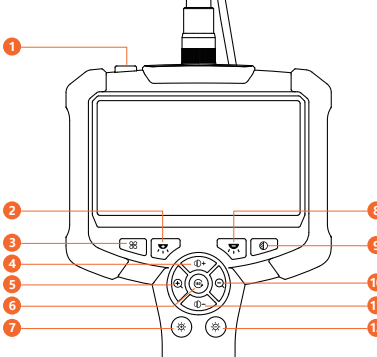

- 1 Power button**  
Press and hold for 3 seconds to turn on and off the power of the machine
- 2 Brighten the display**  
Display brightness gradually increases from 10-25-50-75-100%
- 3 Restore settings**  
All functional states are restored to the state when the device was first turned on
- 4 Enhance sharp contrast**  
Clear contrast gradually increases from weakened-normal-enhanced, which can improve the degree of detail restoration
- 5 Zoom in**  
Image magnification 1.0-1.5-2.0x incrementally
- 6 To rotate**  
The picture is rotated 180 degrees, easy to adjust the angle, better observation
- 7 LED adjustment “+”**  
The brightness of the LED light can be gradually increased from 0-60-80-100%
- 8 Dim screen brightness**  
When the display brightness is the brightest, it can gradually dim from 100-75-50-25-10% and return to normal
- 9 Black and white**  
Through it, you can switch between black and white for better effects in dark environments.
- 10 Zoom out**  
After the picture is enlarged, it can be adjusted to return to normal 2.0-1.5-1.0x gradually decreasing
- 11 Reduce sharp contrast**  
When your clear contrast is strongest, you can use it to gradually weaken the clear contrast, from strengthen-normal-weak to return to normal
- 12 LED adjustment “-”**  
The brightness of the LED light gradually decreases from 100-80-60-0%

Charging Guide

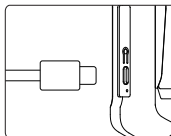

1. Connect the device to the Type-C adapter for charging (5V=1A). The product does not support fast charging.
- The red signal light is always on when charging, and the green light is always on when the product is fully charged.

FAQ

- 1. Lags happened during the photo outputting of the product**  
Please check whether the product has sufficient power, or restart the device.
- 2. Imaging screen is not clear**  
The best imaging focal length of the product is: 2cm-10cm, please calibrate the distance to the object, or clean the front of the camera with a clean alcohol cloth.
- 3. Product charging**  
Please use (5V=1A) charger to charge the device. The product does not support fast charging.
- 4. The camera is heat**  
It is normal for the camera to heat up, especially when the camera LED light is on at the highest brightness. But it does not affect normal use or service life.

Accessories installation Guide

Accessories

Hook(1), Magnet(1), Mirror(1), Fixing device(3)

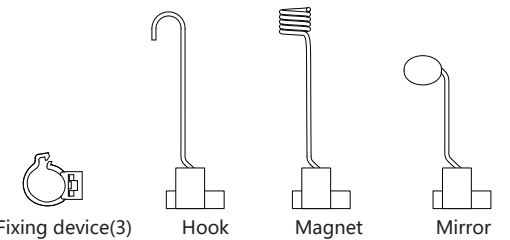

Installation diagram

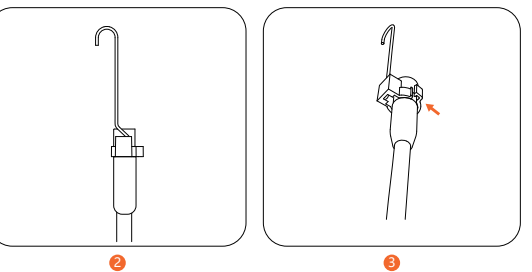

Specifications

Camera diameter: 8mm
Camera resolution: 1920*1080
Viewing angle: 70°
Focusing range: 20-100mm
Auxiliary lighting: 8 adjustable brightness LEDs
Screen type: 4.3-inch color display
Charge port: Type-C
Battery: 2000mAh
Battery life: 3.5 hours
Battery charging time: 3 hours
Operating temperature: -14°F~113°F
Camera temperature: -14°F~176°F
Shutdown power consumption: 30uA
line length: 1/5/10/20/30m

