

## SPECIFICATIONS

Model Number	: WGP15V2
Number of Buttons	: 22
Connectivity	: StrikeSpeed Wireless, BT5.0, Wired
Thumbstick Type	: Hall-Effect
Trigger Type	: Hall-Effect
Face Button Type	: Membrane
D-pad Button Type	: Membrane
Turbo	: Yes
Vibration	: 4-level adjustable
Macro Buttons	: 12
polling Rate	: 1000 Hz (Wired), 1000 Hz (Wireless)
Battery Capacity	: 1000 mAh Li-ion
Battery Life	: Up to 26 Hours
Size	: 156*105*59 mm
Weight	: 272 ± 3 g
Power Rating	: 3.7V --- 125 mA
Compatibility	: Windows 7 or later, Switch, iOS, MacOS, tvOS, Android

## PRODUCT TOUR

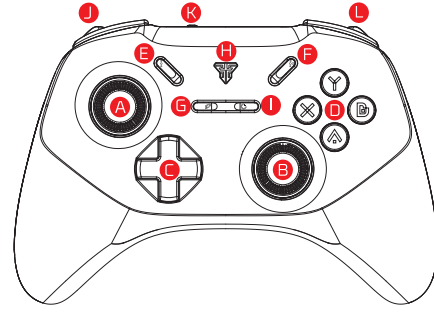

### EN

- |                           |                            |
|---------------------------|----------------------------|
| <b>A</b> Left Thumbstick  | <b>K</b> Sync Button       |
| <b>B</b> Right Thumbstick | <b>L</b> Right Bumper      |
| <b>C</b> Directional Pad  | <b>M</b> Right Trigger     |
| <b>D</b> Face Buttons     | <b>N</b> Left Trigger      |
| <b>E</b> Select Button    | <b>O</b> USB-C Port        |
| <b>F</b> Start Button     | <b>P</b> Trigger Lock      |
| <b>G</b> Turbo Button     | <b>Q</b> Right Rear Paddle |
| <b>H</b> Home Button      | <b>R</b> Left Rear Paddle  |
| <b>I</b> Snap Button      | <b>S</b> Platform Toggle   |
| <b>J</b> Left Bumper      | <b>T</b> 3.5mm Jack        |

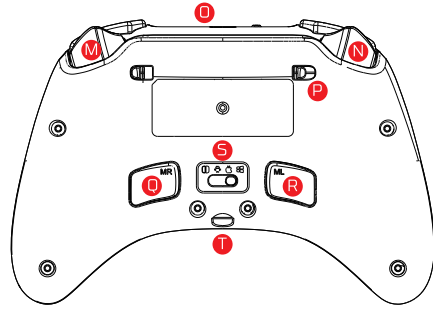

### ID

- |                           |                                |
|---------------------------|--------------------------------|
| <b>A</b> Thumbstick Kiri  | <b>K</b> Tombol Sinkronisasi   |
| <b>B</b> Thumbstick Kanan | <b>L</b> Bumper Kanan          |
| <b>C</b> Tombol Arah      | <b>M</b> Pemicu Kanan          |
| <b>D</b> Tombol Wajah     | <b>N</b> Pemicu Kiri           |
| <b>E</b> Tombol Select    | <b>O</b> USB-C Port            |
| <b>F</b> Tombol Start     | <b>P</b> Kunci Pemicu          |
| <b>G</b> Tombol Turbo     | <b>Q</b> Paddle Belakang Kanan |
| <b>H</b> Tombol Beranda   | <b>R</b> Paddle Belakang Kiri  |
| <b>I</b> Tombol Snap      | <b>S</b> Pengalih Platform     |
| <b>J</b> Bumper Kiri      | <b>T</b> Jack 3.5mm            |

## TRIGGER LOCKS

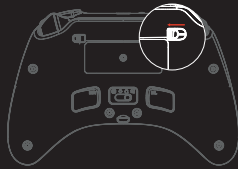

Instantly reduce the Trigger pull for faster in-game response time by sliding the built-in locks.

## CALIBRATE GAMEPAD



To initiate the calibration process for your gamepad Joystick and Trigger, please press the Turbo+Home+Start button. Once the calibration is complete, kindly press the Select button to conclude the calibration.

## LIGHTING MODE



1. You can adjust the lighting mode by pressing the Start button & Left D-pad.

2. To adjust lighting brightness, press the Select button & Up/Down D-pad.

3. There are 4 lighting modes (Running RGB Mode, Wake Mode, Breathing Mode, Static Mode). On Static Mode, press Start button & Right D-Pad to switch the color to your favourite.

## THUMBSTICK & D-PAD INTERCHANGE



To switch the Left Thumbstick to function as a D-Pad, press the Share button twice. Press the Share button twice again to revert the Left Thumbstick back to its original function.

## INTERCHANGEABLE D-PAD



Take control of your favorite games with precision by swapping out the D-Pad to suit your needs! Just lift up, and replace!

## INTERCHANGEABLE THUMBSTICKS



Control your games, your way! Simply pull off the thumbsticks to replace them with higher or lower size, to fit your needs!

## DOWNLOAD

To further customize your setting, please visit our website and download the software (if applicable).



[www.fantechworld.com](http://www.fantechworld.com)

## HOW TO CONNECT

### WIRED CONNECTION

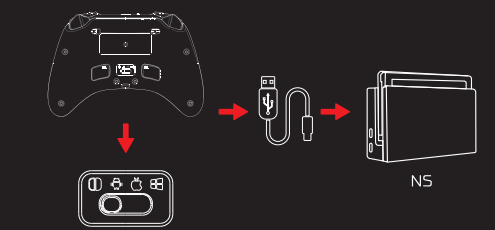
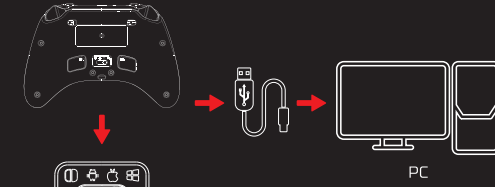

### BT CONNECTION

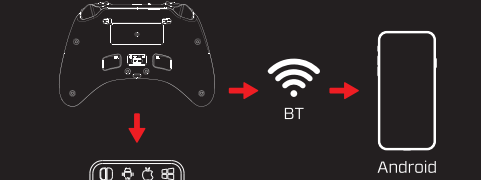
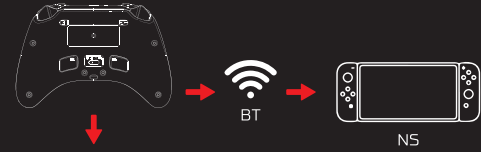

Fantech EOS PRO V2

### 2.4GHZ CONNECTION

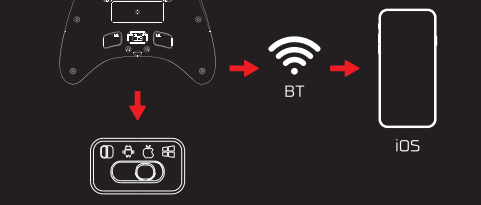
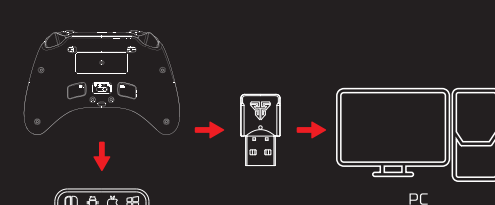

Xbox Wireless Controller

## ANY QUESTIONS?

Thanks for choosing Fantech.  
If you have any question or need any help with your products, please do not hesitate to contact us.

[support@fantechworld.com](mailto:support@fantechworld.com)

WGP15V2  
**EOS PRO II**  
MULTI-PLATFORM WIRELESS CONTROLLER



## QUICK START GUIDE

PANDUAN CEPAT [ID]  
快速入门指南 [ZH]

## LED INDICATOR



## RUMBLE MODE



You can adjust the Rumble intensity by holding the Turbo button and push the Left Analog stick Up & Down.

\*There are 4 level of Rumble (100%-70%-30%-0%).

## TURBO & AUTO TURBO MODE

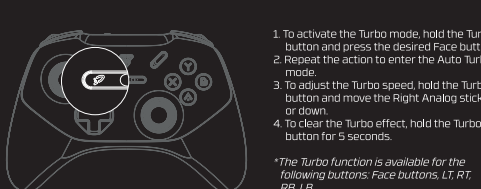

1. To activate the Turbo mode, hold the Turbo button and press the desired Face button.  
2. Repeat the action to enter the Auto Turbo mode.  
3. To adjust the Turbo speed, hold the Turbo button and move the Right Analog stick up or down.  
4. To clear the Turbo effect, hold the Turbo button for 5 seconds.

\*The Turbo function is available for the following buttons: Face buttons, LT, RT, RB, LB.

## MACRO MODE

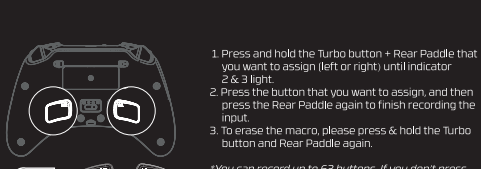

1. Press and hold the Turbo button + Rear Paddle that you want to assign (left or right) until indicator 2 & 3 light.  
2. Press the button that you want to assign, and then press the Rear Paddle again to finish recording the input.  
3. To erase the macro, please press & hold the Turbo button and Rear Paddle again.

\*You can record up to 63 buttons. If you don't press anything for 5 minutes when recording, it will automatically stop inputting the macro.

Join the Fantech  
Discord  
Community

