

# ***E-BIKE USER MANUAL***



---

## **ATTENTION**

Please read this manual carefully before using the electric bicycle. If you do not understand this information, or if you do not cover the issues covered in this manual, please contact the dealer.

---



# ***E-BIKE***

## ***TABLE OF CONTENTS***

<b>ASSEMBLY INSTRUCTIONS</b>	<b>01</b>
<b>BATTERY AND CHARGER CARE</b>	<b>05</b>
<b>OPERATIONAL INSTRUCTIONS</b>	<b>06</b>
<b>MAINTENANCE</b>	<b>08</b>
<b>WARRANTY CARD</b>	<b>09</b>

**\*Before your first operation, please read the user manual carefully!**

### **Note**

Before your first ride, it is important for you to know your new e-bike well, so that you can get the best performance, comfort, enjoyment and safety from it during your ride. To understand the new bicycle and the correct operation, you should first read the manual carefully.

Second, it is significant to take your first ride under a safe and controlled circumstance, like staying away from cars, obstacles and other cyclists.

Third, bicycles are vehicles with certain risks. Please follow the traffic rules during cycling. It's better to learn the local traffic rules about riding an e-bike on public roads before your first ride in case you violate the regulations. For your own safety, never forget to put on a qualified helmet before you get on the e-bike.

Fourth, the electric bike is supplied without basic mandatory equipment, which may vary from place to place. Therefore, if you intend to use the e-bike on public roads, it's necessary to equip the bike with the basic mandatory equipment, in accordance with the relevant laws and regulations.

In addition, this product is designed for your personal use. Do not use it for commercial or other purposes.

Last, keep this manual safe for reference.

### **Warning**

Before each charge, check the charger, cable and plug. If there is any damage, do not use the charger.

Before riding, check the tire pressure and check whether the wheels and handlebar are installed correctly and tightly.

Before riding, check whether the headlights are securely fastened in the correct position, clean and not covered by anything. Damaged reflectors must be replaced.



# 01 ASSEMBLY INSTRUCTIONS

AL26



**Prompt:**

Please read the installation steps before installation and install according to the installation pictures and texts.



## PART 1: INSTALL THE HANDLEBARS.



**01** Remove the four screws.



**02** The handlebar is mounted in the center above the seat tube.



**03** Remove the four screws. Remove the four screws. Remove the four screws.



**04** Remove the four screws. Remove the four screws. Remove the four screws.

## PART 2: INSTALL THE FRONT WHEELS.

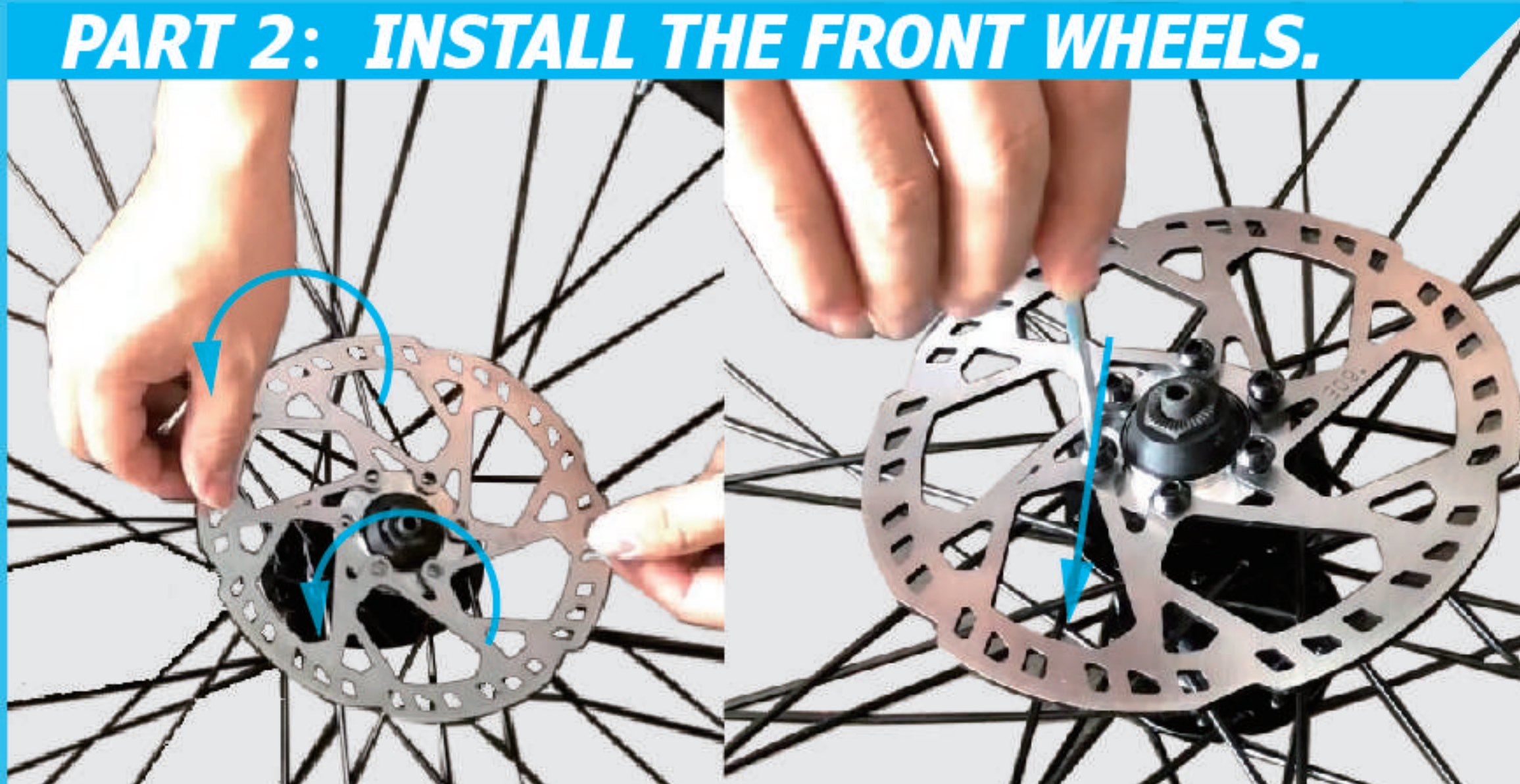

**01** Remove the fixed tool.



**02** Remove the protective shims from the brakes.



**03** Fix the front fork to the designated position of the front wheel (as shown in the figure)



**04** Install the quick release shaft and fix the front fork and front wheel. (As shown in the picture)

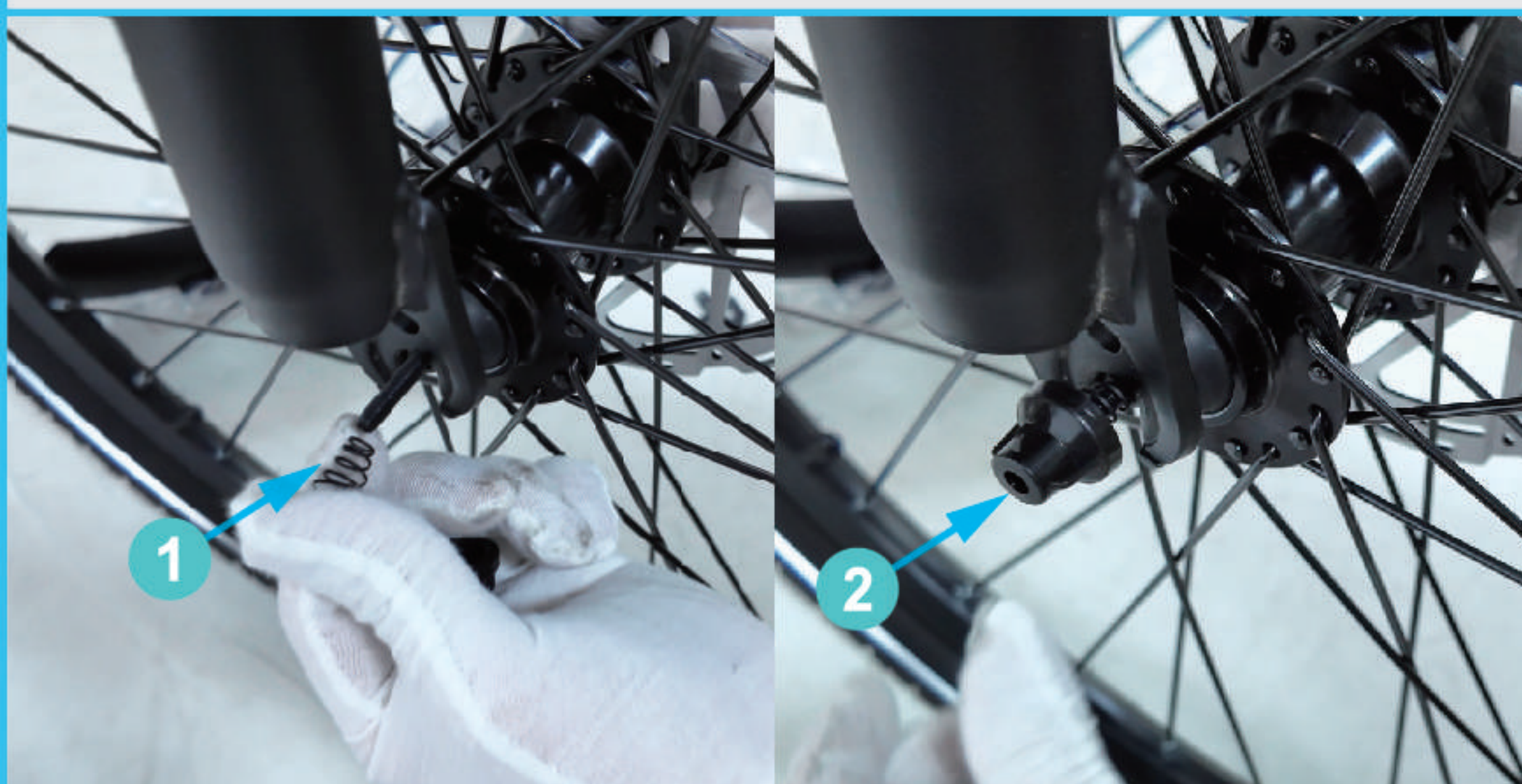

**05** Install the fixing accessories on the other end of the quick release shaft in sequence.

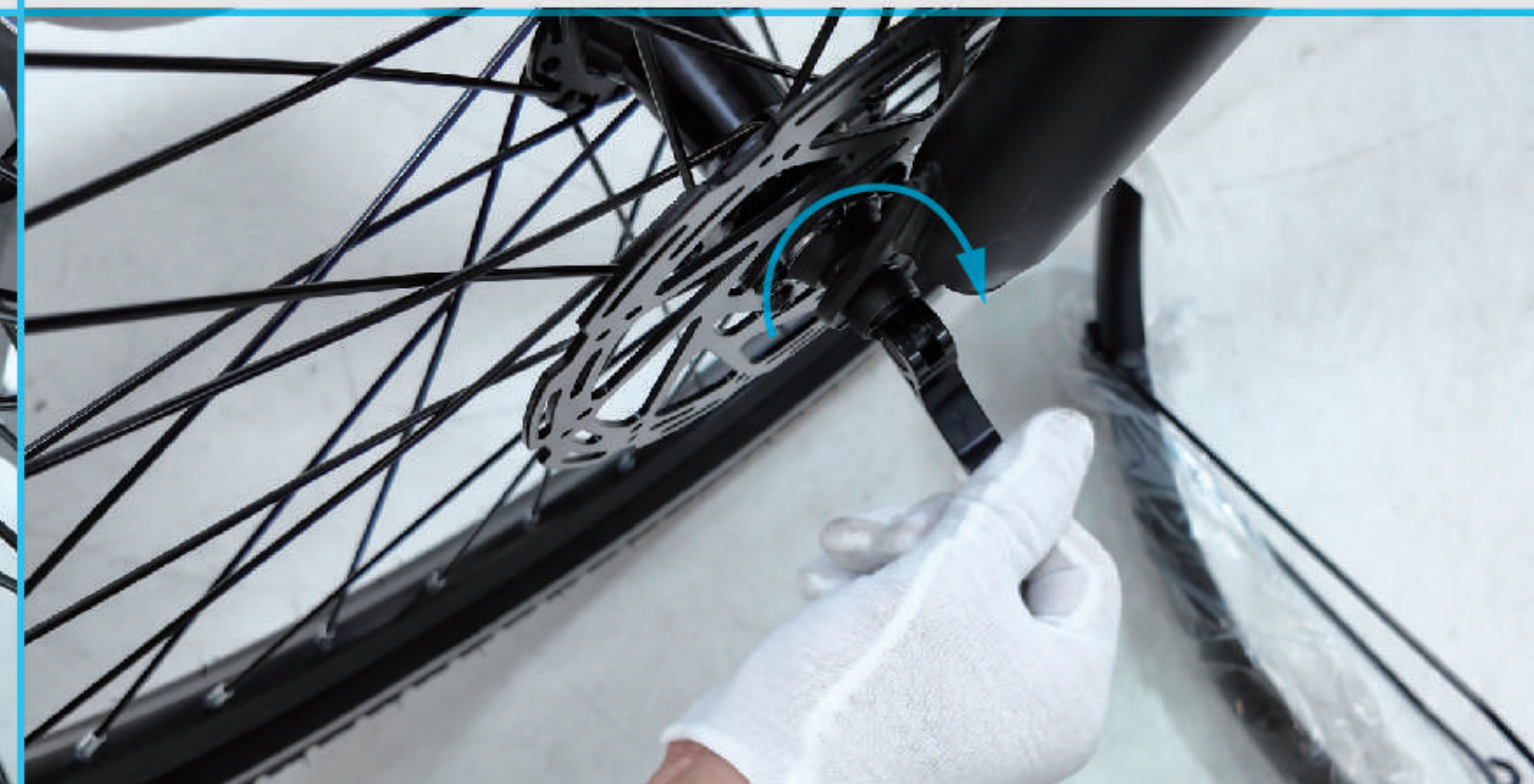

**06** Tighten the quick-release axle to secure the front wheel.



**07** Check that the front wheel is centered.



**08** Once you are sure the front wheel is in the correct position, lock the quick-release axle to lock it.

## PART 3: INSTALL THE HEADLIGHTS AND FENDERS.



**01** Remove the screws here and secure them to the headlight bracket.

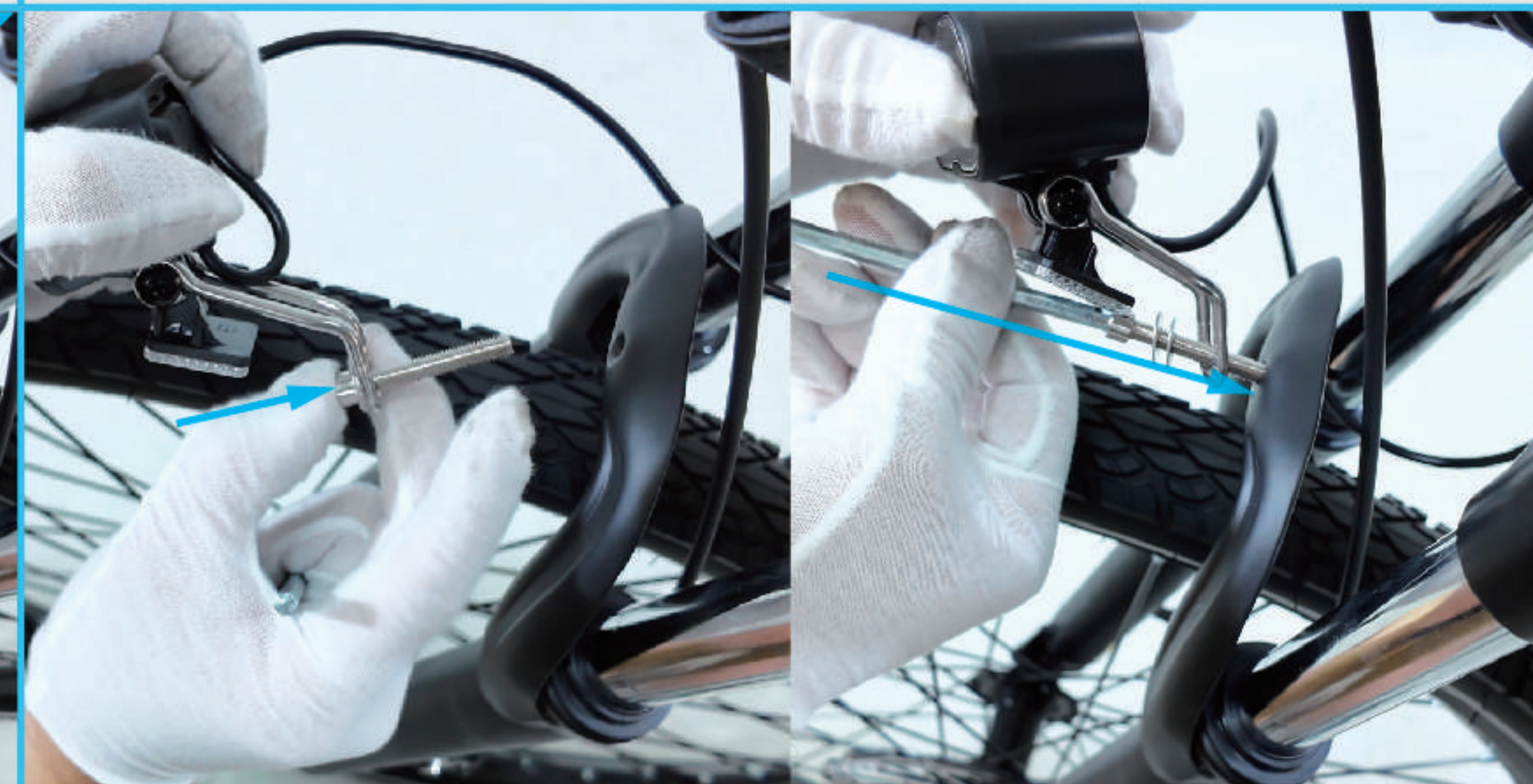

**02** The headlight bracket is fixed in this position and the screws are tightened to fix it to the vehicle.



**03** After the headlight is fixed, install the fender raising washer. (As shown in the picture)



**04** Insert the fender into the screws here.



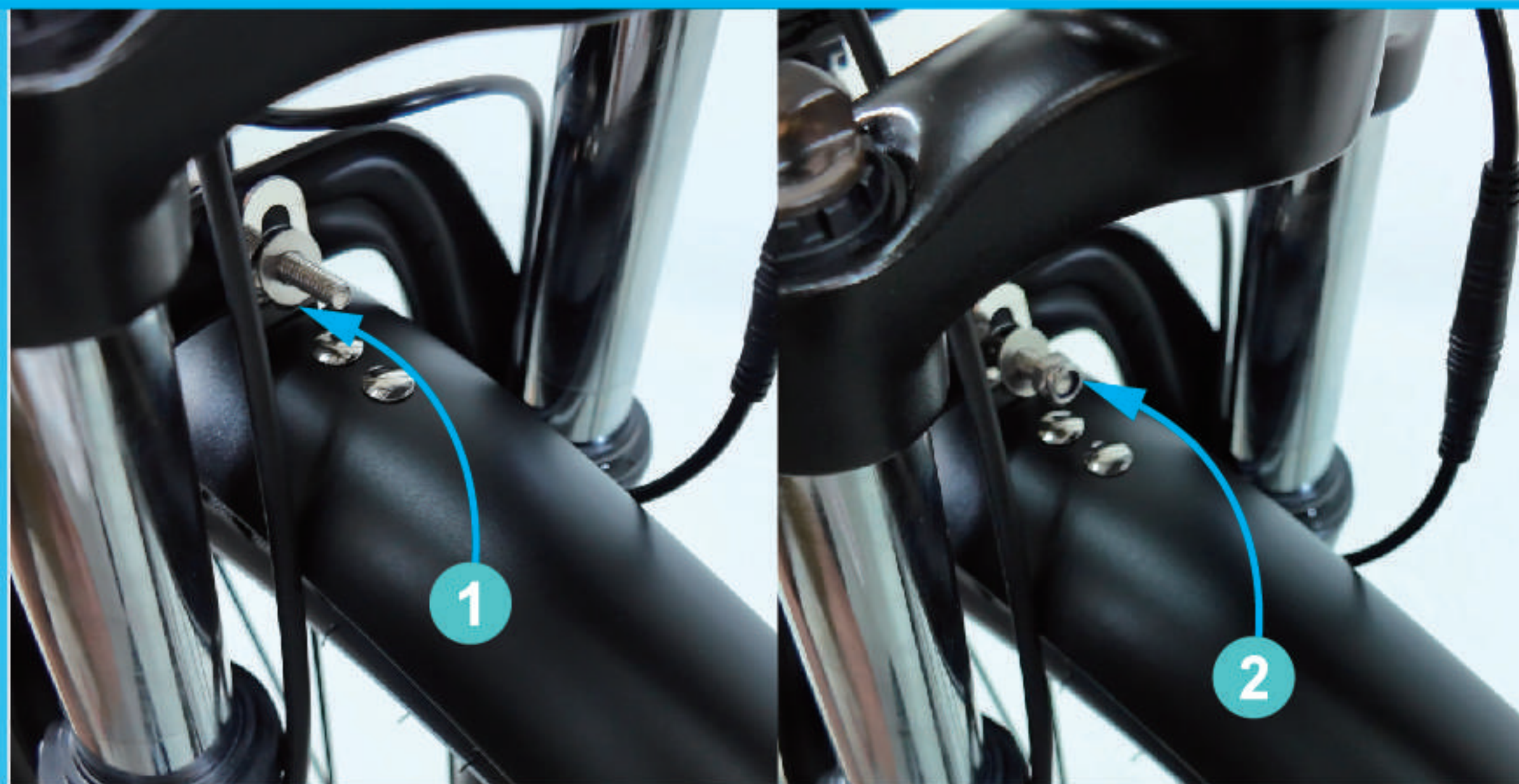

**05** Put the washers and nuts in order and secure the fender.



**06** Tighten the nut to secure the fender.



**07** Install the brackets on both sides of the fender as shown in the figure.



**08** The headlights and fenders are installed.

### PART 5: INSTALL THE PEDALS.



**01** Determine the left and right pedals.



**02** Remove the four screws. Remove the four screws. Remove the four screws. Remove the four screws.



**03** Pedal installation is complete.



**04** The vehicle is assembled.

### How To Take Out The Battery



**01** insert the key into the keyhole.



**02** Turn the key and press to release the latch.



**03** Battery removal status.



**04** Battery







## CHARGER AND BATTERY

### Attention

Connect the battery first, then connect the power supply and make sure the red LED of the charger is lit.

A red light indicates that the battery is charging. A green light indicates that the battery is fully charged.

### About Charger

Charge the charger in a place that meets the following conditions. Place with good wind and low humidity. Places that are not exposed to direct sunlight or rain. Places that are not exposed to water. Places where the indoor temperature is around 15 to 25 °C. Places that infants and pets do not touch.

### About the battery

(1) The battery is not fully charged at the time of shipment, but please use it as it is and charge it after it is used up.

(2) Depending on the environment and battery condition, it may not be charged or the charger lamp display may not be normally diminished, in this case, drive a few kilometers and then try charging again.

(3) The charger and battery will get hot during charging, but this is not a problem.

**⚠ When charging is complete, unplug the charger. Keeping it connected shortens the life of the battery or charger.**

RECHARGE THE BATTERY ON E-BIKE DIRECTLY.





## 02 OPERATIONAL INSTRUCTIONS



## Routine operation

## Power on/off

Long press  to power on / off the display. When the display is off, it will not use the battery power and the leakage current is less than 1uA.

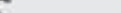
 **The display will automatically shut off if it is not used for more than 10 minutes.**

## Walk boost mode

Long press and hold , the electric bicycle enters the walk boost mode. The electric bicycles will travel at walking speed and the display shows . Release the button to stop the power output immediately and restore to the state before walk boost.



**Figure 5-2 Helping to implement the display screen**

 **The walk boost mode can only be used when pushing the electric bicycle, please do not use it while riding.**

## PAS level selection

Press **+** / **-** to switch PAS level of electric bicycle, thus changing the motor output power. (The following pictures are only for illustration of different speeds in different gears. The specific speed is subject to the actual product)

## Battery level display

The Battery level is shown as 5 bars. When the battery is full charged, all of the 5 bars lighten up. When the battery is fully depleted, the bar begin to flash, warning the user to charge the battery as soon as possible.

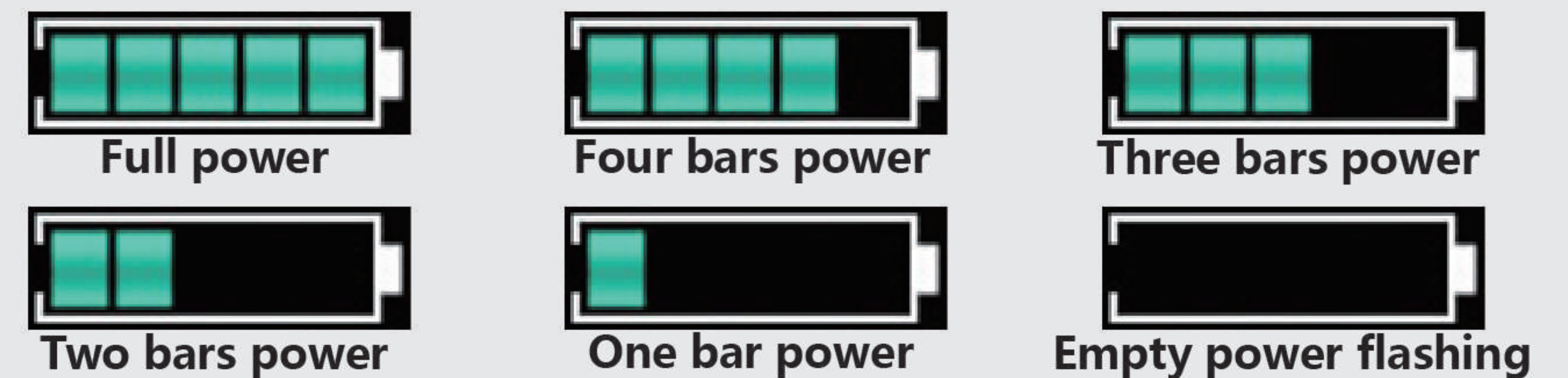

## Error code display

If there is a fault occurs in the electronic system of the electric bicycle, the display will automatically show an error Code, see **Schedule 1** for a detailed definition of the error code.



### Figure 5-6 Error Code Display

## Personalized parameter settings

**⚠ The setting needs to be done with the bicycle stationary.**

The personalized parameter setting procedure is as follows:

When the display is ON and the speed shows 0,

- (1) Press and hold **+** **-** simultaneously for more than 2 seconds to enter the personalized parameter setting interface.
- (2) Press **+**/**-** to toggle between the personalized parameter setting interface, and press **⏻** to enter the parameter changing state.
- (3) Press **+**/**-** to select the parameter, long press **+** for addition operation, long press **-** for subtraction operation.
- (4) Press **⏻** to save the parameter settings and return to the personalized parameter setting interface.
- (5) Long press **⏻** to save the parameter settings and exit the personalized parameter setting interface.



The following options are available on the personalized parameter setting interface

### Metric and Imperial setting

**01P** is the metric and imperial setting, 00 for metric and 01 for imperial.





Press  to enter the parameter changing state. Press the / to select the parameter and press  to save the parameter setting and return to the personalized parameter setting interface.



Figure 6-1 Metric and imperial units setting interface

### Metric and Imperial setting

**01P** is the metric and imperial setting, 00 for metric and 01 for imperial.









Press  to enter the parameter changing state. Press the / to select the parameter and press  to save the parameter setting and return to the personalized parameter setting interface.



Figure 6-1 Metric and imperial units setting interface

### Speed limit setting

**06P** is the speed limit setting. The adjustable speed limit range is: 1~100km/h. (The maximum adjustable speed limit varies by different protocols).

Press  to enter the parameter changing state. Press the / to select the parameter and press  to save the parameter setting and return to the personalized parameter setting interface.

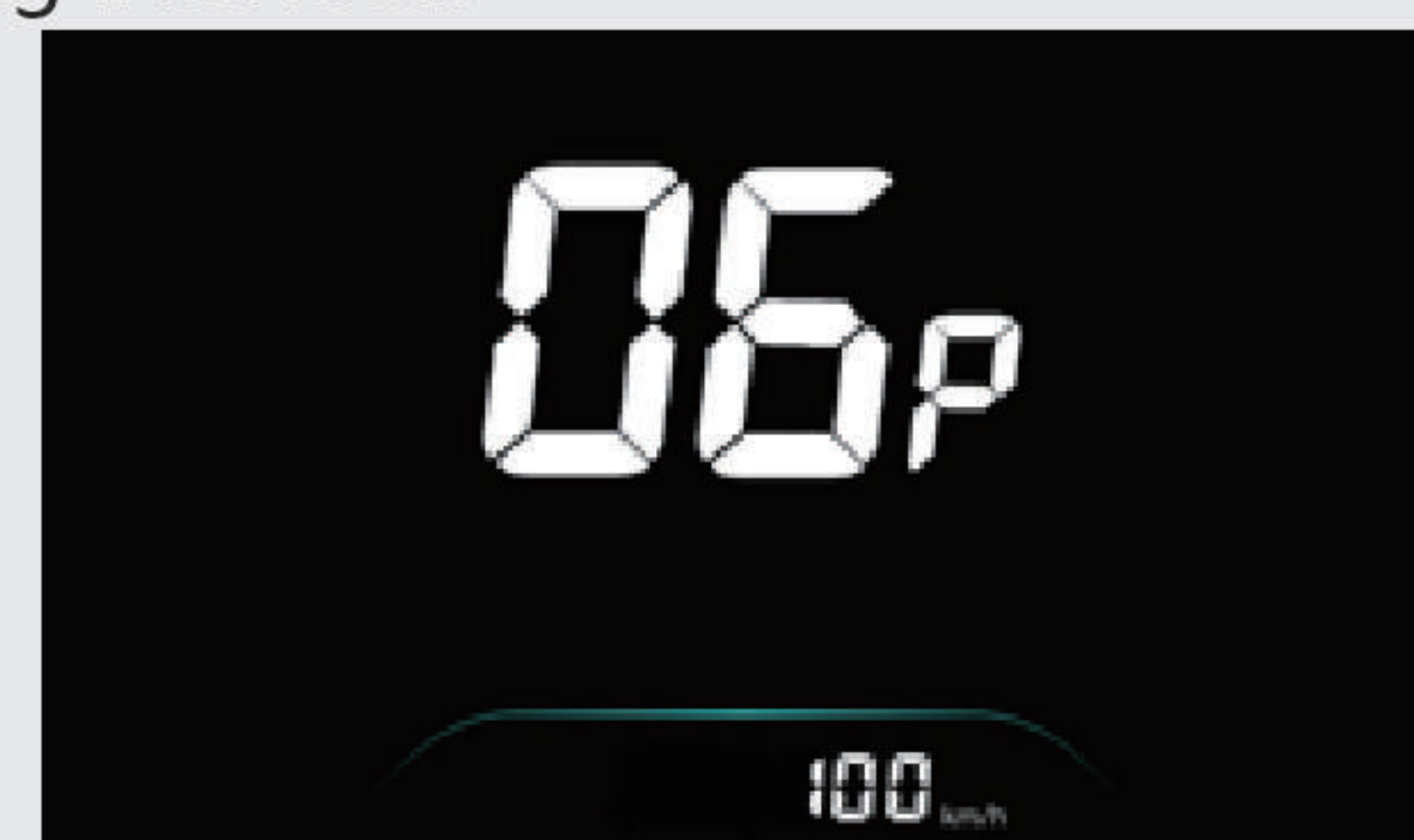





Figure 6-6 Speed limit setting interface

### Drive mode setting

**08P** is the drive mode setting. The available drive modes are: 00→Pedal assist only, 01→Electric only, 02→Both Pedal assist and electric.

Press  to enter the parameter changing state. Press the / to select the parameter and press  to save the parameter setting and return to the personalized parameter setting interface.

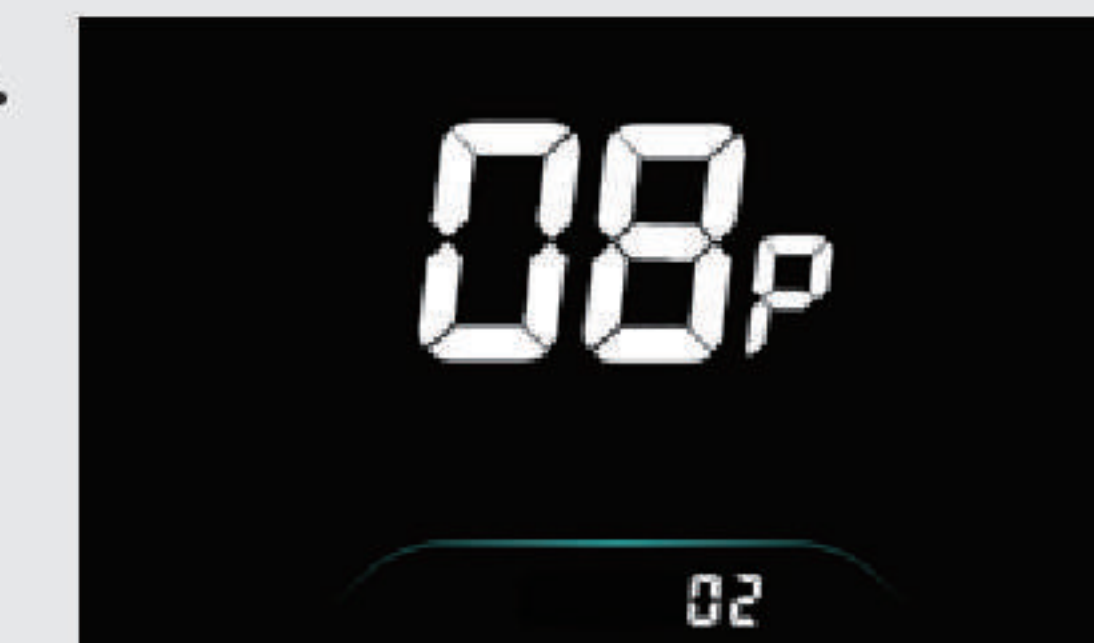







Figure 6-8 Drive mode setting interface

### Shortcut operation

#### Restore factory default parameter settings operation

dE is the restore factory default parameter settings. dEF-Y is the restore the factory default settings, and dEF-N is not to restore.

Enter into the main setting interface and keep the speed at 0, press and hold  and  simultaneously for 2s to enter the restore factory default setting interface. Pressing / to toggle to dEF-Y. Then after pressing  to confirm, the display will show dEF-0 for a few seconds and then automatically start to restore the default settings. The display will automatically exit to setting interface after the restoration.

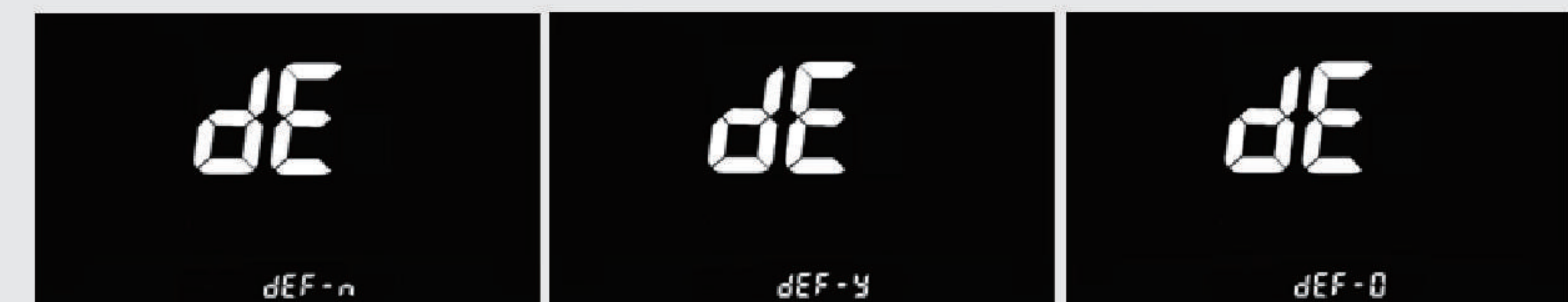

Figure 7-1 Restore factory default parameter setting interface

### Precautions

Pay attention to all the general operating when using the products and do not plug and unplug the display while it is powered on.

- ◆ Avoid bumping the display as much as possible.
- ◆ Please do not change the parameter settings at will, otherwise normal riding cannot be guaranteed.
- ◆ If display does not work properly, please send it to the repair center as soon as possible.
- ◆ There may be differences between the physical products and this manual due to normal upgrade. Please refer to the physical products.

Schedule 1: Error Code Definition			
YL-02 Error codes			
Error code	Definition	Error code	Definition
E001	Controller failure	E004	Throttle failure
E002	Communication failure	E005	Brake failure
E003	Hall failure	E006	Motor phase failure



Maintenance

Cleaning

Use a soft and wet cloth to wipe the mainframe clean. Dirt that is hard to remove can be scrubbed with a toothbrush and toothpaste, then cleaned with a soft and damp cloth. Do not wash your e-bike with alcohol, gasoline, acetone, or other corrosive/volatile solvents. These substances may damage the appearance and internal structure of the e-bike. Do not soak the bike or wash it with a pressure washer or hose.

Storage

A) Bicycle

- 1. Do not expose the e-bike to direct sunlight or rain for an extended period of time, and avoid storing it at a high temperature. It's better to store the bike in a dry and safe place at a temperature of 0°C-25°C.
- 2. Avoid corrosive gas, so as to avoid chemical corrosion and damage to the electrical parts and painted surfaces, which may lead to operational failure and accident.
- 3. Don't store it in an explosive or flammable environment or near flammable liquids.

B) Lithium-ion Battery

- 1. Charge the battery after each ride and avoid draining the battery completely. Because completely draining the battery may cause permanent damage to it. Never keep the lithium-ion battery discharged for a long time. If the voltage of the cell drops under allowed limit due to self-discharge, it will cause damage. For maximum durability, store the battery charged up to 50% of the maximum capacity.
- 2. Never charge the battery in an explosive or flammable environment or near flammable liquids. Do not charge the battery on a flammable substrate, such as paper, textiles, etc., when the battery is detached from the vehicle. Charge it at a safe place away from flammable items.
- 3. Never charge a battery which is already damaged or is leaking.
- 4. Don't charge the battery too long. Stop charging when it gets full.
- 5. Charge or discharge the battery at a temperature within 0~45°C.
- 6. It is better to store the battery indoors within 20°C~25°C temperature while it is not being used for a long time. (When used at 25°C, the battery range and performance is at its best. But using it at a temperature below 0°C can decrease its mileage and performance.)
- 7. Do not store the battery at a too high or too low temperature.
- 8. The humidity of the storage place should be 60±25%RH. As for the working place, the humidity should be 5~85%RH.
- 9. Do not puncture, hit or crash the battery.
- 10. Don't try to disassemble the old or damaged battery or throw it away. Please take it to the local professional battery recycling facility.

C) Other Parts

Head Sets	Remove, clean and lubricate the rims annually. Replace them if necessary.
Joints	Continuously check all nuts, bolts and quick-release devices for tightness.
Brakes	Lubricate the brake cables slightly with oil monthly. Check the adjustment and replace the brake parts (blocks, shoes, pads) in time if they are worn. The cables must be replaced if they are damaged/down.
Front Suspension Fork	Entrust it to experts.
Tires	Regularly check for damage, wear, cut and air leakage.
Wheel Hubs	Lubricate the hub bearings monthly. Check and adjust the cones, if necessary, to prevent the hubs from rubbing against the forks.
Pedals	Lubricate the bearings and check for tightness.
Cranks	Lubricate the bearings monthly (unless a maintenance-free center bracket is installed on the bike). Check whether all center bracket parts are correctly tightened.
Chain	Take it off and clean it every 6 months. The chain must be clean but not dry.
Rims	Frequently check whether the wheels are tight and secure. The rims should be protected from oil, wax, grease, adhesive, etc. Check whether the spokes are loosening or missing.
Sprockets	Clean regularly as necessary and grease lightly. Keep the front and rear derailleur running smoothly by adjusting.
Saddle and Seat Post	Check whether the screws, nuts and quick-release devices are tight.
Kickstand	Clean and lightly grease it annually.

**Attention:** when lubricating, make sure the lubricant doesn't get on the brake discs and pads. Otherwise, the brake system may fail to function.



# 03 WARRANTY CARD

No.	Description	Name	Warranty time (months)	Warranty condition
1	Non-electrical control products	Frame	12	Natural fracture, opening welding, dewelding.
2		Front fork	12	
3	Electrical control products	Motor	12	Performance failure due to poor manufacturing and cannot be repaired.
4		controller	12	Incase of grid break, no power storage, no power charging and other faults, three warrantys will be given (warrantys will be given if the battery does not circulate, and the warranty period for replacing the battery will be calculated according to the remaining date of the warranty period of the original battery)
5		charger	12	
6		battery	12	
7		display	12	
8	Plastic and other parts not under warranty	plastic parts(including fenders), brake pads, brackets, inner tubes, outer tubes, disc rotors, rim brake surfaces, lights, brake fluid, brake cables, chains, belts, pedals, grips etc. are vulnerable parts and consumables in normal use.		
List of other non-warranty situations.				
1. Improper assembly or failure to comply with the manufacturer's assembly requirements.				
2. Improper use of products.				
3. Damage caused by corrosion of drugs and chemicals, and damage caused by irresistible factors such as geological disasters.				
4. Install components, parts or accessories that are not intended for or compatible with the sold vehicle.				
5. Damage or failure caused by accident, misuse, abuse or negligence.				
6. Labor costs arising from replacement or conversion of parts.				
7. In the case that the maintenance measures do not comply with the manufacturer's recommendations, the warranty does not cover the fault problems associated with improper handling; The guarantee is applicable only when regular maintenance is implemented.				



# ***E-BIKE***

---

Please read this manual carefully before using the electric bicycle.  
If you do not understand this information, or if you do not cover  
the issues covered in this manual, please contact the dealer.