



Larvik Studio Stand

for 45"-65" TVs

KALKTVSTNDA, KALKTVSTNBA & KALKTVSTNWA

Safety & Warnings	3
Components	5
Assembly	6
Notes	17

Safety & Warnings

- Read all instructions thoroughly before beginning assembly.
- Exceeding the rated weight limit (including the TV, screws, and all attached hardware and components) may result in instability and possible injury.
- This product is designed for installation on wood stud walls, solid concrete walls, or brick walls.
- For indoor use only. Outdoor use may lead to product failure and injury.
- This product contains small parts that may pose a choking hazard if swallowed. Keep all small components and packaging materials away from young children.
- This product is not a toy. Do not allow children to play near the stand without direct supervision.
- Ensure these instructions are read and fully understood before attempting installation. If you are unsure about any part of the installation, contact help.kogan.com.
- The wall or mounting surface must be capable of supporting the combined weight of the stand and TV. If it is not, the structure must be reinforced.
- It is highly recommended to use the supplied wall anchoring kit to prevent the stand from toppling. Failure to anchor the product may result in damage to the product or property, serious injury, or death.
- Use appropriate safety gear, safe working methods, and proper tools. A minimum of 2 people is required for installation. Failure to follow these guidelines may result in property damage, serious injury, or death.
- Inspect all joints every 3 months and re-tighten any loose screws before continued use.

Weight Ratings



Normal Floor



Glossy Floor



DANGER

Children have died from furniture toppling over.

To help prevent tip over:

- **NEVER** allow children to stand, climb or hang on TV stands.
- Ensure the TV is properly anchored to the TV stand before use around children.



Components



A (x2)



B



C



D



E



F



G (x2)



H (x2)



I (x2)

Hardware



J Screw (x2)



K 2mm Allen Key



L 4mm Allen Key



M Anti-toppling Screw (x4)



N Wall Anchor (x4)



M-A M5x14 Bolt (x4)



M-B M6x16 Bolt (x4)



M-C M6x30 Bolt (x4)



M-D M8x30 Bolt (x4)



M-E M8x50 Bolt (x4)



M-F Bracket (x4)



M-G Small Spacer (x8)



M-H Large Spacer (x8)

Assembly

Notes:

This product weight load differs depending on the floor surface.

- Maximum load for glossy floors (such as hardwood): 25kg.
- Maximum load for normal floors (such as concrete): 32kg.

Step 1

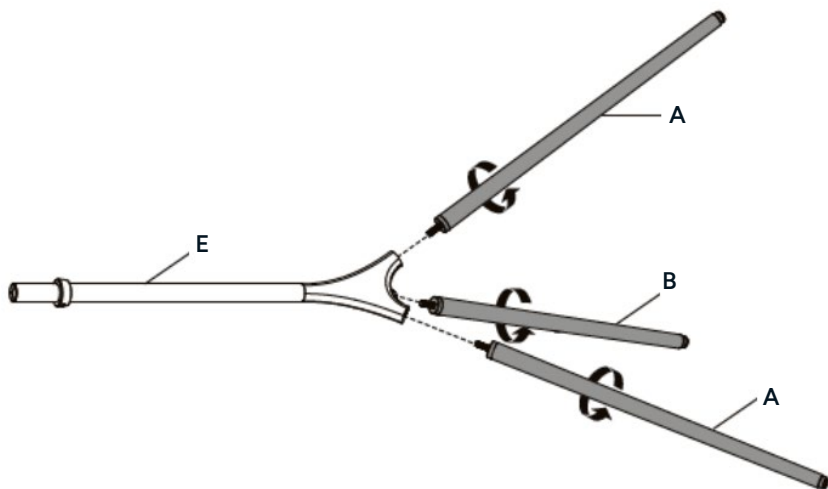

Step 2

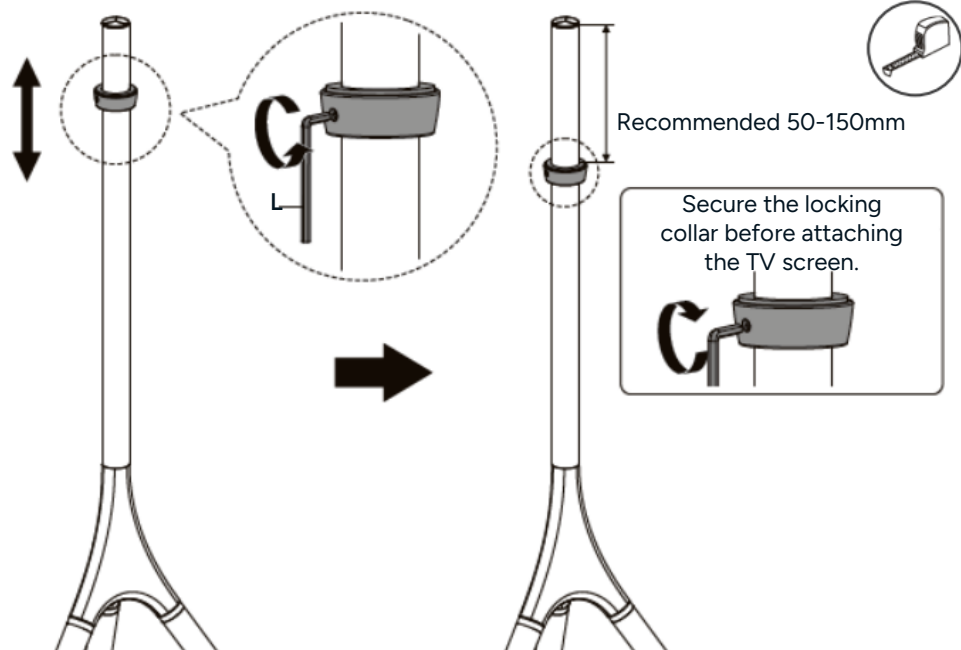

Step 3

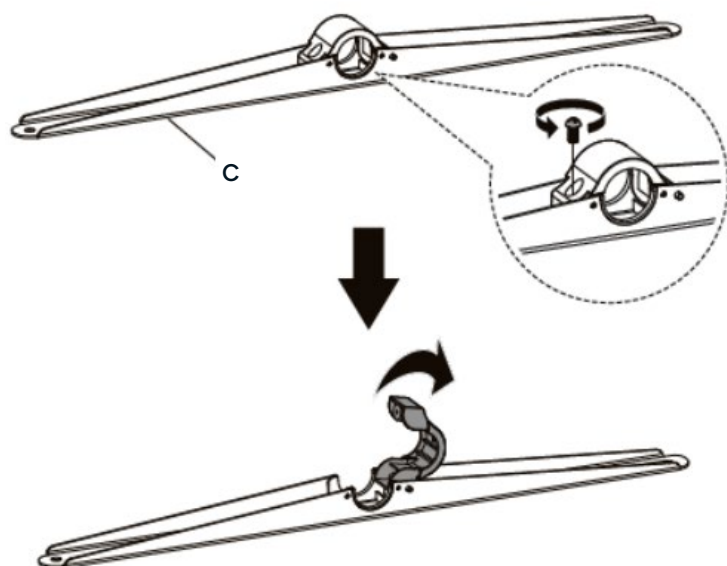

Step 4

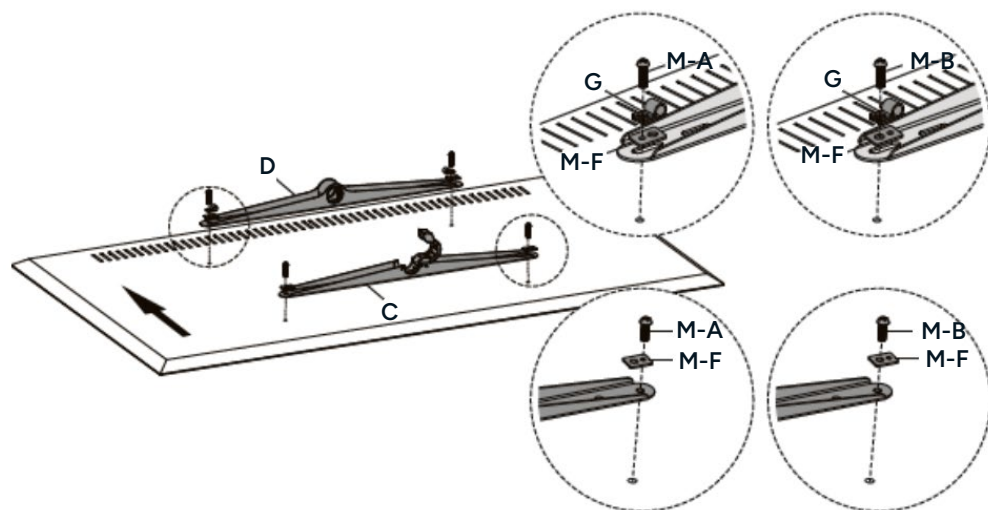
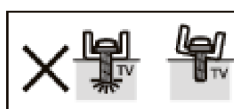
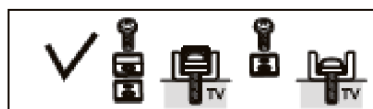

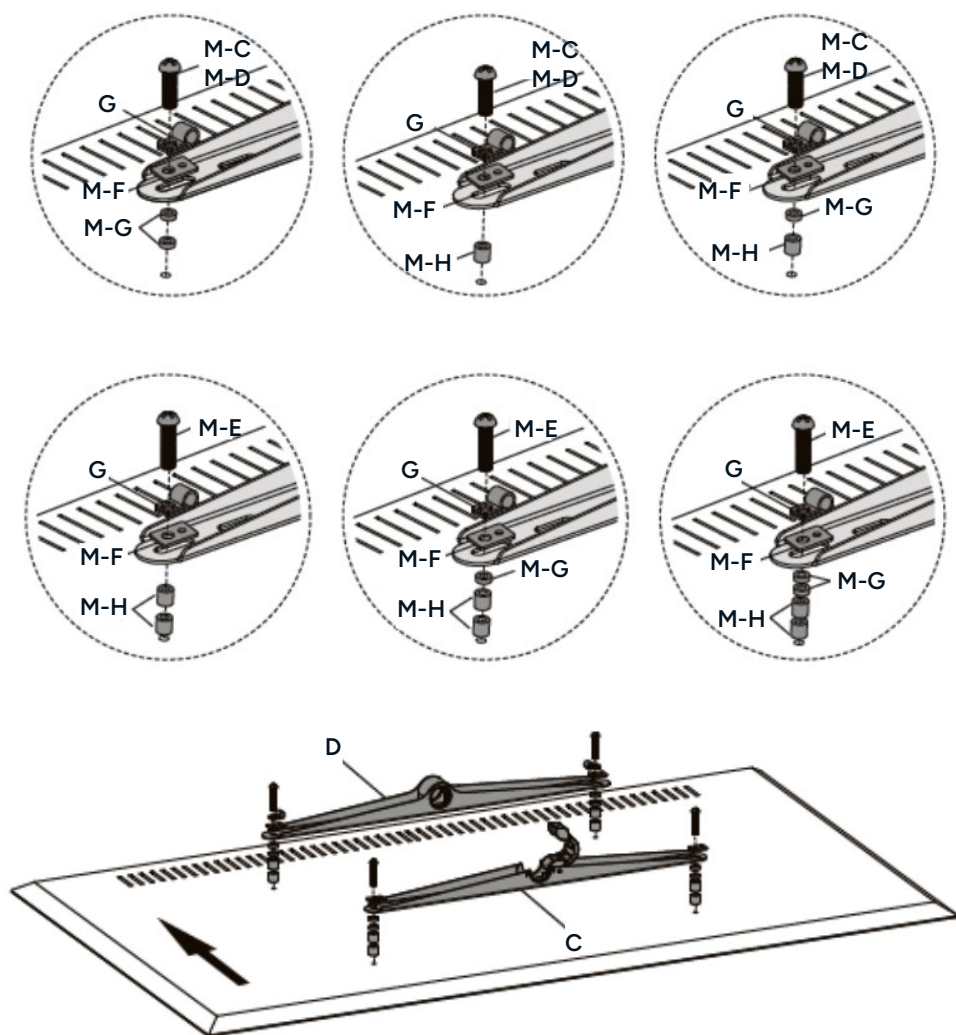

Note:

Ensure the cable clips (G) are attached to the upper bracket throughout step 4.

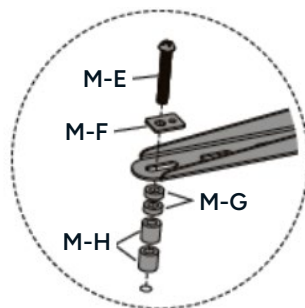
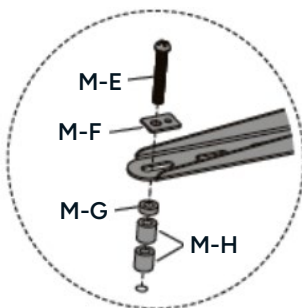
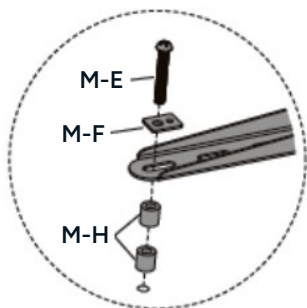
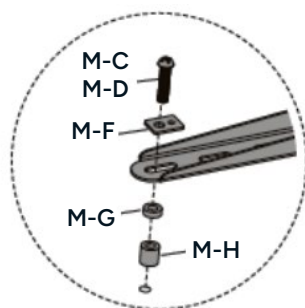
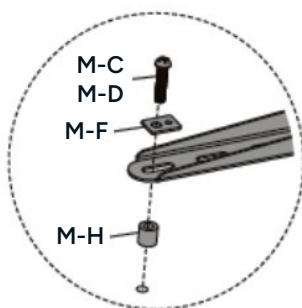
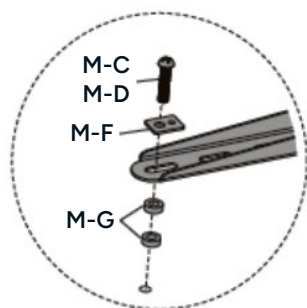
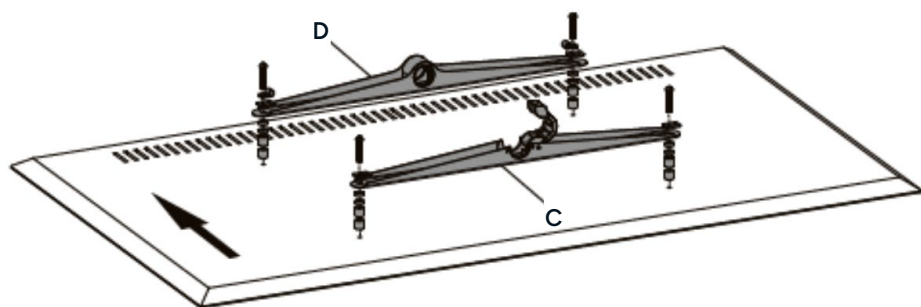

Step 5

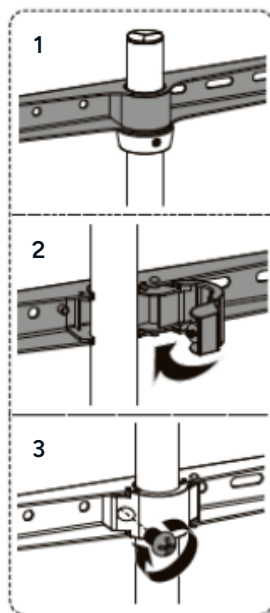
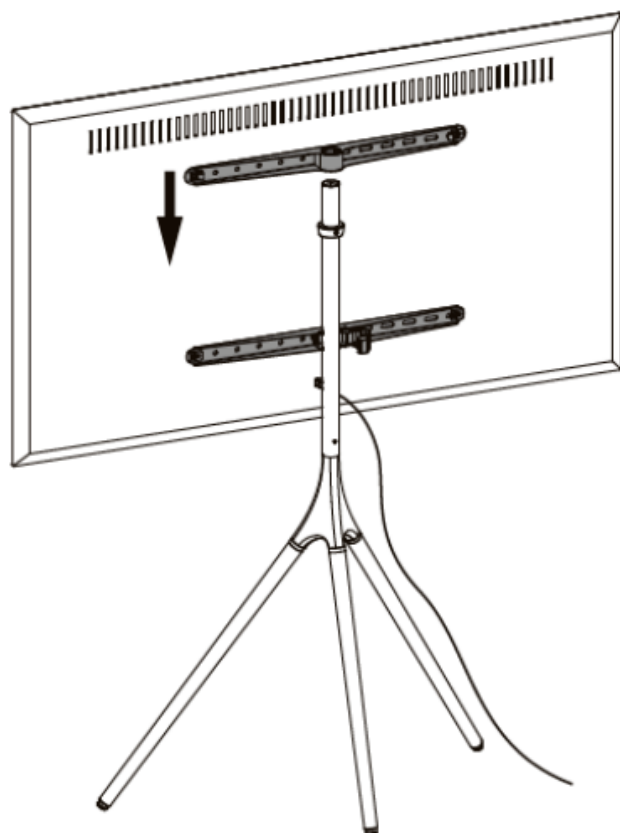

Step 6

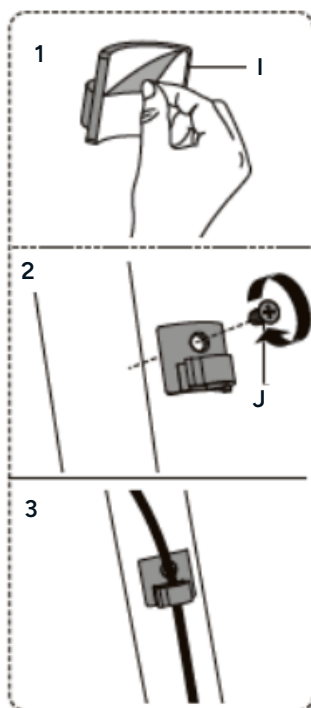
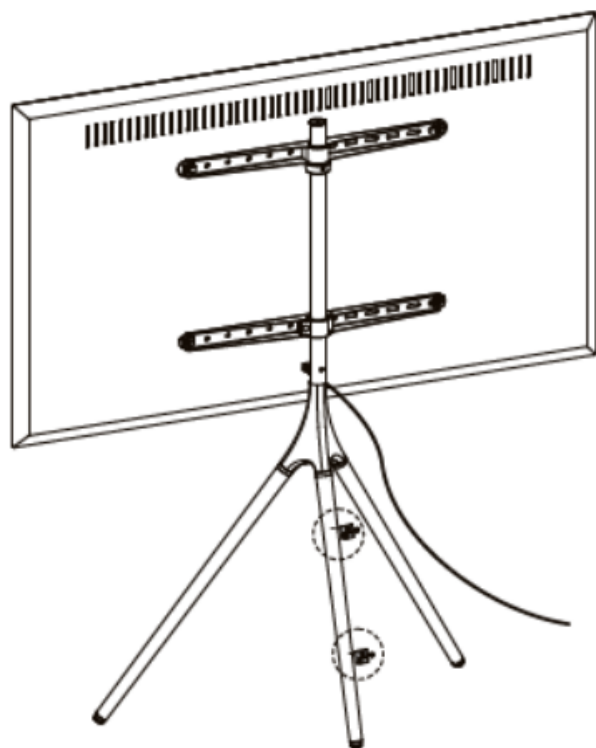

Step 7

Note:

Ensure the screen doesn't touch the aluminium plate.

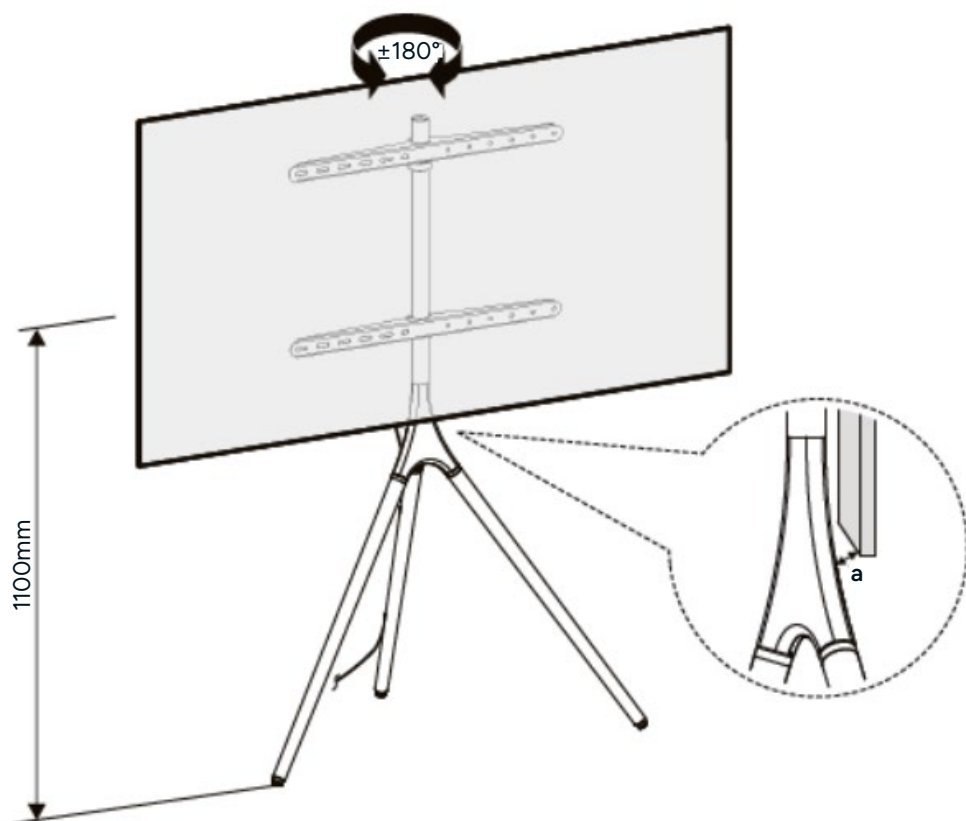

Step 8

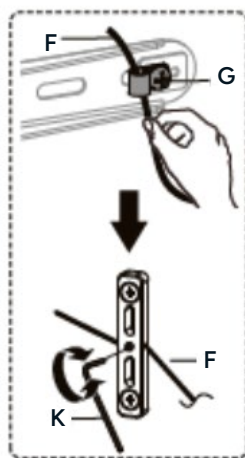
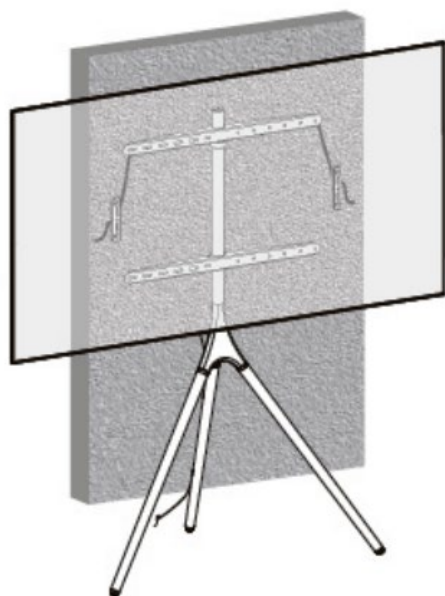
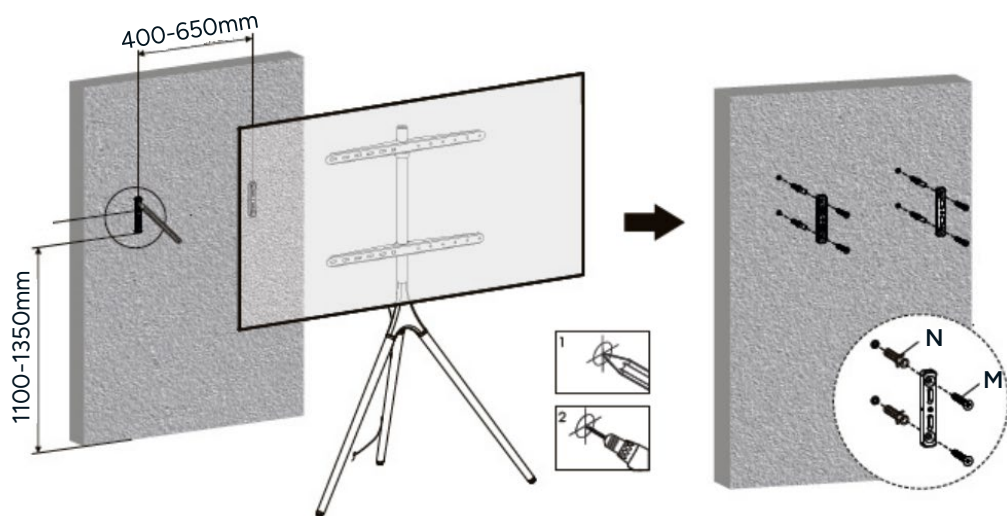
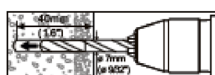

Dimensions

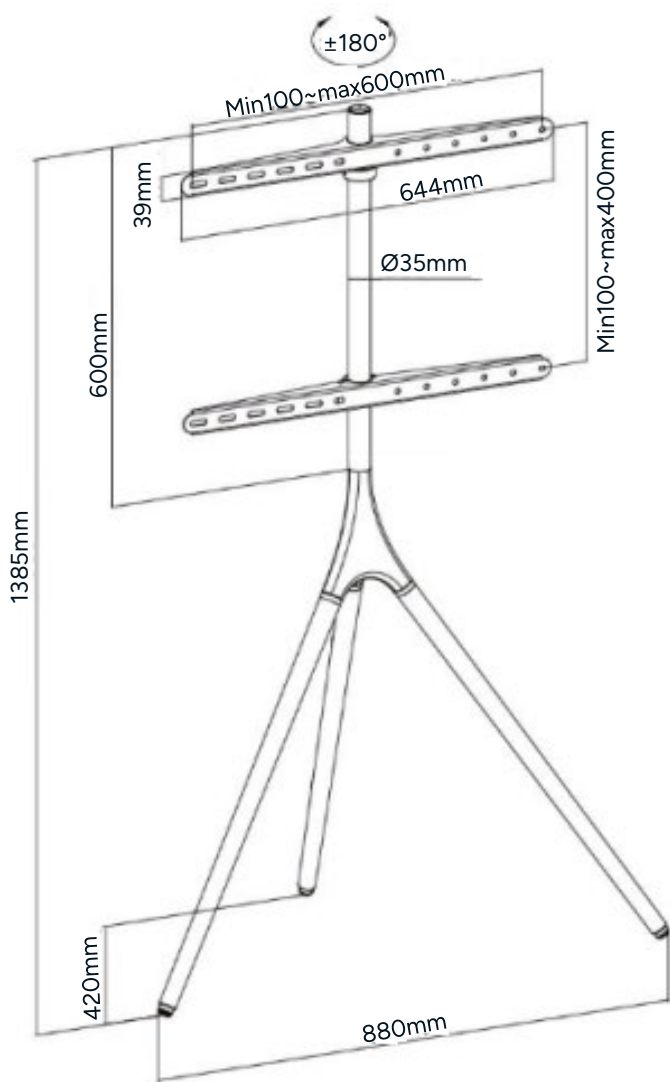

Note:

Design and specifications are subject to change without notice.

[illegible]

[illegible]

[illegible]

Need more information?

We hope that this user guide has given you the assistance needed for a simple set-up.

For the most up-to-date guide for your product, as well as any additional assistance you may require, head online to **help.Kogan.com**.

