

Quick reference guide

ProCuity L, LE, LEX



Scale

Watch the in-service video here!

Zeroing the scale

Before you place a patient on the product, zero the scale.

Note:

- Zero will display for non-NAWI and Tare will display for NAWI (International versions only).
- Always zero the scale after you add a support surface, mattress, or linens to the bed frame.

To zero the scale:

1. Press the Scale button on the footboard control panel.
2. On the Scale screen, press the Zero button.
3. On the New Patient? screen, you may choose from the following:
 - a. Yes to zero and delete scale history.
 - b. No to zero and not delete scale history.
 - c. Cancel to cancel zero and return to the Scale screen.

Note: Do not touch the bed when you zero the scale.

Adding or removing equipment

Note: The add or remove equipment function is only available when there is 4.4 lb (2 kg) gain/loss.

1. Press the Scale button on the footboard control panel.
2. On the Scale screen, press the Add Equip. button (0 +/- icon).
3. One item at a time, add or remove the desired equipment from the product.

Note: Do not touch the product while the product weighs the equipment.
4. Press the Save button to save the current weight and equipment count.

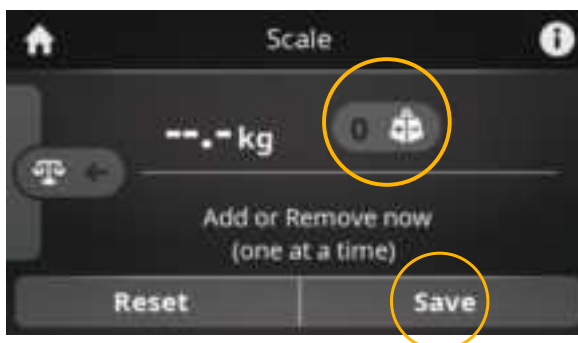

Weighing a patient¹

Note: Always zero the scale after you add a support surface, mattress, or linens to the product.

1.

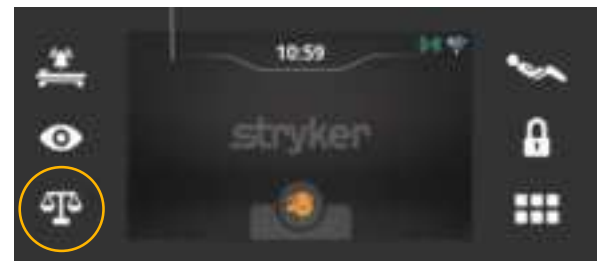

Press the scale button on the bottom left of the footboard control panel.

2.



On the scale screen, press the Save Weight button.

Note: Do not touch the product when you weigh the patient.

3.

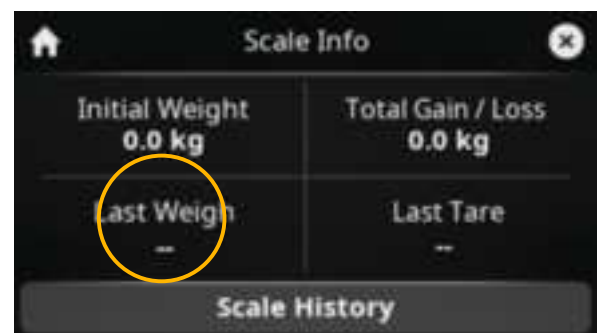

Note: The previous weight from the Last Weigh line will appear in Scale History.

1 WARNING - Do not use the scale system reading as a reference for medical treatment. The scale system assists only to monitor the patient's weight variation.

Arming or Disarming Bed Exit

WARNING – Do not use Bed Exit to replace patient monitoring protocol. Bed Exit is intended only to aid in the detection of a patient exiting the product.

When armed, Bed Exit monitors the patient's position on the product. To arm Bed Exit:

- 1. Set the scale to zero if not already performed.
Note: If you do not set the scale to zero before you place a patient on the product, Bed Exit may not operate as intended.
- 2. Position the patient on the product.
- 3. Press the Bed Exit button on the footboard control panel to arm Bed Exit.



- 4. Select the desired zone.



- If you change the parameter conditions for Bed Exit:
- Bed Exit priority signal sent
 - LEDs on the footboard and siderails flash red
 - Sound alarm is triggered

To disarm Bed Exit, press Turn Off.

Note: Make sure that the product is clear of surrounding objects when scale or Bed Exit is in use.

iBed Watch

The iBed Watch screen displays the iBed Watch functions of the product. When enabled, iBed Watch alerts when changes are made to the selected bed settings:

- Low height
- Siderails up
- Head angle
- Bed flat

If you change the monitored settings for iBed Watch:

- Bed Exit priority signal sent
- LEDs on the footboard and siderails flash red
- Sound alarm is triggered

To enable iBed Watch:

- 1. Position the patient on the product. When complete, press the iBed Watch button on the footboard control panel.

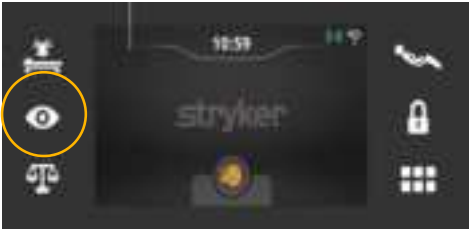

- 2. Select the desired bed settings to monitor.



A	Home	Returns to the Home screen
B	Info	Displays the iBed Watch Info screen
C	Low Height	Monitors low height of the bed
D	Head right siderail	Monitors head right siderail in the highest position
E	Head left siderail	Monitors head left siderail in the highest position
F	Foot right siderail	Monitors foot right siderail in the highest position
G	Foot left siderail	Monitors foot left siderail in the highest position
H	Head Angle	Monitors head angle of the bed
I	Bed Flat	Monitors bed flat position
J	Turn Off	Turns off iBed Watch
K	Exit	Returns to the iBed Watch On screen

To disable iBed Watch, press Turn Off.

Bed overview

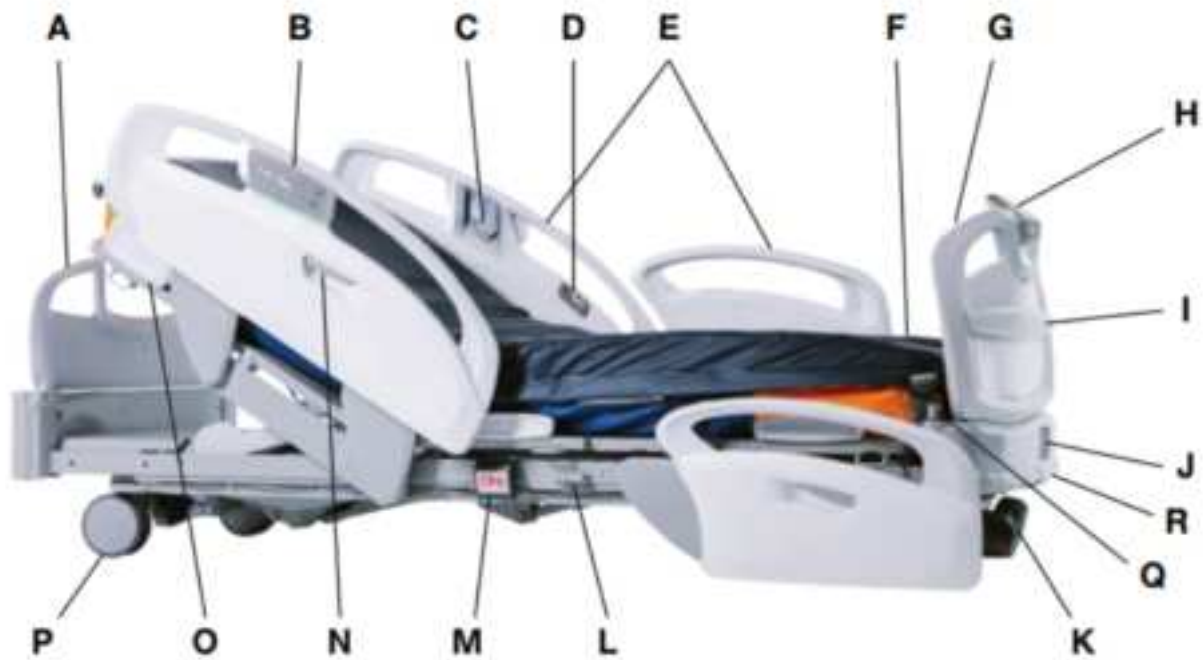

A	Headboard	J	Auxiliary outlet
B	Operator control panel	K	Brake/slew pedal
C	Patient device holder	L	Foley bag hook
D	Patient control panel	M	CPR release handle
E	Siderail	N	Siderail release
F	Support surface	O	Mattress retainer
G	Footboard	P	Caster
H	Footboard control panel	Q	Traction socket
I	Integrated pump rack	R	Bed extender release handle



37-pin connector

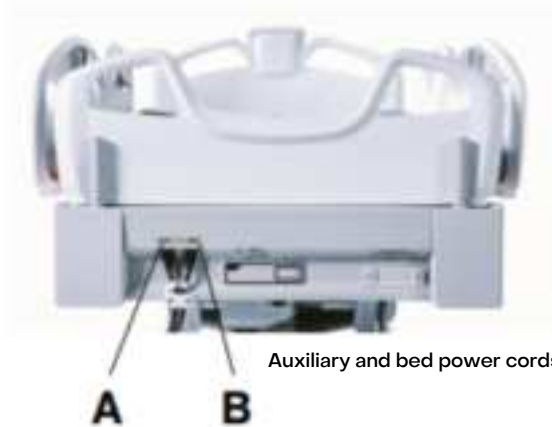

Auxiliary and bed power cords



Applying the brakes



Activating the CPR release handle



Foley bag hook



Releasing the brakes/neutral position

Bed overview

- **WARNING** - Always lower the product to its lowest height when the patient is unattended to reduce the risk of injury due to patient falls.
- Always lock the controls when the patient is unattended.
- Always route the cables, wires, and tubing from other equipment so that parts of the product do not pinch them.
- **CAUTION** - Always clear the product of obstacles before you use motion functions.

Caregiver controls (advanced)

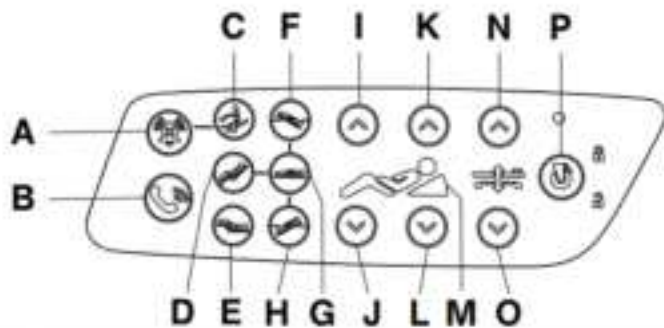

A	Bed exit	Press and hold to cancel bed exit alarm
B	Nurse call	Activates nurse call
C	Patient stand assist	Places the product into a position for patient ingress or egress
D	Cardiac chair position	Places the product into the cardiac chair position
E	Vascular position	Places the product into the vascular position
F	Trendelenburg	Places the product into the Trendelenburg position (head down with foot up)
G	Bed flat	Places the product into a 0° horizontal position
H	Reverse Trendelenburg	Places the product into the Reverse Trendelenburg position (head up with foot down)
I	Gatch up	Raises the Gatch
J	Gatch down	Lowest the Gatch
K	Fowler up	Raises the Fowler
L	Fowler down	Lowest the Fowler
M	Fowler 30°+	Illuminated when the Fowler is 30°+
N	Bed height up	Raises the litter
O	Bed height down	Lowest the litter
P	Brake indicator	Illuminates when you apply or release the brake

Caregiver controls (basic)

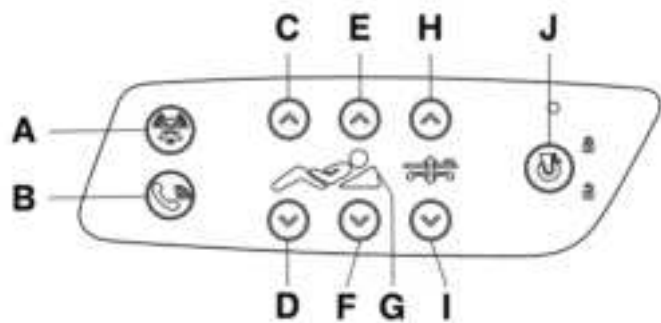

A	Bed exit	Press and hold to cancel bed exit alarm
B	Nurse call	Activates nurse call
C	Gatch up	Raises the Gatch
D	Gatch down	Lowest the Gatch
E	Fowler up	Raises the Fowler
F	Fowler down	Lowest the Fowler
G	Fowler 30°+	Illuminates when the Fowler is 30°+
H	Bed height up	Raises the litter
I	Bed height down	Lowest the litter
J	Brake indicator	Illuminates when you apply or release the brake

Motion lock

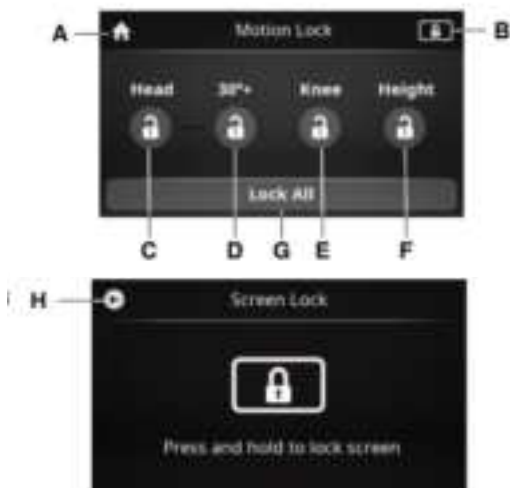

Note - Bed exit, scale, and nurse call features are still available.

A	Home	Returns to the Home screen
B	Screen lock	Returns to the Screen Lock screen
C	Head (Fowler) lock	Locks or unlocks head (Fowler) controls
D	30°+ (Fowler) lock	Locks or unlocks the head (Fowler) position to 30°+
E	Knee (Gatch) lock	Locks or unlocks knee (Gatch) controls
F	Bed height lock	Locks or unlocks bed height controls
G	Lock all	Locks or unlocks all motion function
H	Back	Returns to the Motion Lock screen

WARNING

- Always lock the controls when the patient is unattended.
- Always lock the controls when the patient's condition requires extra safety measures.