

KENWOOD

60cm Total Frost Free Fridge Freezer with Water Dispenser KNFD60T19 / KNFD60X19

installation / instructions manual



Contents

safety warnings	4
unpacking.....	8
installation.....	9
location	9
levelling the unit.....	9
free space requirements.....	9
reversing the door swing	10
cleaning before use	14
before using your unit.....	14
product overview	15
main unit.....	15
operation	16
switching on your unit.....	16
super freeze mode	16
noises inside the unit!.....	16
tips for keeping food in the unit	17
preparations for freezing	17
defrosting frozen food.....	18
integrated water dispenser	18
cleaning the water tank	18
filling the water tank.....	19
using the water dispenser	19
cleaning the interior and the exterior of the unit.....	20
maintenance.....	20
changing the internal LED light	20
care when handling / moving your unit.....	20
servicing	20
switching off for long periods of time	20
condensation	20
disposal	21
specifications.....	22
product fiche.....	22

safety warnings

For your continued safety and to reduce the risk of injury or electric shock, please follow all the safety precautions listed below.

- Read all instructions carefully before using the unit and keep them for future reference.
- Retain the manual. If you pass the unit onto a third party, make sure to include this manual.
- This appliance is intended for indoor household use and similar applications such as:
 - farm houses and by clients in hotels, motels and other residential type environment;
 - bed and breakfast type environment;
 - staff kitchen areas in shops, offices and other working environment;
 - catering and similar non-retail applications.
- Ensure that the plug is easily accessible to enable disconnection from the mains supply.
- If the mains cable is damaged, it must be replaced by the manufacturer, its service agent or a qualified technician in order to avoid a hazard.
- Choose a location for your unit away from heat sources such as radiators or fires as refrigerant and vesicant are burnable.
- The unit must be manoeuvred by a minimum of 2 persons.
- This appliance can be used by children aged from 8 years and above and persons with reduced physical, sensory or mental capabilities or lack of experience and knowledge if they have been given supervision or instruction concerning use of the appliance in a safe way and understand the hazards involved. Children shall not play with the appliance. Cleaning and user maintenance shall not be made by children without supervision.
- Children aged from 3 to 8 years are allowed to load and unload refrigerating appliances.
- Children should be supervised to ensure that they do not play with the unit.
- If your unit is fitted with a lock to prevent children being trapped inside, keep the key out of reach and not in the vicinity of the unit.

- Do not store explosive substances such as aerosol cans with a flammable propellant in this appliance.
- Do not store bottles or glass containers in the freezer compartment. Contents can expand when frozen (fizzy drinks) which may break the bottle and damage your freezer compartment. (If applicable)
- To avoid contamination of food, pay attention to the following:
 - opening the door for long periods can cause a significant increase of the temperature in the compartments of the appliance;
 - clean regularly surfaces that can come in contact with food and accessible drainage systems;
 - clean water tanks if they have not been used for 48 hours; flush the water system connected to a water supply if water has not been drawn for 5 days;
 - store raw meat and fish in suitable containers in the refrigerator so that it is not in contact with or drip onto other food;
 - two-star frozen-food compartments are suitable for storing pre-frozen food, storing or making ice-cream and making ice cubes;
 - one-, two- and three-star compartments are not suitable for the freezing of fresh food;
 - if the refrigerating appliance is left empty for long periods, switch off, defrost, clean, dry and leave the door open to prevent mould developing within the appliance.

WARNING



IT IS HAZARDOUS FOR ANYONE OTHER THAN AUTHORISED SERVICE PERSONNEL TO CARRY OUT SERVICING OF REPAIRS WHICH INVOLVE THE REMOVAL OF COVERS.



TO AVOID THE RISK OF AN ELECTRICAL SHOCK DO NOT ATTEMPT REPAIRS YOURSELF.

The table below contains general guidelines on the storage of food in the refrigerator.

Refrigerator location	Type of food
Fridge door	<ul style="list-style-type: none"> • Foods with natural preservatives, such as jams, juices, drinks, condiments. • Do not store perishable foods.
Crisper bin (salad bin)	<ul style="list-style-type: none"> • Fruits, herbs and vegetables should be placed separately in the crisper bin. • Do not store bananas, onions, potatoes, garlic in the refrigerator.
<ul style="list-style-type: none"> • Fridge shelf – bottom • Chiller bin 	Raw meat, poultry, fish (for short-term storage)
Fridge shelf – middle	Dairy products, eggs
Fridge shelf – top	Foods that do not need cooking, such as ready-to-eat foods, deli meats, leftovers.
Freezer drawer/shelf	<ul style="list-style-type: none"> • Foods for long-term storage. • Bottom drawer/shelf for raw meat, poultry, fish. • Middle drawer/shelf for frozen vegetables, chips. • Top drawer/shelf for ice cream, frozen fruit, frozen baked goods.



WARNING

- Keep ventilation openings in the unit enclosure or in the built-in structure clear of obstructions.
 - Do not use mechanical devices or other means to accelerate the defrosting process, other than those recommended by the manufacturer.
 - Do not use electrical appliances inside the food storage compartments of the unit, unless they are of the type recommended by the manufacturer.
 - Do not damage the refrigerant circuit (The refrigerant is a very environmental-friendly gas but is also combustible. Take care when transporting or moving the unit to ensure that the refrigeration circuit is not damaged. In the event of damage avoid naked flames or ignition sources and ventilate the room in which the unit is placed for a few minutes.)
 - When positioning the appliance, ensure the supply cord is not trapped or damaged.
 - Do not locate multiple portable socket-outlets or portable power supplies at the rear of the appliance.
-



WARNING: Risk of fire/flammable materials

Thank you

 for purchasing your new Kenwood Fridge Freezer.

These operating instructions will help you use it properly and safely.

We recommend that you spend some time reading this installation/instruction manual in order that you fully understand all the operational features it offers.

Read all the safety instructions carefully before use and keep this installation/instruction manual for future reference.

unpacking

Remove all items from the packaging. Retain the packaging. If you dispose of it please do so according to local regulations.

The following items are included:

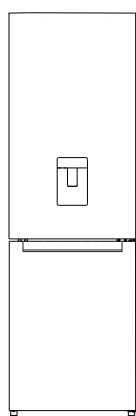

Main Unit



Fridge Glass Shelf x 3



Freezer Glass Shelf x 2



Salad Bin Cover Shelf



Upper Fridge Door Shelf



Lower Fridge Door Shelf



Salad Bin



Freezer Drawer x 3



Wine Rack

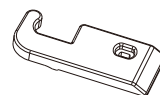

Upper Hinge Cover (left side)

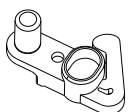

Door Stopper (upper door)

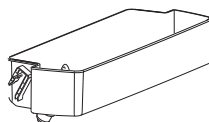

Water Tank

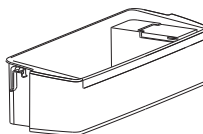

Water Tank Balcony



Water Tank Cover



Door Stopper (lower door)

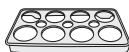

Egg Tray

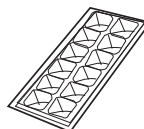

Ice Tray

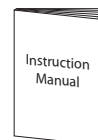

Instruction Manual



If items are missing or damaged please contact Partmaster (UK only).
Tel: 0344 800 3456 for assistance.

installation

location

When selecting a position for your unit you should make sure the floor is flat and firm, and the room is well ventilated with an average room temperature of between 10°C and 43°C. Avoid locating your unit near a heat source, e.g. cooker, boiler or radiator. Also avoid direct sunlight as it may increase the electrical consumption. Extreme cold ambient temperatures may also cause the unit not to perform properly. This unit is not designed for use in a garage or outdoor installation. Do not drape the unit with any covering.

levelling the unit

To do this adjust the two levelling feet at the front of the unit. If the unit is not level, the doors and magnetic seal alignments will not be covered properly.

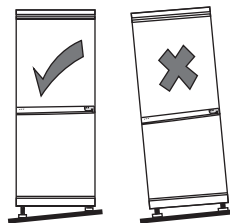

free space requirements

When installing the unit, ensure that 25 mm of free space is left at both sides, 50 mm at the rear of the unit and 25 mm at the top of the unit. The door can be opened to the right or the left, depending on which best suits the location.

Please ensure there is more than twice the width and depth distance space of the unit to fully open the door to a maximum angle.

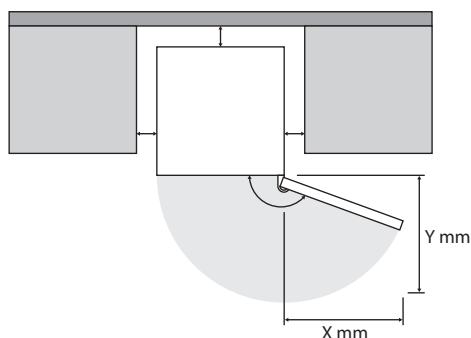

reversing the door swing

tools required: Philips style screwdriver / Flat bladed screwdriver / Hexagonal spanner



- Ensure the unit is unplugged and empty.
- To take the door off it is necessary to tilt the unit backwards. You should rest the unit on something solid, e.g. a chair just below the top panel.
- All parts removed must be saved to do the reinstallation of the door.
- Do not lay the unit flat as this may damage the coolant system.
- We recommend that 2 people handle the unit during assembly.
- If you want to have the door swing reversed, we recommend that you contact a qualified technician. You should only try to reverse the door yourself if you believe that you are qualified to do so.

1. Unscrew the upper right hinge cover, then unscrew the upper hinge. Lift the upper door and place it on a padded surface to prevent from being scratched.

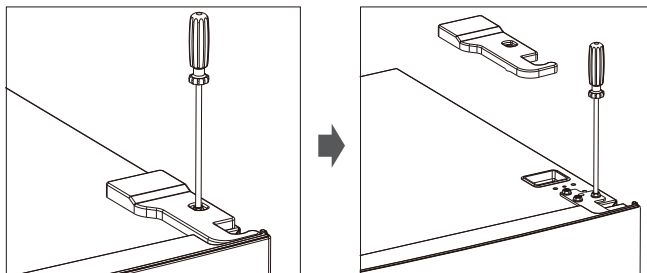

Upper hinge cover has left and right side. The upper hinge cover packed as an accessory is for the left side.

2. Unscrew the upper screw hole cover from the left and put it aside for later use.

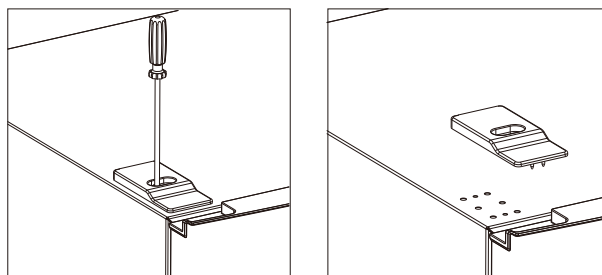

installation

3. Remove the middle hinge. Lift the lower door and place it on a padded surface to prevent from being scratched.

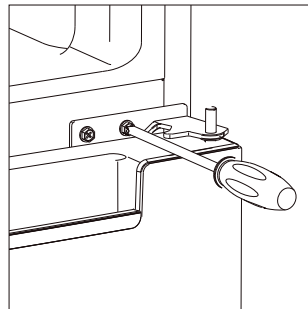

4. Remove both levelling feet and bottom hinge.

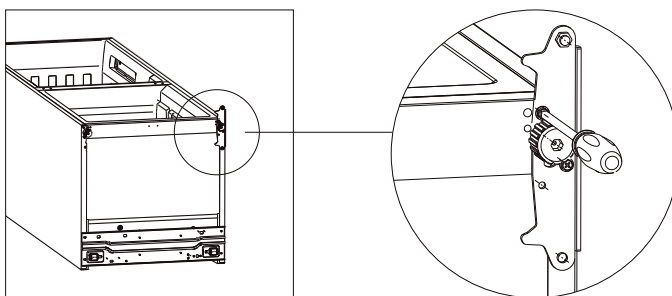

- Do not lay the unit flat as this may damage the coolant system.
- During door reversal, when swapping the position of the bottom hinge or adjusting the levelling feet, tilt the unit. Do not lay the unit flat.

5. Reverse the bottom hinge and re-adjust the position of the bottom hinge pin. Reverse the upper hinge and re-adjust the position of the upper hinge pin. Tighten the pins securely.

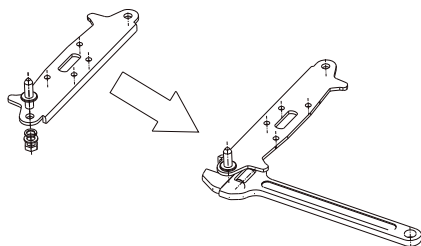

Bottom hinge

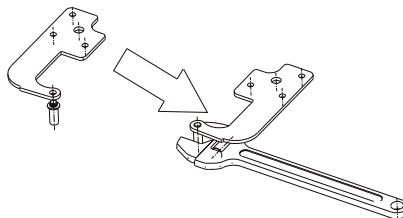

Upper hinge

installation

6. Screw the bottom hinge tightly to its new position. Screw back the levelling feet tightly.

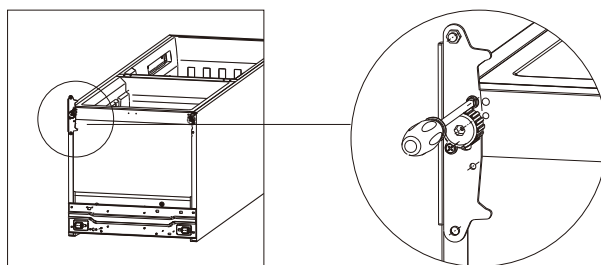

7. Unscrew and remove the stopper from the bottom of the upper and lower doors. Take the spare stoppers from the accessory bag and screw them to the opposite side of the upper and lower doors.

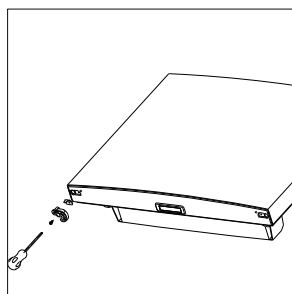
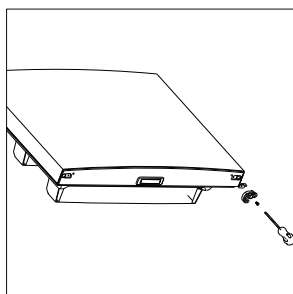

8. Remove the middle hinge hole covers and swap their position with the middle hinge. Reverse the middle hinge.
9. Place the bottom hole of the lower door onto the bottom hinge pin. Insert the middle hinge pin into the upper hole of the lower door. Screw the middle hinge tightly. Cover the remaining holes with the hole covers.

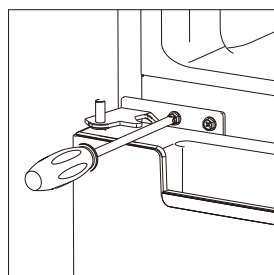

- Ensure the lower door is aligned horizontally and vertically, so that the seals are closed on all sides before finally tightening the middle hinge.

installation

10. Place the bottom hole of the upper door onto the middle hinge pin. Insert the upper hinge pin into the upper hole of the upper door. Screw the upper hinge tightly. Cover the upper hinge with the upper hinge cover for left side.

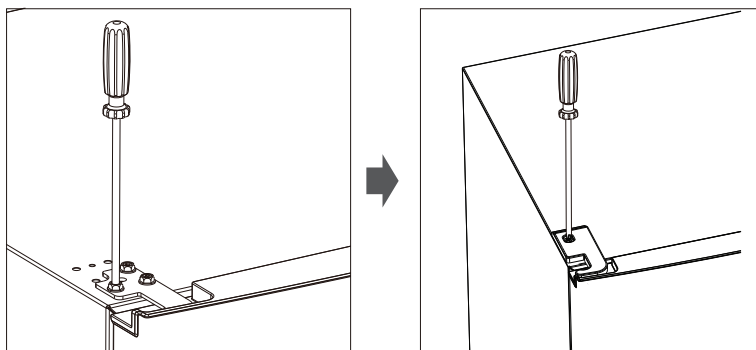

- Ensure the upper door is aligned horizontally and vertically, so that the seals are closed on all sides before finally tightening the upper hinge.

11. Replace and screw the upper screw hole cover on the right.

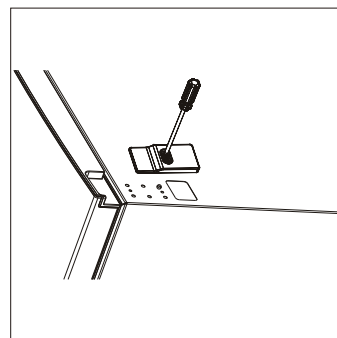

installation



In some cases, the door seal may be crushed after prolonged storing pressure, resulting to the door seal not able to close properly when reversed.

Follow the steps below to solve the issue:

- Peel off the door seal from the upper or lower corner and warm it with a hairdryer; the warmth can allow the door seal to return to its original form. Do not blow directly on the unit as the warmth may damage other parts of the unit.
- Rotate the door seal upside down so that the side originally with the hinge stay with the hinge.
- Insert the door seal back into the door from the upper or lower corner.
- If the issue still occurs, contact your local service centre for assistance.

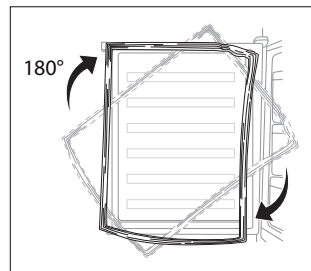

cleaning before use

Wipe the inside of the unit with a weak solution of bicarbonate soda. Then rinse with warm water using a sponge or cloth. Wipe completely dry before replacing the drawers. Clean the exterior of the unit with a damp cloth.

If you require more information refer to the **Cleaning** section.



• **Before Plugging in YOU MUST**

Check that you have a socket which is compatible with the plug supplied with the unit.

• **Before Turning On!**

Do not turn on until two hours after moving the unit. The coolant fluid needs time to settle.

before using your unit

Before placing any food in your unit, turn it on and wait for 24 hours, to make sure it is working properly and to allow it time to fall to the correct temperature. Your unit should not be overfilled.

product overview

main unit

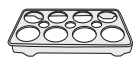
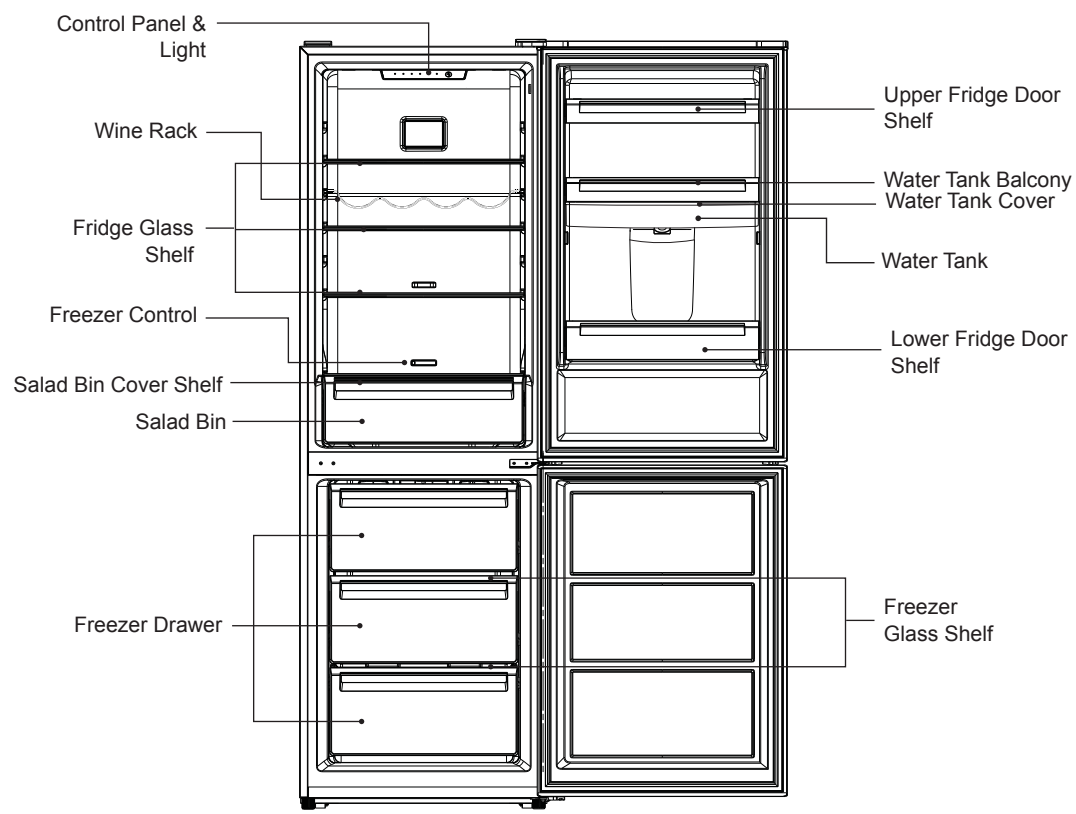

Egg Tray

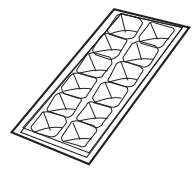

Ice Tray

operation

switching on your unit

1. Connect the mains cable to the mains socket.
2. To adjust the fridge temperature, press **Set** button repeatedly to set temperature for the fridge compartment (2°C to 8°C). The selected temperature will light up. For normal use, 4°C is recommended.



3. To adjust the freezer temperature, slide the **Freezer Control** to the left (coldest) or to the right (least cold). For normal use, it is recommended to slide to the Optimal (middle) position.
4. The unit may not operate at the correct temperature if it is in a particularly hot or a particularly cold room, or if you open the doors often.
5. To ensure that the unit is cool enough to sufficiently chill your food, wait 24 hours before filling it with food.
6. If you are concerned that your unit is not being kept cold enough and wish to check the temperature, you will need a special fridge/freezer thermometer. These are available from most supermarkets and hardware shops. Place the thermometer in either the fridge or freezer compartment and leave overnight. The correct temperature for the fridge compartment should be at the recommended 2-8°C. The correct temperature for the freezer compartment should be -18°C or lower.
7. The appliance will automatically restore in previous operation mode after power failure.

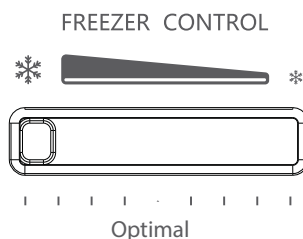

super freeze mode

If you want to freeze food in a short time, you can select super freeze mode.

- Press and hold **Set** button for over 3 seconds to activate super freeze mode. The Super indicator will light up.
- When in super freeze mode, temperature of the fridge compartment cannot be changed.
- The super freeze mode will automatically switch off and the appliance will resume to its original setting after 50 hours. Alternatively, to switch off manually, press and hold **Set** button for over 3 seconds. The Super indicator light will extinguish.

noises inside the unit!

You may notice that your unit makes some unusual noises. Most of these are perfectly normal, but you should be aware of them!

These noises are caused by the circulation of the refrigerant liquid in the cooling system. It has become more pronounced since the introduction of CFC free gases. This is not a fault and will not affect the performance of your unit. This is the compressor motor working, as it pumps the refrigerant around the system.

tips for keeping food in the unit

- Cooked meats/fishes should always be stored on a shelf above raw meats/fishes to avoid bacterial transfer. Keep raw meats/fishes in a container which is large enough to collect juices and cover it properly. Place the container on the lowest shelf.
- Leave space around your food, to allow air to circulate inside the compartments. Ensure all parts of the unit are kept cool.
- To prevent transfer of flavours and drying out, pack or cover the food separately. Fruit and vegetables do not need to be wrapped.
- Always let pre-cooked food cool down before you put in the unit. This will help to maintain the internal temperature of the unit.
- To prevent cold air escaping from the unit, try to limit the number of times you open the doors. We recommend that you only open the doors when you need to put food in or take food out.

preparations for freezing

- Use quality food and handle it as little as possible. Freeze food in small quantities as it freezes faster, takes less time to defrost and enables you to control the quantity you need better.
- Leave cooked food to cool completely. Chill food before freezing if possible.
- Consider how you will want to cook the food before freezing it.
- Don't freeze food in metal containers if you may want to microwave it straight from the freezer.
- Use special freezer bags, freezer film, polythene bags, plastic containers, and aluminium foil (heavy duty grade only). If in doubt, double wrap your food. Don't use aluminium foil for acidic foods, e.g. citrus fruits. Don't use thin cling film, glass, or used food containers without cleaning.
- Exclude as much air from the container as possible. You could buy a special vacuum pump which sucks excessive air out of the packaging.
- Leave a small amount of air space when freezing liquids to allow expansion.
- You can use the space in the freezer most efficiently if you freeze liquids (or solids with liquids, e.g. stew) in square blocks. This is known as "Preforming". Pour the liquid into a polythene bag which is inside a square sided container. Freeze it, and then remove it from the container and seal the bag.
- Label your frozen foods as they will look the same when in frozen state. Use special freezer tapes, labels and pens with different colours. This allows you to easily organise and to effectively use the freezer. Write the contents and date; otherwise the frozen food might exceed the storage time and this could cause food poisoning. Please refer to your food packaging for the recommended storage time.
- You may also add the weight and cooking notes, e.g. "defrost first", "cook from frozen" and keep a separate log of what is in each drawer. This will save opening the door and searching around unnecessarily.

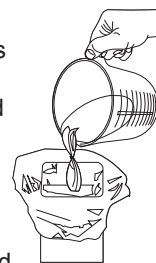

defrosting frozen food

- Take the frozen food out from the freezer compartment and uncover the frozen food. Let it defrost at room temperature. Don't forget that defrosting in a warm area encourages the growth of bacteria and low temperature cooking may not destroy dangerous bacteria.
- Drain off and throw away any liquid lost during defrosting.
- Always make sure there are no ice-crystals in the food before cooking, particularly with meat. These crystals indicate that the food has not fully defrosted.
- Cook food as soon as possible after defrosting.
- Many microwaves and ovens have a defrost setting. To avoid bacterial build up, only use these if you intend to cook the food immediately afterwards.



Never re-freeze anything that has been defrosted unless you cook it again, to kill off harmful bacteria. Never re-freeze defrosted shellfish. Re-seal packs properly after removing items. This prevents drying or freezer-burn and a build up of frost on any remaining food.

integrated water dispenser

Follow these steps to ensure the water tank is cleaned before use.

cleaning the water tank

1. Remove the water tank balcony by gripping both sides and carefully lifting free from the refrigerator door.
2. Remove the water tank by gripping both sides and carefully lifting free from refrigerator door. Detach water tank cover from water tank.
3. Clean all parts with washing detergent and rinse thoroughly.
4. Attach water tank cover to water tank and slide back into place.
5. Ensure water tank and cover is secure, then slide water tank balcony back into place.

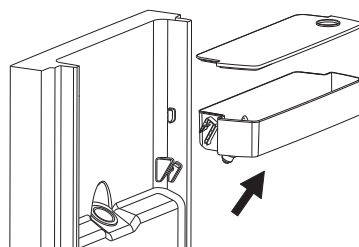
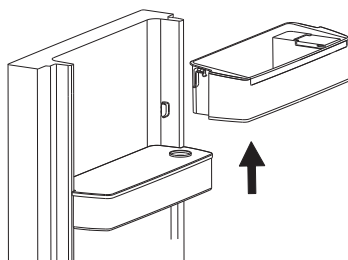

filling the water tank

1. Ensure the water tank is securely in place before filling with drinkable water.
2. Open the lid found on the water tank balcony.
3. Fill water tank to the MAX level indicated, then close the lid. Filling above the MAX level may cause water to overflow when closing the lid.

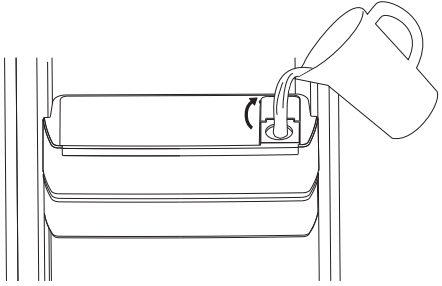

- **Always ensure the water tank is securely attached before use.**
- The water dispenser may not function correctly if water tank is not secured.
- Do not use the refrigerator without the water tank.

using the water dispenser

The water dispenser is located in the front of the upper door.

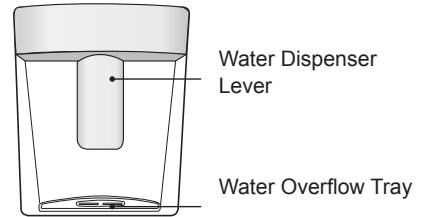

Place a cup under the outlet and gently push against the dispenser level. Ensure the cup is lined up with the dispenser to prevent spillage.

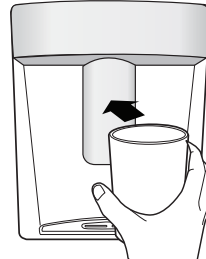

- **After each use, small amounts of water may drip from the water dispenser. This is normal.**
- The excess water will collect in the water overflow tray. Empty the water overflow tray periodically to prevent spillage.

cleaning the interior and the exterior of the unit

- Remove all the shelves and drawers.
- Wipe the inside of the unit with a weak solution of bicarbonate soda and then rinse with warm water using a sponge or cloth. Wipe completely dry before replacing the shelves, drawers and salad bin.
- Use a damp cloth to clean the exterior, and then wipe with a standard furniture polish. Make sure that the doors are closed to avoid the polish getting on the magnetic door seals or inside the unit.
- The grille of the condenser at the back of the unit and the adjacent components can be vacuumed using a soft brush attachment.

maintenance

changing the internal LED light

The internal light is an LED panel that cannot be changed by the user. Please contact a qualified service agent.

care when handling / moving your unit

Hold the unit around its sides or base when moving it. Under no circumstances should it be lifted by holding the edges of the top surface.

servicing

The unit should be serviced by an authorised engineer and only genuine spare parts should be used. Under no circumstances should you attempt to repair the unit yourself. Repairs carried out by inexperienced persons may cause injury or serious malfunction. Contact a qualified technician.

switching off for long periods of time

When the unit is not in use for a long period of time, disconnect it from the mains supply, empty all food and clean the appliance, leaving the door ajar to prevent unpleasant smells.

condensation

Condensation may appear on the outside of the unit. This may be due to a change in room temperature. Wipe off any moisture residue. If the problem continues, please contact a qualified technician for assistance.

disposal

Old units still have some residual value. An environmentally friendly method of disposal will ensure that valuable raw materials can be recovered and used again. The refrigerant used in your unit and insulation materials require special disposal procedures. Ensure that none of the pipes on the back of the unit are damaged prior to disposal.

Up to date information concerning options of disposing of your old unit and packaging from the new one can be obtained from your local council office.

When disposing of an old unit break off any old locks or latches and remove the door as a safeguard.

specifications

Rated Voltage	220-240V~, 50 Hz
Rated Current	0.9 A
Rated Power	110 W (Defrost: 160 W)
Dimension (H x W x D)	1840 x 600 x 675 mm

Features and specifications are subject to change without prior notice.

product fiche

Brand	Kenwood
Model	KNFD60T19 / KNFD60X19
Household Appliance Category	7
Energy Efficiency Class	A+
Energy consumption 306 kWh per year , based on standard test results for 24 hours. Actual energy consumption will depend on how the appliance is used and where it is located.	
Fridge Storage Volume	223 L
Freezer Storage Volume	95 L (4-star)
Frost-free for the freezer compartment.	
Temperature Rise Time	18 hours
Freezing Capacity	4.5 kg / 24 hours
Climate Class	SN, N, ST, T This appliance is intended to be used at an ambient temperature between 10°C and 43°C.
Airborne Acoustical Noise	43 dB(A) re 1 pW

Need Help with your product?

Your product is supported by Knowhow

under a Trademark Licence from Fisher & Paykel Appliances Italy SpA.

For help or spare parts please call us on:

0344 561 1234



The symbol on the product or its packaging indicates that this product must not be disposed of with your other household waste. Instead, it is your responsibility to dispose of your waste equipment by handing it over to a designated collection point for the recycling of waste electrical and electronic equipment. The separate collection and recycling of your waste equipment at the time of disposal will help conserve natural resources and ensure that it is recycled in a manner that protects human health and the environment.

For more information about where you can drop off your waste for recycling, please contact your local authority, or where you purchased your product.

DSG Retail Ltd. (co. no. 504877)
1 Portal Way, London, W3 6RS, UK

EU Representative

DSG Retail Ireland Ltd (259460)
3rd Floor Office Suite,
Omni Park SC, Santry, Dublin 9, Republic of Ireland

Manufactured for DSG Retail Limited under Licence from Fisher & Paykel Appliances Italy SpA.
DSG Retail Limited is responsible for after sales service.

IB-KNFD60T_X19-190507V3