

Full HD
1080P

Wireless HD Extender

MODEL:823



USER MANUAL

VEN1.0

© The copyright belongs to the product manufacturer.

Dear Customer:

Thank you for choosing our products!

For your better use of this product, please read this manual carefully before using it. This product is for household use only. If there is any malfunction, please repair it in time.



NOTE:



Please adjust the video output signal of the playback device to **720p** or **1080p**.



Please put TX or RX in an open place and keep a distance of **2-3m** from the wireless router to avoid signal interference.



When transmitting PC video and audio signals, some PC operating systems need to set the video and audio signal source output.



If noise occurs during use, switch the audio setting of the signal output device to stereo output.



It supports 1 transmitter for wireless transmission and **2-4** receivers. Does not support the use of multiple transmitters in the same environment.



Transmission distance is about **20-30 meters** when there is no other wireless signal interference/obstacles in the operating environment.



The hue, saturation, and brightness of the picture output by the receiver are different in various TVs, projectors and other equipment. You can adjust the TV HSB parameters according to your preferences.



Please uses a **5V** power adapter, a higher power adapter such as **9V** or **12V** will damage the product.

We provide a **1-YEAR REPLACEMENT GUARANTEE.**

Please have your proof of purchase & pic of the defective product available when you contact us.

If the product you received is defective, missing accessories or you need assembly assistance,

PLEASE DON'T RETURN IT TO THE STORE

and contact our after-sales mailbox directly.

✉ Global after-sales service mailbox:

SUPPORT@PAKITE.COM

PANEL DESCRIPTION

1 Transmitter (TX) Panel Description

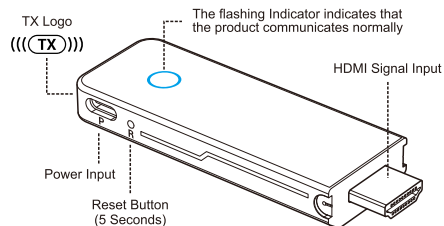

2 Receiver(RX) Panel Description

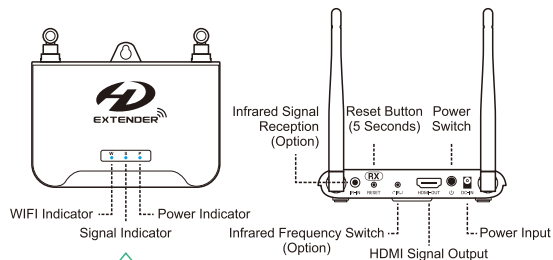

- P** The Power Indicator is always-on after the product is powered on.
- S** The Signal Indicator is always-on when The HDMI signal is output/input.
- W** The flashing WIFI Indicator indicates that the product communicates normally.

INSTALLATION INSTRUCTIONS

1 Transmitter (TX) Installation

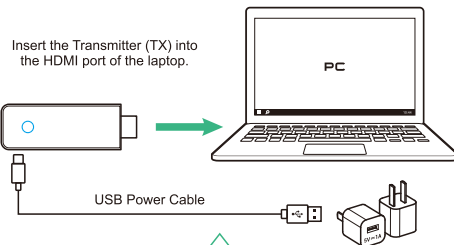

Part of computers do not have enough power to the USB port to support the device working, so using a 5V=1A USB power adapter is recommended.

2 Receiver (RX) Installation

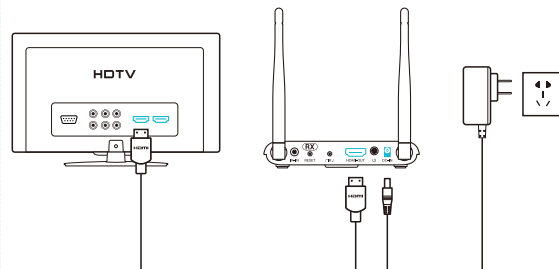

COMPUTER CONNECTION GUIDE

1 Use with Computer

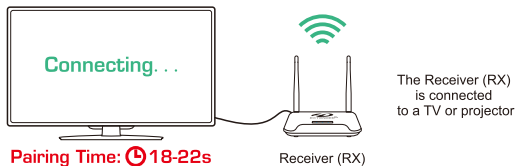
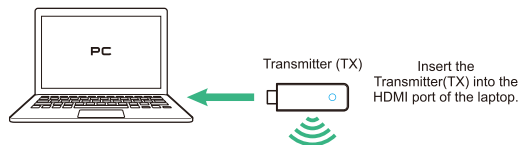

2 Computer Setting

After entering the computer system, press the Windows key and the letter P key on the keyboard at the same time. The projection menu bar will appear on the right side of the screen, click "Duplicate".



STB CONNECTION GUIDE

1 Use with STB

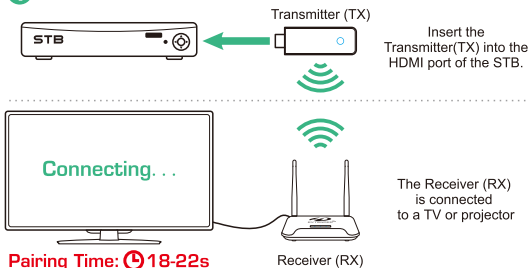

2 STB Audio Setting

Turn on the setting function of STB and switch **HDMI Audio** output to **LPCM 2 Channel** through **Audio** setting.

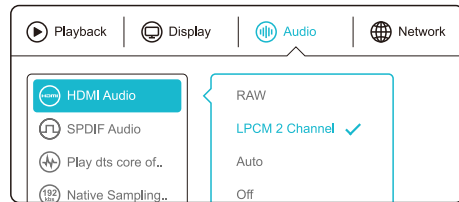

Please Support Environment Protection
Waste electrical products should not be disposed of household waste. Please put them to the recycle facilities. Check with your local authority or retailer for recycling advice!

