



USER GUIDE

BLUETOOTH CEILING/WALL SPEAKERS

Visit Our Website



SCAN ME
PyleUSA.com

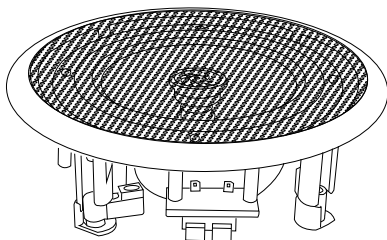

PDICBT552RD - PDICBT652RD - PDICBT852RD
2-Channel Bluetooth Ceiling / Wall Speaker,
2-Way Flush Mount Home Speakers

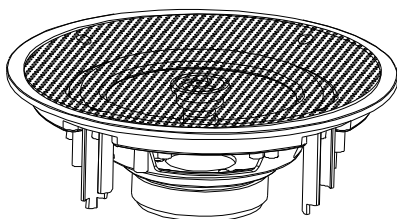

PDICBT256 - PDICBT266 - PDICBT286 - PDICBT2106
4-Channel Bluetooth Ceiling / Wall Speaker,
2-Way Flush Mount Home Speakers

Get Into It!

Technical Specs:

Model	PDICBT552RD	PDICBT652RD	PDICBT852RD	PDICBT256	PDICBT266	PDICBT286	PDICBT2106
Amount of Speakers	2	2	2	4	4	4	4
Speaker Size	5.25"	6.5"	8.0"	5.25"	6.5"	8.0"	10.0"
MAX Output Power	150 Watt	200 Watt	250 Watt	150 Watt	200 Watt	250 Watt	300 Watt
Impedance	8 Ohm	8 Ohm	8 Ohm	8 Ohm	8 Ohm	8 Ohm	8 Ohm
Sensitivity	88 dB	88 dB	89 dB	88 dB	89 dB	89 dB	89 dB
Frequency Response	80-20 kHz	70-20 kHz	50-20 kHz	80-20 kHz	60-20 kHz	40-20 kHz	35-20 kHz
Cut-Out Diameter	6.5"	7.6"	9.3"	6.8"	7.9"	9.4"	11"
Mounting Depth	2.6"	2.8"	3.0"	3.0"	3.1"	3.5"	3.8"

California Prop 65 Warning



WARNING:

This product may expose you to chemicals, which is known to the state of California to cause cancer, birth defects and other reproductive harm. Do not ingest.

For more info go to: www.P65warnings.ca.gov

EXISTING CONSTRUCTION

IN-CEILING SPEAKERS

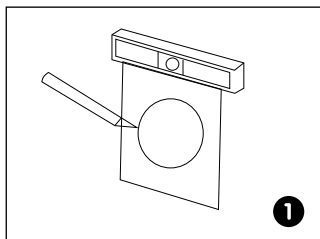

1. Cut the drywall.

Note: Always allow at least 1/2 inch between a wall stud and the speaker cutout.

Otherwise, the locking tabs will not be able to swivel into place.

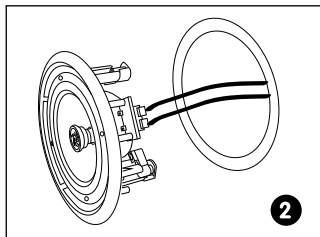

2. Connect the speaker wires to the speaker.

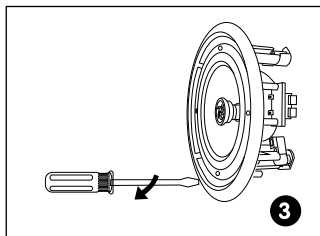

3. Secure the speaker.

Screw down each of the four Phillips head screws.

The locking tabs will swivel into place and secure the unit to the rear surface of the drywall.

Apply the adhesive strips to secure the grille.

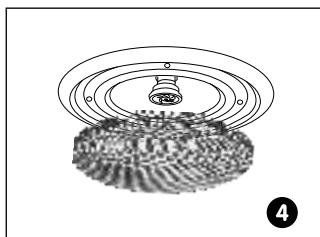

4. Replace the metal grille.

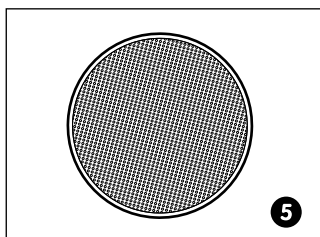

5. Installation complete.

BLUETOOTH CONNECTION DIAGRAM

- Bluetooth Version: 5.0
- Bluetooth Network Name: Pyle
- Bluetooth Network Password: '0000'
- Bluetooth Wireless Range: 30+ feet

2 CHANNEL

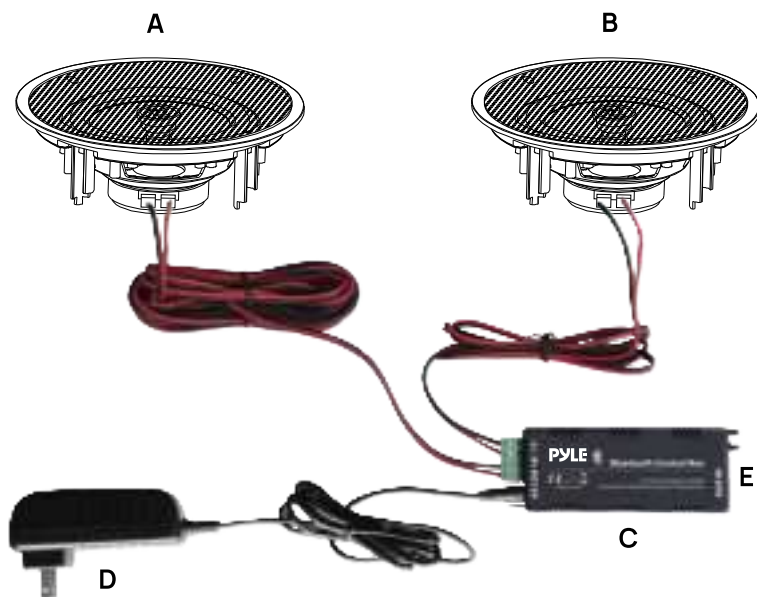

Bluetooth Wiring

As shown in the diagram:

- A = Speaker
- B = Speaker
- C = Bluetooth Amplifier
- D = Power adapter (DC 12V)
- E = Aux-in port

Follow the polarity markings on the Bluetooth amplifier box.

Connect the red wire to the positive (+) terminal and the black wire to the negative (-) terminal.

4 CHANNEL

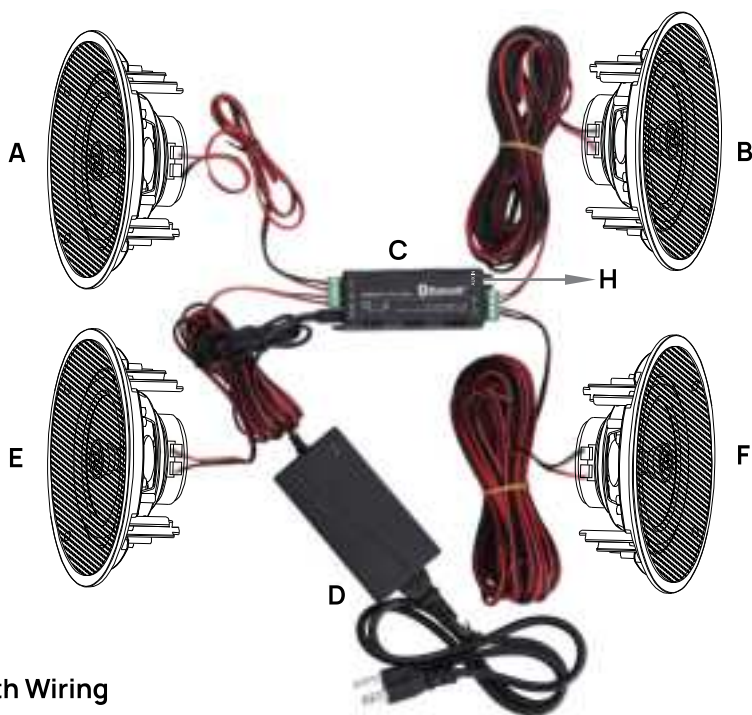

Bluetooth Wiring

As shown in the diagram:

- A = Speaker
- B = Speaker
- C = Bluetooth Amplifier
- D = Power adapter (DC 12V)
- E = Speaker
- F = Speaker
- H = Aux-in port

Follow the polarity markings on the Bluetooth amplifier box. **Connect the red wire to the positive (+) terminal and the black wire to the negative (-) terminal.**

Register Product

Thank you for choosing PyleUSA. By registering your product, you ensure that you receive the full benefits of our exclusive warranty and personalized customer support.

Complete the form to access expert support and to keep your PyleUSA purchase in perfect condition.

Start Here



Model Number:
PDICBT552RD

[PyleUSA.com/pages/register](https://www.pyleusa.com/pages/register)

PYLE

Get Into It!



Questions? Comments?

We are here to help!

Phone: (1) 718-535-1800

PyleUSA.com/ContactUs

Get Into It!