

What's in the Box

Make sure everything is included.
Anything missing?
Please contact support@eufy.com

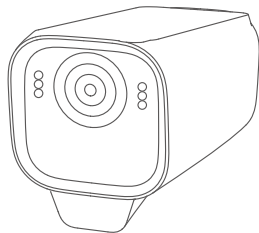

1

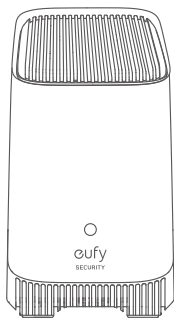

2

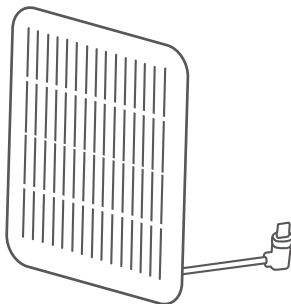

3



4

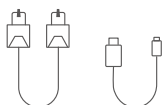

5

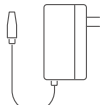

6



7



8

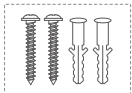

9

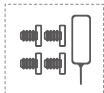

10

#	Items	Add-On	2-Cam Kit	3-Cam Kit	4-Cam Kit
1	Camera	1	2	3	4
3	Backup Solar Panel(s)	0	1	1	2
4	Mounting Brackets	1	3	4	6
8	Positioning Stickers	2	3	4	6
9	Screw Packs	2	3	4	6
10	Hard Drive Screws & Reset Needle	0	1	1	1

At a Glance

eufyCam S3 Pro (T8162)

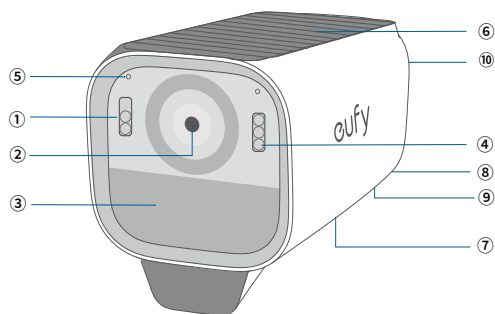

- ❶ Spotlight
- ❷ Camera Lens
- ❸ Motion Sensor
- ❹ LED Indicator
- ❺ Microphone
- ❻ Built-in Solar Panel
- ❼ Speaker
- ❽ SYNC Button
- ❾ USB-C Charging Port
- ❿ Mounting Hole

HomeBase S380 (T8030)

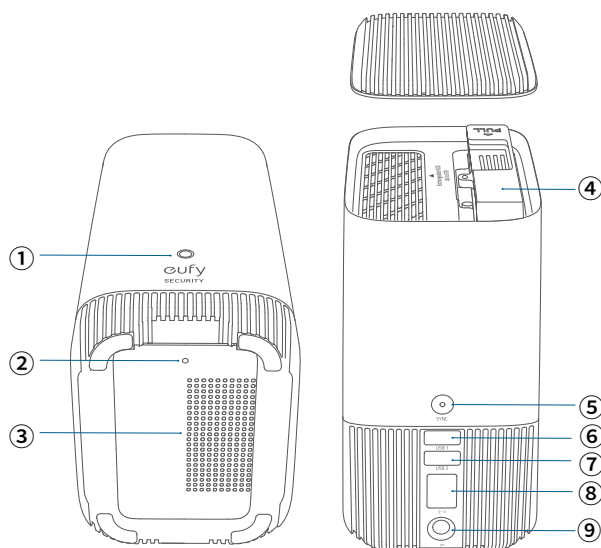

- ❶ Status LED
- ❷ Reset Hole
- ❸ Speaker
- ❹ Hard Drive Bracket
- ❺ SYNC / ALARM OFF Button
- ❻ USB Port 1 (Output Power: 5V/2.4A; for Charging eufyCam)
- ❼ USB Port 2 (for Data)
- ❽ Ethernet Port
- ❾ DC Power Port

Getting Started with the App

1. Scan the QR code below or search for "eufy" to download.



2. Log in or create a new account.

3. Follow in-app instructions to add the HomeBase.

- Turn on the HomeBase and connect it to your router.
- Wait about 1 minute for the LED to turn blue.
- Use the included Ethernet cable to connect to your home Wi-Fi router.
- Use the included power adapter (12V/2A) to power on the HomeBase.



- To improve the wireless range of HomeBase, place it on a table or shelf 3-5 feet (1-1.5 m) high and as far away from the wall as possible.

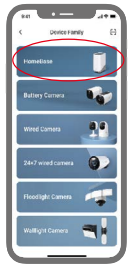
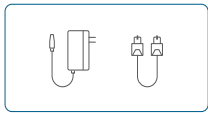

①

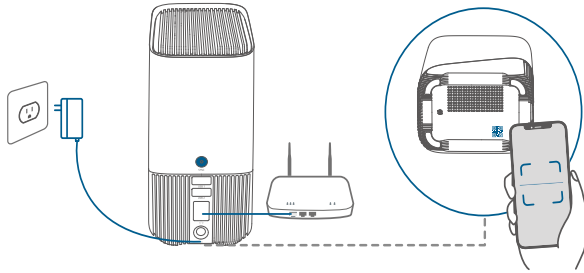

②

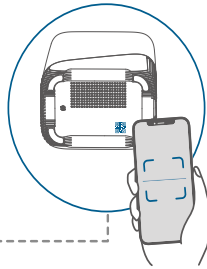

③

4. Follow in-app instructions to add eufyCam S3 Pro and then sync them with the HomeBase.



- Up to 16 eufyCams can be synchronized with the HomeBase.
- Keep the maximum distance of 1 meter between HomeBase and eufyCam when synchronizing.
- Upgrade the firmware if a new version is detected and the popup prompts you to do so.

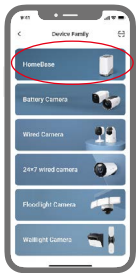

①

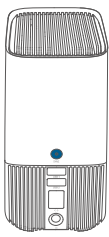

< 3.3 ft (1 m)

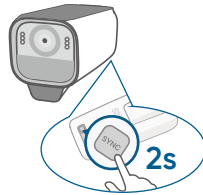

②

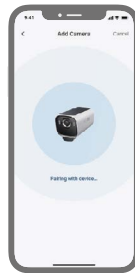

③

5. Complete other settings or skip for later setup.

- Motion Detection
- Face Management
- Video/Audio Settings

Preparing

Expand HomeBase Storage (Optional)

HomeBase S380 comes with 16 GB of storage for saving video recordings and allows you to add an additional hard drive to expand the space. Your hard drive must meet the following requirements:

Type	Hard disk drive (HDD) or solid state drive (SSD) that uses the SATA interface
Size	2.5 inch
Capacity	Unlimited
Recommended	Western Digital, Seagate, SAMSUNG, Kingston, PNY, Crucial, SanDisk



- The HomeBase must be powered off when you install or remove a hard drive.
- Transfer all the data in your hard drive to a secure location before adding it to the HomeBase.
- A new hard drive must be initialized through the eufy Security app to work with the HomeBase.

1. Push down the top lid to remove it.

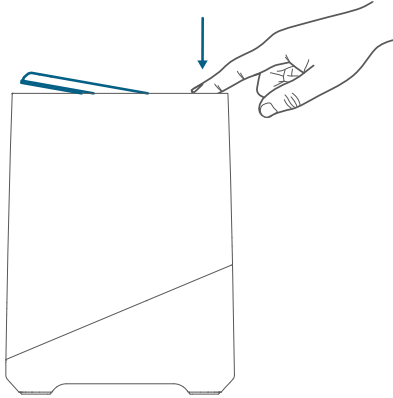

2. Loosen the screw, then take out the hard drive bracket.

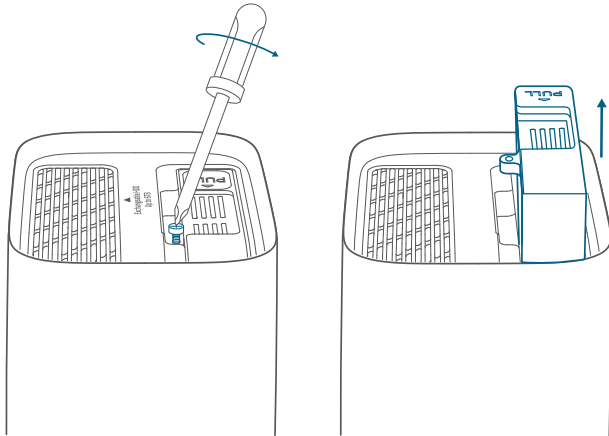

3. Fix your hard drive to the bracket with the provided screws.

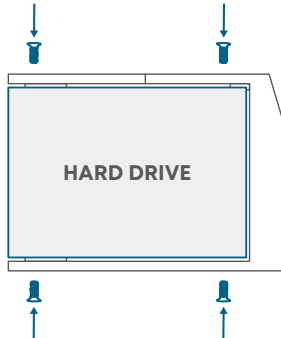

4. Insert and screw the bracket back to the HomeBase, then put the top lid back into place.

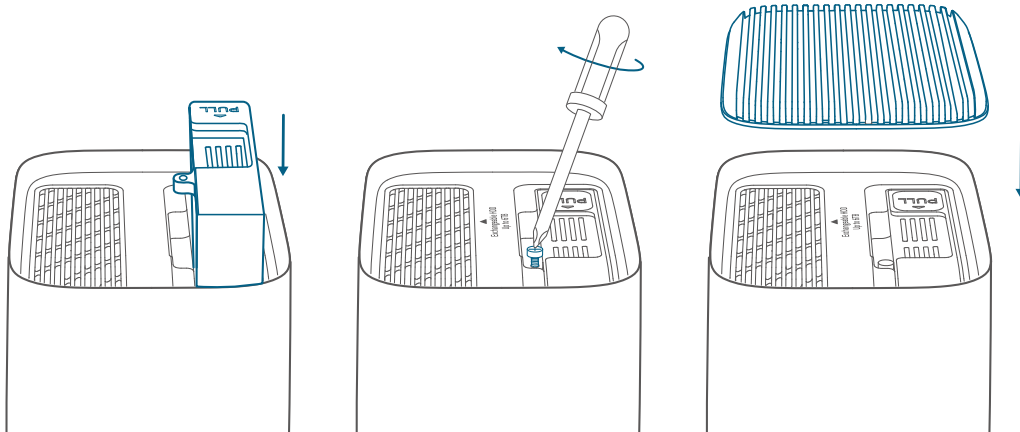

Fully Charge the Cameras before Mounting

Fully charge the cameras (to 100% battery level) before installing them outdoors.

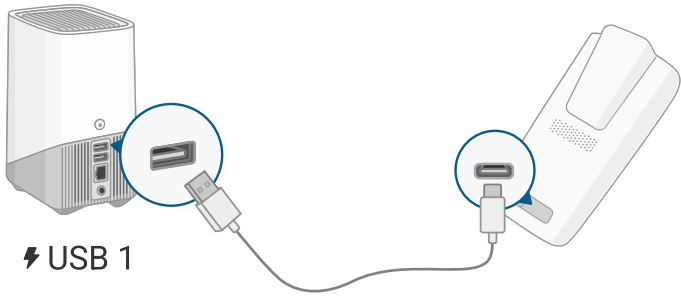
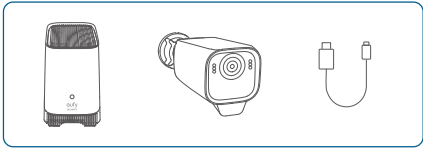

1

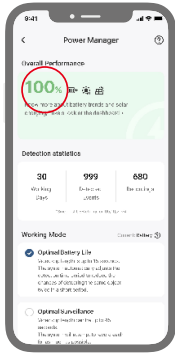

2

LED Indicator	Description
Blue	In Charging
Off	Fully Charged

Mounting Guide

1. Choose a Location

Your eufyCam includes a built-in solar panel and a backup solar panel that converts sunlight into electrical energy and keeps your eufyCam charged every day.

- The charging efficiency fluctuates according to the intensity of the sunlight.
- Don't worry when the battery level goes down. It happens when there isn't enough sunlight or the camera is consuming more power than usual. You don't need to charge the camera with a cable until a low battery alarm goes off.

For eufyCam

Choose a location where you can get the desired view.

Best location recommended:

- Height of 2-3 m
- Field of View of 12 m
- 100% of the built-in solar panel area receives sunlight
- Fully exposed to direct sunlight for at least 1.5 hours per day
- Strong Wi-Fi signal

For Backup Solar Panel

Best location recommended:

- 100% of the built-in solar panel area receives sunlight
- Fully exposed to direct sunlight for at least 1.5 hours per day

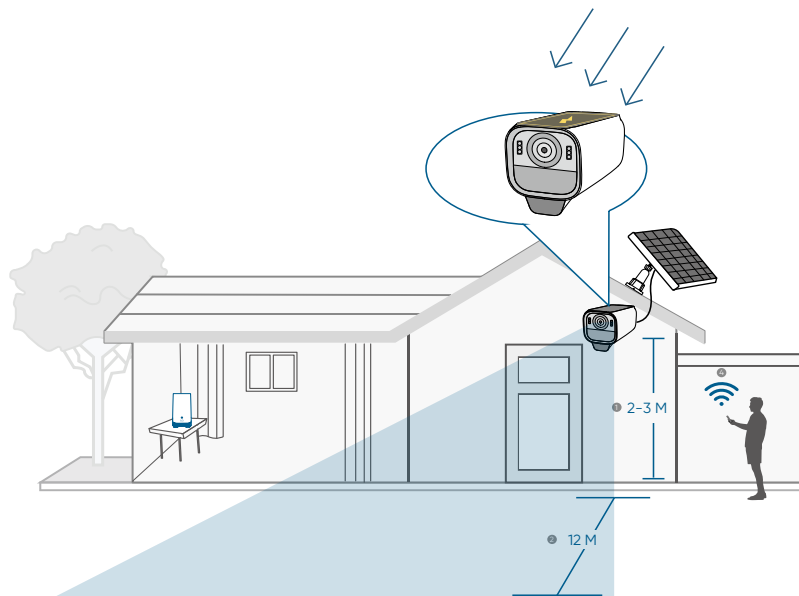

2. Install the Mounting Bracket

Position & Drill Holes

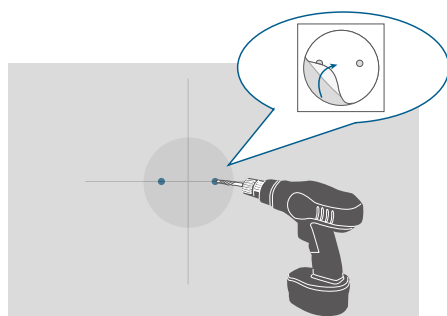
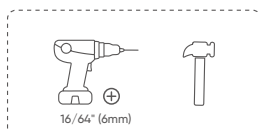

①

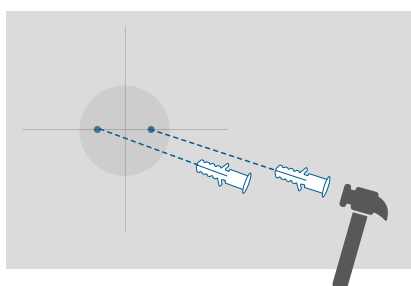

②

1. Drill holes

2. Insert anchors (skip for wooden wall)

Install Mounting Base

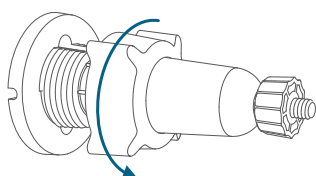
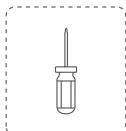
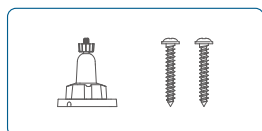

①

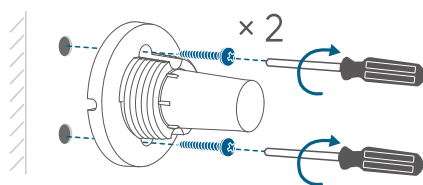

②

1. Take it apart

2. Install the base

3. Mount the Camera

 Make sure the USB-C charging port is securely protected by the waterproof cover.

Mount the Camera

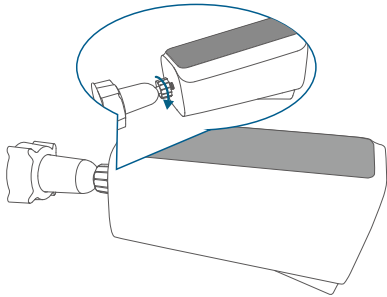
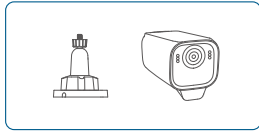

①

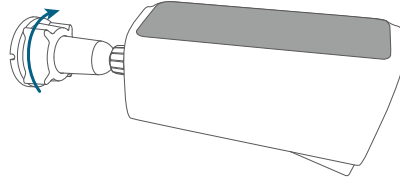

②

1. Tighten the small knob
2. Tighten the small knob

Adjust the Camera Field of View

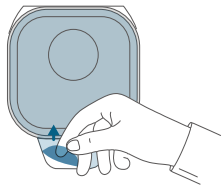

①

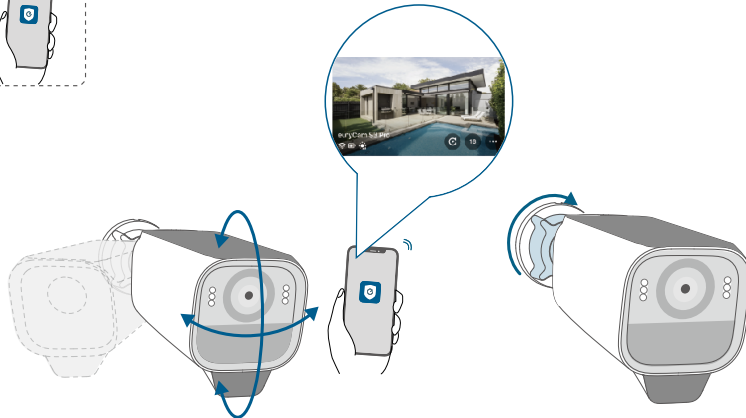

②

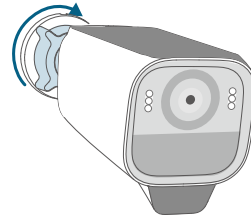

③

1. Remove the protective film
2. Get an optimal angle when viewing the live stream in the app
3. Tighten the large knob

4. Mount the Backup Solar Panel

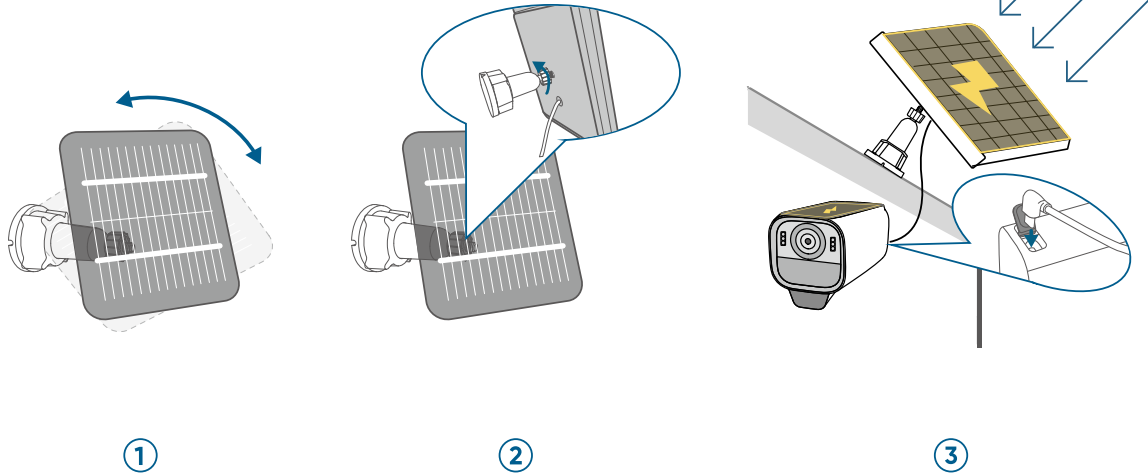
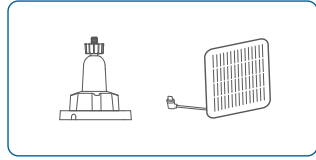

1. Mount the solar panel
2. Tighten the small knob
3. Connect and adjust

Congratulations!



Now you're all set to use your eufyCam!
Please explore more in the eufy app.

Other Information

Compliance

Default Open Port 1: Wi-Fi (2.4GHz)

Port Description:

1. When powered on for the first time or after a reset, if there is no configured Wi-Fi information, it may enter network pairing mode (such as AP/BLE pairing);
2. In normal working mode, it will automatically connect to the router and save the SSID and password;
3. If you need to switch Wi-Fi configuration, you can use the App or follow the instructions in the manual to reconfigure the network.
4. TCP monitors Port 15250, and is used for connecting HomeBase.

Model: T8162

1. Power consumption in low power: $\leq 0.5\text{ W}$;

When the product is fully charged and supplied by the EPS, it enters the low power consumption condition after 1 minute.

2. Recommended external adapter:

Brand: ANKER

Manufacturer: Anker Innovations Limited

Model: A2337

Input: 100-240V~ 1.0A, 50-60Hz

Output: 5.0VDC, 2.0A, 10W

Model: T8030

1. Networked standby mode: ≤ 7 W;

When the product is connected to the router via the RJ45 port and provides Wi-Fi signal to T8162, in case of no data transmission, it enters the networked standby mode after 1 minute.

When the product is disconnected from the RJ45 port and does not provide Wi-Fi signal to T8162, in case of no data transmission, it enters the networked standby mode after 1 minute.

2. Adapter information:

Brand: Keyu

Manufacturer: Shenzhen Keyu Power Supply Technology Co., Ltd.

Model: KA2401A-2001200EU

Input: 100-240V~, 50/60Hz or 50-60Hz, 0.65A Max

Output: 20.0VDC, 1.2A, 24.0W