

# Diffuser of essential oils



Reference : DE122  
Version : 1.5  
Language : English

## User manual

You have purchased a product **LIVOO** brand and we thank you. We take great care in design, ergonomics and ease of use of our products. We hope that this product will give you complete satisfaction.

This instruction manual is available too on our website [www.livoo.fr](http://www.livoo.fr)

### GENERAL INSTRUCTIONS

PLEASE, TAKE TIME TO READ WELL THE INSTRUCTIONS FOR USE PARTICULARLY BEFORE THE FIRST USE. A misuse of the appliance can damage it or hurt the user. Assure that you use the appliance for the use for which it is designed; we refuse any responsibilities as for the damages by an incorrect use or a bad manipulation.

1. Check that your mains voltage corresponds to that stated on the appliance.
2. The safety instructions do not by themselves eliminate any danger completely and proper accident prevention measures must always be used.
3. Never leave the appliance unsupervised when in use. Keep out of reach of children or incompetent persons.
4. Stand the appliance on a table or flat surface.
5. Unplug the appliance when not in use.
6. Keep this manual with the appliance. If the appliance is to be used by a third party, this instruction manual must be supplied with it.

7. Cleaning and user maintenance shall not be made by children without supervision.
8. Keep the appliance and its cord out of reach of children aged less than 8 years.
9. This appliance can be used by children aged from 8 years and above and persons with reduced physical, sensory or mental capabilities or lack of experience or knowledge if they have been given supervision or instruction concerning use of the appliance in a safe way and understand the hazards involved.
10. Children shall not play with the appliance.
11. There is potential injury from misuse.
12. Unplug the appliance during filling and cleaning.
13. Care should be taken when using the appliance due to the emission of hot water vapour.
14. The appliance must only be supplied at safety extra low voltage corresponding to the marking on the appliance.
15. Refer to below paragraph for details regarding filling, cleaning and descaling.
16. This appliance is intended to be used in household and similar applications such as:
  - staff kitchen areas in shops, offices and other working environments
  - farm houses
  - by clients in hotels, motels and other residential type environments

- bed and breakfast type environments

## TECHNICAL CHARACTERISTICS

Voltage: DC5V 0.8A

Power: 2W

Cotton rod and replacement rod included

USB cable supplied

## DESCRIPTION

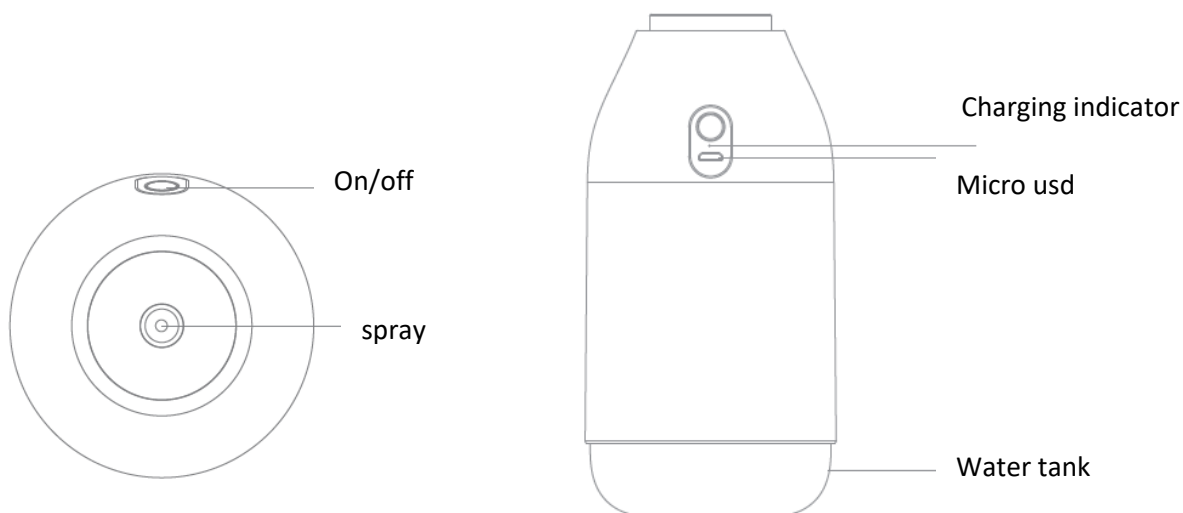

## USE

- Place the unit on an even surface. It's suggested to pour on tap water, pure water or mineral water in normal temperature. Corrosive liquid is not suitable to pour into this unit.
- Fill the tank with 270ml of water maximum.

**Livoo**  
Feel good moments  
**User manual**

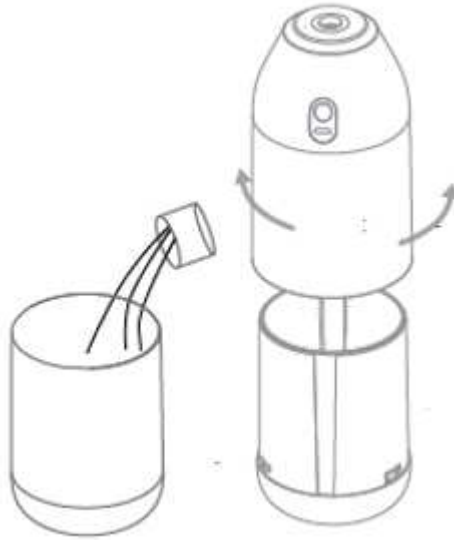

Short press button to turn on the spray, short press button again to turn on the intermittent spray mode, third time short press again to turn off.

Spray function stops automatically when there is no water and LED light will blink.

Led lighting:

- 1 long support / strong light
  - 1 second long support / light
  - 1 3rd long support / light stop
  - 1 short support continuous dissemination
  - 1 second short support / discontinuous dissemination
  - 1 3rd short press / broadcast stop
- LED light will be auto off after 6 hours.

**Note: use only water soluble essential oil and rinse the water tank after use to avoid gets dirty.**

## GENERAL CARE AND CLEANING

We recommend that you empty the tank and clean the diffuser after each use.

1. After use, unplug the appliance, empty water from back side
2. Use a clean cloth to clean the unit
3. To replace cotton rod



## DESCALING

The appliance has to be descaled regularly especially if you have not used mineral water as explained on manual.

1. Remove the cover and fill the tank with vinegar and water (  $\frac{1}{3}$  vinegar,  $\frac{2}{3}$  water), wait few minutes.
2. Rinse the tank and dry it.

### **Procedure to observe for battery's end of life**

The appliance batteries must be removed before discarding the equipment. Please follow the procedure below:

Ensure that your appliance is disconnected so as to reduce any risk of electrical shock. Discharge the batteries fully.

Remove the protection cover situated in a location where you connect the mains voltage adapter and it is removed so as to access the batteries compartment. Carry a screwdriver to remove the screw.

Remove the batteries from the equipment. Cut the cables and tab connecting the batteries in the printed circuit and remove them.

### **ATTENTION: THESE NI-MH CELLS MUST BE RECYCLED OR ELIMINATED IN ACCORDANCE WITH THE EQUIPMENT SCRAPPING.**

Do not burn, dismantle, crush or break out the batteries because they can release toxic substances. Do not expose them to extreme temperatures.

Drop them in the batteries recycling bins designed for this purpose or return them to your retailer.



**Correct Disposal of this product**

**(Waste Electrical & Electronic Equipment)**

**(Applicable in the European Union and other European countries with separate collection systems)**

The European Directive 2012/19/EU on Waste Facilities Electrical and Electronic (WEEE)

This marking shown on the product or its literature, indicates that it should not be disposed with other household wastes at the end of its working life.

To prevent possible harm to the environment or human health from uncontrolled waste disposal, please separate this from other types of wastes and recycle it responsibly to promote the sustainable reuse of material resources.

Household users should contact either the retailer where they purchased this product or their local authority office, for details of where and how they can take this item for environmentally safe recycling.



**LIVOO**  
BP 61071  
67452 Mundolsheim - FRANCE

- Photo no contractual
- Worried about the quality of his products the manufacturer reserves the right to make modifications without advance notice