



INSTRUCTION **MANUAL**

BLACKGATEHUNTING.COM

INTRODUCTION R4G-LITE+

- 1 Lens/Sensors
- 2 Antenna
- 3 IR LEDs (940NM)
- 4 LED Indicator Light
- 5 Battery Tray
- 6 PIR Motion Sensor
- 7 Padlock Hole
- 8 DC Power Port (12V)
(Plug Size 5.5 x 2.1mm)
- 9 Tripod/Mount Attachment
1/4" x 20
- 10 Power Switch
- 11 Format SD Card Button
- 12 Account Indicator
- 13 Battery Indicator
- 14 SIM Card Indicator
- 15 Signal Indicator
- 16 Strap Brackets
- 17 Pipe-Through
Bracket for
Python Cable

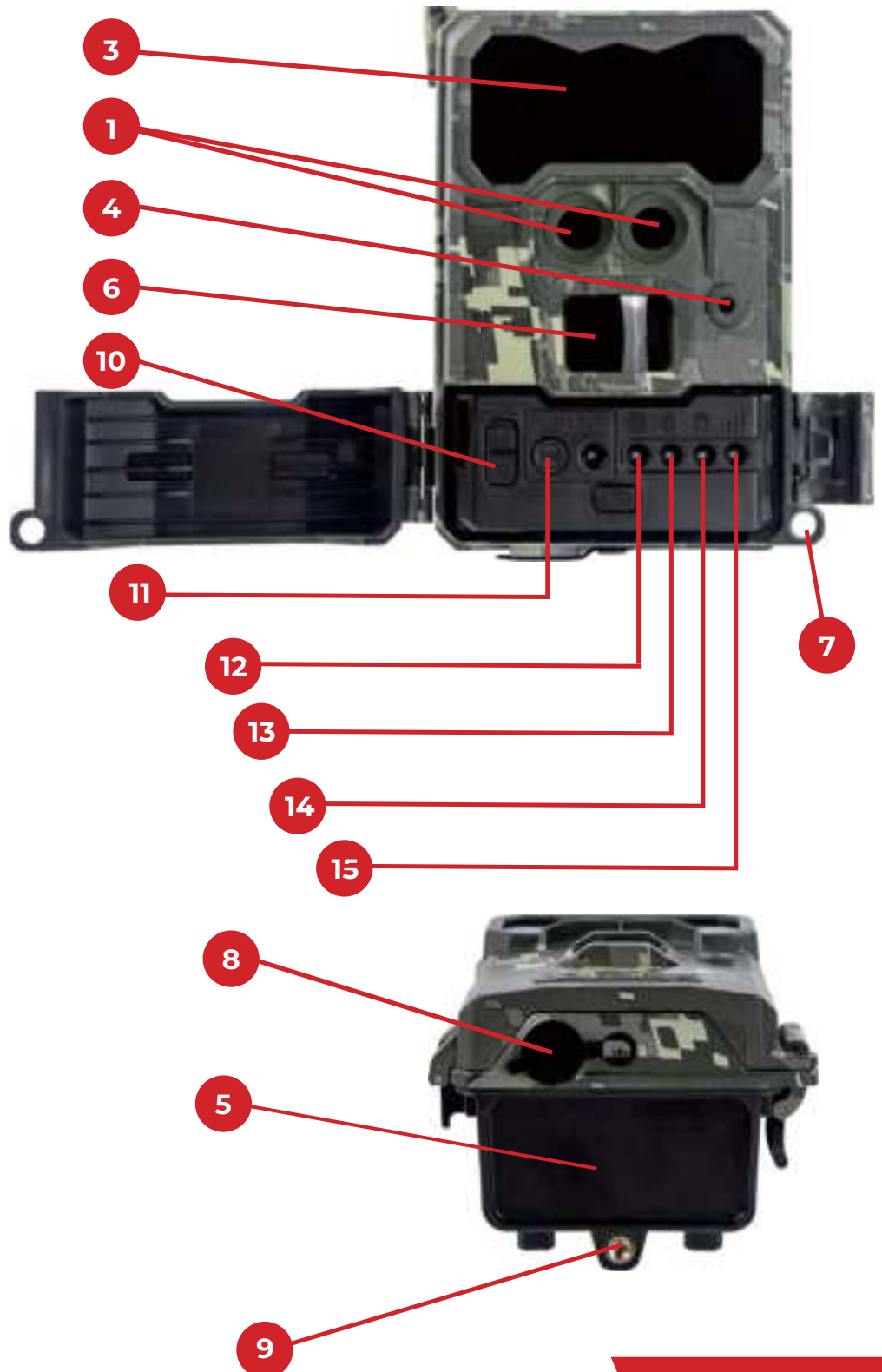

QUICK START GUIDE

WHAT IS IN THE BOX?

- (1) R4G-LITE+ TRAIL CAMERA
- (1) INSTRUCTION MANUAL
- (1) MOUNTING STRAP
- (1) ANTENNA
- (1) PRE-INSTALLED SIM CARD

WHAT YOU WILL NEED

- (16) AA BATTERIES
(LITHIUM RECOMMENDED)
- (1) SD CARD - CLASS 10, U3 REQUIRED
MINIMUM 100 MB/S



BLACK GATE MOBILE APP DOWNLOAD



**BLACK GATE
MOBILE**

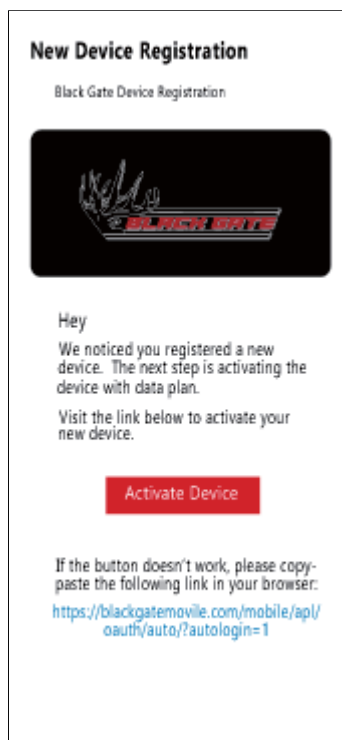
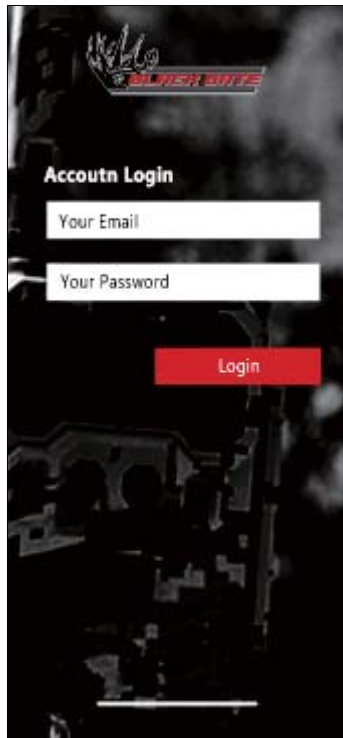

QUICK SET UP

SETTING UP THE CAMERA

1. Make sure the antenna is properly installed and seated down tightly.
2. Install (16) AA batteries and a class 10, U3 SD card into the camera. Use only 16GB-64GB SD card.
Recommended to use Black Gate or SanDisk only
3. Do NOT remove the SIM card pre-installed into the camera.
4. Scan the QR code sticker using the Black Gate Mobile App. Proceed to activate your camera and choose a data plan.
5. Turn on the device and make sure the power light indicator beside the Format SD button is solid Green, also the battery indicator light blinks green. The camera will register and all 4 LED indicators will show green before going into live mode.
 - If the battery light indicator shows red, please replace batteries with NEW AA batteries.
 - If the "Globe" account indicator shows red please check your account on www.blackgatemobile.com and make sure the camera is activated and has a data plan.
 - If the SIM card indicator shows red, please remove and re-insert the SIM card and also make sure you have a active data plan for this camera you are registering.
 - If the Signal bars indicator shows red, this means you have no signal. Please move to a different area to capture better reception.

DOWNLOADING THE BLACK GATE MOBILE APP

In your Apple or Google Play Store, download the Black Gate Mobile App and sign in using an email and password you created.

If you already have a Black Gate account with ACTIVE cameras, you can simply login to your app and add your camera following the instructions below.

Once you have created your account, and set up your data plan, it is time to activate your camera in the app:

1. Click "Add Device"
2. Locate the QR code on the R4G-Lite either inside the door or on the back of the device.
3. Using your phone, Scan the QR Code "If scanned correctly, it will state that the camera has been added successfully"
4. Check your email for an activation link to purchase data on the Black Gate Mobile Portal
5. Once logged into www.blackgatemobile.com portal, look under your devices and click on "View/Manage"
6. Select the data plan of your choice and continue through the checkout process. (This will be a recurring plan monthly unless device is deactivated in the portal)
7. Go back to the Black Gate Mobile App on your phone, and your camera will now be activated and ready for use.
8. Your new photos will come in under your device name in the Dashboard tab.
9. Settings can be changed under the device tab
10. To add an additional camera, follow and repeat steps 1-9.



**BLACK GATE
MOBILE**



SETTINGS / SPECIFICATIONS

Camera Mode	Camera Mode Only (No Video)
Day/Night Mode	Daytime: Color, Nighttime: B+W
IR Range	70+ Feet
PIR Angle	52 degrees, 4:3 Format
Flash	940 NM No-Glow
SD Card	Class 10, U3, 16GB - 64GB, Minimum 100 MB/Sec
Picture Format	JPEG
Multishot	Optional 1-9 Photoburst
Trigger Speed	<.3 seconds
SD Card Recycle	Yes, Default
Battery	16 AA Lithium Ultimate Optional external power source (12V external battery pack or solar panel) Recommended 3000mAh DC barrel size 5.5 x 2.1mm
External DC	12V
Transfer Picture via 4G	High, detailed thumbnail images sent to Black Gate App (additional data charges may apply)
Request HD Photo via 4G	Available to be requested from Black Gate Mobile App
Upload Frequency/ Send Type	Immediate/Hourly/Daily
4G Communication	LTE wireless
4G Antenna	1 Antenna Module
Device Serial No.	Yes
Interface	LTE and SD Card
Mounting	Strap; Tripod (1/4" x 20 threaded insert) - two locations
Operating Temperature	-5F to 125F
Operation Humidity	5% - 95%
Waterproof rating	IP66
Dimensions	5.5" x 3.5" x 2.5"
Weight	1 lb (without batteries)
Certification	FCC RoHs

PRODUCT CARE

INTERNAL CONDENSATION ON LENS

The R4G-Lite+ is IP66 rated waterproof. The camera housing is water resistant and resistant to harsh outdoor elements. The only way condensation can get behind the lens is if the antenna is not screwed down tightly or if the DC plug on the bottom of the camera is not in place, if you are not using external power. If there is dirt or debris on the door seal, this can also effect the waterproof seal and allow water in the device. Follow instructions to alleviate this issue if need be:

- Pull the SD card out and let the camera sit for 3-4 days open, in an area where there is circulating air (fan or vent).
- Or place in a sealed container with rice for 24 hours to draw out the moisture.
- Clean the seal well with soap and water and tighten your antenna.
- Place back out in the field.

IF THE CAMERA HAS ACCIDENTALLY BEEN SUBMERGED IN WATER

1. Open camera and immediately remove batteries and SD card.
2. Leave the camera open to dry out for 3-4 days. If you try to power on while the camera is still wet, it could destroy the module and computer board and ruin the camera. This will void the warranty.



LIMITED WARRANTY

**CHECK OUT WARRANTY
INFORMATION ON OUR WEBSITE
WWW.BLACKGATEHUNTING.COM**

The device has been evaluated to meet
general RF exposure requirement.

To maintain compliance with FCC's RF
exposure guidelines, the distance must
be at least 20 cm between the radiator
and your body, and fully supported by
the operating and installation.

FCC REGULATIONS

FEDERAL COMMUNICATIONS COMMISSION - PART 15

This equipment has been tested and found to comply with the limits for a Class B digital device, pursuant to Part 15 of the Federal Communications Commission rules. These limits are designed to provide reasonable protection against harmful interference in a residential installation. This equipment generates, uses and can radiate radio frequency energy and, if not installed and used in accordance with the instructions, may cause harmful interference to radio communications. However, there is no guarantee that interference will not occur in a particular installation. If this equipment does cause harmful interference to radio or television reception, which can be determined by turning the equipment off and on, the user is encouraged to try to correct the interference by one or more of the following measures:

- Reorient or relocate the receiving antenna.
- Increase the separation between the equipment and receiver.
- Connect the equipment into an outlet on a circuit different from that to which the receiver is connected.
- Consult the dealer or an experienced radio/TV technician for help.

Changes or modifications to this equipment not expressly approved by the party responsible for compliance could void the user's authority to operate the equipment. This device complies with Part 15 of the FCC rules. Operation is subject to the following two conditions: (1) this device may not cause harmful interference, and (2) this device must accept any interference received, including interference that may cause undesired operation.

RETURN

**DO NOT RETURN
THIS PRODUCT TO
YOUR RETAILER**

**PLEASE CALL
937-900-7195**

**OR EMAIL
CONTACT@BLACKGATEHUNTING.COM**

For any warranty issues or questions