



## QUICK START GUIDE

**Firmware Version: 2.3.x**

Last updated on Dec 13, 2024

# SPIDER ST1

MOTORCYCLE MESH COMMUNICATION SYSTEM



The firmware version 2.3.x indicates that this manual is applicable to all firmware updates within the version 2.3 series.

## ■ Downloadable Sena Software

Download the **Sena Motorcycles App** at **Google Play Store** or **App Store**.



Download the **Sena Device Manager** at **sena.com**.

## ■ Product Details

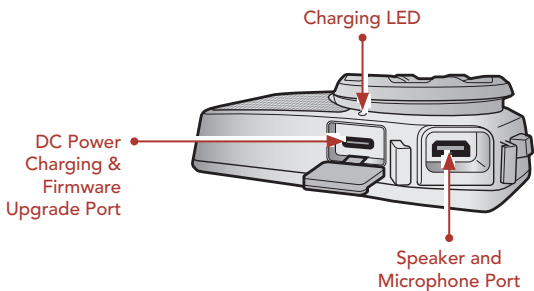
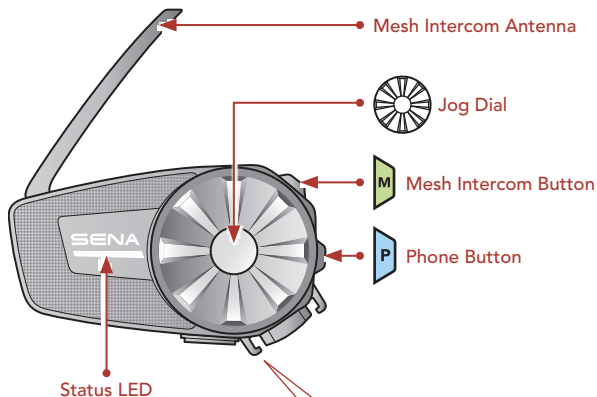

## ■ Installation

- For more information about installation, refer to the User's Guide.

### Using the Clamp Unit

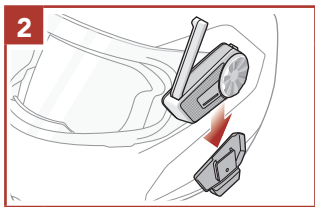
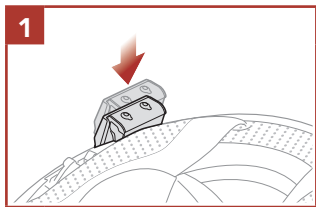

### Using the Glued Surface Mounting Plate

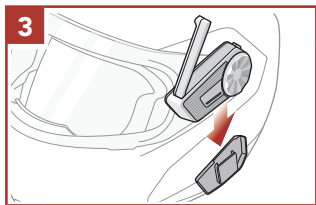
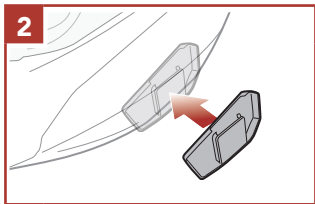
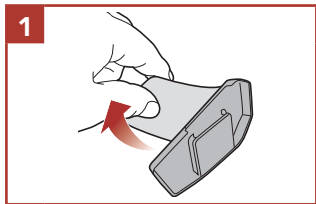

## Installing the Speakers

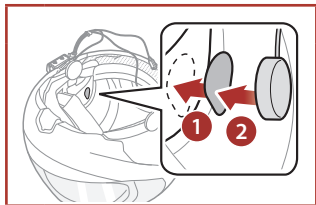

## Installing the Wired Boom Microphone

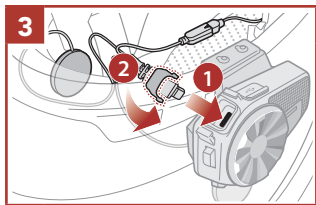
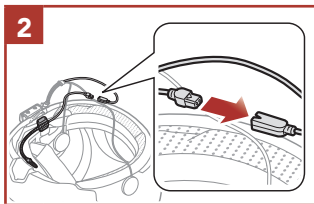
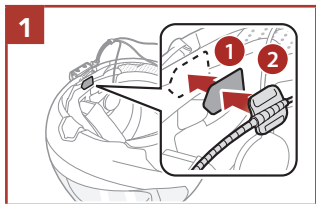

## Installing the Wired Microphone

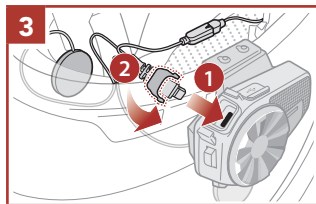
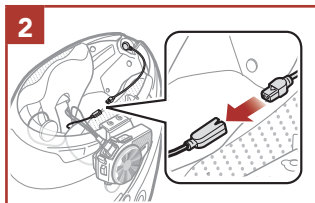
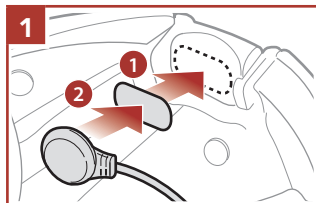

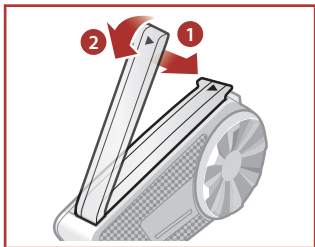

## ■ Mesh Intercom Antenna

Pull the Mesh Intercom Antenna outwards slightly to unfold it.



## Icon Legend

 **Tap** button/Jog Dial the specified number of times

 **Press and Hold** button/Jog Dial for the specified amount of time

   **Rotate** Jog Dial clockwise (right) or counterclockwise (left).

   **Rotate while Pressing** Jog Dial clockwise (right) or counterclockwise (left).

 "Hello"

**Audible prompt**

## Basic Operations

### Powering On

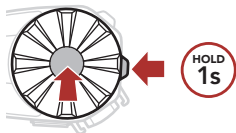

### Powering Off

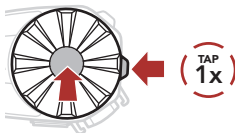

### Volume Up



### Volume Down



## ■ Checking the Battery Level

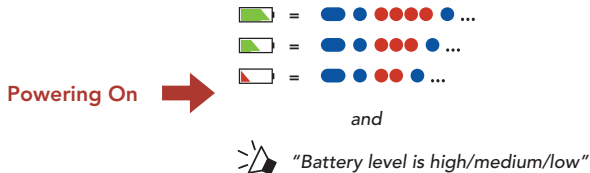

## ■ Phone Pairing



- ② Select **SPIDER ST1** in the list of Bluetooth devices detected.



- When you turn on the SPIDER ST1 for the first time or reboot it after a factory reset, the SPIDER ST1 will automatically enter phone pairing mode.
- To cancel phone pairing, press any button.



## ■ Using the Phone

### Answer a Call

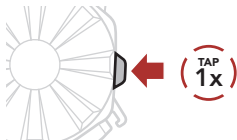

### End a Call

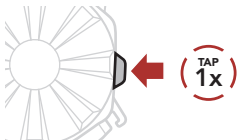

### Reject a Call



### Call a Voice Assistant

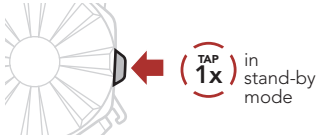

## ■ Music Control

### Play/Pause



### Track Forward



### Track Backward



## ■ Mesh Intercom™

**Open Mesh™:** communication within the same channel.

**Group Mesh™:** communication within the same private group.

- For more information on **Mesh Intercom**, refer to the User's Guide.

### Mesh Intercom On



### Mesh Intercom Off



**Note:** When **Mesh Intercom** is on, the **SPIDER ST1** will automatically connect to nearby **SPIDER ST1** users and the headset will be in **Open Mesh (default: channel 1)** initially.

# Open Mesh

## Channel Setting (Default: channel 1) in Open Mesh

### Using the Button

- ① Enter into the Channel Setting.



- ② Navigate between channels.

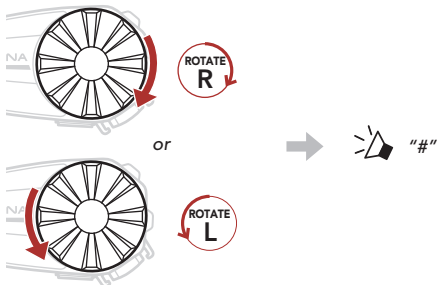

- ③ Save the channel.



### Using the Sena Motorcycles App

You can select the channel through the **Sena Motorcycles App**.

# ■ Group Mesh

**Group Mesh** is a closed group intercom function that allows users to join, leave, or rejoin a group intercom conversation without pairing each headset.

## 1) Creating a Group Mesh

Creating a **Group Mesh** requires **two or more Open Mesh users**.

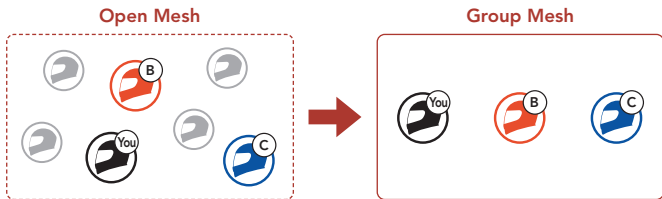

- ① **Users (You, B, and C)** enter into **Mesh Grouping** to create a **Group Mesh**.



- ② When **Mesh Grouping** is completed, the **users (You, B and C)** will hear a voice prompt on their headset as **Open Mesh** switches to **Group Mesh**.



## 2) Joining an Existing Group Mesh

One of the **current users** in an **Existing Group Mesh** can allow **new users (one or more)** in **Open Mesh** to join the **Existing Group Mesh**.

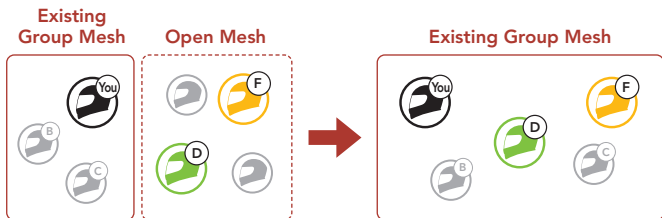

- ① One (**You**) of the **current users** in the **Existing Group Mesh** and **new users (D and F)** in **Open Mesh** enter into **Mesh Grouping** to join the **Existing Group Mesh**.



- ② When **Mesh Grouping** is completed, the **new users (D and F)** will hear a voice prompt on their headset as **Open Mesh** switches to **Group Mesh**.



## ■ Enable/Disable Mic (Default: Enable)

Users can enable/disable the microphone when communicating in a **Mesh Intercom**.



## ■ Mesh Reach-Out Request

You (caller) can send a request message to turn on the Mesh Intercom to nearby friends who have it turned off.

- ① If you want to send or receive a request message, you need to enable **Mesh Reach-Out** on the **Sena Motorcycles App**.
- ② While your headset's Mesh Intercom is on, you (caller) send a request message using the **headset's Button** or the **Sena Motorcycles App**.

[Caller]

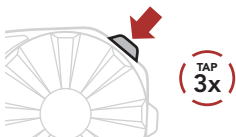

[Caller]

 "Mesh reach-out request"

[Nearby Friends]

 "Mesh intercom requested"

- ③ Friends who receive the request message need to manually turn on their Mesh Intercom using the **headset's Button** or the **Sena Motorcycles App**.

## Reset Mesh

If a headset in an **Open Mesh** or **Group Mesh** resets the **Mesh**, it will automatically return to **Open Mesh (default: channel 1)**.



## Configuration Menu

### Accessing the Configuration Menu



### Navigating Between Menu Options



### Execute Menu Options

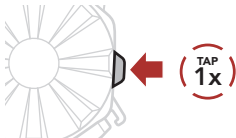

# Troubleshooting

## Factory Reset





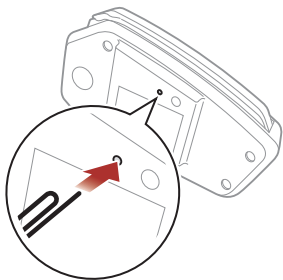











## Fault Reset













**Note: Fault Reset** will not restore the headset to the factory default settings.



## Quick Reference

TYPE	OPERATION	BUTTON COMMANDS
 <b>Basic Operations</b>	Power on/ Power off	 
	Volume up/Volume down	 or 
 <b>Mobile Phone</b>	Answer phone call	
	End phone call	
	Reject phone call	
	Call a Voice Assistant	
 <b>Music</b>	Play/Pause music	
	Track forward	
	Track backward	

TYPE	OPERATION	BUTTON COMMANDS
 <b>Mesh Intercom™</b>	Mesh Intercom on/off	 
	Channel setting	 
	Mesh Grouping	 
	Enable/Disable Mic	 
	Mesh Reach-Out Request	 
	Reset Mesh	