

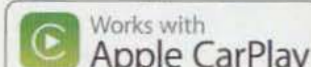

CAR12TC

QUICK START GUIDE

Media Receiver with Android Auto™ and Apple CarPlay®
featuring a 11.6" digital TFT Display



This Quick Start Guide gives you the basics to start using your CAR12TC. Please visit <https://www.jensenmobile.com> to download a complete owner's manual or call customer service at 1-888-921-4088 (Monday-Friday, 9AM-5PM EST).

Designed and Engineered in USA

JENSEN®

Wiring Diagram - Inputs/Outputs

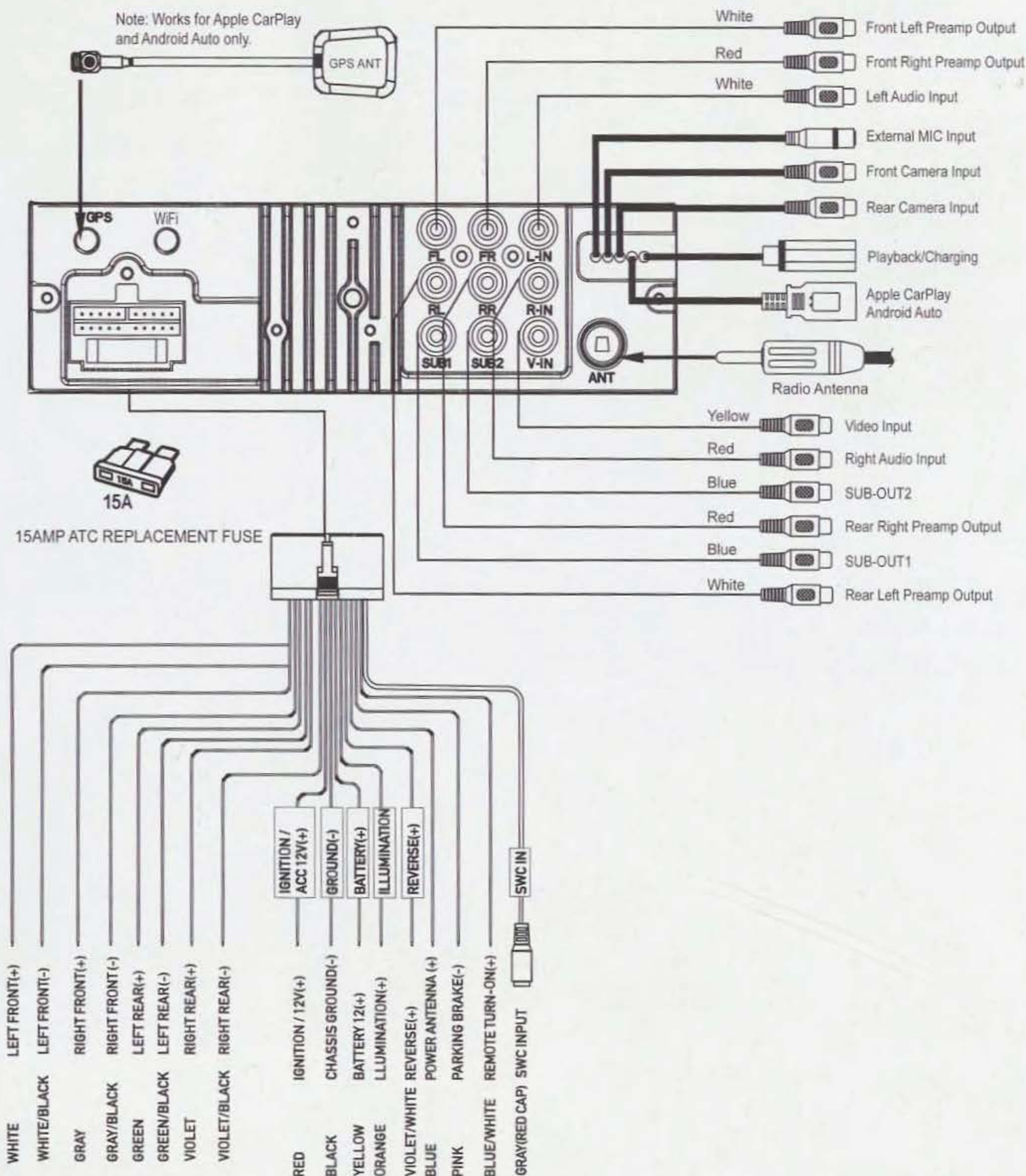

Note:
When replacing a fuse, make sure to use the correct type and amperage. Using an incorrect fuse could cause damage. The unit uses (1) 15 amp ATC mini style fuse located on the power connector.

Control Locations

The radio display features the following functions and displays:

- ① **Control Knob**
*Short press to mute / Long press to power off
*Rotate to increase or decrease volume
- ② **Reset**
- ③ **Previous / search back**
- ④ **Next / search forward**
- ⑤ **CPAA voice button**
- ⑥ **Source / Home**



Main Menu

In main menu, press the desired icon to enter the corresponding mode: Apple Carplay/Android Auto/Bluetooth Audio/Radio/USB/Bluetooth Phone/AV IN/Cameras/Settings.



Tuner Operation

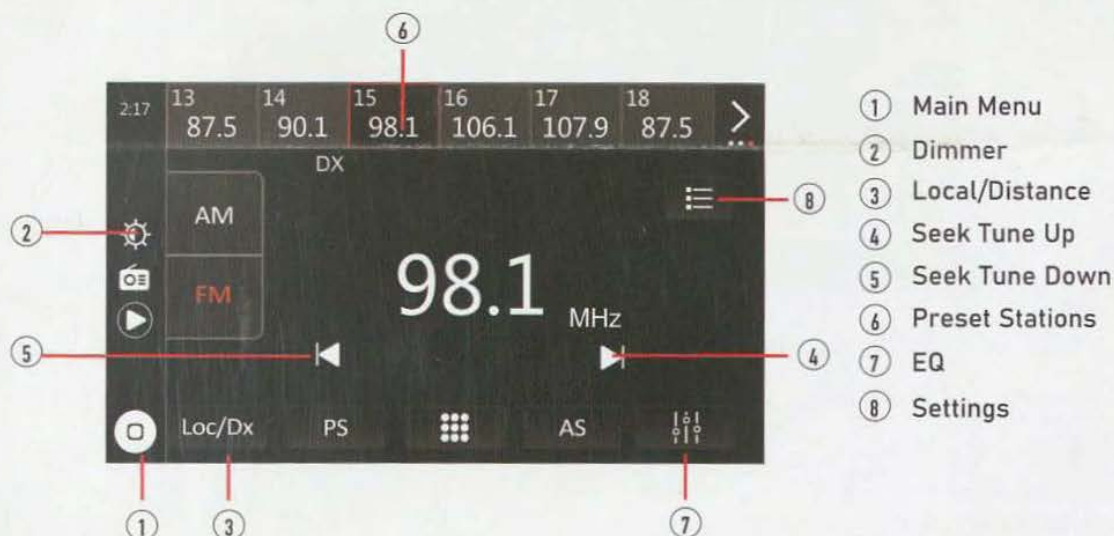

USB Operation

From the main menu, touch the USB icon on the main screen.



- ① Main Menu
- ② Current Mode Indicator
- ③ Repeat
- ④ Random
- ⑤ List
- ⑥ ID3 Tag Display Area
- ⑦ Track Down
- ⑧ Play/Pause
- ⑨ Track Up
- ⑩ Album Art

Audio Operation

Press the AUDIO icon on the main menu screen to enter the audio settings menu.

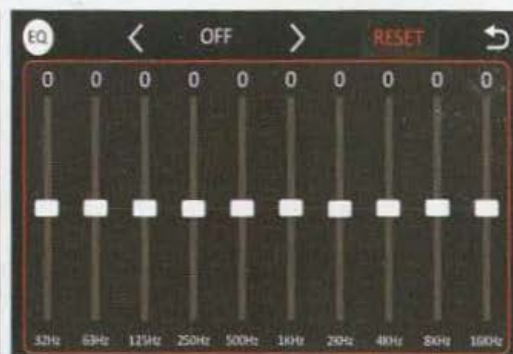
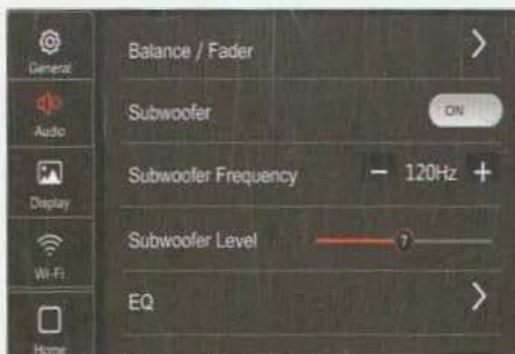

Screen Operation

Press the Display icon in the Settings menu to access the Brightness, Contrast, Button Illumination Colors and Wallpaper Settings.

The outer screen is lined with color-changing illumination for customization options.



General Operation

Press the General icon in the Settings menu to access the Time Zone, Date and Time and other radio Settings.



Adjusting Front and Rear Camera Screen Image

if your front or rear cameras appear to have a reversed image on the radio's display, go into the Camera section in the Settings menu to reverse the image of the camera. To do this, toggle the "Rear Camera View Reverse" or "Front Camera View Reverse" function to correct the viewing angle of the camera(s)



Wired & Wireless Apple CarPlay Operation

Wired connection

1. Connect an Apple CarPlay compatible device to this unit via USB.
2. Press the Apple CarPlay icon.

The Apple CarPlay home screen appears.

Wireless connection

Before using Apple CarPlay wirelessly, turn on the Bluetooth/Wifi function on the Phone.

1. Press  icon on the main menu;
2. Press "✓" to confirm to use wireless Apple CarPlay;
3. Press "🔍" icon to search phone device. The available devices appear on the list;
4. Find the desired device on the screen and press "Pair";
5. A pass key will be displayed on the screen;
6. The same key appears on the iPhone, press "Pair" and then press "Allow" for the popups;
7. Press "✓" on the screen to confirm to connect;
8. Press "Use CarPlay" on the iPhone. The unit configures the connection then starts the application.



Wired & Wireless Android Auto™ Operation

Wired connection

1. Connect an Android Auto™ compatible device to this unit via USB.
2. Press the Android Auto icon.

The Android Auto home screen appears.

Wireless connection

Before using Android Auto wirelessly, turn on the Bluetooth/Wifi function on the Android device.

1. Press  icon on the main menu;
 2. Press "✓" to confirm to use wireless Android Auto;
 3. Press "🔍" icon to search phone device. The available devices appear on the list;
 4. Find the desired device on the screen and press "Pair";
 5. A pass key will be displayed on the screen;
 6. The same key appears on the Android device, press "Pair" and then press "Allow" for the popups;
 7. Press "✓" on the screen to confirm to connect;
- The unit configures the connection then starts the application.



Bluetooth Operation

Before using Bluetooth

Before you can use a Bluetooth device to make hands-free calls or stream audio, it must be authenticated. This is also referred to as "pairing" a device.

Pairing a New Device

The unit broadcasts the pairing signal constantly when no devices are currently connected. Complete the pairing sequence from your Bluetooth device. Refer to the owner's manual for your device for more details. The device name is "**CAR12TC**". The unit can be in any mode of operation when pairing is performed. On certain phones, pairing may need to be done more than once.

Connect

The head unit will automatically connect to the last connected device when the connect feature is set to Auto connect On. If the connect feature is set to Auto Connect Off, the head unit will not automatically connect to any device.



Bluetooth Phone

From the main menu, Touch the **Bluetooth** on the screen. Bluetooth icon will appear anytime a Bluetooth device is connected.

Dialing a Number

Press  to display keypad and dial a number.

Making and Ending a Call

Press  to connect a call, and press  to end a call.

Transferring Audio

Press  to transfer audio between the head unit and mobile phone.

Streaming Audio

Press  to play or pause the music.

Press  to skip to the previous track.

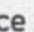
Press  to advance to the next track.



Limited Three Year* Warranty

This warranty gives you specific legal rights. You may also have other rights which vary from state to state.

Jensen warrants this product to the original purchaser to be free from defects in material and workmanship for a period of three years from the date of the original purchase.

Jensen agrees, at our option, during the warranty period, to repair any defect in material or workmanship or to furnish an equal new, renewed, or comparable product (whichever is deemed necessary) in exchange without charges, subject to verification of the defect or malfunction and proof of the date of purchase. Subsequent replacement products are warranted for the balance of the original warranty period.

What is covered? This warranty covers all defects in the material and workmanship in this product. The following are not covered: software, installation/removal costs, damage resulting from accident, misuse, abuse, neglect, product modification, improper installation, incorrect line voltage, unauthorized repair, or failure to follow instructions supplied with the product, or damage occurring during return shipment of the product. Specific license conditions and copyright notices for the software can be found via www.jensenmobile.com.

Warranty Coverage

* Limited 3-year warranty. (Proof of purchase required)

Extend your warranty from 3 years to 5 years when installed by the selling dealer and you register online at www.jensenmobile.com.

What to do?

1. Before you call for service, check the troubleshooting guide in your owner's manual. A slight adjustment of any custom controls may save you a service call.
2. If you require service during the warranty period, you must carefully pack the product (preferably in the original package) and ship it by prepaid transportation with a copy of the original receipt from the retailer to an authorized service center.
3. Please describe your problem in writing and include your name, a return UPS shipping address (P.O. Box not acceptable), and a daytime phone number with your shipment.
4. For more information and for the location of the nearest authorized service center please contact us by one of the following methods:
 - Call us toll-free at (888) 921-4088
(Monday-Friday, 9:00 am, to 5:00 pm, EST)
 - E-mail us at cs@jensenmobile.com

Exclusion of Certain Damages: This warranty is exclusive and in lieu of any and all other warranties, expressed or implied, including without limitation the implied warranties of merchantability and fitness for a particular purpose and any obligation, liability, right, claim or remedy in contract or tort, whether or not arising from the company's negligence, actual or imputed. No person or representative is authorized to assume for the company any other liability in connection with the sale of this product. In no event shall the company be liable for indirect, incidental, or consequential damages.

FCC Compliance

This device complies with Part 15 of the FCC Rules. Operation is subject to the following two conditions:

- (1) this device may not cause harmful interference, and
- (2) this device must accept any interference received, including interference that may cause undesired operation.

Warning: Changes or modifications to this unit not expressly approved by the party responsible for compliance could void the user's authority to operate the equipment.

Note: This equipment has been tested and found to comply with the limits for a Class B digital device, pursuant to Part 15 of the FCC Rules. These limits are designed to provide reasonable protection against harmful interference in a residential installation. This equipment generates, uses and can radiate radio frequency energy and, if not installed and used in accordance with the instructions, may cause harmful interference to radio communications. However, there is no guarantee that interference will not occur in a particular installation. If this equipment does cause harmful interference to radio or television reception, which can be determined by turning the equipment off and on, the user is encouraged to try to correct the interference by one or more of the following measures:

- Reorient or relocate the receiving antenna.
- Increase the separation between the equipment and receiver.
- Connect the equipment into an outlet on a circuit different from that to which the receiver is connected.
- Consult the dealer or an experienced radio/TV technician for help.

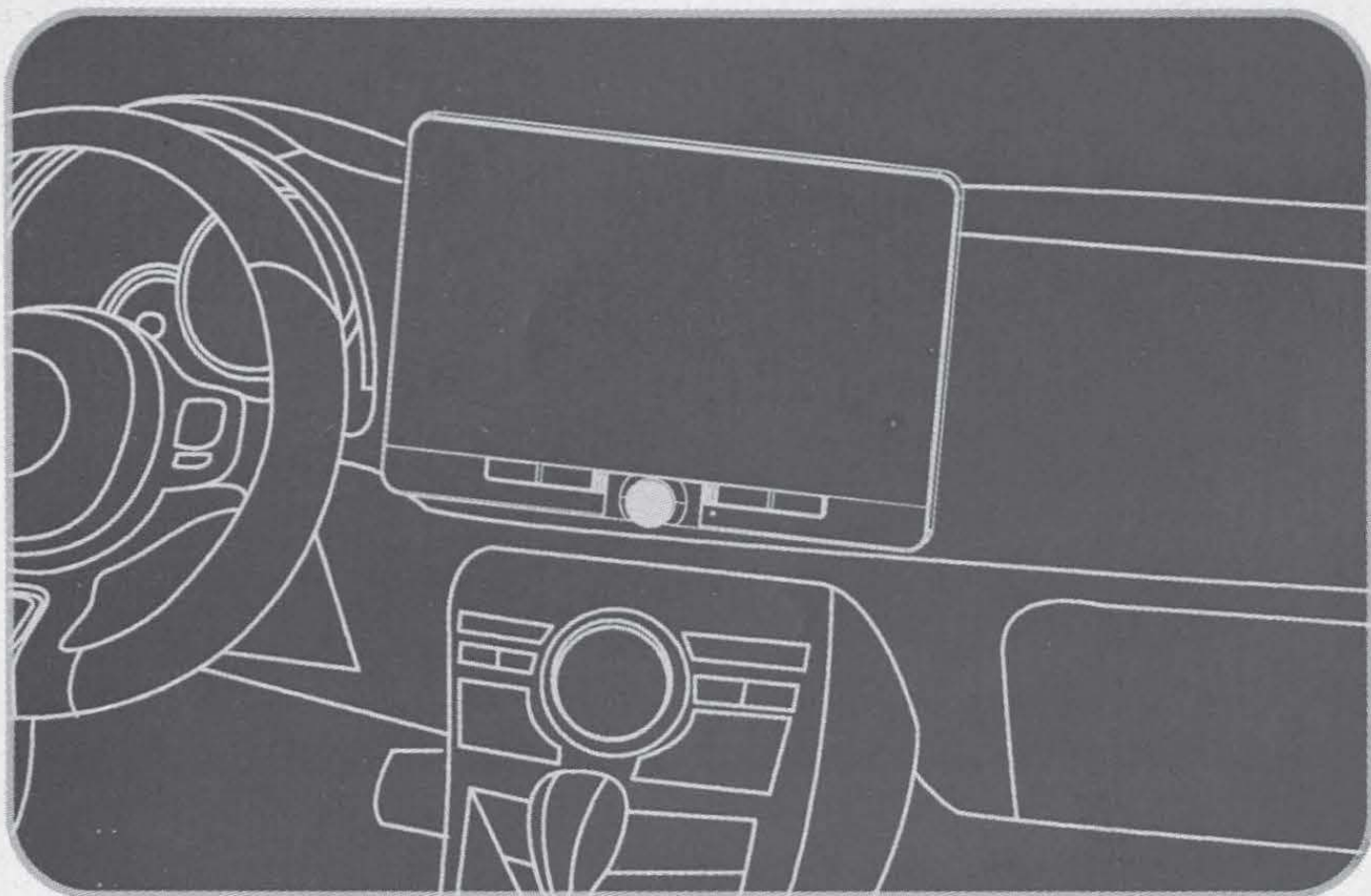

Installation Guide

Preparing for Installation

Package Contents

- | | |
|-------------------------------------|--|
| 1. Main Unit | 6. Trim Ring |
| 2. Mounting Sleeve for 1 DIN | 7. Wiring Harness |
| 3. Release Keys | 8. Microphone |
| 4. Screw Kit | 9. GPS Antenna (for CarPlay and Android Auto only) |
| 5. Chassis sleeve for 2 DIN install | |

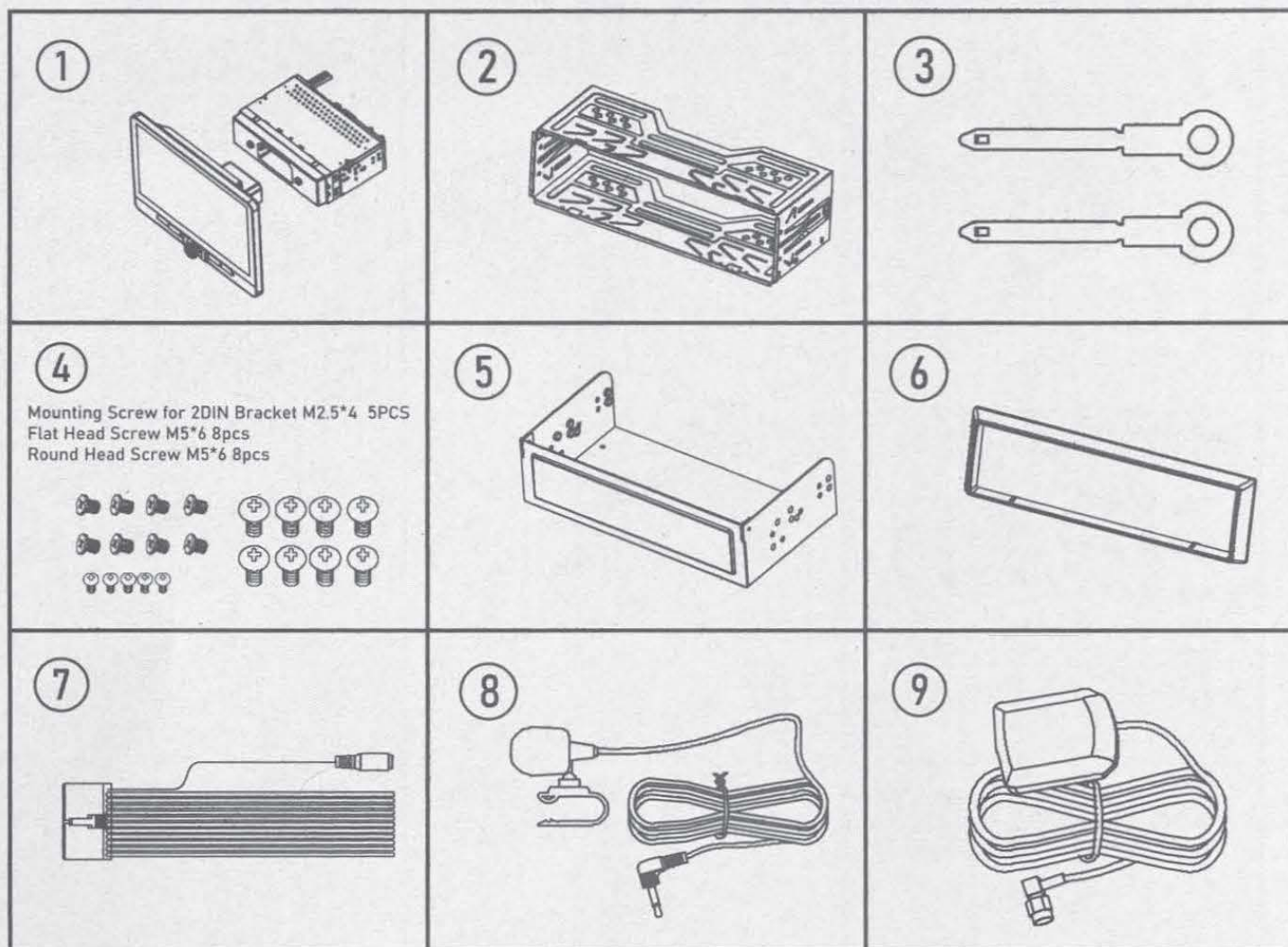

Installation

Before You Begin

Before You Begin

- Consult a qualified technician for instructions.
We always recommend professional installation.
- Disconnect the negative battery terminal.
- Remove trim ring from unit (if installed).
- Insert the removal keys, and remove the mounting sleeve from the receiver.

Note: Most vehicles require an installation kit, wiring harness and/or antenna adapter (all sold separately) to properly install the head unit in the vehicle.

Install Mounting Sleeve and Trim Ring

- 1) Install the mounting sleeve into a dash kit (sold separately) or dash opening, bending the tabs to secure the mounting sleeve.
- 2) Connect the wiring harness, microphone and antenna to the chassis of the radio.
- 3) Snap trim ring into place making sure the notched area is on the bottom.
- 4) Slide the receiver into the mounting sleeve to secure.

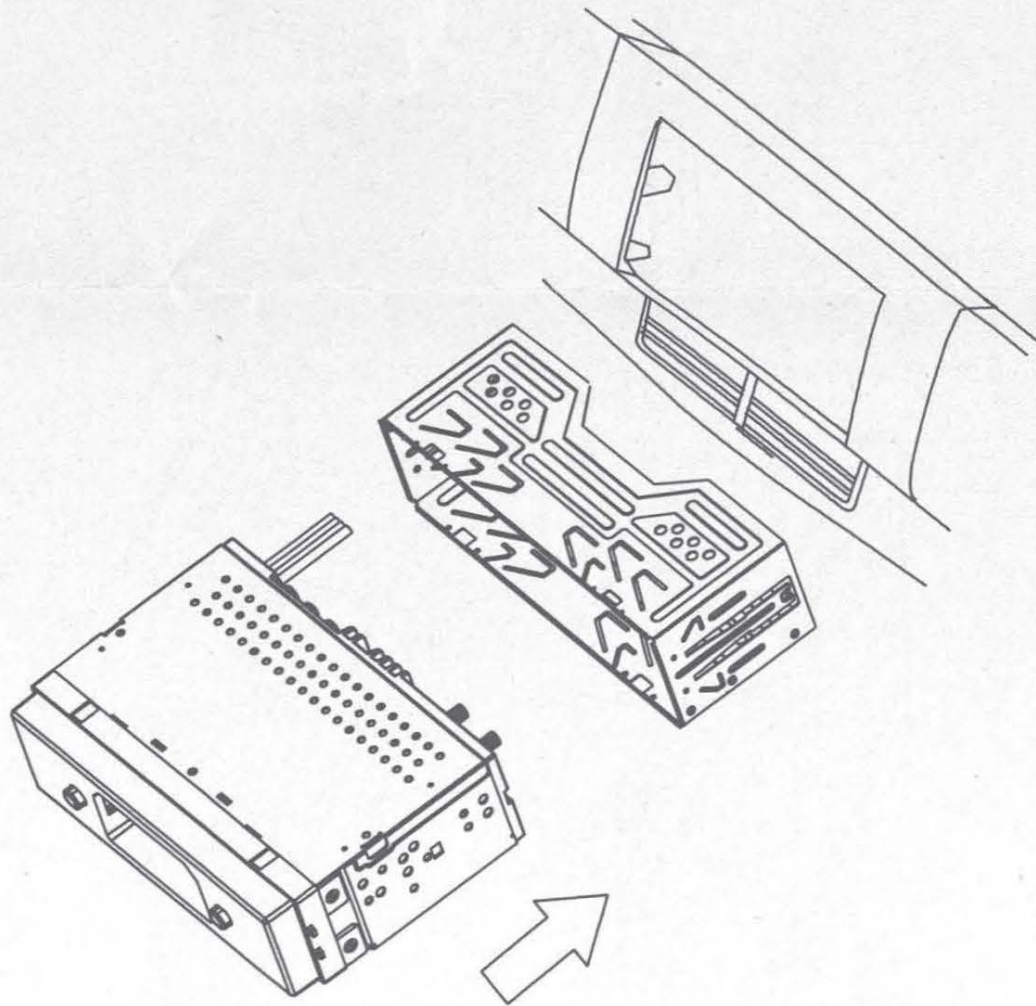

Step #1

Connecting the LCD to the Chassis

To connect the LCD to the unit, carefully push the LCD connector into the receiver's chassis until you hear a click as shown below.

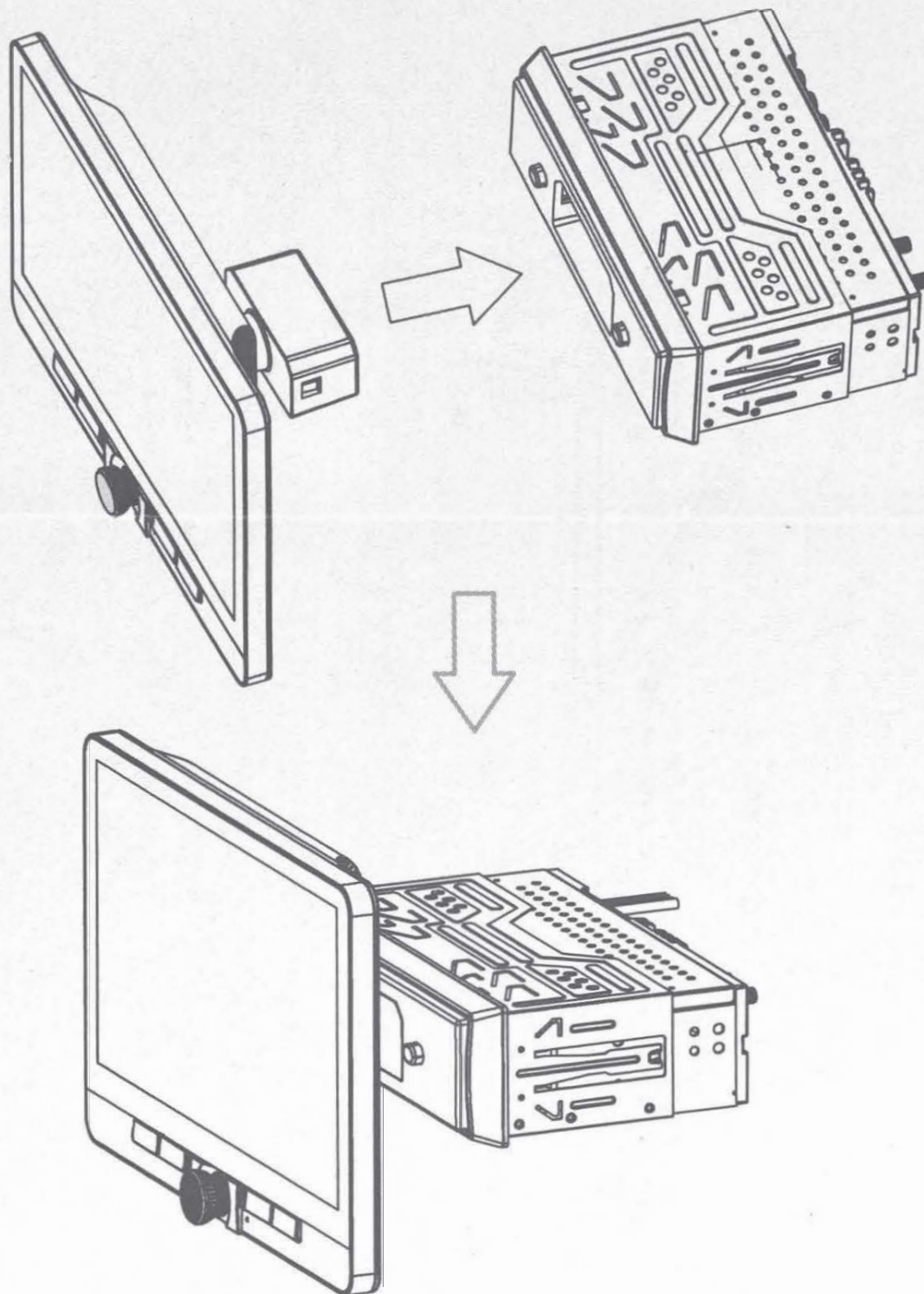

Step #2

Removing the LCD from the Chassis

1. Hold down the two release buttons

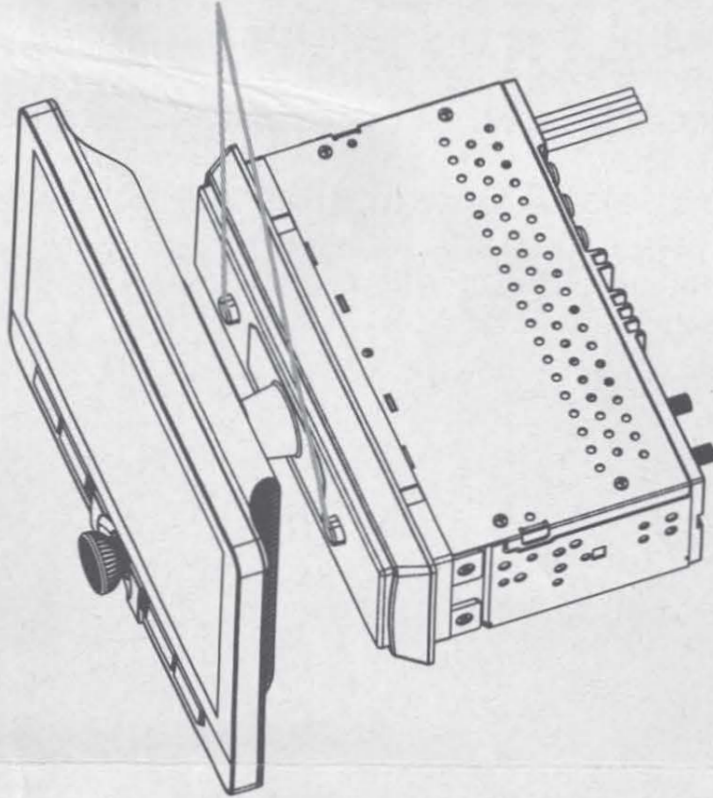

2. Gently pull the display panel forward

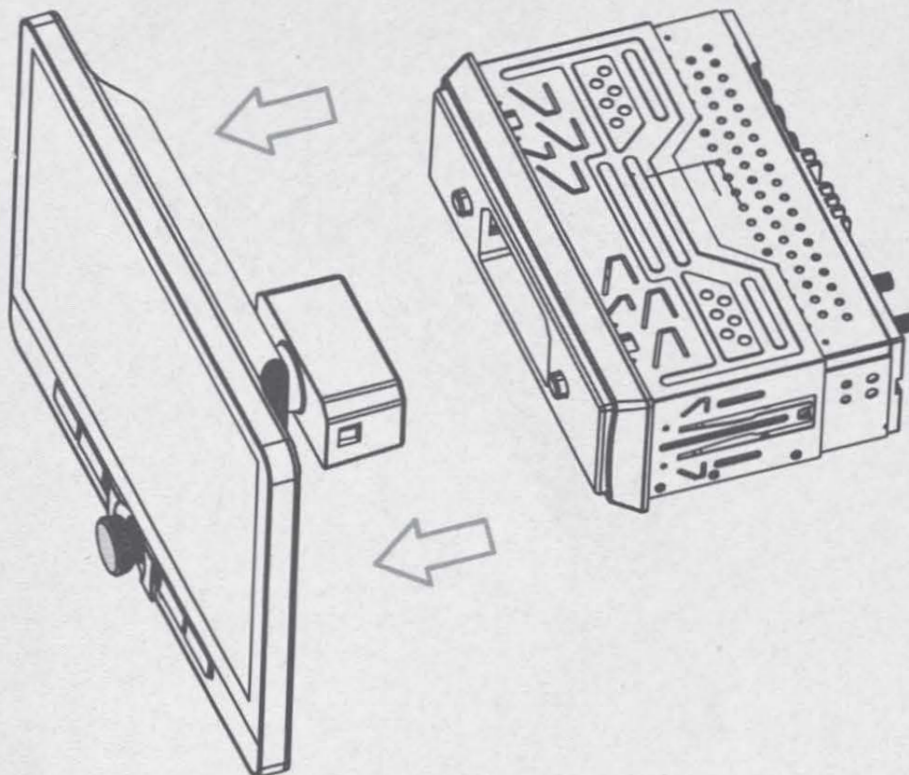

Step #3

Installing the 2-DIN Chassis Sleeve

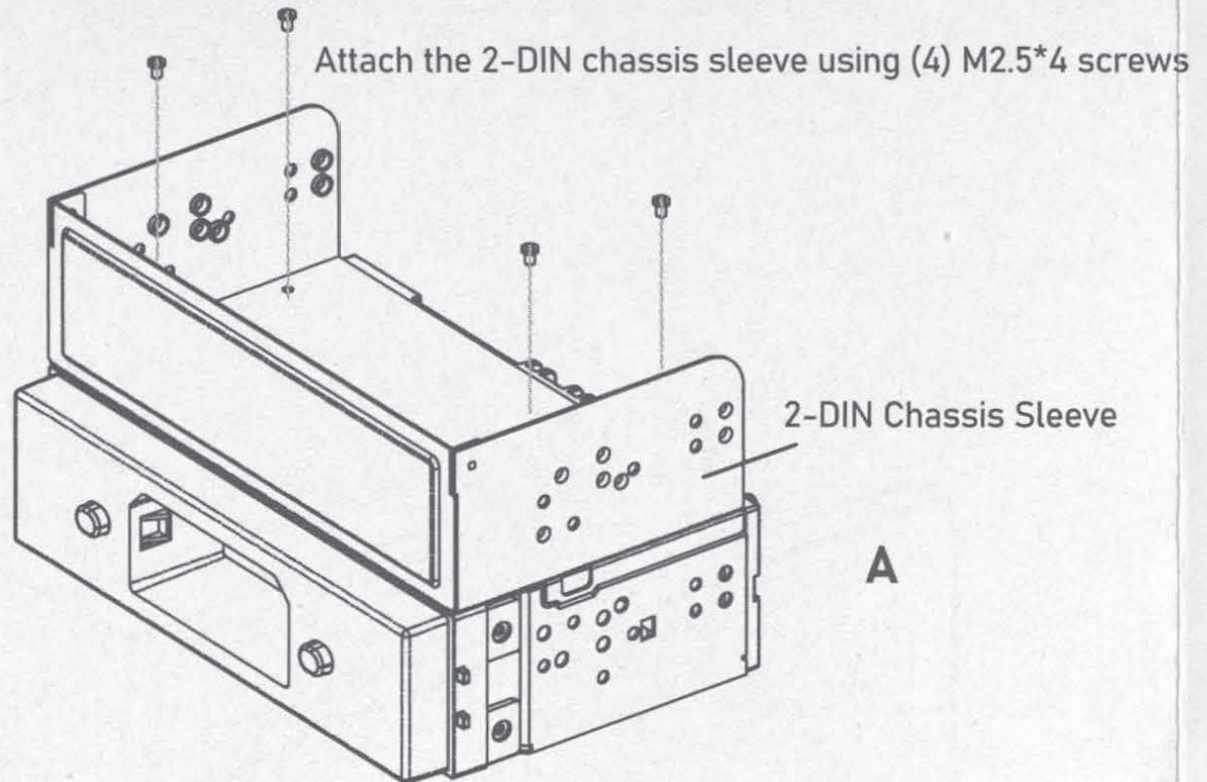

Install the 2-DIN mounting chassis sleeve to the top of the chassis (shown above) or to the bottom of the chassis (shown below).

OR

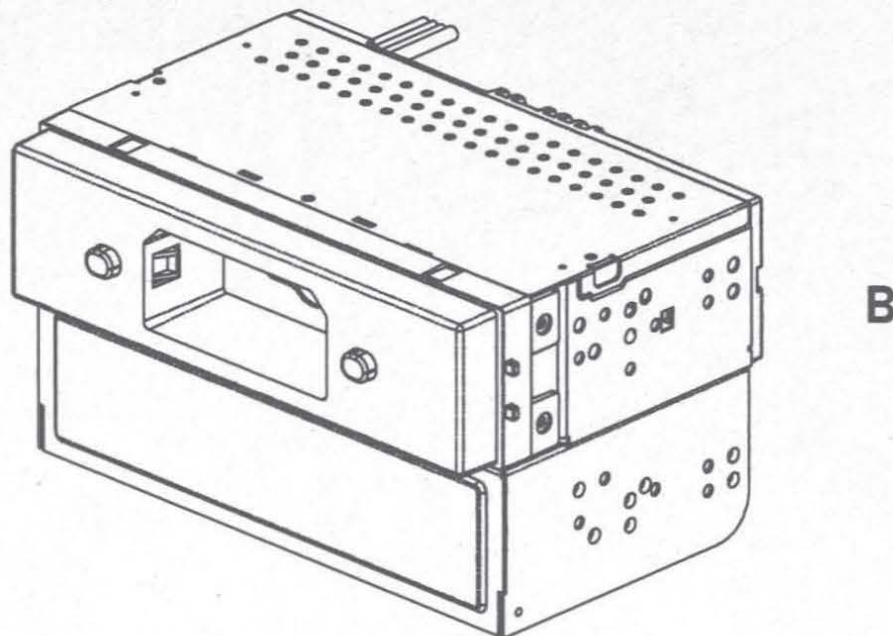

Install Mounting Side Brackets

Mounting brackets shown below or optional vehicle mounting kit are not included

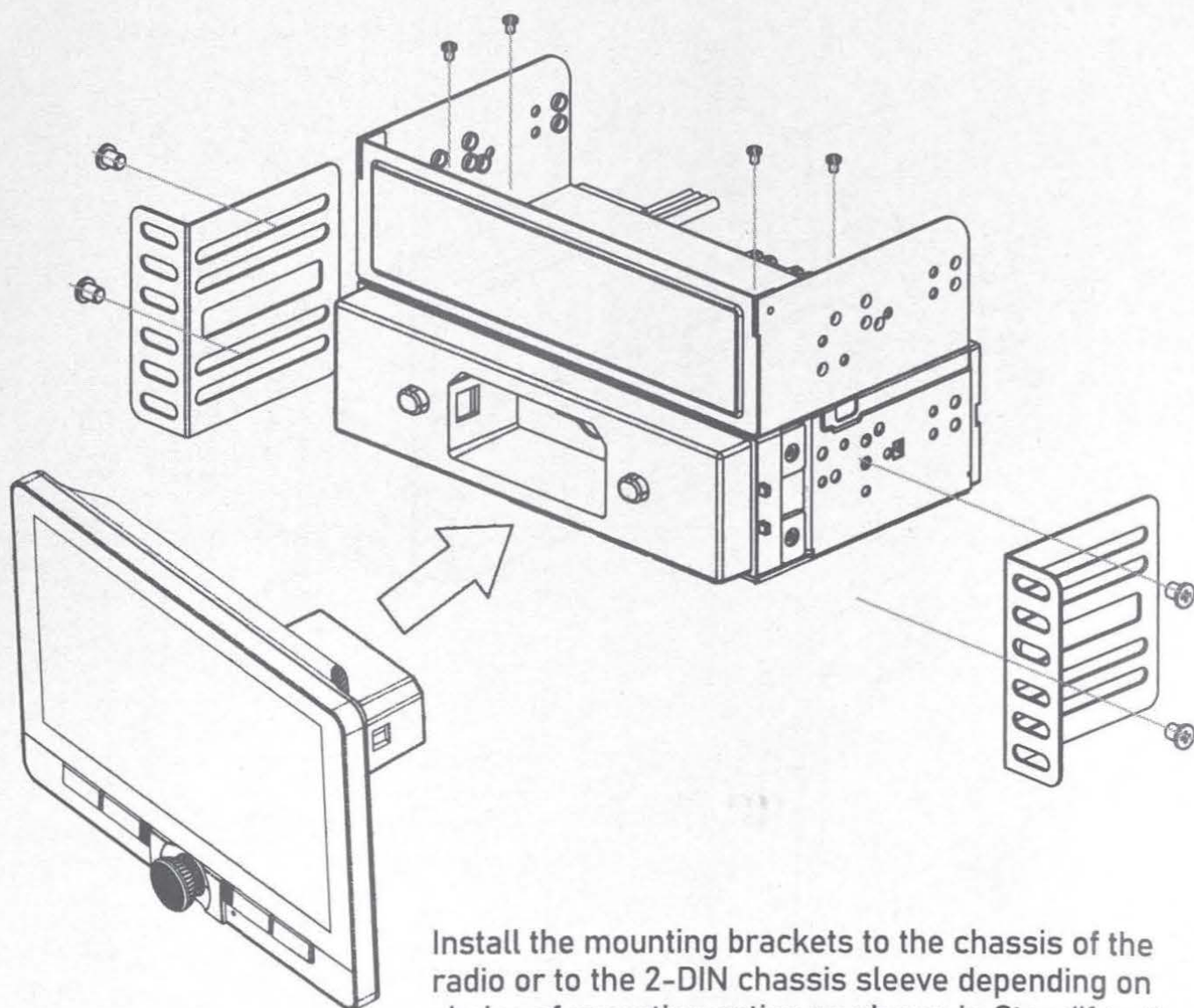

Install the mounting brackets to the chassis of the radio or to the 2-DIN chassis sleeve depending on choice of mounting option as shown in Step #1 to the left.

Installation Complete

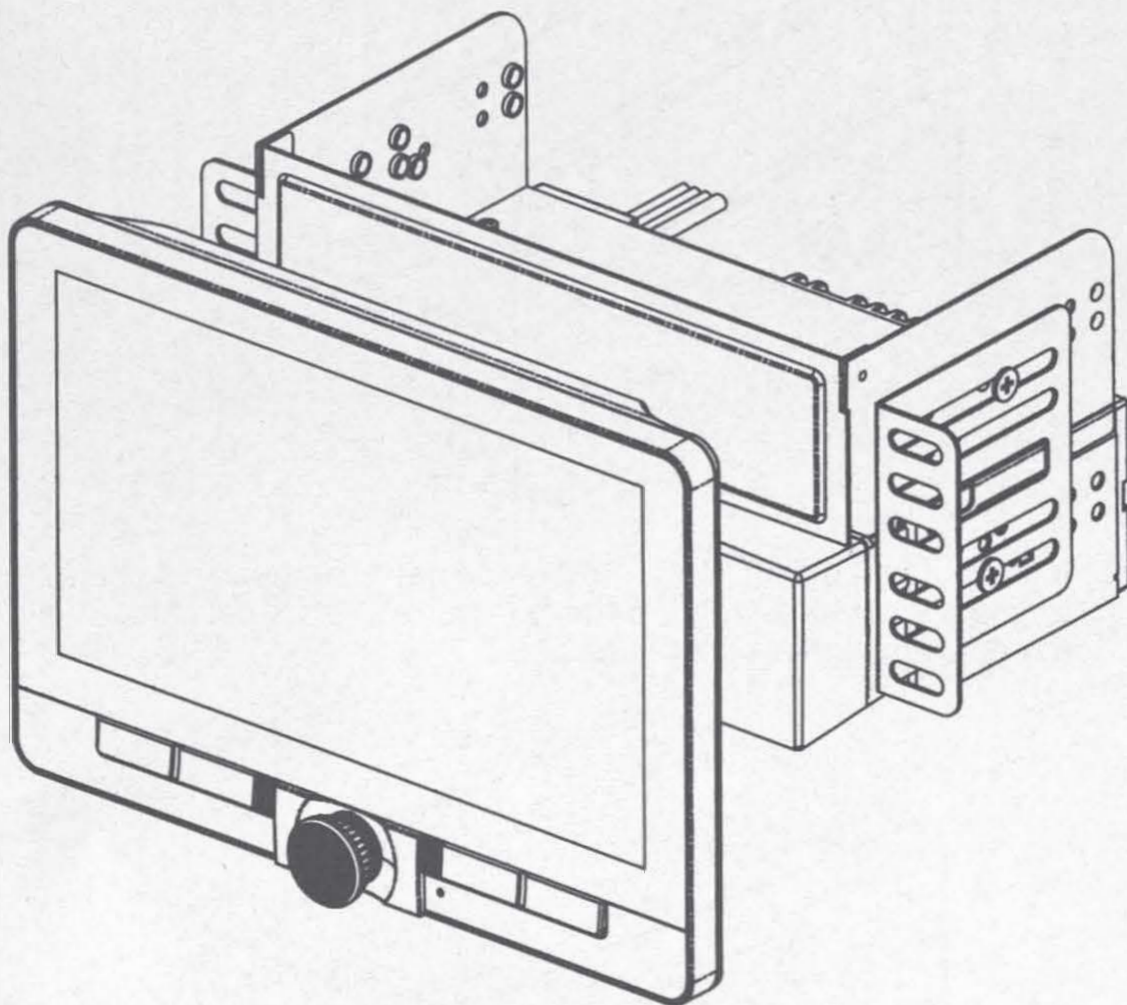

Register to Extend Your Warranty



Scan to register, or visit:

jensenmobile.com/registration

Please register within 60 days of purchase to extend your warranty.

Registration requires the retailer's name, model number, and date of purchase on your receipt.

Visit **www.jensenmobile.com** for owner's manuals and other product information.

If you need any assistance, please contact customer service at **cs@jensenmobile.com** or call **1-888-921-4088** M-F 9 am - 5 pm ET

Thank you for your purchase!

JENSEN[®]

www.JensenMobile.com

Follow us to keep up to date with new products and information!

Facebook

@JensenAudio

Instagram

@JensenAudio

X

@JensenAudio