



DETECT | CONNECT | PROTECT

Smart Life App

Installation Guide



Device Requirements

Android 4.1 or higher **iOS** 8.0 or higher

- 1 | Navigate to the app store on your mobile device.



- 2 | Download the Smart Life app.
- 3 | Once app is downloaded, open the app and select [Register](#).



- 4 | The app should automatically detect your country code. If not, please select manually select the code of your country of residence.

- 5 | Enter your email address.

- 6 | Enter the verification code that was sent to your email address and your desired password, then select [Confirm](#).

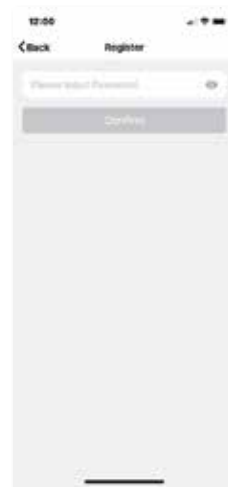

- 7 | You have now successfully created an account and you're now ready to start setting up your smart bulbs and features.

- 8 | Select the Plus (+) in the top right corner to add a device.

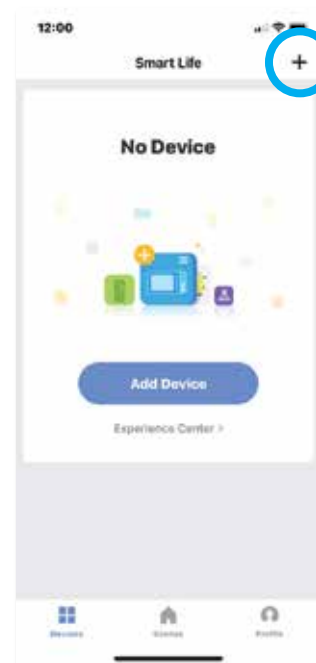

- 9 | Select [Device](#)

- SENTINEL or GUARDIAN - choose Video Surveillance then Smart Doorbell

- SENTRY or WATCHMAN - choose Video Surveillance then Smart Camera

- DEFENDER - choose Electrician then Garage Door Opener

- SMART PLUG - choose Electrician then Socket (WiFi)

- ALARM PRODUCTS - choose Security & Sensors then the appropriate device, ensuring that it's a Wi-Fi device



10 | To enter pairing mode, turn the device on. The Smart Device will begin blinking rapidly once in pairing mode.

11 | Connect to your desired Wi-Fi network, enter your password, then select **Confirm**

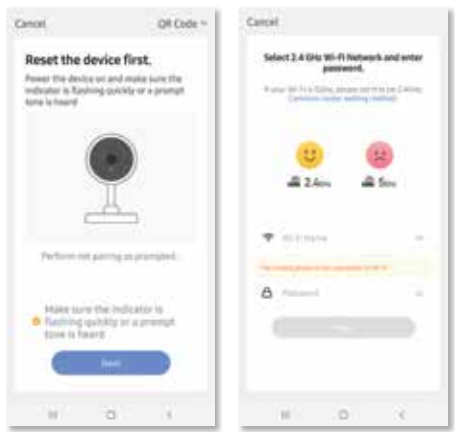

12 | Scan QR code with device, when you hear the beep press **"I heard the beep"**



13 | Once you select **Confirm** after entering your password, the app will start to pair the Smart Device.



Notice

If you get a message that says "Failed to Add" it means that the connect has failed. You may have to enter the Smart Device into pairing mode again, and repeat steps 10 through 13.

14 | Once your device successfully connects to the app, the below screen will pop up and you can change the name of your Smart Device.

Keep this simple to make it easy for your Alexa App or Google Home to understand which light you would like to control.

After naming your Smart Device, select **Done**.

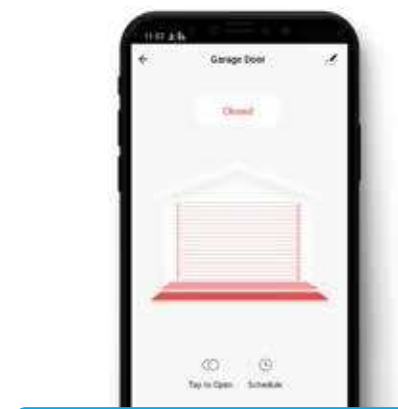
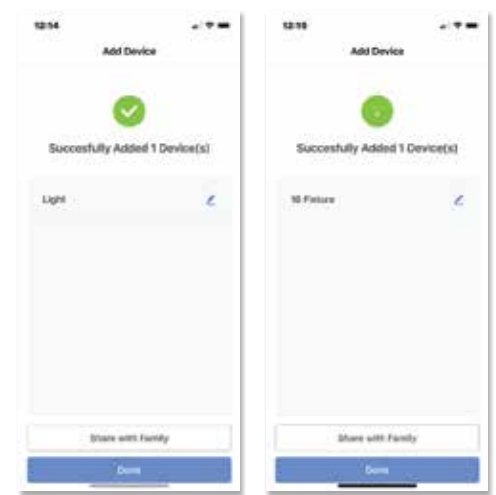

For more detailed instructions on the Smart Life App please visit www.toseesecurity.com.au and head to the resources page.

