

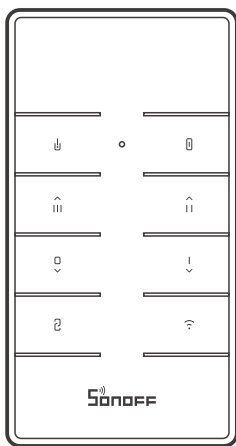

# RM433R2

User manual V1.0



## 433MHz Remote Controller

---

## Pull out the battery insulation sheet

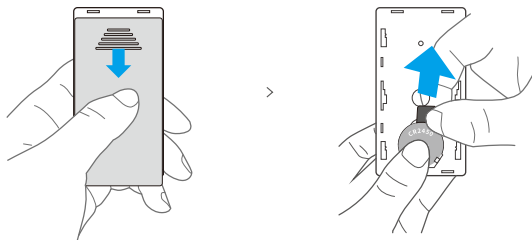

⚠ The device has the version with battery and without battery.

## Specifications

Model	RM433R2
RF	433MHz
Remote controller size	87x45x12mm
Remote controller base size	86x86x15mm (not included)
Power supply	3V button cell x 1 (Battery model: CR2450)
Material	PC V0

## Product Introduction



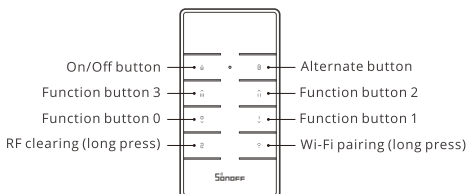





The RM433R2 applies to all SONOFF products with 433MHz frequency and other devices supporting the 433MHz communication protocol.











⚠ Buttons are created with different functions when pairing with different products.

# Buttons Instructions

## Example 1: iFan04 Wi-Fi Fan & Light Controller

Buttons	Functions
	On/Off (light)
	Mute
	Off (fan)
	Low speed
	Medium speed
	High speed
	Long press for 5s until the ceiling fan makes two sounds "Beep Beep" to clear the code. After clearing code is completed, if you need to use the product, please press any button within 5s after powering on again until the ceiling fan makes a sound "Beep", and pairing is successful.
	Long press for 5s until the fan makes two short and one long "Beep" sound to enter the quick pairing mode (Touch). Then you can add the device on eWeLink APP. In quick pairing mode, you can short press any button on the remote controller to exit this mode.

## Example 2: D1 Wi-Fi smart dimmer

Buttons	Functions
	On
	Off
	Short press for the low brightness, long press to turn down the brightness
	Short press for the medium brightness, long press to turn down the brightness
	Short press for the higher brightness, long press to turn up the brightness
	Short press for the high brightness, long press to turn up the brightness
	Long press for 5s until you hear "Beep Beep" and release, then the remote controller is cleared successfully. After clearing code is completed, if you need to use, short press any button within 5s after powering on again and you will hear "Beep", which indicates the remote controller is paired successfully.
	Long press for 5s until the connected light enters the breathing mode, which indicates the device enters quick pairing mode (Touch), then you can add the light on eWeLink APP. In quick pairing mode, you can short press any button on the remote controller to exit this mode.

# Works with SONOFF devices

- RFR2
- BASICRFR3
- 4CHPROR3
- SlampherR2
- RF BridgeR2
- D1 Wi-Fi smart dimmer
- TX series Wi-Fi smart switches
- iFan04 Wi-Fi Fan & Light Controller

## RM433R2-BASE

### Installation method 1:

Install the base on the wall with 3M adhesive tapes.

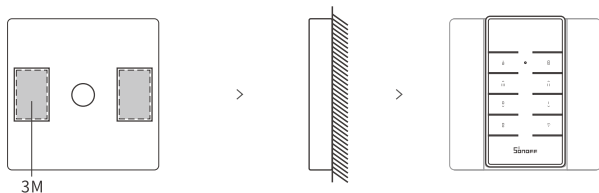

### Installation method 2:

Remove the two upper covers from both sides of the base to install with screws.

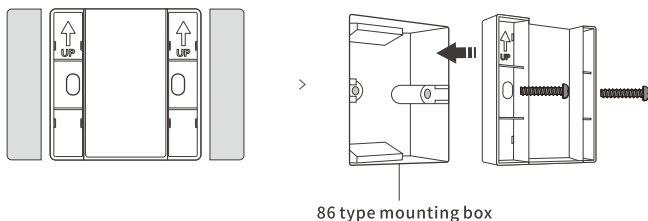

⚠ The base is not included into the package, please purchase it separately.