

**HYUNDAI**  
ELECTRONICS

**DC MOTOR CEILING FAN  
WITH REMOTE  
HY52DCMCFFA**

---

**USER MANUAL**

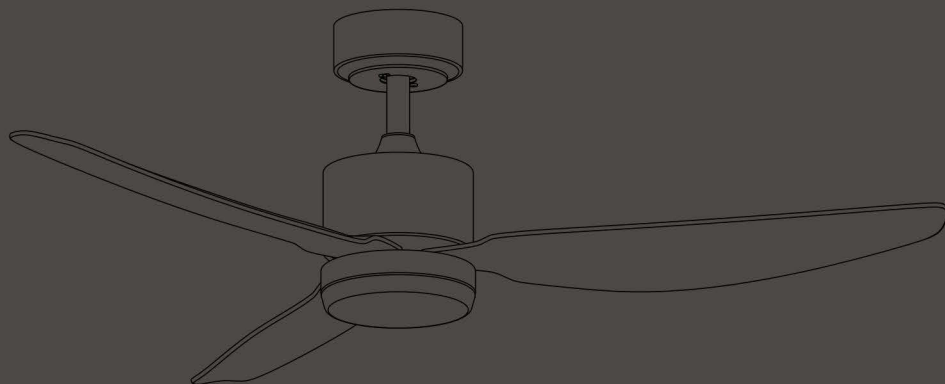

HY52DCMCFFA

Safety & Warnings	3
Components	6
Overview	6
Installation	7
Operation	17
Cleaning &Care	18
Specifications	18
Troubleshooting	19

## Safety & Warnings

**IMPORTANT:** For your safety, this product must be installed by a licensed electrical contractor.

- Make sure that the mains voltage matches the voltage stated on the rating label of the appliance.
- Check the power cord regularly for visible damage. If the cord is damaged, cease use immediately and contact help.Kogan.com for support, in order to avoid danger.

**WARNING:** Do not use the appliance if its cord, plug, or housing is damaged, or if it malfunctions or has been dropped or damaged in any way.

- Do not use the appliance in confined spaces with explosive or toxic vapours.
- The appliance is not intended to be used by children under the age of 8. It can be used by children over the age of 8, if they are given continuous supervision.
- This appliance is not intended to be used by persons with reduced physical, sensory, or mental capabilities, or lack of experience or knowledge, unless they have been given supervision or instruction concerning the use of the appliance in a safe way by a person responsible for their safety, and understand the hazards involved.
- Supervise young children to make sure that they do not play with the appliance. Close supervision is necessary when the appliance is being used by or near children.
- Keep the appliance and its cord out of reach of children under the age of 8.
- Do not try to repair the appliance yourself. Contact help.Kogan.com for support.  
Cleaning and maintenance must be carried out according to this user guide to make sure the appliance functions properly. Always turn off and unplug the appliance before cleaning.
- Cleaning and maintenance tasks must not be carried out by children.
- Make sure the fan is not placed near drapes, curtains, or any object that may be drawn into the fan.
- Never attach the fan to a power point, but to the ceiling itself.
- The minimum distance between the fan blades and the floor must be 2.1m. The minimum carrying capacity of the outlet box from which the fan is hung must be 45kg.

## HY52DCMCFFA

- Make sure you install an I-poles disconnection switch with a minimum distance of 3mm between poles in the supply wiring to the ceiling fan.
- Make sure the installation site will not allow the rotating fan blades to contact any objects and that there is a minimum distance of 150mm (6") from the blade tip to the wall or ceiling. Please note that the bigger this distance is, the more airflow the fan will produce.
- Switch off the power before connecting the fan.
- The electrical wiring must be in accordance with local regulations. The fan must be properly grounded to avoid the risk of electric shocks.
- Never mount the fan in a moist or wet room. Be careful when working near the rotating blades.
- This appliance must be installed in accordance with national electrical installation regulations.

**WARNING:** In order to ensure your children's safety, please keep all packaging (plastic bags, boxes, polystyrene etc.) out of their reach.

**IMPORTANT:** Shut off the main electric switch during installation or maintenance. (It is enough to switch off).

- Do not use outdoors. The product must be installed in a dry place, where it is not exposed to water or moisture.
- Do not connect the fan motor to a dimmer switch. This could result in malfunction or motor damage.  
It is not recommended that ceiling fans and gas appliances operate in the same room at the same time.
- The fan must be completely turned off and stopped before reversing the fan direction.
- This will prevent the fan motor and controller from getting damaged (if installed).
- Do not insert any object into the fan blades during operation. This will damage the blades and upset the balance of the fan causing the unit to wobble.
- After the fan is completely installed, make sure all base and fan blade fixings are secured and tightened to prevent any problems.
- Some of the connections may loosen due to the fan's natural movement. Check the support connections brackets and blade attachments twice a year to make sure they remain secured. If any are loose, tighten.
- Do not touch the appliance with wet hands or feet.

- Never expose the appliance to atmospheric conditions (rain, sun...)
- Do not use the device next to potentially explosive or inflammable liquids or gases.
- This product is intended for household use ONLY and not for commercial/industrial or outdoor use.
- Keep batteries out of the reach of children and animals; they could cause damage if swallowed. If they were swallowed, contact your doctor immediately.
- If any visible signs of damage, holes or deterioration are observed, avoid direct contact between batteries and skin or eyes. If batteries leak and come in contact with your eyes, immediately wash them with clean water and contact your doctor.

## HY52DCMCFFA

### COMPONENTS

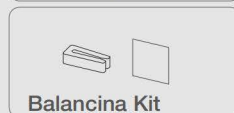
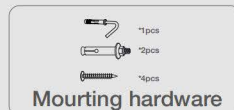
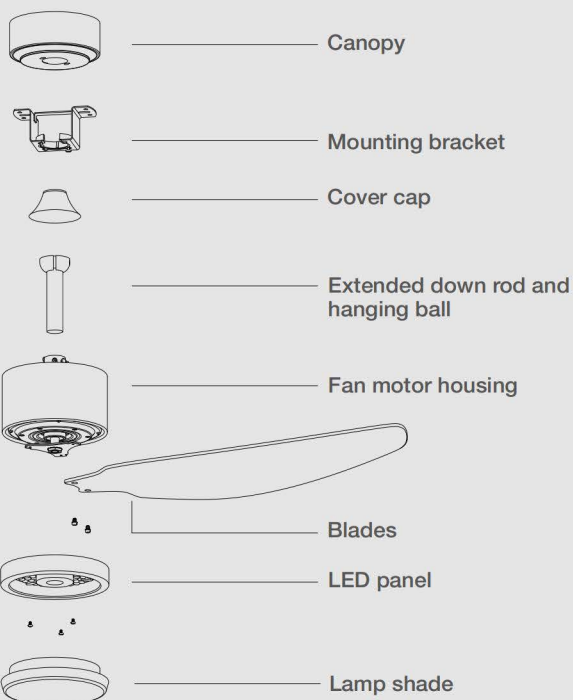

### Additional Tools and Material Required (Not Included):

- Phillips screwdriver •Flat blade screwdriver •Step ladder
- Wire cutter •Adjustable pliers or wrench •Electrical tape

## INSTALLATION

Unpack your ceiling fan carefully, remove all parts and components and lay on a cloth or soft surface to avoid damage. Do not lay the motor housing on its side; the housing may get damaged. Before commencing installation, check that all parts are included.

**WARNING:** All electrical tasks should only be undertaken after disconnection of electricity by removing fuses or turning off the circuit breaker to avoid the risk of electric shock.

### Installation of the Mounting Bracket

The hanger bracket must be screwed onto a firm, flat surface. The structure to which it is installed must be able to withstand ten times the static weight of the fan.

#### Wooden surface:

If installing the ceiling fan into a wooden ceiling or joist, attach the mounting bracket using the 4 supplied self-tapping screws. **Note:** Self-tapping screws are only suitable for wooden ceilings.

Ensure the mounting bracket is properly secured to prevent the fan from falling.

Loosen the two canopy screws from the mounting bracket.

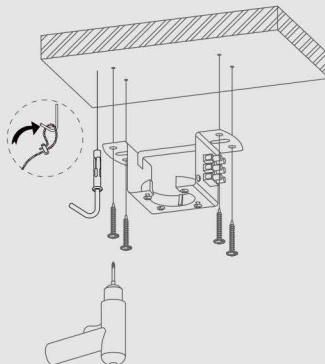

## HY52DCMCFFA

### Concrete surface:

If installing the ceiling fan into a concrete ceiling, drill up the four holes in the mounting bracket using an 8mm drill bit.

Attach the mounting bracket using the 4 M6 expansion bolts.

Once the mounting bracket is installed, drill a 10mm hole next to the bracket.

#### Note:

Be cautious when drilling the 10mm hole to avoid hitting an electrical wiring.

Install the expansion screw hook in the 10mm hole.

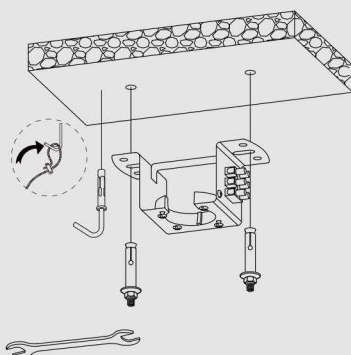

### Installation of the Down Rod and Hanger Ball

1. Unscrew the screw on the down rod's hanger ball, then loosen the hanger ball.
2. Remove the stop pin from inside the down rod and remove the hanger ball.
3. Remove the clevis pin and hairpin clip from the down rod.

**Note:** For installation in higher ceilings, you may require the extended down rod. Transfer the hanger ball onto it and make sure to move the earth wire from one to the other. Pass the electrical supply leads from the top of the motor all the way through the down rod until they come out the other end.

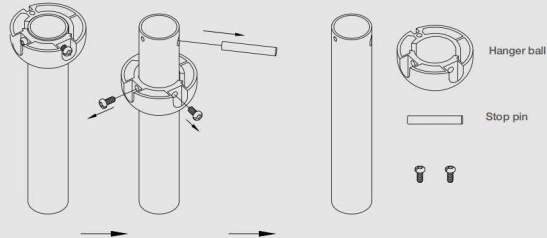

4. Insert the down rod into the motor housing's hole and align the holes on both sides with the holes on the down rod.

5. Carefully insert the clevis pin through the holes so that it passes through the down rod. Secure the clevis pin in place using the hairpin clip.

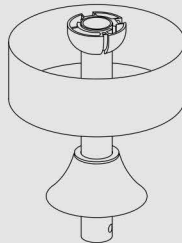

## HY52DCMCFFA

6. Tighten all the fasteners to ensure there is minimal rod and fan movement during operation.

**IMPORTANT:** Ensure all screws are fastened properly. Loose screws will cause the motor to oscillate excessively, damage to the fan or fatal injuries.

7. Once the above steps are all finished, install the hanger ball onto the down rod.

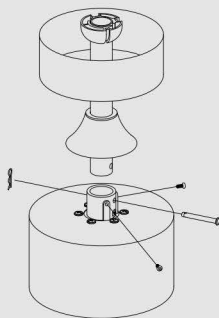

8. Insert the stop pin in the down rod and lift the hanger ball.

9. Tighten all the screws firmly so that all the components are properly secured.

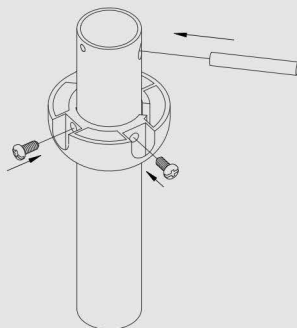

**Hanging the Fan to the Mounting Bracket**

1. Lift the fan up to the mounting bracket, insert the hanger ball into the mounting bracket through the opening and carefully let it rest.
2. Rotate the hanger ball and make sure that the tab located in the mounting bracket is aligned with the hanging ball's slot.
3. When aligned, the fan will automatically sit in its correct position. This will prevent rotation of the rod and fan when the unit is operating.

**Note:**

When installing the fan, ensure the fan ceiling cover doesn't press the antenna (or other wire). Doing so may cause damage to the wire or short-circuiting.

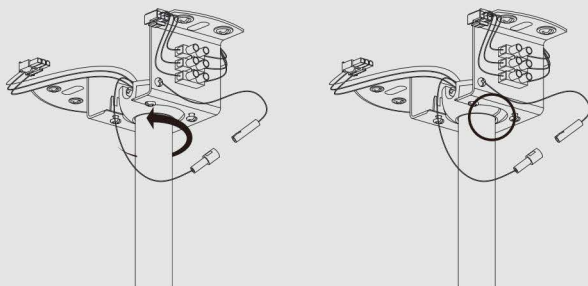
**Install the Canopy**

Push the canopy plate upward and tighten all screws.

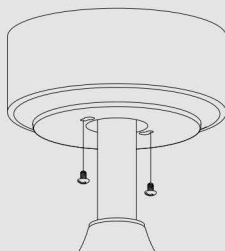

## HY52DCMCFFA

**Installing the LED Panel and Lamp Shade**

1. Before installing the fan blades, remove the positioning pieces and screws.

**Blade Assembly**

1. Remove the 2 screws and the lamp holder from the fixing panel.
2. Insert the blades through the motor housing's side slots and align them with the 3 holes.
3. Secure the blades using 2 blade screws and ensure that the blade screws are tightened properly. Do not over-tighten the screws as this can damage the blades.

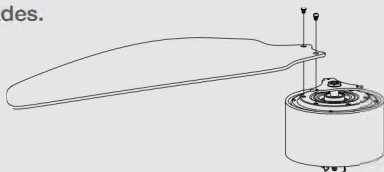
**Note:**

If installing more than one fan, be careful not to mix up the blades and screws as each model is designed with specific materials and parts.

4. Repeat this process for the remaining blades.
5. Align the LED panel screw holes with those on the motor and attach both parts by means of the screws provided.

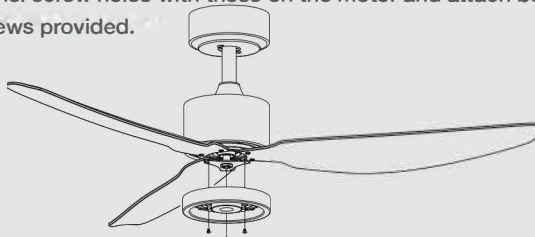

6. Carefully install the lamp shade into the main body and turn it clockwise to secure it in place.

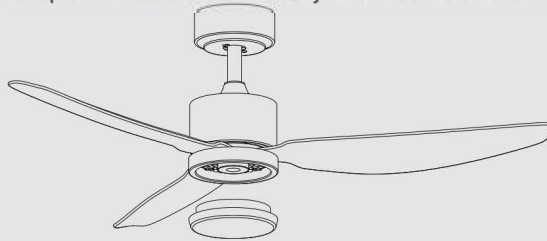

**WARNING:** Do not over-tighten when installing the glass shade.

#### Remote Receiver and Wiring Instruction

1. Place the receiver through the hanging bracket and connect the wires following the colour codes.
2. Connect the push connectors from the fan to the remote receiver.

#### Notes:

- Refer to the "Warning Diagram" section for more detailed information.
- Ensure the ground wire is connected correctly, otherwise it will cause the fan or light to malfunction.

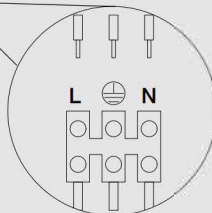
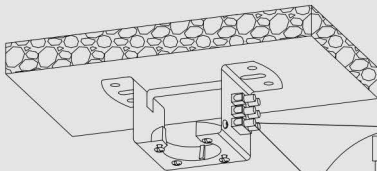

L — Live wire  
 N — Null line  
 E — Earth wire

HY52DCMCFFA

Wiring the Fan

1. Connect the 220-240V mains power (dwelling) to the terminal block on the mounting bracket.
2. Attach the receiver to the mounting bracket with the flat side facing upwards.
3. Connect the 3P connector from the hanger bracket into the AC POWER INPUT socket on the receiver.
4. Connect the 3-light connector from the fan motor assembly into the 3P LIGHT socket on the receiver.
5. Insert the 3P motor connector from the fan motor assembly into the 3P MOTOR socket on the receiver.

**WARNING:** To avoid potential electric shock, ensure the electricity is turned off at the main fuse box before wiring.

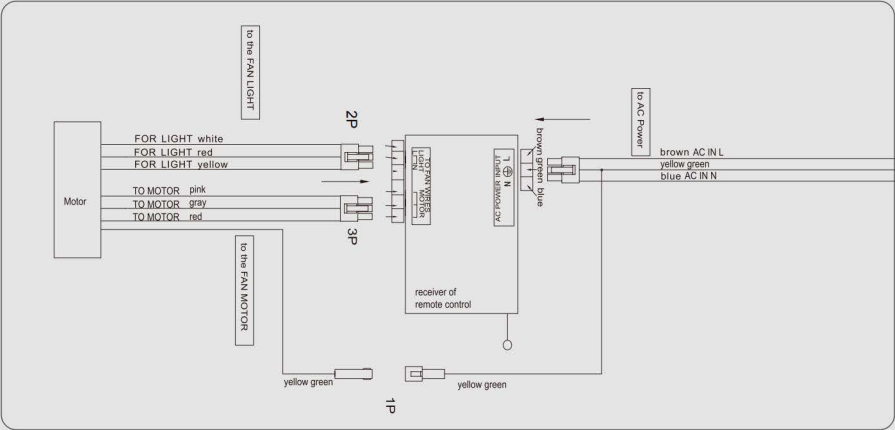

### Pairing the Remote to the Receiver

Turn "ON" the power supply and then within 30 seconds, on the remote press and hold the  Button for 5 seconds. The fan will emit a long "beep" sound indicating pairing is successful.

#### Note:

The fan will exit learning mode after the power supply has been on for longer than 30 seconds.

- If pairing fails, double-check that all wiring is correct, the batteries are installed with the correct polarity (+/-) and that the batteries are not flat.
- Check if there are any similar remote-controlled products nearby. Remote-controlled products using the same frequency will interfere with each other.
- Low battery will affect the sensitivity and signal reception accordingly of the remote control. The indicator flashes when the batteries are getting low and need to be replaced.
- If leaving unused for an extended period, remove the batteries from the remote control.

#### Notes:

- Adopt RF wireless digit emission technique, biunique controlled, coincident code rate is less than one millionth.
- If the remote control or receiver are damaged, contact **help.Kogan.com** support for maintenance.
- The remote control can be used from any angle of the receiver.
- With the memory function, the controller can save the status (light and direction) while the supply power is OFF and will resume after turning the power supply back ON.

## HY52DCMCFFA

### Balancing Kit

1. The Balancing Kit should only be used if there is an unacceptable amount of fan wobble after completing the previous installation steps.
2. Turn the fan on and set the speed control setting to a speed at which the wobble is the greatest.
3. Turn off the fan and allow it to come to a complete stop. Select one blade and place the balance clip on it, halfway between the blade holder and the blade tip on the trailing edge of the blade.
4. Turn the fan on. Note whether the wobble has increased or decreased. Turn the fan off, move the clip to another blade and retest. Repeat this procedure on all blades noting the blade on which the greatest improvement is achieved.
5. Move the clip back to the blade that showed the greatest improvement. Move the clip inward and outward on this blade and operate the fan to find the optimum position where the clip gives the greatest improvement.
6. Remove the clip and install balancing weight to the top of the blade along the centreline near the point where the clip was positioned.
7. If the fan wobble problem has not been corrected, you may wish to try to improve the balancing further by using the balancing clip and additional weights.

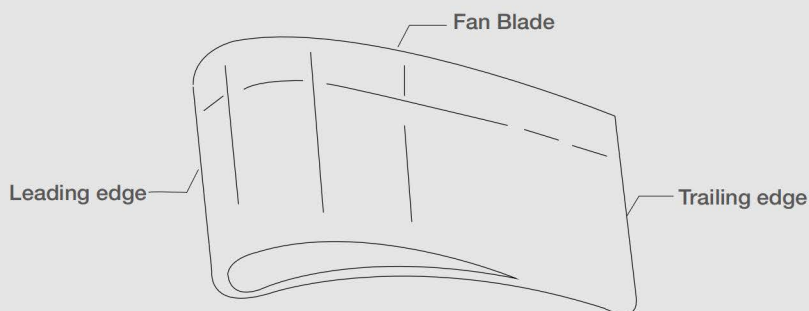

The image is for illustrative purposes only. Actual fan blades may differ in appearance.

## OPERATION

The direction switch on the fan body controls air flow:

- **Winter function:** Press the switch UP for the blades to move warm air near the ceiling around.
- **Summer function:** Press the switch DOWN for blades to create a breeze and impair circulation.

**WARNING:** Before using the direction switch, turn the fan off and make sure the fan has stopped rotating to prevent possible injuries and motor damage.

Change direction by pushing the switch up or down when the fan is off.

## Remote Control

Restore electrical to the outlet box by turning the electricity on at the main fuse box.

Remove the battery cover from the remote control, install the battery and reset the cover.

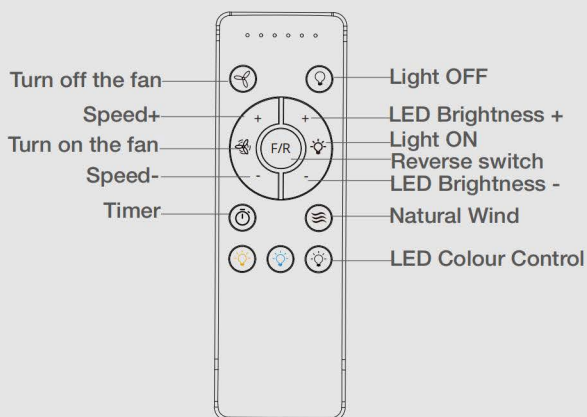

Use 2x1.5V AAA batteries to replace.

If not using for long periods of time, remove the battery to prevent damage to the remote control and store the remote control away from excess heat or humidity.

HY52DCMCFFA

CLEANING & CARE

Remote Control

1. To replace the remote-control batteries, press the battery cover and slide it towards the arrow direction.
2. This remote control requires 2 x 1.5V batteries.
3. Reassemble the battery compartment cover.
  - Always ensure the battery compartment cover is closed properly.
  - Do not leave the remote control in an area exposed to direct sunlight.
  - Do not try recharging the discharged batteries by heating them or with a battery charger.
  - Rechargeable batteries are always specified as so.
  - Do not throw batteries into fire; it could cause an explosion.

Fan

Always turn the fan off and disconnect it from the power supply and allow it to stop before cleaning it.

- Clean the outside surface with a soft damp cloth.
- Do not immerse the fan in water.
- Never use scouring pads, abrasive or chemical cleaners.
- Clean your fan periodically. Use only a cloth or brush.
- Metal finishes are finished with a lacquer to prevent tarnishing.
- Do not allow the inner parts of the fan to get wet (especially the circuit board). Doing so may cause an electric shock and damage the fan.
- While the product is not in use, make sure it is unplugged from the power supply. To store it, place it in its original box in a safe and dry location until it is used again. In case of fault or damage, do not try to repair the fan by yourself to avoid risk of fire or electric shock. Cease use immediately and contact **help.Kogan.com** for support.

SPECIFICATIONS

<b>Voltage</b>	220-240V
<b>Fan (Max)</b>	40W
<b>Lamp (Max.)</b>	20W

**TROUBLESHOOTING**

<b>Problem</b>	<b>Troubleshooting Steps</b>
The fan does not start up	<ul style="list-style-type: none"> <li>• Check all the fuses or circuit breakers.</li> <li>• Turn off the electrical power and check all wire connections.</li> </ul>
The fan emits noises	<ul style="list-style-type: none"> <li>• Always allow a few days "break in" time for any new fan at medium or high speed. Try to diagnose the exact location of the noise by listening carefully from several sides (blades, motor, light kit, etc.).</li> <li>• Ensure all screws in the fan assembly and light kit are tight and properly threaded. If not, back out and retighten. Tighten these screws at least once a year because they may loosen slowly over time and cause a clicking noise.</li> <li>• Make sure the light kit is securely fastened to the fan and all glass screws are finger tightened only. Do not tighten with pliers or a screwdriver.</li> <li>• Make sure the mounting bracket is installed snugly to the junction box.</li> <li>• Make sure the canopy is not touching the ceiling.</li> <li>• Ensure that the screws fastening the blade holders to the motor are tight and the lock washers provided for that purpose have been used.</li> </ul>
The fan does not produce much air	<ul style="list-style-type: none"> <li>• The fan may be running in reverse, so air is directed upward.</li> <li>• The room may contain items that obstruct the airflow.</li> <li>• The fan may be too small for the size of the room.</li> </ul>
Fan wobbling	<p>Note: A small amount of wobble is considered acceptable and should not be considered a defect.</p> <ul style="list-style-type: none"> <li>• Make sure the mounting bracket is fixed tightly to the ceiling with no movement at all. Tighten screws if necessary.</li> <li>• Make sure all screws holding the blades to the blade support and blade support to motor are tight.</li> <li>• Make sure the light kit and the glass screws are tight.</li> </ul>

For Inquiries, Contact: [kogan@kogan.com](mailto:kogan@kogan.com)

**Kogan.com Ltd**  
<https://help.kogan.com/>