

## How To Image Data From Jeep DMSM Camera Module (DCM)

This section provides instructions for imaging data from a Jeep Driver Monitoring System Module (DMSM) module (generically called the DCM module) on Jeep Cherokee or Wagoneer vehicles equipped with a *Hands-Free Active Driving Assist* system. The data cannot be imaged through the OBD connector but can be imaged by connecting directly to the module or connecting to a connector on the vehicle.

Click [here](#) for imaging instructions for the Grand Cherokee

Click [here](#) for imaging instructions for the Grand Wagoneer/Wagoneer

**IMPORTANT:** when connecting directly to the DCM module, you will need to use the vehicles driver camera in order to get the module to communicate in order to retrieve data. A camera can be purchased from a local Jeep dealer (MOPAR P/N: 04672802AC ) or it can be purchase from a similar vehicle at a wrecking yard.

### Grand Cherokee DCM Imaging:

The Grand Cherokee driver camera images can be retrieved from the DCM module directly or by connecting to a vehicle connector located behind the knee airbag below the steering column.

#### On Vehicle Connection:

1. Remove the cover below the steering column and the knee airbag ([see figure 1](#))
2. Unplug the 8 pin connector below the steering column ([see figure 2](#))
3. See table below figure for for connecting cable 851 to the vehicle
4. Plug in 12VDC power into the CDR 900 ([see figure 4](#))

#### Direct to Module Connection:

1. Remove the DMSM module which is located behind the center of the dash and mounted to the HVAC housing. Refer to vehicle's service manual for the removal of the DMSM module
2. Connect cable 851 as per the figure 4 and table to make the connections to the DMSM module to the CDR 900
3. Plug in 12VDC power into the CDR 900 ([see figure 4](#))

**Figure 1:** Grand Cherokee:Knee Airbag below the steering column

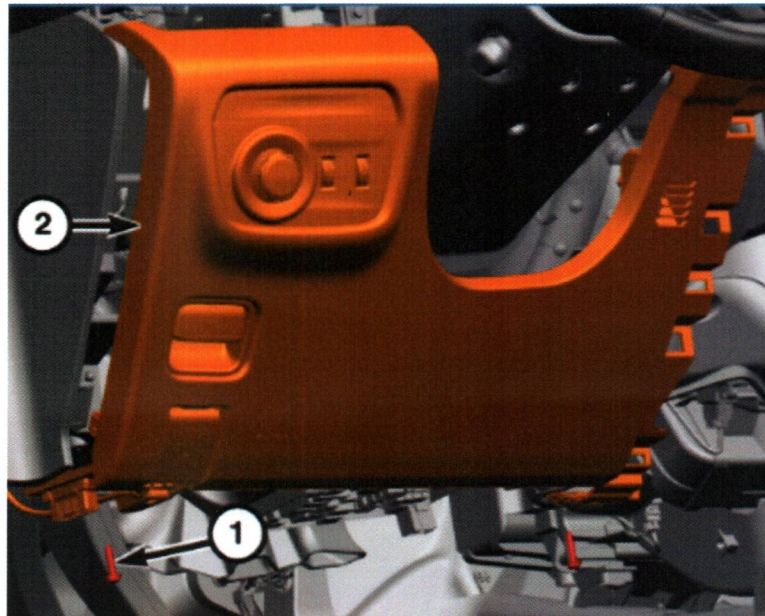

**Figure 2:** Grand Cherokee: connector for imaging DCM

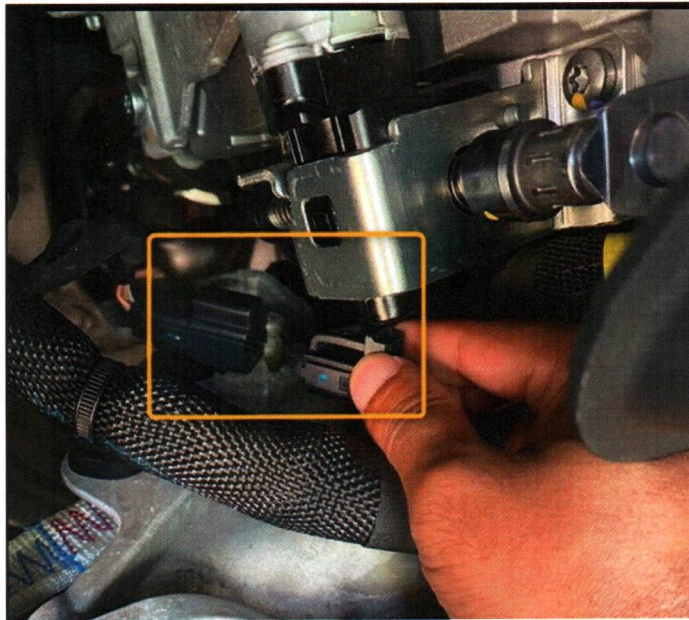

#### Grand Wagoneer/Wagoneer DCM Imaging:

##### **Direct to Module Connection:**

1. Remove the DMSM module which is located below the steering column behind the access panel ([see Figure 3](#)). Refer to vehicle's service manual for the removal of the DMSM module
2. Connect cable 851 as per the figure 4 and table to make the connections to the DMSM module to the CDR 900
3. Plug in 12VDC power into the CDR 900 ([see figure 4](#))

Figure 3: Wagoneer location of DMSM module

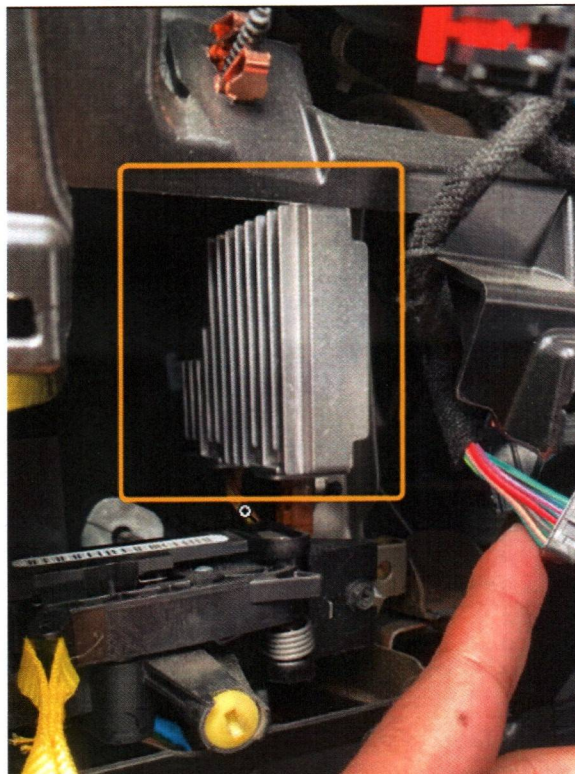
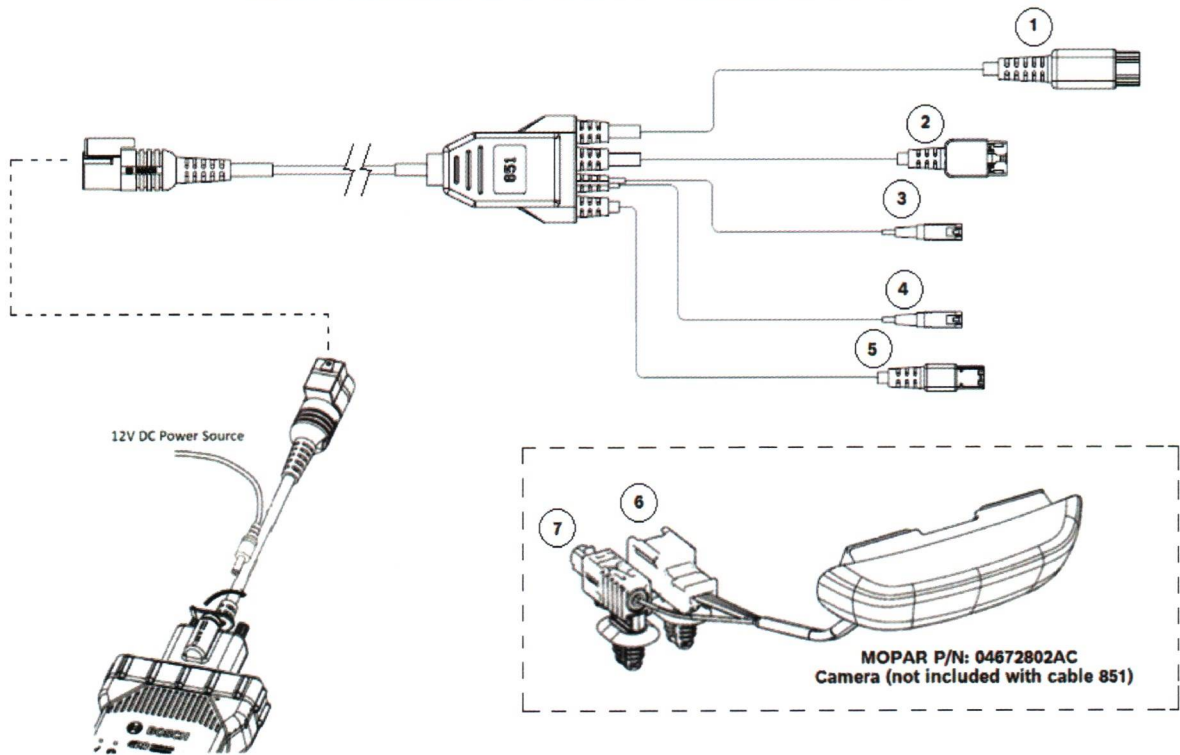



Figure 4: Cable ID 851, CDR Driver Cam (P/N 1699200984) and camera



Connector (figure 4)	Direct to Module	On Vehicle	Description
1		x	connect to the 8 pin connector on vehicle (see figure 2)
2	x		12 pin connector connects to the DMSM module
3	x		Coax cable, connects to the DMSM module
4	x		Coax cable, connects to the camera (connects to 7)
5	x		4 pin connector connects to camera (connects to 6)
6	x		Camera 4 pin connector (connects to 5)
7	x		Camera coax cable (connects to 4)

**IMPORTANT:** the following instructions are provided only for the purpose of understanding how to use the CDR Tool to image data from the OEMs vehicle. These instructions are not intended to replace other important processes, procedures and safety guidelines involved in investigating and imaging data safely from a vehicle. It is the user's responsibility to proceed with caution, follow industry accepted recommended practices during the imaging process and refer to the vehicle service manual when working on or dismantling a vehicle.