



# DUAL LENS LINKAGE CAMERA USER MANUAL

# Claim Your Lifetime Warranty



Thank you for choosing Ctronics products.

We are committed to providing the best service to all our customer.  
If anything has happened to your product, please contact us for a lifetime warranty.



 Online support



 ctronics



 ctronics



 ctronics support

E-mail: [support@ctronics.com](mailto:support@ctronics.com)

Website: [www.ctronics.com](http://www.ctronics.com)

Service Hotline: +1 833 880 2117(US)

Working Hours: Mon-Fri 9am-12am, 1pm-6pm(EST)

Kind reminder: Phone service only support **English**. For other languages, please send us email or chat to us online.

## Table of Contents

1. Product overview	01
2. Setting	01
3. Downloading and installation of APP on a mobile phone	01
4. Connection to a WiFi network	03
5. APP overview	09
6. Use HIP2P client software to set up the camera	18
7. FAQ	27

## 1. Product overview

Ctronics CTIPC security cameras are indoor or outdoor cameras of different shapes and functions. They support both Android and iOS smart phones, and Windows PC and Mac. User can install multiple Ctronics CTIPC security cameras on single equipment.

## 2. Setting

After power-on, the camera will begin to work. It can be used as an independent video recorder. It is suggested to connect the System to your mobile device or PC for easy access to it.

## 3. Downloading and installation of APP on a mobile phone

Please search for the app "Ctronics pro" in the App Store or Google Play, download and install it on your smartphone.

**Note:** A prompt reading "Grand mobile phone use permissions for APP?" will appear in connection to the camera. Please Choose "Yes" to enable all functions of the APP.



Android



ios

### 3.1 Registration of login ID

A personal APP account can protect your privacy security. Only you can view it.

① Open the APP and choose “Register” to enter the registration interface (Fig. 1).

② To register, enter your email and password. Once confirmed, click “Register” to complete setup. (Fig.2)

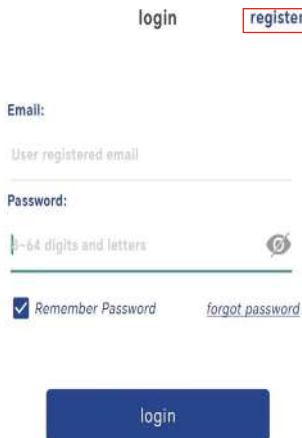

The login interface features a header with 'login' and 'register' tabs, where 'register' is highlighted with a red border. Below the tabs is a left-pointing arrow. The form includes an 'Email:' field with the placeholder 'User registered email', a 'Password:' field with the placeholder '8-64 digits and letters' and a toggle icon, a checked 'Remember Password' checkbox, and a 'forgot password' link. At the bottom is a blue 'login' button.

Fig. 1

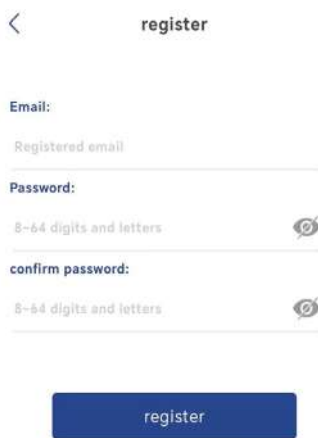

The registration interface features a header with 'login' and 'register' tabs, where 'register' is selected. Below the tabs is a right-pointing arrow. The form includes an 'Email:' field with the placeholder 'Registered email', a 'Password:' field with the placeholder '8-64 digits and letters' and a toggle icon, a 'confirm password:' field with the placeholder '8-64 digits and letters' and a toggle icon, and a blue 'register' button at the bottom.

Fig. 2

## 4. Connection to a WiFi network

### Before Using:

1. If using sd card Before power-on, please insert the Micro- sD card (2-128GB). If the Micro - SD card is inserted after power-on, detection may fail and the product will need to be powered on again.
2. In WiFi connection, make the product and your mobilephone 1ft to 3ft (30cm to 100cm) from the router.
3. Before adding the camera, please turn on the Bluetooth permission and positioning permission of the APP, then turn on the Bluetooth of the phone and start preparing to connect the camera.  
(Note: Failure to open the APP will cause the camera connection to fail).

### 4.1 Method A: Bluetooth Connection of Ctronics IP Camera (Not for a little of old models)

You can scan the QR code below or visit the link to watch the added video



<https://youtu.be/Rz6R0dlo0jo>

1. Connect the camera to a proper power supply and put it in a place close to your mobile device and router.
2. After power-on and self-check, long press “Reset” for 8s and release it upon a prompt tone that suggests successful reset.  
(**Note:** After completing this step, you need to wait for 1 minute before proceeding to the next step)

3. Enter "Ctronics pro" APP, click "+" button in the upper right corner(Fig.3), Turn on the Bluetooth function according to the prompts(Fig.4).

4. APP will automatically search for cameras that support Bluetooth, select your camera ' UID info to add(Fig.5).

5. Select available WiFi and enter the WiFi password to finish the addition.(Fig.6、 7)

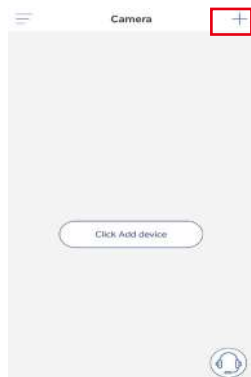

Fig.3

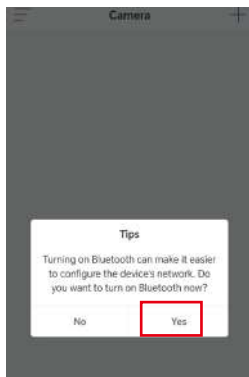

Fig.4



Fig.5

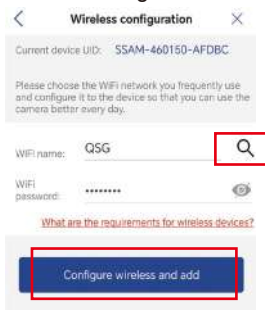

Fig.6



Fig.7

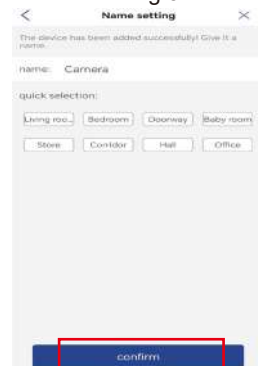
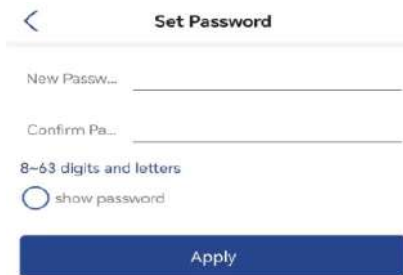
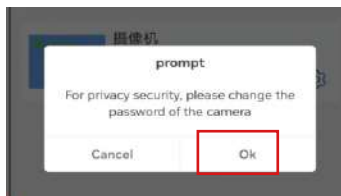

Fig.8

## Camera Password Setup

The camera default password is “admin”. To enhance security, after the initial setup, you will be prompted to change the password when you first access the camera. Follow the on-screen instructions to create a new password with at least 8 characters, including both letters and numbers. Make sure to store the new password safely. If you encounter a “password error”, reset the camera and try the setup process again.



## Delete Camera

swipe Left on the device in the list, click the delete button to remove the camera.

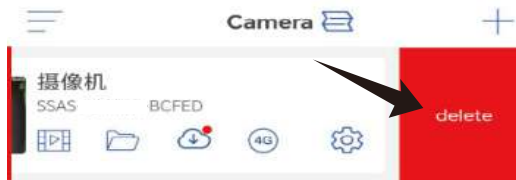



## 4.2 Method B: Configure the network through the personal hotspot on your mobile phone.

You can scan the QR code below or visit the link to watch the added video



<https://youtu.be/9VKOEBBcEMM>

### Step 1: Preparations

1. Connect the camera to a proper power supply and put it in a place close to your mobile device and router.
2. After power-on and self-check, long press “Reset” for 8s and release it upon a prompt tone that suggests successful reset.  
(**Note:** After completing this step, you need to wait for 1 minute before proceeding to the next step)
3. Enter the WLAN setting interface of your mobile device, find the WiFi network of your family in the WiFi network list and connect to it.

### Step 2: Connect the camera to your WiFi network.

1. Open mobile application “Ctronics pro” on your mobile phone, click symbol “+” (Fig.9) and choose “Camera (WiFi/Wired)” (Fig.10) to enter the device adding interface (Fig.11).

2. Click “New device” and check whether the camera has been powered on (Fig12). If it has, click “Power is on. Next step” to enter the network cable connection confirmation interface. If the network cable is not connected, click “Not connected to the network cable” (Fig13) to choose the network configuration interface.

3. Choose “ Not connected to the network cable ” as the adding way (Fig13) and click “Go add” to scan the QR code on the camera (Fig14). After successful scanning, there will be automatic connection to the camera hotspot. Click “CONNECT” (Fig.15 ) to enter the wireless configuration interface.

4. Choose the WiFi network of your family, enter its password, confirm it and click “Configure wireless and add” (Fig.16 ) for configuration. The camera will connect to the WiFi network automatically. Click “confirm” to add the camera (Fig.17 ).

(\***Note:** Make sure the password of the WiFi network of your family contains 31 characters at most and no special character like “?! ” or “&,. ”. It is suggested to make the password contain both digits and letters.)

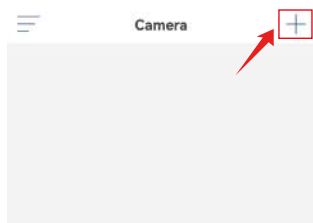

Fig.9

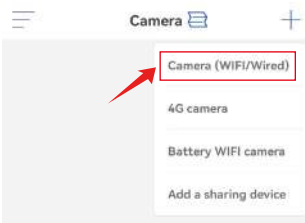

Fig.10



Fig.11

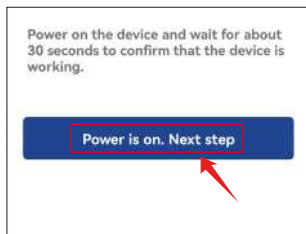

Fig.12

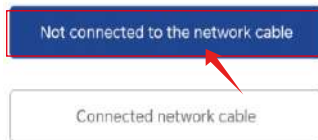

Fig.13



Fig.14

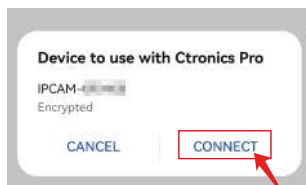

Fig.15



Fig.16

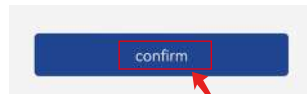

Fig.17

## 5. APP overview

### Contact Us

If you have any questions, please click the "customer service" icon in APP to enter the device page, select the device you need to give feedback and chat with online customer service. If the customer service is offline, please leave messages, and we will respond within 24 hours. If there is no reply after 24 hours, please contact: [support@ctronics.com](mailto:support@ctronics.com).

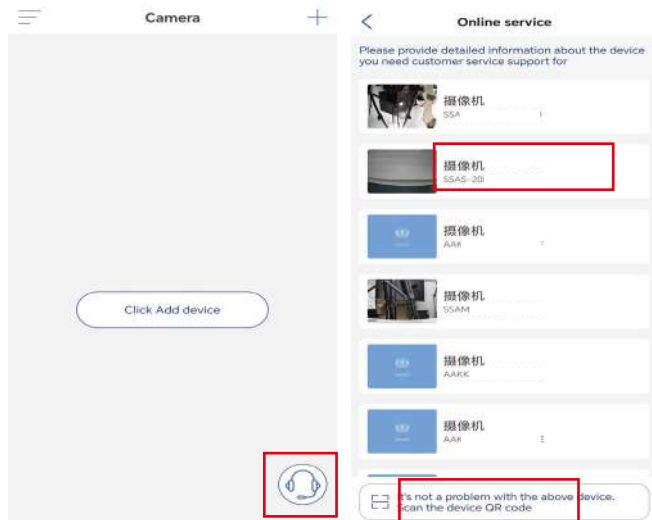

Fig.18

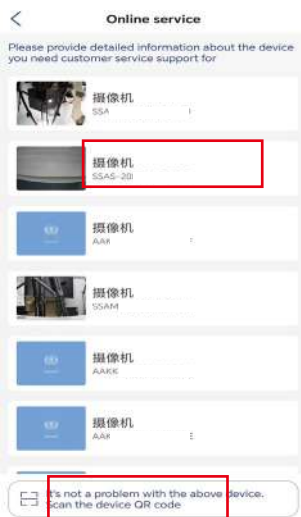

Fig.19

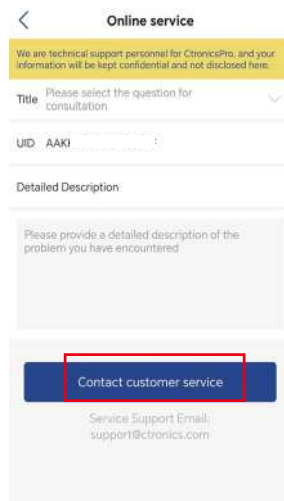

Fig.20

On the main interface of the APP, user can view the videos saved in the MicroSD card of the mobile device, and the local screenshots and videos on the camera, visit the camera and set parameters (Fig.21).

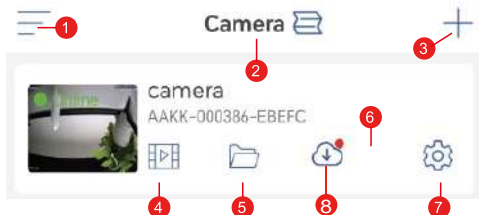

Fig.21

1. **Sidebar:** It is for viewing your account information and the local files and entering the store to view and purchase products. For any question about the product, please click the online customer service sign to contact us.
  2. **Four-screen setting:** In the four-screen setting interface, click “Add four-screen group”. Enter the group name and choose the cameras to add. Click “OK” to view the real-time images of the four cameras at the same time.
  3. **Add camera:** Click “+” to choose the device to connect according to model of the camera.
  4. **Playback of videos in MicroSD card:** Click the icon to view the videos and files under “Time playback”, “File playback” and “Image playback”.
  - Time playback:** Click it to choose from “All Videos” and “Alarm Videos”. After that, choose the wanted date and time to view the corresponding videos.
- (Fig.22 )

**File playback:** Click it to search the video of a time accurately, play it and download it to your mobile phone. (Fig.23)

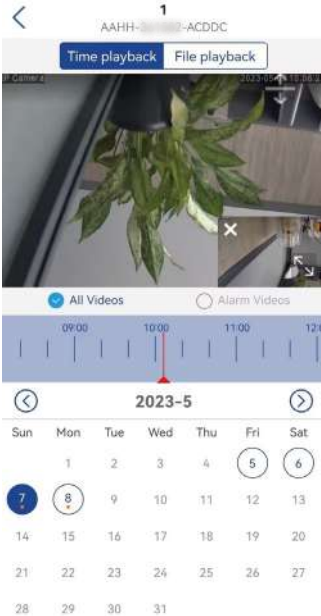

Fig.22



Fig.23

**5. Local files:** After the snapshot and video buttons on the real-time image interface are clicked, the manually snapshotted images and videos will be saved on this interface and viewed and downloaded to the photo albums in your mobile phone.

6. **Camera viewing:** Click the camera image to enter the real-time monitoring interface (Fig.24).

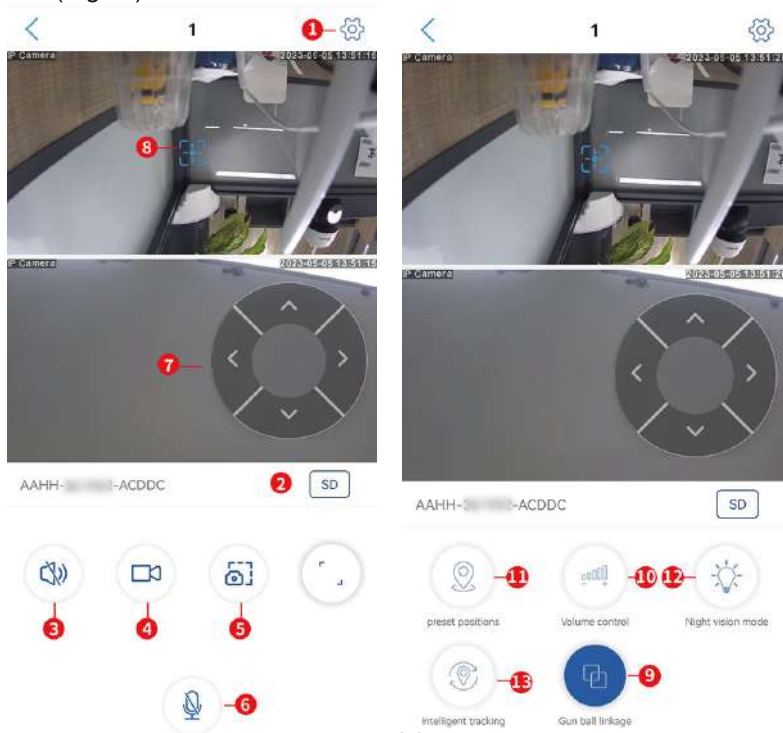

Fig.24

(1) **Setting:** For entering the camera's parameter setting interface to adjust the parameters

(2) **Image quality mode:** For choosing between “HD” and “SD” for the previewed images

- (3) **Sound monitoring:** For monitoring the sounds close to the camera
- (4) **Manual recording:** For recording the current video and save it as a local file on the APP
- (5) **Screen image saving:** For getting a screenshot of the current screen image and saving it as a local image on the APP
- (6) **Voice intercom:** For voice intercoms (by long pressing this icon)
- (7) **PTZ operation button:** For operating the PTZ for upward, downward, leftward and rightward rotation through the four directional buttons
- (8) **View Linkage Screen :** When you move this icon, the lens of the dome camera will quickly move to this position, allowing you to view the detailed picture of this position.
- (9) **Dual Lens Linkage :** After enabling this function, when the main screen of the bullet camera detects a moving object, the dome camera will immediately turn to track until the moving object leaves.
- (10) **Volume control:** For setting the camera's input volume and output volume
- (11) **Preset position:** Move the camera to a position, enter "1" and click "Set". This position will be recorded as position "1". Move the camera to the second position, enter "2" and click "Set". This position will be recorded as position "2". Set any other needed position by repeating the steps above. When it is necessary to move the camera to a preset position, just enter the corresponding number and click "Call". The camera will then move to the preset position automatically.
- (12) **Night vision mode:**
  - Infrared light mode:** For enabling the infrared light for taking black-and-white pictures
  - Full-color mode:** For turning on the white-light light to get full-color screen images



**Intelligent mode:** When no human is detected, the infrared light will be turned on to take black-and-white pictures; when any human has been detected, the white-light light will be turned on to take color pictures. If the camera has no longer been triggered by any human, the pictures will become black-and-white ones again 30s later.

**(13)Intelligent tracking:** The PTZ rotates to track the detected any motion or human-shaped object detected till its disappearance. The camera will then back to its original position automatically.

**7. Camera setting:** For entering the camera's setting interface (Fig.25)

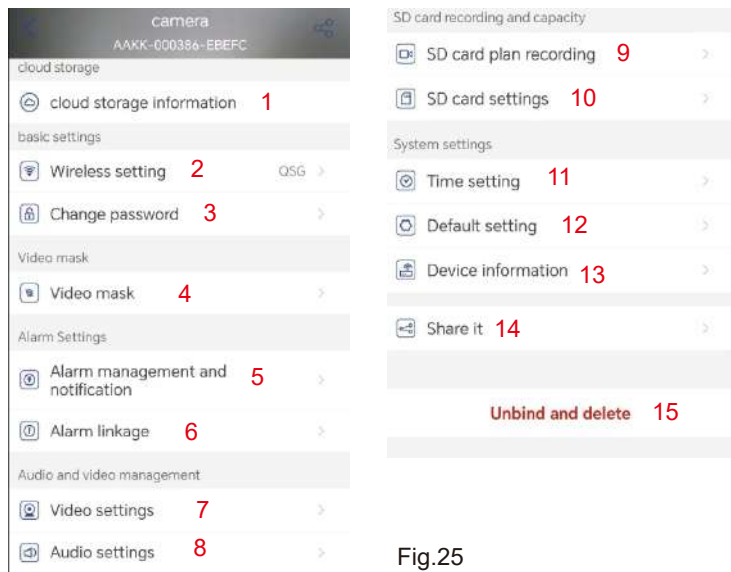

Fig.25

(1) **Cloud Service** : Subscribe to the camera's cloud service and view cloud video recordings. (Some cameras do not support this feature)

(2) **Wireless setting**

You can click “Acquire wireless network cable close to device” to search the WiFi network in your family and enter its password to connect to it.

(3) **Change password**

The default password is “admin”. After connection to the WiFi network, you’d better change the default password to protect the camera.

(4) **Video Occlusion Function**: The camera supports setting specific areas to be masked in the footage to protect user privacy.

(5) **Alarm management and notification**

① **Alarm push**: For pushing alarms to your mobile phone after detecting moving objects

**Note**: If your mobile phone does not receive any alarm after the camera has detected any moving object to record a video for it, you can scan the following QR code or click the following link to view “Make APP run videos on mobile phone’s background” and conduct the reference operation (Android mobile phone only).



<https://youtube.com/shorts/Z3Bu7SPGAyc?feature=share>

## ② **Equipment alarm**

Motion detection and alarming:

After detecting any moving object, the camera will alarm. The motion detection sensitivity can be set.

AI alarming:

For enabling/disabling the camera to track the identified objects

Alarm trigger: The default mode is interlinked trigger, in which the camera detects moving human-shaped objects only to avoid excessive false alarms. In separate trigger, the camera alarms after detecting any moving or human-shaped object.

Set alarm plan: Including simple setting and advanced setting

Simple setting: Around-the-clock detection and alarming from Monday to Sunday by default

Advanced setting: For setting a user-defined period for detection and alarming

## (6) **Alarm linkage**

Enable/disable saving of videos or snapshot in TF card: For saving the videos or snapshots recorded or taken into the TF card

Set alarm linkage: For enabling the camera to sound an alarm through its speaker after detecting any moving object. Sound type and duration of the alarm can be chosen.

## (7) **Video settings**

Code rates and frame rates of the video images can be viewed. (\* Note: The video parameters are adjusted by the camera automatically and do not need to be modified.)

## (8) **Audio settings**

Audio output type: Line input/ microphone input. Input/output volume: 1-100 (adjustable)

### **(9)SD card plan recording**

Enable/disable the camera to record videos around the clock

Set camera's bit stream: The first bit stream or the second bit stream

Set duration of around-the-clock video file: 15s ~ 900s

Set recording period: Simple setting, and advanced setting

Simple setting: Around-the-clock detection and alarming from Monday to

Sunday by default Advanced setting: For setting a user-defined period for detection and alarming

### **(10)SD card settings**

For viewing the total storage space and remaining storage space of the

MicroSD card (\* Note: a 1080P camera supports a TF card of 64G at most; a camera above 1080P supports a TF card of 128G at most.)

### **(11)Time setting**

For setting the camera's time and time zone

### **(12) Default setting**

For restarting and resetting the camera

### **(13)Device information**

For viewing the camera's information including software version, IP address, network type, etc.

### **(14)Share camera**

Device Sharing Click the share icon in the top right corner or use the "Share" option in the settings menu. Enter the recipient's registered email address and select the desired permissions to complete the sharing process. (Fig.26)

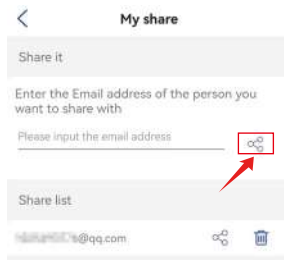

Fig.26

(15).Delete and unbind the camera (you can also choose to reset the camera)

**8.Cloud Service :** Subscribe to the camera's cloud service and view cloud video recordings.(Some cameras do not support this feature)

## 6. Use HIP2P client software to set up the camera

### 6.1 Use the HiP2P software to connect to the camera

#### Step 1: Preparation

1. Download and install the PC/MAC software "HiP2P" from the Ctronics website [www.ctronics.com](http://www.ctronics.com).
2. Connect the camera to the power supply.
3. Connect the camera to the mobile phone through network configuration,

## Step 2: Connect the camera in HiP2P software

1. Run the "HiP2P" software on the computer. There is no password by default, and the password is blank.
2. Click the setting icon on the menu bar and select the input device UID button (Fig.27-1).
3. Enter the UID and name of the camera. The default password is admin. (The UID is on the label of the camera.)(Fig.27-2)
4. Click the preview interface, select the device, click the right mouse button, and drag the camera into the screen window.
5. After a few seconds, the camera will display the status "Online" on the interface (Fig. 28)

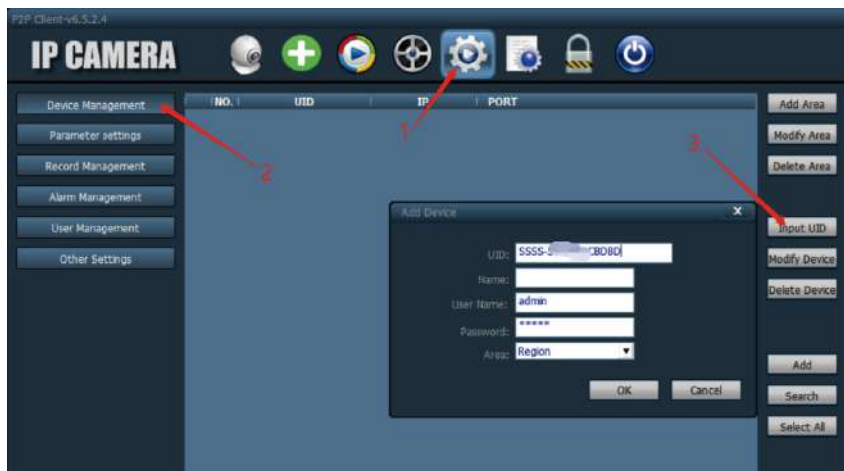

Fig.27-1



Fig.27-2



Fig.28

## 6.2 PC/Mac client software introduction

You can connect multiple Ctronics security cameras on the same PC though PC/Mac software "HiP2P", which can be downloaded from Support-Download on the Ctronics website.

### \*Note:

1. Compared with the Windows software, the interface of the Mac software is more simplified. Many functions may only exist in the Windows software.
2. The password of the default login account "admin" is blank. You can leave the password blank and confirm that you can access the functions on the interface.

There are 8 function icons in the menu bar: Preview, Auto add, Local playback, Remote playback, Settings, System log, Switch user, and Exit (from left to right).

## 6.3 Preview interface

This is used to view the real-time picture of the camera, operate the camera PTZ and image picture, set the preset position, use the voice intercom, take pictures and video, and perform split-screen viewing (Fig.29).

(\*Note: All functions may not be applicable to your camera. Please refer to the product description or contact us to get the available functions for your camera.)



Fig. 29

1. Camera list: Display the name information of the camera.
2. Camera real-time image: View the real-time image of the camera.
3. PTZ control: Operate the camera to rotate up and down, as well as use the camera lens optical zoom (Fixed focus cameras do not support the zoom function).
4. Preset position setting: Move the camera to a position, enter 1, and click "Set". This position will be recorded as position 1. Move the camera to the second position, enter 2, and click "Set". The second position will be recorded as position 2. When you need to move the camera to the preset position, just enter the number and click "call". The camera will automatically



- move to the corresponding position (only applicable to PTZ cameras).
5. Image settings: Adjust the color balance, brightness, etc. of the image.
  6. Electronic zoom: Zoom in on part of the image.
  7. Intercom function: Click the button to speak to the person who is on the other side of the camera.
  8. Volume adjustment: Adjust the volume.
  9. Manual recording: Click to record the real-time picture and save it to the computer disk.
  10. Save the picture: Click to take a screenshot of the real-time picture and save it to the computer disk.
  11. Number of split screens: Choose single screen or multiple screens to view the camera screen.
  12. Full screen mode: Display full screen picture.
  13. Hide event: Click to hide the event box below.
  14. Distant View: Click this button to view the image in the distance.
  15. Close-up View: Click this button to view a close-up image.
  16. Adaptive Real-time Video Size: Due to the screen size, the video will be stretched in full screen state, you can choose to adjust the video size adaptively.

## **6.4 One-click add interface**

Click it to automatically add cameras in the same LAN.

## **6.5 Remote playback**

Remote playback means that after the customer inserts the TF card, the camera will automatically save the video to the TF card. When you want to play the recorded video on the TF card, please select the camera, recording type, date and time to find the recorded video for viewing (Fig.30).



Fig. 30

1. Video file list: Displays the name and time information of the video files in the SD card.
2. Video type: Choose different video types to filter the video.
3. Select channel: Select different cameras to view the video.
4. Recording time: Play the recordings of different time periods according to the year, month, day, and time.
5. Camera video image: View the video image of the camera.
6. Play button: Click to start playing the video.
7. Pause playback: Click to pause video playback.
8. Save the picture: Click to take a screenshot of the playback screen and save it to the computer disk.
9. Electronic zoom: Zoom in on part of the image.

10. Full screen mode: Display full screen picture.
11. Volume adjustment: Adjust the volume.
12. Video progress bar: Move the progress of the video for repeated viewing.

## 6.6 Settings

Device management to manage the camera in the software (Fig.31).



Fig.31

1. Area management: You can add area, modify area, or delete area.
2. Add camera: Input the camera's UID, name, and password to add (the default password is "admin", or if the password is modified, you need to enter the modified password).
3. Camera management: Modify or delete the added camera.
4. Search and add the local camera.

Parameter setting: Set camera parameters (Fig.32)



Fig. 32

1. **Video:** View the video parameters, set OSD and video frequency.  
(\*Note: Video parameters do not support manual modification; they are adaptive by the system)
2. **Image settings:** View image parameters and turn on or off the smart tracking.
3. **Audio:** Set the input and output volume to control the volume.
4. **Alarm settings:** Set motion detection and humanoid detection, mailbox alarm, and FTP alarm. When an object is detected, it will alarm and send pictures or videos to the mailbox and FTP server. You can also set the alarm time and customize the alarm time period.
5. **Network settings:** View some information such as IP address, HTTP port, HTSP port, and onvif protocol.

- 6. TF card:** Set the type of video stream to be recorded and the duration of the video file. Check the remaining space of the TF card and format the TF card. You can also set the time of the recording to customize the recording.
- 7. Timed capture:** Set the image to be saved to the TF card and FTP server.
- 8. PTZ:** Set the camera PTZ parameters.
- 9. Login information:** Modify the password of the camera.
- 10. System:** Set the time zone of the device and view device information parameters.
- 11. Wifi settings:** Set the WiFi network of the device and check whether the connected WiFi network is normal.
- 12. Motion detection:** Set multiple detection areas and detection sensitivity.
- Recording management:** Set PC hard disk recording, enable/disable recording, set recording schedule, make custom settings for recording, and you can also select the computer disk to change the storage path, etc.
- (\***Note:** Please keep the software running on the PC to record video on the hard disk of the PC.)
- Alarm management:** Set the alarm function on the PC side, enable/disable the alarm on the PC side, set the alarm schedule, set the alarm to record on the PC hard disk, and set the sound alarm on the PC.
- User Management:** Set the user account and password of HIP2P on the PC.
- Other settings:** Set the saving path of the picture after taking a local photo, the number of split screens for the real-time interface, the default password after adding a camera, etc.

## 7. FAQ

### 1. How do i turn the camera on?

Once the camera is powered on, it will automatically turn on and self-check the gimbals. There is no power indicator on the camera. You can cover the light detector to simulate night mode and check whether the infrared LED is on. If it is, the camera is well powered.

### 2. What if the camera network "IPCAM-xxxxxx" cannot be found and the mobile device cannot be connected to the camera?

Please reset the camera to factory settings, then search the internet again on your mobile device.

### 3. How can I recover the password of the camera?

If you forget the password, you have to reset the camera to factory default settings and reset the camera.

### 4. How do I reset the camera to factory default settings?

If the camera is connected online, you can find the reset option in the phone application or PC software to reset the camera. If the camera is offline, you can press and hold the reset button on the camera connection line for 15-20 seconds to reset the camera.

### 5. How do I delete the videos on the TF card?

When the TF card is full, the camera will automatically clear the original records in the TF card. If you want to delete the video manually, you can enter Ctronics pro' APP TF card settings and format the TF card.

6. The time displayed on the recorded video is incorrect. What is the difference in the actual recorded time?

By default, the time zone of the camera is GMT+8. Please enter the camera's time setting and select the correct time zone for your camera. If you have summer time, please enable daylight saving time. After selecting the new time zone, remember to verify the changes. The camera will restart to get the correct time.

7. The alarm notification is turned on, but when there is motion detection, my smartphone still cannot receive the notification.

This may happen on Android phones, because the Android system closes apps in the background to save battery life. When the application is closed, it will not be able to send notifications. You can modify battery management/ battery optimization in your Android phone settings to allow the application Ctronics to run in the background.

8 . I access the TF card and get the recorded video, but I cannot play the recorded video on the computer.

The recorded video is in H264 format, which is our proprietary format. You can download the software "HiPlayer" from our website [www.ctronics.com](http://www.ctronics.com) to play the video. You can also download the "FileConverter" software to convert the video from H264 to AVI, or directly use the HIP2P client to view the video.