



Affordable. Reliable. Home Improvement.

BATHROOM FLOOR CABINET

MODEL: 25-46-3.4



Affordable. Reliable. Home Improvement.

BATHROOM FLOOR CABINET

MODEL:25-46-3.4

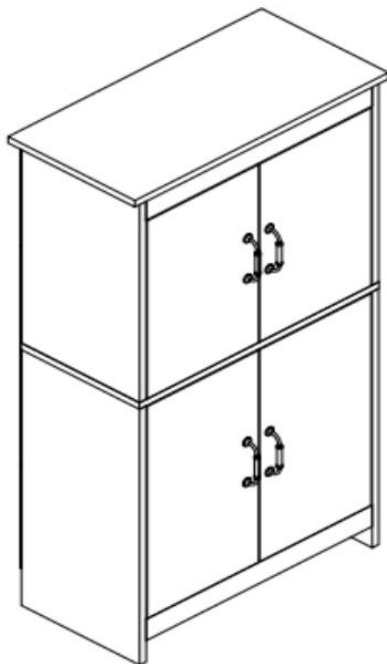

<Picture Only For Reference >

This is the original instruction, please read all manual instructions carefully before operating. VEVOR reserves a clear interpretation of our user manual. The appearance of the product shall be subject to the product you received. Please forgive us that we won't inform you again if there are any technology or software updates on our product.

IMPORTANT SAFEGUARDS



WARNING: Read and understand this entire manual before operating or servicing this product. Failure to follow these warnings and instructions can cause personal injury or damage to valuable property.

Assembly precautions

1. Assemble only according to these instructions. Improper assembly can create hazards.
2. Wear ANSI-approved safety goggles and heavy-duty work gloves during assembly.
3. Keep the assembly area clean and well-lit.
4. Keep bystanders out of the area during assembly.
5. Do not assemble if tired or when under the influence of alcohol, drugs or medication.
6. The product capabilities apply to properly and completely assembled products only.
7. Assemble on a flat, level, hard and smooth surface capable of safely supporting the Cabinet.
8. If possible, you can use power tools to make assembly easier.
9. For additional information regarding the parts listed in the following pages, please refer to the Assembly Diagram of this manual. Unwrap and separate all parts in a clean work area.

Use precautions

1. DO NOT SIT OR STAND ON THIS ITEM.
2. This product is not a toy. Do not allow children to play with or near this item.
3. Do not exceed specified weight capacities.
4. Use only on a flat, level, hard, and smooth surface that can safely support a fully loaded the Cabinet.
5. Use as intended only.
6. Inspect before every use; do not use if parts are loose or damaged.

SAVE THESE INSTRUCTIONS

PLATE LIST

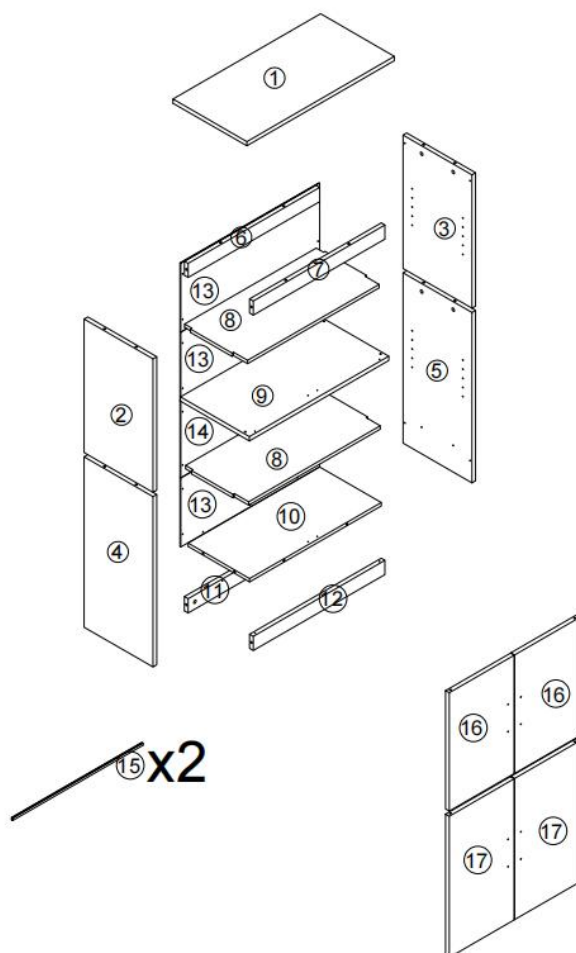

ACCESSORIES LIST

A ×28



M6×35

B ×28



12×10

C ×4



M5×40

D ×4



M3×12

E ×4



M3×14

F ×2

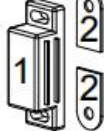

G ×25



M4×12

H ×8



J ×4



K ×8



M4×18

L ×8

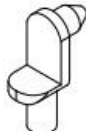

M ×2



ASSEMBLY STEP

STEP1

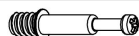
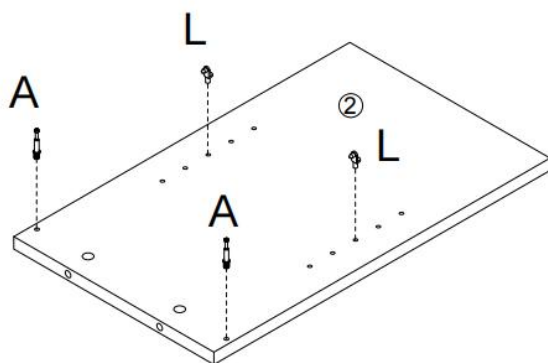
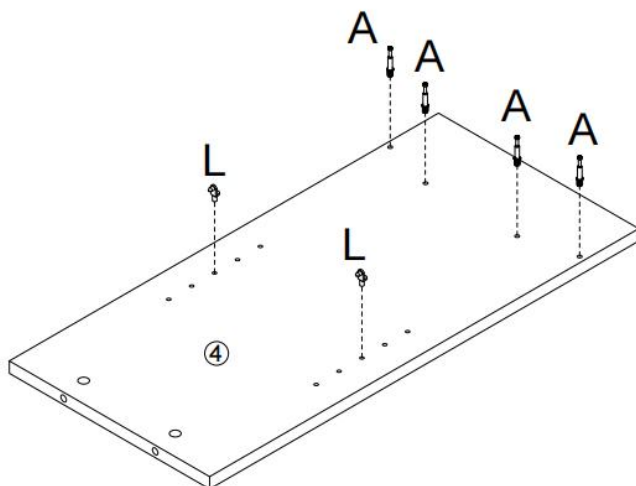
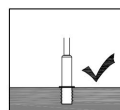
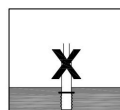
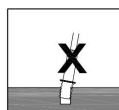

M6×35



Ax6

Lx4

STEP2

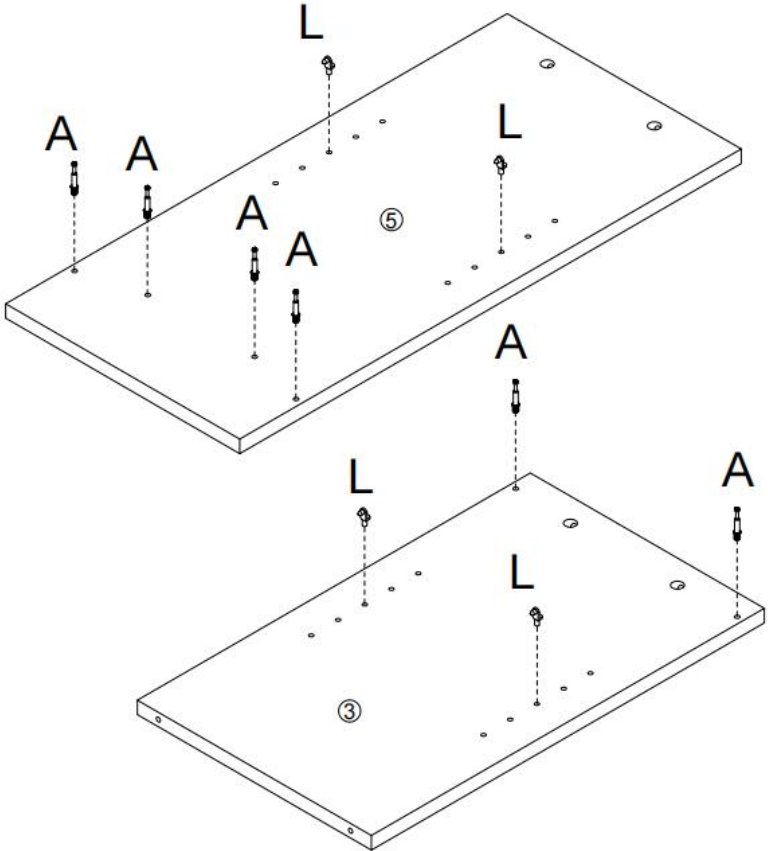
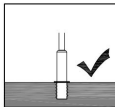
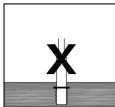
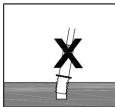

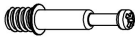
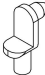
 M6×35	
Ax6	Lx4

STEP3

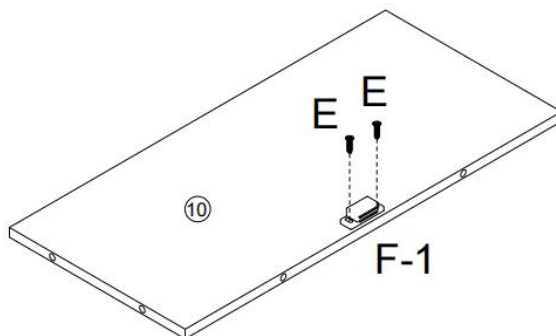

Fix the door suction holder F-1 to plate No. 10 with screw E



M3×14

Ex2

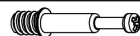
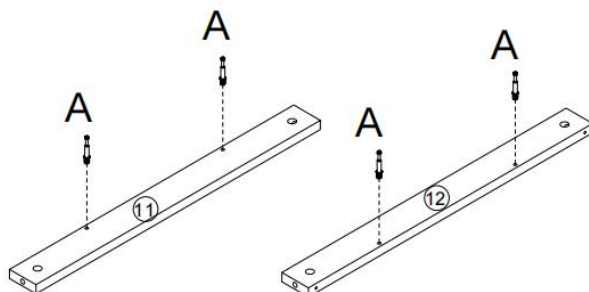
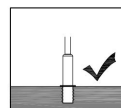
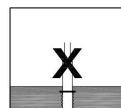
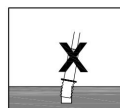

F-1x1

STEP4



M6×35

Ax4

STEP5

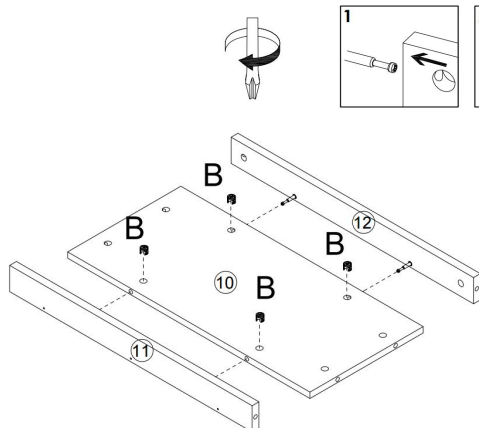

12×10

Bx4

STEP6

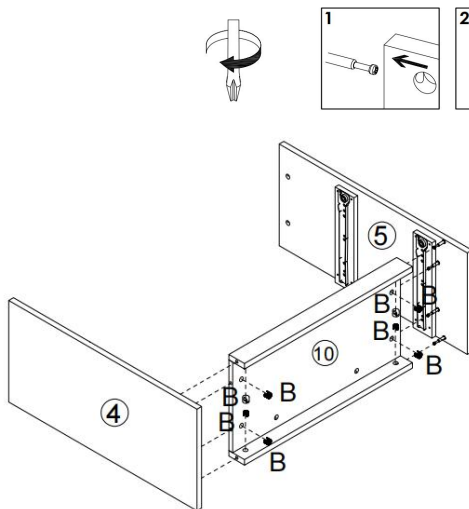

12×10

Bx8

STEP7

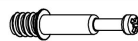
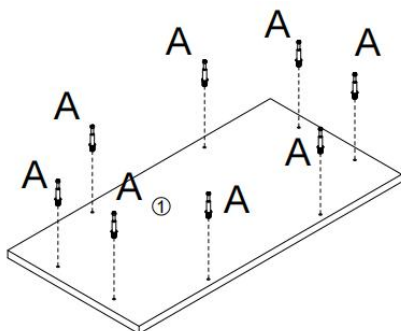
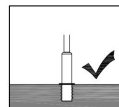
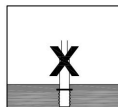
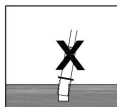

M6×35

Ax8

STEP8

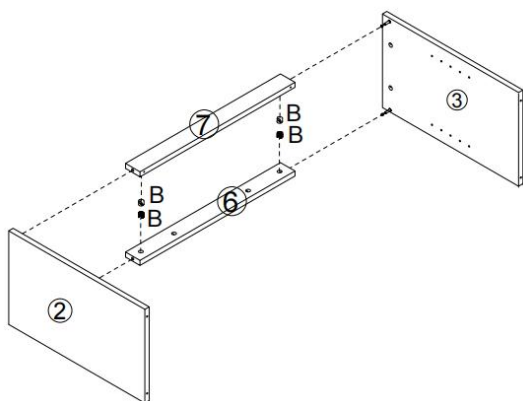
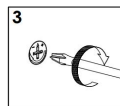
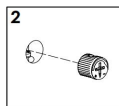
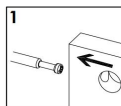

12×10

Bx4

STEP9

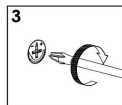
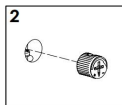
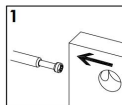
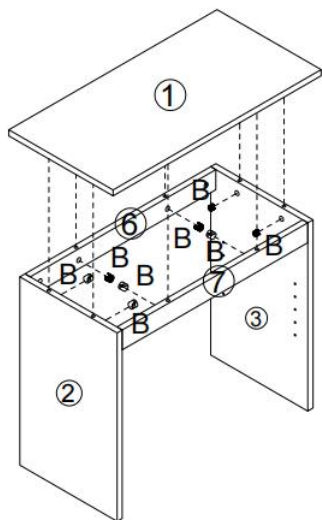

12×10

Bx8

STEP10

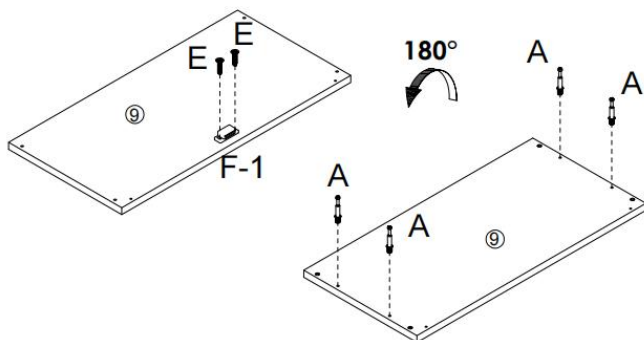
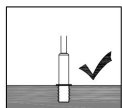
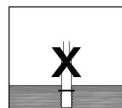
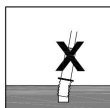

Fix the door suction holder F-1 to plate No. 9 with screw E

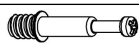

M6×35

Ax4



M3×14

Ex2



F-1x1

STEP11

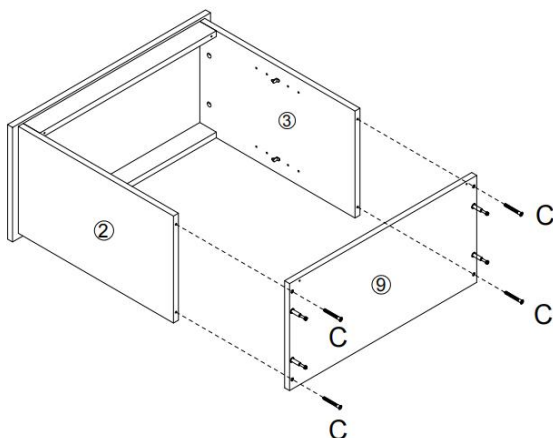

M5x40

Cx4

STEP12

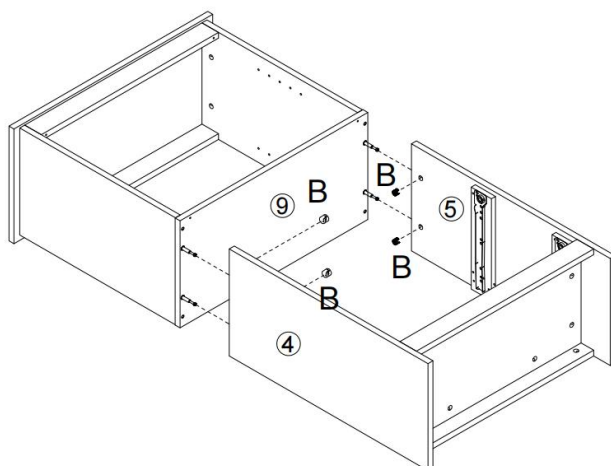
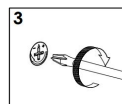
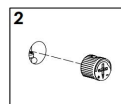
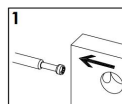

12x10

Bx4

STEP13

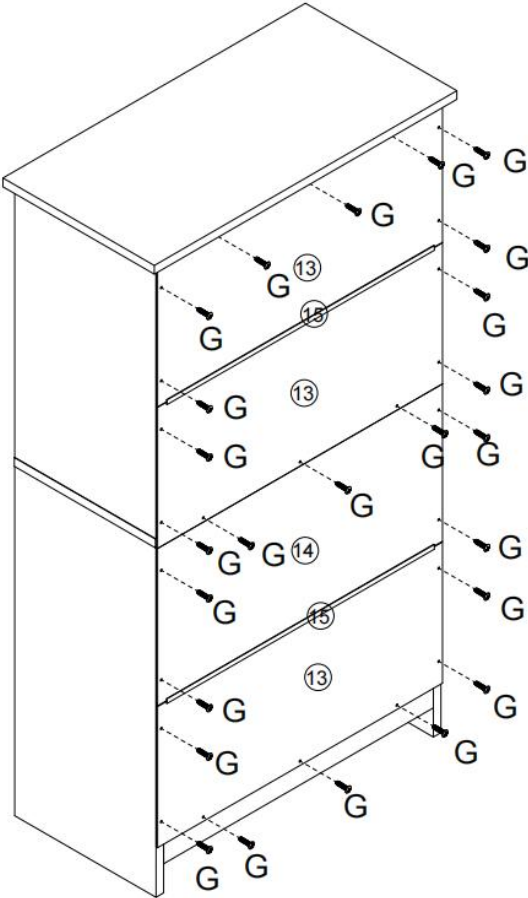





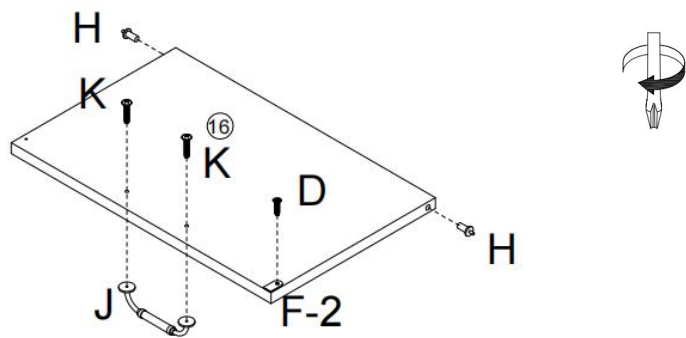

M4×12

Gx25

STEP14

Fix the handle F-2to the No. 16 plate with screw D





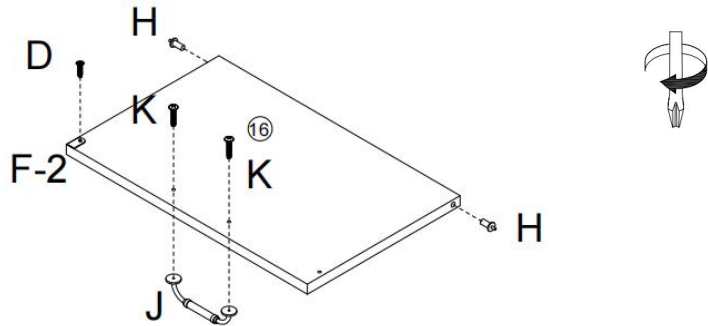

				
M3×12	F-2x1	Hx2	Jx1	M4×18
Dx1				Kx2

STEP15

Fix the handle F-2to the No. 16 plate with screw D





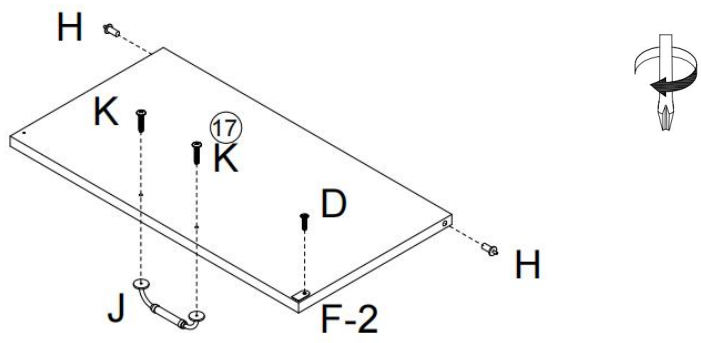

				
M3×12	F-2x1	Hx2	Jx1	M4×18
Dx1				Kx2

STEP16

Fix the handle F-2 to the No. 17 plate with screw D





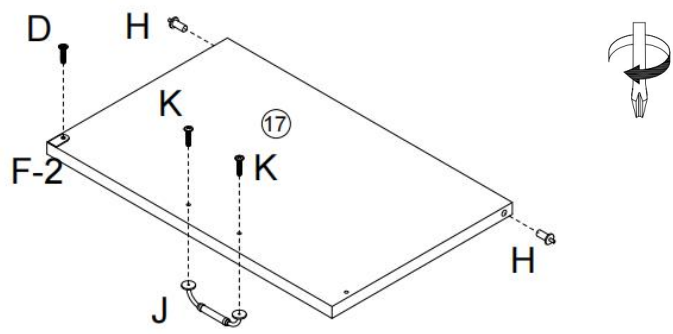

				
M3×12	F-2x1	Hx2	Jx1	M4×18
Dx1				Kx2

STEP17

Fix the handle F-2 to the No. 17 plate with screw D



				
M3×12	F-2x1	Hx2	Jx1	M4×18
Dx1				Kx2

STEP18

Press whit your hand

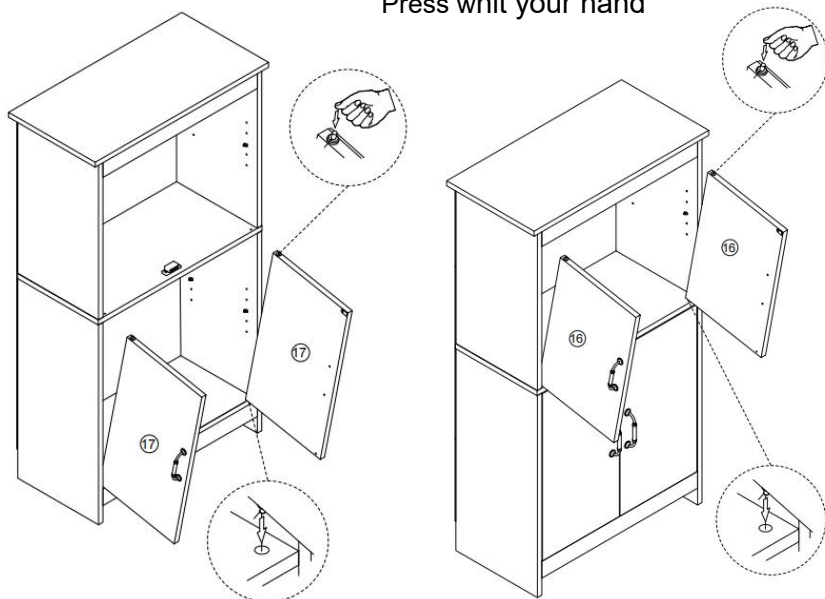

NOTE: Pay special attention to the direction of the door when installing the door in this step. Once the installation is wrong, the door assembly cannot be taken out here alone.

STEP20

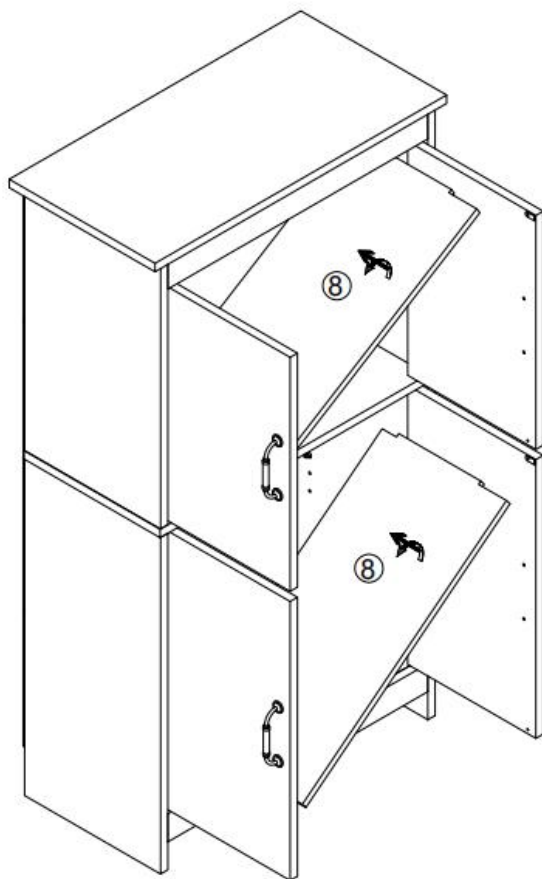

NOTE:The product provides 3 installation heights, then you can adjust the position of the laminate according to the space height you need.

STEP23

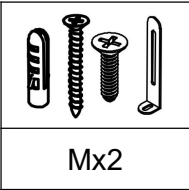
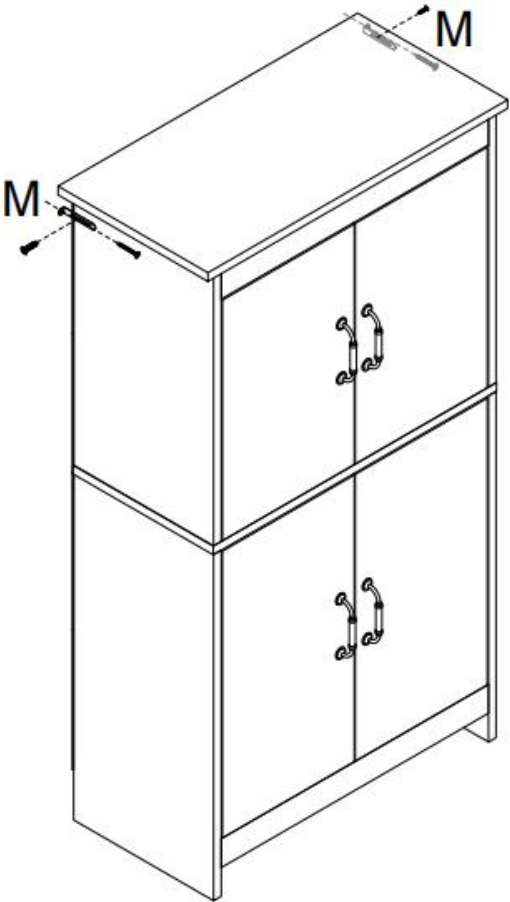
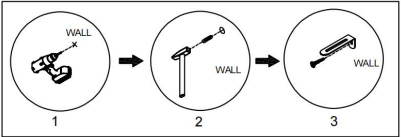

Mx2

PRODUCT PARAMETER

Model	25-46-3.4
Colour	White
Grade	P2
Product Size(D×W×H)	300×600×1100mm(11.8×23.6×43.3in)

* Products such as specifications, appearance, and design are subject to modification without prior notice.

Manufacturer: Shanghaimuxinmuyeyouxiangongsi

Address: Shuangchenglu 803nong11hao1602A-1609shi, baoshanqu, shanghai 200000 CN.

Imported to AUS: SIHAO PTY LTD. 1 ROKEVA STREETEASTWOOD NSW 2122 Australia

Imported to USA: Sanven Technology Ltd. Suite 250, 9166 Anaheim Place, Rancho Cucamonga, CA 91730

EC	REP
----	-----

E-CrossStu GmbH
Mainzer Landstr.69, 60329 Frankfurt am Main.

UK	REP
----	-----

YH CONSULTING LIMITED.
C/O YH Consulting Limited Office 147, Centurion House, London Road, Staines-upon-Thames, Surrey, TW18 4AX

