

SIMPLY VS20.20

SIMPLY VS10.12

SIMPLY VS10.10

POLTI Vaporella®

MANUALE DI ISTRUZIONI

INSTRUCTION **MANUAL**
MANUEL D'INSTRUCTIONS

MANUAL DE INSTRUCCIONES
BEDIENUNGSANLEITUNG

MANUAL DE INSTRUÇÕES

REGISTRA IL TUO PRODOTTO
REGISTER YOUR PRODUCT
ENREGISTREZ VOTRE PRODUIT
REGISTRA TU PRODUCTO
GERÄTREGISTRIERUNG
REGISTE O SEU PRODUTO
www.polti.com

 **POLTI®**
NATURAL HOME FEELING

POLTI VAPORELLA SIMPLY VS20.20



POLTI VAPORELLA SIMPLY VS10.12



POLTI VAPORELLA SIMPLY VS10.10

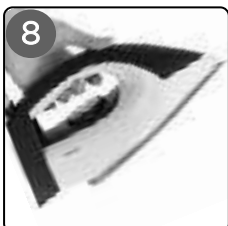
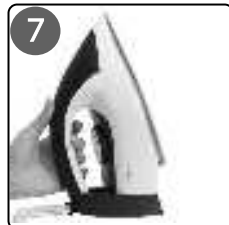
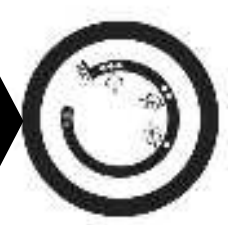
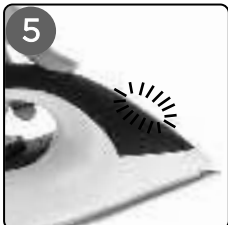
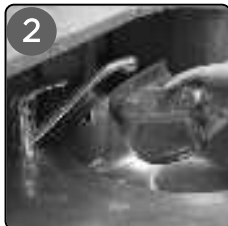

OPTIONAL

FPAS0032



ASSE STIRA E ASPIRA TOP
STIRA E ASPIRA TOP SHAFT
PLANCHE STIRA E ASPIRA TOP
TABLA STIRA E ASPIRA TOP
BÜGELTISCH STIRA E ASPIRA TOP
TÁBUA STIRA E ASPIRA TOP

FPAS0030



ASSE STIRA E ASPIRA
STIRA E ASPIRA SHAFT
PLANCHE STIRA E ASPIRA
TABLA STIRA E ASPIRA
BÜGELTISCH STIRA E ASPIRA
TÁBUA STIRA E ASPIRA

FPAS0045



ASSE VAPORELLA TOP
VAPORELLA TOP SHAFT
PLANCHE VAPORELLA TOP
TABLA VAPORELLA TOP
BÜGELTISCH VAPORELLA TOP
TÁBUA VAPORELLA TOP

FPAS0001



ASSE VAPORELLA
VAPORELLA SHAFT
PLANCHE VAPORELLA
TABLA VAPORELLA
BÜGELTISCH VAPORELLA
TÁBUA VAPORELLA

FPAS0044



ASSE VAPORELLA ESSENTIAL
VAPORELLA ESSENTIAL SHAFT
PLANCHE VAPORELLA ESSENTIAL
TABLA VAPORELLA ESSENTIAL
BÜGELTISCH VAPORELLA ESSENTIAL
TÁBUA VAPORELLA ESSENTIAL

PAEU0096



TROLLEY

PAEU0202



TELO UNIVERSALE
UNIVERSAL CLOTH
HOUSSE UNIVERSELLE
FUNDA UNIVERSAL
UNIVERSAL-BÜGELTISCHBEZUG
COBERTURA UNIVERSAL

PAEU0339



TELO XL PER ASSE VAPORELLA TOP
XL COVER FOR VAPORELLA TOP IRONING BOARD
HOUSSE XL POUR TABLE À REPASSER VAPORELLA TOP
FUNDA XL PARA TABLA DE PLANCHAR VAPORELLA TOP
XL-BÜGELTISCHBEZUG FÜR BÜGELTISCHE VAPORELLA TOP
COBERTURA XL PARA TÁBUA VAPORELLA TOP

Gli accessori optional sono disponibili all'acquisto nei migliori negozi di elettrodomestici, nei Centri Assistenza autorizzati e sul sito www.polti.com.

The optional accessories are on sale at all the best domestic appliance retailers, an Authorised Polti Service Centre or online at www.polti.co.uk.

Les accessoires en option sont disponibles dans les meilleurs magasins d'appareils électroménagers, auprès d'un SAV agréé ou sur le site www.polti.fr.

Los accesorios opcionales están a la venta en las mejores tiendas de electrodomésticos, centros de asistencia autorizados o en la página web www.polti.com.

Die optionalen Zubehörteile sind in gut geführten Haushaltsgeschäften, bei den autorisierten Kundendienstcentern oder auf www.poltide.de erhältlich.

Os acessórios opcionais estão disponíveis para compra nas melhores lojas de eletrodomésticos, um dos Centros de Assistência Autorizados ou no site www.polti.com.

WELCOME TO THE WORLD OF POLTI VAPORELLA

POLTI VAPORELLA SIMPLY: THE STEAM GENERATOR IRON
WITH A LARGE SEPARATE TANK
FOR SIMPLE AND QUICK IRONING



ACCESSORIES FOR ALL NEEDS

Visiting our site **www.polti.co.uk** or any of the top household appliance stores, you will find a vast range of accessories to enhance the performance and convenience of your appliance and make household tasks even simpler.

To check the compatibility of an accessory with your appliance, search the code PAEUXXXX/FPASXXXX listed next to each accessory on page 3-4.

If the accessory code you wish to buy is not listed in this manual, please contact our Customer Service team for more information.



REGISTER YOUR PRODUCT

Visit our website **www.polti.co.uk** or call our Customer Services department to register your product. You can benefit from a special welcome offer, in participating countries, and keep up to date on all the latest Polti news, as well as buy accessories and consumables.

To register your product, in addition to your personal information, you must enter the serial number (SN) which you will find on the silver label, located on the box and underneath the appliance. To save time and have your serial number to hand, write it in the space provided on the back cover of this manual.



OFFICIAL YOUTUBE CHANNEL

Want to know more? Visit our official channel:
www.youtube.com/poltispa.

We'll show you the natural power and ecological effectiveness of steam both for ironing and for cleaning, through many videos of Polti Vaporella and of all other products in Polti's world.

Sign up to the official channel to keep yourself updated about our video contents!

ATTENTION: The safety warnings are only shown in this manual.

SAFETY WARNINGS

IMPORTANT PRECAUTIONS FOR USE



WARNING! BEFORE USING THE APPLIANCE, CAREFULLY READ ALL THE INSTRUCTIONS AND WARNINGS IN THIS



MANUAL, AND ON THE APPLIANCE ITSELF.

Polti S.p.A. declines all liability for any accident deriving from any improper use of this appliance.

Correct use of the product is only as detailed in this instruction manual.

Any use which does not comply with these instructions will invalidate the warranty.

SAFETY SYMBOLS:



WARNING: High temperature. Risk of scalding!

If shown on the product, do not touch as parts may be very hot.



WARNING: Steam.

Risk of scalding!

This appliance reaches very high temperatures. Incorrect use of the device can cause scalding.

- Never disassemble or carry out maintenance on the appliance apart from that indicated in this manual. In the event of a fault or malfunction, do not try to repair the appliance yourself. In the event of a heavy knock, fall, damage or fall into water, the appliance may no longer be safe to use. Incorrect use or a lack of respect for the instructions herein may lead to serious accidents. Always contact Authorised Service Centres.
- This iron must not be used if it has been dropped, if there are visible signs of damage or if it leaks.
- The plug must be removed from the power socket before the tank is filled.
- The opening to the tank must not be opened while in use.
- The appliance must not be left unattended if plugged in to the mains.
- The iron must be used and rested on a stable surface.
- When placing the iron on its stand, make sure that the surface on which the stand is placed is stable.

- The iron must be used with the ironing (fixed or removable) mat provided.
- This appliance can be used by children aged from 8 years and above and persons with reduced physical, sensory or mental capabilities or lack of experience and knowledge if they have been given supervision or instruction concerning use of the appliance in a safe way and understand the hazards involved. Children shall not play with the appliance. Cleaning and user maintenance shall not be made by children without supervision.
- Keep the appliance and the power cable out of the reach of children under 8 years of age when the appliance is switched on or during the cooling phase.
- Keep all the parts of the packaging out of the reach of children; they are not toys. Keep the plastic bag out of the reach of children: danger of suffocation.
- This appliance is designed exclusively for indoor domestic use.
In order to reduce the risk of accidents, including: fires, electrocution, personal injury and scalding, both during use and during preparation, maintenance and storage, always take the fundamental precautions listed in this manual.

RISKS CONNECTED TO THE POWER SUPPLY- ELECTROCUTION

- The earthing system and highly sensitive residual-current circuit breaker, complete with magnetothermic cut-out for your domestic system, guarantee safe use of electrical appliances. Therefore, for your own safety, check that the electrical system to which the appliance is connected complies with current laws.
- Do not connect the appliance to the mains if the voltage does not correspond with that of the domestic electrical circuit in use.
- Do not overload sockets with adaptors and/or transformers. Only connect the product to a single socket with current that is compatible with the plug supplied.
- Electrical extension leads that are unsuitable for the power rating or which are not compliant with law may overheat and possibly lead to short-circuiting, fire, power outage or damage to the equipment. Only use extension leads which are certified, suitable for the power rating, supporting 16A and earthed.
- Always turn the appliance off before unplugging it.

- To remove the plug from the socket, do not pull the power cable, but hold the plug itself to avoid damage to the plug and the cable.
- Always unplug the appliance if it is not in use and before any preparation, maintenance or cleaning operation.
- Fully unwind the cable and water hose before connecting to the mains and before use. Always use the product with the cable and water hose fully unwound.
- Do not pull or jerk the cable or water hose, or expose them to stress (twisting, crushing or stretching). Keep the cable and water hose away from hot and/or sharp surfaces and parts. Do not allow the cable and water hose to come into contact with the hot iron plate. Avoid crushing the cable and water hose in doors and windows. Do not pull the cable and water hose tight around corners. Avoid treading on the cable and water hose. Do not walk over the cable and water hose. Do not wind the power cable and water hose around the appliance, especially if the appliance is hot.
- Do not change the plug on the power cable.
- If the cable and water hose are damaged, they must be replaced by the manufacturer, the manufacturer's service agent or similarly qualified persons in order to avoid any possible hazards. Do not use the product if the power cable and water hose are damaged.
- Do not touch or use the appliance barefoot and/or with wet body or feet.
- Do not use the appliance near containers full of water, e.g. sinks, baths and swimming pools.
- Do not immerse the appliance, including the power cable and plug, in water or other liquids.
- Steam must not be directed towards equipment containing electric or electronic components.

RISKS DURING USE OF THE PRODUCT - INJURIES/SCALDING

- The product should not be used in areas where there is a danger of explosions or in the presence of toxic substances.
- Do not pour toxic substances, acids, solvents, detergents, corrosive substances and/or explosive liquids, perfumes, perfumed water, or any type of descalant into the tank. Do not use Polti Kalstop.

- Only pour water or the water mix indicated in the “WHICH WATER TO USE” section into the tank.
- Do not direct the steam jet or the iron onto toxic substances, acids, solvents, detergents or corrosive substances. The handling and removal of dangerous substances must be carried out according to the indications of the manufacturers of these substances.
- Do not direct the steam jet or the iron onto explosive powders or liquids, hydrocarbons, open flames and or extremely hot objects.
- Do not direct the steam jet at the ironing mat and/or the appliance itself.
- Do not position the product near sources of heat such as fireplaces, stoves and ovens.
- Do not obstruct the openings and grills on the product.
- Do not direct the steam jet or the iron onto any part of the body of people or animals.
- Do not direct the steam jet or the iron onto clothes while they are being worn.
- Clothes and fabrics which have been subjected to a deep steam reach very high temperatures, above 100°C. Take care when handling the appliance.
- During use, keep the product in a horizontal position on a stable surface.
- Iron only on supports that are heat resistant and which allow the steam to permeate.
- When placing the iron on its stand, make sure that the surface on which the stand is placed, is stable.
- If the iron rest mat needs to be replaced, only use original spare parts.
- Do not rest the iron on a base without the ironing mat.
- Do not place the hot appliance on heat-sensitive surfaces.
- If ironing whilst sitting down, take care to ensure that the jet of steam is not angled towards your legs. Steam can scald.
- Before connecting the appliance to the current, ensure that the continuous steam jet button is not pressed (if present).
- Do not leave the iron unattended when the steam is activated.
- Wait until the iron has cooled down completely before storing after use.

CORRECT USE OF THE PRODUCT

This appliance is intended for domestic use as steam generator iron, with separate tank in accordance with the descriptions and instructions contained in this manual. Please read these instructions carefully and keep them. This manual is also available on the website www.polti.co.uk.

POLTI S.p.A. reserves the right to make the aesthetic, technical and construction changes it deems necessary, without prior notice.

Before leaving our factory all our products are rigorously tested. Therefore, Polti Vaporella Simply may already contain some residual water in the tank.

Correct use of the product is only as detailed in this instruction manual. Any other use may damage the appliance and invalidate the warranty.

INFORMATION FOR USERS

Pursuant to European Directive 2012/19/EU, regarding electric and electronic appliances, this appliance must not be disposed of with domestic waste, but must be sent to an official collection facility. This appliance complies with EU Directive 2011/65/EU.



The crossed-out bin symbol on the appliance indicates that, at the end of its useful lifespan, the product must be disposed of separately from other waste. Therefore, at the end of its life, the user must hand over the appliance to an appropriate collection centre for electric and electronic waste or, according to the legislation in force in the country, leave the used appliance with the distributor when buying a new product to replace it. Proper separate waste collection to facilitate the subsequent recycling, treatment and environmentally compatible disposal of the appliance helps to prevent negative effects on the environment and human health, and promotes recycling of the materials the product is made of. Unlawful disposal by the owner may result in the application of the administrative sanctions envisaged by current legislation.

WHICH WATER TO USE

Polti Vaporella Simply was designed to operate with a mixture composed of 50% tap water having a hardness up to 20° f and 50%

commercially-available demineralised water.

If the water used is particularly hard (above 20° f), excessive limescale could accumulate in the appliance, if so use demineralised water only.

Warning: check the hardness of the water at the technical office at your local council or the local water supplier.

Never use rain water or water containing additives (e.g. starch, perfumes), perfumed water or water produced by other domestic appliances, water softeners and filter jugs.

Do not add chemical, natural, detergent, or limescale removing substances, etc. Do not use Polti Kalstop.

1. PREPARATION FOR USE

1.1 Position Polti Vaporella Simply on a stable, flat, heat-resistant surface.

1.2 Remove (1) and fill the tank with water (2) up to the MAX line on the tank.

This operation must always be carried out with the power cable disconnected from the mains.

Thanks to the continuous refill system you do not need to stop the ironing and wait for the appliance to cool down because the tank can be filled as needed.

1.3 Reinsert the water tank until you hear the hook click.

1.4 Release the iron from the rest (see 11.4).

1.5 Connect the cable plug to an earthed power supply of the correct voltage (3).





1.6 Make sure you have completely unrolled the water hose.

1.7 Press the ON/OFF switch (⏻) (4) once: the continuous blue indicator light will turn-on together with the iron heating light (5).

The sound emitted on your appliance during use is due to the water refilling system and is quite normal.

2. IRON TEMPERATURE ADJUSTMENT

Before ironing an item of clothing, always check the symbols on its label, for the instructions provided by the manufacturer. Check, based on the following table, the most appropriate type of ironing:

	High temperature - cotton, linen: Set the iron temperature adjustment knob to the position •••
	Medium temperature - wool, silk: Set the iron temperature adjustment knob to the position •• Do not use steam.
	Low temperature - synthetic, acrylic, nylon, polyester: Set the iron temperature adjustment knob to the position • Do not use steam.
	- Do not iron - Steam ironing and steam treatment not allowed

WARNING: Do not use steam at medium and low temperatures to prevent the leakage of water from the plate. Delicate fabrics such as wool, silk, synthetics may be steam treated from a distance and vertically, positioning the iron temperature dial to the at maximum temperature (the ••• position).

Divide the laundry according to the symbols on the garment labels or according to the kind of fabric. Always start ironing with the garments that require the lowest temperature, in order to reduce the waiting times and avoid the risk of burning the fabrics.

WARNING: Do not leave the hot plate on any surface. Use the Polti Vaporella Simply vertical rest, placing the rear part of the iron directly onto the ironing board or surface on which you are ironing (7). The appliance also comes with a handy iron rest mat (fixed) with non-slip pads designed to withstand hot temperatures.

3. STEAM IRONING - MAX FUNCTION

3.1 Make sure that section 1 has been completed and regulate the temperature of the iron (6) as described in section 2.

3.2 Wait for the iron-heating indicator light to go off (5).

3.3 Press the steam button (8) on the iron to make steam come out of the holes on the

plate. Proceed to iron clothes in accordance with the instructions above.

When first using the steam, there may be some drops of water leaking out of the plate, this is due to imperfect thermal stabilization. We therefore recommend that the first jet of steam be directed onto a cloth.

The iron heating indicator light turns on and off during use. This merely indicates that the electric resistance is in operation: continue to iron as normal.

4. STEAM IRONING - ECO FUNCTION

The ECO function allows you to iron with significant energy savings and at the same time enjoy the best possible performance, even on the more difficult fabrics (cotton/jeans/linen).

To activate the ECO function, simply keep the ON/OFF switch (⊕) pressed and release it after 3 seconds, the green indicator light around the ECO button will turn on (9) indicating the function is active. To disable the ECO function, keep the ON/OFF switch (⊕) pressed and release it after 3 seconds: the green indicator light will turn off.

When first using the steam, there may be some drops of water leaking out of the plate, this is due to imperfect thermal stabilization. We therefore recommend that the first jet of steam be directed onto a cloth.

The iron heating indicator light turns on and off during use. This merely indicates that the electric resistance is in operation: continue to iron as normal.

5. THE STEAM-JET STEAM BOOST FUNCTION (for the Polti Vaporella Simply VS20.20 model only)

The STEAM BOOST function can be activated for simple and easy ironing: set the temperature dial to the ••• position and click twice on the iron button (8). A powerful blast of steam will allow you to speed up and improve ironing, even on heavy fabrics, and to remove the most difficult creases.

If you wish to repeatedly activate the steam jet, we recommend you wait until the iron returns to maximum temperature.

6. VERTICAL IRONING

The iron may be used in the vertical position to remove creases from fabrics and/or to refresh the fabric fibres, eliminating any residual odours.

Hold the iron in a vertical position, press the button (8), and if permissible based on the type of fabric, touch it lightly with the plate.

7. DRY IRONING / DELICATE FABRICS

Ensure that section 1 has been followed, adjusting the temperature of the iron (6) to the lowest temperature as in section 2 and iron without pressing the steam button.

8. OUT OF WATER

If the appliance is out of water, the red out-of-water indicator light on the appliance will turn on (10) and no steam will be produced.

To restart operations just fill the water tank again as described in the section 1.

9. CALC CLEANING SYSTEM

The Polti Vaporella Simply Calc Cleaning system enables the removal of limescale, thus guaranteeing a better supply of steam, avoiding the leakage of stains or dirt from the holes in the plate.

Running the Calc Cleaning cycle regularly gives better performance and durability over time. Run the cycle whenever the blue indicator light around the ON/OFF switch (ⓘ) flashes and when the appliance emits a beep. In any case, it is possible to perform the cleaning cycle at any time.

Before running the cleaning cycle, make sure you have a large receptacle or bowl on hand to collect the water, steam and limescale that will come out from the iron during the process, thus avoiding the wetting of the ironing board or surface on which you are ironing.

How to clean limescale using the “Calc Cleaning” cycle:

- Fill the tank halfway with water.
- Make sure the machine is on.
- Position the temperature dial on the maximum value.
- Keep the ON/OFF switch (ⓘ) pressed until the appliance emits a triple beep (for at least 7 seconds), release the switch;
- Place the iron above the receptacle/bowl and press the steam activator on the iron to begin the cleaning cycle;
- During the cleaning cycle, the LED light fla-

shes blue; hot water, steam and limescale particles will come out from the iron. The cleaning cycle takes approximately 1 minute, do not interrupt the flow until it is complete.

- At the end of the complete cleaning cycle, the triple beep indicates that the procedure has finished and the blue indicator light around the iron will stop flashing.
- After having run the Calc Cleaning procedure, residual water may leak from the plate.
- Dry the iron with a cloth.

WARNING: The iron is hot and its temperature depends on the dial position.

- You may now resume normal ironing. If for any reason you decide to end the cleaning cycle before it finishes, keep the ON/OFF BUTTON (ⓘ) pressed (for at least 7 seconds) until the appliance emits a triple beep. Cleaning will be interrupted and the blue LED light will stop flashing.

10. GENERAL MAINTENANCE

Except when running the Calc Cleaning cycle, always unplug the appliance from the power mains before conducting any maintenance upon it, making sure that the product has cooled down before proceeding.

To clean the outside of the appliance, use only a damp cloth.

Do not use detergents of any type.

Clean the iron soleplate when it is completely cold with a damp cloth or with a non-abrasive sponge.

11. STORAGE

11.1 Turn off the appliance and disconnect from the mains electricity.

11.2 Wait for the appliance to cool down completely before storing it.

11.3 Empty the water tank.

11.4 Place the iron onto the mat, securing it with the special locking button on the front of the appliance (11). Press the button to unlock it (12)

11.5 Place the power cable and water hose in their special housing (13).

12. TROUBLESHOOTING

PROBLEM	CAUSE	SOLUTION
Steam does not come out from the Iron soleplate	No power ON/OFF (⏻) switch is off.	Check that the power is on and that the ON/OFF (⏻) switch is pressed.
	Water tank is empty.	Fill the water tank.
Little steam comes from the Iron soleplate.	The steam is dry, so is barely visible, but is present and effective.	This is normal especially in particular environmental conditions.
	You have not kept the button continuously pressed.	Keep the iron button pressed while ironing.
	You are ironing in Eco mode.	For a more powerful jet of steam, deactivate Eco mode and iron using the Max function.
Water comes out from the Iron soleplate instead of steam.	The temperature dial is not turned to maximum value.	Rotate the temperature dial to maximum.
	First steam release.	Release onto a cloth until steam comes out from the holes on the soleplate.
	The Calc Cleaning system just finished and any remaining water might leak from the plate.	Dry the iron with a cloth and resume normal ironing.
	The Steam Boost function was activated several times.	Always wait for the iron to reach maximum temperature between one activation and the next.
	Calc Cleaning function activated.	End the cleaning cycle.
Traces of water remain on the garments.	The ironing-board lining is impregnated with water.	Check that the ironing board is suitable (a board with a grill that prevents condensation).
The steam does not discharge immediately after the steam button has been pressed.	The water in the tank turns into steam in the iron plate. When you press the steam button, it takes 1-2 seconds to generate steam and discharge it.	This is normal, press and hold down the iron button while ironing.
The steam will continue to discharge after the steam button has been released.	The water in the tank turns into steam in the iron plate. When the button is released, the remaining water is turned into steam.	Release the steam button for 2-3 seconds before placing the iron onto the mat or in a vertical position.
When the iron is placed on the mat or in a vertical position, a strong jet of steam discharges, even after the button on the iron has been released.	When the iron is in the vertical position, the remaining water is collected and converted into steam with an intense delivery.	This is normal. Release the steam button for 2-3 seconds before placing the iron onto the mat or in a vertical position.
If problems persist or are not listed above, please contact a Polti Authorised Service Centre (www.polti.co.uk for the updated list) or contact Customer Services.		

WARRANTY

This appliance is for domestic use only and is guaranteed for two years from the date of purchase against any defects present at the time the goods are handed over; the date of purchase must be proven via a proof of purchase document valid for tax purposes and issued by the seller.

For repairs, the appliance must be accompanied by proof of purchase.

This warranty does not affect the consumer rights deriving from European Directive 99/44/EC as regards some aspects of sale and warranty of consumer goods, rights which the consumer should uphold with respect to the seller.

This warranty is valid in the countries which adhere to European Directive 99/44/EC. For other countries, local regulations on warranties apply.

WHAT THE WARRANTY COVERS

During the warranty, Polti guarantees free repair of a product with a manufacturing or factory defect and, therefore, the client is not liable to pay for any work or materials.

In case of irreparable defects, Polti may replace the product free of charge.

To avail of the warranty, the customer should visit one of the Polti Authorised Service Centres with proof of purchase from the seller valid for tax purposes and bearing the date of purchase of the product. Without proof of purchase and the relative date of purchase, the work will be charged for. Store the proof of purchase document safely for the whole duration of the warranty.

WHAT THE WARRANTY DOES NOT COVER

- Any fault or damage not deriving from a manufacturing defect.
- Any fault due to improper use or use other than that indicated in the instruction booklet, an integral part of the product sales contract.
- Any defect resulting from force majeure (fires, short circuits) or caused by third parties (tampering).
- Damage caused by the use of non-original Polti parts, and repairs or modifications performed by staff or service centres not authorised by Polti.
- Damage caused by the customer.
- Parts (filter, brush, hose, etc.) damaged by use (consumable goods) or normal wear and tear.
- Any damage caused by limescale.
- Defects resulting from a lack of maintenance/cleaning in accordance with manufacturer's instructions and/or using water/substances other than those specifically indicated (see the WHICH WATER TO USE section).
- Assembly of non-original Polti accessories or those that have been modified or which are not suitable for the appliance.

Inappropriate use and/or use not compliant with the instructions for use and any other warnings or indications contained in this manual invalidates the warranty.

Polti takes no responsibility for any direct or indirect damage to people, objects or animals caused by non-compliance with the instructions indicated in this instruction booklet, regarding warnings for use and product maintenance.

To see the up-to-date list of the Polti Authorised Service Centres, visit the website www.polti.co.uk.



POLTI®

NATURAL HOME FEELING

Scopri il mondo e l'offerta completa di Polti sul sito polti.com, iscriviti alla newsletter per restare sempre aggiornato su tutte le novità e le offerte.

Discover the world and the complete offering of Polti on polti.co.uk, sign up for the newsletter to stay up to date on all the news and offers.

Découvrez le monde et l'offre complète de Polti sur polti.fr, inscrivez-vous à la newsletter pour rester informé sur les nouveautés et offres.

Descubra el mundo y la oferta completa de Polti en el sitio web www.polti.com y suscríbase a la newsletter para estar al día de todas las novedades y ofertas.

Entdecken Sie die Welt und die Angebote von Polti auf www.polti.com und abonnieren Sie unseren Newsletter, um immer über die Neuheiten und Angebote auf dem Laufenden zu bleiben.

Descubra o mundo e a oferta completa da Polti no site polti.com, assine a newsletter para se manter atualizado sobre todas as novidades e ofertas.

www.polti.com



REGISTRA IL TUO PRODOTTO
REGISTER YOUR PRODUCT
ENREGISTREZ VOTRE PRODUIT
REGISTRA TU PRODUCTO
GERÄTREGISTRIERUNG
REGISTRE O SEU PRODUTO

SN:

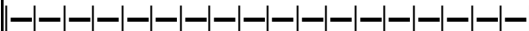

CALL CENTER

ITALIA SERVIZIO CLIENTI	800 162 162
FRANCE SERVICE CLIENTS	04 78 66 42 12
ESPAÑA SERVICIO AL CLIENTE	900 53 53 28
PORTUGAL SERVIÇO AO CLIENTE	707 780 274
UK CUSTOMER CARE	0161 813 2765
DEUTSCHLAND KUNDENDIENST	03222 109 472 9

OTHER COUNTRIES, PLEASE VISIT WWW.POLTI.COM



POLTI S.p.A. - Via Ferloni, 83
22070 Bulgarograsso (CO) - Italy
www.polti.com

Follow us:

