

ASSEMBLY INSTRUCTIONS

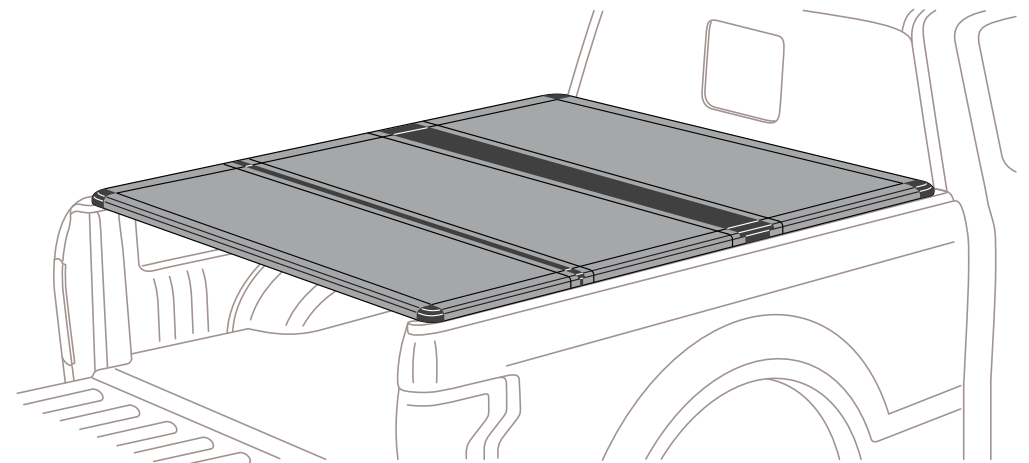

Tri-Fold Hard Tonneau Cover With Tailgate Light Strip

Part List

①	X1	Cover Assembly
②	X6	Clamp Foam Pad
③	X1	Seal Strip
④	X2	Replacement Hinge
⑤	X4	Mounting Block (for Toyota/Nissan/Jeep ONLY)
⑥	X1	Allen Wrench (for Toyota/Nissan/Jeep ONLY)
⑦	X2	Bulkhead Seal Sticker (for Tacoma ONLY)
⑧	X1	7-Way Modular Trailer Harness
⑨	X1	Corrugated Tube
⑩	X5	Zip-Tie

⚠ Warning:

1. Tonneau cover must be completely secure in the closed position or opened position while driving. DO NOT DRIVE with cover in partially opened position.
2. Clean the debris before fold the tonneau cover.
3. Professional installation would be highly recommended.
4. Period check to ensure all clamps remain secure and tight.
5. Remove the tonneau cover before tow the truck from rear.
6. Do not drive without safety clamps.
7. Check the hinge before fold or unfold during installation. If any damage found, do not use the cover and contact us.
8. The tailgate signal light may interfere with parking sensors or activate trailer mode.
9. Secure wire harness in safe areas to avoid pinching, splicing, overheating, and any potential moving parts under or around underside of truck.

Step 1:

1. Clean the bulkhead and bedrail before installation.
2. For Tacoma truck stick the seal sticker on the bulkhead bar.
3. Stick the seal strip onto the bulkhead.

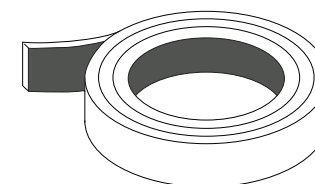
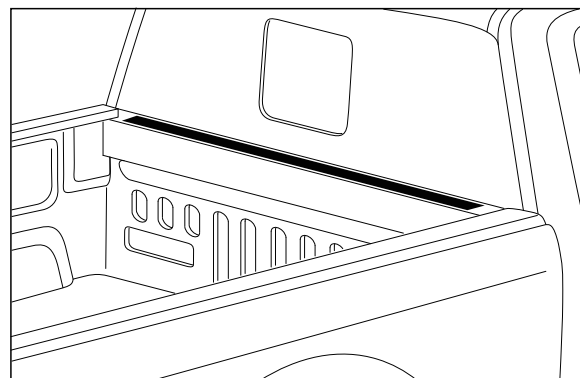

Step 2:

1. Place cover assembly on front truck bed rail against the cab. Leave the wire harness out of the truck bed.
2. Release safety buckles.

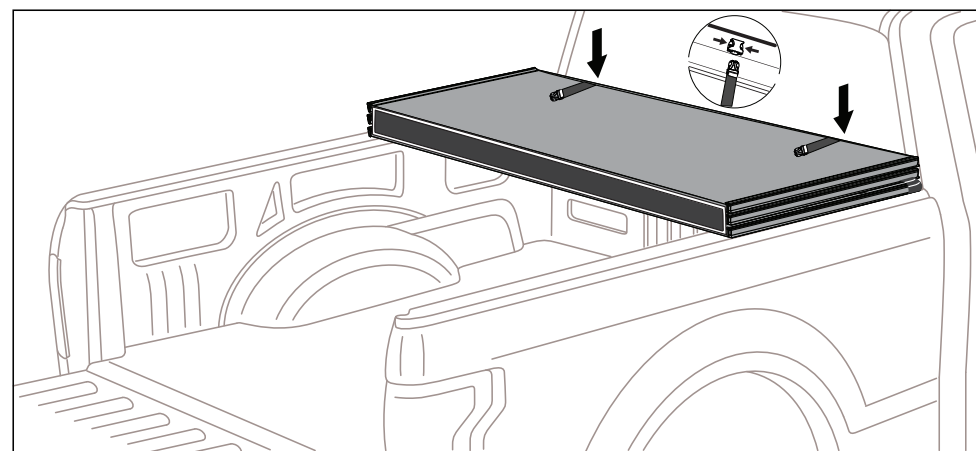

Step 3:

1. Fully unfold the cover towards rear.
2. Ensure the cover aligns on truck bed.

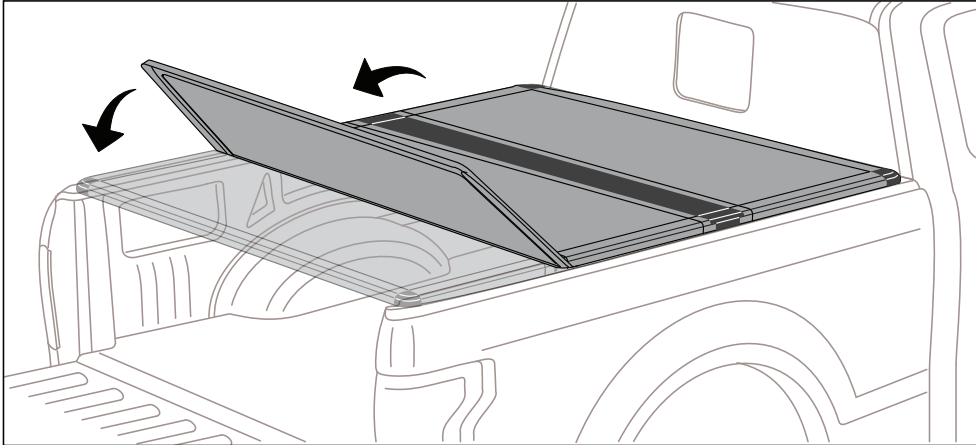

Step 4:

Carefully refold the cover without moving position on the truck bed.

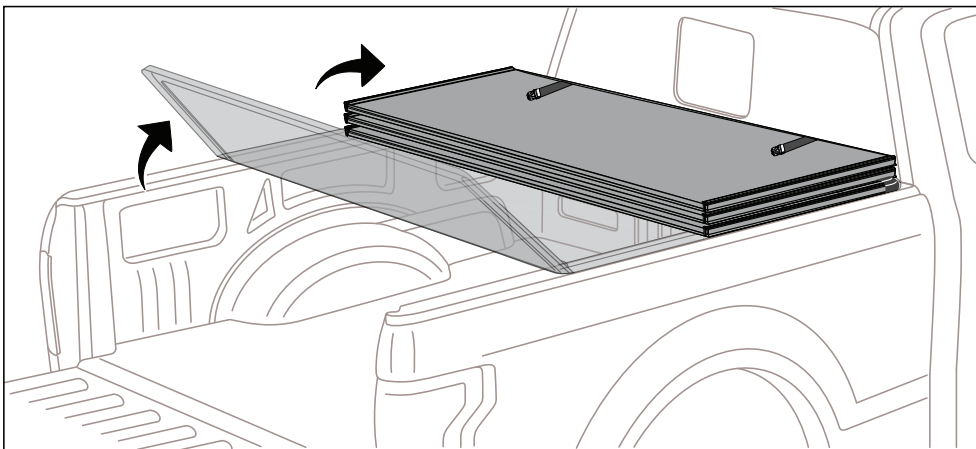

Step 5:

1. Pull down the front clamp to vertical position.
2. Loosen the knob and slide front clamp to bed rail.
3. Stick the clamp pad to mounting position on bed rail.
4. Hook the J-shaped clamp under the metal bed rail lip and tighten the knob.

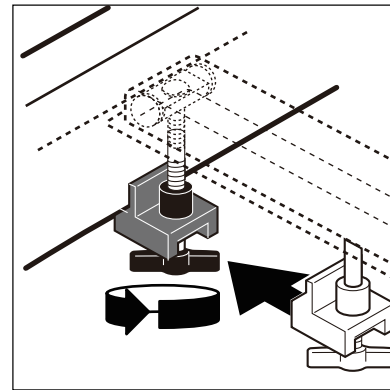

Note:

Hand tighten ONLY. DO NOT over tighten.

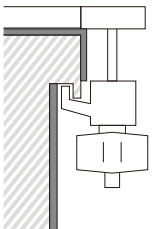
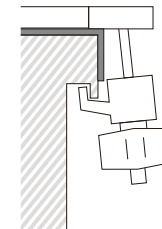
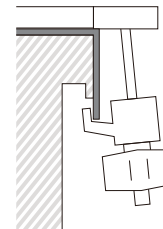
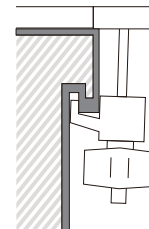

The clamps may not precisely vertical.

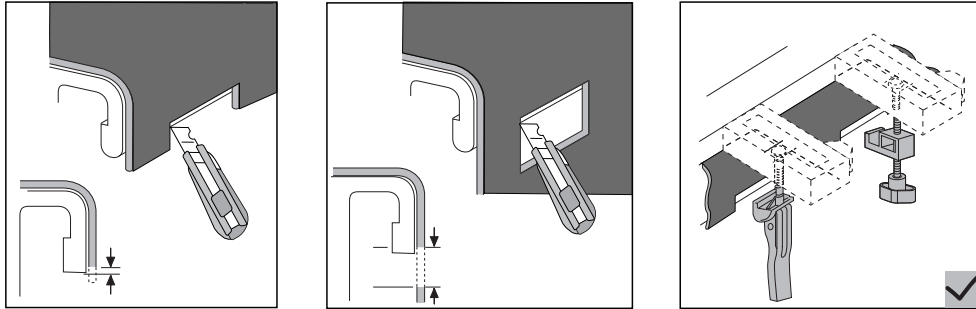

Step 6:

1. Loosen the safety clamp and attach to the bed rail lip on both side.
2. Hand tighten the knob clockwise. DO NOT use wrench or overtighten.
3. Adjust the strap to proper length. and pull the the other end of the strap to tight.

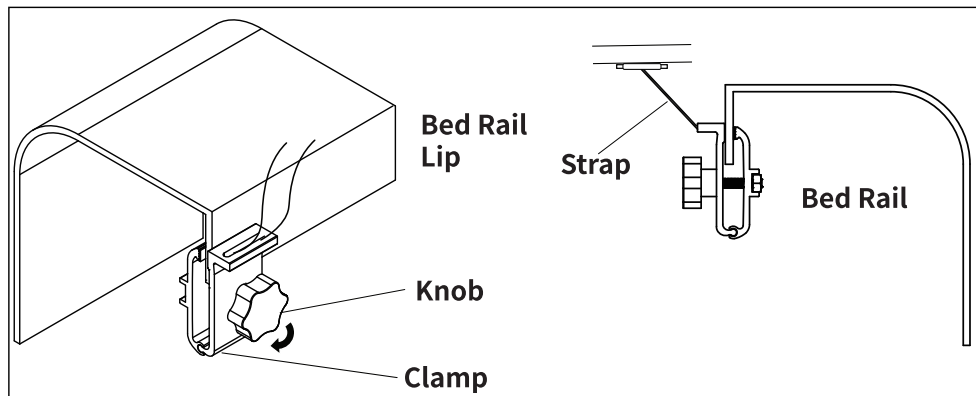

Step 7:

Carefully unfold the cover and secure the rear clamps.

1. Pull down the rear clamp to vertical position.
2. Slide rear clamp to bed rail.
3. Stick the clamp pad to mounting position on bed rail.
4. Turn the clamp handle to adjust rear clamp to proper length.
5. Hook the J-shaped clamp under the metal bed rail lip and push the clamp handle to vertical position.

Note:

The clamps may not precisely vertical.

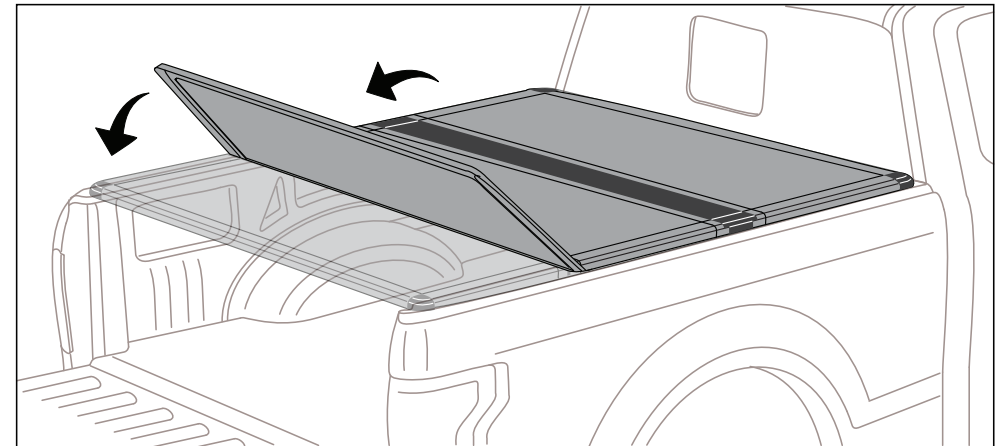

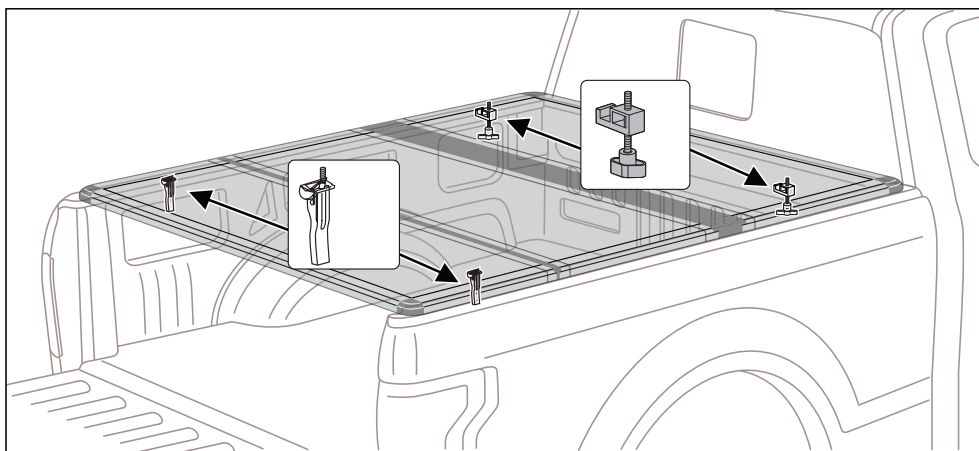
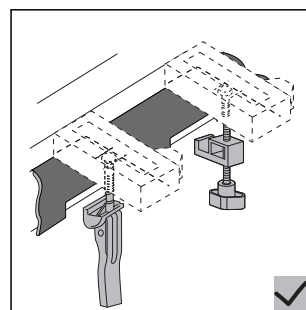
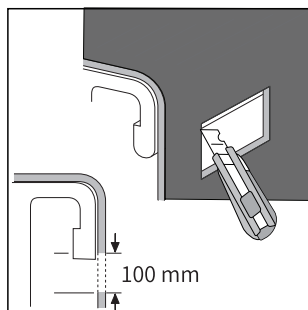
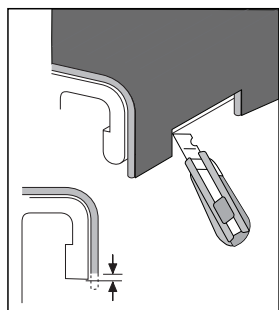
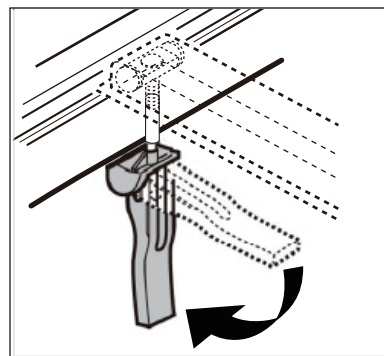
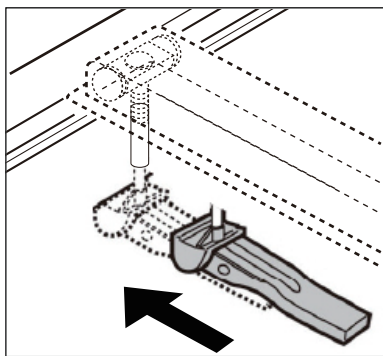

Step 8:

1. Feed the tonneau cover wire through the corrugated tube.
2. Run the tonneau cover wire harness down the gap between the cab and truck bed.



Step 9:

1. Disconnect 7-way trailer harness plug behind the rear bumper.
2. Attach the modular wire harness to 7-way trailer port and re-attach the plug from to the second port on modular wire harness.



Step 10:

1. Run tonneau cover wire harness to rear of the truck and attach to modular wire harness.

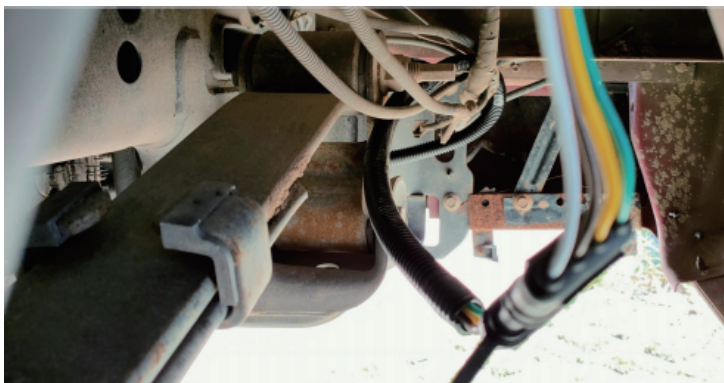

Step 11:

1. Secure remaining loose/hanging wires to truck body panel or frame rail using zip-ties.
2. Temporary remove the inner fender liner if equipped, and use the fender liner to isolate the wire harness.



Run tonneau cover wire harness along the driver side factory harness.



Secure the wire harness on the exist mounting holes on body panel or frame rail.

Step 12 (Optional):

1. Some vehicles may activate trailer mode after the trailer wire engaged, and automatically disable the rearward parking sensor. For this special circumstance, it requires self-wiring.
2. Discard the 7-way modular trailer harness.
3. Cut off the 4-pin tonneau cover wire harness plug.
4. Wire the white wire to the vehicle frame electric ground pole.
5. Wire the yellow wire to the left turn/brake light (driver side taillamp).
6. Wire the green wire to the right turn/brake light (passenger side taillamp).
7. Wire the brown wire to the tail light (rearward running light).



Function	Color
Ground	White
Tail Light	Brown
Left Turn/Brake	Yellow
Right Turn/Brake	Green

Fold up the Cover:

1. Open the tailgate.
2. Release and fold up the rear clamps.

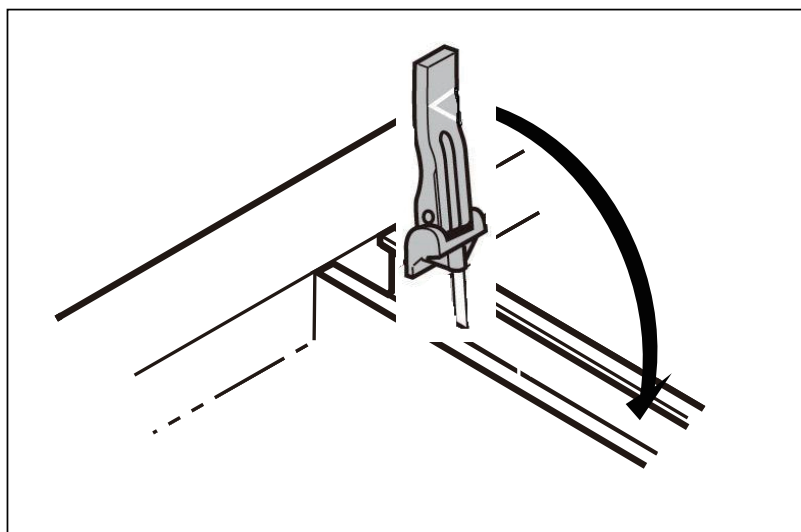
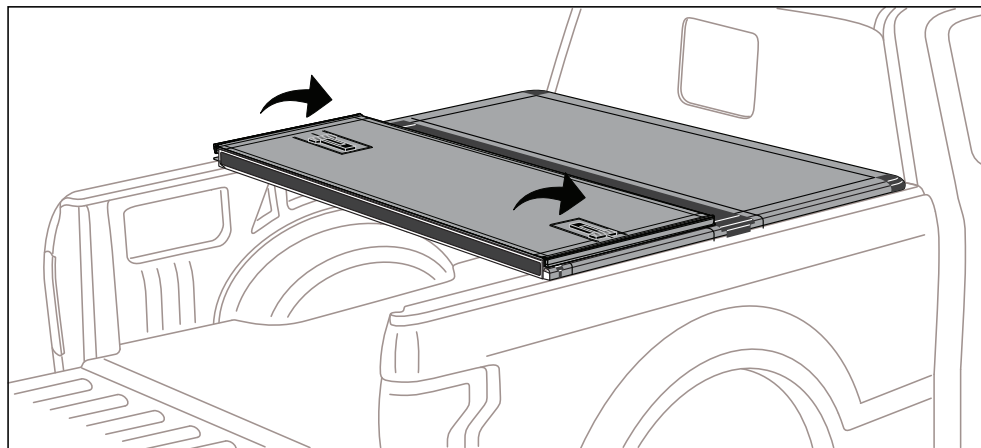

3. Fold up the cover towards front.
4. Secure the safety buckles.

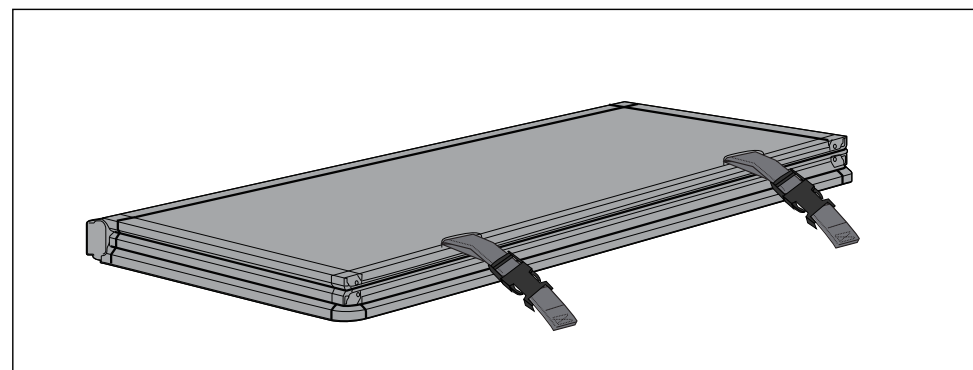
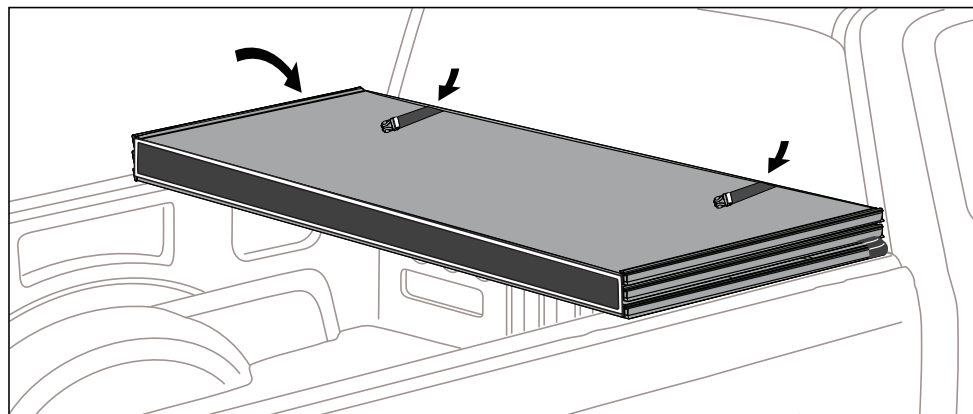

5. After the tonneau cover installed, periodic check to ensure all clamps and buckles remain secure and tight.

Special Instruction for Trucks with Utility Rail:

For trucks with utility rail:

1. Slide mounting block into track rail.
2. Attach front clamps onto mounting block.
3. Attach center and rear clamps onto mounting block.
4. Tighten set screw on mounting block.

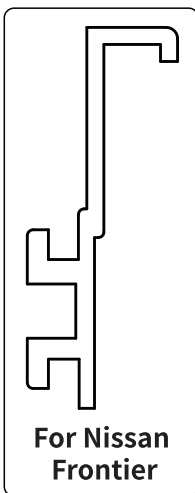
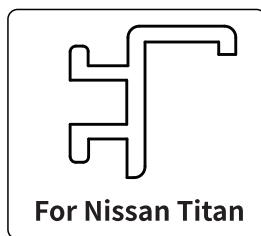
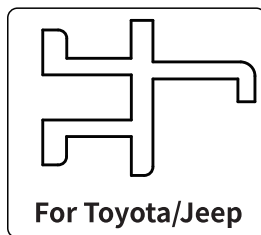
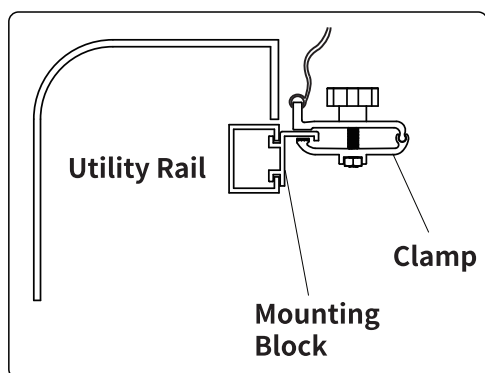
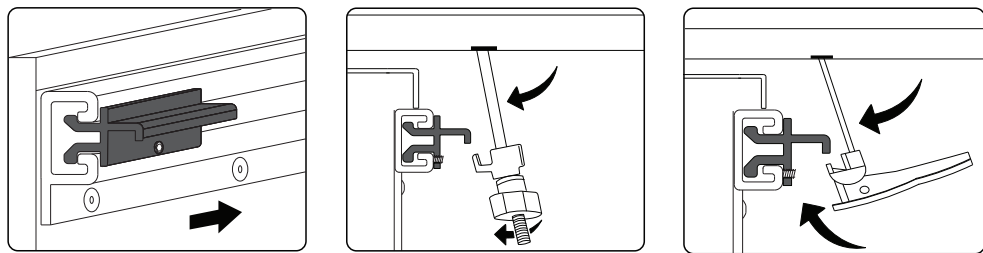

Special Instruction for Tacoma Trucks:

1. Remove the bulkhead bar.
2. Stick the seal on both ends of bar.
3. Install the bulkhead bar back.

