

Tuya Smart App User Manual

--For smart lock

Shenzhen Eversunny Ltd

No 1

Download App

To download the App, search for "TuyaSmart" in any app store, or scan the QR code below



No 2

Register/ Log in/ Password retrieval

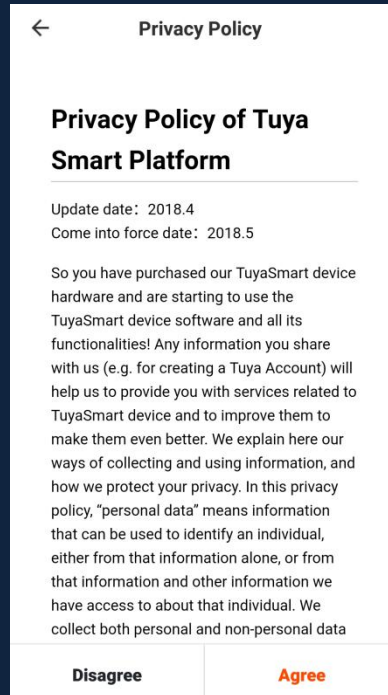
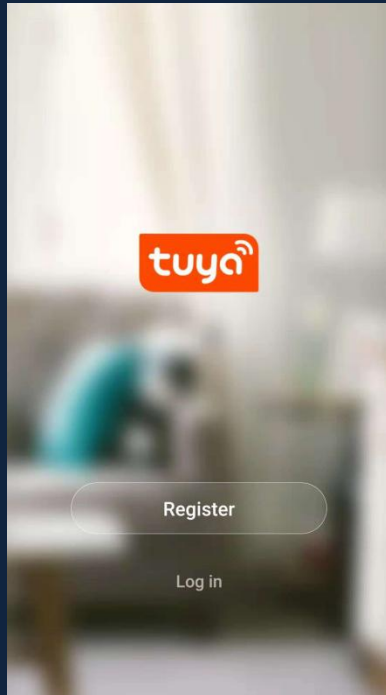

2.1 Registration:

If you do not have an app account, you may choose to register text message authentication. The registration process is described on this page and the next.

2.1.1 Click "Register" to go to the TuyaSmart privacy policy page. Click Agree to proceed to the mobile phone number registration page

No 2

Register/ Log in/ Password retrieval

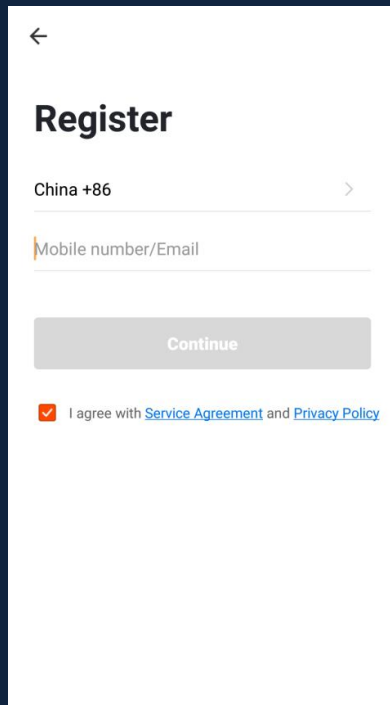

←

Register

China +86 >

Mobile number/Email

Continue

☒ I agree with [Service Agreement](#) and [Privacy Policy](#)

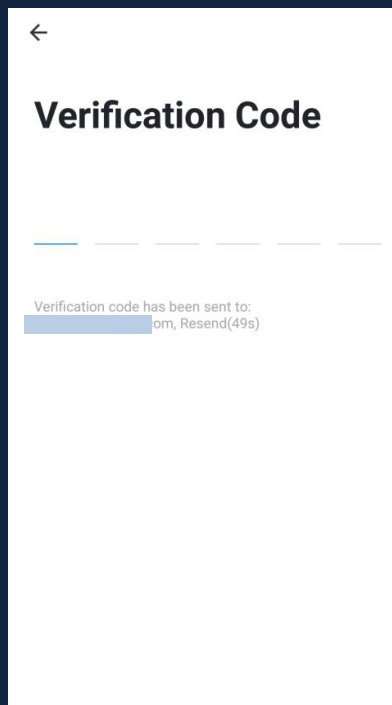

←

Verification Code

Verification code has been sent to: [redacted]om, Resend(49s)

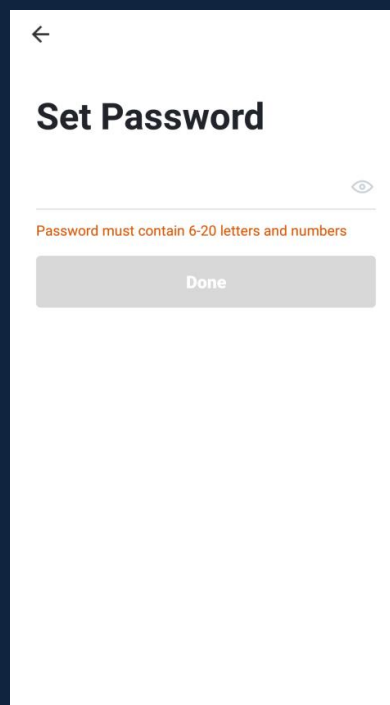

←

Set Password

Password must contain 6-20 letters and numbers

Done

2.1.2 The system will identify automatically the country/region you are in, or you may choose to select manually a country/region. Enter your mobile phone number or email and click “Continue” to get Verification code, and then set password as shown in the picture. (It is recommended to register by email)

No 2

Register/ Log in/ Password retrieval

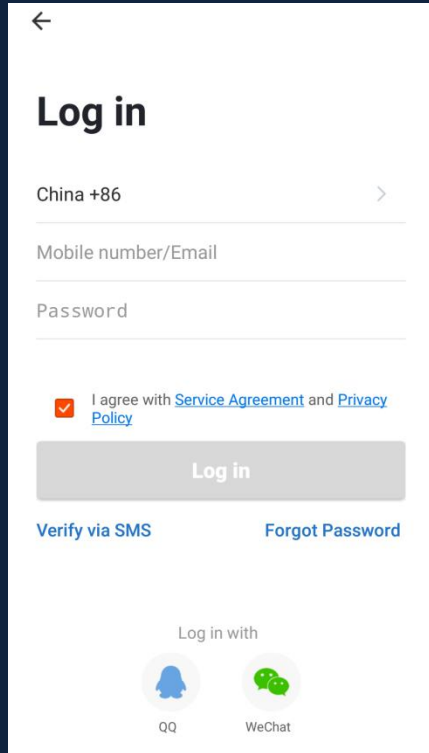

←

Log in

China +86 >

Mobile number/Email

Password

☒ I agree with [Service Agreement](#) and [Privacy Policy](#)

Log in

[Verify via SMS](#) [Forgot Password](#)

Log in with

QQ WeChat

2.2 Log in

If you already have an app account, click “Log in” with existing account to proceed to the log in page

2.2.1 The system will identify automatically the country/region you are in, or you may also choose to select manually a country/region

2.2.2 Enter the mobile phone number or email you have registered and enter the password in to log in

2.2.3 Third-Party Social Login (China only) If you have already installed WeChat on your mobile phone, click the WeChat icon in Social Login and proceed through the authorization page to log in.

No 2

Register/ Log in/ Password retrieval

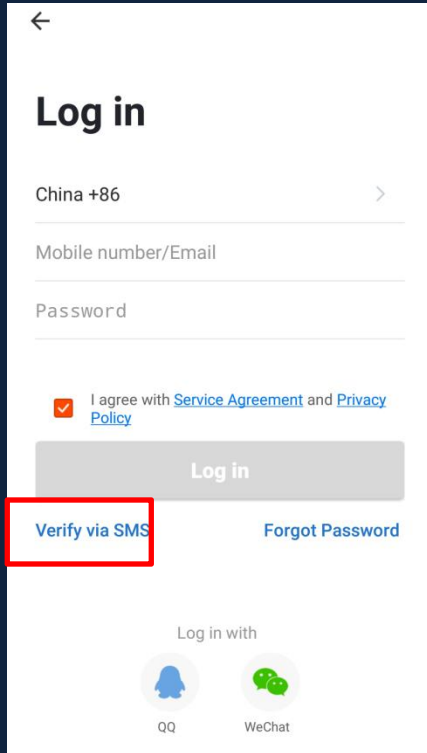

←

Log in

China +86 >

Mobile number/Email

Password

☒ I agree with [Service Agreement](#) and [Privacy Policy](#)

Log in

Verify via SMS

Forgot Password

Log in with

QQ WeChat

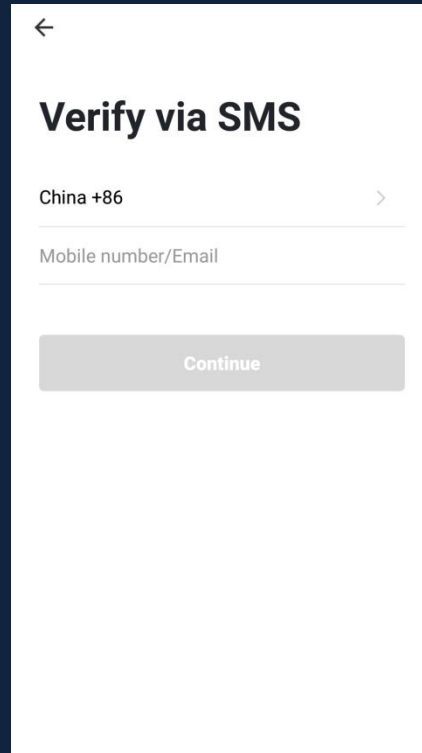

←

Verify via SMS

China +86 >

Mobile number/Email

Continue

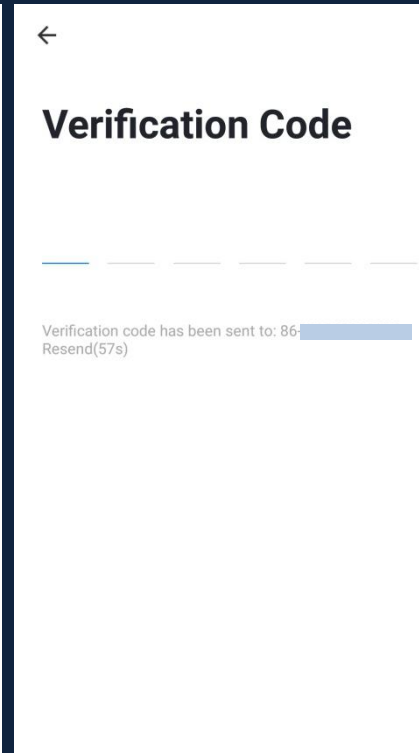

←

Verification Code

Verification code has been sent to: 86- Resend(57s)

2.3 Verify via SMS

Click “Verify via SMS” and then enter your phone number or Email to get verification code.

No 2

Register/ Log in/ Password retrieval

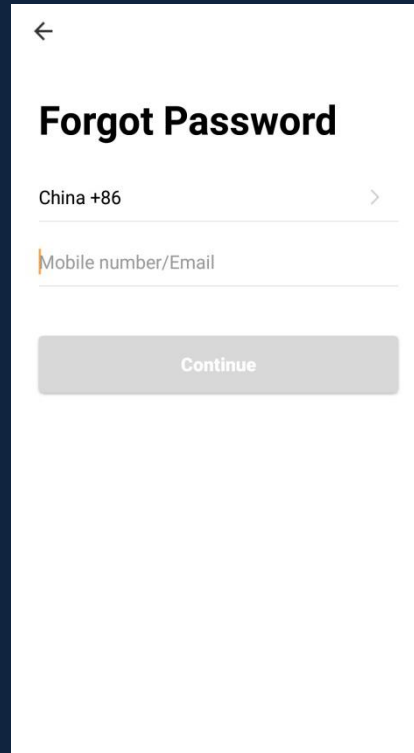
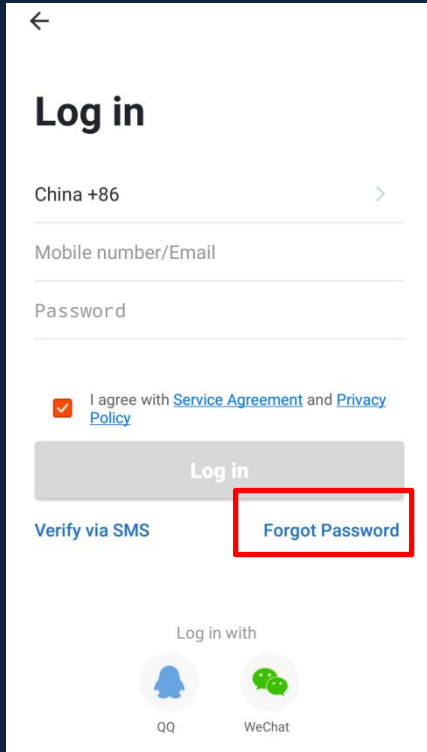

2.4 Password retrieval

If you forgot your app password, you can reset your password by following the Password Retrieval procedure

2.4.1 Click "Forgot Password" , as shown in the first picture,

2.4.2 The system will identify automatically the country/region you are in, or you may choose to select manually a country/region. Enter the mobile phone number or email you used to register and click "Continue" , as shown in the picture.

No 2

Register/ Log in/ Password retrieval

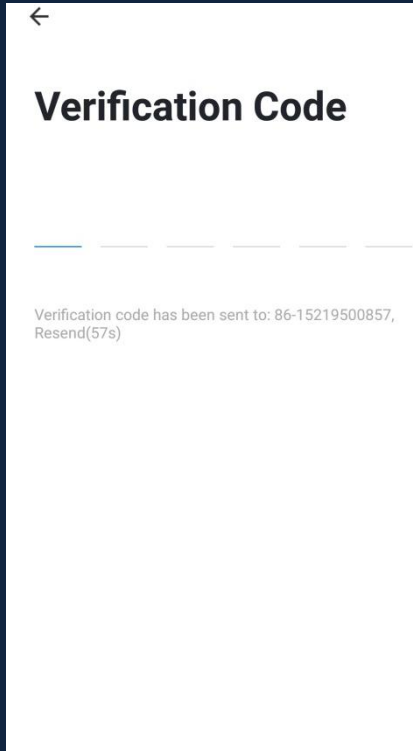

←

Verification Code

— — — — —

Verification code has been sent to: 86-15219500857,
Resend(57s)

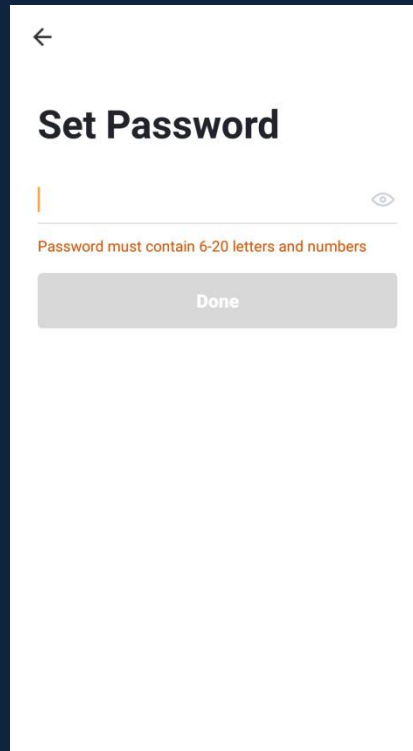

←

Set Password

| 

Password must contain 6-20 letters and numbers

Done

2.4.3 Enter the authentication code sent to your mobile phone number or email,

2.4.4 Reset the password and Enter the new password to log in.

No 3

Household/ Member Management

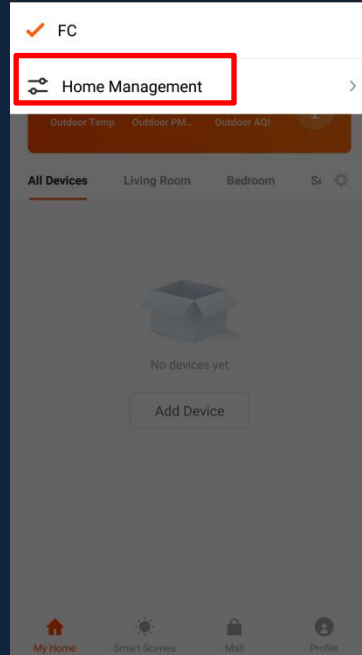
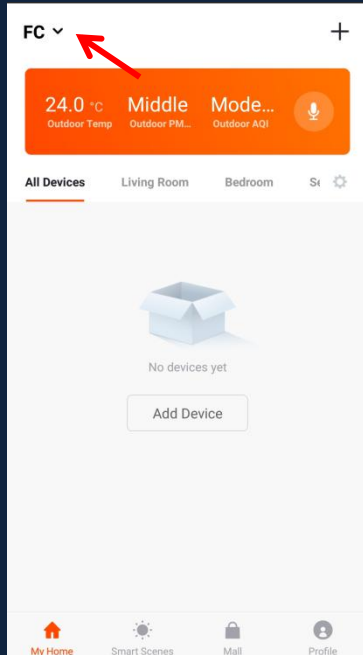

Click the pull-down arrow at the top left corner of “FC” to add a household and manage households. One account can manage multiple households at the same time. The user can operate a device in a household by selecting it in the household menu.

No 3

Household/ Member Management

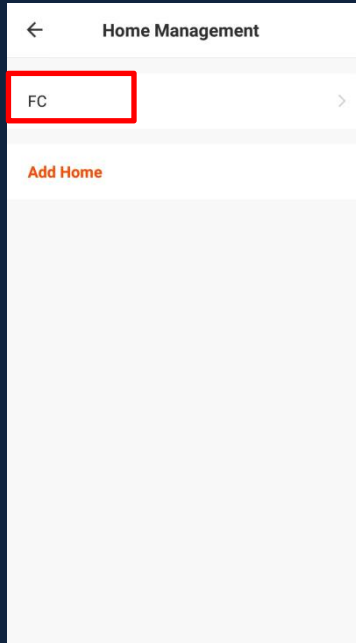

3.1 Home Management

Click "FC" to enter home management page

Other household members can enjoy control of smart devices in the household, but will not be able to modify, add, or delete a device

No 3

Household/ Member Management

3.3 Combine and classify administrative access of different individuals to devices. All devices and smart scenarios in a household can be shared among household members without having to complete the sharing settings each time

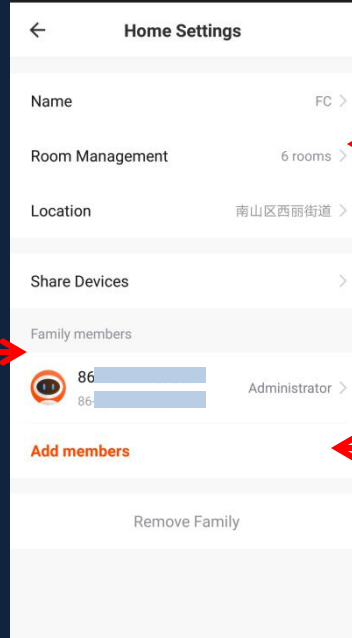

3.2 Add/Delete rooms in a household and manage all room settings in a household in one place

3.4 Add members

Other household members can enjoy control of smart devices in the household, but will not be able to modify, add, or delete a device

No 4

Add Device

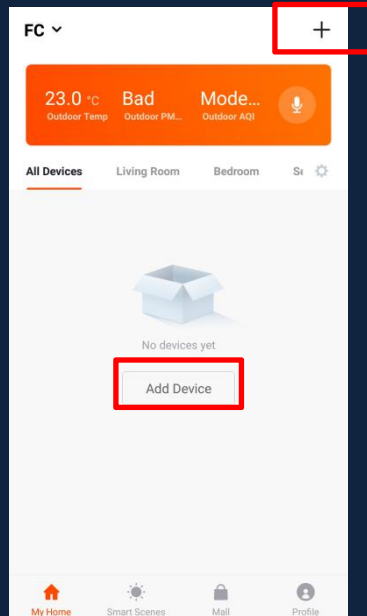

4.1 Click "Add Device" on the app home page or the "+" sign at the top right corner to go to the "All Devices" page, where devices can be selected and added as necessary

* A password administrator needs to be set in advance for verification use when adding device.

No 4

Add Device

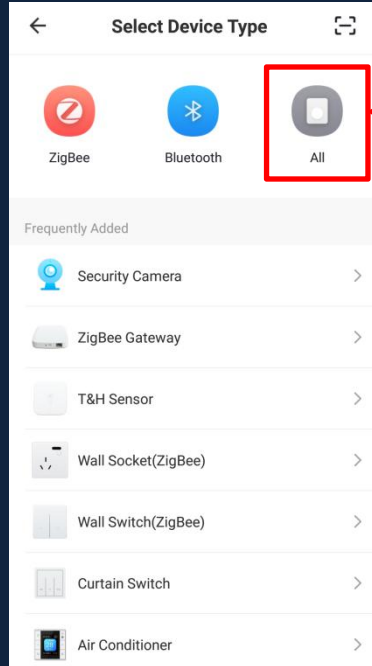

4.2 Click “All” to choose device

4.3 Find and click “Lock” as shown in the picture

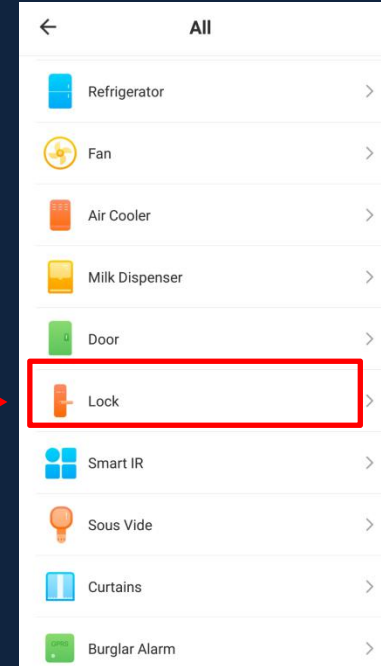

No 4

Add Device

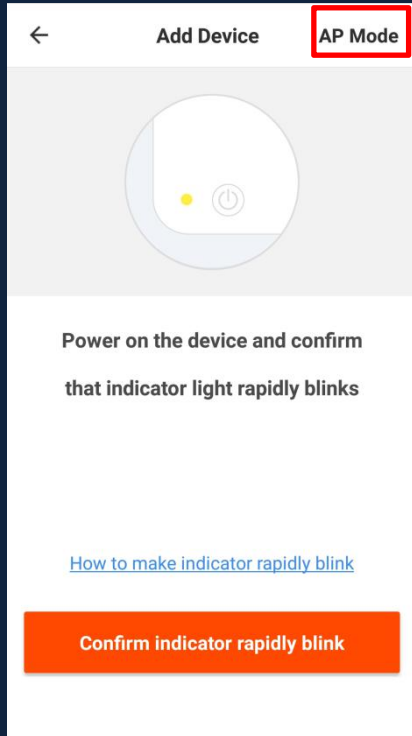

4.3.1 The app supports two configurations: Default mode and Compatibility mode. Click "Compatibility mode" at the top right corner of the "Default mode" home page to switch between modes

4.3.2 To select "Default mode" , please make sure the indicator light on the smart device is flashing rapidly (blinking twice per second) and then click the button to proceed to the next step

No 4

Add Device

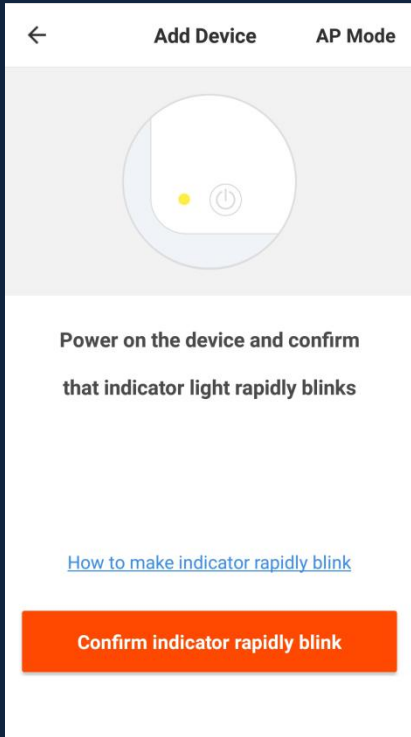

4.4 Awake the lock pad, press "3"+"#" after verified admin. You'll see "8" on the pad flash quickly, then you can click "confirm indicator rapidly blink" to continue adding device.

* Please make sure your phone is connected with wifi

No 4

Add Device

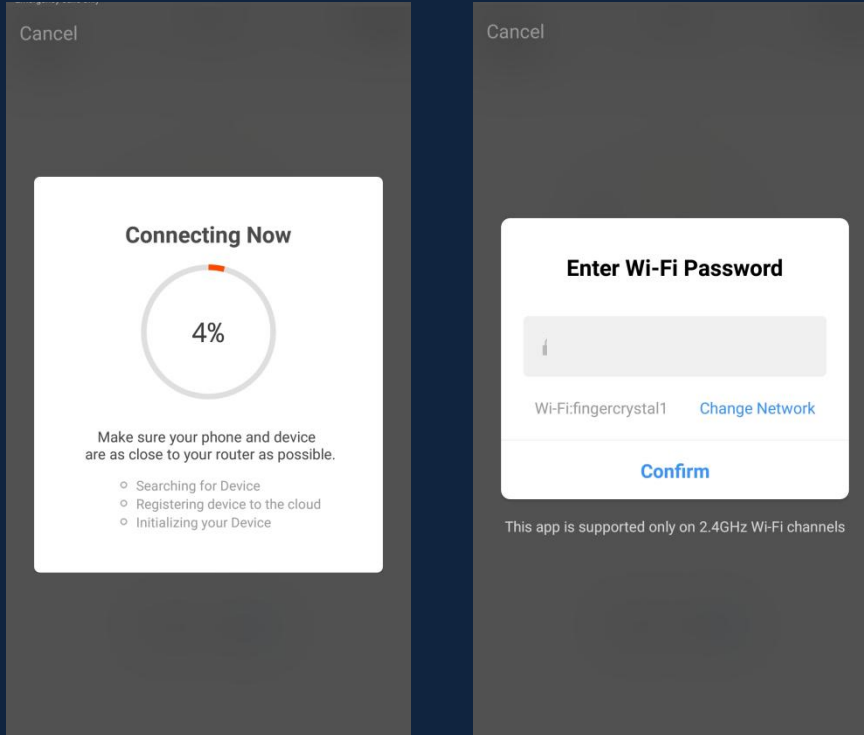

4.5 Connecting

There will be a prompt from the lock when connecting succeed

Please make sure that your wifi channel is 2.4G.

No 4

Add Device

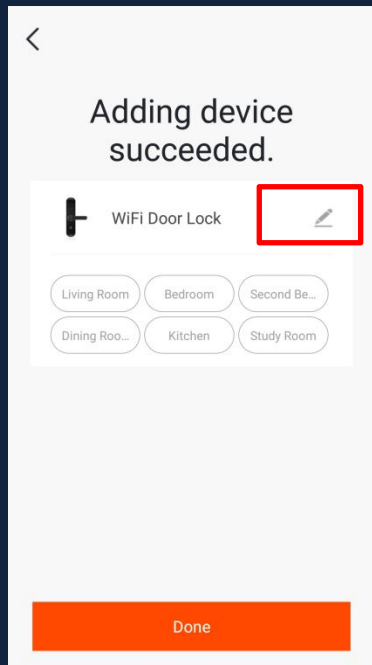

4.6 Finish adding device

4.6.1 Adding succeed, you can change the name, etc

4.6.2 Click “Done” to enter the remote control page

No 5

Remote Control

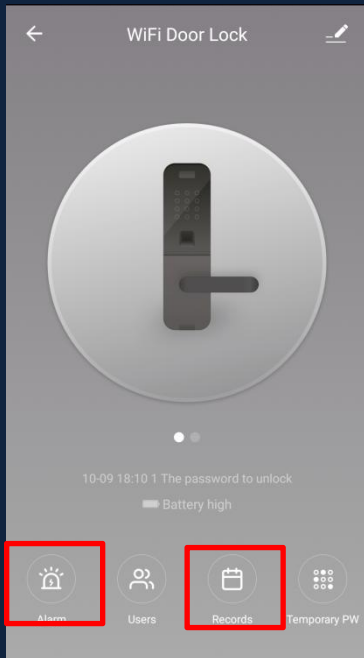

5.1 Related functions

5.1.1 Click “Alarm” to check the battery state

5.1.2 Click “Records” to check the unlock records

No 5

Remote Control

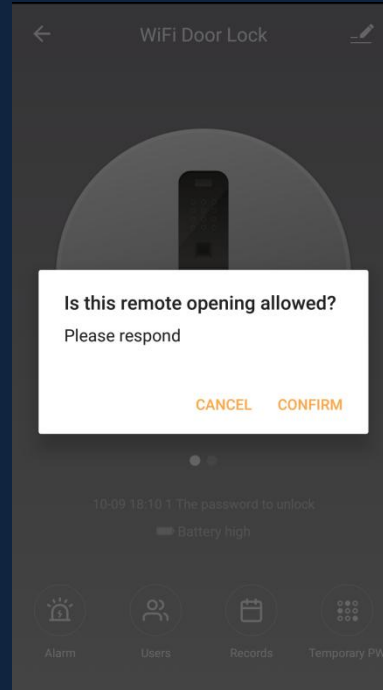
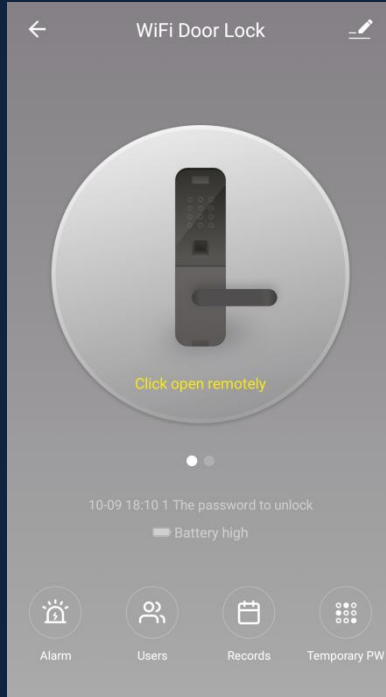

5.2 Remote Unlock

5.2.1 Press “4” + “# ” on the lock pad

5.2.2 The App will ask for your confirmation to open remote

5.2.3 Click "CONFIRM" to unlock

No 5

Remote Control

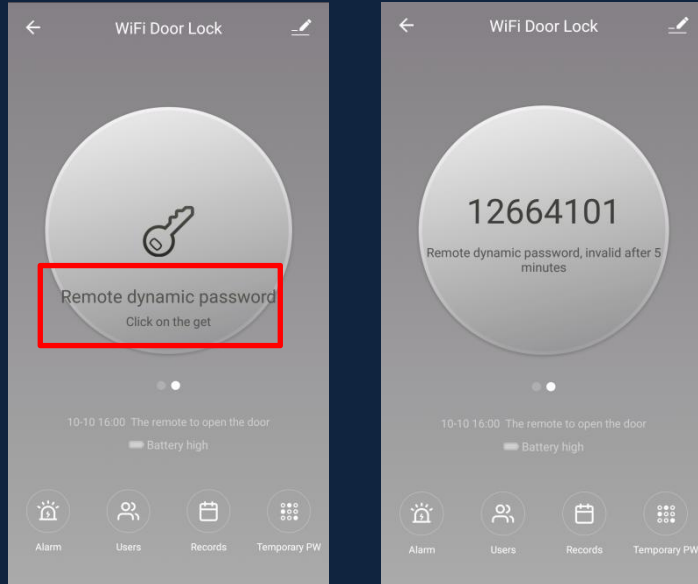

5.3 Dynamic Password

5.3.1 Click phone screen and you will get dynamic password

5.3.2 Enter the dynamic password to unlock

No 5

Remote Control

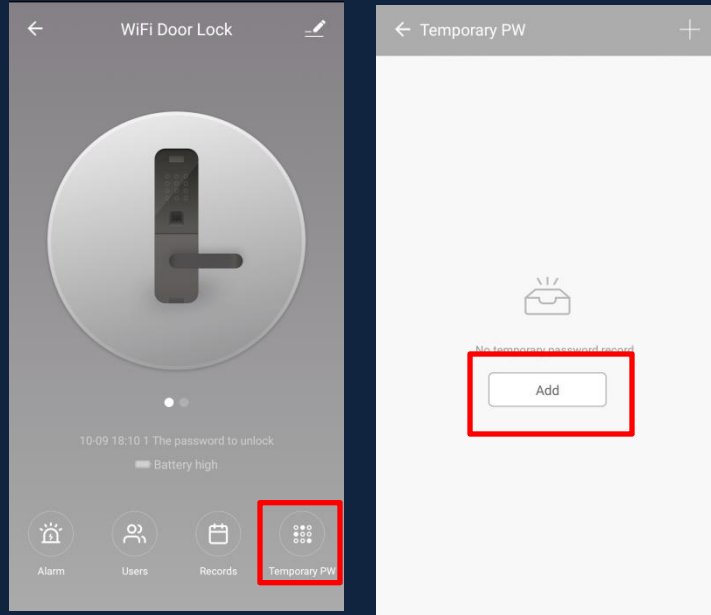

5.4 Temporary Password

5.4.1 Click on the left bottom to set Temporary password

5.4.2 Click “Add”

No 5

Remote Control

5.4 Temporary Password

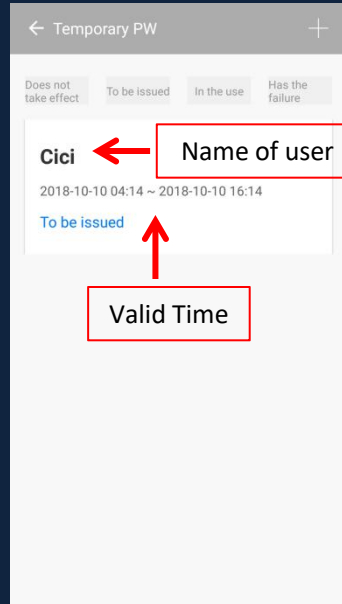
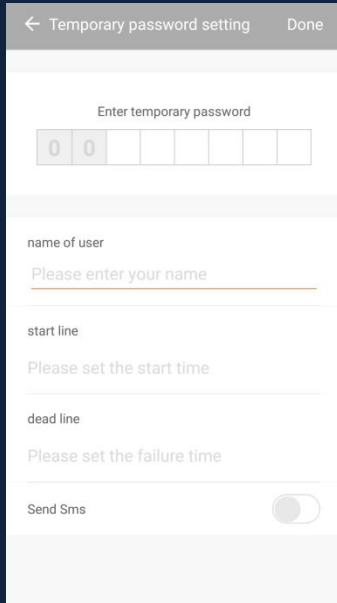

5.4.3 Set your own Temporary password, name of user, and the start and dead time.

5.4.4 All finished, click “Done” on the top right to exit temporary password setting and you will see page as pic.2 shows.

5.4.5 Awake the lock pad, enter “00” plus the 6 codes you set, then the lock can be unlocked.