

1. 下載 SmartHome 應用程式，創建並登入賬戶。

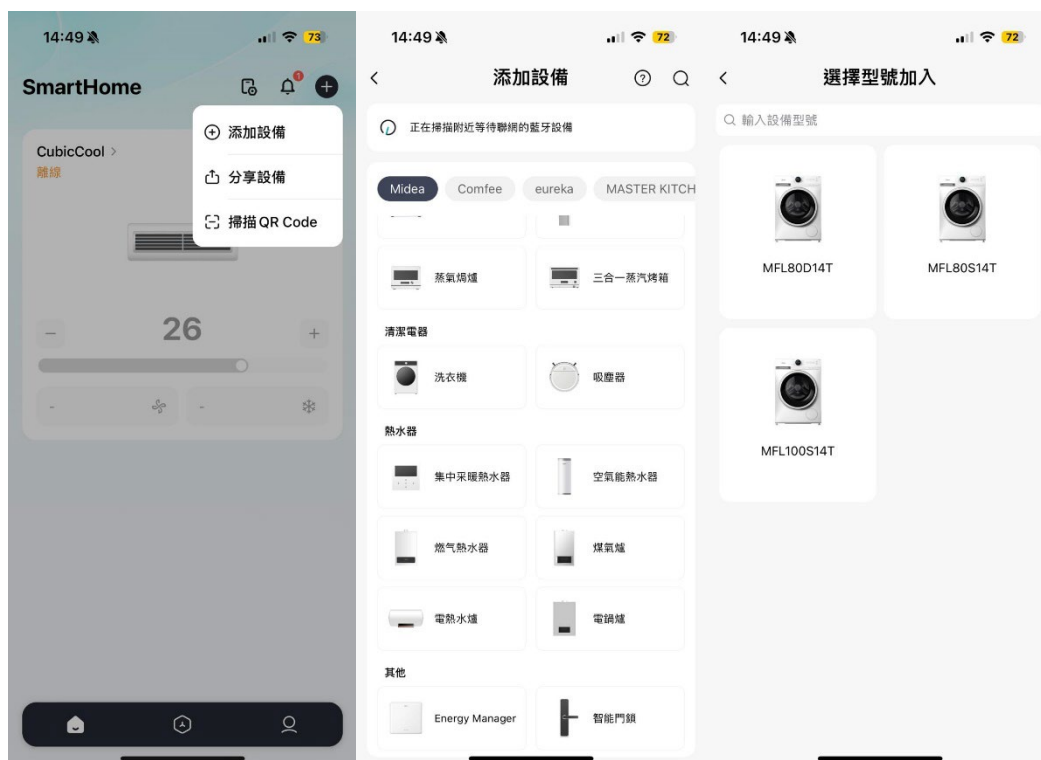

2. 手機連接至家中 WiFi 無線網絡。
3. 手機開啟'藍牙'及'定位'服務。
4. 開啟洗衣機電源。
5. 任意旋轉旋鈕，指示其中一個程序。
6. 打開 SmartHome 應用程式。

7. 手動選擇‘添加設備’>‘Midea’>‘洗衣機’>選擇型號。



8. 選擇無線網絡進行聯網。





9. 長按面板上【】鍵直至顯示屏上出現‘AP’。



10. 返回手機'設定-WiFi'，連接至應用程序上提及的洗衣機無線網絡。



11. 圖標常亮，連接成功。

12. 長按  鍵，直至顯示屏上  圖標亮起，啟動遠程控制。

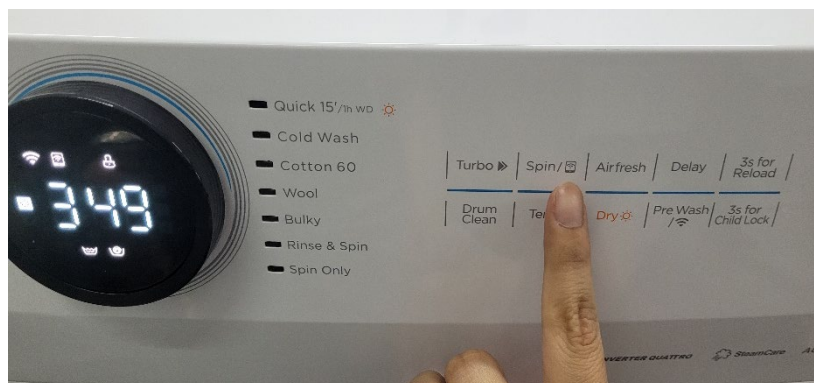

1. Download the SmartHome App, create an account and log in.

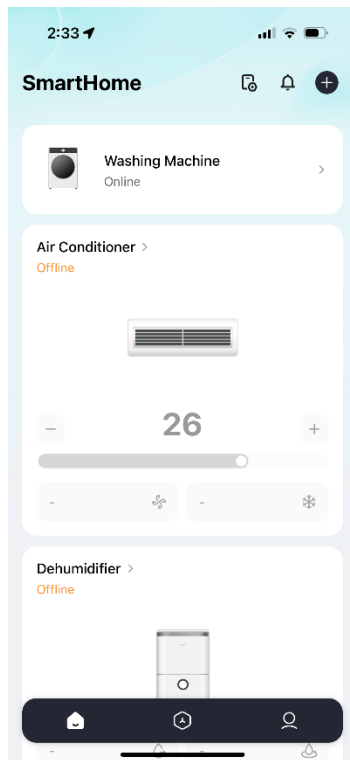

2. Connect your smartphone to the home wireless network (WiFi connection).
3. Turn on the 'Bluetooth' and 'Location Services'.
4. Power on the washing machine.
5. Turn the knob to select any program.
6. Open the SmartHome App.

7. Manual selection 'Add device' > 'Midea' > 'Washing Machine' > model no.

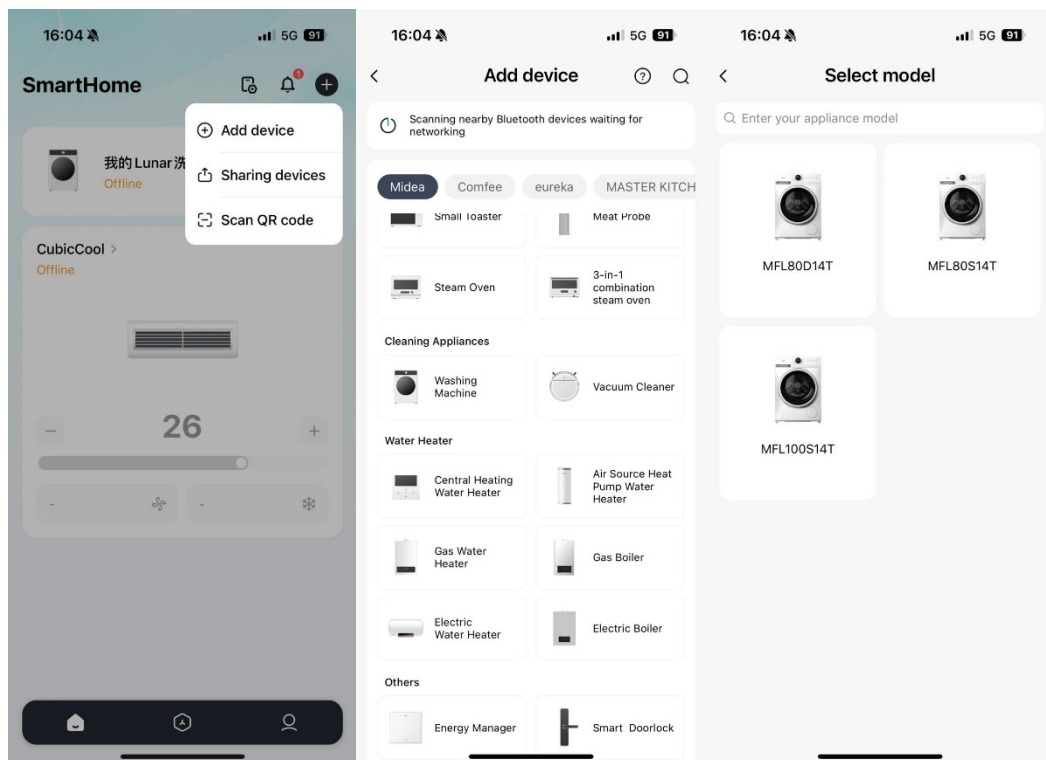

8. Select the wireless network for washer to connect.

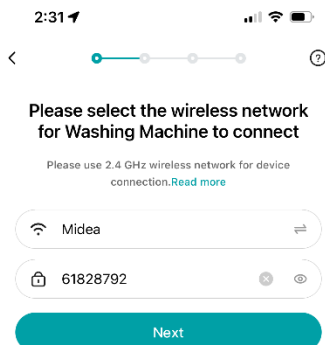



9. Long press button on the panel, until the display screen shows 'AP'.

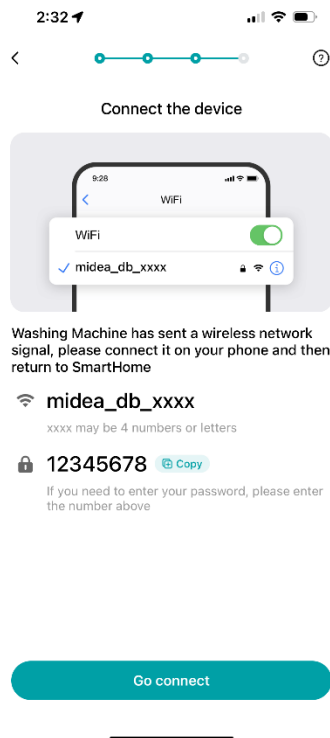

10. On your smartphone 'Settings-WiFi', connect to the washer's wireless network which mentioned on the App.



11. icon light on, successfully connected!

12. Long press  button until the display screen  icon light on, to activate remote control.

