

双胶纸80g4C 骑马订

CUSTOMER SERVICE

Vivid Chameleons & Habitats is here to support all of our products. If there are any questions or concerns, please contact us from below information. Thanks much and we look forward to speaking to you!

Contact: info@vchams.com
Phone Number: 626-382-4367
Website: www.vchams.com

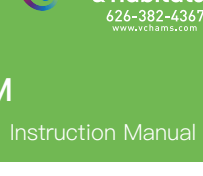

AUTOMATIC MISTING SYSTEM

Model: VC004

Instruction Manual

Name of Product Details

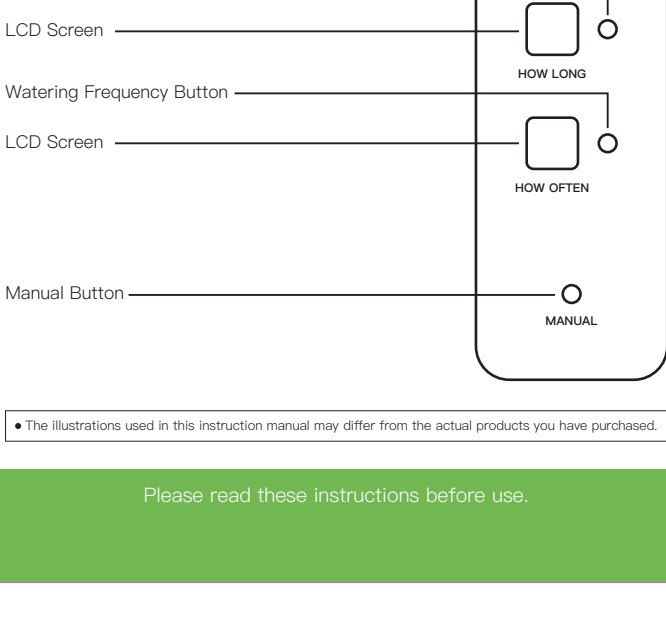

Please read these instructions before use.

IMPORTANT SAFETY INSTRUCTIONS

When using the Misting Pump, please follow some basic guidelines:

- Part 1**
1. Use DC 5V/2A power adapter to power on pump.
 2. Do not use this device in the extreme cold or hot condition.
 3. Keep the black tube away from heated surfaces to prevent deformation.
 4. The device is not waterproof, do not immerse it into the water to clean it, or disassemble the device to clean it.

- Part 2**
1. Do not assemble the equipment when it is power ON.
 2. Always unplug the outlet tube before performing any routine maintenance.
 3. If the device drop into water accidentally, please quickly take the pump out and use a blow dryer to dry it thoroughly.
 4. Do not forcefully pull the fittings apart or rip the tubes out of the fitting directly.
 5. Only use the provided accessories parts for the device.
 6. Do not unscrew the tip of the nozzle when you receive the system. Only unscrew the nozzle tip to unclog tip.
 7. Never use the misting system if it contains damaged cord or power adapter. Do not use the system if the Misting Pump is damaged.

- Part 3**
1. This device is not for children under 12 years old, unless they are supervised by adults.
 2. Any question, don't hesitate to contact us via email: info@vchams.com

INCLUDED IN PACKAGE

Parts Included	Name	PCS	Description
	Timer Pump	1	Pump with timer settings misting time
	Distribution Hose	1	Length: 5m/16ft Outside diameter of pipe: 1/4"
	Filter	1	Filtering impurities from water
	End Plug	1	Stop water flow at the end of the tubing
	Nozzle	2	1/4-inch Detachable 360° Rotation Misting Nozzle.
	Suction Cup	2	Install in the bottom of device and sucks on glass or other non-porous surface
	USB Cable	1	Power Supply (Type-C)
	Adapter	1	Power Supply (5V/2A)
	Nylon Cable Ties	6	hanging nozzle or tubing

INSTALLATION

Before installation, please pay attention to the following aspects:

1. Power up the device and press the manual button to hear the pump sound is trying to pump water. Then hit manual button to turn the pump off.
2. Do not put the water reservoir in a position higher than the top of reptile terrariums to avoid causing the SIPHON EFFECT.
3. Make sure black tubing is properly inserted into the INLET and OUTLET port by pushing the tube all the way into the opening (see #5 below).
4. Make a neat and flat cut when do the tube cutting.
5. Push the tube into the nozzle deeply, otherwise it will cause water leak. You might thought that you pushed the tube deep enough, but in many cases the tube was not push deep enough. The tube needs to go into the opening at least 0.7 inch (1.8cm) deep.
6. Drill or cut a hole in the top mesh to create nozzle space.

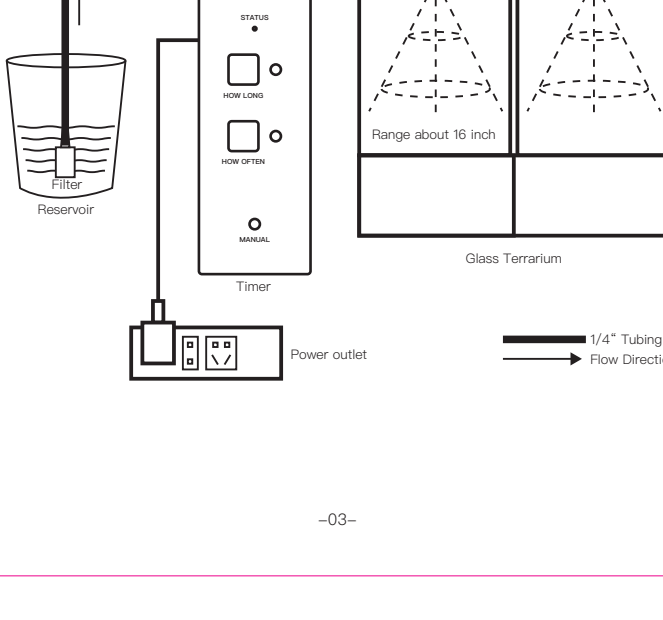

INSTALLATION Step By Step

Method 1	Method 2
For the screen top mesh terrarium that has holes for cables or tubing.	For the terrarium that has No hole for cables or tubing.

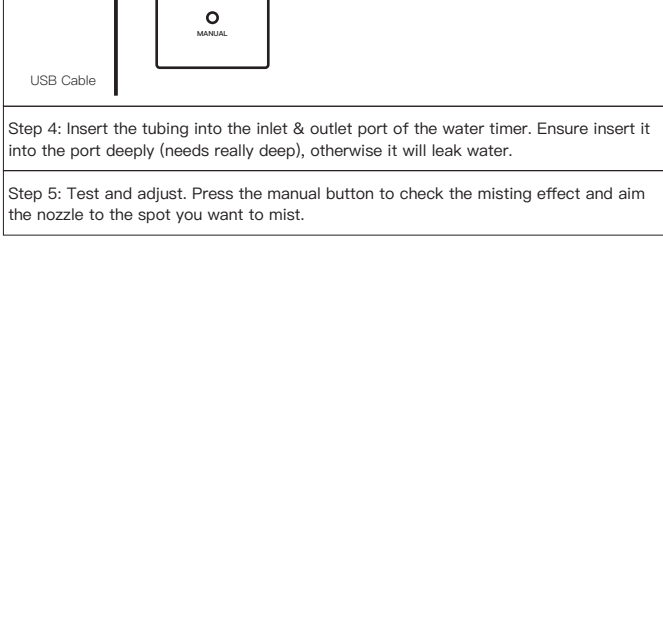

Step 4: Insert the tubing into the inlet & outlet port of the water timer. Ensure insert it into the port deeply (needs really deep), otherwise it will leak water.

Step 5: Test and adjust. Press the manual button to check the misting effect and aim the nozzle to the spot you want to mist.

PROGRAMMING INSTRUCTIONS

Part 1: Manual Misting Mode

1. Simply press the manual button to turn on/off the Manual Misting Mode. It won't disturb the exist automatic timer setting.
2. When the device in standby mode, press any button to lit the display up first, then press the "MANUAL" button to turn on the Manual Misting.
3. To stop MANUAL Misting, just press the "MANUAL" button again.
4. Active the Manual mode to check if the pump is working normal or not and any leakage from the connection parts of the hose.

Part 2: Automatic Misting Mode

Tips:

1. Press and hold the HOW LONG/HOW OFTEN button, the numeric will increase or decrease quickly.
2. Setting value increase and decrease reversing: Press the "MANUAL" button during timer setting up, then press the "How Long" or "How Often" button again; the numeric will decrease, vice versa.
3. Blue light indicators meaning:

Keep on	In setting mode
Blinking	In working mode
OFF	Standby mode

HOW LONG Setting			
Value	Meaning	Example	Step 1: Press any button on the control panel to lit the screen up.
0	No need to misting		Step 2: Press the "HOW LONG" button continuously; the numeric display will increase automatically. Press and hold the HOW LONG button, and the numeric will change quickly.
1-99	Misting 1-99 seconds		
2F, 3F, 4F, 5F	Misting 2,3,4,5 minutes		Step 3: When the desired seconds or minutes value is reached, release the button then set up the interval time.

HOW OFTEN Setting			
Value	Meaning	Example	Step 4: Press the "HOW OFTEN" button continuously; the numeric display will increase automatically. Press and hold the Interval Time button, and the numeric will change quickly.
Minutes	L1/L2/L3		Step 5: When the desired hours or days value is reached, release the button, and the device will start its first set-up misting in 5 seconds.
Hours	0.1-0.9		
Days	10-23		
Days	1-30		

Pay Attention!

1. Once a new timer has been set, do not press any button during this 5 seconds.
2. Once programmed, the timer will run continuously unless it's power off. Please add sufficient water in time to guarantee your misting needs.
3. To set up a new watering schedule, please repeat the steps above, and the unit will automatically run the new irrigation cycle.
4. The blue light should flash on and off the whole time when it is misting.
5. The programming steps mentioned above (from setting the duration time to interval time) is a suggestion. It's flexible to set them according to your preferences, which does not affect the entire programming.

TIMER EXAMPLE	
	Setting How Long= 30 How Often= 0.6 Current Time: 9:00 AM Timer Meaning Misting every 6 hours for 30 seconds, starting from now 9:00 AM. Then the circulation of the timer is: 09:00 ---15:00 ---21:00---3:00 ---09:00... Interval time 6 hours
Note: The device does not have an internal clock to let you pick a specific start time. If you need to set it to mist everyday at 7 am, just do the steps at 7 am and it will then mist everyday at 7 am.	

SPECIFICATIONS

Adapter Input: AC 100~240VAC 50/60Hz
Adapter Output: 5V/2A
Power: 10 Watt
Working Temperature: 0~40°C/32~104°F
Output Flow Rate: 0.26 GPM(1L/min) (no couplings or nozzle)
Weight: 0.39 lbs. (0.17 kg)
Products Size: 11.5x 5.5 x 4.5 cm/4.5x 2.2 x 4.8 in
Lifespan: Up to 12 months
Material: ABS
Model: PL 201

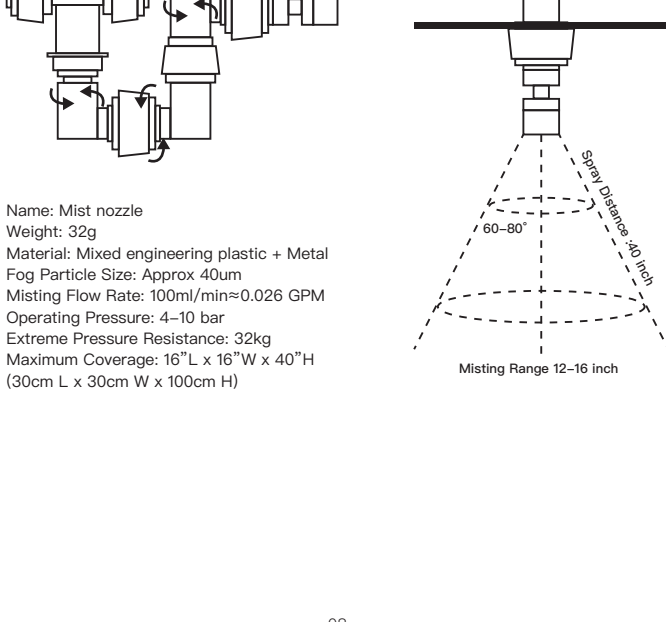

CARE/MAINTENANCE

- Algae can occasionally develop in the water reservoir, but this is natural and harmless. Make sure to regularly clean the water tank with disinfectant to reduce the development of algae.
- Please do not make the tubing close to the pet heating light. Please clean the tubing regularly or replace it with a new one.
- Do not use acidic liquids to clean the supply tubing and device. Otherwise, it will destroy the diaphragm in the water pump and lead to the device defective by misuse.
- Please do not use the device in an environment of zero degrees or below zero temperature. Otherwise, the water will freeze and damage the diaphragm in the water pump, leading to the device defective.
- When not using the equipment, please clean the black tubing and dry the nozzles.
- If you do not use the device for a long time, please store it in a dry environment, and wrap the device with a plastic bag to prevent the potential damage caused by air humidity.
- Please do not disassemble and assemble the equipment privately to avoid unnecessary damage.

TROUBLE SHOOTING

Problem	Causes	Solutions
No water misting out	No Power	Press any button to light up the screen, no reaction. Check if the power port loosen; or use a new adapter(5V/2A)
	Filter get clogged	Clean the filter or change a new one
	The inlet and outlet tubes are reversed.	Make sure the tube with filter insert into the inlet port correctly and deeply become
Water leaks	Defective	Please contact: info@vchams.com
	Water leak out from the bottom of device	Device defective, please contact: info@vchams.com
	Water keeps dripping from the stainless steel misting head after stop misting.	As the water pressure not release completely, and the pressure can't support the misting out, it will drip after misting stopping. It's ok, when there is no water in tube, it won't drips.
Misting Timer Not works	Siphoning Effect	Make sure the water source are below to your reptile enclosure.
	Water Leaks from joints	Insert the tube into the nozzle port deeply. Make sure the end plug are used for the last end of the nozzle.
	Setting wrong	Please attention that how often setting 0.1 are different from 1, 0.1 means every 1 hour, 1 means every 1 day. Suggest you set How often to L1 (every 10 minutes) to check whether the timer works.
Missing Accessories	Defective	please contact: info@vchams.com

FREQUENTLY ASKED QUESTIONS

- Part 1: About Nozzle**
- 1.Q: How's the misting effect? Can I adjust the effect?
- A: The misting effect is very nice, it will mimic the rain to improve the enclosure's humidity faster than fogger. The misting effect can't be adjusted, we suggest you tighten the coverage of the nozzle tip to guarantee the best misting effect.
- 2.Q: What's the maximum coverage of the nozzle means?
- A: We test the misting coverage by place the nozzle in vertical. In its best misting effect, The maximum misting distance is 40 inch. And the maximum range is 16 inch, its coverage is 16" L x 16" W x 40" H. When you shot the misting in different angle, the coverage go changes.
- 3.Q: Brand new system nozzle tips spray?
- A: Do not try to "fix" the nozzle tips by yourself. We test them twice before shipping them out. First, check the tube to the inlet and outlet port. If there are bubbles in the water from the inlet tubing, that means they connect wrong, just exchange the tubing. Second, make sure every connection is tightened and no water is leaking. Third, non of them work, contact us.
- NOTE: Don't blow through the nozzles as they contain a check valve inside. Even you could blow through it, the flow would be so low that you would not feel it. The pumps provide a high water pressure to make the back valve open.
- 4.Q: Nozzle doesn't mist well, it only drips or even doesn't mist after a period of use.
- A: There are two reasons for not mist well. First the sprayer gets clogged, second the insufficient pressure from main device. Solution: don't tamper with the center of the nozzle tip as that will surely damage it. Just soaking the whole nozzle in CLR or vinegar solution to dissolve the minerals. For the insufficient pressure as the filter get clogged, the nozzle tip should not have enough water pressure. Use a brush to clean the filter or place a new one. Last, non of them work, contact us.
- 5.Q: How to clean the nozzle after long time use?
- A: Solution: don't tamper with the center of the nozzle tip as that will surely damage it. Just soaking the whole nozzle in CLR or vinegar solution to dissolve the minerals.
- Part 2: About Water or Water Volume**
- 6.Q: What kind of water to use?
- A: We recommend using demineralized water in our systems. Reverse Osmosis (RO) is ideal and is commonly used and sold as filtered drinking water. Using tap, well, spring or water treated by pitcher or faucet filters won't prevent the minerals from depositing in the nozzles, and aside from improving the taste, nothing else. The RO water doesn't clog your nozzles, dries clear with no water spots, and is ideal for your daily misting.

- 7.Q: How often do I have to refill the water?
- A: It depends how big the water reservoir you use. The GPM of each nozzle is 0.026 GPM, meaning that the nozzle misting 0.026 GPM out in one minute. Here is our calculation example: use 2 nozzles for a reptile enclosure, and set to mist 30 seconds every day, hoping every 2 weeks to refill the bucket.
- Then we get the calculation as follow:
- 0.026 GPM
30 seconds=0.5 minute
2 nozzles=2
2 weeks=14 days
0.026*0.5*2*14=0.364 Gallon.
- In this case, you need to prepare a bucket at least 0.4 gallon.
- If you use 1 gallon bucket, then you refill the water every 4 weeks.
- Part 3: Application**
- 8.Q: What kind of reptiles and snakes are suitable with this misting system?
- A: As we mention before, the maximum coverage of the nozzle is 16" L x 16" W x 40" H (30cm L x 30cm W x 100cm H). For an enclosure of 48" L x 24" W x 24" H, two nozzles are enough for its coverage. If you get desert or temperate reptile, please use only one nozzle.
- Part 4: Accessories and other**
- 10.Q: Where can I get extra tubing and nozzle?
- A: Please search Moistlandland reptile and tubing kits on amazon, they will get them.
- 11.Q: My cable and adapter lost, what kind of cables and adapter do I need?
- A: Type C USB cable and DC 5V 2A adapter.
- 12.Q: How to turn the misting system off?
- A: There is no on/off button. The unit will turn on automatically when you plug it in, and turn off when you unplug it.
- 13.Q: Do I need to reset the timer when I power it up again?
- A: No, the device has the memory function, it will store your setting even it is power off.

LIMITED WARRANTY ON AUTOMATIC MISTING SYSTEM

OUR RESPONSIBILITY FOR DEFECTIVE GOODS IS LIMITED TO REPAIR, REPLACE-
MENT OR REFUND AS DESCRIBED BELOW IN THIS WARRANTY STATEMENT.

WHO MAY USE THIS WARRANTY?

This limited warranty only to the consumer who originally purchased the product ("you"). It does not extend to any subsequent owner or other transferee of the product.

WHAT DOES THIS WARRANTY COVER?

This limited warranty covers defects in materials and workmanship of the Automatic Misting System (the "product") for the Warranty Period as defined below.

WHAT DOES THIS WARRANTY NOT COVER?

This limited warranty does not cover any damage due to: (1) transportation; (2) storage; (3) improper use; (4) failure to follow the product instructions or to perform any preventive maintenance; (5) modifications; (6) unauthorized repair; (7) normal wear and tear; or (8) external causes such as accidents, abuse, or other actions or events beyond our reasonable control.

WHAT IS THE PERIOD OF COVERAGE?

This limited warranty starts on the date of your purchase and lasts for one year (the "Warranty Period"). The Warranty Period is not extended if we repair or replace the product. We may change the availability of this limited warranty at our discretion, but any changes will not be retroactive.

WHAT ARE YOUR REMEDIES UNDER THIS WARRANTY?

With respect to any defective product during the Warranty Period, we will, at our sole discretion, either: (a) repair or replace such product (or the defective part) free of charge or (b) refund the purchase price of such product if an exchange unit cannot be provided.