



# Weight Kit

## Greensmaster® and Sand Pro®/Infield Pro® Traction Unit

Model No. 100-6442

### Installation Instructions

**Note:** Determine the left and right sides of the machine from the normal operating position.

**Note:** Remove the tire from the caster fork for ease in hole drilling and installation of the Weight Kit.

For added traction performance, the Weight Kit (100-6442) can be added to the front of the machine.

**Note:** If the machine is fitted with a front lift or plow attachment, the Weight Kit will not fit due to physical interference.

**Important:** If a puncture occurs in a tire with calcium chloride, remove the machine from the turf area as quickly as possible. To prevent possible damage to the turf, immediately soak the affected area with water.

## Preparing the Machine

- Park the machine on a level surface.
- Engage the parking brake (if applicable).
- Shut off the engine and remove the key (if applicable).

## Installing the Kit on the Greensmaster 3100 (Model 04356), 3120 (Model 04355), and 3150 (Models 04357 and 04358)

1. Locate, mark, and drill 3 holes (13.5 mm [0.53 inch]) on each side of the rear caster fork as shown in [Figure 1](#).

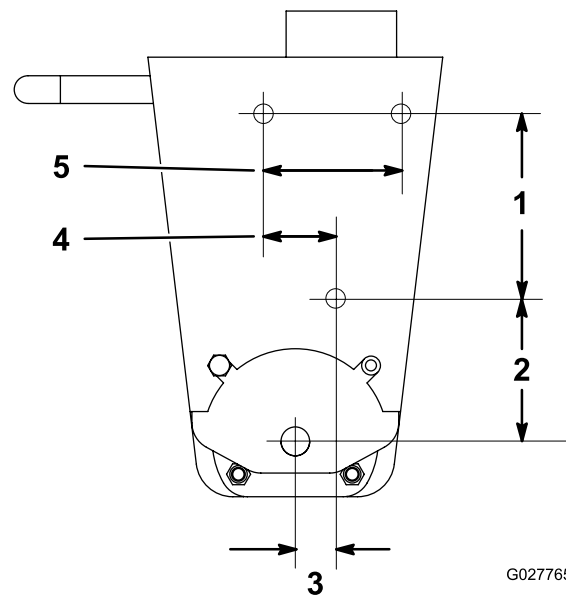

G027765

g027765

Figure 1

- |                          |                          |
|--------------------------|--------------------------|
| 1. 127 mm (5 inches)     | 4. 37.4 mm (1.47 inches) |
| 2. 95.3 mm (3.75 inches) | 5. 74.8 mm (2.95 inches) |
| 3. 37.7 mm (1.49 inches) |                          |

2. Attach 3 weights to the left side of the caster fork using 3 bolts (M12 x 80 mm) and locknuts ([Figure 2](#)).



- Attach 5 weights to the right side of the caster fork using 3 bolts (M12 x 110 mm) and locknuts (Figure 2).

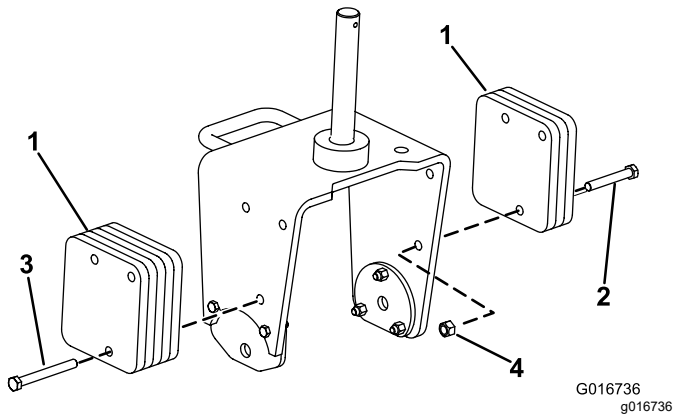

**Figure 2**

- |                       |                        |
|-----------------------|------------------------|
| 1. Weights            | 3. Bolt (M12 x 110 mm) |
| 2. Bolt (M12 x 80 mm) | 4. Locknut (M12)       |

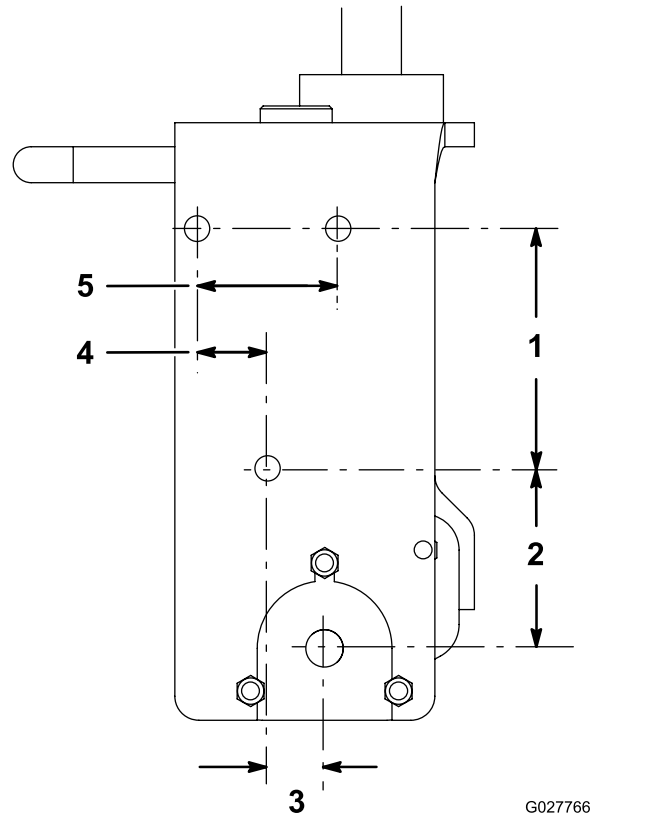

**Figure 3**

- |                          |                          |
|--------------------------|--------------------------|
| 1. 127 mm (5 inches)     | 4. 37.4 mm (1.47 inches) |
| 2. 95.3 mm (3.75 inches) | 5. 74.8 mm (2.95 inches) |
| 3. 30.1 mm (1.19 inches) |                          |

## Installing the Kit on the Greensmaster 3250-D (Models 04383 and 04384)

- Locate, mark, and drill 3 holes (13.5 mm [0.53 inch]) on each side of the rear caster fork as shown in Figure 3.

- Attach 5 weights to the left side of the caster fork using 3 bolts (M12 x 110 mm) and locknuts (Figure 4).
- Attach 3 weights to the right side of the caster fork using 3 bolts (M12 x 80 mm) and locknuts (Figure 4).

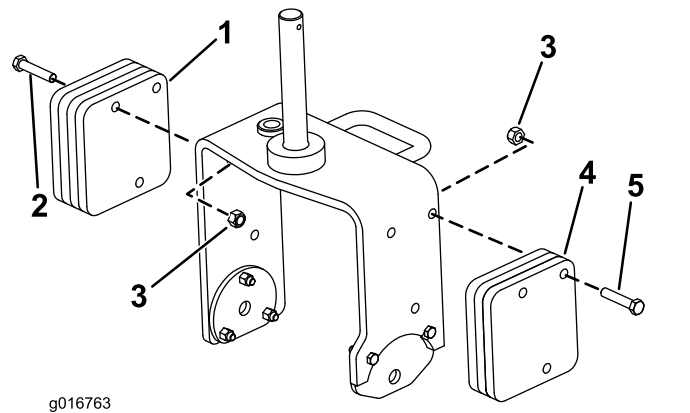
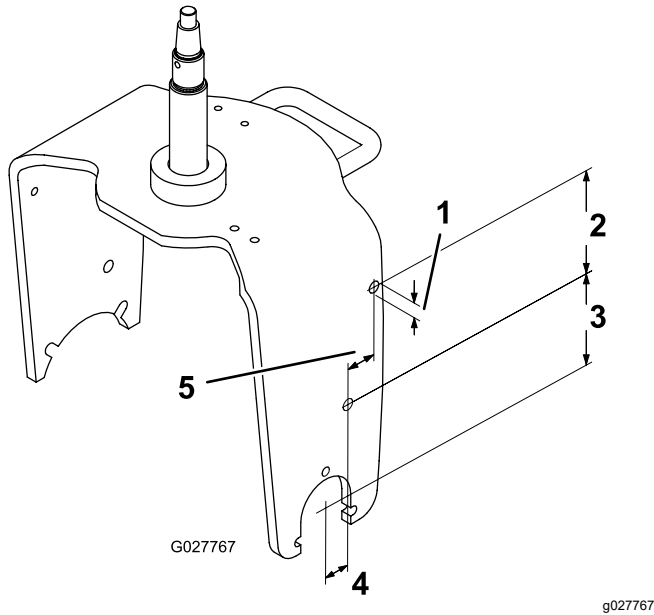

**Figure 4**

- |                        |                       |
|------------------------|-----------------------|
| 1. Weights (5)         | 4. Weights (3)        |
| 2. Bolt (M12 x 110 mm) | 5. Bolt (M12 x 80 mm) |
| 3. Locknut (M12)       |                       |

## Installing the Kit on the Sand/Infield Pro 3040 (Model 08703)

1. Locate, mark, and drill 2 holes (13.5 mm [0.53 inch]) on each side of the front caster fork as shown in [Figure 5](#).



**Figure 5**

- |                           |                          |
|---------------------------|--------------------------|
| 1. 13.5 mm (0.53 inch)    | 4. 31.7 mm (1.25 inches) |
| 2. 127 mm (5 inches)      | 5. 37.4 mm (1.47 inches) |
| 3. 112.5 mm (4.43 inches) |                          |

2. Attach 4 weights to each side of the caster fork using 2 bolts (M12 x 100 mm) and locknuts for each side ([Figure 6](#)).

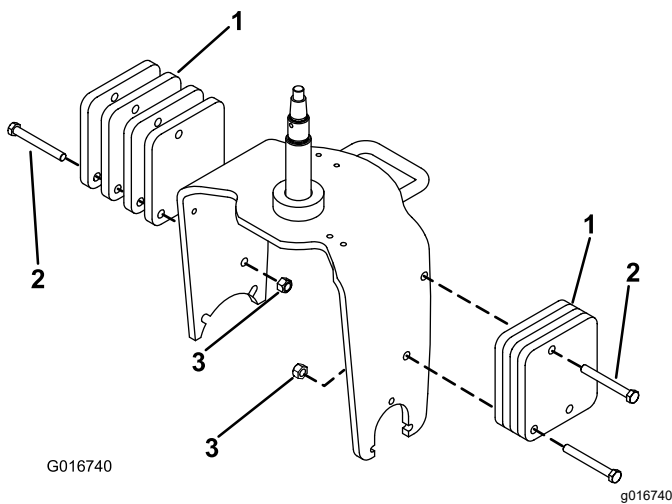
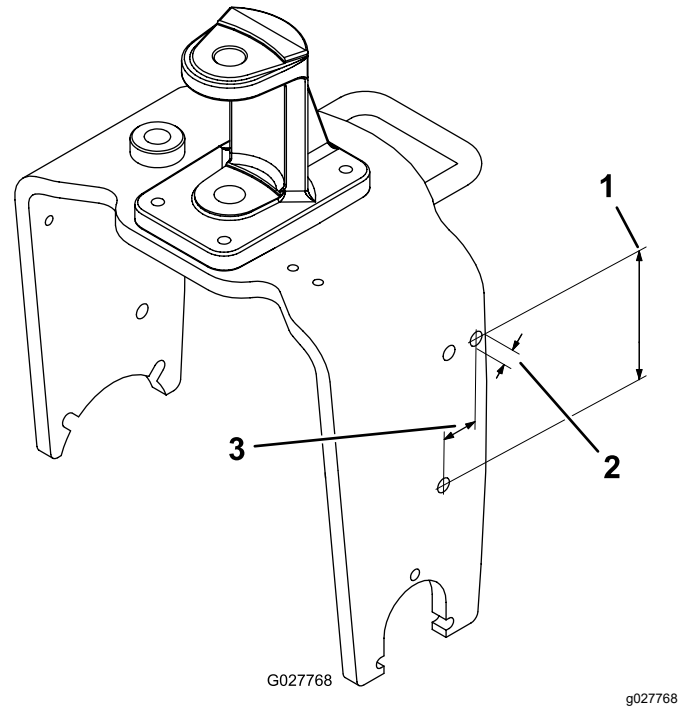

**Figure 6**

- |                        |                  |
|------------------------|------------------|
| 1. Weights (4)         | 3. Locknut (M12) |
| 2. Bolt (M12 x 100 mm) |                  |

## Installing the Kit on the Sand/Infield Pro 5040 (Model 08705)

1. Locate, mark, and drill a hole (13.5 mm [0.53 inch]) on each side of the front caster fork as shown in [Figure 7](#).



**Figure 7**

- |                        |                          |
|------------------------|--------------------------|
| 1. 127 mm (5 inches)   | 3. 37.4 mm (1.47 inches) |
| 2. 13.5 mm (0.53 inch) |                          |

2. Attach 4 weights to each side of the caster fork using 2 bolts (M12 x 100 mm) and locknuts for each side ([Figure 8](#)).

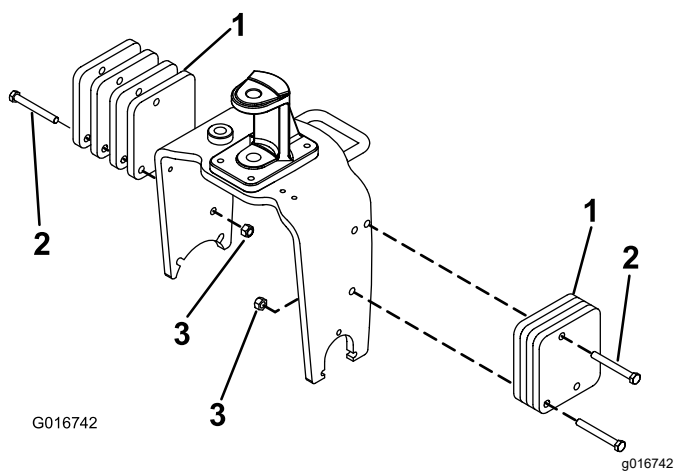

**Figure 8**

- |                        |                  |
|------------------------|------------------|
| 1. Weights (4)         | 3. Locknut (M12) |
| 2. Bolt (M12 x 100 mm) |                  |
-