



# 145L Chest Freezer

**Model Number STR-H145W-D**

## INSTRUCTION MANUAL

**AFTER SALES SUPPORT**

1300 886 649

[info@tempo.org](mailto:info@tempo.org)

MODEL: STR-H145W-D PRODUCT CODE: 11696 11/2019



# Welcome

Congratulations on choosing to buy a STIRLING® product.

All products brought to you by STIRLING® are manufactured to the highest standards of performance and safety and, as part of our philosophy of customer service and satisfaction, are backed by our comprehensive 3 Year In Home Warranty.

We hope you will enjoy using your purchase for many years to come.

# Contents

<b>02</b>	<b>Welcome</b>
<b>04</b>	<b>Warranty Details</b>
<b>05</b>	<b>General Safety Instructions</b>
<b>08</b>	<b>Product Overview</b>
<b>09</b>	<b>Getting Started</b>
<b>11</b>	<b>Instructions</b>
<b>14</b>	<b>FAQs and Troubleshooting Guide</b>
<b>16</b>	<b>Other Useful Information</b>
<b>19</b>	<b>Repair and Refurbished Goods or Parts Notice</b>



# STIRLING<sup>®</sup>

145L Chest Freezer

## Warranty Details

---

REGISTER YOUR PURCHASE AT [www.aldi.com.au/en/about-aldi/product-registration/](http://www.aldi.com.au/en/about-aldi/product-registration/) TO KEEP UP-TO-DATE WITH IMPORTANT PRODUCT INFORMATION



---

The product is guaranteed to be free from defects in workmanship and parts for a period of 36 months from the date of purchase. Defects that occur within this warranty period, under normal use and care, will be repaired, replaced or refunded at our discretion. The benefits conferred by this warranty are in addition to all rights and remedies in respect of the product that the consumer has under the Competition and Consumer Act 2010 and similar state and territory laws.

Our goods come with guarantees that cannot be excluded under the Australian Consumer Law. You are entitled to a replacement or refund for a major failure and to compensation for any other reasonably foreseeable loss or damage. You are also entitled to have the goods repaired or replaced if the goods fail to be of acceptable quality and the failure does not amount to a major failure.



### AFTER SALES SUPPORT

  1300 886 649

 [info@tempo.org](mailto:info@tempo.org)

MODEL: STR-H145W-D PRODUCT CODE: 11696 11/2019

# General Safety Instructions

## READ CAREFULLY AND KEEP FOR FUTURE REFERENCE

Read this manual thoroughly before first use, even if you are familiar with this type of product. The safety precautions enclosed herein reduce the risk of fire, electric shock and injury when correctly adhered to. Keep the manual in a safe place for future reference, along with the completed warranty card, purchase receipt and carton.

To avoid unnecessary mistakes and accidents, it is important to ensure that all people using the appliance are thoroughly familiar with its operation and safety features. Therefore make sure that these instructions remain with the appliance if it is moved or sold, so that everyone using it through its life will be properly informed on appliance use and safety.



Pay particular attention to messages that follow this safety alert symbol or the words **DANGER**, **WARNING** or **CAUTION**. These words are used to alert you to a potential hazard that can seriously injure you and others. The instructions will tell you how to reduce the chance of injury and let you know what can happen if the instructions are not followed.



**WARNING:** Risk of fire

**WARNING!** This appliance contains flammable materials: isobutane (R600a) as refrigerant and cyclopentane as insulation blowing gas. While R600a is a gas with a high level of environmental compatibility, it is nevertheless flammable. Do not expose the appliance to high heat, sparks and open flames. During transport and installation, ensure that none of the components of the refrigerant circuit become damaged.

## Refrigerant matters

**WARNING:** Do not damage the refrigerant circuit! Never use an appliance with a damaged refrigerant circuit! If the refrigerant circuit becomes damaged, avoid proximity to open fires and all types of heat and ignition sources. Thoroughly ventilate the room in which the appliance is located. The room for installing the appliance must be at least 1m<sup>3</sup> per 8g of refrigerant. The amount and type of refrigerant in the appliance can be found in the technical specifications on page 18 and on the appliance rating plate.

It is hazardous for anyone other than an authorised service person to service this appliance. In Queensland, the authorised service person **MUST** hold a Gas Work Authorisation for hydrocarbon refrigerants to carry out servicing or repairs which involve the removal of covers.

## Responsible disposal

At the end of its working life, do not throw this appliance out with your household rubbish. Electrical and electronic products contain substances that can have a detrimental effect on the environment and human health if disposed of inappropriately. Observe any local regulations regarding the disposal of electrical consumer goods and dispose of it appropriately for recycling and recovery of the refrigerant and blowing agent.

**WARNING!** This refrigeration appliance contains flammable refrigerants and insulation blowing gases, which must be removed before disposal. Contact your municipal authorities for any codes or regulations concerning the disposal of such materials.

**DANGER! Risk of child entrapment!** When discarding this or another freezer, make sure to take off the lid and leave any shelving/baskets in place so that children cannot easily climb in and get trapped inside.

# General Safety Instructions (Cont.)

To reduce the risk of fire, electric shock or injury, always follow basic safety precautions and accident prevention measures when using this appliance, including the following:

## Electrical safety

- **Voltage:** Plug the appliance in a 220-240V, 50Hz, properly earthed power outlet, which must be in good working order. Make sure your outlet voltage and circuit frequency correspond to the voltage stated on the appliance rating label.
- **Power connection:** Do not use an adaptor; do not use an extension cord. Plug the power plug directly into a power outlet that cannot easily be turned off accidentally, and that is easily accessible so you can switch it off when required.
- **Power cord:** Do not kink or damage the power cord. Do not leave it exposed or dangling. Secure it behind the appliance so no one steps on or places anything on the cord or against it. A squashed or damaged power plug may overheat and cause a fire.
- **Damaged cord:** Do not use a cord that shows cracks or abrasion damage along its length or at either end. Any damage to the cord may cause a short circuit, fire and/or electric shock. If the power cord is damaged, it must be replaced by the manufacturer or its service agent. Contact our after sales support centre for advice.
- **WARNING!** The **light bulb** supplied with this appliance is a special use bulb, which is only suitable for use with this appliance, it is not usable for domestic lighting. Do not operate the appliance without the lamp installed. Do not touch the light bulb if it has been on for a long period of time, as it could be very hot.
- **Disconnection:** Never unplug the unit by pulling the cord. Always grip the plug firmly and pull straight out from the power point.
- **Electrical work:** If the installation of this appliance requires any electrical work, make sure it is carried out by a licensed electrician.

## Usage conditions and restrictions

- **Indoor domestic use only:** This appliance is intended for private domestic use only. It is not suitable for industrial or commercial use. Do not use it outdoors.
- **Intended purpose:** This product is a household freezer (with refrigerator function) and is only suitable for food storage. Do not use it for other purposes, such as storage of blood, drugs or biological products. Do not use it for anything other than its intended purpose, and only use it as described in this manual. Do not attempt to alter or modify this appliance in any way.
- **Usage restrictions:** This appliance is not intended for use by persons (including children) with reduced physical, sensory or mental capabilities, or lack of experience and knowledge, unless they have been given supervision or instruction concerning the use of the appliance by a person responsible for their safety.
- **Children:** Supervise children to ensure they do not play with the appliance. Close supervision is necessary when any appliance is used by or near children. Never allow children to operate, play with or crawl inside or on top of the appliance.
- **Keep the top clear:** Do not place heavy objects on top of the appliance.
- **Personal safety:** Take care when closing the appliance to avoid getting your fingers caught in the small gaps between the storage cabinet and lid.

# General Safety Instructions (Cont.)

- **WARNING! Electrical appliances:** Do not place any appliances (e.g. microwave ovens, rice cookers, voltage regulators etc.) on top of the chest freezer. Do not use any electrical appliances (such as ice cream makers) inside refrigeration appliances, unless they are approved for this purpose by the manufacturer.

## Cleaning and maintenance

- **Disconnect:** Unplug the appliance before cleaning or servicing. Failure to do so can result in electric shock, injury or death. Do not plug in or unplug the appliance when your hands are wet.
- **Flames:** Do not let open flames or ignition sources enter the appliance.
- **Flammable/explosive substances:** Never clean this appliance with flammable fluids. Do not store or use volatile, flammable or explosive substances such as aerosol cans with a flammable propellant in or close to this or any other appliance. The fumes can create a fire hazard or explosion.
- **Solvents:** Do not use solvent based cleaning agents or abrasives on the interior as these may damage or discolour the surfaces of the appliances.
- **WARNING!** Do not use **mechanical devices** or other means to accelerate the defrosting process, other than those recommended by the manufacturer. Never use a sharp or metal instrument to remove frost or clean the appliance. Use a plastic scraper, if necessary.
- **Service:** Do not attempt to repair, modify or replace any part of the appliance unless specifically recommended in this manual. If a service is required, please contact our after sales support centre. All servicing must be carried out by an authorised technician, and only genuine spare parts must be used.

## Installation (see page 9 for more installation instructions)

- **Heavy:** This appliance is heavy, take care when moving it. To avoid back or other injury, consider a two person lift or mechanical aid when installing it. Failure to do so can result in back or other injury. The appliance has roll wheels underneath the back corners for easy manoeuvrability.
- **WARNING: Ventilation:** To ensure proper ventilation, keep any ventilation openings, in the appliance enclosure or in the built-in structure, clear of obstructions. Ensure adequate air circulation around the appliance to prevent overheating.
- **Location:** Choose a well ventilated indoor area that meets the following requirements:
  - **Ambient temperature:** The ambient temperatures must correspond to the climate class (T) indicated on the rating plate of the appliance: 18°C – 43°C.
  - **Floor surface:** The floor must be sturdy, level and strong enough to support the unit when it is fully loaded. We recommend you place a plastic mat underneath the appliance if your floor covering is sensitive to moisture.
  - **Areas to avoid:** Avoid areas where the appliance would be exposed to direct sunlight, sources of heat (stove, heater, radiator, oven, etc.), extreme cold ambient temperatures or excessive moisture and high humidity (such as outdoors or exposed to wind, rain water spray or drips). Installing it in the coolest area of the room will save energy consumption and running costs.

# Product Overview

## Scope of delivery



### A Parts list

- 1 External handle
- 2 Recessed handle
- 3 Lid
- 4 Interior LED light
- 5 Interior storage cabinet
- 6 Drainage hole
- 7 Levelling legs
- 8 Control panel
- 9 Wire storage basket (removable)
- 10 Plastic ice scraper (not shown)

### B Documentation (not shown)

Instruction Manual, Quick Start Guide, Warranty Certificate

### NOTE:

Due to continued product improvement, images and illustrations in this manual may vary slightly from the product purchased. All images in this manual are for reference purposes only. Parts are not necessarily pictured to scale.



# Getting Started

## Unpacking

- **Unpacking:** This product has been packaged to protect it against transportation damage. Remove all packaging materials from around and inside the appliance, including foam pads and tapes. Tear the protective film (if any) off the lid and cabinet.
  - **Packaging materials:** Keep the original packaging carton and materials in a safe place. It will help prevent any damage if the product needs to be transported in the future, and you can use it to store the appliance when it is not in use. In the event that the carton is to be disposed of, please recycle all packaging materials where possible.  
Plastic wrapping can be a suffocation hazard for babies and young children, so ensure all packaging materials are out of their reach and disposed of safely.
  - **Parts:** Check to ensure you have all the parts listed opposite.
  - **Damage:** When unpacking, check the appliance carefully for damage. If it is damaged, do not install the appliance. Contact our after sales support centre for advice on examination or return of the damaged appliance.
  - **Power cord:** Unwind the power cord to its full length and inspect it for damage. Do not use the appliance if the appliance or its cord have been damaged or are not working properly. In case of damage, contact our after sales support line for advice on examination, repair or return of the damaged product.
  - **Read the manual:** Before installing your new freezer, read all safety instructions, especially the sections on installation and electrical safety on pages 6–7. Then follow the installation instructions below and on the next page.
  - **Clean:** Make sure the freezer is disconnected from the power supply before wiping the interior surfaces and accessories with a damp cloth, moistened in lukewarm water with a mild detergent. This will remove any dust from transit and storage and help remove the typical smell of a brand new product. Then dry thoroughly.
- CAUTION:** Do not use harsh or abrasive detergents or powders as these will damage the finish.

## Installation

- **Clearances:** Ensure that air can circulate freely around the back of the cabinet, which is necessary to cool the compressor and condenser. Allow at least 10cm clear space at the back and sides of the unit, and 1m above.
- **Overhanging wall units:** Ideally, the appliance should not be positioned below overhanging wall units. However, if it must be positioned below an overhanging wall unit, the distance between the top of the cabinet and the wall unit must be at least 1m so that you can comfortably open the lid and access the contents.
- **Upright, level position:** When installing the appliance, tilt it carefully – not more than 45° – and move it to its designated place; the freezer has roll wheels under the back corners of the base to help you position it into place. Also ensure to install the appliance level, which is necessary for proper operation. Use the levelling feet at the front corners of the base for adjustment, if necessary.

# Getting Started (Cont.)

## Electrical connection

- **Before plugging in your new freezer, let it stand upright for at least 4 hours.** This will allow the refrigerant gases to settle into the compressor and reduce the possibility of a malfunction in the cooling system.
- **Earthing:** The appliance must be earthed. The plug of the power supply cord is equipped with a contact for this purpose. Do not under any circumstances cut or remove the third (earth) prong from the power cord. If the plug does not fit your outlet (or if the outlet is loose), please consult a licensed electrician and have the outlet changed.
- **Plug:** Before plugging the freezer into a dedicated, properly earthed wall outlet, ensure that your outlet voltage and circuit frequency correspond to the voltage stated on the rating label. Also ensure that the plug is not squashed or damaged by the back of the appliance. A squashed or damaged plug may overheat and cause a fire.  
**WARNING!** It must be possible to disconnect the appliance from the mains power supply; the plug must therefore be easily accessible after installation.
- **Power cord:** The freezer's power supply cord must not be lengthened. Secure the cord behind the unit. Do not leave it exposed or dangling to prevent injury and accidental disconnection from the power supply.
- **When first starting up, and after a period out of use, allow the unit to cool down on the coldest temperature setting for at least 2 hours before placing food in the cabinet.**

## First use

- The first time you turn the unit on, select the appropriate mode (see opposite) and set the temperature control to the coldest temperature in the range.
  - **If you are using the appliance as a chest freezer,** let it run in “Super Freezing” mode for 24 hours, then select “Freezer” mode and set an appropriate temperature.
  - **If you are using the appliance as a refrigerator,** select “Fridge” mode and set the temperature to 2°C. Then, after 24 hours, adjust the temperature to one that suits your needs.

**NOTE:** The unit may not work at the set temperature on particularly hot days, or if the lid is opened too frequently. **To ensure efficient operation, do not open the lid unnecessarily or for prolonged periods of time.**

# Instructions

## Using the appliance

This appliance can be used as a chest freezer, or as a refrigerated storage cabinet for unfrozen food. For convenient access and organised storage, the cabinet is equipped with a wire basket. The control panel is located at the front of the storage cabinet, in the bottom right-hand corner (Fig. 1).



### FRIDGE

Press this button to use the cabinet in “Fridge” mode and adjust the temperature in the storage cabinet between 2°C and 6°C. (Hold the button for fast advancement through the digits.)

In “Fridge” mode, the appliance is suitable for short-term storage of fresh food. The temperature range in this mode is low enough to limit some bacterial growth, but it is not suitable for long-term storage of perishable foods.

### FREEZER

Press this button to use the cabinet in “Freezer” mode and adjust the temperature in the storage cabinet between -14°C and -25°C. (Hold the button for fast advancement through the digits.)

In “Freezer” mode, the appliance is suitable for freezing fresh food and long-term storage (up to three months) of frozen food.

### LOCK

The system will be locked automatically 30 seconds after the last button operation. After locking, pressing any button will be ineffective. The display panel will flash twice and the unit will emit two beep sounds, indicating that the operation is invalid.

### UNLOCK

Press and hold the FRIDGE and FREEZER buttons for three seconds at the same time to unlock the system. You can now select a mode or adjust the temperature.

### SUPER

Press this button to use the cabinet temporarily in “Super Freezing” mode, the display will show “SF”. This is recommended for fast freezing, for example, when you have added a large quantity of fresh food to the freezer cabinet. Unless cancelled earlier, “Super Freezing” mode will automatically revert to the previously set freezer temperature after 52 hours.

### NOTE:

- \* “Super Freezing” mode cannot be selected when the unit is operating in “Fridge” mode.
- \* In “Super Freezing” mode the fridge temperature cannot be adjusted.

# Instructions (Cont.)

## Freezing fresh food

- Only freeze fresh food that is suitable for freezing.
- Do not store food uncovered in the freezer. Always use good quality, freezer-proof packaging to maintain food quality. Remove air from packages of solid food and seal bags tightly before freezing.
- Ensure that food placed in the freezer is dated and labelled. This will help you keep track of storage times.
- Keep portions small to ensure they are frozen (and subsequently defrosted) rapidly.
- Make sure that fresh, unfrozen food packages do not touch food that is already frozen, thus avoiding a temperature rise in the frozen food.
- When freezing food, do not push food together too much, leave some space for air to circulate around each item.
- When adding large amounts of fresh food to the freezer, keep in mind that it will take approximately 24 hours for fresh food to freeze to solid frozen state. For best results, do not add other fresh food to the freezer drawer during this time.
- Do not place hot foods or liquids which may evaporate in the freezer compartment.

## Storing frozen food

- When buying frozen food, only buy quantities that you can store straight away; use an insulated container for your shopping and when you get home, place the food in the freezer immediately.
- When storing pre-packed, commercially frozen food, follow the food manufacturer's instructions for storing the food in a home freezer. Do not exceed any storage times listed on the packaging.
- Once you have opened a packet of frozen food, rewrap it airtight to prevent surface evaporation which causes drying or freezer burn.
- Do not place carbonated liquids such as bottles of fizzy drink in the freezer as the container could explode under pressure and damage the freezer.
- Do not refreeze food once it has been defrosted.
- Frozen food which has thawed accidentally should either be used immediately or thrown away. Alternatively, if the food is uncooked and has not been completely defrosted, it may be cooked and then refrozen.
- **CAUTION!** Do not remove items from the freezer if your hands are damp or wet as this could cause skin abrasions.

# Instructions (Cont.)

## Saving energy

- Locate the freezer in the coolest area of the room, away from heat-producing appliances and out of direct sunlight.
- Let hot foods cool to room temperature before placing them in the freezer. Overloading the freezer forces the compressor to run longer.
- Be sure to wrap foods properly, and wipe containers dry before placing them in the freezer. This cuts down on frost build-up inside the unit.
- Do not line the storage basket with aluminium foil, wax paper or paper towelling. Liners interfere with cold air circulation, making the freezer less efficient.
- Do not pack food packages close together as this prevents air circulating.
- Organise and label food to reduce lid openings and extended searches. Remove as many items as needed at one time and close the lid as soon as possible.
- Do not set the thermostat to exceedingly cold temperatures. On very hot days, or when you have added a large quantity of fresh food, select **SUPER** freezing mode **temporarily** for fast freezing. (Unless cancelled earlier, SUPER freezing mode automatically reverts to the previously set freezer temperature after 52 hours.)
- Do not open the freezer lid unnecessarily or for too long, especially during a power failure.

## Power failure

- Most power failures are corrected within a few hours and should not affect the temperature inside your freezer, if you minimise the number of times the lid is opened. However, if the power is going to be off for a longer period of time, you need to take proper steps to protect your food.
- Do not refreeze frozen food without checking its condition first.
- If in doubt, discard the food. Do not refreeze food that has thawed completely.

## Going away?

- **Short vacation:** Leave the appliance operating during vacations of less than a month.
- **Long vacation:** If you are not going to use the appliance for longer periods, remove all food and unplug the power cord. Clean and dry the interior thoroughly. To prevent odour and mould growth, leave the lid open slightly, blocking it open, if necessary. (Restrict children's access to the room with the open appliance to avoid creating a child entrapment risk.)

## Moving the appliance

Remove all food from inside the appliance, securely tape down the basket and tape the lid shut. Protect the outside of the unit with a blanket or similar soft material and make sure the appliance stays secure in the upright position during transportation.

# FAQs and Troubleshooting Guide

If you experience a problem with your chest freezer, check in the following table for solutions to help you solve the problem. If after these checks you still have a problem with your freezer, contact our after sales support centre for advice.

**CAUTION:** Before troubleshooting, disconnect the power supply. Any troubleshooting that is not mentioned in this manual may only be carried out by a qualified electrician or similarly qualified person.

Problem	Possible cause
The freezer does not work.	<ul style="list-style-type: none"><li>• It is not plugged in or the plug is loose.</li><li>• The circuit breaker tripped or a blown fuse.</li><li>• The outlet socket is defective – mains malfunctions are to be corrected by a licensed electrician.</li></ul>
The compressor turns on and off frequently. Does that indicate that there is a problem?	<ul style="list-style-type: none"><li>• The room temperature is hotter than normal.</li><li>• A large amount of food has been added to the cabinet.</li><li>• The lid is being opened too often, or not closed completely.</li><li>• The lid gasket does not seal properly.</li><li>• The appliance does not have the correct ventilation clearances.</li><li>• The appliance has recently been disconnected for a period of time. At least two hours are required for the appliance to cool down.</li></ul>
The temperature inside the freezer is too warm.	<ul style="list-style-type: none"><li>• The temperature control is set too warm. Set a lower temperature within the -14°C to -25°C range and allow several hours for the temperature to stabilise.</li><li>• The lid is kept open too long or is opened too frequently. Warm air enters the appliance every time the lid is opened. Open the lid less often.</li><li>• The lid is not closed completely.</li><li>• The lid gasket does not seal properly. Clean it, or if no longer seals airtight, see the last problem on the following page for a solution.</li><li>• A large amount of warm food might have been stored recently. Wait until the freezer has had a chance to reach its selected temperature.</li><li>• The freezer has recently been disconnected for a period of time. At least two hours are required for the appliance to cool down.</li><li>• The appliance is located near a heat source.</li></ul>

# FAQs and Troubleshooting Guide (Cont.)

The temperature inside the freezer is too cold.	<ul style="list-style-type: none"> <li>The freezer temperature is set too cold. Select a warmer temperature and allow several hours for the temperature to stabilise.</li> <li>The unit is running in "Super Freezing" mode.</li> </ul>
The temperature of the external freezer surface is warm.	<ul style="list-style-type: none"> <li>The exterior freezer walls can be warmer than room temperature. This is normal while the compressor works to transfer heat from inside the freezer cabinet.</li> </ul>
There is a popping or cracking sound when the compressor comes on.	<ul style="list-style-type: none"> <li>Metal parts undergo expansion and contraction, just as hot water pipes. This is normal. The sound will level off or disappear as the freezer continues to run.</li> </ul>
There is a bubbling or gurgling sound, like water boiling.	<ul style="list-style-type: none"> <li>Refrigerant (used to cool the freezer) is circulating throughout the system. This is normal.</li> </ul>
There are vibrations; what is causing them? How can I stop the vibrations?	<ul style="list-style-type: none"> <li>Check to ensure that the appliance is on a level surface.</li> <li>The floor is uneven or weak. The appliance rocks on the floor when it is moved slightly. Be sure your floor can adequately support it.</li> <li>Put a piece of metal or timber underneath parts of the appliance to level it.</li> <li>The appliance is touching the wall. Re-level the appliance and move it away from the wall.</li> </ul>
Moisture forms on the inside freezer walls.	<ul style="list-style-type: none"> <li>Hot and humid weather increases the internal rate of frost build-up. This is normal.</li> <li>The lid is slightly open.</li> <li>The lid is kept open too long, or is opened too frequently. Open the lid less often.</li> </ul>
Moisture forms on the outside of the freezer.	<ul style="list-style-type: none"> <li>The lid is slightly open, causing cold air from inside the freezer to meet warm, moist air from the outside.</li> </ul>
The lid will not close properly.	<ul style="list-style-type: none"> <li>The freezer is not on a level surface.</li> <li>The gasket is dirty.</li> <li>The storage basket is out of position.</li> </ul>
Heavy build-up of frost on the lid seal.	<ul style="list-style-type: none"> <li>Carefully warm the leaking sections of the lid gasket (seal) with a hair dryer (on a cool setting). At the same time, shape the warmed lid gasket by hand until it sits correctly and provides an airtight seal.</li> </ul>

# Other Useful Information

## **WARNING!**

To reduce the risk of electric shock or injury, always disconnect the appliance from the power supply before defrosting or cleaning it.

## **Defrosting the freezer**

When the unit is run in “Freezer” mode, its interior walls will become progressively covered with frost. For efficient operation and minimum energy consumption, it is important that this frost layer is removed regularly. You may use the supplied plastic ice scraper to remove a thin layer of frost — do NOT use a metal implement.

If the frost on the freezer walls has built up to about 3–4mm thickness, the unit should be defrosted properly, as described below. Preferably, choose a time when your stock of frozen food is low.

- Unplug the freezer and remove the food and storage basket. (Keep any frozen food temporarily in a fridge or cooler bag to keep defrosting to a minimum.)

- During defrosting, any ice and frost that has accumulated will melt into the freezer cabinet. To drain the water, you will need to open two plugs to the drainage hole: one is located at the bottom of the front panel (Fig. 2) and the other at the bottom of the interior cabinet (Fig. 3).

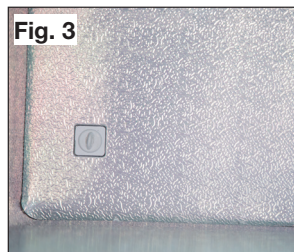

- Place a shallow tray and some dry towels underneath the outer drain plug for the water to drain into. Then slightly pull out the plug and rotate it 180 degrees (Fig. 4) so the water can flow out the hole.
- Defrosting usually takes a few hours. To defrost faster keep the lid open. Check the tray occasionally so the water does not overflow. Wipe any remaining water out of the freezer cabinet with a dry, soft cloth.
- When done, clean the appliance as described on the next page. Alternatively, push the drain plug in and also re-plug the drain plug inside the freezer cabinet. Clean and/or dry all interior freezer surfaces thoroughly, then reset the freezer temperature and plug in the freezer to restart it.

**Fig. 4**

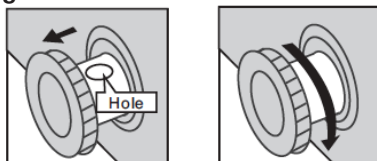

## **WARNING!**

- Never use sharp or metallic tools to scrape off frost from the evaporator as you could damage it. To scrape ice off surfaces, use a plastic scraper.
- Never use boiling water to accelerate defrosting as it may damage the plastic parts.



# Other Useful Information (Cont.)

## Cleaning the freezer

For hygienic reasons clean the appliance interior and accessories regularly. We recommend cleaning the freezer after defrosting it.

- Make sure the unit is unplugged from the power supply and all food and the storage basket are removed.
- Wash the inside surfaces and the interior accessories with a damp, warm cloth moistened in a water and baking soda solution. The solution should be about two tablespoons of baking soda to one litre of water. Rinse and wipe dry with a soft cloth.
- Clean the outside of the unit with a damp, well wrung out cloth, keeping the area around the control panel dry. Keep the lid gasket (seal) clean.
- If used as a refrigerator, regularly examine the drain in the appliance for defrost water and clean the drain, if necessary. If the drain is blocked, water will collect in the base of the appliance.
- After cleaning, push the drain plug in and also re-plug the drain plug inside the cabinet. When everything is dry, place appliance back into service.
- Allow approximately two hours for the cabinet to cool down again (depending on how long was disconnected from the power). If the appliance is used as a freezer, you can speed up the cooling down time by setting the control panel to “Super Freezing” mode for a few hours before resetting it to your usual freezer mode and temperature.

### WARNING!

- Never clean the unit with an abrasive, acid, oil or solvent-based cleaning agent, or with abrasive pads or scourers. Never use flammable fluids or sprays for cleaning as the fumes from these substances can create a fire hazard or explosion.
- Never clean the appliance with a steam cleaner. Moisture could accumulate in the electrical components, danger of electric shock! Hot vapours can lead to the damage of plastic parts.
- The appliance must be completely dry before it is placed back into service.
- Ethereal oils and organic solvents can attack plastic parts, e.g. lemon juice or the juice from orange peel, butyric acid, or cleansers that contain acetic acid. Do not allow such substances to come into contact with the appliance parts.

## Storage

If the appliance is not going to be used for an extended period of time, unplug it from the power supply and store the clean and dry appliance in the original packaging to protect it from dust.

## Interior light

This chest freezer has an interior light built into the lid. It lights and extinguishes automatically when the lid is opened (more than 30°) and closed. If the light needs replacing, please contact our after sales support centre to book a service call. The light can only be replaced by properly qualified service personnel.

# Other Useful Information (Cont.)

## Service, repair and spare parts

Do not attempt to alter or modify this appliance in any way, or to repair or replace any part unless it is specifically recommended in this manual. All other servicing should be referred to a qualified technician; contact our after sales support centre. The following spare parts are available from our after sales support centre. To purchase a part, call the centre on 1300 886 649 or email us at [info@tempo.org](mailto:info@tempo.org).

Basket	Door gasket/seal	Door hinge & door hinge cover
Drain pipe plug	Ice scraper	Indicator light
Shelf	Thermostat & thermostat knobs	

## Technical specifications

Power	75W 220-240V~ 50Hz 0.55A
Climate class	T
Dimensions	845(H) x 705 (W) x 545 (D) mm
Capacity	145L
Refrigerant	R600a, 42g
Insulation Blowing Agent	Cyclopentane
Net weight	28kg

## Compliance

This appliance has been fully tested and meets all requirements as set out by standards AS/NZS 60335.1 and AS/NZS 60335.2.24.



The RCM Mark (Regulatory Compliance Mark) indicates that the product complies with the relevant guidelines of the ACMA as well as corresponding government requirements for the safety of electrical devices.



# STIRLING®

145L Chest Freezer

## Repair and Refurbished Goods or Parts Notice

---

Unfortunately, from time to time, faulty products are manufactured which need to be returned to the supplier for repair.

Please be aware that if your product is capable of retaining user-generated data (such as files stored on a computer hard drive, telephone numbers stored on a mobile telephone, songs stored on a portable media player, games saved on a games console or files stored on a USB memory stick) during the process of repair, some or all of your stored data may be lost. **We recommend you save this data elsewhere prior to sending the product for repair.**

You should also be aware that rather than repairing goods, we may replace them with refurbished goods of the same type or use refurbished parts in the repair process.

**Please be assured though, refurbished parts or replacements are only used where they meet ALDI's stringent quality specifications.**

If at any time you feel your repair is being handled unsatisfactorily, you may escalate your complaint. Please telephone us on 1300 886 649 or write to us at:

Tempo (Aust) Pty Ltd ABN 70 106 100 252  
PO BOX 6056 Frenchs Forest, Sydney, Australia NSW 2086  
Telephone: 1300 886 649 (Aust) - Fax: (02) 9975 2688  
Tempo Help Desk: 1300 886 649 (Aust)  
(Operating Hours: Mon-Sat 09:00am to 06:00pm AEST)  
Email: [info@tempo.org](mailto:info@tempo.org)





## Warranty returns

Should you for any reason need to return this product for a warranty claim, make sure to include all accessories with the product.

## Product does not work?

If you encounter problems with this product, or if it fails to perform to your expectations, make sure to contact our After Sales Support Centre on 1300 886 649.

For an electronic copy of this manual, go to [www.stirlingappliances.com.au](http://www.stirlingappliances.com.au) and download a copy, or contact our after sales support centre.

### Instruction Manual Revision Index

Version No	Issue Date	Description
V1.0	11 June 2019	Original release