

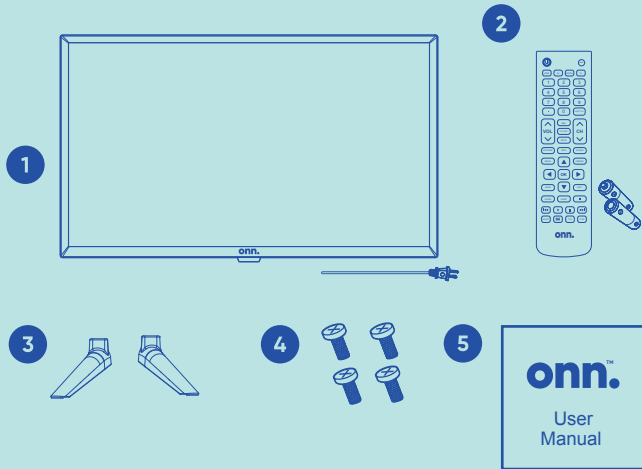

**32" HD LED TV**  
**Quick Start Guide**

## What's in the Box?

Check to make sure you have everything below.



1. TV with Power Cord
2. Remote Control and Batteries
3. TV Stands
4. Screws for TV Stands
5. onn. User Manual

## Installing the Stands

01

Do not install the stands if you want to wall mount your TV. See your wall mount instructions or chat live at [www.onntvsupport.com](http://www.onntvsupport.com).

**You will need:** Phillips screwdriver (not included)

1. Place the TV screen-down on a clean, flat, soft surface (ie: blanket) to prevent scratches or damage to the screen.
2. Use a Phillips screwdriver to attach each stand with the provided screws.
3. Place the TV upright on a stable, level surface.

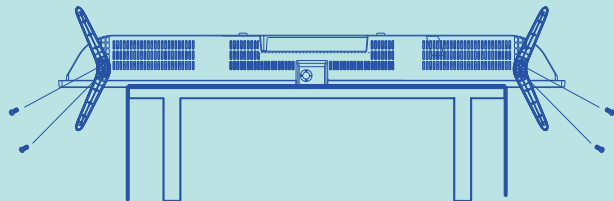

## Installing Remote Control Batteries

02

1. Remove the cover from the remote control's battery compartment.



2. Insert two AAA batteries (included), making sure to match the + and – terminals to the symbols in the compartment.



3. Replace the cover on the remote control's battery compartment.



**Note:** See your User Manual for information about your remote control's functions.

## Connecting Devices

03

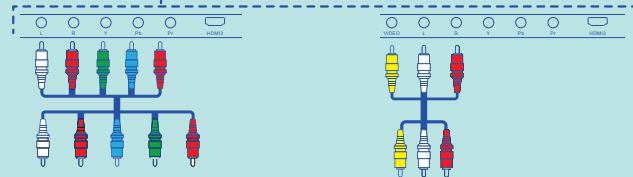
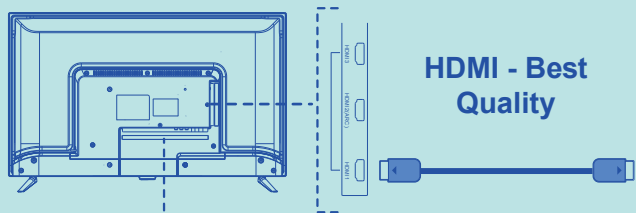

**Component - Better Quality**

**Composite (AV) - Good Quality**

## Connecting Devices (Continued)



**Digital Audio - Best Audio Quality**  
Digital Optical

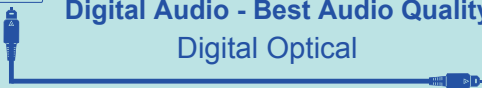

**Coaxial - Good Quality**



**Analog Audio - Good Audio Quality**



3.5 mm audio cable

**Streaming  
Device**



**Streaming Devices**

**Note:** Some streaming devices need to connect to power.



## Connecting to Power

04

1. After connecting all your devices, connect the power cord to a power outlet. The TV enters standby mode and its indicator lights red.

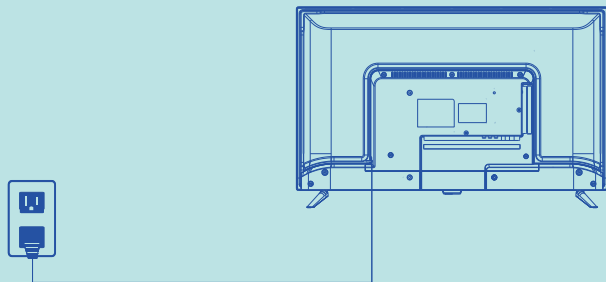

2. Press  (power) on the TV or remote control to turn on the TV. The red indicator turns off.



## Setup Wizard

05

Press the buttons on your remote to select or change a setting. When you're finished, press MENU to exit the Setup Wizard.

- **Menu Language:** Select the language you want to be displayed in the menu. The default language is English.
- **Air/Cable:** Select whether you want to watch with an antenna (Air) or through a cable jack (Cable).
- **Auto Scan:** Search and store available channels automatically.



## Customer Support & Warranty

**Online Chat:** [www.onntvsupport.com](http://www.onntvsupport.com)

**Email:** [customerservice@onntvsupport.com](mailto:customerservice@onntvsupport.com)

**Customer Support:**

**844-334-2355**

**9am - 9pm EST daily**

See your User Manual for answers on operating, customizing, and troubleshooting.

We recommend keeping your TV box for the duration of your warranty (one year). See your User Manual for details.

© 2019 onn. All Rights Reserved.

**We'd love to hear from you. Scan  
with your Walmart app and let us  
know what you think.**

