

Inverter Air Conditioner Indoor/Outdoor Units Disassembly Manual

Models:

WYT009GLSI25RH

WYT012GLSI25RH

WYT018GLSI25RH

WYT024GLSI25RH

IDU Disassembly

Indoor Unit Model Numbers: WT009GLSI25HLH | WT012GLSI25HLH | WT018GLSI25HLH | WT024GLSI25HLH

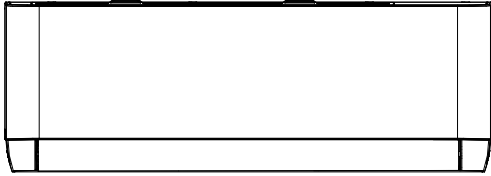
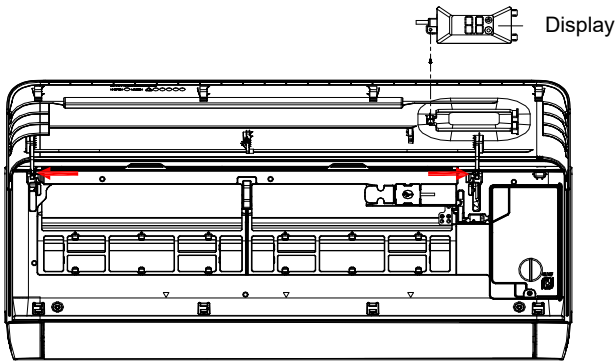
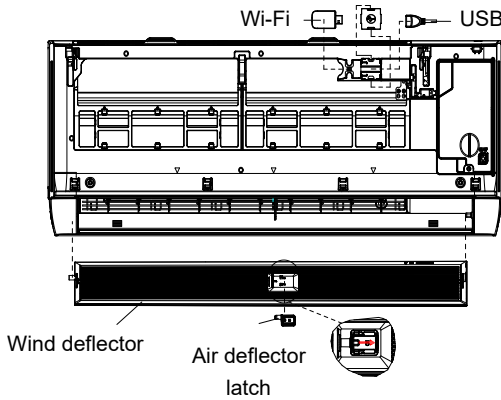
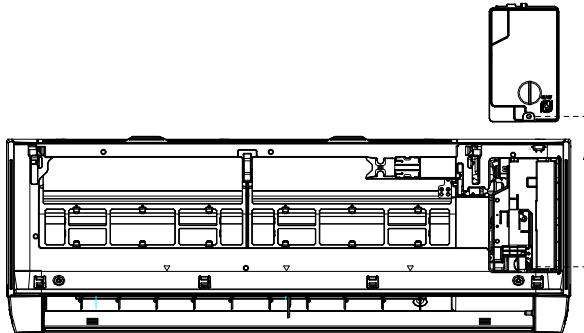
Steps	Reference Photo
Before disassembly	
1. Disassemble the front panel, display board, and Wi-Fi module	
<p>A. Open the front panel.</p> <p>B. Remove 1 screw, then take the display box out from the panel.</p> <p>C. Release the panel axis, which is shown in red arrows, out from the middle frame and take the panel out.</p>	 <p>Display</p>
2. Remove the louver and take the Wi-Fi module out from the middle frame	
<p>A. Remove the air guide by sliding the air guide pin to the right. The pin stays on the air guide after removing the air guide.</p> <p>B. Slide the Wi-Fi module to the left to remove it.</p> <p>C. Remove the Wi-Fi retaining cover from the retaining clips and take out the USB cable.</p>	 <p>Wi-Fi</p> <p>USB</p> <p>Wind deflector</p> <p>Air deflector latch</p>
3. Remove the louver	
Unfix 1 screw on the cover of the electric box, and remove the cover.	

4. Remove the front cover plate

A. Press the red arrow to loosen the 6 fixed clips between the front cover and center frame.

B. Rotate the front cover plate outward to disengage the fixing pins of the front cover plate and center frame. Then, remove the front cover plate.

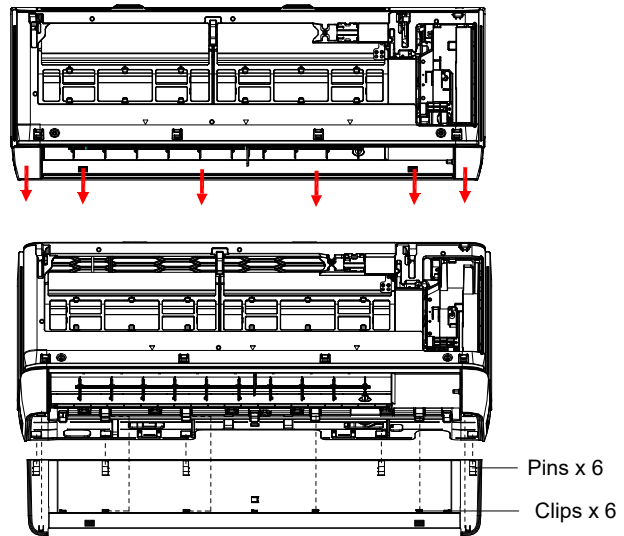
**5. Remove the sweep blade assembly**

A. Remove the sweep blade assembly by loosening the 5 clips from the base upwards.

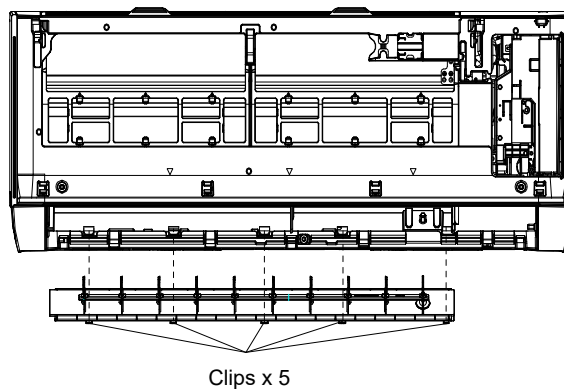
**6. Remove the filter**

A. Pinch the top of the strainer at the grommet position and slightly press upward to remove the strainer.

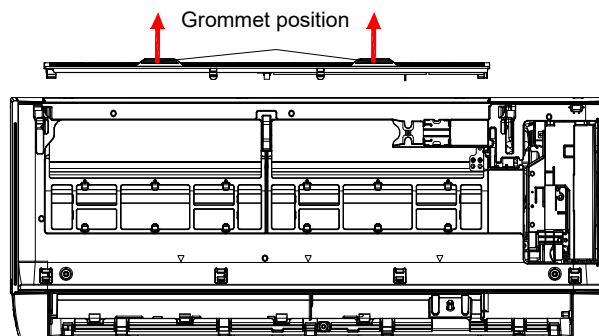

7. Disassemble the middle frame

- A.** Remove the 2 fixing screws between the center frame and base.
- B.** Loosen the 4 fixing clips between the upper part of the center frame and base.
- C.** According to the position indicated by the arrow of the center frame, press downward to loosen the 3 fixed clips between the center frame and the upper edge of the air vent on the base.
- D.** Follow the arrow in the center frame to indicate the position, press outward to loosen the 3 fixed clips between the center frame and the lower edge of the air vent on the base.
- E.** Remove the center frame upwards.

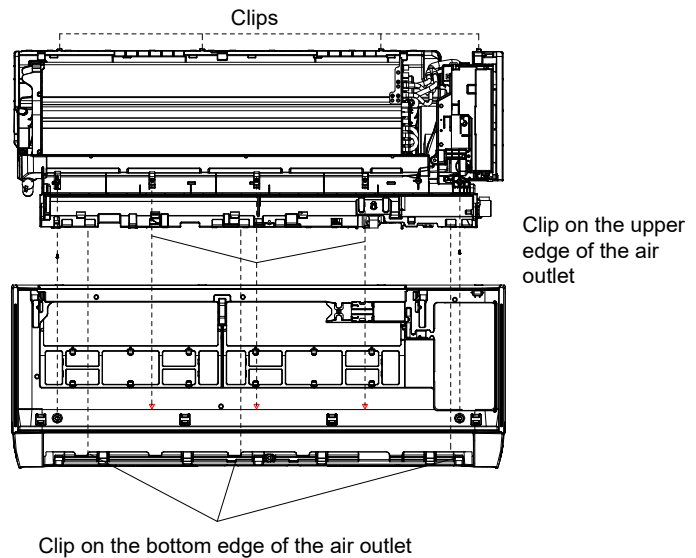

8. Disassemble the electric control box

- A.** Remove the electric control box and base fixing screws.
- B.** Remove the control box.

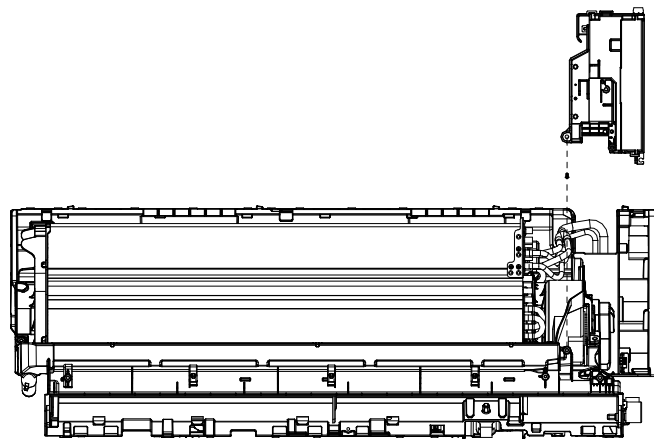

9. Remove the wall panels and pipe pressure plates

- A.** Loosen the fixing screws of the wall plate and base.
- B.** According to the direction of the arrow, press the fixing clips on the base wall plate. Loosen the wall plate and base fixing clips, then remove the wall plate.
- C.** Hold the pipe pressure plate gripper position upward, then loosen the pipe pressure plate and the base of the fixed clips. Remove the pipe pressure plate.

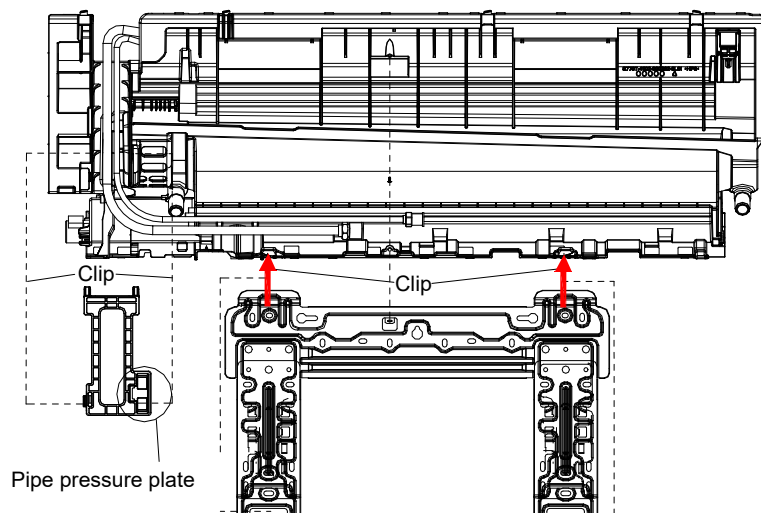

10. Disassemble the evaporator

A. Remove the evaporator and base fixing screws.

B. Loosen the left side of the evaporator and the base fixing buckle, then lift the left side of the evaporator upward.

C. After the left side of the evaporator is lifted, the right side of the evaporator will loosen. The evaporator can be taken out.

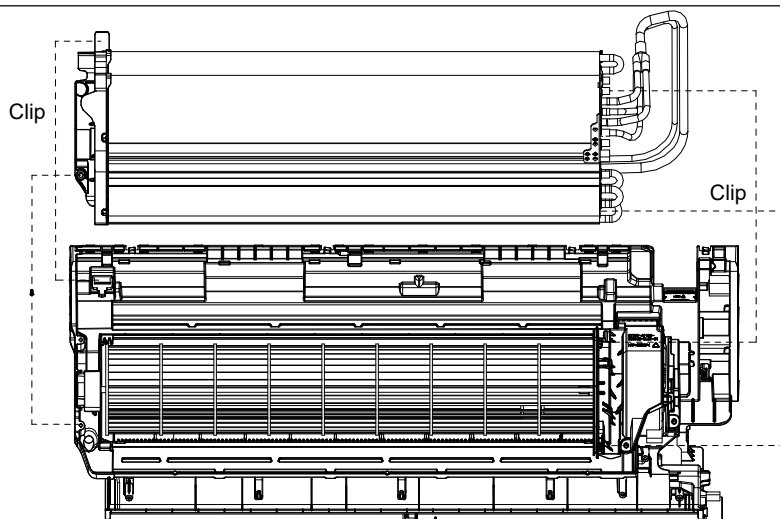
**11. Remove the motor cover**

A. Remove the motor cover and the 2 fixing screws on the base to take out the motor cover upwards.

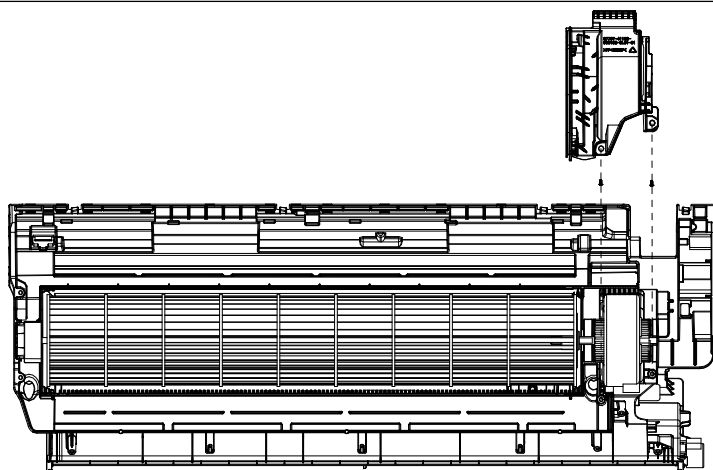
**12. Remove the cross-flow fan and motor**

A. Remove the cross-flow fan and cross-flow fan motor upwards.

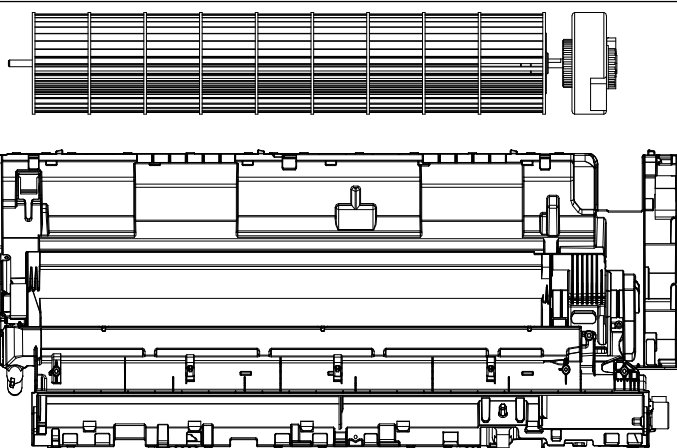
**13. Remove the cross-flow fan motor**

A. Remove the cross-flow fan motor by taking the cross-flow fan and cross-flow fan motor mounting screws out.

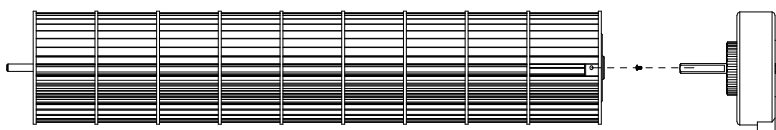

Refrigerant Leakage Detector Installation

WYT009GLSI25RH
WYT012GLSI25RH

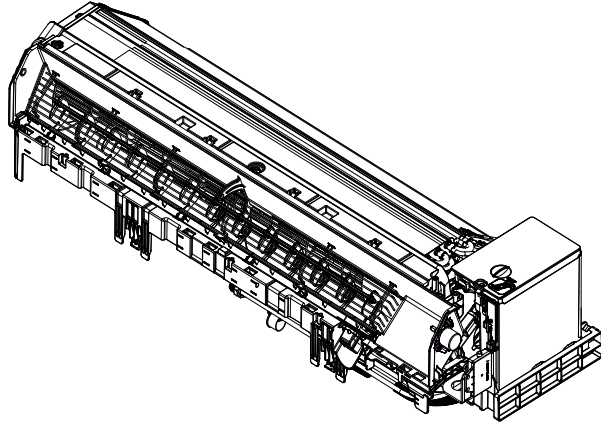

WYT018GLSI25RH
WYT024GLSI25RH

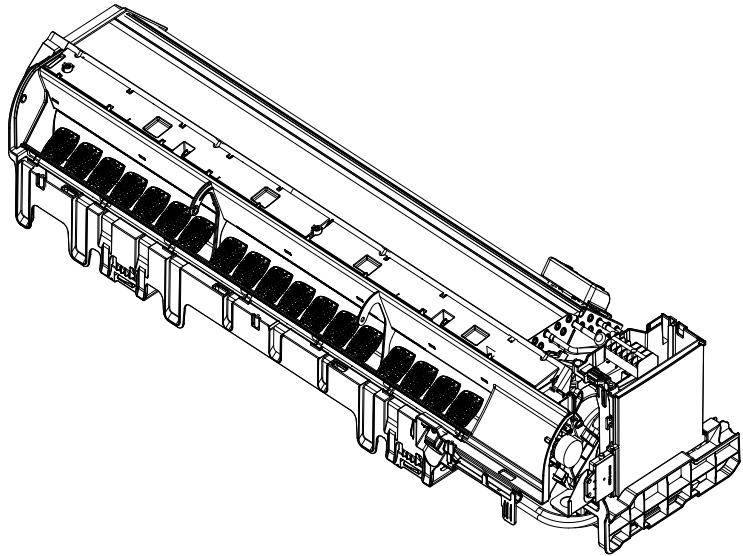

Power Cord Mounting Plate Installation

WYT009GLSI25RH
WYT012GLSI25RH

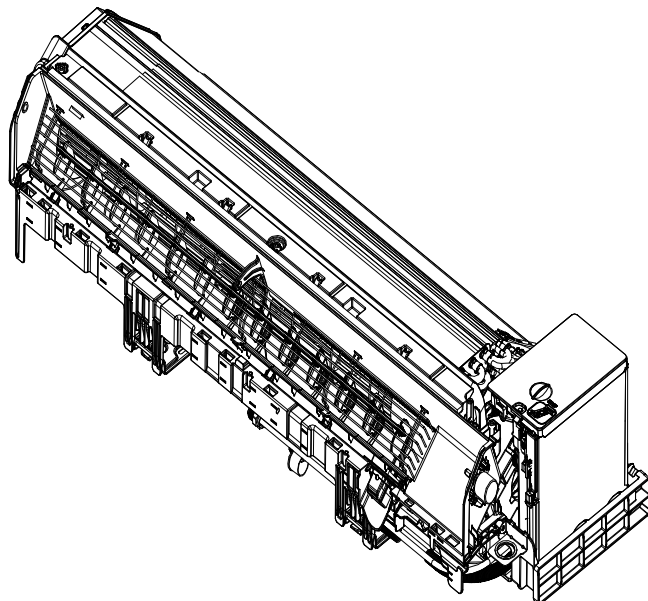

WYT018GLSI25RH
WYT024GLSI25RH

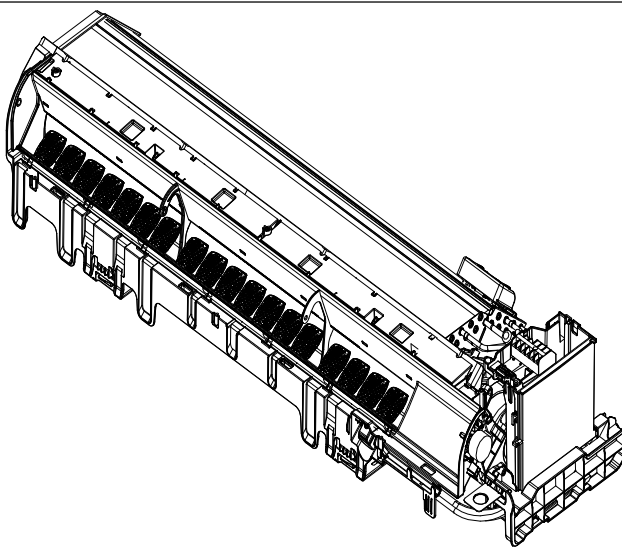

ODU Disassembly

Outdoor Unit Model Numbers: YN009GLSI25RPH | YN012GLSI25RPH | YN018GLSI25RPH | YN024GLSI25RPH

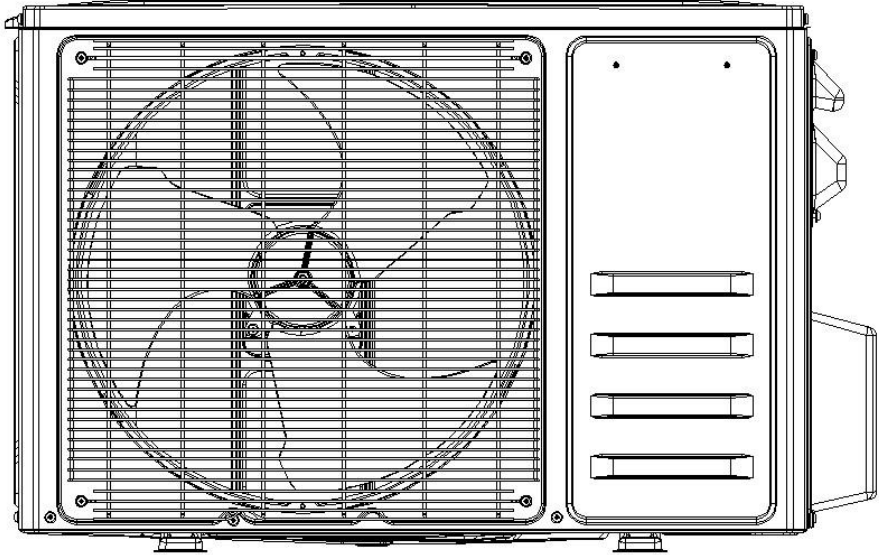
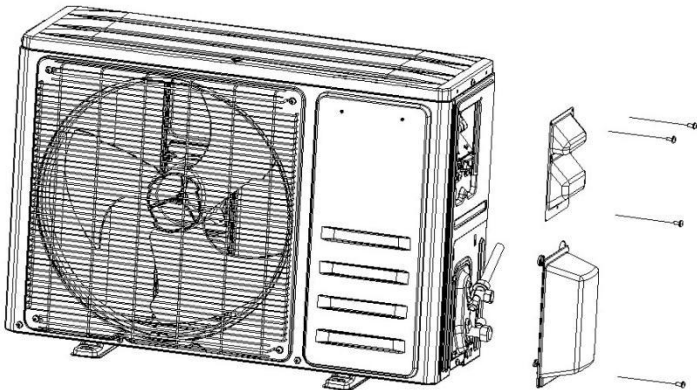
Steps	Reference Photo
Before disassembly	
1: Remove the PCB cover, valve cover, and top cover	
A 1). Unfix 1 screw on the PCB cover, then you can remove the cover from the unit. 2). Unfix 1 screw on the valve cover, and then you can take it out.	

B

Unfix the screws on the top/left/right plates, and then you can take the top cover out.

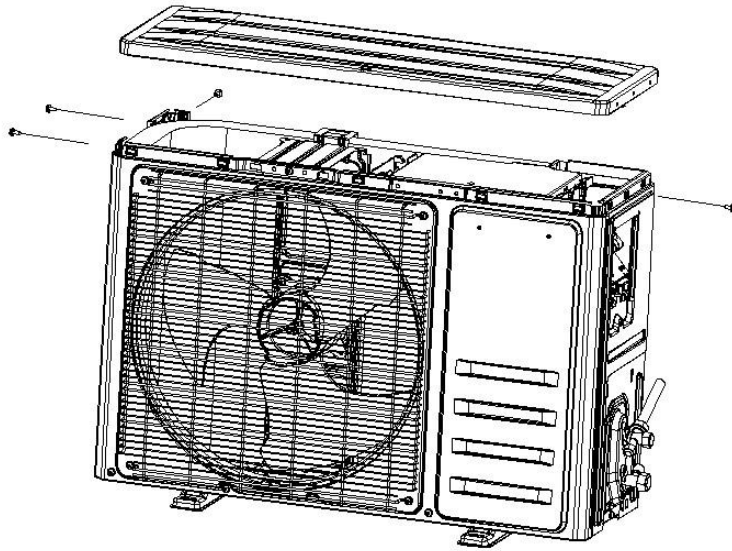

2: Disassemble the fan guard and front panel

A

Remove the screws assembling the grille to the front panel, then remove the grille.

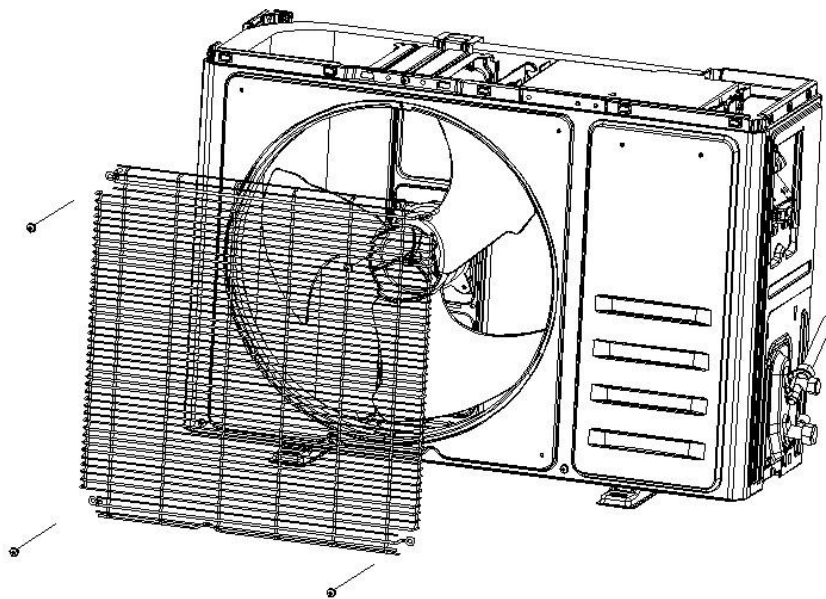

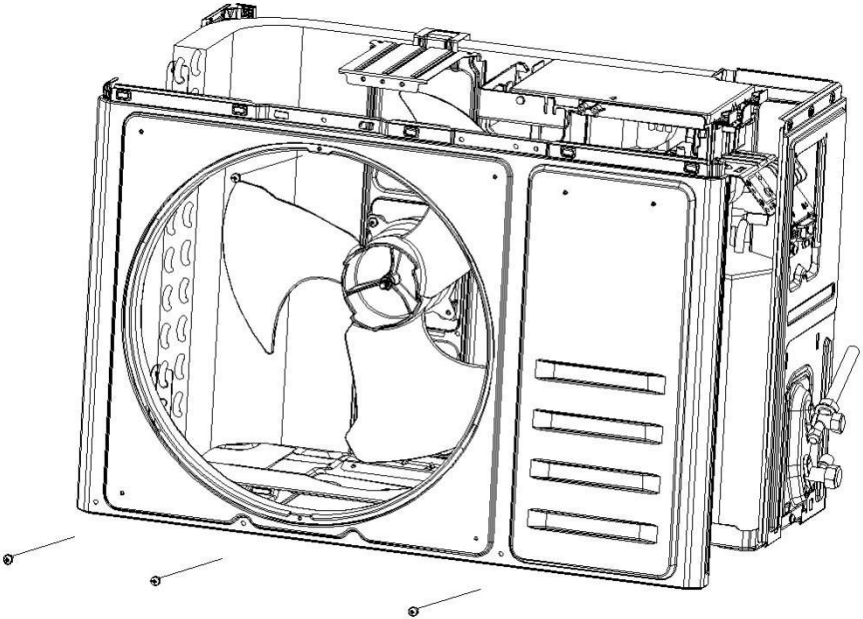
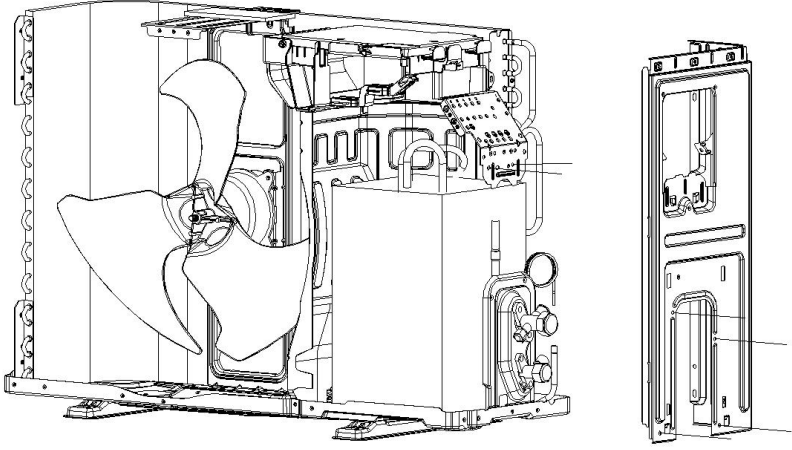
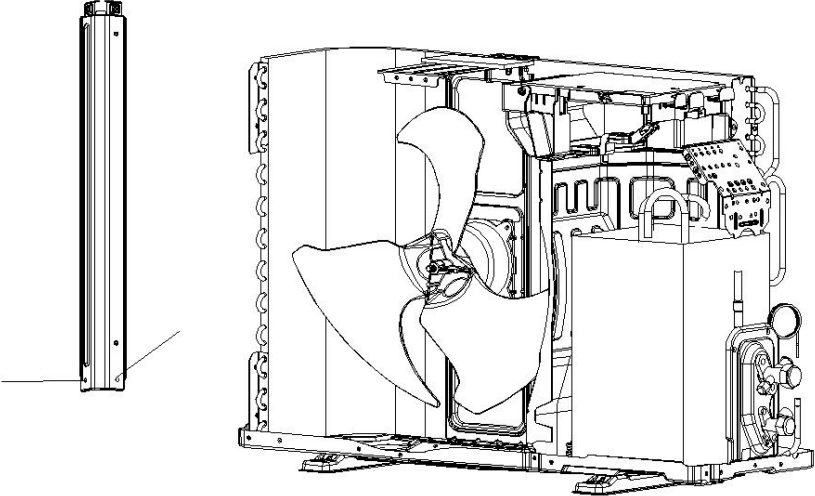
B	<p>1). Unfix the screws on the front panel of the fan guard.</p> <p>2). Separate the ODU middle plate and base plate. Lift the front panel so you can take it out from the unit.</p>	
3: Disassemble the left and right plate		
A	<p>Unfix screws on the right plate, electric box assembly, valve plate, and base plate. You can then take the right plate out.</p>	 → X
B	<p>Unfix the screws on the left plate, base plate, and condenser plate. You can then take the left plate out.</p>	

4: Disassemble the axis fan blade**A**

Unscrew the fan blade nut. Remove the blade.

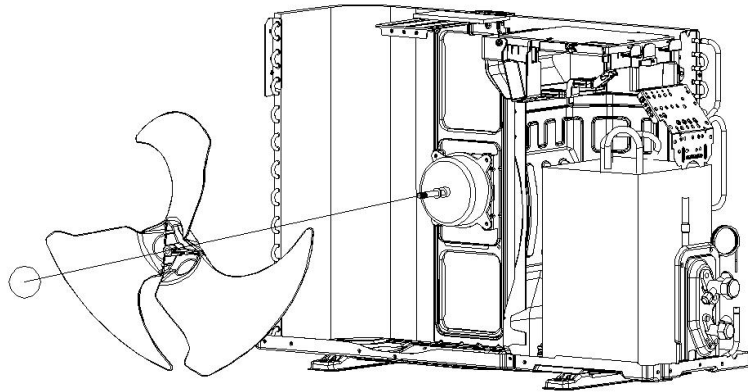
**5: Disassemble the electric box****A**

Unfix the screws on the electric box and motor supporter, etc. Loosen the wiring clamp, then you can take the control box out.

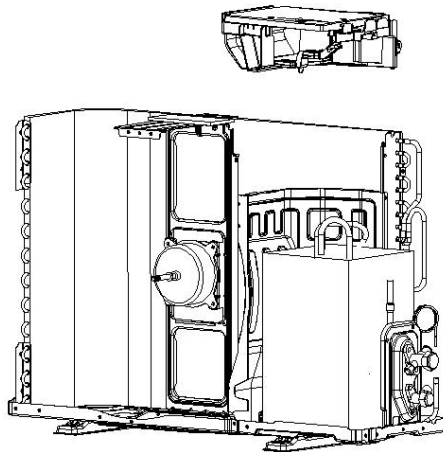
**6: Remove the noise cotton****A**

Take the cotton out, as shown in the picture.

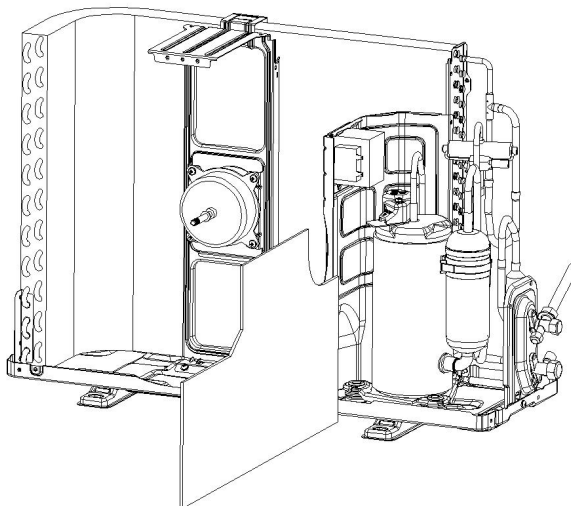

7: Disassemble the separate plate**A**

Unfix the screw on the separate plate and unit, then take it out.

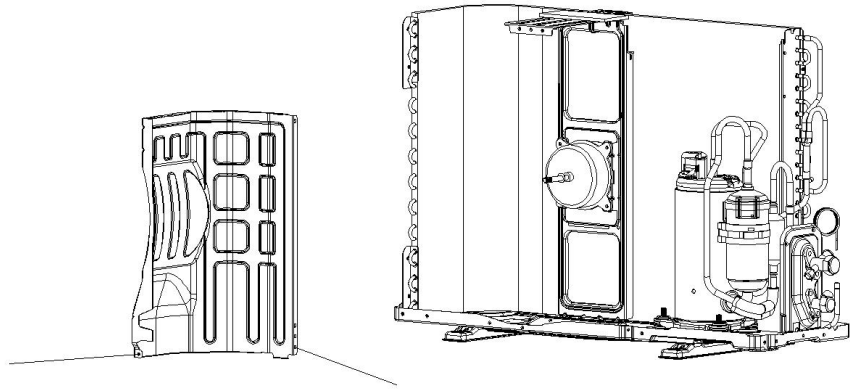
**8: Disassemble the 2-way and 3-way valve****A**

Unfix the screws on the valve plate and base. You can take the 2-way and 3-way valve out by welding.

Note:

- 1). Welding can only occur while there is no gas in the unit.
- 2). Pay attention to the fire to prevent any injury.

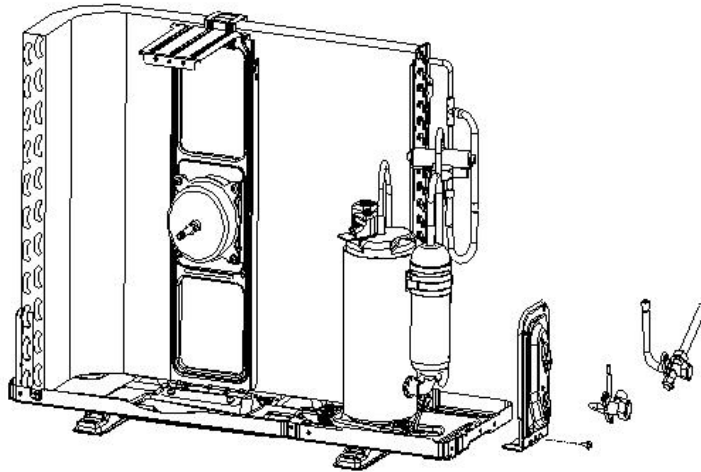
**9: Disassemble the 4-way valve assembly****A**

Remove the 4-way valve from the system by welding. Ensure there is no damage to the compressor, nameplate, etc.

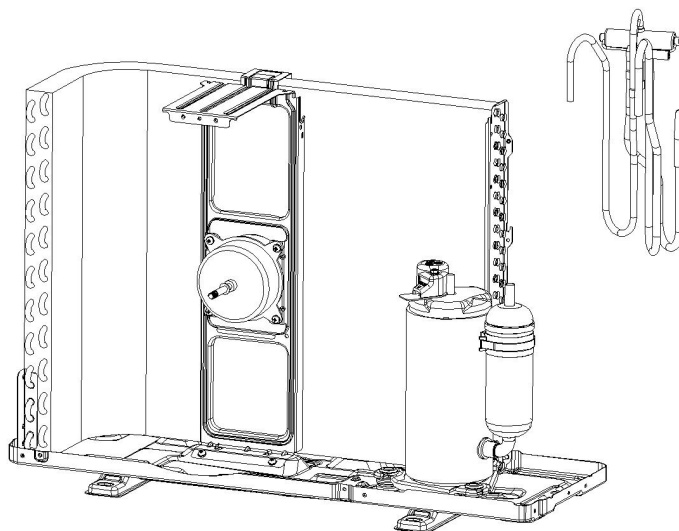

10: Disassemble the compressor**A**

Unscrew the nuts and remove the compressor.

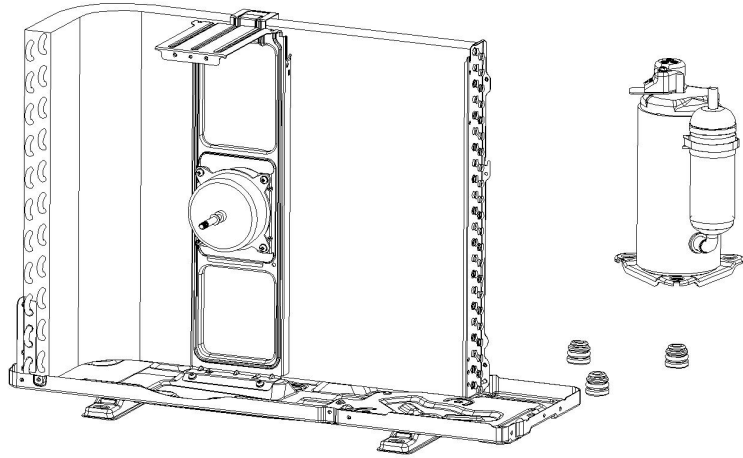
**11: Remove the fan motor and fan supporter****A**

Unfix the screws on the fan motor and supporter, then remove the supporter of the base plate.

Note: Pay attention to the motor wiring. It can't be taken out by force.

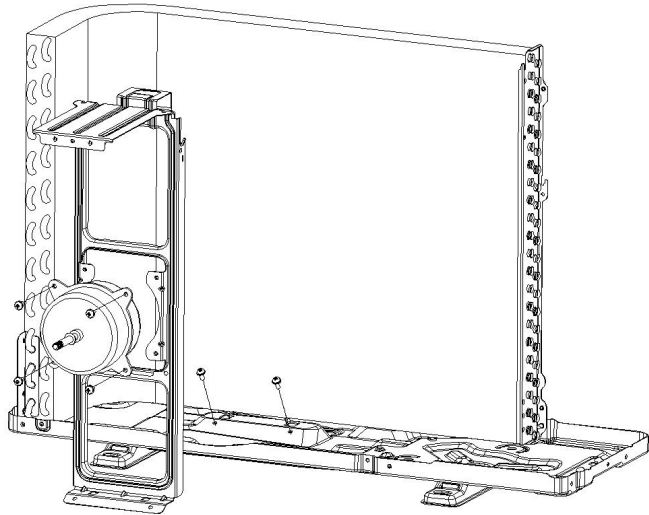

The design and specifications of this product are subject to change without prior notice as development continues. Consult with the sales agency or manufacturer for details. Refer to the equipment nameplate for all other applicable specifications.



is a registered trademark of Parker Davis HVAC International, LLC.

Parker Davis HVAC International
7290 NW 77 Court, Miami, FL 33166 - USA
Tel : (305) 513-4488
Fax : (305) 513-4499
E-mail : info@pdhvac.com
Website: www.pdhvac.com

Pioneer product line, parts, and supplies are available online for convenient ordering at:
www.highseer.com
www.pioneerminisplit.com

Scan the below code to visit our support page where you can find more installation materials:

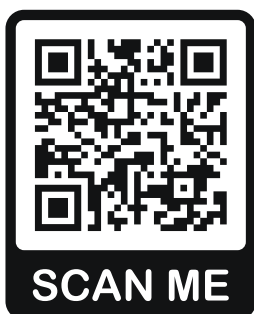

Copyright © Parker Davis HVAC International, LLC. All rights reserved.
