

Saros Z70 Robotic Arm Operation Guide

What Can the Robotic Arm Do?

- Remote Control Pick Up
- Sort Items
- Follow-up Cleaning
- Switch Between Robot Camera and Robotic Arm Camera during Remote Viewing

First-Time Setup: Enable the Robotic Arm

You need to enable the robotic arm function before first use.

① ③

Emergency Stop Button

Power Button

When the robotic arm is inside its compartment:

- Press and hold both the **Emergency Stop Button** and the **Power Button** to

enable or disable the robotic arm function.

(Note: This only enables or disables the robotic arm. To deploy it, please use the app.)

By the way, when the robotic arm is outside its compartment:

- Press the **Emergency Stop Button** to immediately stop the robotic arm.
- Press and hold both the **Emergency Stop Button** and the **Power Button** to reset the robotic arm.

(The robotic arm will return to its compartment, and the Electric Hatch will close.)

Please refer to the attached video for guidance: : <https://youtu.be/tX6-pCwVwNs>

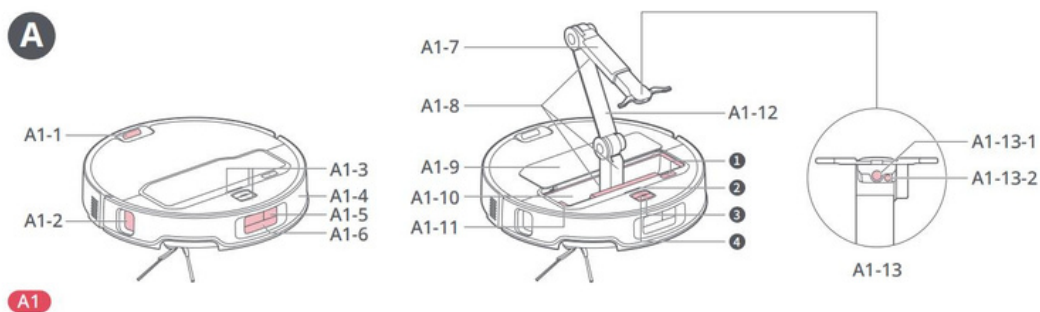

First Function: Sort Items

Add Storage Zones

To sort items, first add Storage Zones on the map.

Go to the home page, tap the Edit button, and add **Shoe Storage Zone** and **Roborock Storage Box**. Adjust their size and position, then tap **Save**.

Note:

1. A physical storage box is included in the package. Place it at the physical location matching the Fabric Storage Zone.
2. The storage box provided for the robot is made of integrated cardboard and needs to be folded and assembled into a box. Please refer to the attached video for guidance: <https://youtube.com/shorts/EqnP8aDcc88>

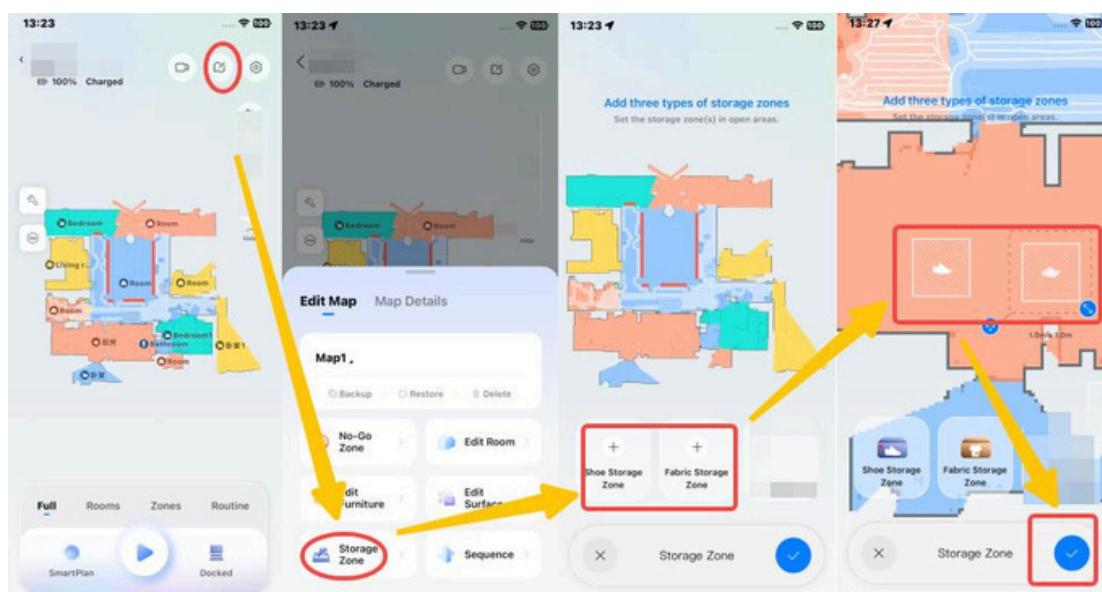

Automatic Sorting

You can organize items either by automatic sorting or manual sorting — both methods work, so just pick the one that suits you best!

To turn on automatic sorting, go to **Settings > Robotic Arm Setting > switch on Automatic Sorting**.

Once it's enabled, the robot will start sorting items automatically during its cleaning tasks.

You can watch the video tutorial here: <https://youtu.be/y6LrSgx3DUk>

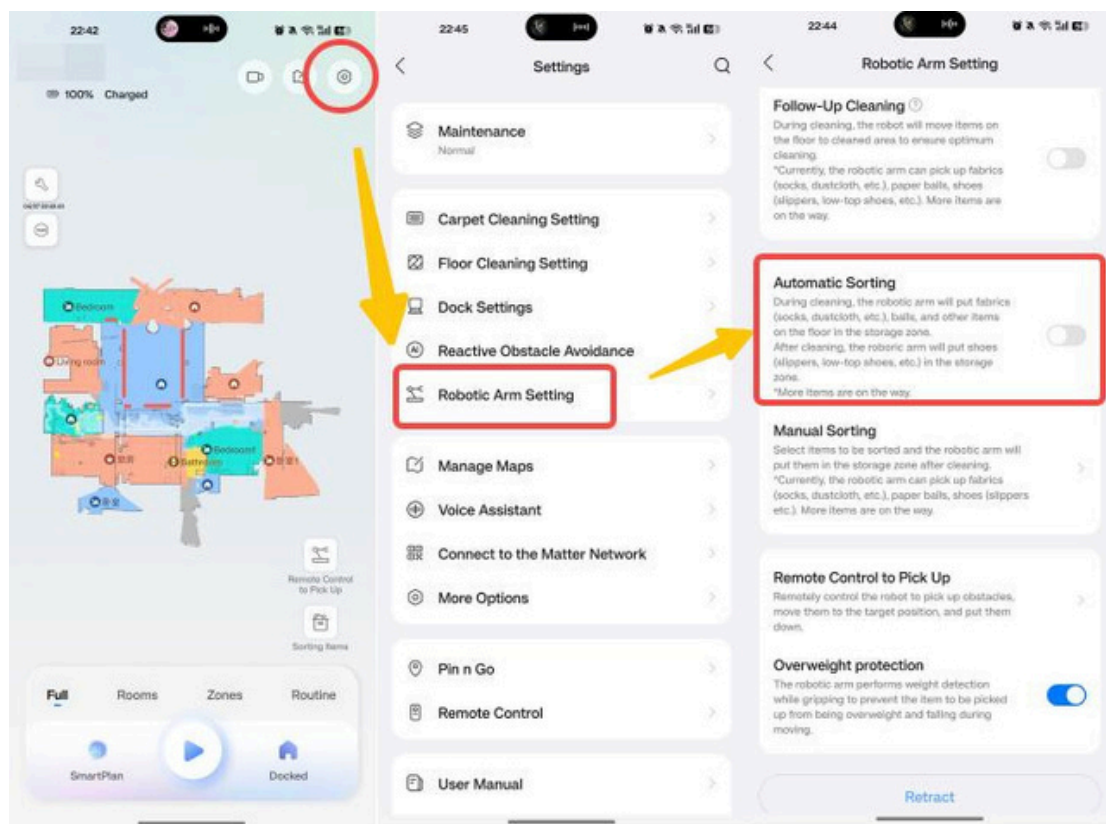

Manual Sorting

Turn off **Automatic Sorting** first.

There are two ways to start **Manual Sorting**, and you can use either one:

1. Tap **Sorting Items** on the homepage.
2. Or go to **Settings > Robotic Arm Setting > Manual Sorting**.

Select items icon and then tap **Start Sorting**.

You can watch the video tutorial here: https://youtu.be/CmH_TEONxVs

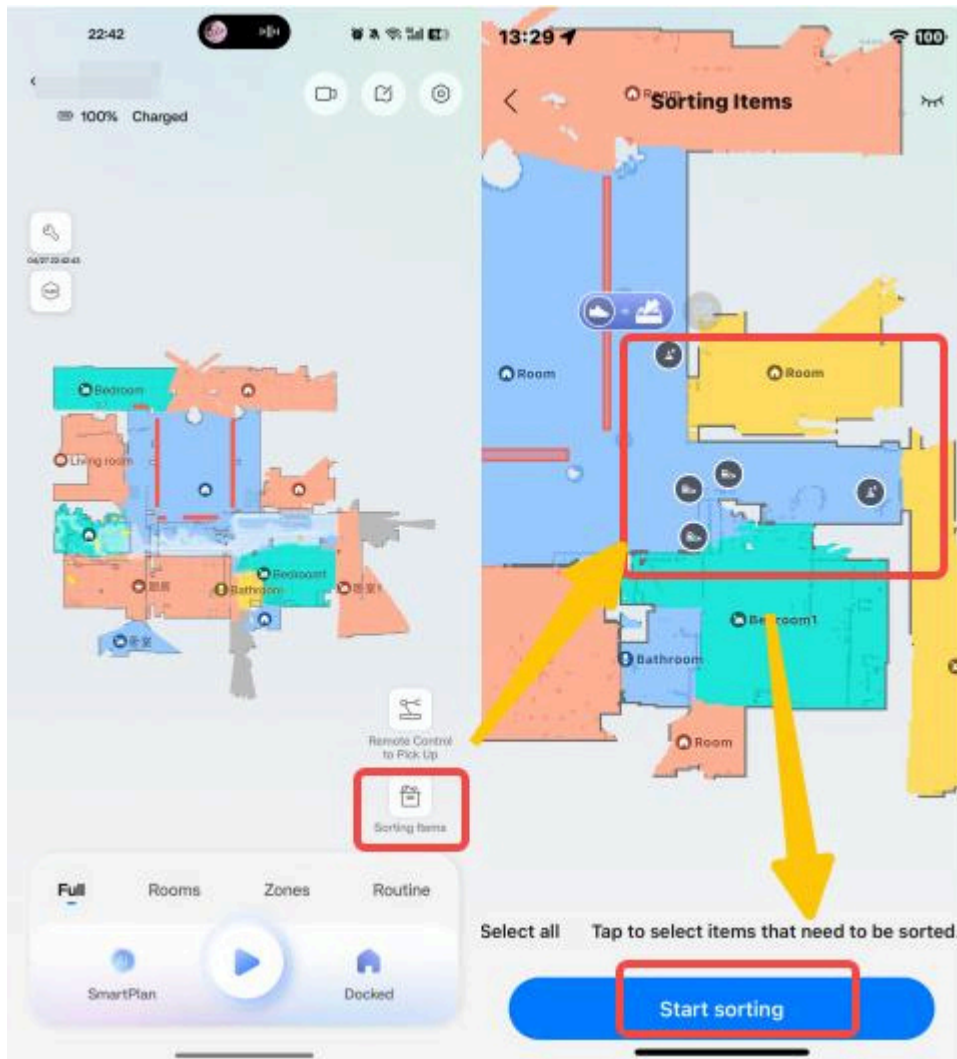

Alternatively, you can tap the obstacle icon directly on the map. You will see a **Sorting** option. Tap it to have the robot sort the selected item.

Note: This method is only applicable for sorting a single item.

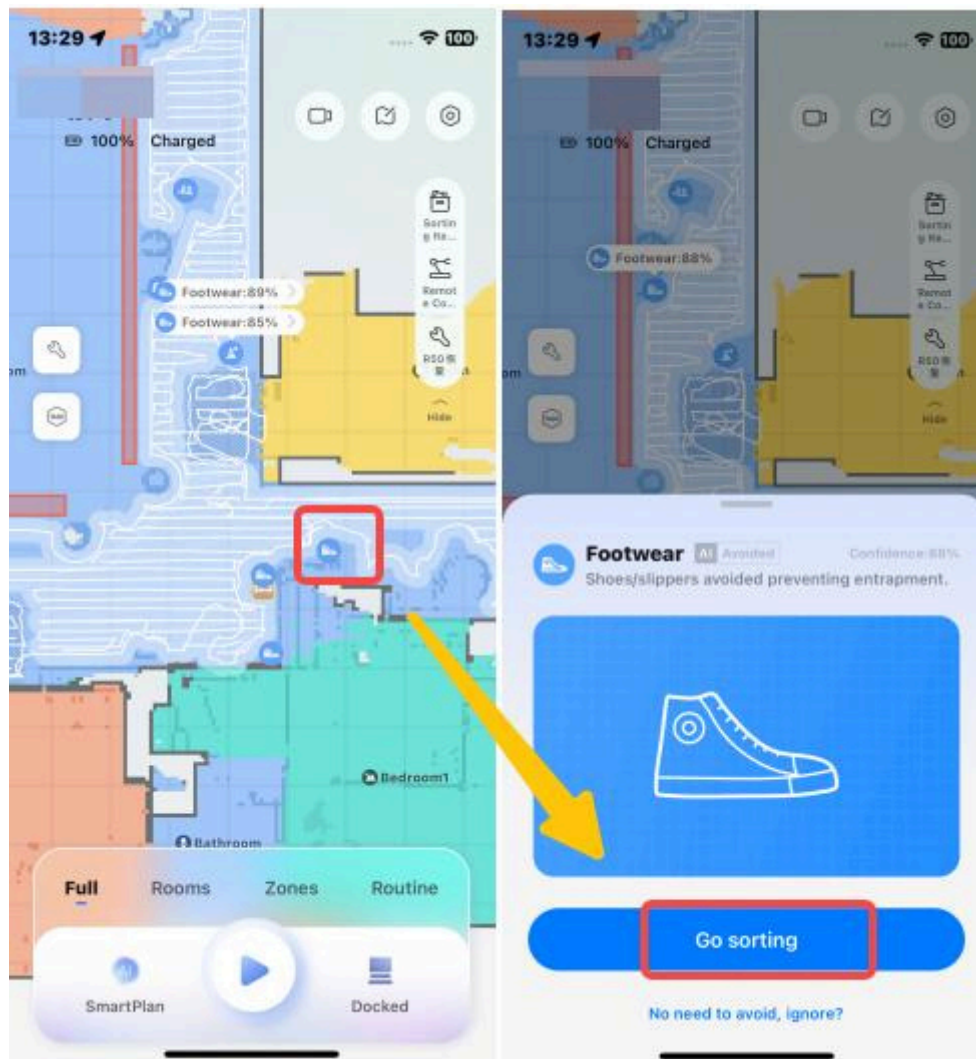

Second Function: Remote Control to Pick Up

You can control the robotic arm to pick up items remotely.

On the main map page, tap the **robotic arm icon** to enter the **Remote Viewing** page. Then tap **Remote Control to Pick Up** at the bottom right to access the control interface.

Note: A 2-way video call feature is also available on this page, but this section focuses on Remote Control to Pick Up.

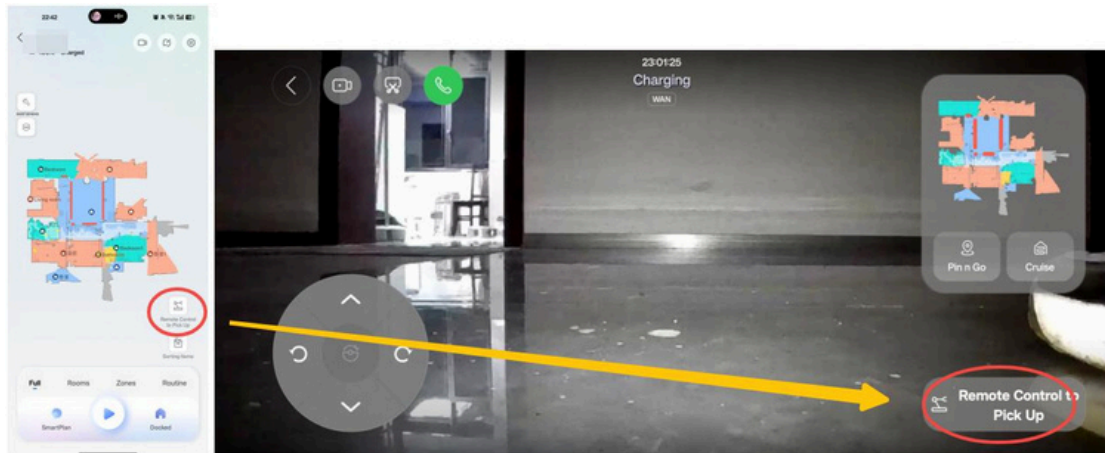

Automatic pick up

Auto Pick Up includes two stages:

Pick Up and **Put Down**.

Pick Up

1. Move the robot until the item is positioned inside the blue zone.
2. Tap **Start Picking Up**. The robotic arm will automatically grip the item.
3. If needed, tap **Pause** to either **Continue Picking Up** or **End Picking Up**.

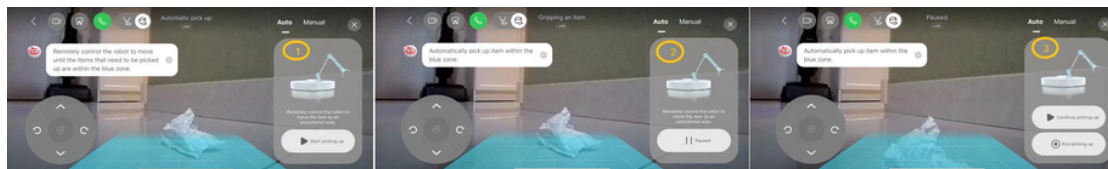

Put Down

After successfully picking up the item, move the robot to a clear area. Tap **Put Down** to release the item.

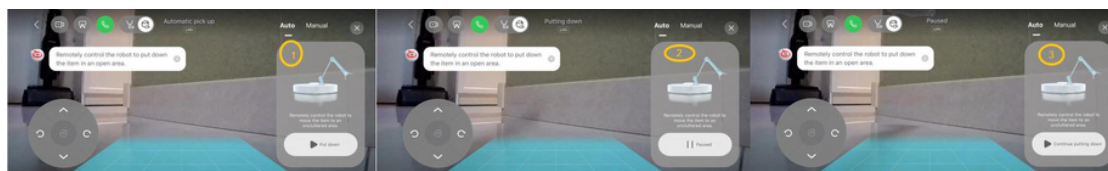

You can watch the video tutorial here: <https://youtu.be/PykRa9Q5E-c>

Manual pick up

Tap the robotic arm icon on the main map to open the **Remote Control to Pick Up** page, then switch to **Manual** mode.

There are two ways to control the arm: **Arm Motion** and **Joint**.

- **Arm Motion** controls the M5 joint and the end claw—it's simpler and quicker to use.
- **Joint** gives you finer control over M3, M4, and the end claw. (You can check the diagram below for reference.)

In both control modes, you'll see three control columns:

-
- Left: Turn the claw (end effector) in different directions.
- Middle: Move the arm or joints up and down.
- Right: Move the arm or joints forward and backward.

At the bottom, you'll find two buttons:

- A closed claw icon = **Pick Up** an item.
- An open claw icon = **Put Down** an item.

You can watch the video tutorial here: https://youtu.be/_I9xc6bPfN8

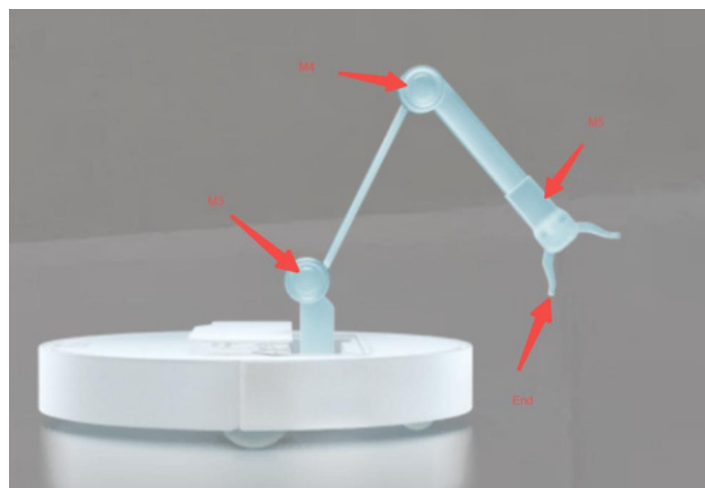
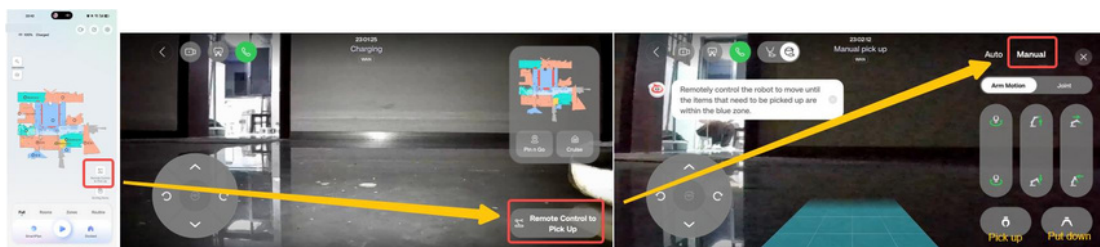

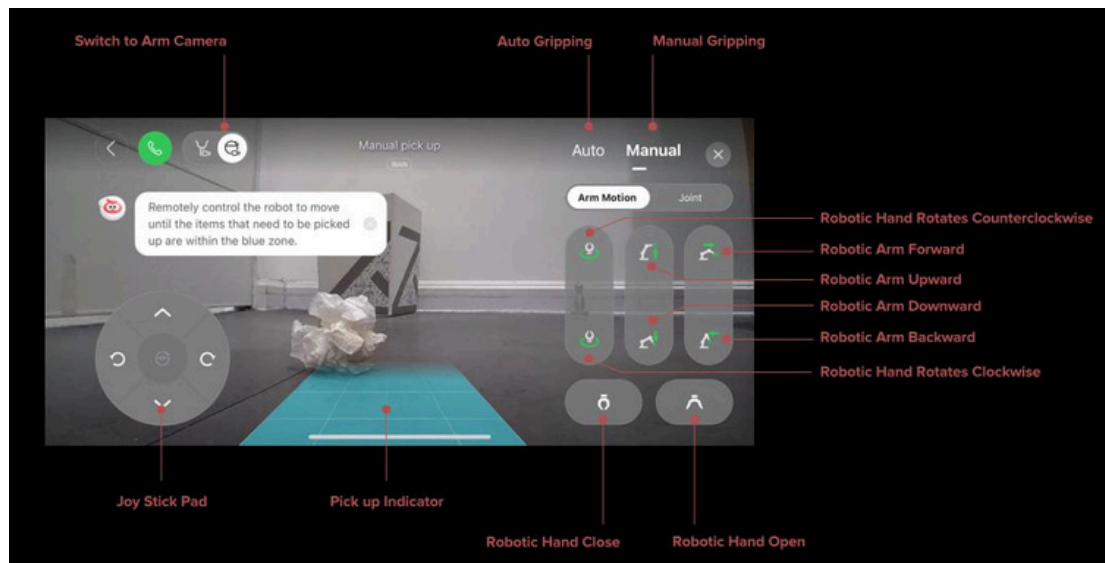

Third Function: Switch Between Robot Camera and Robotic Arm Camera

In 'Remote Control to Pick Up page', tap the camera icons to switch between the robot's main camera and the robotic arm camera.

You can also adjust the arm and joint positions on the Manual Pick Up page to change the robotic arm camera's viewing angle.

You can watch the video tutorial here: <https://youtu.be/IWyT4Cvc1yQ>

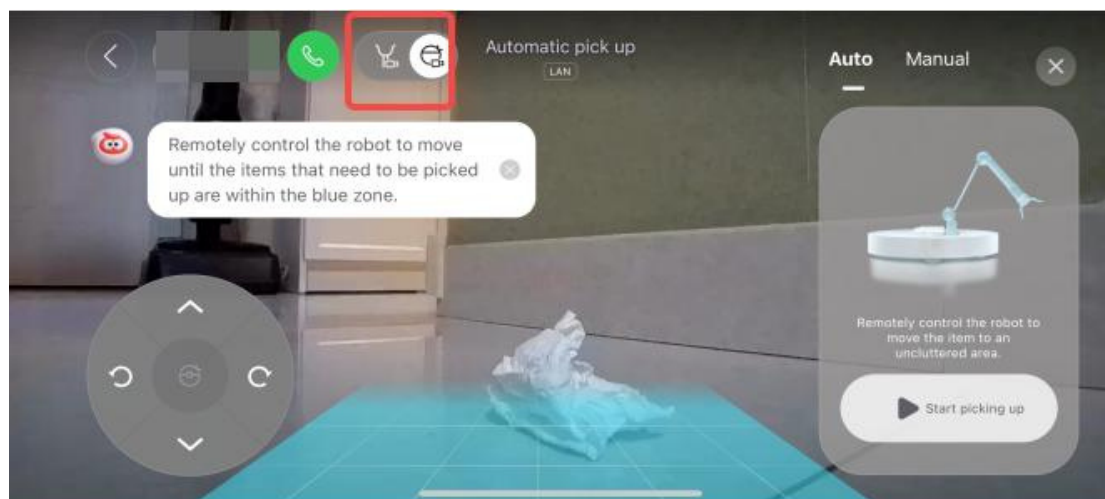

Forth Function: Follow-up Cleaning

The robot uses the robotic arm to move small items out of the way to clean

underneath, helping prevent missed spots.

Supported items include fabrics (socks, dust cloths), paper balls, and shoes (slippers, low-top shoes).

Enable it via **Settings > Robotic Arm Settings > Follow-Up Cleaning**.

Once enabled, the robot will perform this action automatically during cleaning: no manual operation needed.

You can watch the video tutorial here: <https://youtu.be/CPTToEHqLmas>

