

小米

User Manual for Whole-House Router BE3600 Pro

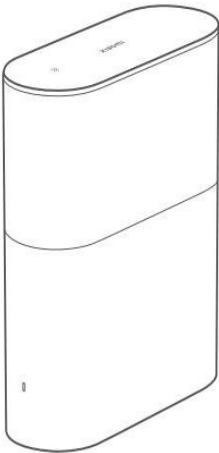

Packaging List



Xiaomi Whole-House Router BE3600 Pro

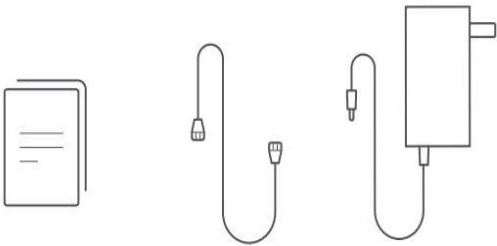

Instruction manual

Network cable

Adapter

Product Introduction

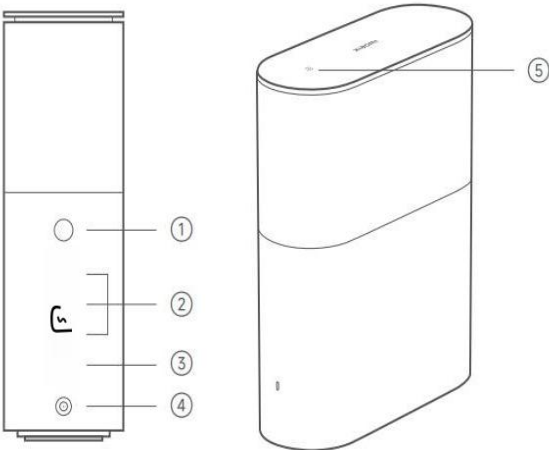

Serial Number	Name	Purpose
①	MESH/RESET button	Short press: For networking with routers supporting Xiaomi Mesh function * Long press: Restore router to factory settings
②	1G network port	A network port with a rate limit of 1 Gbps, which can be used as a WAN port or a LAN port (automatically identified)
③	2.5G network port	A network port with a rate limit of 2.5 Gbps, which can be used as a WAN port or a LAN port (automatically identified)
④	Power interface	Used for connecting the power adapter
⑤	NFC	For Android phones - simply touch to connect to the router's Wi-

You can check the product models and versions that support Xiaomi Mesh on the official website of Xiaomi Mall. The NFC pairing function requires the mobile phone to have NFC enabled and to be in the screen-locked and unlocked state.

Indicator light status	Explanation
Turn off	Off-state or without power connection
Orange is constantly illuminated.	System is starting up or there is an abnormal network connection.
Orange breathing	Startup completed. System is ready for configuration.
Orange flashing	In the Mesh main router, or during system upgrade
Blue light is constantly on.	Normal operation
Blue breathing	A configurable sub-router has been found. If no network configuration operation is performed for 2 minutes, it will automatically return to its normal bright state.
Blue flashing	Access of lower-level nodes

## Internet configuration

### Step 1: Connect

Please power on the router and connect any of its network ports to the wall socket or the LAN port of the optical modem/broadband modem. Optical MODems/broadband modems are provided by broadband operators. If they are not provided, the incoming network cable needs to be directly connected to any network port on the back of the router.

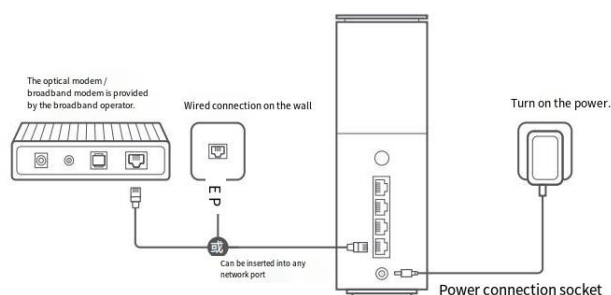

### Step 2: Set up Internet access

Use your mobile phone or computer to connect to Wi-Fi (without a password). The Wi-Fi name can be found on the bottom label of the router.

At this point, the page will automatically navigate to the Internet access guidance page (if there is no automatic redirection, please open the system's default browser and enter miwifi.com).

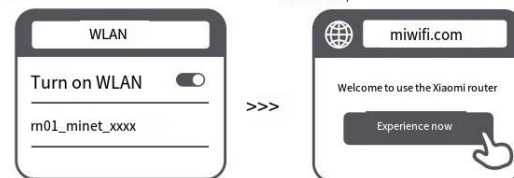

Note: Please wait until the indicator light turns into an orange breathing pattern, then search and connect to the Wi-Fi.

2. Please enter the account and password provided by your broadband operator and click "Next" (This step may be skipped depending on your internet connection method.)

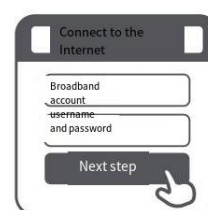

Note: If you forget your broadband account password, you can contact the broadband operator for assistance.

Below are the customer service phone numbers of the commonly used operators:

Telecommunication broadband customer service: 1000  
Broadband Connection Customer Service: 96007  
China Unicom Broadband Customer Service: 10010  
Great Wall Broadband Customer Service: 95079  
Mobile Broadband Customer Service: 10086

3. Set up a new Wi-Fi and manage the password. You can also use the Wi-Fi password as the management password at the same time.

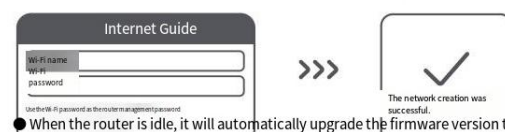

● When the router is idle, it will automatically upgrade the firmware version to provide a better experience. Note: If the Wi-Fi configuration has been modified, after this step is completed, the Wi-Fi module will restart, resulting in a temporary inability to detect Wi-Fi. Please try to search for Wi-Fi again later.

## Mi Home APP Management

To enjoy a better experience, it is recommended to use the Mi Home APP.

### Manage the router.

Connect the mobile phone to the Wi-Fi of the router.

2. Open the Mi Home APP and log in using your Xiaomi account.

Note: You can scan the QR code below with your mobile phone, or search for and download the Mi Home APP in the app store.

3. Follow the prompts that automatically pop up to complete the binding.



Install the Mi Home APP  
Manage the Xiaomi router

## Xiaomi Mesh Network Setup

If you need to achieve better network coverage for larger spaces, you can purchase multiple routers that support the Xiaomi Mesh function. Follow the steps below to set up the Mesh network.

The product models and versions that support the Xiaomi Mesh function are subject to the official website of Xiaomi Mail.

### Operation process

The following operation procedures are all based on the Xiaomi Whole-House Router BE3600 Pro as the main router.

#### Method 1: Network setup via Mi Home APP

Click on the Mi Home APP.

2. Enter the "Mesh Network Device" page of the main router.

3. Click on "Add Node".

4. Follow the prompts for setting up the network to complete the process.

#### Method 2: Mesh key group networking

Please place the sub-router near the main router and connect it to the power supply.

Note: Ensure that the distance between the main router and the sub-router is more than one meter. Otherwise, the two routers will interfere with each other and affect the network configuration.

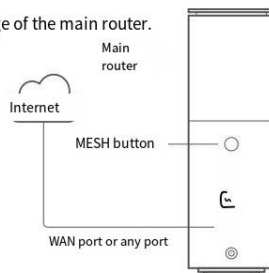

2. After the secondary router is powered on, the main router will automatically detect the secondary router and the indicator light will start to breathe in blue color.

Note: If the sub-router has been configured, please first press and hold the RESET button for 5 seconds to restore it to the factory settings.

3. Press the MESH button on the main router briefly. The indicator light of the main router will start flashing in blue.

### Start the networking process.

4. Wait for the indicator light of the sub-router (for single-light products) or the Internet indicator light (for dual-light products) to come on.

The indicator light turns white or blue and remains constantly on, indicating that the network setup is successful.

5. Place the sub-router at the location requiring Wi-Fi coverage and turn it on.

## Method Three: Wired Network Setup

Please place the sub-router in the area where Wi-Fi coverage is needed and turn on the power.

2. Connect the WAN port of the sub-router (or any port if there is no WAN port) to the LAN port of the main router (or any port if there is no LAN port).

The indicator light of the main router will start flashing blue, and the networking process will begin.

Note: If the sub-router has been configured, please first press and hold the RESET button for 5 seconds to restore it to the factory settings.

3. Wait until the indicator light of the sub-router (for single-light products) or the Internet indicator light (for dual-light products) turns white or remains constantly blue, indicating that the networking is successful.

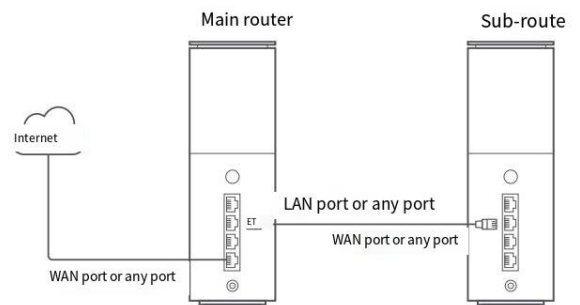

## Help for Xiaomi Router

You can scan the QR code below with your mobile phone to access the pop-up page and obtain the assistance information you need.



Product model: RNO1

Scan the QR code to watch the video and enjoy more convenient services.

Service hotline:  
400-100-5678

Product Name: Wireless Router

Product model: RNO1

Manufacturer: Beijing Xiaomi Electronic Products Co., Ltd.

Address: Beijing Economic and Technological Development Zone, Beijing

Room 802, 8th Floor, Building 5, Block 15, Science and Innovation Street 10

Service hotline: 400-100-5678

Service website: [www.mi.com/service](http://www.mi.com/service)

Note: The model parameters and safety information of this product are displayed in the manual and on the bottom of the product device.



Paper

## Q&A

Why can't I access the internet even though I have completed the internet connection setup?

Confirm whether the Wi-Fi network of the router can be found through the mobile phone. If not, make sure the router is powered on and has completed its startup process.

2. Use your mobile phone to locate and connect to the router.
3. Visit the website [miwifi.com](http://miwifi.com).
4. Try to fix the problem based on the network diagnosis results.

How to restore the router to its factory settings?

Make sure the router has completed its startup process.

2. Press and hold the RESET button of the router for more than 5 seconds.
- Note: Once the indicator light turns orange, you can release the RESET button.
3. After the router successfully restarts, the reset operation is completed.

Note: After resetting the router, it will revert to its factory settings. You will need to reconfigure the router accordingly.

What should I do if I forget the password for the router's backend management?

If no special settings are made, the management password will be the same as the Wi-Fi password. Please try to log in. If the problem cannot be solved, it is recommended to restore the router to its factory settings and reconfigure the internet connection.

Electronic Information Product Hazardous Substance Declaration

Toxic and harmful substances or elements						
Component Name	Lead	Hg	Cd	Hexavalent chromium Cr(VI)	Dibrominated biphenyls PBB	PBDE
Shell	○			○		○
Circuit board	○	○	○	○	○	○
Power adapter	×	○	○	○	○	○
Attachment	○	○	○	○	○	○

This table is compiled in accordance with the provisions of SJ/T11364. : This indicates that the content of the toxic and harmful substance in all homogeneous materials of this component is below the limit requirements stipulated in the GB/T26572 standard.

×: This indicates that the content of the toxic or harmful substance in at least one homogeneous material of this component exceeds the limit requirements stipulated in the GB/T26572 standard.

Note: This product adopts an environmentally friendly design concept and effectively controls harmful substances. The "×" indicates that the harmful substances are mainly due to limitations in technological development and cannot be replaced. However, they meet the exemption requirements of the GB/T26572 standard.

This logo also indicates the environmental usage period of the product and its components. When certain components have different environmental usage periods, they will be separately marked (for example, the battery unit module will have another label attached to its product). This environmental usage period only applies to the conditions specified in the product manual for operation.

This document pertains to electronic and electrical products that are imported or sold within the territory of the People's Republic of China.

10

Router Performance Failure Report

Name	Performance failure
Wireless router	<p>After the product is activated, the indicator light remains constantly orange for more than two minutes without breathing.</p> <p>After the product is powered on, it fails to start or the indicator light does not illuminate.</p> <p>The function buttons of the product are not functioning properly.</p> <p>The product cannot be set up for internet access after being activated.</p> <p>The product is unable to connect to Wi-Fi after being powered on.</p>

Router Three-Party Warranty Certificate

Warranty regulations

This product's after-sales service strictly follows the "Consumer Rights Protection Law of the People's Republic of China" and the "Product Quality Law of the People's Republic of China" to provide three guarantees service after sale. The service contents are as follows

Within 7 days from the date of your receipt, if the product exhibits any of the performance failures listed in the "Router Performance Failure List", and is confirmed through testing by the Xiaomi after-sales service center, you will be entitled to free return or exchange services.

2. From the day you receive the product, within 8 to 15 days, if there is a router performance failure as per the "Router Performance Failure List", you can apply for a replacement or repair service.

The listed performance issues have been confirmed through testing by the Xiaomi after-sales service center and can be resolved for free.

3. Within 12 months from the date of your receipt, if the product experiences any of the performance failures listed in the "Router Performance Failure List", and is confirmed by the Xiaomi after-sales service center, you will be entitled to free repair services.

Non-warranty regulations

Unauthorized repairs, misuse, collisions, negligence, abuse, liquid ingress, accidents, alterations, incorrect use of non-authorized product accessories, or tearing, altering or defacing labels, security marks, or labels.

The main information has been obscured and is illegible.

2. It has exceeded the validity period of three packages.

3. Damage caused by force majeure.

4. Situations that do not conform to the performance failures listed in the "Router Performance Failure Table".

5. If any performance faults listed in the "Router Performance Failure Table" occur due to human factors, related to this product and its accessories.

Please provide the text that needs to be translated.

Due to the need for using packaging boxes during transportation to ensure the safety of the products, we suggest that you keep the packaging boxes for at least 30 days from the date of receipt.

This product is only available for sale in China (excluding Hong Kong, Macao and Taiwan regions). Therefore, this product is only sold in China.

The company provides after-sales service in the region (excluding Hong Kong, Macao and Taiwan). This warranty policy only applies to the Chinese region (excluding Hong Kong, Macao and Taiwan).

## Instructions for Using Low-Power Devices

---

The NFC technology used in this product complies with the technical requirements for general low-power devices of Class C in the "Directory and Technical Requirements for Low-Power Short-Range Radio Transmitting Equipment", and is used for data transmission applications. The use methods of the integrated antenna, control, adjustment, and switching, etc. can be referred to in the relevant content of the product.

2. It is strictly prohibited to arbitrarily change the usage scenario or conditions, expand the transmission frequency range, increase the transmission power (including the additional installation of RF power amplifiers), or modify the transmission antenna.

3. It is prohibited to cause harmful interference to other legal radio stations, nor is it allowed to claim exemption from such interference.

### Harmful interference protection

4. It should be capable of withstanding interference from radiation radio frequency energy from industrial, scientific and medical (ISM) application equipment, as well as interference from other legal wireless radio stations.

5. If it causes harmful interference to other legal radio stations, it should be immediately stopped from being used, and measures should be taken to eliminate the interference before it can be resumed for use.

6. When using micro-power devices within aircraft or within the electromagnetic protection areas designated by laws, regulations, national relevant provisions and standards for radio telescopes, meteorological radar stations, satellite earth stations (including telemetry, ranging, receiving, navigation stations), military-civilian radio stations, and airports, one must abide by the regulations of the relevant industry authorities for electromagnetic protection.

7. It is prohibited to use any types of model remote controllers within a 5000-meter radius centered on the midpoint of the airport runway.

8. Please use this product within the temperature range of 0°C to 40°C and with a 12V direct current voltage.

## IPv6 Configuration Guide

---

Open the browser, enter miwifi.com, and then enter the password to access the router management page.

2. Click to enter the "Common Settings" > "Internet Settings", and enable the IPv6 function and IPv6 firewall.

3. Refer to the page instructions, select the required working mode, and complete the corresponding settings.

---